

LEGEND:

- EASTING
- WATER LINE
 - DITCH &
 - FENCE
 - SANITARY LINE
 - EDGE OF ASPHALT
 - BURIED STORM
 - COAL LINES
 - ELECTRICAL LINES
 - LIGHTING POWER
 - HYDRANT
 - GATE VALVE
 - MANHOLE
 - TRANSIT SIGHT
 - CONNECTION TO EXISTING WATERLINE

- COLD MIXED 50mm AND PAVED 50mm
- NEW ASPHALT
- CONCRETE SIDEWALK

4	ISSUED FOR TENDER	10/1/11
3	ISSUED FOR 30% REVIEW	10/1/11
2	ISSUED FOR 60% REVIEW	10/1/11
1	ISSUED FOR 100% REVIEW	10/1/11

A	As noted on sheet	A
B	As noted on sheet	B
C	As noted on sheet	C

Project: SPRINGHILL INSTITUTION PARKING EXPANSION
Location: SPRINGHILL, NOVA SCOTIA

Asphalt Layout

Design: R. King - K. Coffey
Drawn: T. McLeod
Date: Nov. 2011
Project Number: R.043943.002
Drawing No. L4

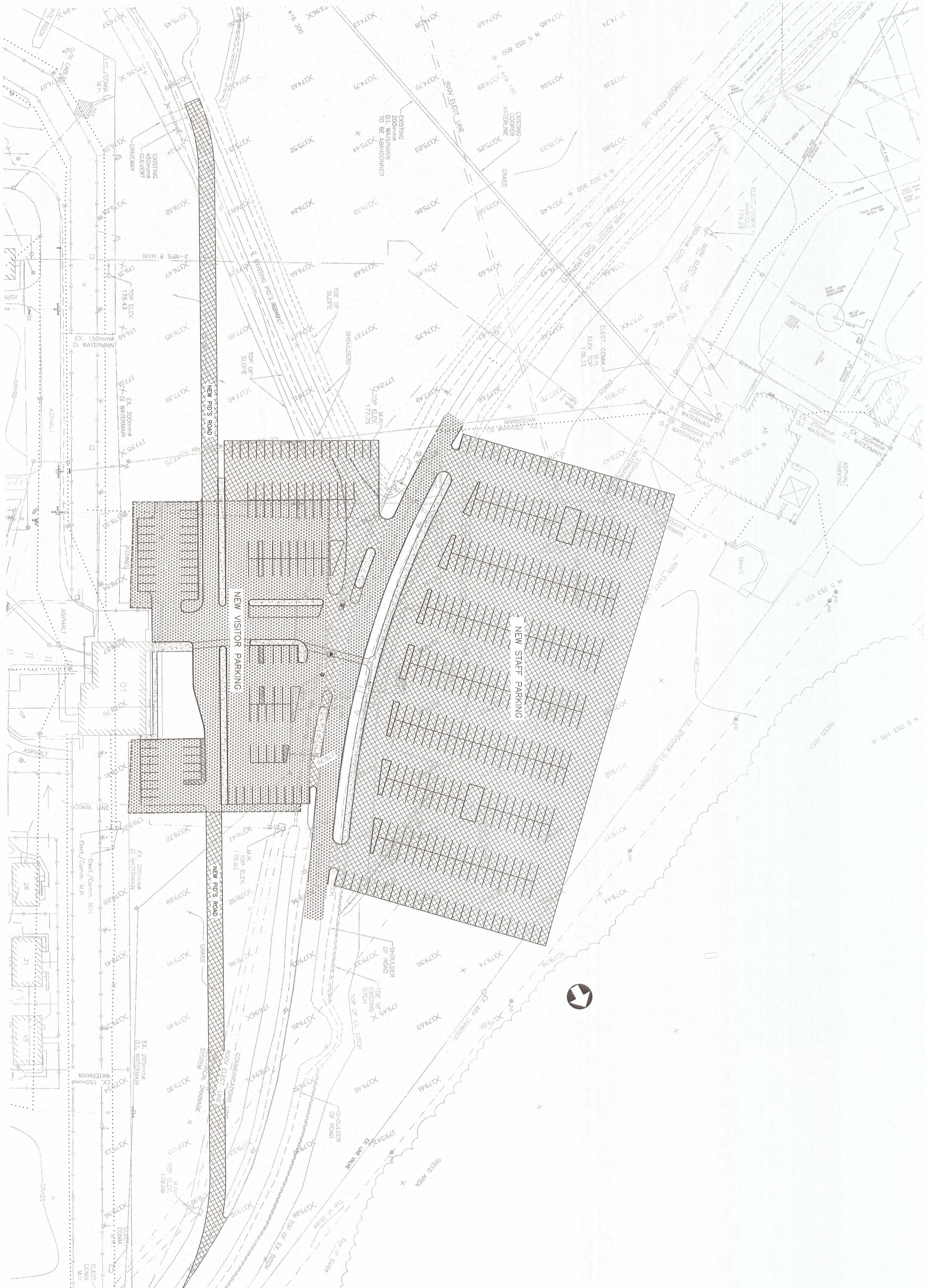

PLAN
SCALE/SCHALE 1:500
0m 10m 20m 30m 40m 50m