

Spec item #: H-11	SPECIFICATION	TCMSB Field #: N/A
H-11 Tow Deck Coating and Inspection		

Part 1: Scope:

1.1 The intent of this item shall be to clean, repair coating, and inspect the Tow Deck of the vessel. A total of 180 m3 are to be prepared for coating, with 150 m3 of original deck to be SSPC-SP-10 Near White Metal and the remainder, 30 m3 being new steel, to be side-swept for proper coating adhesion. Approx deck area is from Frame 1 to Frame 17.

1.2 This work shall be carried out in conjunction with the following:

- Hd-04 Hull Painting
- Hd-12 Ballast Tank Testing and Coating.

Part 2: References:

2.1 Guidance Drawings/Nameplate Data

2.1.1 NJC-11-100

2.1.2 Attached guidance drawing

2.2 Standards

2.2.1 Ships ISM Hot-Work, Confined Space, Fall Protection Lockout Procedures

2.2.2 Steel Structures Painting Council Standard (SSPC)

2.3 Regulations

2.3.1 TP 4414E Guidelines Respecting Helicopter Facilities

2.4 Owner Furnished Equipment

2.4.1 The contractor shall supply all materials, parts, equipment, labour and tools required to perform the specified work.

Part 3: Technical Description:

3.1 General

Surface Preparation

3.1.1 A total of 180 m2 are to be prepared for coating, with 150 m2 of original deck and remaining 30 m2 are new steel. Abrasive Blast all bare and rusted areas to SSPC-SP-10 (150) Near White Metal and feather back existing intact coating (30) to

accept new coating. The repairs shall include surface preparation and primer coatings to damaged areas. The quote shall include the unit cost per square meter and shall be used to adjust up or down by PWGSC 1379 action the total area for the work. The total area is 180 square meters.

Primer

- 3.1.2** 3.1.2 Apply two full coats of Amercoat 5105 Primer (AX9708 Red Oxide) to all blasted areas. Apply @ 2 to 3 mils DFT.

Topcoat

- 3.1.3** 3.1.3 Apply two full coats of Amercoat 235 (Oxide Red A41270 Deck Red) Topcoat to entire area. Apply @ 2 to 3 mils DFT. Colour considered to be Coast Guard Deck Red.

3.1.4

- 3.1.5** 3.1.4 The thickness determination of the new coating shall be verified and recorded at three positions on each repair area. Measuring points shall be as indicated by the Owner's representative.
- 3.1.6** The areas of the ship's deck as designated by the Chief Officer for Helicopter Operations shall have stenciling renewed. A circular area shall be painted yellow measuring no less than 4.5 meter in diameter Stenciling and Yellow paint shall be owner supplied Amerlock 400 (Yellow).
- 3.1.7** The Contractor shall perform the work in strict accordance with Ameron's application instructions for each applicable coating.
- 3.1.8** All work shall be done to the satisfaction of the Chief Engineer and Chief Officer.

3.3 Location

- 3.3.1** Tow Deck Aft

3.4 Interferences

- 3.4.1** The Contractor is responsible for the identification of all interference items, their temporary removal, storage and refitting to vessel.

Part 4: Proof of Performance

4.1 Inspection

- 4.1.1** All work shall be completed to the satisfaction of the Chief Engineer, Chief Officer and NACE Inspector.

4.2 Testing

- 4.2.1** The contractor shall prove to the owners the DFT measurements at areas where the coating was completely missing.

4.3 Certification

4.3.1 The Contractor shall supply documentation of coatings applied.

Part 5: Deliverables:

5.1 Drawings/Reports

5.1.1 The thickness determination DFT of the new coatings applied shall be verified and recorded. Reports shall be given to Chief Engineer.

5.1.2 All reports from the work specified shall be given to the Chief Engineer.

H-11 TOW DECK COATING + INSPECTION

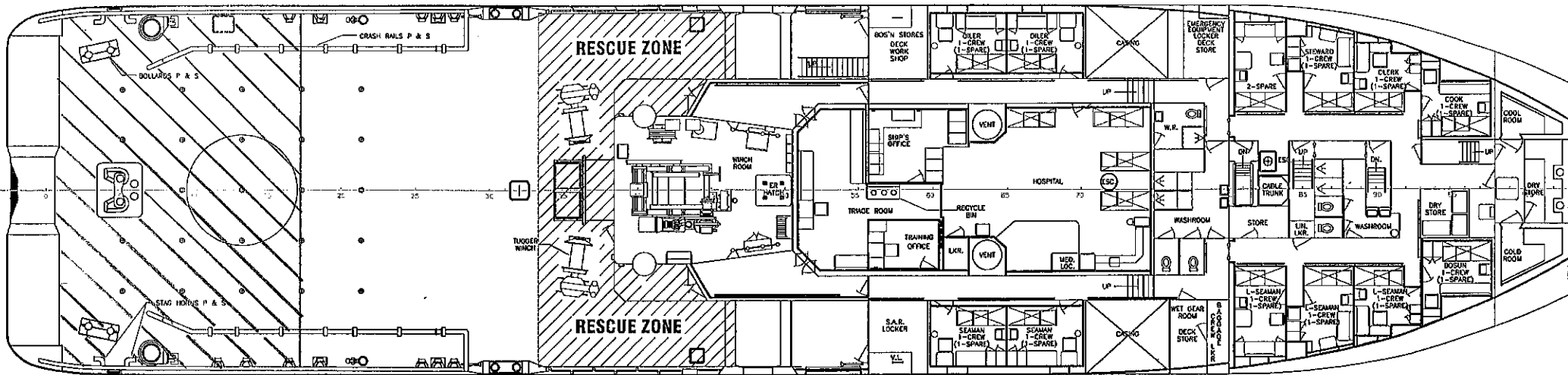

MAIN DECK

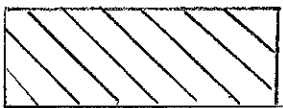

AREA TO BE BLASTED + COATED (DECK ONLY)