

MAIN FLOOR PLAN - HIGH LEVEL
SCALE 1:100

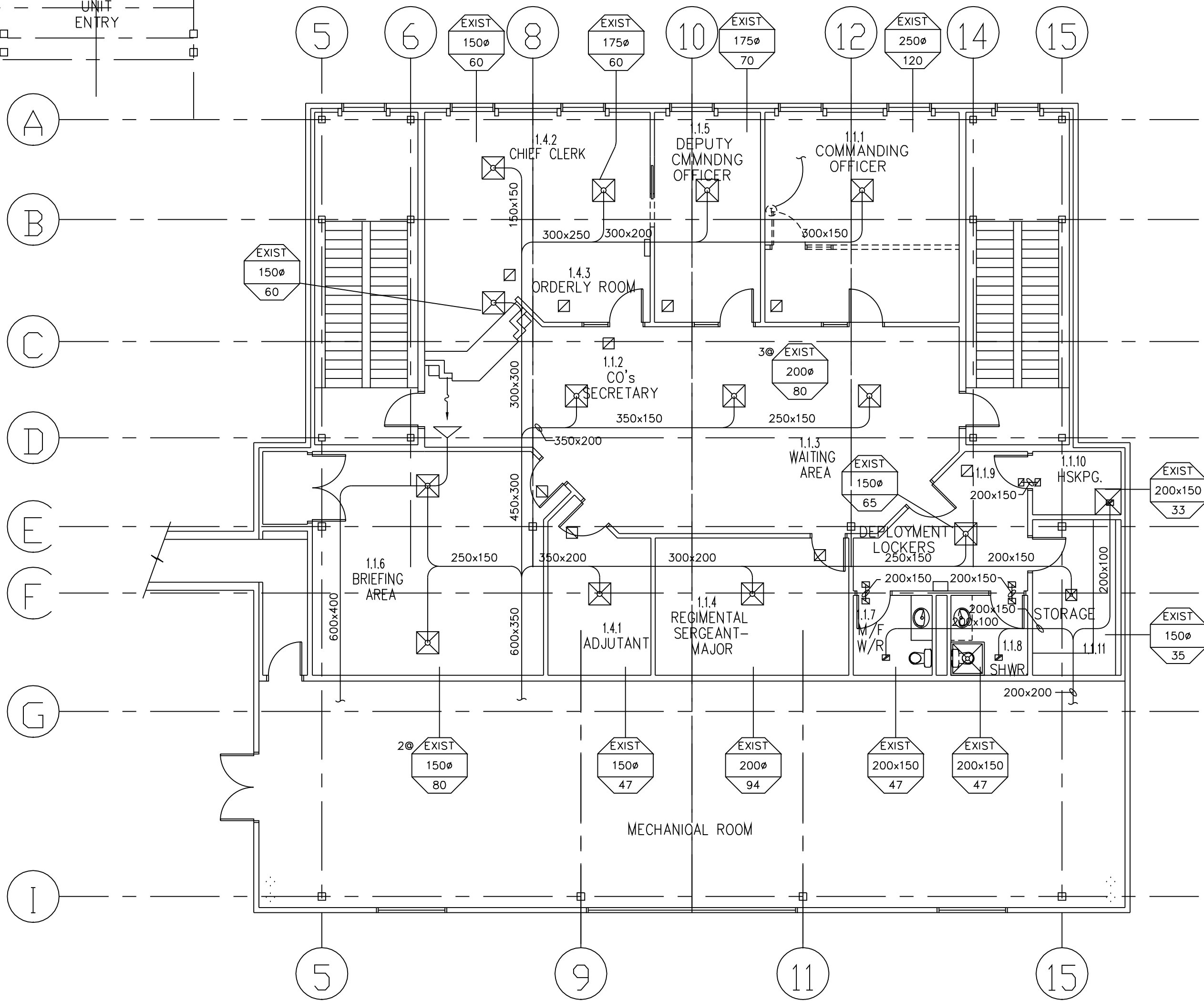

UPPER FLOOR PLAN
SCALE 1:100

- KEYNOTES:**
- REMOVE EXISTING VAV TERMINAL BOX. MODIFY EXISTING 550# SUPPLY AIR DUCT AS SHOWN.
 - CAP & REMOVE EXISTING 750x150 SUPPLY AIR GRILLE.
 - CONNECT NEW 300# SUPPLY AIR DUCT TO EXISTING 400# SUPPLY AIR DUCT & DOWN TO LEVEL ABOVE NEW CEILING. REFER TO DRAWING H-N2-0501/1-411 FOR CONTINUATION.
 - CONNECT NEW 350# SUPPLY AIR DUCT TO EXISTING 400# SUPPLY AIR DUCT & DOWN TO LEVEL ABOVE NEW CEILING. REFER TO DRAWING H-N2-0501/1-411 FOR CONTINUATION.
 - CAP & REMOVE EXISTING DUCTWORK, TERMINAL BOXES & 600x150 SUPPLY AIR GRILLES.
 - CONNECT NEW 450# SUPPLY AIR DUCT TO EXISTING 600# SUPPLY AIR DUCT & DOWN TO LEVEL ABOVE NEW CEILING. REFER TO DRAWING H-N2-0501/1-411 FOR CONTINUATION.
 - CONNECT NEW 350# SUPPLY AIR DUCT TO EXISTING 350# SUPPLY AIR DUCT & DOWN TO LEVEL ABOVE NEW CEILING. REFER TO DRAWING H-N2-0501/1-411 FOR CONTINUATION.
 - RELOCATE EXISTING THERMOSTAT TO NEW LOCATION AS SHOWN. MODIFY CONTROL TUBING AS REQUIRED. MOUNT THERMOSTAT 450mm ABOVE FLOOR LEVEL.
 - SPARE.
 - CAP & REMOVE EXISTING 900x150 SUPPLY AIR GRILLE.
 - ROTATE EXISTING 900x150 SUPPLY AIR GRILLE TO DELIVER AIR DOWNWARD.
 - CONNECT EXISTING 450# SUPPLY AIR DUCT TO EXISTING 500# SUPPLY AIR DUCT.
 - NEW 450# SUPPLY AIR DUCT DOWN TO LEVEL ABOVE NEW CEILING.
 - REMOVE EXISTING 900x150 SUPPLY AIR GRILLE & RETURN TO OWNER.
 - CONNECT NEW 350# SUPPLY AIR DUCT TO EXISTING 600x300 SUPPLY AIR DUCT.
 - 300# SUPPLY AIR DUCT DOWN TO LEVEL ABOVE NEW CEILING.
 - RELOCATE EXISTING EXHAUST FAN AH3EE2 TO NEW LOCATION AS SHOWN. REMOVE EXISTING 600x300 EXHAUST DUCT RISER.
 - EXISTING 1850x800 EXHAUST LOUVRE TO REMAIN.
 - EXISTING 1850x800 OUTSIDE AIR LOUVRE TO REMAIN.
 - EXISTING EXHAUST FAN AH1EE2 TO REMAIN.
 - EXISTING 2100x950 SUPPLY AIR DUCT FROM AH-1 IN MECHANICAL ROOM.
 - EXISTING 2200x800 RETURN AIR DUCT UP TO AH-1 IN MECHANICAL ROOM.
 - EXISTING 400x650 SUPPLY AIR DUCT FROM AH-2 IN MECHANICAL ROOM.
 - EXISTING 600x300 RETURN AIR DUCT UP TO AH-2 IN MECHANICAL ROOM.
 - EXISTING 350x450 SUPPLY AIR DUCT FROM AH-3 IN MECHANICAL ROOM.
 - EXISTING 1000x300 RETURN AIR DUCT UP TO AH-3 IN MECHANICAL ROOM.
 - TO RADIATION.
 - EXISTING THERMOSTAT TO BE RELOCATED.
 - CONNECT NEW 200# SUPPLY AIR DUCT TO EXISTING 600x300 SUPPLY AIR DUCT.
 - RELOCATE EXISTING MOTORIZED OUTSIDE AIR DAMPER TO THIS LOCATION.
 - CONNECT NEW 600x300 RETURN AIR DUCT TO EXISTING OUTSIDE AIR PLENUM ON TOP AS SHOWN. C/W MIXING BAFFLE.
 - CONNECT NEW 600x300 EXHAUST AIR DUCT TO EXISTING EXHAUST AIR PLENUM AS SHOWN.
 - 600x300 RETURN AIR T C/W BELLMOUTH FITTING, 25 ACOUSTIC INSULATION & EXPANDED METAL SCREEN IN CEILING SPACE.
 - 600x300 MOTORIZED EXHAUST AIR DAMPER.
 - 600x300 MOTORIZED RETURN AIR DAMPER.
 - EXISTING CEILING PROPELLER FAN TO REMAIN.
 - 200# SUPPLY AIR DUCT DOWN TO LOWER LEVEL.
 - CAP & REMOVE EXISTING 300# SUPPLY AIR DUCT.
 - REMOVE EXISTING 450x250 EXHAUST DUCT & ROOF MOUNTED FAN. PATCH EXISTING ROOF OPENING TO MATCH EXISTING ROOF.
 - RELOCATED EXISTING EXHAUST FAN AH3EE2 MOUNTED FROM EXISTING ROOF STRUCTURE AS HIGH AS POSSIBLE. C/W FLEXIBLE CONNECTIONS & SPRING ISOLATORS.
 - NEW DUCT COOLING COIL CC-5.
 - TO NEW RADIATION VALVES. REFER TO DRAWING H-N2-0501/1-404.
 - EXISTING THERMOSTAT TO BE RELOCATED. REFER TO DRAWING H-N2-0501/1-411.
 - NEW 200# EXHAUST AIR DUCT UP TO ROOF MOUNTED EXHAUST FAN AH1EE3 C/W BACKDRAFT DAMPER.

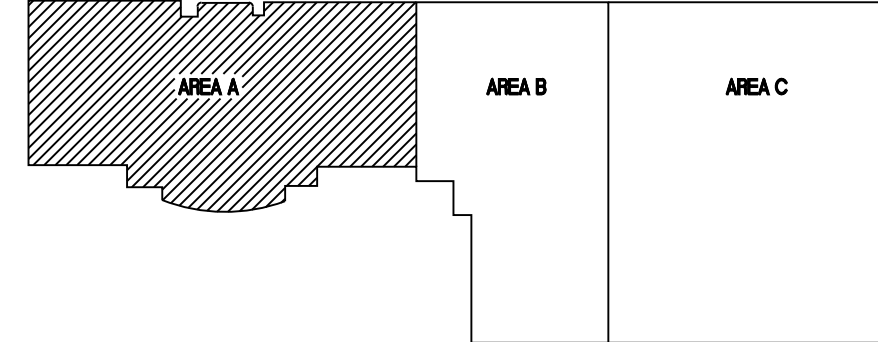

NO.	DATE	REVISION	REVISION	APPR.
2	03/13/97	RECORD DRAWING		
1	02/21/96	ISSUED FOR TENDER		



SCALE - ÉCHELLE
1:100
PROJECT - PROJET
CFB EDMONTON, ALBERTA

RELOCATION OF 1 FIELD AMBULANCE

TRADE - MÉTIER
ELECTRICAL
DATE
1996-02

SUBJECT - SUJET
FLOOR PLAN AREA 'A'
HIGH LEVEL + UPPER FLOOR PLAN
VENTILATION

PRODUCTION	CONCURRENCE - ASSENTIMENT
DESIGNED ÉTUDE GY	DES OFF AGENT CONCEPT
DRAWN DESSINE SKH	SECT HD CHEF SECT
CHECKED VÉRIFIÉ GCM/GY	DES MGR GEST CONCEPT
COORDINATION	REVIEWED - REVU