

project title
titre du projet
WARKWORTH ONTARIO
CORRECTIONAL SERVICES CANADA
WARKWORTH INSTITUTION
COUNTY RD. #29, CAMPBELLFORD

titre du dessin
SITE SERVICES
SANITARY

approved by
approve par

S. PATEL. P.ENG

projet, date
date du projet 2004-11-2

305913

460-05-1/2

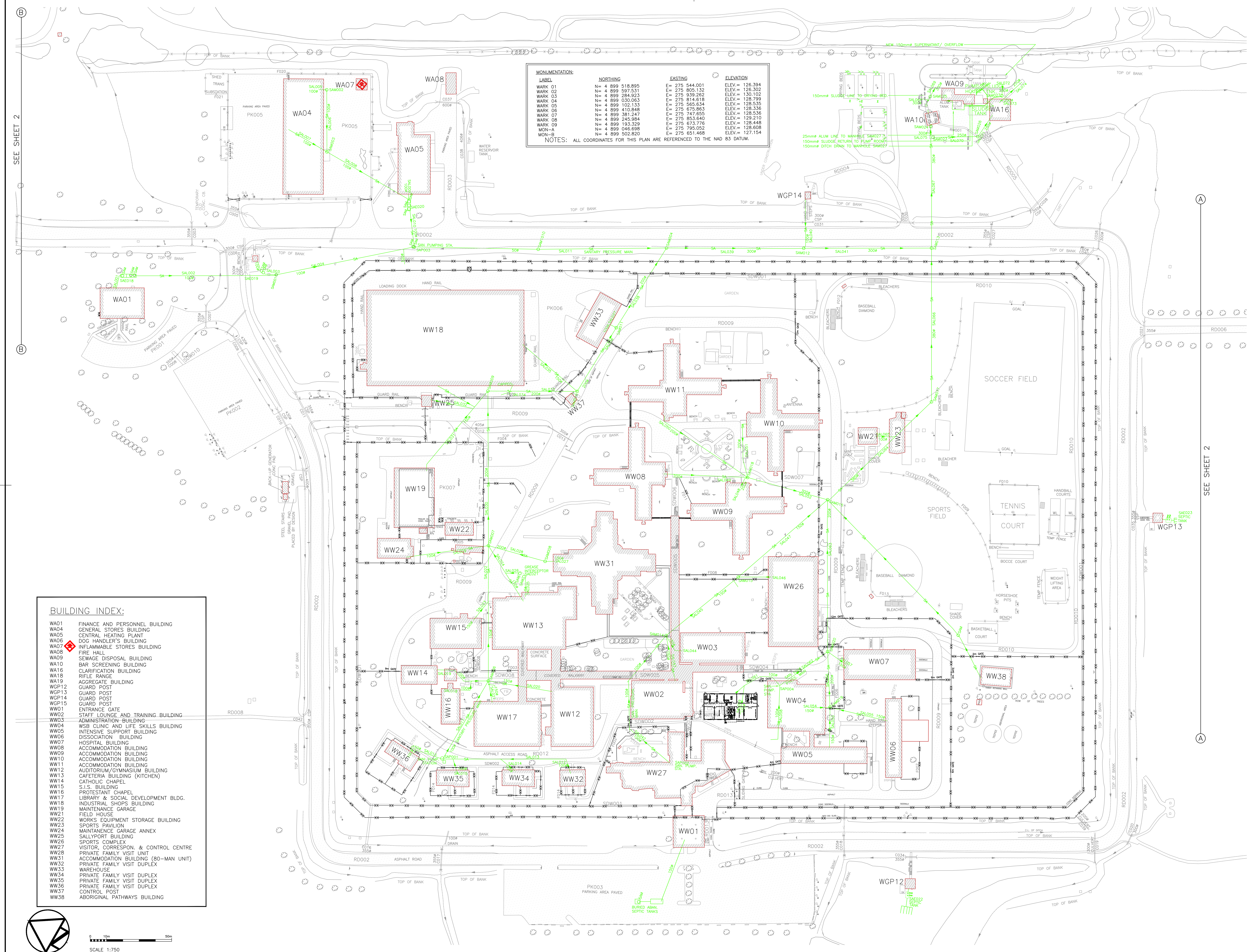

WA01	FINANCE AND PERSONNEL BUILDING
WA02	GENERAL STORES BUILDING
WA05	CENTRAL HEATING PLANT
WA06	DOC HENDERSON'S BUILDING
WA07	INFLAMMABLE STORES BUILDING
WA08	FIRE HALL
WA09	SEWAGE DISPOSAL BUILDING
WA10	BAR SCREENING BUILDING
WA16	CLARIFICATION BUILDING
WA18	RIFLE RANGE
WA19	AGGREGATE BUILDING
WG12	GUARD POST
WG13	GUARD POST
WG14	GUARD POST
WG15	GUARD POST
WO01	ENTRANCE CATE
WO02	STAFF LOUNGE AND TRAINING BUILDING
WO03	ADMINISTRATION-BUILDING
WO04	TRAINING AND LIFE SKILLS BUILDING
WO05	INTENSIVE SUPPORT BUILDING
WO06	DISSOCIATION BUILDING
WO07	HOSPITAL BUILDING
WO08	ACCOMMODATION BUILDING
WO09	ACCOMMODATION BUILDING
WO10	ACCOMMODATION BUILDING
WO11	ACCOMMODATION BUILDING
WO12	AUDITORIUM/GYMNASIUM BUILDING
WO13	CATERIA BUILDING (KITCHEN)
WO14	CATHOLIC CHAPEL
WO15	S.I.S. BUILDING
WO16	PROTESTANT CHAPEL
WO17	SOCIAL AND DEVELOPMENT BLDG.
WO18	INDUSTRIAL SHOPS BUILDING
WO19	MAINTENANCE GARAGE
WO20	FIELD HOUSE
WO22	WORKS EQUIPMENT STORAGE BUILDING
WO23	SPORTS PAVILION
WO24	MAINTENANCE GARAGE ANNEX
WO25	SALTATORY BUILDING
WO26	SPORTS COMPLEX
WO27	VISITOR, CORRESPOND. & CONTROL CENTRE
WO28	RECEPTION BUILDING
WO31	ACCOMMODATION BUILDING (80-MAN UNIT)
WO32	PRIVATE FAMILY VISIT DUPLEX
WO33	WAREHOUSE
WO34	PRIVATE FAMILY VISIT DUPLEX
WO35	PRIVATE FAMILY VISIT DUPLEX
WO36	PRIVATE FAMILY VISIT DUPLEX
WO37	CONTROL POST
WO38	ABORIGINAL PATHWAYS BUILDING

SCALE 1:750

PLOT SCALE: 1:1

CAD FILE: EDR

CAD FILE: EDRM DOC. #74479

GSC-A0