

**BUREAU FERMÉ STANDARD 10m² (AU PÉRIMÈTRE)
NOMBRE : 83 (44 AVEC ORIENTATION À GAUCHE ET
39 AVEC ORIENTATION À DROITE)**

BUREAUX 1208, 1212, 1209, 1213, 1219, 1233,
1237,
1232, 1234, 1240, 1242, 1243, 1254, 1256, 1262, 1263,
1267, 1271, 1272, 1284, 1290, 1298

BUREAUX 1206, 1210, 1214, 1216, 1207, 1211, 1224,
1231,
1235, 1241, 1236, 1252, 1260, 1261, 1265, 1269, 1288,
1296

BUREAUX 1401, 1403, 1410, 1412, 1416, 1424,
1426,
1438, 1446, 1448, 1454, 1460, 1472, 1474, 1478, 1481,
1482, 1484, 1485, 1489, 1490, 1492

BUREAUX 1407, 1408, 1409, 1413, 1414, 1415, 1422,
1430,
1434, 1440, 1450, 1452, 1464, 1468, 1470, 1480, 1479,
1483, 1486, 1488, 1494

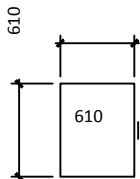
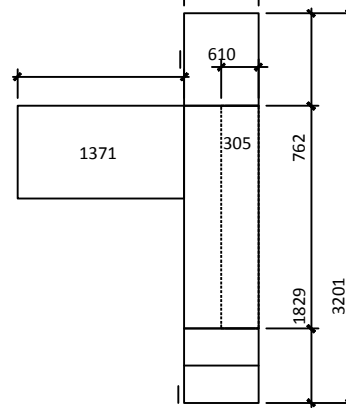
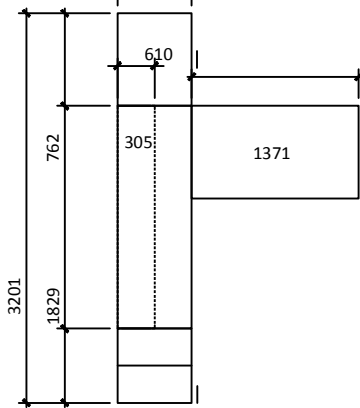

24"(610mm) X 30"(762mm) X ±72"H(1829mm)
2-HI ARMOIRE DE RANGEMENT AVEC TIROIRS À CLASSEURS

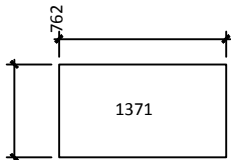

30"(762mm) X 54"(1371mm) SURFACE DE TRAVAIL (BUREAU)

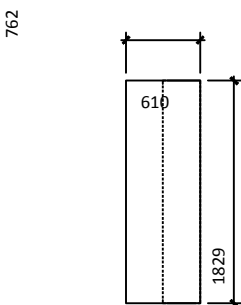

24"(610mm) X 72"(1829mm) SURFACE DE
TRAVAIL MUNIE D'UN COMPARTIMENT DE
RANGEMENT SUPÉRIEUR

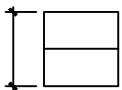

24"(610mm) X 24"(610mm) X ±72"H(1829mm)
PENDERIE COMBINÉE

**BUREAU FERMÉ ATYPIQUE 10m² (INTÉRIEUR)
NOMBRE : 4 (1 AVEC ORIENTATION À GAUCHE;
3 AVEC ORIENTATION À DROITE)**

BUREAU 1499

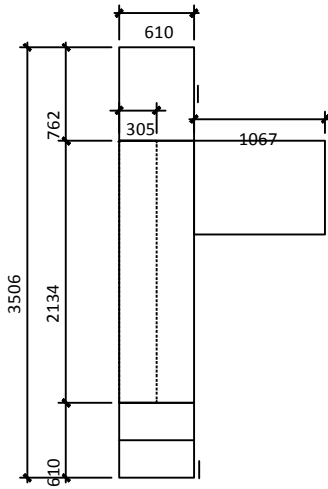

BUREAUX 1455, 1495, 1497

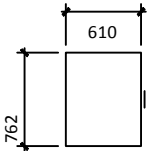
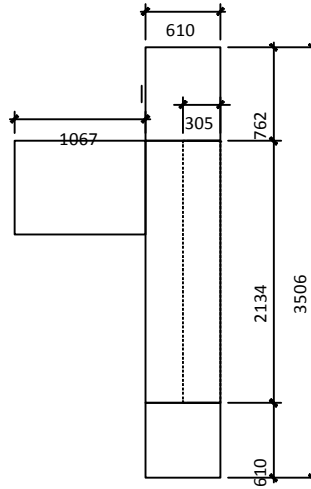

24"(610mm) X 30"(762mm) X ±72"H(1829mm)
2-HI ARMOIRE DE RANGEMENT MUNIE DE CLASSEURS (AVEC VERROU)

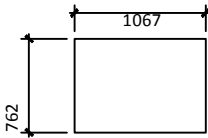

30"(762mm) X 42"(1067mm)
SURFACE DE TRAVAIL
(BUREAU)

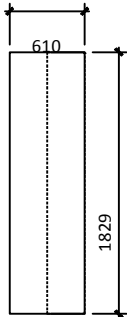

24"(610mm) X 72"(1829mm)
SURFACE DE TRAVAIL MUNIE
D'UN COMPARTIMENT DE
RANGEMENT SUPÉRIEUR

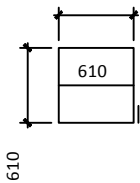

24"(610mm) X 24"(610mm) X ±72"H(1829mm)
PENDERIE COMBINÉE

ANNEXE C – PLANS TYPIQUES – page 3 de 7

BUREAU FERMÉ ATYPIQUE 10m² (INTÉRIEUR)

NOMBRE : 18 (7 AVEC ORIENTATION À GAUCHE; 11 AVEC ORIENTATION À DROITE)

BUREAUX 1225, 1229, 1247, 1257, 1295
1421, 1445

BUREAUX 1245, 1255, 1275, 1287, 1293, 12100
1419, 1439, 1447, 1449, 14100

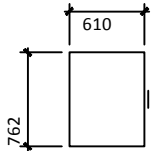
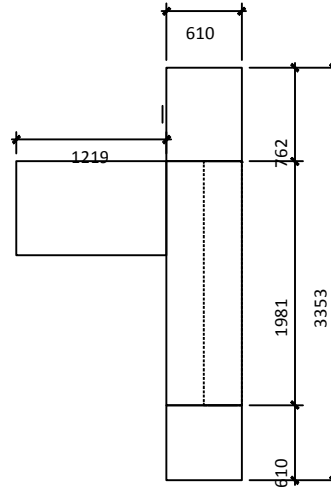
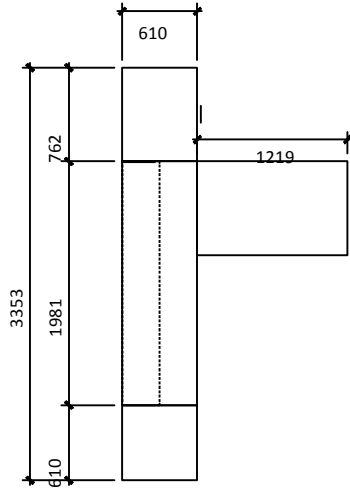

24"(610mm) X 30"(762mm) X ±72"H(1829mm)
2-HI ARMOIRE DE RANGEMENT MUNIE DE CLASSEURS (AVEC VERROU)

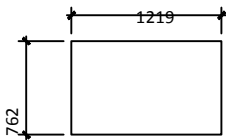

30"(762mm) X 48"(1219mm)
SURFACE DE TRAVAIL
(BUREAU)

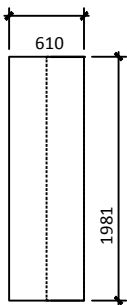

24"(610mm) X 78"(1981mm) SURFACE DE TRAVAIL MUNIE D'UN COMPARTIMENT DE RANGEMENT SUPÉRIEUR

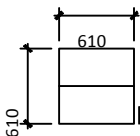

24"(610mm) X 24"(610mm) X ±72"H(1829mm)
PENDERIE COMBINÉE

ANNEXE C – PLANS TYPIQUES – page 4 de 7

BUREAU FERMÉ ATYPIQUE 10m² (INTÉRIEUR)
NOMBRE : 8 (4 AVEC ORIENTATION À GAUCHE;
4 AVEC ORIENTATION À DROITE)

BUREAUX 1431, 1435, 1461, 1465

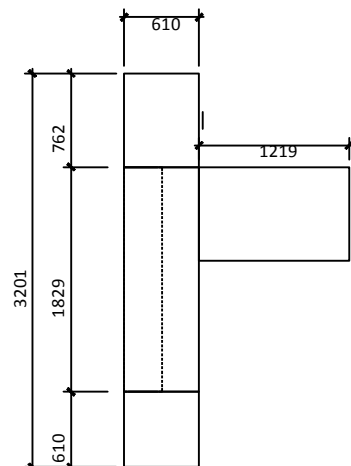

BUREAUX 1429, 1433, 1457, 1463

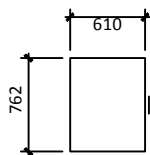
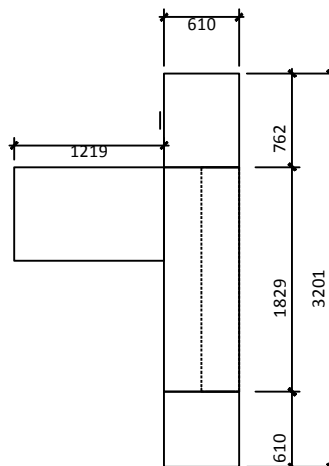

24"(610mm) X 30"(762mm) X 72"H(1829mm)
2-HI ARMOIRE DE RANGEMENT MUNIE DE
CLASSEURS (AVEC VERROU)

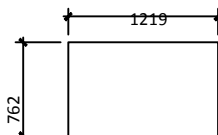

30"(762mm) X 48"(1219mm)
SURFACE DE TRAVAIL
(BUREAU)

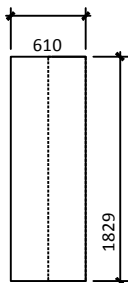

24"(610mm) X 72"(1829mm)
SURFACE DE TRAVAIL MUNIE
D'UN COMPARTIMENT DE
RANGEMENT SUPÉRIEUR

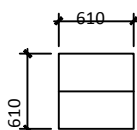

24"(610mm) X 24"(610mm) X 72"H(1829mm)
PENDERIE COMBINÉE

ANNEXE C – PLANS TYPIQUES – page 5 de 7

**BUREAU ATYPIQUE DE LA DIRECTION (14m²)
NOMBRE : 1 (ORIENTATION À GAUCHE)**

**BUREAU TYPIQUE DE LA DIRECTION (14m²)
NOMBRE : 3 (1 AVEC ORIENTATION À GAUCHE; 2
AVEC ORIENTATION À DROITE)**

BUREAU 1404

BUREAU 1228

BUREAUX 1428, 1274

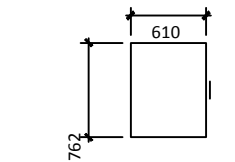
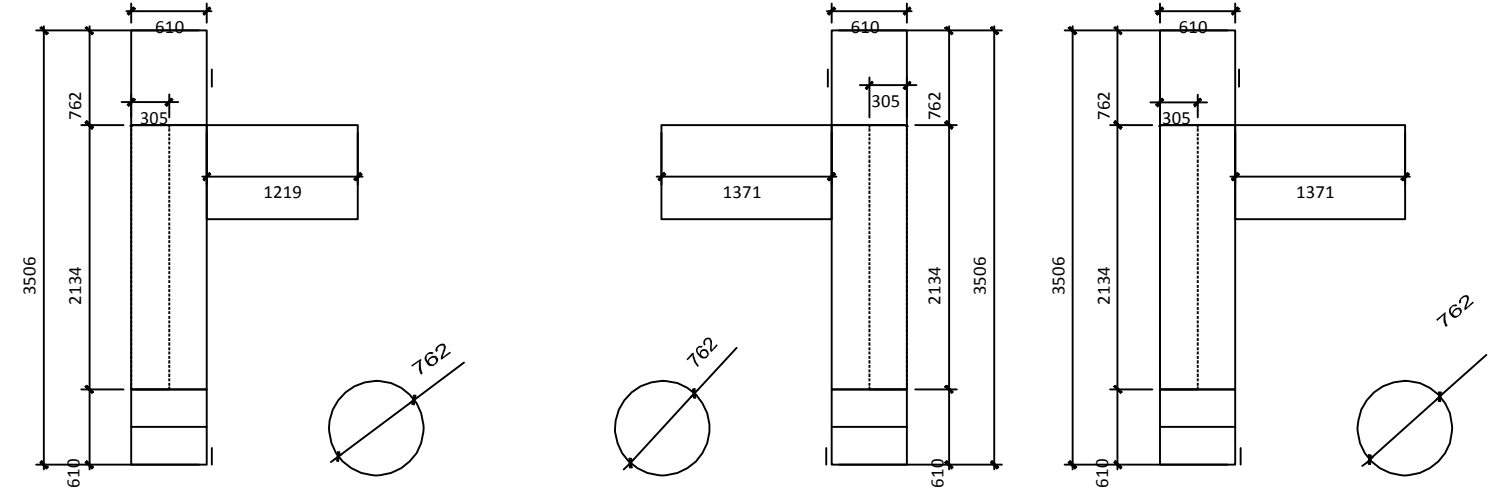

24"(610mm) X 30"(762mm) X
±72"(1829mm)H
2-HI ARMOIRE DE
RANGEMENT MUNIE DE
CLASSEURS

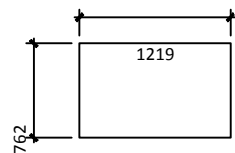

30"(762mm) X
48"(1219mm)
SURFACE DE
TRAVAIL (BUREAU)

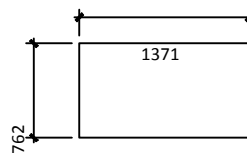

30"(762mm) X
54"(1371mm) SURFACE
DE TRAVAIL (BUREAU)

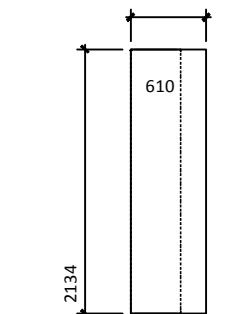

24"(610mm) X 84"(2134mm)
SURFACE DE TRAVAIL
MUNIE D'UN
COMPARTIMENT DE
RANGEMENT SUPÉRIEUR

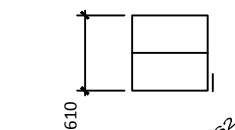

24"(610mm) X 24"(610mm)
PENDERIE COMBINÉE

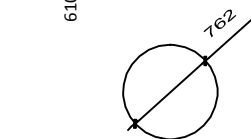

30"(762mm) TABLE DE
RÉUNION CIRCULAIRE

**BUREAU DU/DE LA
DIRECTEUR/TRICE-ADJOINT/E
(28m²) NOMBRE : 2**

BUREAUX 1215B, 1227B

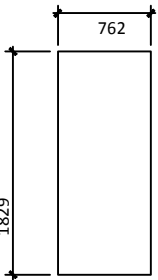
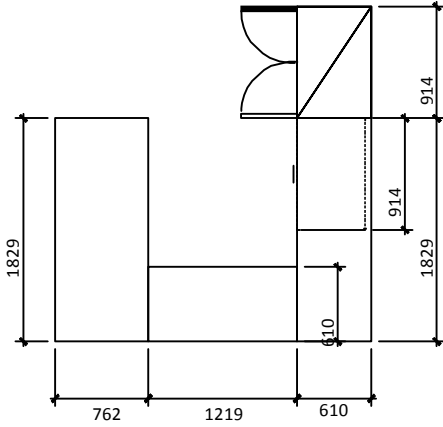
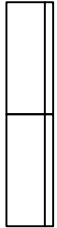
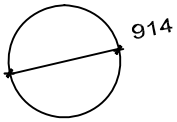

30"(762mm) X 72"(1829mm)
SURFACE DE TRAVAIL (BUREAU)

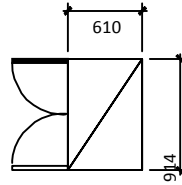

24"(610mm) X 36"(914mm)
ESPACE DE RANGEMENT

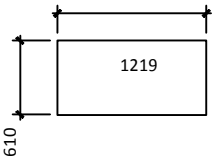

24"(610mm) X 48"(1219mm) SURFACE DE
TRAVAIL (PONT/RETOUR)

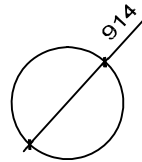

36"(914mm) DIA. TABLE
CIRCULAIRE

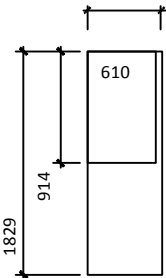

24"(610mm) X 72"(1829mm) BAHUT ET
36"(914mm) RANGEMENT POUR FICHIERS



15"D(381mm) X 36"W(914mm) X
±72"H(1829mm) BIBLIOTHÈQUE

LISTE DU MOBILIER AUTOSTABLE POUR LES RÉUNION DE GROUPES

TABLES ET BAHUTS

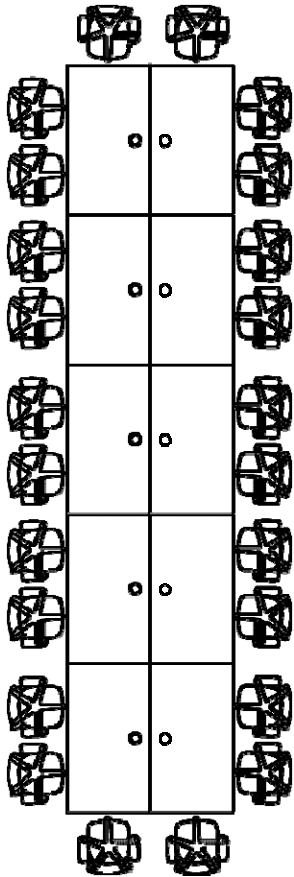

CONFIGURATION
POUR LES
RÉUNIONS

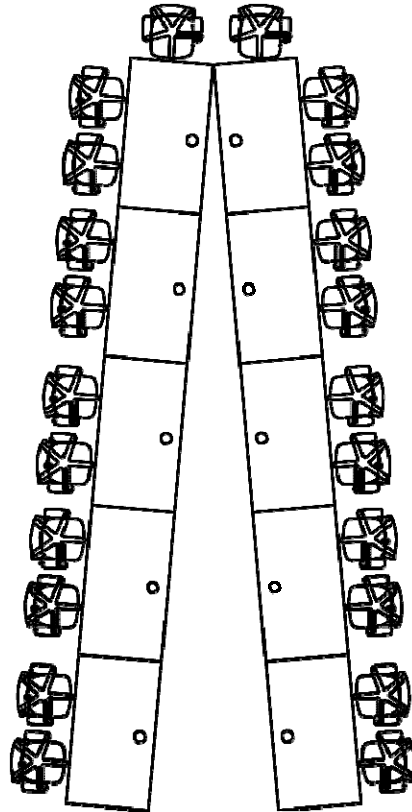

CONFIGURATION
POUR LES
VIDÉOCONFÉRENCES

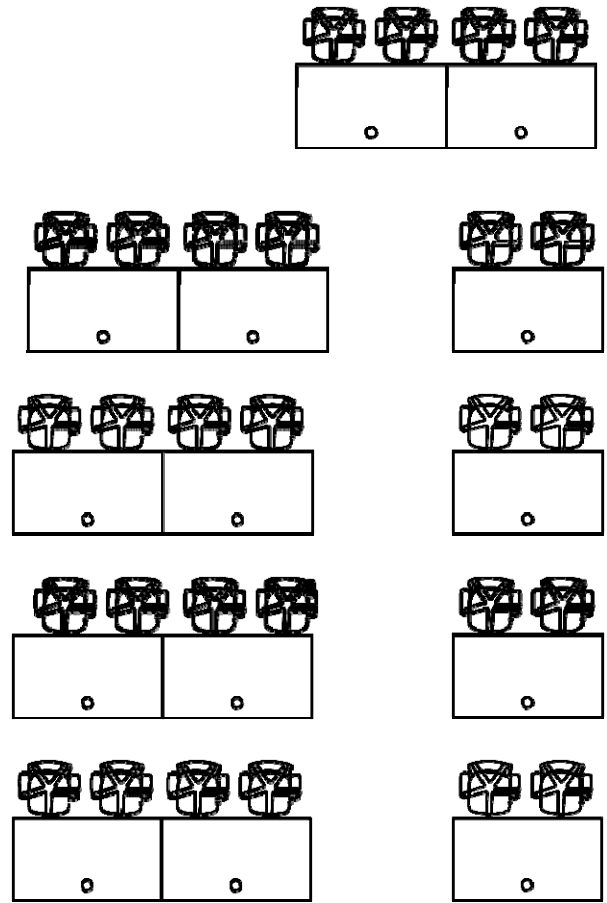

CONFIGURATION
POUR LES
FORMATIONS

SALLE DE
CONFÉRENCE 1205

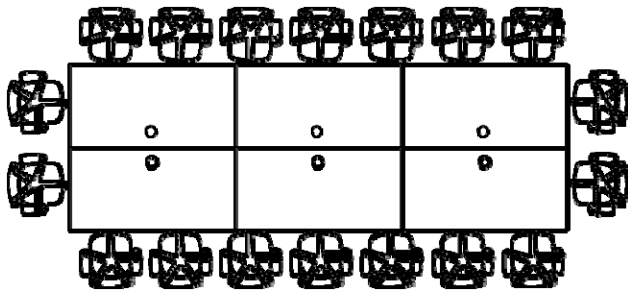

SALLE DE
CONFÉRENCE 1444