

LEGEND:

- EXISTING:
- WATER LINE
 - DITCH &
 - FENCE
 - SAINTARY LINE
 - EDGE OF ASPHALT
 - BURIED STORM
 - COMAL LINES
 - ELECTRICAL LINES
 - LIGHTING POWER
 - LIGHT STANDARD
 - HYDRANT
 - GATE VALVE
 - MANHOLE
 - THURST BLOCK
 - SOILS STUDY
 - EXISTING WATERLINE
 - GEOTECHNICAL BOREHOLES

4	ISSUED FOR TENDER	2010/12
3	ISSUED FOR 90% REVIEW	2010/11/23
2	ISSUED FOR 60% REVIEW	2010/11/15
1	ISSUED FOR 30% REVIEW	2010/11/08

A	As noted on plan	A
C	As noted on plan	B/C

PROJECT:
SPRINGHILL INSTITUTION
PARKING EXPANSION

SPRINGHILL, NOVA SCOTIA

PID'S ROAD LAYOUT
PLAN

designed by: P. King - K. Conboy	drawn by: T. Woodard	checked by: P. King	approved by: P. King
date: Nov. 2011	date: Nov. 2011	date: Nov. 2011	date: Nov. 2011
scale: 1:500	scale: 1:500	scale: 1:500	scale: 1:500
project name: Springhill Institution Parking Expansion	project no: R043943.002	drawing no: L5	revision no: 1

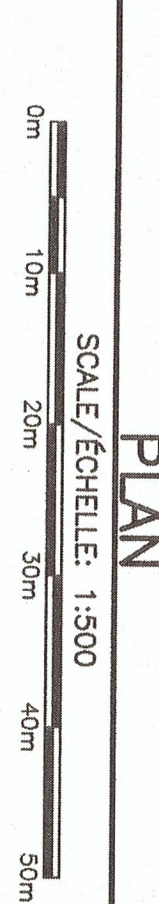
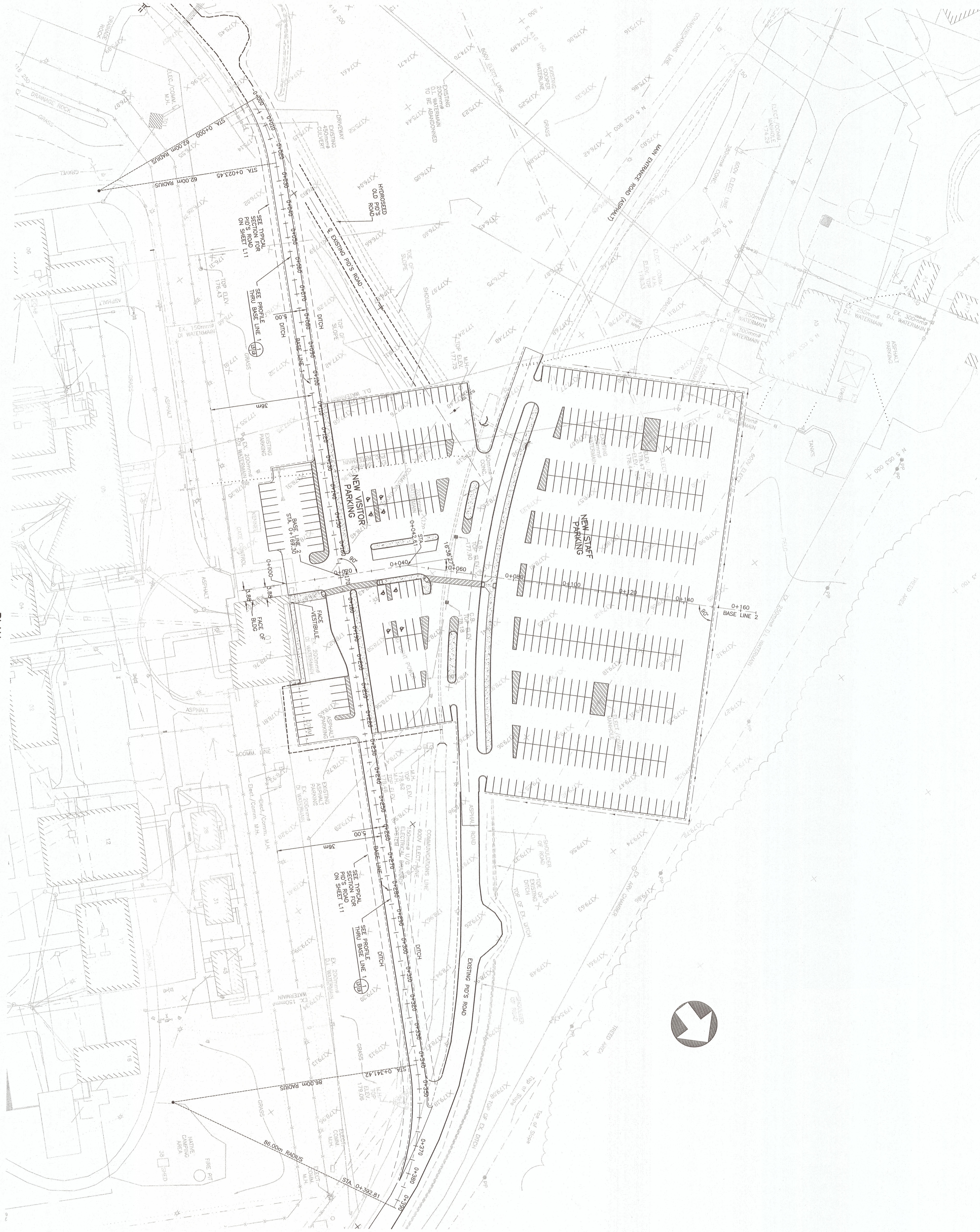

PLAN