

SMALL CRAFT HARBOURS

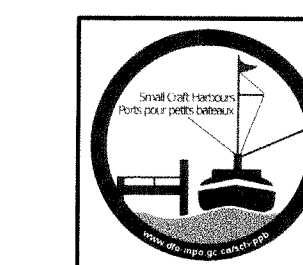

- NOTES:
1. ALL ELEVATIONS ARE IN METRES UNLESS OTHERWISE NOTED.
2. ALL DIMENSIONS ARE IN MILLIMETRES UNLESS OTHERWISE NOTED.

PROVINCE OF NEWFOUNDLAND PERMIT HOLDER
This Permit Allows
APN ENGINEERING INC.
To practice Professional Engineering in Newfoundland and Labrador.
Permit No. as issued by APEGL: F0882 which is valid for the year 2013.

STAMP
REGISTERED PROFESSIONAL ENGINEER
NEIL C. HUNT
NEWFOUNDLAND & LABRADOR

Table with 2 columns: Revision/Issued For, Date. Row 1: B ISSUED FOR TENDER 13/04/16. Row 2: A ISSUED FOR 33% REVIEW 13/04/12.

CONCRETE LAUNCHWAY REPAIRS
SIBLEY'S COVE, NL

DEMOLITION PLAN

Table with 2 columns: Field, Value. Includes fields for designed (N.H.), date (APRIL 11, 2013), drawn (P.H.), date (APRIL 11, 2013), approved, Tender (DFO Project Manager), project number (F6140-130001), drawing no. (C2).

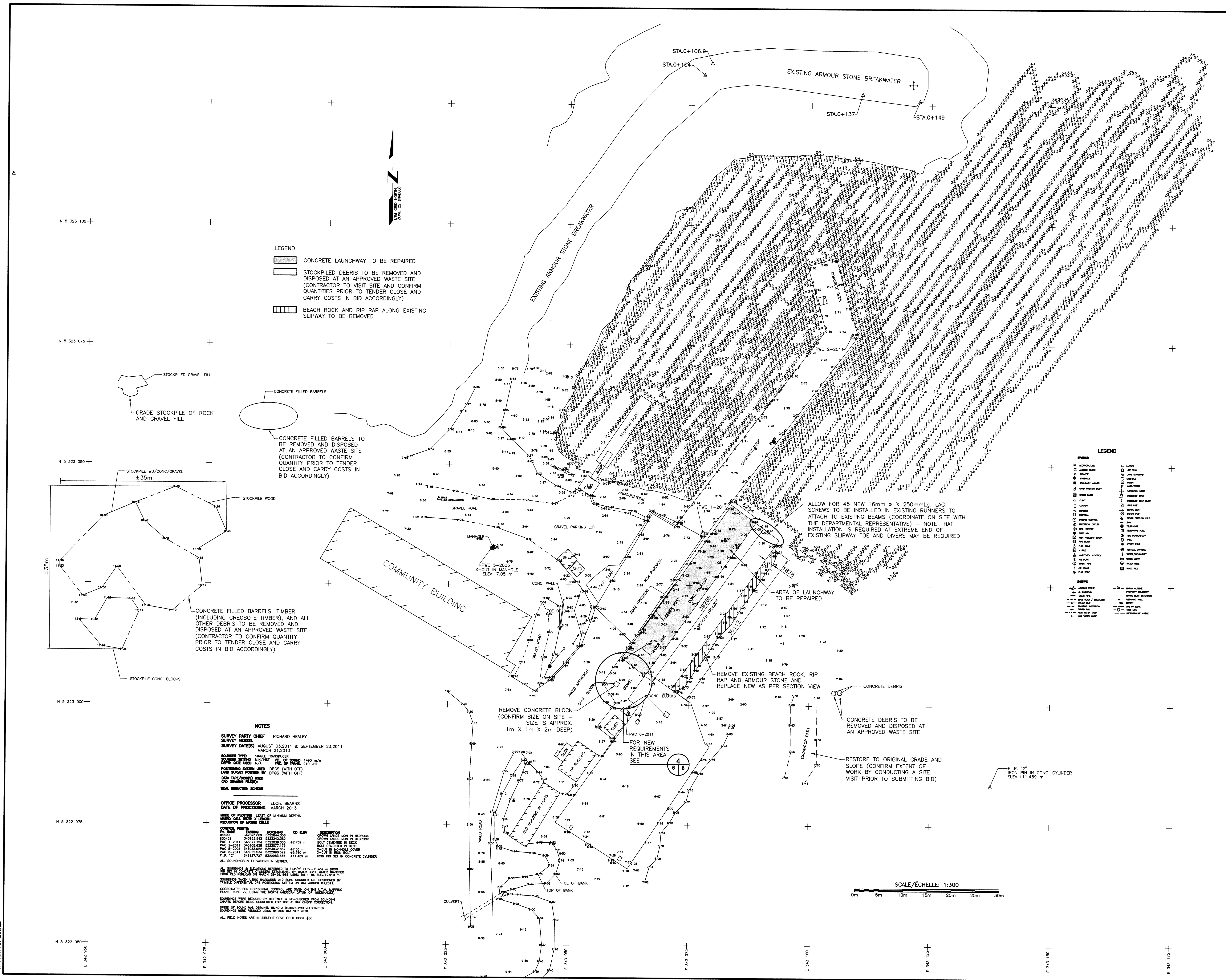

- LEGEND:
Concrete launchway to be repaired
Stockpiled debris to be removed and disposed at an approved waste site
Beach rock and rip rap along existing slipway to be removed

- LEGEND
Materials and symbols for launchway, concrete, debris, and other site features.

NOTES
SURVEY PARTY CHIEF RICHARD HEALEY
SURVEY VESSEL
SURVEY DATES AUGUST 03, 2011 & SEPTEMBER 23, 2011
MARSH 21, 2011.3
SOUNDER TYPE SINGLE TRANSDUCER
SOUNDING METHOD HYDROGRAPHIC

