

# Champion<sup>®</sup>

The Dishwashing Machine Specialists

Project \_\_\_\_\_

Item No. \_\_\_\_\_

Quantity \_\_\_\_\_

PP-3 TASKMASTER

## STANDARD FEATURES

- Type 304 polished stainless steel construction
- 14 gauge stainless tanks and drain boards
- 10" high x 3-1/4" deep back splash
- Twist handle drains
- Taskmaster Control System
  - Single Cycle Microprocessor Control
  - Integrated low water detection
  - Plug and play service system
- Stainless steel legs and cross rails
- Stainless steel adjustable bullet feet
- Dual stainless steel pump and impeller
- Self-draining pump systems
- Stainless steel front skirting
- Multi-sided discharge
- Removable discharge plates
- Centrifugal pump with 4" diameter intake and 3" diameter outlet
- Two - 1-1/2 HP fully enclosed (TEFC) wash pump motors with permanently sealed bearings
- Inherent motor overload protection, manual reset
- Low water protection for wash pump motor
- 2,500 watt wash tank heater
- 1 year labor, 3 years parts on pumps and control panel

**PP-3**  
**Taskmaster**  
Power Wash Sink System



**NEW!**



## SPECIFIER STATEMENT

Specified unit will be Champion model PP-3 Taskmaster Power Wash Sink System.

Features (2) 1-1/2 TEFC Hp wash pump motors, taskmaster control system, dual stainless steel pump and impeller and self draining pump systems.

Champion Industries, Inc.  
P. O. Box 4149, Winston-Salem, NC 27115  
Tel: 336/661-1556 Fax: 336/661-1979  
2674 N. Service Road,  
Jordan Station, Ontario, Canada L0R 1S0  
Tel: 905/562-4195 Fax: 905/562-4618

## OPTIONS & ACCESSORIES

- 480/60/3 electrical
- Utensil basket
- Removable wash tank cover
- Sheet pan rack
- 5,000 watt wash tank heater
- Sanitize tank heat
- Pot and pan rack
- Table mounted over shelf
- Stainless steel under shelving
- 1/2" pre-rinse faucet
- 1/2" fill faucet
- Multi-Taskmaster
  - Variable speed
  - Temperature control
  - Programmable wash cycle
  - Integrated soap dispensing

- Auto Fill
- Auto Drain

Direction from soiled to clean end (select one)

- Left to right
- Right to left



(Consult the factory for custom lengths & widths)

Dimensions shown in inches

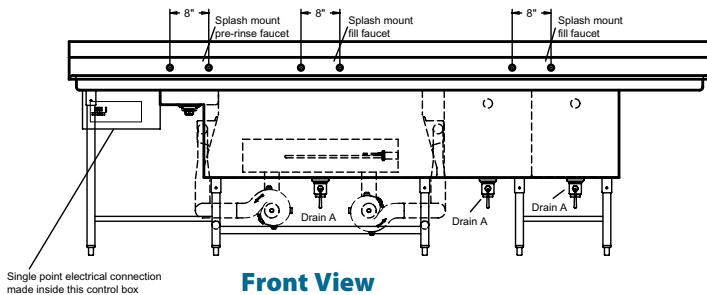
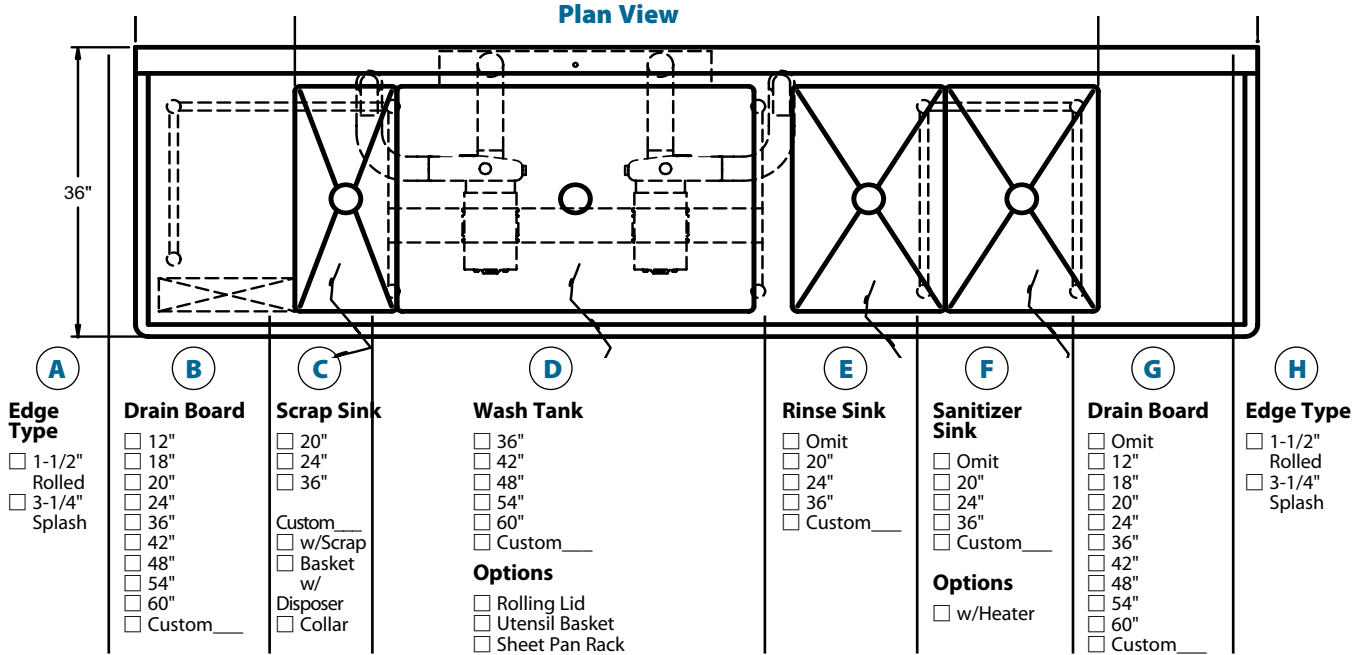

**Front View**

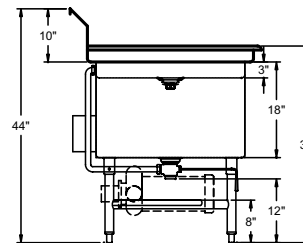

**Side View**

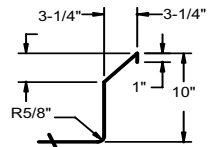

**Splash Detail**  
Scale: 3/4" = 1"

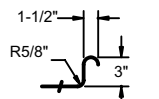

**Rolled Edge Detail**  
Scale: 3/4" = 1"

**Detail Views**

**Warning:** Plumbing and electrical connection should be made by qualified personnel who will observe all the applicable plumbing, sanitation, and safety codes and the National Electrical Code.

**PP-3 with 2.5 kW Electric Heat**

Elec. Specs.	Rated Amps	Minimum Supply Ckt. Conductor Ampacity	Maximum Overcurrent Protective Device
208-240/60/3	25	30	30
480/60/3	12	20	20

**PP-3 without Electric Heat**

Elec. Specs.	Rated Amps	Minimum Supply Ckt. Conductor Ampacity	Maximum Overcurrent Protective Device
208-240/60/3	13	15	15
480/60/3	7	15	15

<b>Utilities</b>	
<b>1</b>	<b>Electrical</b> (see box)
<b>2</b>	<b>Hot Water</b> 1/2" NPT connection for mixing faucet. 1/2" NPT connection for pre-rinse sprayer.
<b>3</b>	<b>Cold Water</b> 1/2" NPT connection for mixing faucet. 1/2" NPT connection for pre-rinse sprayer.
<b>4</b>	<b>Drain</b> A. Sink drains, 2" NPT B. Scraper drain, 1-1/2" NPT (25-5/8" AFF)

**SPECIFICATIONS**

**Motor** 2 x 1-1/2 Hp

**Power Requirements**  
208-240/60/1; 208-240/60/3

**Direction of Operation** R-L or L-R

Due to an ongoing value analysis program at Champion, specifications contained in this catalog are subject to change without notice.

Champion Industries, Inc., P. O. Box 4149, Winston-Salem, NC 27115 • 336/661-1556 • Fax: 336/661-1979 • www.championindustries.com  
 Moyer Diebel, 2674 North Service Rd., Jordan Station, Ontario, Canada L0R 1S0 • Tel: 905/562-4195 • Fax: 905/562-4618 • www.moyerdiebellimited.com