

Department of Public Works / Ministère des Travaux publics

Ontario Region / Région d'Ontario

REID, CROWTHER and Partners Limited

Engineers
Toronto, Ontario.

WALL AND YAMAMOTO Architects
Burlington Ontario

A. detail no. / détail no.
B. location / sur dessin
C. dwg. no. / dessin no.

date / AS BUILT

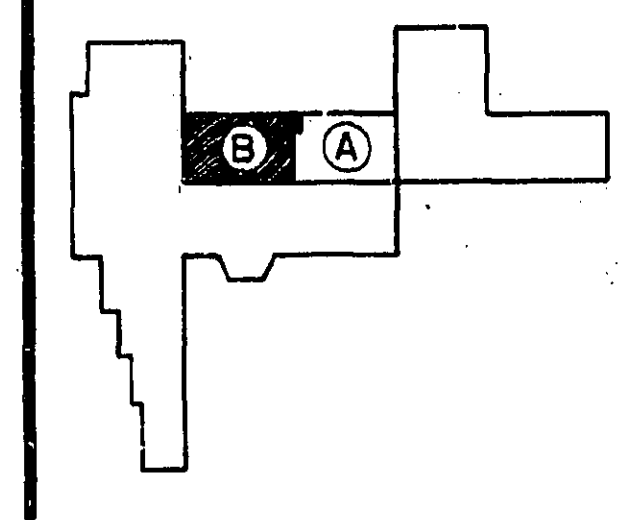

Key Plan
BURLINGTON ONTARIO.
CANADA CENTRE
FOR INLAND WATERS
SERVICE BUILDINGS.

RESEARCH & DEVELOPMENT
PART "D"
SECOND FLOOR PLAN
PLUMBING & DRAINAGE

DESIGNED BY: I.R.E. JUNE 1969
DRAWN BY: B.M. JUNE 1969
CHECKED BY: R.C.P.L. JUNE 1969
APPROVED BY: JUNE 1969
JOB NUMBER: R-88121
DWG. NO.: P15 OF 19

NOTES:
FOR PLUMBING LEGEND & FIXTURE IDENTIFICATION
SEE DWG. R-88121