

NATIONAL ENERGY BOARD
CALGARY, ALBERTA
PROPOSED FURNITURE 3rd FLOOR (REV 6.)

2013-09-09

12-022

SAHURI
+ partners
architecture

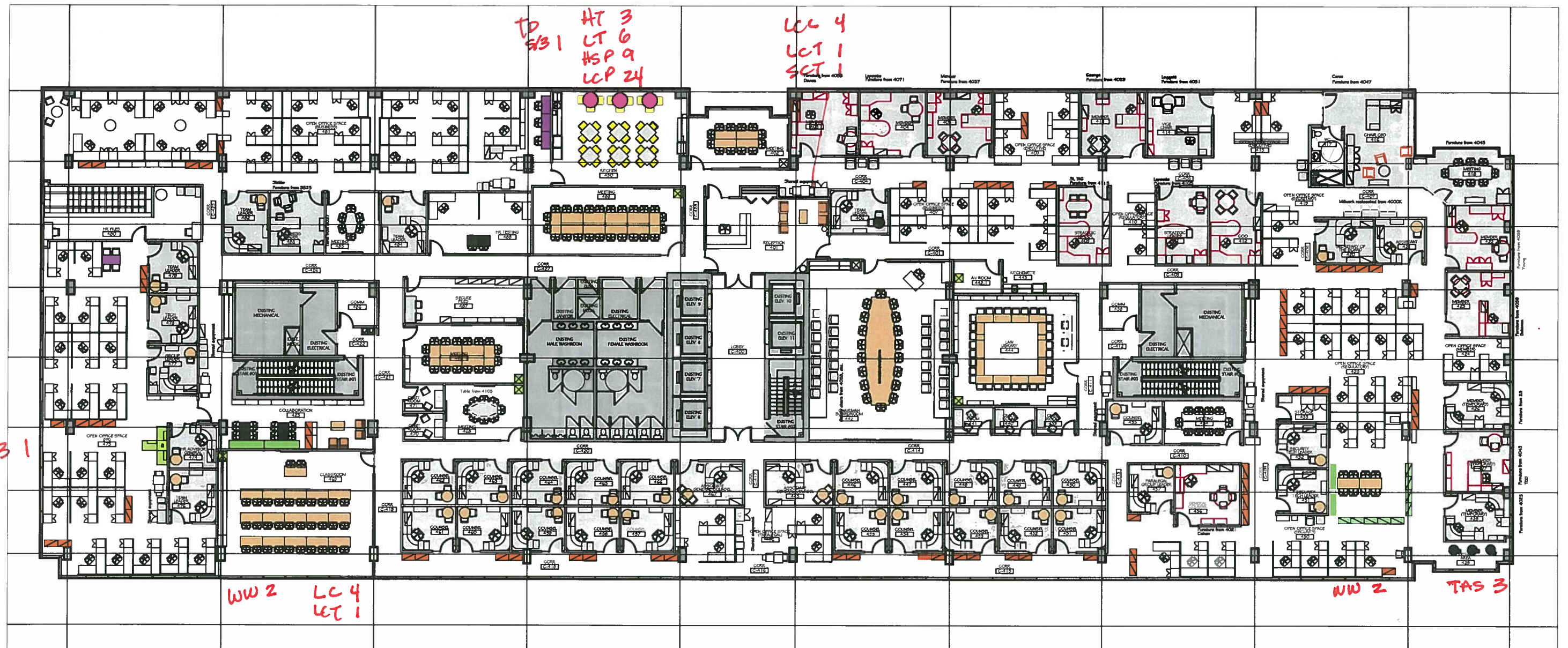

- | | | |
|---|--|---|
| <p>Seating</p> <p>Tablet Arm</p> <p>Lounge Seating</p> <p>Library/Collaboration (Upholstered)</p> <p>Kitchenette Chair(Polyurethane)</p> <p>Modular Seating</p> <p>Table</p> <p>Coffee Table</p> <p>Low Table (915x915)</p> <p>High Table (1067d)</p> | <p>Large Small</p> <p>Chair Love seat</p> <p>High Low</p> <p>High Low</p> <p>Large Small</p> | <p>Miscellaneous</p> <p>Work Wall</p> <p>Touchdown (610x1220)</p> <p>N.I.C.</p> <p>AV Cabinet</p> <p>3 dr. Lateral with work top</p> <p>File Enclosure</p> |
|---|--|---|

NATIONAL ENERGY BOARD
CALGARY, ALBERTA
PROPOSED FURNITURE 4th Floor Rev. 4

2013-09-09

12-022

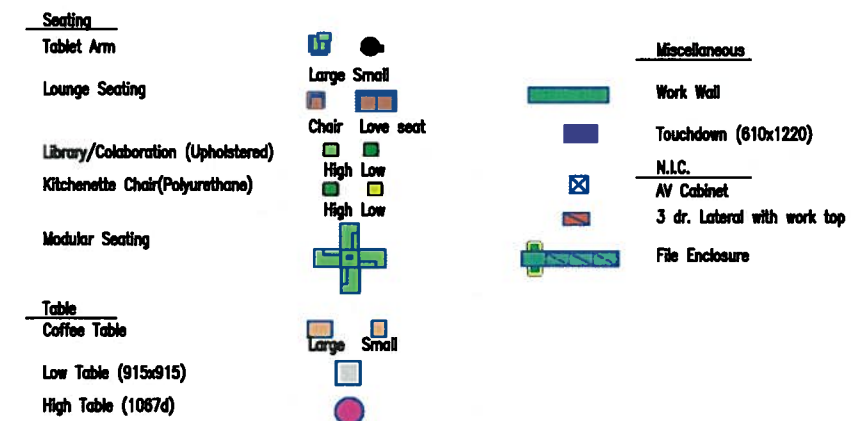
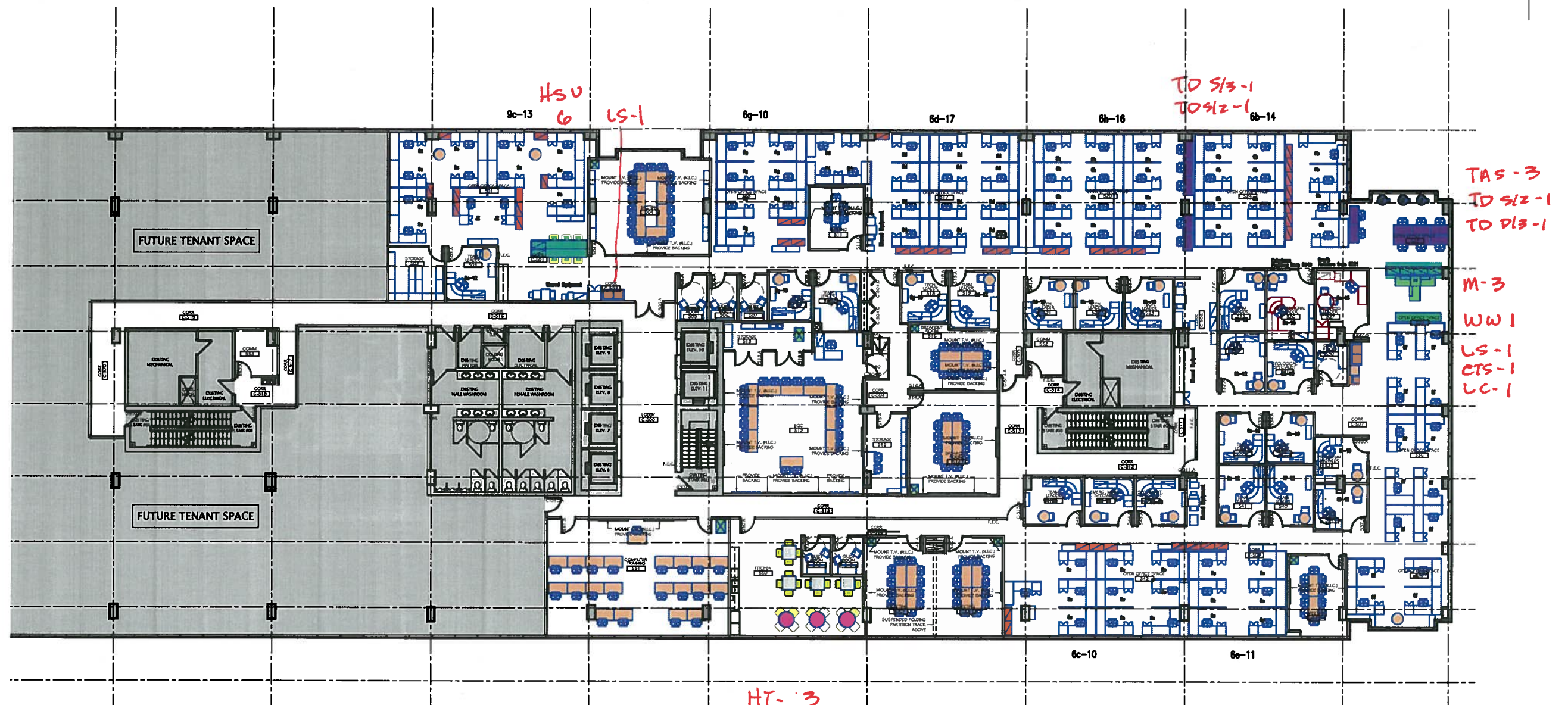

NATIONAL ENERGY BOARD
 CALGARY, ALBERTA
 PROPOSED FURNITURE PLAN, 5th Floor, Rev. 4

2013-09-09

12-022

SAHURI
 + partners
 architecture inc