

The following Addendum forms part of the Contract Documents for the Grand Valley Institute for Women – Principal Entrance Building (Project number R.047995.001). The following changes, additions or deletions shall be made to the following documents as indicated and all other Contract Documents shall remain the same.

This Addendum Number 02 contains 2 written pages, 1 Specification Section (10 74 49) and 3 attached drawings (SKA-004, SKA-005, SKA-006).

ARCHITECTURAL

Specification:

Section 09 30 13 – Ceramic Tiling

1. Item 2.1; Revise to read as follows:

2.1 Tile

- .1 Porcelain Floor Tile: to CAN/CGSB-75.1, ANSI A118.4, Class MR (02 -3.0%), 10 mm x 300 mm x 300 mm size, slip resistant surface, pattern & colour as indicated on Finish Legend.
- .2 Porcelain Wall Tile: to CAN/CGSB-75.1, ANSI A118.4, Class MR (02 -3.0%), 10 mm x 300 mm x 300 mm size, pattern & colour as indicated on Finish Legend.

2. Item 2.10; Add as follows:

2.10 Membranes

- .1 Waterproofing Membranes: Load bearing, reinforced, liquid applied membrane; manufactured to accommodate flood testing and reduce the incidence of thermal shock cracking to tiling installations; meeting requirements of ANSI A108.1

Section 10 74 49 – Manufactured Exterior Security Specialties

1. Section 10 74 49; Add and forms part of this Addendum.

ARCHITECTURAL

Drawing:

Drawing A2.03 – Second Floor Plan

1. All columns to be concealed behind 15.9mm drywall, unless noted otherwise on drawings.

Drawing A3.01 – Ground Floor Ceiling Plan A

1. All columns contained within 'Scope of Steel Fire Proofing' boundary to follow UL Design X528, unless noted otherwise on drawings, with the following exceptions: PB-P4, PC(offset)-P10.
2. Column PB-P4 is to be protected with intumescent paint from the ground floor slab to the underside of second floor deck which conforms to the specification. PC(offset)-P10 does not require fire protection.

3. Refer to sketch SKA-004, which forms part of this addendum, for clarification of scope of renovation ceiling work. Adjust sprinkler heads and mechanical diffusers to conform to new ceiling layout.

Drawing A3.02 - Ground Floor Ceiling Plan B

1. Refer to sketch SKA-005, which forms part of this addendum, for clarification of scope of renovation ceiling work. Adjust sprinkler heads and mechanical diffusers to conform to new ceiling layout.

Drawing A8.01 - Ground Floor Finishes Plan A

1. Window Screens (S8) located within Non-Contact Rooms (P118, P119, P121, P122) to have Polished Wire Glass that conforms to the specification.
2. Wall Finishes on the four walls which encompass the shower area to be porcelain tile (full height) that conforms to the specification.

Drawing A8.03 - Second Floor Finishes Plan

1. Wall Finish in room A203b to be porcelain tile (full height) that conforms to the specification.

End of ADDENDUM Number 01

Part 1 General

1.1 SUMMARY

- .1 This Section includes requirements for supply and install of pre-manufactured security pole and mounting accessories for video surveillance.

1.2 RELATED REQUIREMENTS

- .1 Section 28 23 00 – Video Surveillance

1.3 SUBMITTALS

- .1 Submit in accordance with Section 01 33 00 - Submittal Procedures.
- .2 Product Data:
 - .1 Submit product data from manufacturer indicating performance criteria, size, and installation requirements.
- .3 Shop Drawings:
 - .1 Submit shop drawings indicating anchoring, bases and support system for security pole.

1.4 QUALITY ASSURANCE

- .1 Provide each flagpole as complete unit produced by single manufacturer, including fittings, accessories, bases and anchorage devices.

1.5 DELIVERY, STORAGE AND HANDLING

- .1 Deliver, store and handle materials in accordance with Section 01 61 00 - Common Product Requirements.
- .2 Delivery and Acceptance Requirements: deliver materials to site in original factory packaging, labelled with manufacturer's name and address.
- .3 Storage and Handling Requirements:
 - .1 Store materials off ground in dry location and in accordance with manufacturer's recommendations in clean, dry, well-ventilated area.
 - .2 Store and protect security poles and mounting accessories from nicks, scratches, and blemishes.
 - .3 Replace defective or damaged materials with new.
- .4 Packaging Waste Management: remove for reuse and return by manufacturer of pallets, crates, padding, packaging materials in accordance with Section 01 74 21 - Construction/Demolition Waste Management and Disposal.

Part 2 Products

2.1 SECURITY POLE

- .1 Security Pole: Manufactured tilt down security pole with camera mounting equipment.
- .2 Design Criteria
 - .1 Security pole, bases and anchorage devices to resist maximum wind load of 0.50 m².
 - .2 Description:
 - .1 Exposed Height: 10 m
 - .2 Diameter: Nominal 193 mm
- .3 Basis-of-Design Materials: Altron, AW1545/10 TD

2.2 ACCESSORIES

- .1 Pre-manufactured camera mount:
 - .1 Basis-of-Design Materials: Altron, AW1699/F
- .2 Pre-manufactured parapet camera mount:
 - .1 Basis-of-Design Materials: Altron, SBI-2000PMC/D-IC

Part 3 Execution

3.1 EXAMINATION

- .1 Verification of Conditions: verify that conditions of substrate previously installed under other Sections or Contracts are acceptable for security pole installation in accordance with manufacturer's written instructions.
 - .1 Visually inspect substrate in presence of Departmental Representative.
 - .2 Inform Departmental Representative of unacceptable conditions immediately upon discovery.
 - .3 Proceed with installation only after unacceptable conditions have been remedied and after receipt of written approval to proceed from Departmental Representative.

3.2 INSTALLATION

- .1 Install security pole, base cabinet assemblies, camera mount and fittings to shop drawings and manufacturer's instructions.
- .2 Check and adjust installed fittings for smooth tilt down operation.

3.3 PROTECTION

- .1 Protect installed products and components from damage during construction.

END OF SECTION

NOTE: ADJUST SPRINKLER
HEADS AND MECH.
DIFFUSERS TO
CONFORM TO NEW
CEILING LAYOUTS

NOTE: REPAINT ALL EXIST.
GYPSUM CEILINGS

INSTALL NEW T-BAR
CEILING (C1) WHERE
REQ. BY NEW SERVICES
INSTALL (REFER TO
MECH.ELEC.)

RE-PATCH GYPSUM (C5)
WHERE REQ. BY NEW
SERVICES INSTALL
(REFER TO MECH./ELEC.)

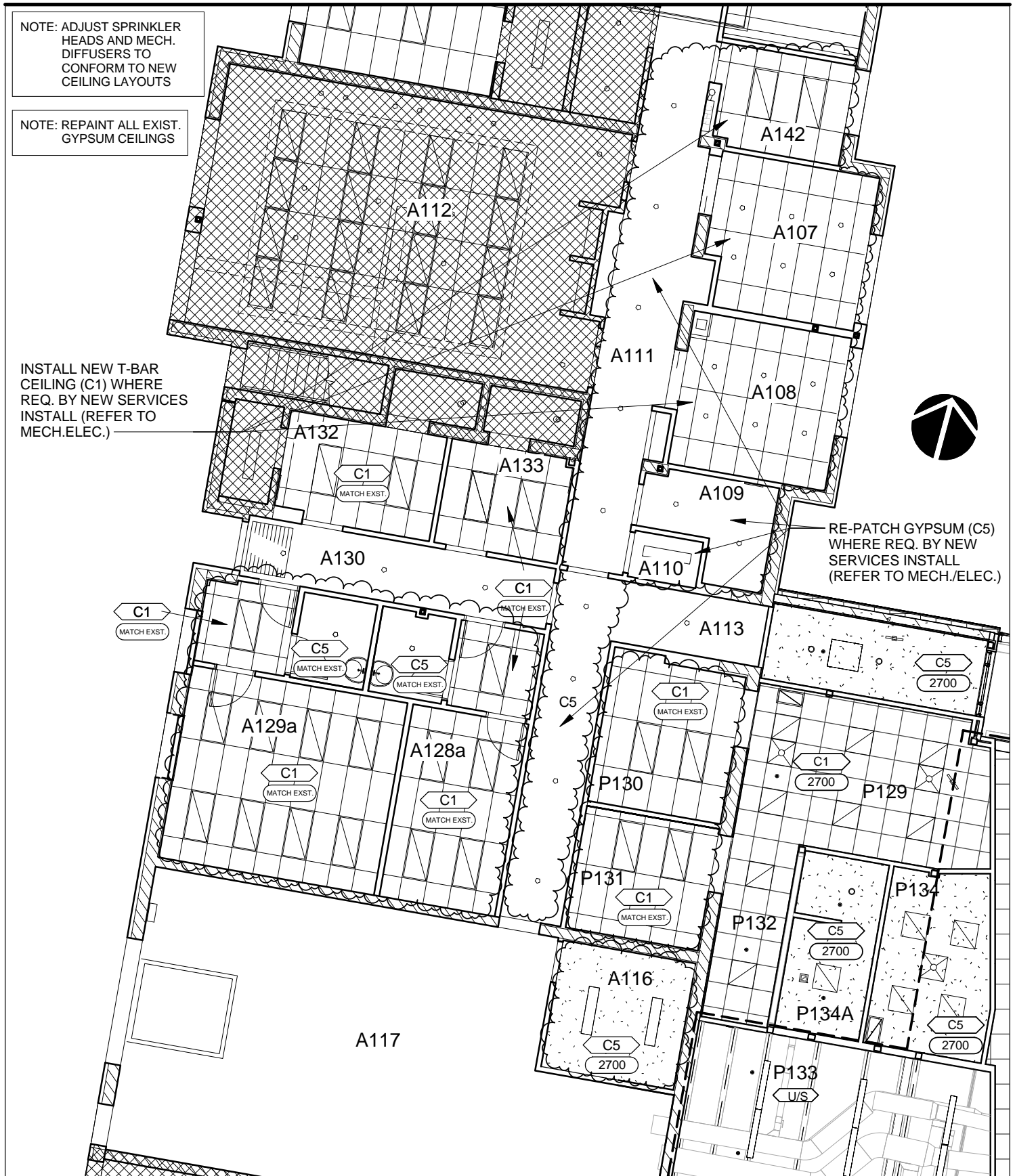

TO BE READ IN CONJUNCTION WITH DRAWING: A3.01

DIALOG™

PROJECT TITLE: PRINCIPAL ENTRANCE BUILDING

DRAWING NUMBER: SKA-004

PROJECT #: R.047995.001

DRAWN BY: GG

DRAWING TITLE: GROUND FLOOR REFLECTED
CEILING PLAN A

CHECKED BY: RN

DATE: 11/18/13

NOTE: ADJUST SPRINKLER
HEADS AND MECH.
DIFFUSERS TO
CONFORM TO NEW
CEILING LAYOUTS

NOTE: RE-PAINT ALL GYPSUM
CEILINGS TO LINE
INDICATED ON PLAN

RE-PATCH GYPSUM (C5)
WHERE REQ. BY
LIGHTING RELOCATION

EXTENT OF CEILING
RE-PAINTING FOR
RENOVATION AREA

INSTALL NEW T-BAR
(C1) TO
ACCOMMODATE NEW
WALL

RE-PATCH GYPSUM (C5)
WHERE REQ. BY NEW
SERVICES INSTALL
(REFER TO MECH.ELEC.)

INSTALL NEW T-BAR
CEILING (C1) WHERE
REQ. BY NEW SERVICES
INSTALL (REFER TO
MECH.ELEC.)



TO BE READ IN CONJUNCTION WITH DRAWING: A3.02

DIALOG™

PROJECT TITLE: PRINCIPAL ENTRANCE BUILDING

DRAWING NUMBER: SKA-005

PROJECT #: R.047995.001

DRAWN BY: GG

DRAWING TITLE: GROUND FLOOR REFLECTED
CEILING PLAN B

CHECKED BY: RN

DATE: 11/18/13



TO BE READ IN CONJUNCTION WITH DRAWING:

DIALOG™

PROJECT TITLE: PRINCIPAL ENTRANCE BUILDING

DRAWING NUMBER: SKA-006

PROJECT #: R.047995.001

DRAWN BY: GG

DRAWING TITLE: EXISTING SWITCHBOARD MAKE &
MODEL ELECTRICAL ROOM A120

CHECKED BY: RN

DATE: 11/18/13