

# ANNEX "C"

English

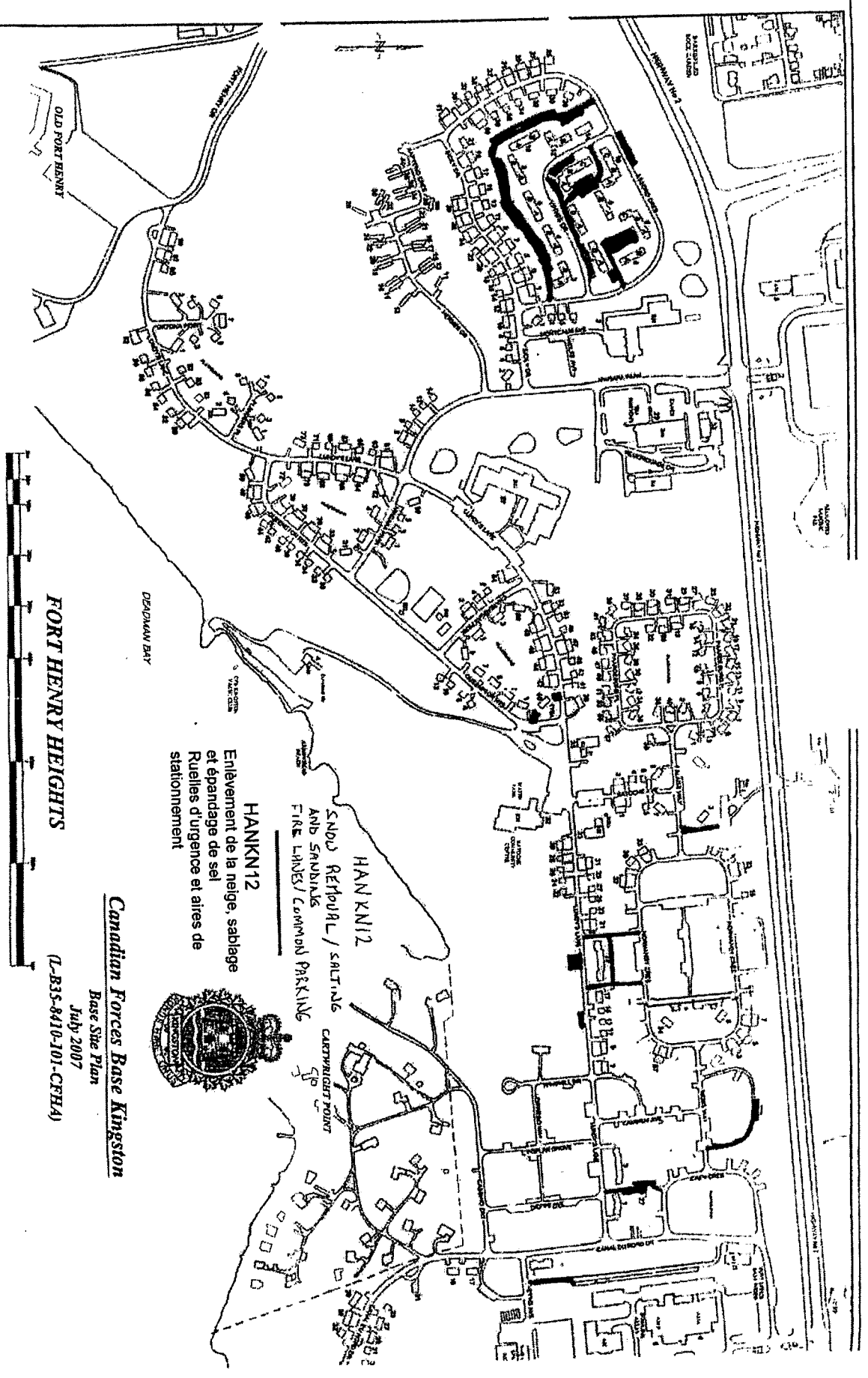

HANKN12  
Enlèvement de la neige, sablage  
et épandage de sel  
Ruelles d'urgence et aires de  
stationnement

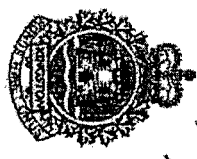

FORT HENRY HEIGHTS

(L-B35-8410-101-CFH4)

Canadian Forces Base Kingston  
Base Site Plan  
July 2007



ONTARIO  
PROVINCIAL  
STANDARD  
SPECIFICATION

METRIC  
OPSS 1004  
MARCH 1993

MATERIAL SPECIFICATION FOR  
AGGREGATES - MISCELLANEOUS

AMEX "D"

TABLE OF CONTENTS

1004.01	SCOPE	1004.10	Not Used
1004.02	REFERENCES		
1004.03	Not Used		
1004.04	SUBMISSION AND DESIGN REQUIREMENTS		
1004.04.01	Samples		
1004.04.01.01	Abrasives for Blast Cleaning		
1004.05	MATERIALS		
1004.05.01	General		
.02	Abrasives for Blast Cleaning		
.03	Gravel Sheeting		
.04	Mortar Sand		
1004.05.04.01	General		
.02	Gradation Requirements		
.03	Test for Organic Impurities		
.04	Test for Strength		
1004.05.05	Sand for Winter Sanding		
.06	Rip Rap, Rock Protection and Gabion Stone		
1004.05.06.01	Rip Rap and Gabion Stone		
.02	Rock Protection		
1004.05.07	15.0 mm Clear Stone		
.08	Sand Bedding for Buried Utilities		
1004.06	Not Used		
1004.07	Not Used		
1004.08	Not Used		
1004.09	Not Used		

1004.01	SCOPE		
This specification covers specific requirements for abrasives for blast cleaning, gravel sheeting, mortar, winter sanding operations, rip rap, rock protection, gabion stone, 15.0 mm clear stone and sand bedding for buried utilities, and provides for the use of reclaimed Portland cement concrete, in rip rap, rock protection and gabion stone.			
1004.02	REFERENCES		
This specification refers to the following standards, specifications or publications:			
Ontario Provincial Standard Specifications, Materials:			
OPSS 1001 Aggregates - General			
OPSS 1010 Aggregates - Granular A, B, M, and Select Subgrade Material			
American Society for Testing & Materials:			
ASTM C67-83 (R-1990) - Effect of Organic Impurities in Fine Aggregate on Strength of Mortar			
Ministry of Transportation Publications:			
MTO Laboratory Testing Manual, Test Number:			
LS 602 - Sieve Analysis of Fine and Coarse Aggregates			
LS 610 - Organic Impurities in Sands for Concrete			
LS 611 - Abrasion Test for Deleterious Material in Ice Control Sand			



ONTARIO  
PROVINCIAL  
STANDARD  
SPECIFICATION

METRIC  
OPSS 2502  
DECEMBER 1990

MATERIAL SPECIFICATION FOR  
SODIUM CHLORIDE

TABLE OF CONTENTS

2502.01	SCOPE	2502.05.01	General Requirements
2502.02	Net Used	2502.05.02	Sodium Chloride shall conform to the requirements listed below and shall always be in a free flowing state and used.
2502.03	Net Used	2502.05.03	Chemical Composition, by mass
2502.04	Net Used	2502.05.04	Cosmos and Fine Crushed Rock Salt
2502.05	MATERIALS	2502.05.05	Moisture content, not more than 1.5%
2502.05.01	General Requirements	2502.05.06	Sodium Chloride content, dry mass basis, not less than 98.0%
2502.05.02	Chemical Composition, by mass	2502.05.07	Insoluble matter, dry mass basis, not more than 4.0%
2502.05.03	General Requirements	2502.05.08	General
2502.05.04	Net Used	2502.05.09	Delivery and Packaging
2502.05.05	Net Used	2502.05.10	Inspection, Sampling and Testing
2502.05.06	Net Used	2502.05.11	Measurement and Payment
2502.05.07	Net Used	2502.10	Net Used
2502.05.08	Net Used		
2502.05.09	Net Used		
2502.05.10	Net Used		
2502.05.11	Net Used		

AUTHORITY PURCHASE OF  
MATERIAL BY PURCHASE ORDER

2502.01 SCOPE  
This specification covers the requirements for the supply and delivery of sodium chloride.

LTO Slave Designation	Percentage Passing by Weight	
	Coarse Crushed Rock Salt	Fine Crushed Rock Salt
8.5 mm	100	100
4.75 mm	30 - 100	100
2.36 mm	5 - 65	
1.18 mm	0 - 30	35 min.
600 µm	0 - 10	

ANNEX "E"

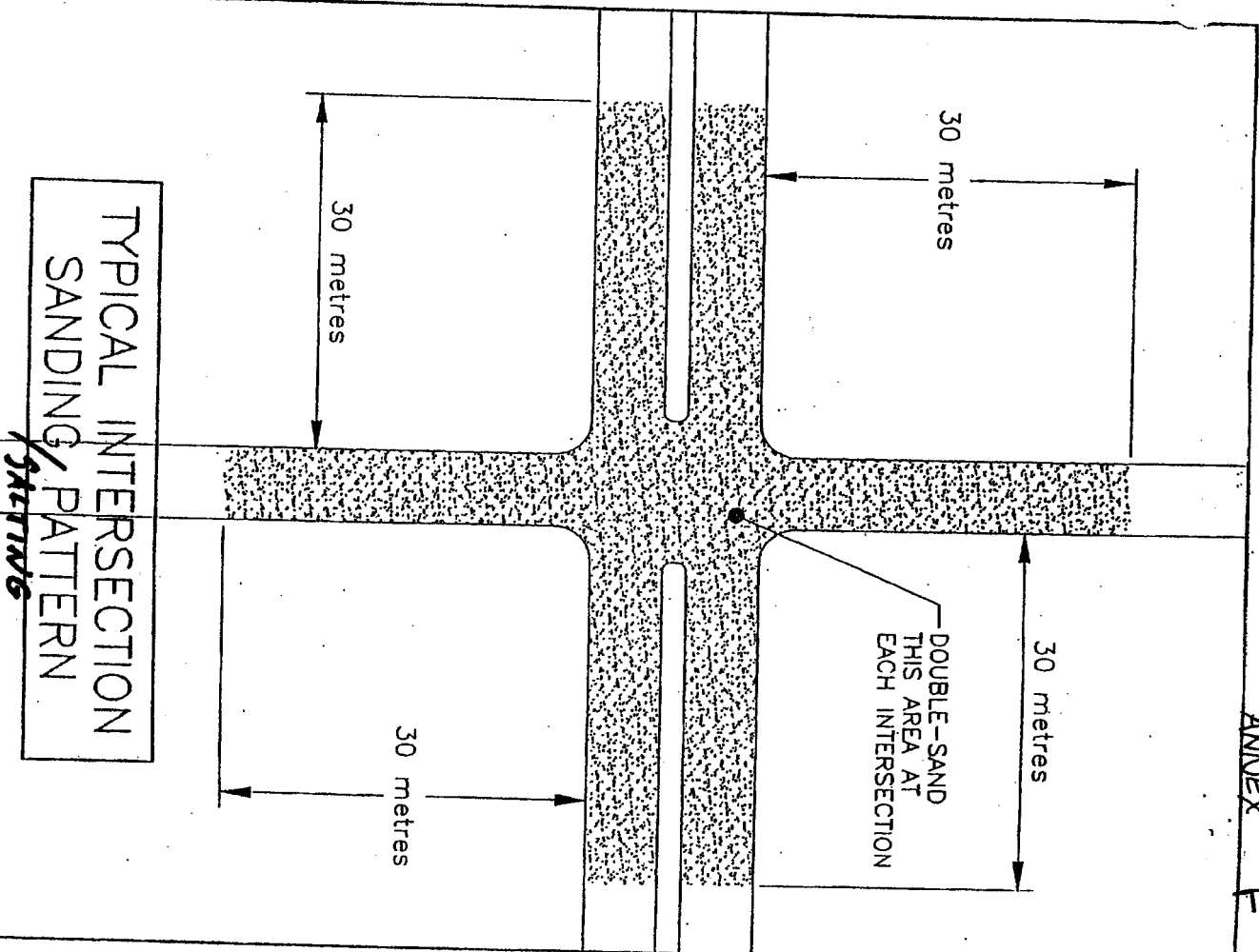

ANNEX "C"  
ANNEX "G"

TERRAIN DE JEU  
PLAYGROUND

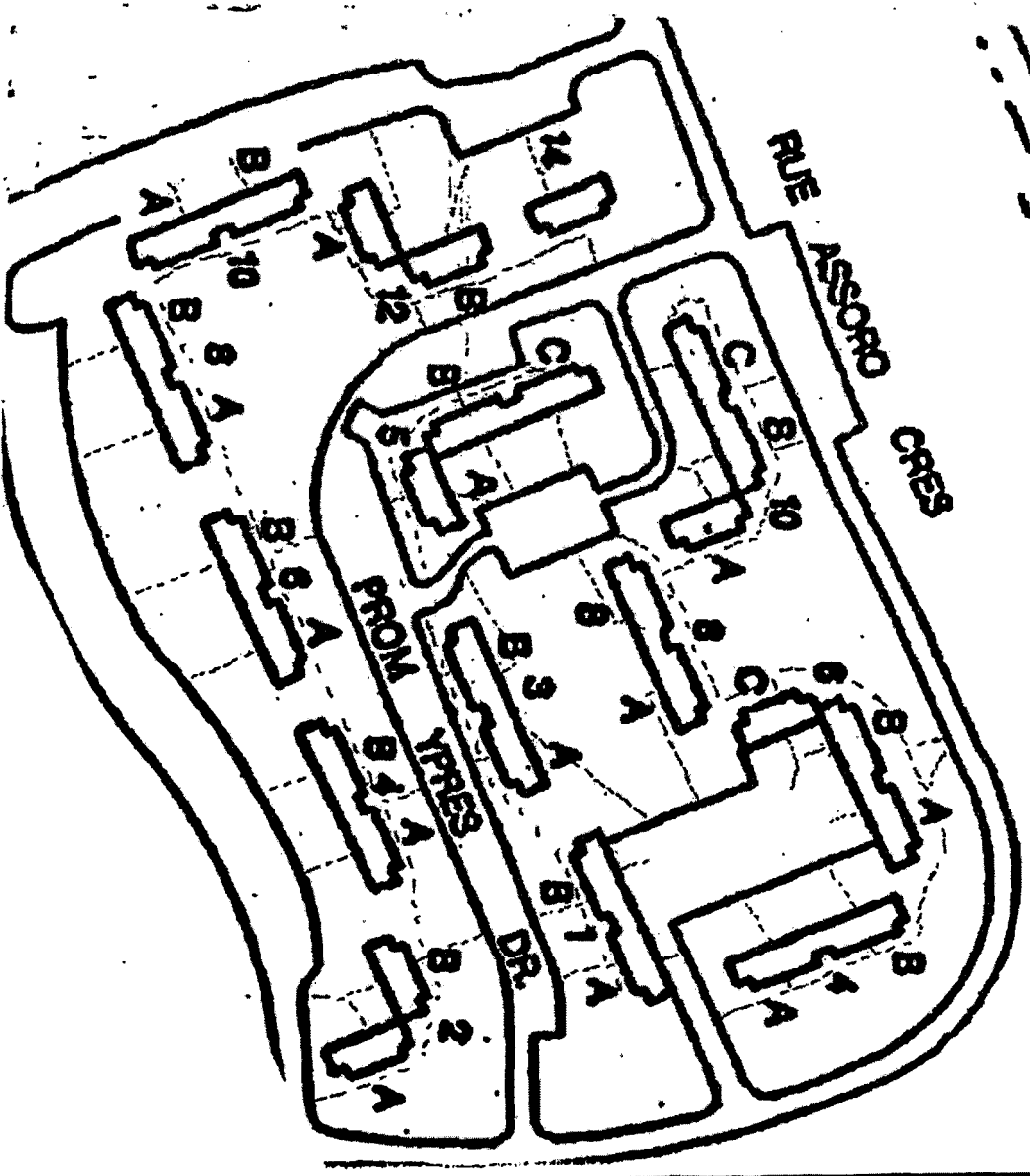

Annex "H"					HANKN12	
Fire lane/Parking Areas						
number	name		width	length	total M2	
1	Falaise		5	55	275	side lane
40	Lundy's Lane		6.6	14	92	parking area
40	Lundy's Lane		8	12	96	parking area
19	Lundy's Lane		16	20	320	front lot
19	Lundy's Lane		4	80	320	rear "H" pattern
19	Lundy's Lane		4	80	320	rear "H" pattern
19	Lundy's Lane		8	66	528	rear "H" pattern
15	Lundy's Lane		4	20	80	front lot
3	Lundy's Lane		13	20	260	front lot
1	Lundy's Lane		7	29	203	rear shared lot with 3 Lundys
1	Lundy's Lane		5	83	415	rear shared lot with 3 Lundys
1	Lundy's Lane		5	33	165	rear shared lot with 3 Lundys
	Mons Way		9	30	270	Crescent serving sheds
	Mons Way		3	100	300	Crescent serving sheds
11	Canal		5	40	200	Common rear parking
	Ypres and Assoro				11717	All firelanes and common parking