

RETURN BIDS TO:
RETOURNER LES SOUMISSIONS À:
Bid Receiving - PWGSC / Réception des soumissions -
TPSGC
11 Laurier St./11 rue Laurier
Place du Portage, Phase III
Core 0A1 / Noyau 0A1
Gatineau, Québec K1A 0S5

SOLICITATION AMENDMENT MODIFICATION DE L'INVITATION

The referenced document is hereby revised; unless otherwise indicated, all other terms and conditions of the Solicitation remain the same.

Ce document est par la présente révisé; sauf indication contraire, les modalités de l'invitation demeurent les mêmes.

Comments - Commentaires

THIS DOCUMENT CONTAINS A SECURITY
REQUIREMENT /
CE DOCUMENT CONTIENT UNE EXIGENCE
EN MATIÈRE DE SÉCURITÉ.

Vendor/Firm Name and Address

**Raison sociale et adresse du
fournisseur/de l'entrepreneur**

Issuing Office - Bureau de distribution

Construction Services Division/Division des services de
construction
11 Laurier St./11 Rue Laurier
3C2, Place du Portage
Phase III
Gatineau, Québec K1A 0S5

Title - Sujet Macdonald-Cartier Br. Rehab.	
Solicitation No. - N° de l'invitation EP731-141814/A	Amendment No. - N° modif. 006
Client Reference No. - N° de référence du client 20141814	Date 2014-02-05
GETS Reference No. - N° de référence de SEAG PW-\$\$\$FG-345-64316	
File No. - N° de dossier fg345.EP731-141814	CCC No./N° CCC - FMS No./N° VME
Solicitation Closes - L'invitation prend fin at - à 02:00 PM on - le 2014-02-12	
Time Zone Fuseau horaire Eastern Standard Time EST	
F.O.B. - F.A.B. Plant-Usine: <input type="checkbox"/> Destination: <input type="checkbox"/> Other-Autre: <input type="checkbox"/>	
Address Enquiries to: - Adresser toutes questions à: Nealon, Shawn	Buyer Id - Id de l'acheteur fg345
Telephone No. - N° de téléphone (819) 956-3391 ()	FAX No. - N° de FAX (819) 956-8335
Destination - of Goods, Services, and Construction: Destination - des biens, services et construction: Pont Macdonald-Cartier Bridge, Ottawa, Ontario / Gatineau, Quebec	

Instructions: See Herein

Instructions: Voir aux présentes

Delivery Required - Livraison exigée	Delivery Offered - Livraison proposée
Vendor/Firm Name and Address Raison sociale et adresse du fournisseur/de l'entrepreneur	
Telephone No. - N° de téléphone Facsimile No. - N° de télécopieur	
Name and title of person authorized to sign on behalf of Vendor/Firm (type or print) Nom et titre de la personne autorisée à signer au nom du fournisseur/ de l'entrepreneur (taper ou écrire en caractères d'imprimerie)	
Signature	Date

Solicitation No. - N° de l'invitation

EP731-141814/A

Amd. No. - N° de la modif.

006

Buyer ID - Id de l'acheteur

fg345

Client Ref. No. - N° de réf. du client

20141814

File No. - N° du dossier

fg345EP731-141814

CCC No./N° CCC - FMS No/ N° VME

THE PURPOSE OF THIS AMENDMENT IS TO ISSUE ADDENUM NO. 2

End of amendment

Solicitation No. - N° de l'invitation

EP731-141814/A

Amd. No. - N° de la modif.

006

Buyer ID - Id de l'acheteur

fg345

Client Ref. No. - N° de réf. du client

20141814

File No. - N° du dossier

fg345EP731-141814

CCC No./N° CCC - FMS No/ N° VME

ADDENDUM NO. 2

ADDENDUM No. 2

Project Number R.005066.506

The following changes in the bid documents are effective immediately. This addendum will form part of the contract documents. These modifications are related to the English version of the documents. The French version of the addendum has additional modifications, which are related to corrections required in the French version of the documents only.

PLANS

- 1 Drawing S46
 - .1 Delete "Design Movements: Total Thermal Movement 270 mm and Seismic Movements ± 70 mm Transversely, ± 120 mm Longitudinally" and replace with "Design Movements: Design Thermal Movement = 375 mm, Design Seismic Movements = 635 mm Longitudinally and 140 mm Transversely. Total effective gap requirements (excluding separation beams) to accommodate longitudinal movements are to be as follows: Thermal Movement Gaps: Min Gap = 125 mm, Max Gap = 500 mm Seismic Movement Gaps: Min gap = 0 mm, Max Gap = 635 mm".
- 2 Drawing E09 and E11
 - .1 Delete current Note 4. Replace with new Note 4 – Leave a 500 mm loop on each cable between box girder and abutment to allow structure movement.

SPECIFICATIONS

- 1 Section 01 56 00 – Temporary Barriers and Enclosures
 - .1 Subsection 1.5 – add a new subsection 1.5.5 – "The attached standard MTQ Barrier is accepted as an equivalent barrier. Do not intermix different standard provincial barriers in a single line of barriers during construction phases or at the new median barrier in its final configuration at completion of work."
- 2 Section 02 41 16 – Structure Demolition
 - .1 Subsection 3.5.4 provides estimated total areas for partial depth concrete removal. See the attached drawings for concrete deterioration at the abutments, piers (including Pier 2 void/severe spall) and underside of deck.
- 3 Section 05 65 00 – Bearings for Approach Spans
 - .1 Subsection 1.5.1 – change "The dimensions specified on the contract drawings are given as an indication" by "Thickness of the laminated bearings specified on the contract drawings should be respected, the other dimensions are given as an indication".
 - .2 Subsection 1.5 – add a new subsection 1.5.2 – "Design Details and connections of

the sliding laminated bearings at the Gatineau Approach in accordance with requirements of CAN/CSA S6 or AASHTO to resist forces, longitudinal and transverse shear forces, and allow for movements indicated on the construction drawings. Thickness of the laminated bearings specified on the contract drawings should be respected, the other dimensions are given as an indication. The manufacturer is responsible for calculating the dimensions to meet loads data and the requirements of the standards mentioned above.

- .3 Subsection 1.8.3 – The entire paragraph is deleted.

NORME

GLISSIÈRE EN BÉTON
POUR CHANTIER –
UNITÉ CONVENTIONNELLE

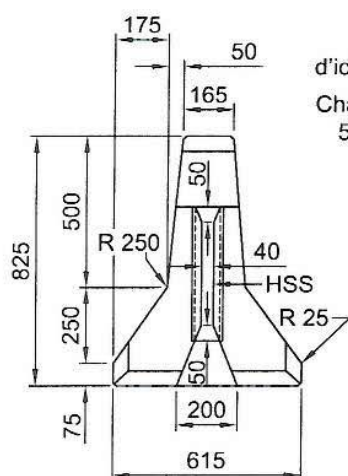

EXTRÉMITÉ FEMELLE

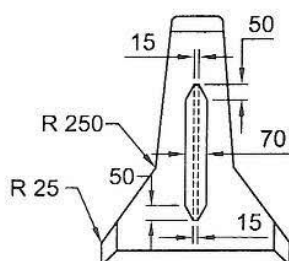

EXTRÉMITÉ MÂLE

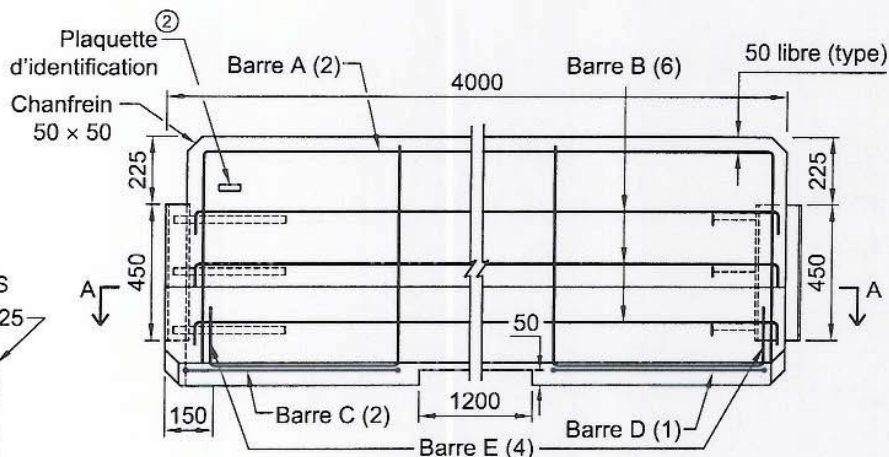

ÉLEVATION

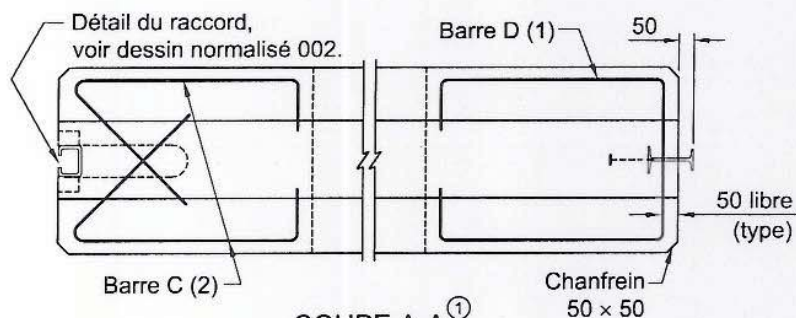

COUPE A-A^①

- ① Les barres B et E ne sont pas dessinées dans la coupe A-A.
② La plaque d'identification est décrite à la section 5.6.1.3 «Plaque d'identification».

Notes :

- sauf indication contraire, toutes les arêtes doivent être chanfreinées de la façon suivante : 15 x 15 mm;
- les barres d'armature peuvent être remplacées en tout ou en partie par du treillis métallique de résistance équivalente dans chaque direction;
- le diamètre des barres d'armature est 15M;
- les cotes sont en millimètres.

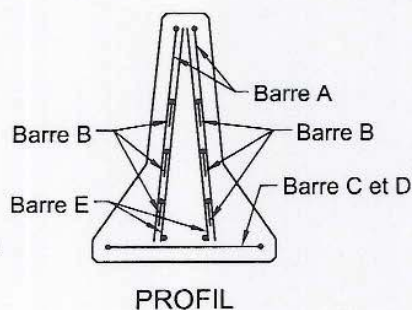

PROFIL

MATÉRIAUX — NORMES APPLICABLES

Armature, type W,
limite élastique minimale 400 MPa
Aciers de construction, type W,
limite élastique minimale 300 MPa

Tome VII, norme 5101

Tome VII, norme 6101

Béton, types IV, V, V-P et XIV-C
Goujons, type B

Tome VII, norme 3101
CAN/CSA W59

NORME

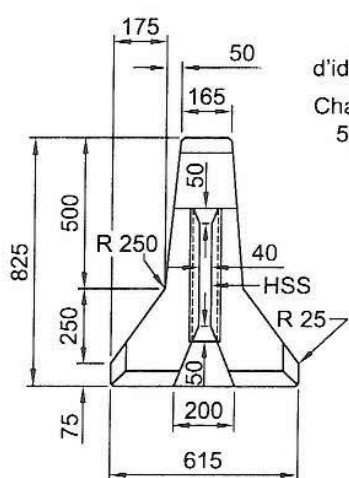

EXTRÉMITÉ FEMELLE

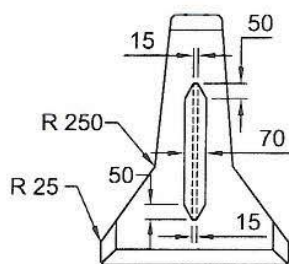

EXTRÉMITÉ MÂLE

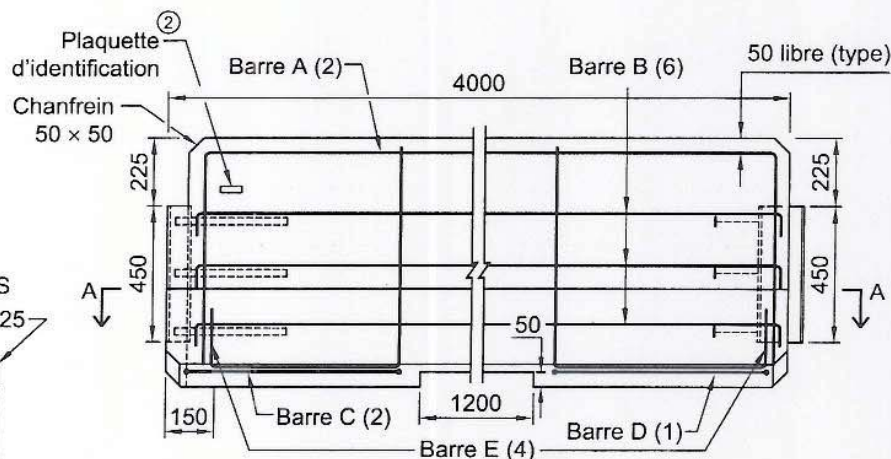

ÉLEVATION

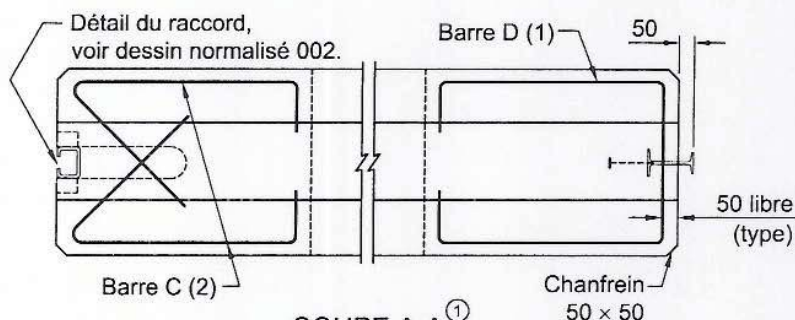

COUPE A-A ①

- ① Les barres B et E ne sont pas dessinées dans la coupe A-A.
② La plaque d'identification est décrite à la section 5.6.1.3 «Plaque d'identification».

Notes :

- sauf indication contraire, toutes les arêtes doivent être chanfreinées de la façon suivante : 15 x 15 mm;
- les barres d'armature peuvent être remplacées en tout ou en partie par du treillis métallique de résistance équivalente dans chaque direction;
- le diamètre des barres d'armature est 15M;
- les cotes sont en millimètres.

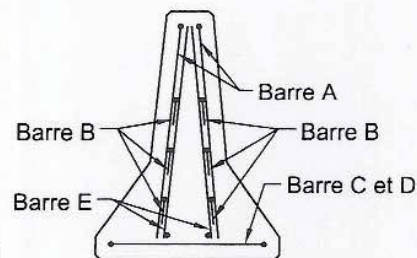

PROFIL

MATÉRIAUX — NORMES APPLICABLES

Armature, type W,
limite élastique minimale 400 MPa
Aciers de construction, type W,
limite élastique minimale 300 MPa

Tome VII, norme 5101
Tome VII, norme 6101

Béton, types IV, V, V-P et XIV-C
Goujons, type B

Tome VII, norme 3101
CAN/CSA W59

TOTAL SPALLLED AREA/TOTAL DES SURFACES ÉCLATÉES = 7 m²
TOTAL DELAMINATED AREA/TOTAL DES SURFACES DÉLAMINÉES = 7 m²

- LEGEND
- EXPOSED REINFORCING STEEL/
BÂRE D'ARMATURE DÉCOUVERTE
 - SPALL/ÉCLATÉMENT
 - DELAMINATION/DEAMINATIONS
 - SCALING/ÉCAILLAGE
 - REPAIR/REPARATION
 - WET AREA/ENDROIT HUMIDE

- M MEDIUM CRACK/FISSURE MOYENNE (0.3 TO 1.0mm)
- W WIDE CRACK/FISSURE LARGE (>1.0mm)
- W W STAINED CRACK/ FISSURE TACHÉE



MCCORMICK RANKIN
CORPORATION

Drawn by: BR
Designed par:
Checked by: JT/WRB
Verified par:
Date: NOV. 2011
Scale: AS NOTED
Échelle:

PUBLIC WORKS AND GOVERNMENT SERVICES CANADA
TRAVAUX PUBLICS ET SERVICES GOUVERNEMENTAUX CANADA
MACDONALD-CARTIER BRIDGE - PONT MACDONALD CARTIER
COMPREHENSIVE DETAILED INSPECTION
INSPECTION COMPLÈTE ET DÉTAILLÉE
NORTH ABUTMENT / CULÉE NORD

PLATE NO.
NO. DE FEUILLE
AB1

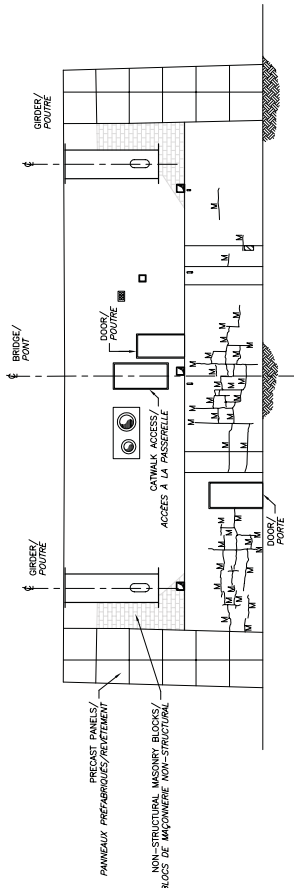
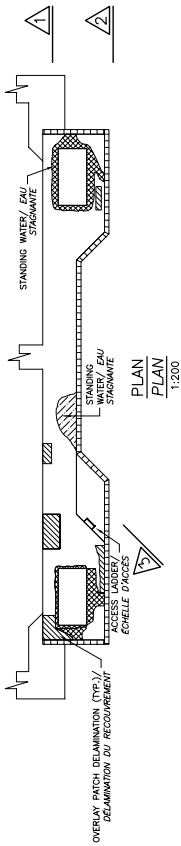

2 SOUTH EXTERIOR ELEVATION
ÉLEVATION EXTÉRIEURE SUD
1:200

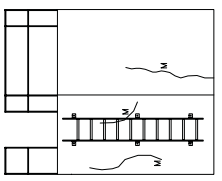

3 ACCESS LADDER
ÉCHELLE D'ACCÈS
1:100

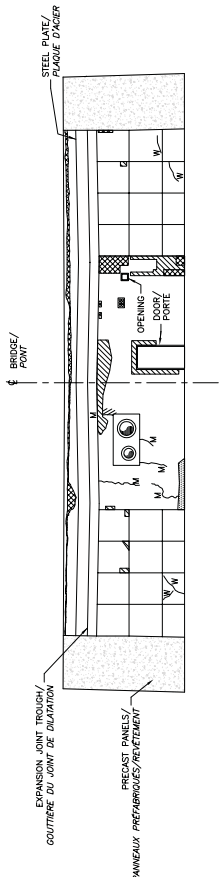

1 SOUTH INTERIOR ELEVATION
ÉLEVATION INTÉRIEURE SUD
1:200

- NOTES:
- MEDIUM TO SEVERE SCALING ON PRECAST PANELS OF ABUTMENT FACING/
ÉCAILLAGE DISPERSÉ MODÉRÉ À SÉVÈRE SUR LES PANEAUX PRÉFABRIQUÉS.
 - CONDUITS NOT SHOWN FOR CLARITY/
CONDUITS NON MONTRÉS POUR LA CLARTÉ.











3 ACCESS LADDER
ÉCHELLE D'ACCÈS

1 NORTH INTERIOR ELEVATION
ÉLEVATION INTÉRIEURE NORD

- NOTES:
1. RUST STAINING ALONG TOP ROW OF PRECAST PANELS/
RUST DE POUILLE LE LONG DE LA RANGÉE SUPÉRIEURE DES PANNEAUX
PRÉFABRICÉS.
 2. RUST STAIN ALONG TOP 1.5' OF Poured CONCRETE/
PANNEAUX DE POUILLE SUR 1.5' DE BÉTON COULÉ.
 3. WARMING OF THE SURFACE OF THE CONCRETE/
MOYENNE ÉCHAUFFEMENT DE LA SURFACE DE BÉTON COULÉ.
 4. REPAIRS FOUND ON PRECAST PANELS/
RÉPARATIONS SOUS-ÉVALUÉES SUR LES PANNEAUX PRÉFABRICÉS.
 5. CONCRETE NOT BURNED FOR CLARITY/
CONCRÉTIS NON BRÛLÉS POUR LA CLARTÉ.

TOTAL SPALLED AREA/TOTAL DES SURFACES ÉCLATÉES = 7 m²
TOTAL DELAMINATED AREA/TOTAL DES SURFACES DÉLAMINÉES = 4 m²

LEGEND

—	EXPOSED REINFORCING STEEL/ BARRÉ D'ARMATURE DÉCOUVERTE
	SPALL/ÉCLATEMENT
	DELAMINATION/DÉLAMINATION
	SCALING/ÉCAILLAGE
	MAP CRACKING/FISSURATION À MAILLES
	WET AREA/ ENDOIT HUMIDE
	RUST STAINING/TACHE DE ROUILLE
	MEDIUM CRACK/FISSURE MOYENNE (0.3 TO 1.0mm)
	WIDE CRACK/FISSURE LARGE (>1.0mm)

**MCCORMICK RANKIN
CORPORATION**

Drawn by: Dessiné par:	TN
Checked by: Vérifié par:	JT/WRB
Date:	NOV. 2011
Scale: Echelle:	AS NOTED

PUBLIC WORKS AND GOVERNMENT SERVICES: CANADA
TRAVAUX PUBLICS ET SERVICES GOUVERNEMENTAUX: CANADA
MACDONALD-CARTIER BRIDGE – PONT MACDONALD CARTIER

COMPREHENSIVE DETAILED INSPECTION
INSPECTION COMPLETE ET DÉTAILLÉE
SOUTH ABUTMENT / CULÉE SUD

PLATE NO.
NO. DE FEUILLE

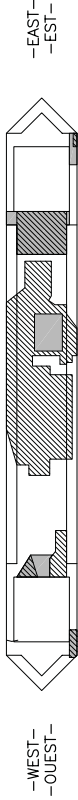

PLAN AT BEARING SEAT
PLAN DU SŒCLE D'APPUI

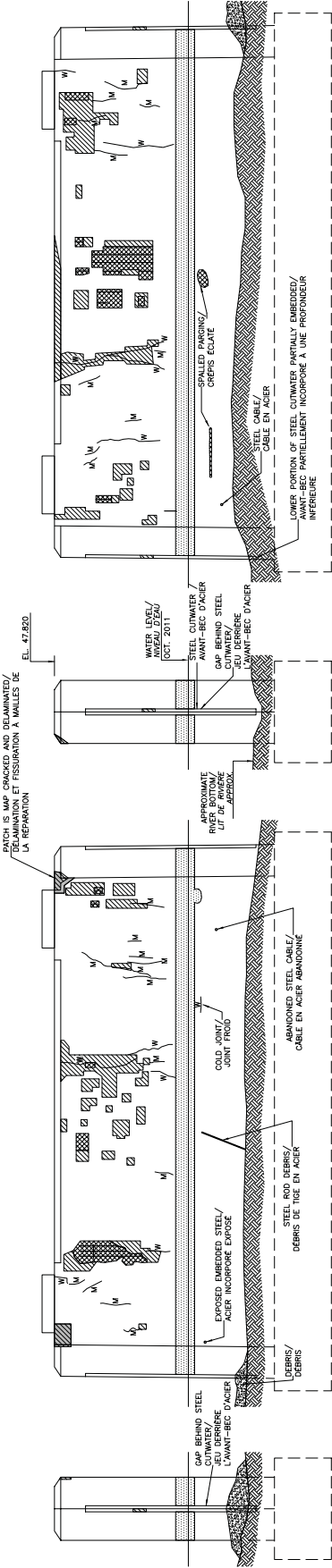

WEST ELEVATION
ÉLEVATION OUEST

SOUTH ELEVATION
ÉLEVATION SUD

EAST ELEVATION
ÉLEVATION EST

NORTH ELEVATION
ÉLEVATION NORD

TOTAL SPALLED AREA/TOTAL DES SURFACES ÉCLATÉES = 10 m²
TOTAL DELAMINATED AREA/TOTAL DES SURFACES DÉLAMINÉES = 54 m²

- LEGEND
- EXPOSED REINFORCING STEEL/BARRE D'ARMATURE DÉCOUVERTE
 - SPALL/ÉCLATEMENT
 - DELAMINATION/DÉLAMINATION
 - SOUNDING/ÉCART
 - HONEYCOMBING/VID D'ÉBÈLLE
 - REPAIR/RÉPARATION
 - MAP CRACKING/FISSURATION A MALLÉES
 - MEDIUM CRACK/FISSURE MOYENNE (0.3 TO 1.0mm)
 - WIDE CRACK/FISSURE LARGE (>1.0mm)



MCCORMICK RANKIN
CORPORATION

Drawn by: TN
Designé par:
Checked by: JT/WRB
Vérifié par:
Date: DEC. 2011
Scale: 1:200
Échelle:

PUBLIC WORKS AND GOVERNMENT SERVICES CANADA
TRAVAUX PUBLICS ET SERVICES GOUVERNEMENTAUX CANADA
MACDONALD-CARTIER BRIDGE - PONT MACDONALD CARTIER
COMPREHENSIVE DETAILED INSPECTION
INSPECTION COMPLÈTE ET DÉTAILLÉE
PIER No. 1 / PILIER No. 1

PLATE NO.
NO. DE FEUILLE

P1



PLAN AT BEARING SEAT
PLAN DU SOCLE D'APPUI











WEST ELEVATION
ÉLÉVATION OUEST

SOUTH ELEVATION
ÉLÉVATION SUD

NORTH ELEVATION
ÉLÉVATION NORD

TOTAL SPALLED AREA/TOTAL DES SURFACES ÉCLATÉES = 14 m²
TOTAL DELAMINATED AREA/TOTAL DES SURFACES DÉLAMIÉES = 132 m²

- LEGEND**
- | | |
|---|---|
|  | EXPOSED REINFORCING STEEL/BARRE D'ARMATURE DÉCOUVERTE |
|  | SPALL/ÉCAILLEMENT |
|  | DELAMINATION/DELAIMATION |
|  | SCALING/ÉCAILLAGE |
|  | HONEYCOMBING/NID D'ABEILLE |
|  | REPAIR/REPARATION |
|  | MAP CRACKING/FISSURATION A MAILLES |
|  | MEDIUM CRACK/FISSURE MOYENNE (0.3 To 1.0mm) |
|  | WIDE CRACK/FISSURE LARGE (>1.0mm) |

**McCORMICK RANKIN
CORPORATION**



Drawn by: Dessiné par:	TN
Checked by: Vérifié par:	JT/WRB
Date:	DEC. 2011
Scale: Échelle:	1:200

PUBLIC WORKS AND GOVERNMENT SERVICES CANADA
TRAVAUX PUBLICS ET SERVICES GOUVERNEMENTAUX CANADA
MACDONALD-CARTIER BRIDGE - PONT MACDONALD CARTIER

COMPREHENSIVE DETAILED INSPECTION
INSPECTION COMPLETE ET DÉTAILLÉE
PIER No. 2 / PILIER No. 2

PLATE NO.
NO. DE FEUILLE

P2

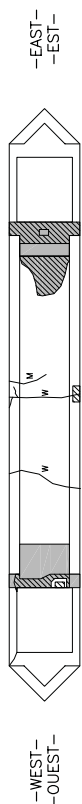

PLAN AT BEARING SEAT
PLAN DU SOCLE D'APPUI

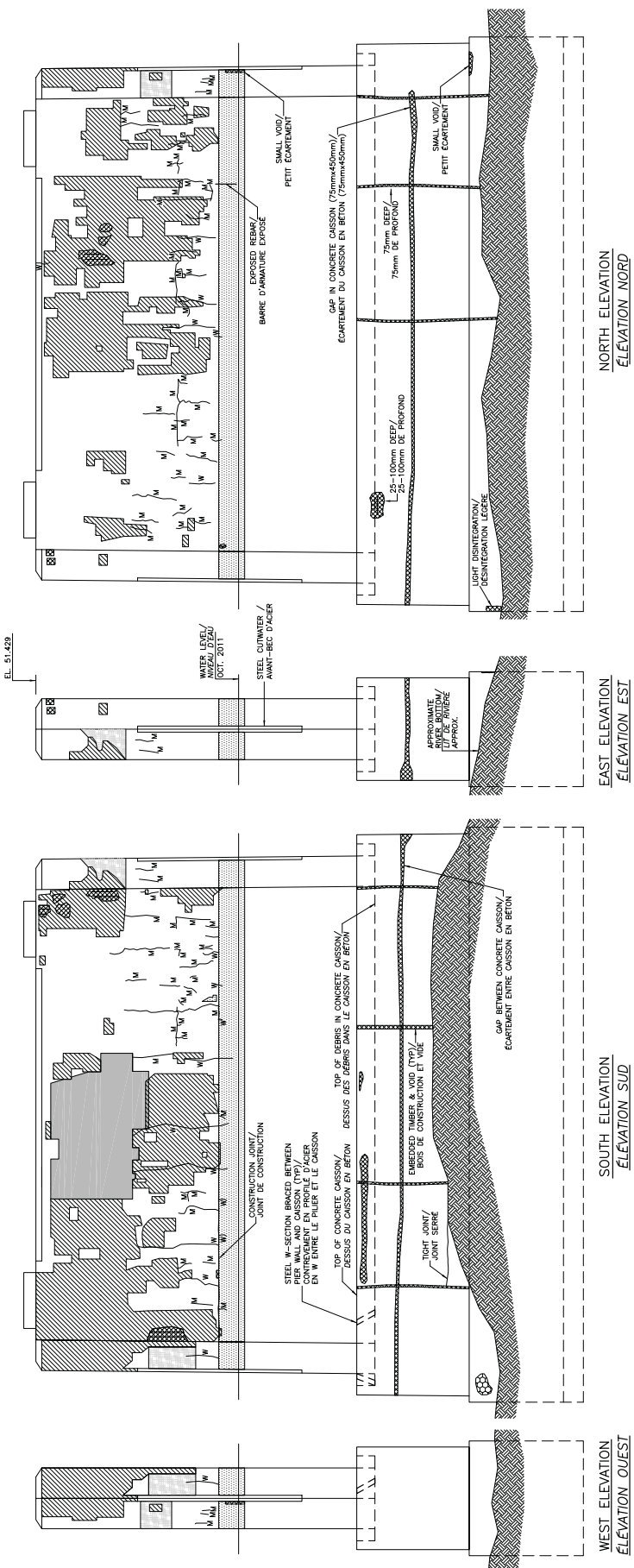

TOTAL SPALLED AREA/TOTAL DES SURFACES ÉCLATÉES = 5 m²
TOTAL DELAMINATED AREA/TOTAL DES SURFACES DÉLAMINÉES = 172 m²

- LEGEND
- EXPOSED REINFORCING STEEL/BARRE D'ARMATURE DÉCOUVERTE
 - SPALL/ÉCLATEMENT
 - DELAMINATION/DÉLAMINATION
 - SCALING/ÉCAILLAGE
 - HONEYCOMBING/VID D'ÂBÎLLE
 - REPAIR/REPARATION
 - MAP CRACKING/FISSURATION À MALLÉES
 - MEDIUM CRACK/FISSURE MOYENNE (0.3 TO 1.0mm)
 - WIDE CRACK/FISSURE LARGE (>1.0mm)



MCCORMICK RANKIN
CORPORATION

Drawn by: TN
Designed par:
Checked by: JT/WRB
Verified par:
Date: DEC. 2011
Scale: 1:200
Echelle:

PUBLIC WORKS AND GOVERNMENT SERVICES CANADA
TRAVAUX PUBLICS ET SERVICES GOUVERNEMENTAUX CANADA
MACDONALD-CARTIER BRIDGE - PONT MACDONALD CARTIER
COMPREHENSIVE DETAILED INSPECTION
INSPECTION COMPLETE ET DÉTAILLÉE
PIER No. 3 / PILIER No. 3

PLATE NO.
NO. DE FEUILLE
P3

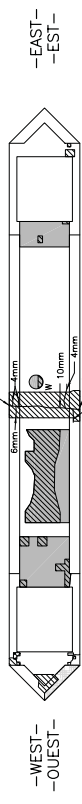

PLAN AT BEARING SEAT
PLAN DU SOCLE D'APPUI

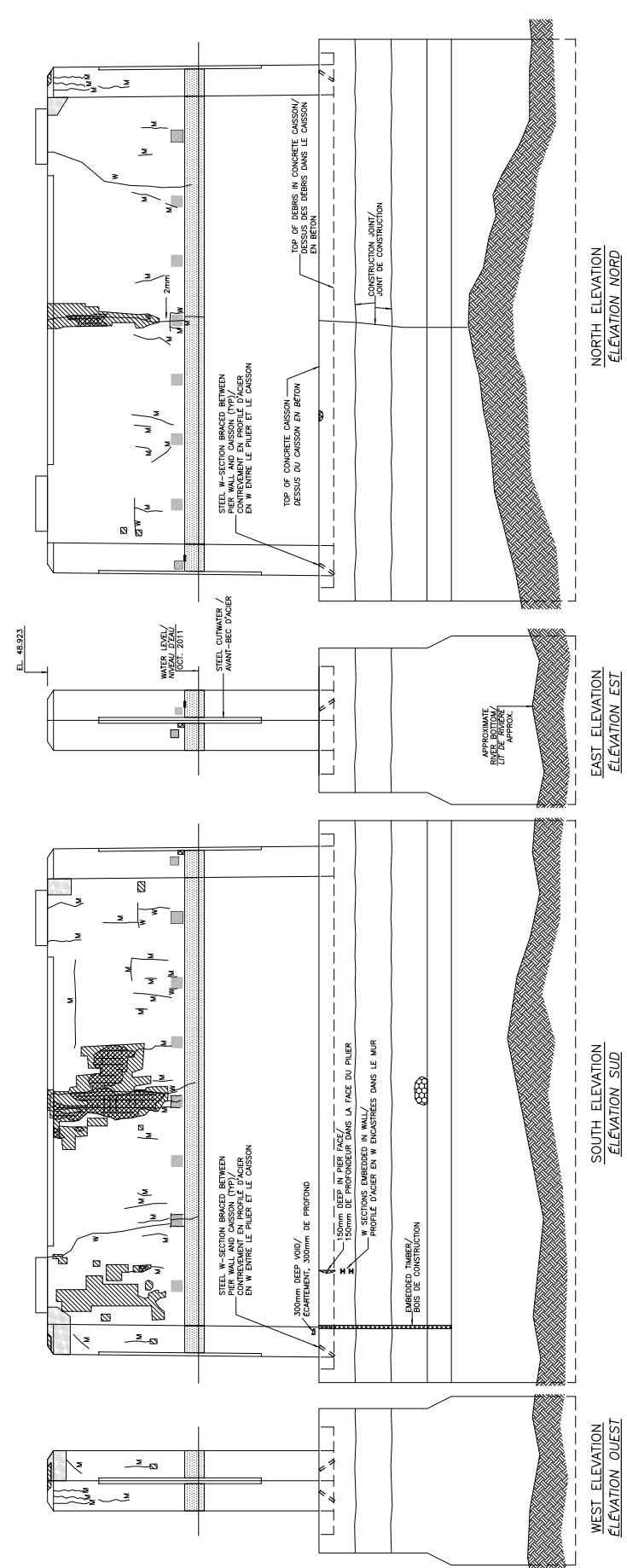

TOTAL SPALLED AREA/TOTAL DES SURFACES ÉCLATÉES = 10 m²
TOTAL DELAMINATED AREA/TOTAL DES SURFACES DÉLAMINÉES = 30 m²

- LEGEND
- EXPOSED REINFORCING STEEL/BARRE D'ARMATURE DÉCOUVERTE
 - SPALL/ECLATÉMENT
 - DELAMINATION/DELAMINATION
 - SOUNDING/ÉCAILLAGE
 - HONEYCOMBING/VID D'ÉCELLE
 - REPAIR/REPARATION
 - MAP CRACKING/FISSURATION À MALLÉES
 - MEDIAN CRACK/FISSURE MOYENNE (0.3 TO 1.0mm)
 - WIDE CRACK/FISSURE LARGE (>1.0mm)



MCCORMICK RANKIN CORPORATION

Drawn by: TN
Designé par:
Checked by: JT/WRB
Vérifié par:
Date: DEC. 2011
Scale: 1:200
Échelle:

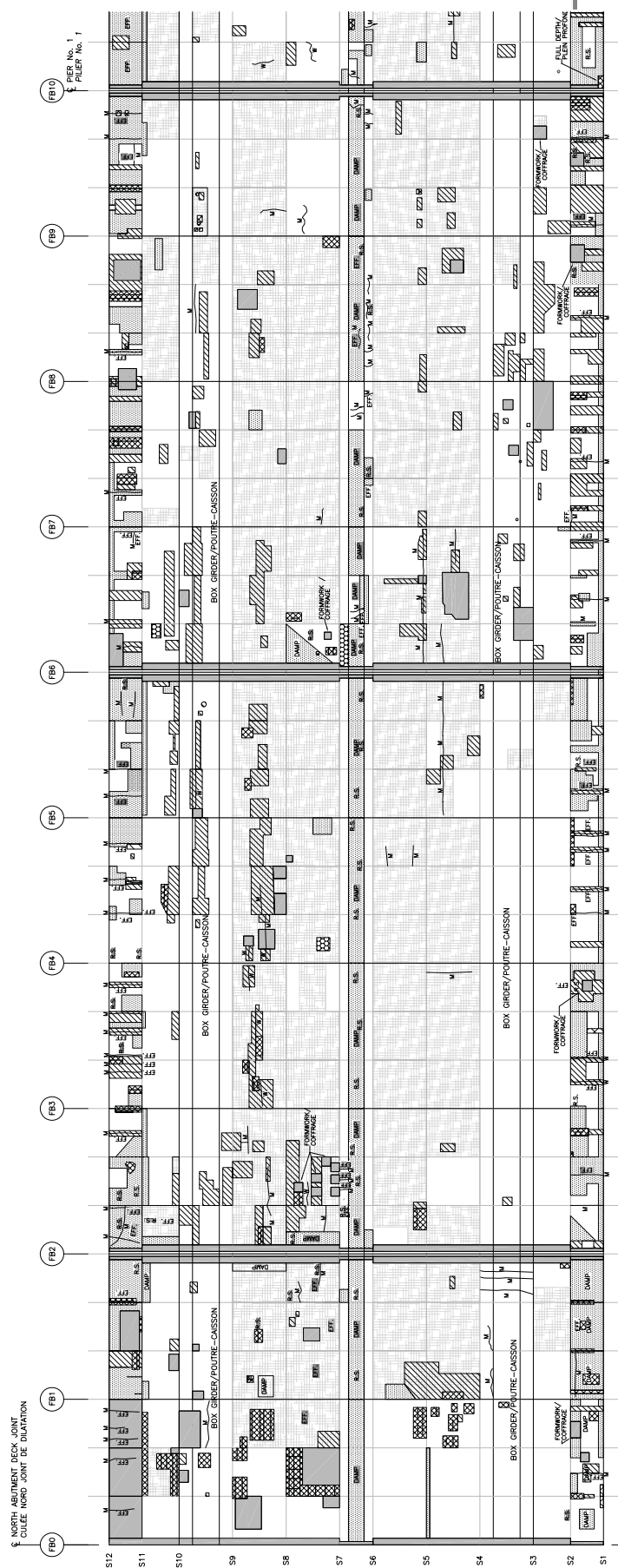

TOTAL DELAMINATED AREA/TOTAL DES SURFACES DELAMINEES = 163.8 m²
TOTAL SPALLED AREA/TOTAL DES SURFACES ECLATEES = 41.0 m²

LEGEND

- EXPOSED REINFORCING STEEL/BARRE D'ARMATURE DECOUVERTE
- MAP CRACKING/FISSURE A MAILLES
- MEDIUM CRACK/FISSURE MOYENNE (0.3 TO 1.0mm)
- WIDE CRACK/FISSURE LARGE (>1.0mm)
- DELAMINATION/DELAMINATION
- SPALL/ECLATEMENT
- EFFLORESCENCE STAINING/EFFLORESCENCE
- SCALING/ECAILLAGE
- DAMP = DAMP AREA/SURFACES D'HUMIDITE
- HONEYCOMBING/IND D'EBELLE
- R.S. = RUST STAINING/TACHES DE ROUILLE
- REPAIR/REPARATION



**MCCORMICK RANKIN
CORPORATION**

Drawn by: TN
Drawing for:
Checked by: JT/WRB
Verified for:
Date: DEC. 2011
Scale: 1:500
Echelle:

PUBLIC WORKS AND GOVERNMENT SERVICES CANADA
TRAVAUX PUBLICS ET SERVICES GOUVERNEMENTAUX CANADA
MACDONALD-CARTIER BRIDGE - PONT MACDONALD CARTIER
COMPREHENSIVE DETAILED INSPECTION
INSPECTION COMPLETE ET DETAILLEE
UNDERSIDE DECK CONDITIONS / DETÉRIORATION DU DESSOUS DU TABLIER

PLATE NO.
NO. DE FEUILLE
UD 1

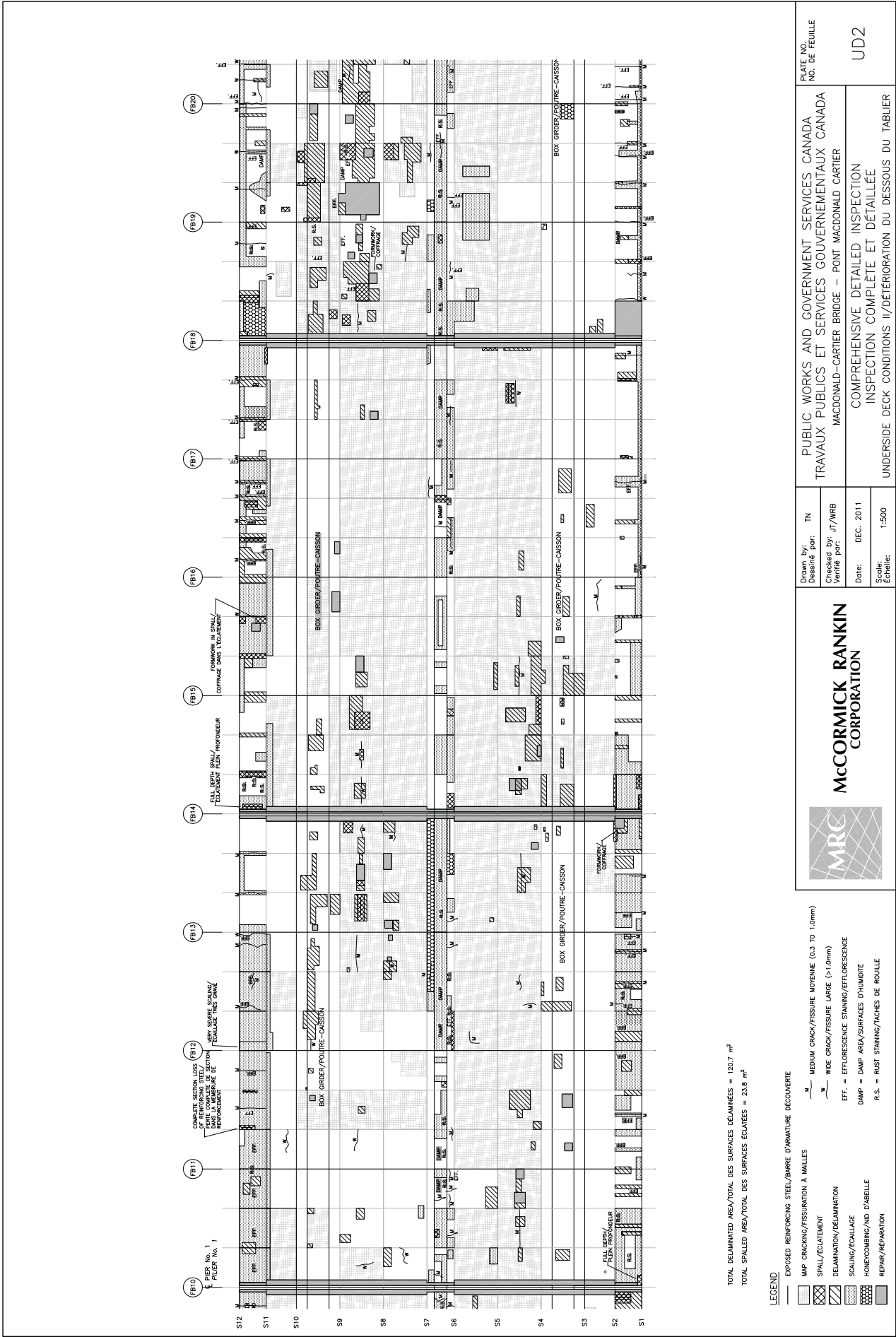

TOTAL DELAMINATED AREA/TOTAL DES SURFACES DÉLAMINÉES = 120.7 m²
TOTAL SPALLED AREA/TOTAL DES SURFACES ÉCLATÉES = 23.8 m²

LEGEND

- EXPOSED REINFORCING STEEL/BARRE D'ARMATURE DÉCOUVERTE
- MAP CRACKING/FISSURATION À MAPLES
- SPALL/ÉCLATÉMENT
- DELMINATION/DÉLAMINATION
- SCALING/ÉCAILLAGE
- HONEYCOMBING/NOY D'AILLE
- REPAIRS/RÉPARATION
- M MEDIUM CRACK/FISSURE MOYENNE (0.3 TO 1.0mm)
- W WIDE CRACK/FISSURE LARGE (>1.0mm)
- EFF EFFLORESCENCE STAINING/EFFLORESCENCE
- DAMP DAMP AREA/SURFACES D'HUMIDITÉ
- R.S. RUST STAINING/TACHES DE ROUILLE



MCCORMICK RANKIN
CORPORATION

Drawn by: TN
Drawing for:
Checked by: JT/WRB
Verified for:
Date: DEC. 2011
Scale: 1:500
Echelle:

PUBLIC WORKS AND GOVERNMENT SERVICES CANADA
TRAVAUX PUBLICS ET SERVICES GOUVERNEMENTAUX CANADA
MACDONALD-CARTIER BRIDGE – PONT MACDONALD CARTIER
COMPREHENSIVE DETAILED INSPECTION
INSPECTION COMPLÈTE ET DÉTAILLÉE
UNDERSIDE DECK CONDITIONS II/DÉTÉRIORATION DU DESSOUS DU TABLIER

UD2

PLATE NO.
NO. DE FEUILLE

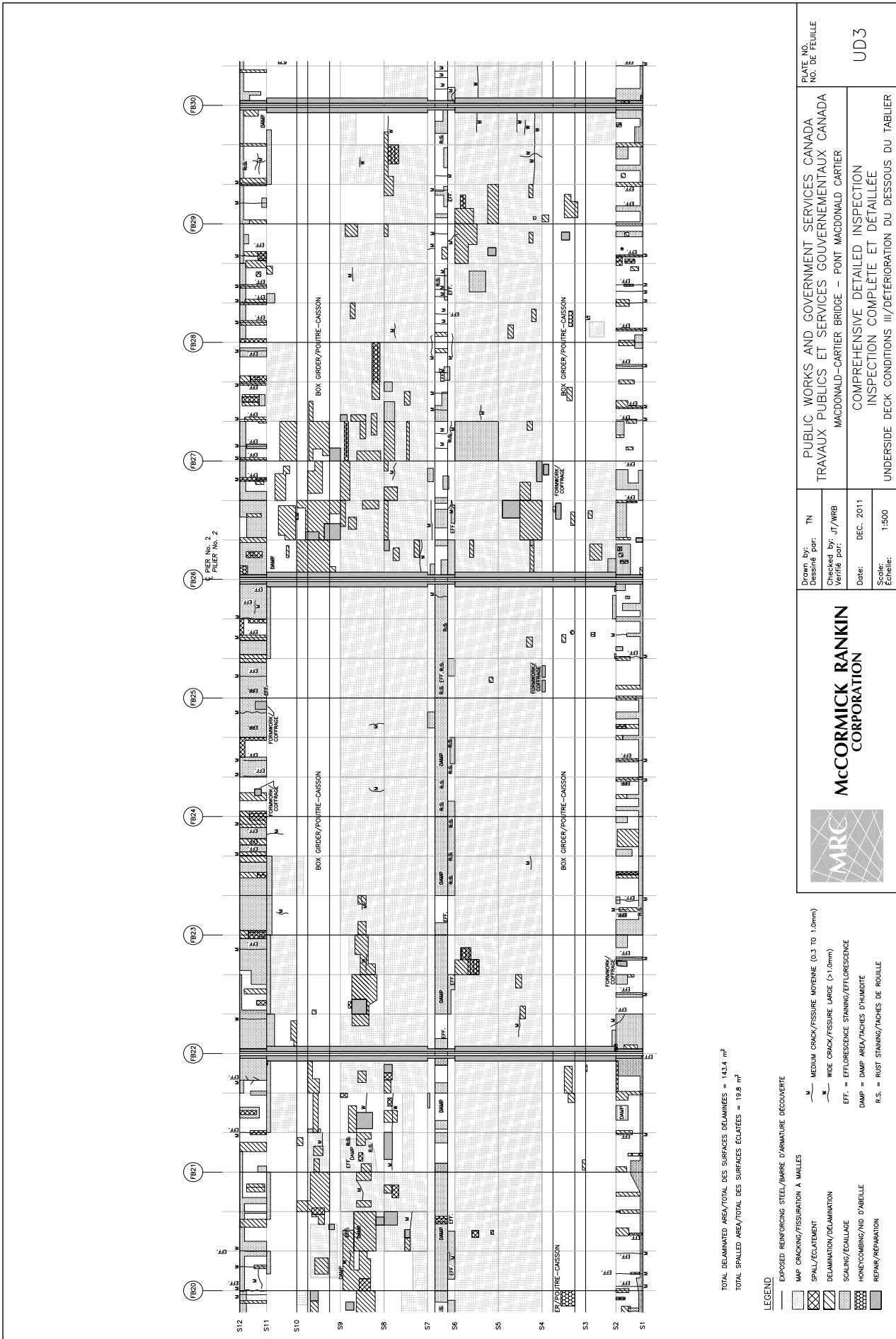

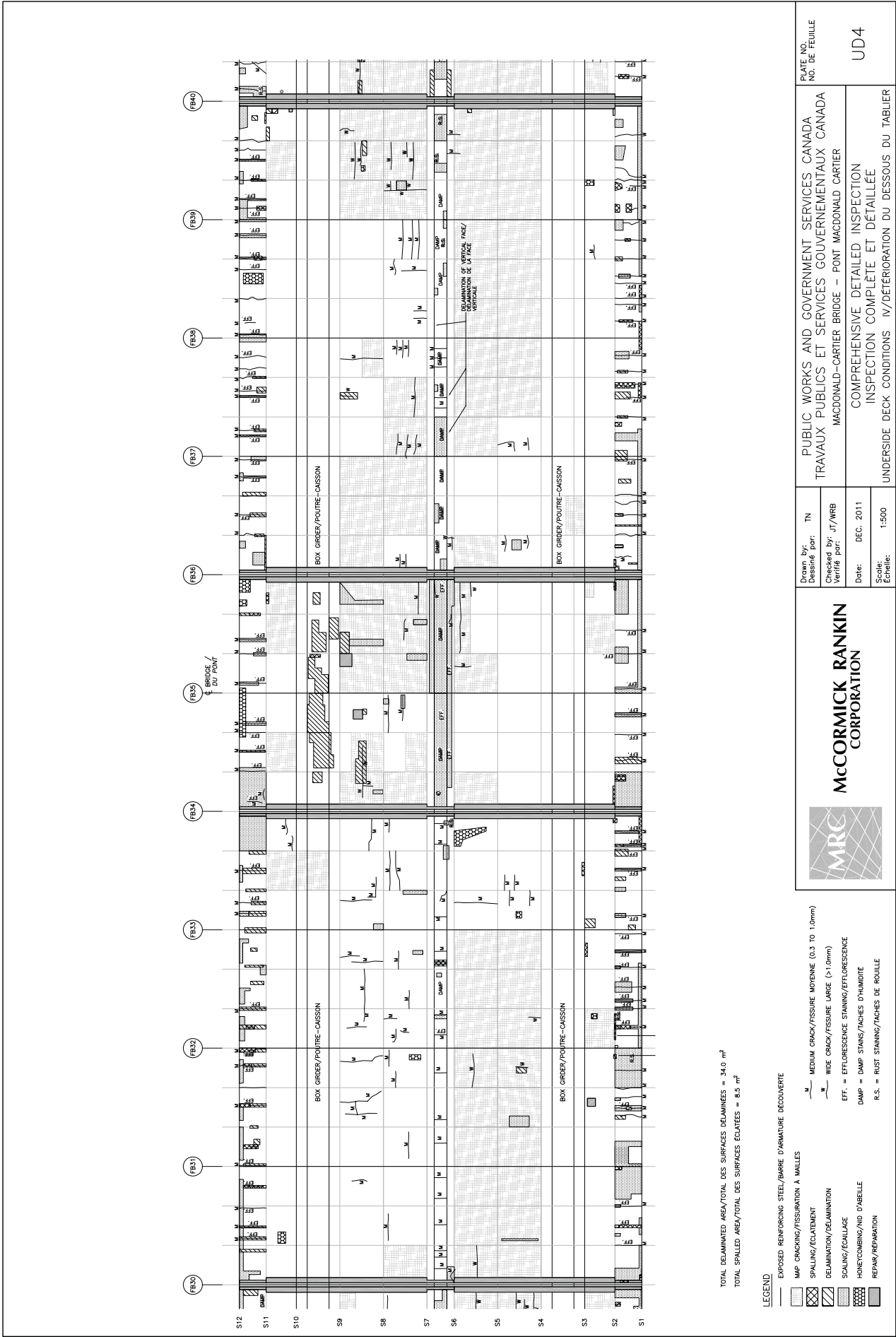

TOTAL DELAMINATED AREA/TOTAL DES SURFACES DELAMINEES = 34.0 m²
TOTAL SPALLED AREA/TOTAL DES SURFACES ECLATEES = 8.5 m²

LEGEND

- EXPOSED REINFORCING STEEL/BARRE D'ARMATURE DECOUVERTE
- MAP CRACKING/FISSURE MOYENNE (0.3 TO 1.0mm)
- WIDE CRACK/FISSURE LARGE (>1.0mm)
- DELAMINATION/DELAMINATION
- SPALLING/ECLATEMENT
- SCALING/ECAILLAGE
- HONEYCOMBING/NOY D'ABELLE
- REPAIR/REPARATION
- MEDIUM CRACK/FISSURE MOYENNE (0.3 TO 1.0mm)
- WIDE CRACK/FISSURE LARGE (>1.0mm)
- EFF = EFFLORESCENCE STAINING/EFFLORESCENCE
- DAMP = DAMP STAINS/TACHES D'HUMIDITE
- R.S. = RUST STAINING/TACHES DE ROUILLE



**MCCORMICK RANKIN
CORPORATION**

Drawn by: TN
Checked by: JT/WRB
Date: DEC. 2011
Scale: 1:500

PUBLIC WORKS AND GOVERNMENT SERVICES CANADA
TRAVAUX PUBLICS ET SERVICES GOUVERNEMENTAUX CANADA
MACDONALD-CARTIER BRIDGE - PONT MACDONALD CARTIER
COMPREHENSIVE DETAILED INSPECTION
INSPECTION COMPLETE ET DETAILLEE
UNDERSIDE DECK CONDITIONS IV/DETERIORATION DU DESSOUS DU TABLIER

PLATE NO.
NO. DE FEUILLE

UD4

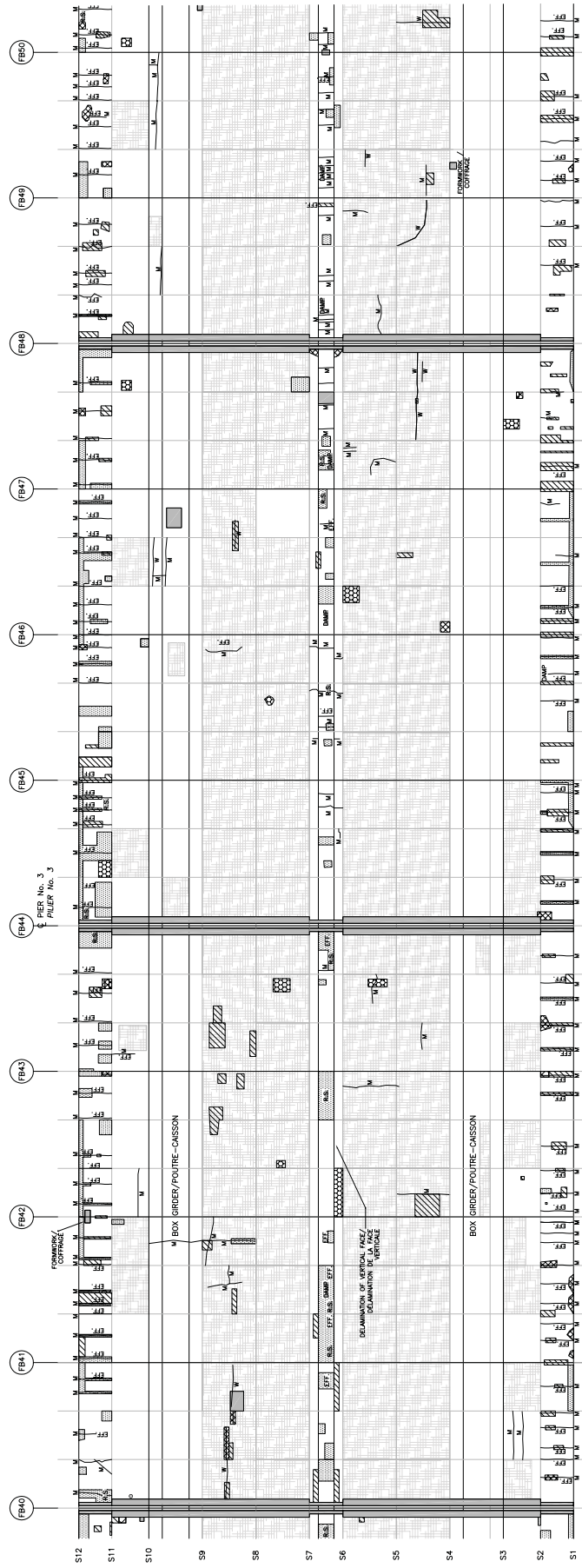

TOTAL DELAMINATED AREA/TOTAL DES SURFACES DÉLAMINÉES = 35.6 m²
TOTAL SPALLED AREA/TOTAL DES SURFACES ÉCLATÉES = 5.8 m²

LEGEND

- EXPOSED REINFORCING STEEL/BARRE D'ARMATURE DÉCOUVERTE

MAP CRACKING/FISSURATION A MAINTIENS

SRAM / SECUREMENT

DEAMINATION/DEAMINATION

DECOMINATION/DECOMINATION

SCALING/ECAIAGE

[illegible]

μ — MEAN CRACK/ESSURE MOYENNE (0.3 TO 1.0mm)

WIDE CRACK/POSSIBLE LARGE (> 1.0 mm)

WIDE CRACK/FISSURE DRAINAGE (2:1:0.0011)

EFF. = EFFLUENCE STAINING/EFFLUENCE

DAMP = DAMP STAINS/TACHES D'HUMIDITE



**MCCORMICK RANKIN
CORPORATION**

Drawn by:
Dessiné par:

Checked by: JT/WRB
Verifié par:

Date:	DEC 2011
-------	----------

Date: DEC. 2011

PUBLIC WORKS AND GOVERNMENT SERVICES CANADA
TRAVAUX PUBLICS ET SERVICES GOUVERNEMENTAUX CANADA
MACDONALD—CARTIER BRIDGE PONT MACDONALD CARTIER

COMPREHENSIVE DETAILED INSPECTION
INSPECTION COMPLÈTE ET DÉTAILLÉE

UNDERSIDE DECK CONDITIONS V/DÉTERIORATION DU DESSOUS DU TABLIER

PLATE NO.	
NO. DE FEUILLE	

UD5

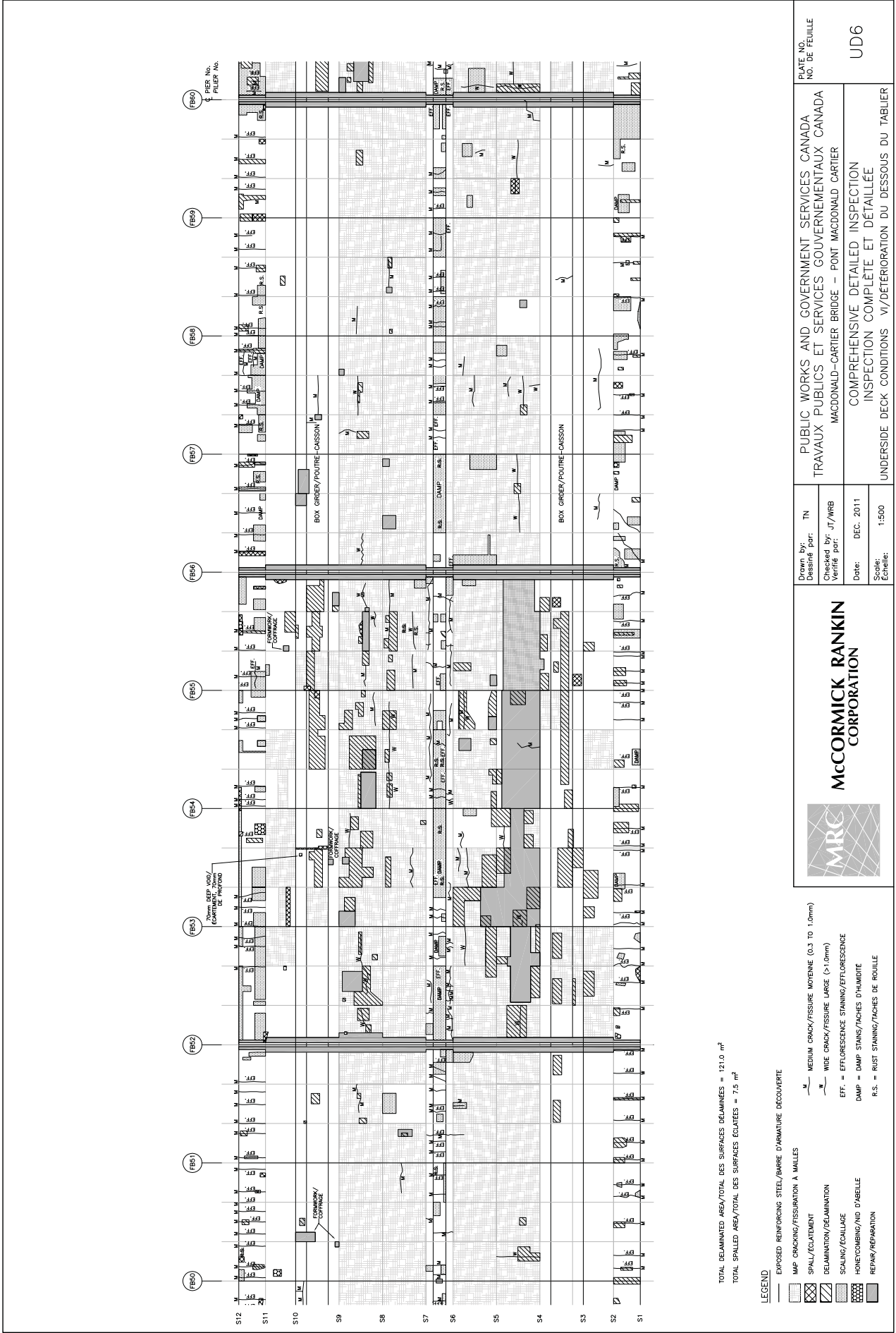

TOTAL DELAMINATED AREA/TOTAL DES SURFACES DÉLAMINÉES = 121.0 m²
TOTAL SPALLED AREA/TOTAL DES SURFACES ÉCLAIÉES = 7.5 m²

- LEGEND
- EXPOSED REINFORCING STEEL/BARRE D'ARMATURE DÉCOUVERTE
 - MAP CRACKING/FISSURATION À MAILLES
 - SPALL/ÉCLAIEMENT
 - DELAMINATION/DÉLAMINATION
 - SCALING/ÉCAILLAGE
 - HONEYCOMBING/NOY D'ÉBÈLE
 - REPAIR/RÉPARATION

- MEDIUM CRACK/FISSURE MOYENNE (0.3 TO 1.0mm)
- WIDE CRACK/FISSURE LARGE (>1.0mm)
- EFF = EFFLORESCENCE STAINING/EFFLORESCENCE
- DAMP = DAMP STAINS/TACHES D'HUMIDITÉ
- R.S. = RUST STAINING/TACHES DE ROUILLE



MCCORMICK RANKIN CORPORATION

Drawn by: TN
Drawing for:
Checked by: JT/WRB
Verified by:
Date: DEC. 2011
Scale: 1:500
Echelle:

PUBLIC WORKS AND GOVERNMENT SERVICES CANADA
TRAVAUX PUBLICS ET SERVICES GOUVERNEMENTAUX CANADA
MACDONALD-CARTIER BRIDGE - PONT MACDONALD CARTIER
COMPREHENSIVE DETAILED INSPECTION
INSPECTION COMPLÈTE ET DÉTAILLÉE
UNDERSIDE DECK CONDITIONS V/DÉTÉRIORATION DU DESSOUS DU TABLIER

PLATE NO.
NO. DE FEUILLE
UD6

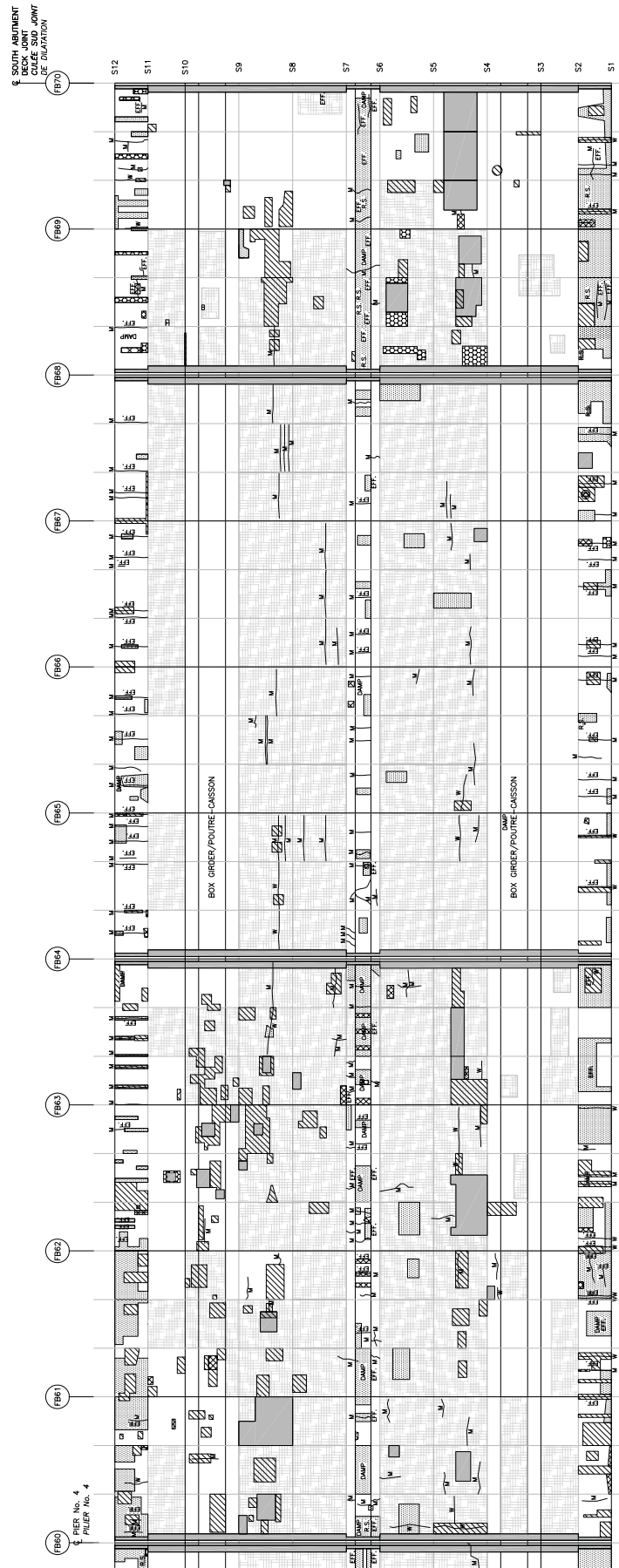

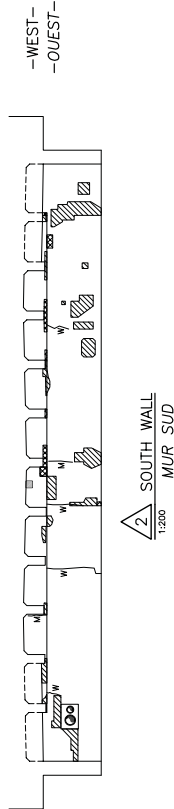
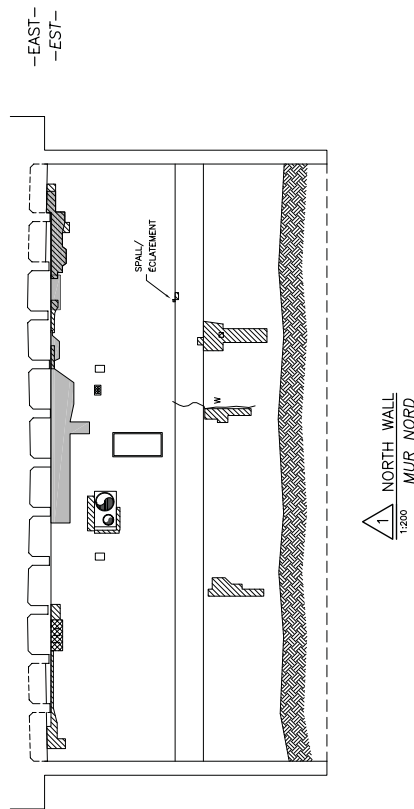
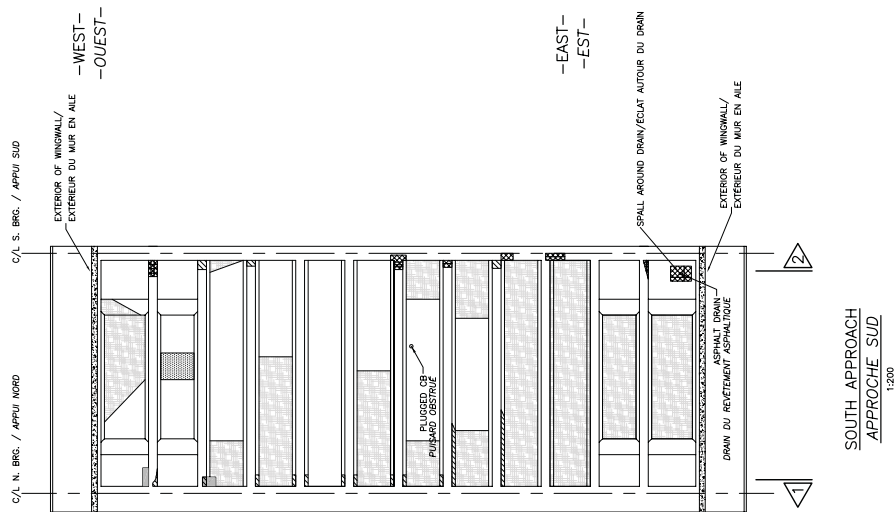

TOTAL SPALLED AREA/TOTAL DES SURFACES ÉCLATÉES = 3 m²
TOTAL DELAMINATED AREA/TOTAL DES SURFACES DÉLAMINÉES = 17 m²

- LEGEND**
- | | |
|--|---|
| | EXPOSED REINFORCING STEEL/BARRE D'ARMATURE DÉCOUVERTE |
| | SPLIT/DELAMENT |
| | DELAMINATION/DELAMINATION |
| | SCALING/ÉCALAGE |
| | HONEYCOMBING/VID D'ÉCELLE |
| | REPAIR/REPARATION |
| | MAP. CRACKING/FISSURATION À MAILLES |
| | MEDIUM CRACK/FISSURE MOTENNE (0.3 to 1.0mm) |
| | WIDE CRACK/FISSURE LARGE (>1.0mm) |

 McCORMICK RANKIN CORPORATION	Drawn by: _____ Dessiné par: _____ Checked by: JT/WRB Vérifié par: _____	TN Date: DEC. 2011 Scale: 1:200 Echelle: _____	PUBLIC WORKS AND GOVERNMENT SERVICES CANADA TRAVAUX PUBLICS ET SERVICES GOUVERNEMENTAUX CANADA MACDONALD CARTIER BRIDGE - PONT MACDONALD CARTIER COMPREHENSIVE DETAILED INSPECTION INSPECTION COMPLETE ET DÉTAILLÉE U/S DECK AT SOUTH APPROACH / DESSOUS DU TABLIER À L'APPROCHE SUD	PLATE NO. NO. DE FEUILLE
				UD8

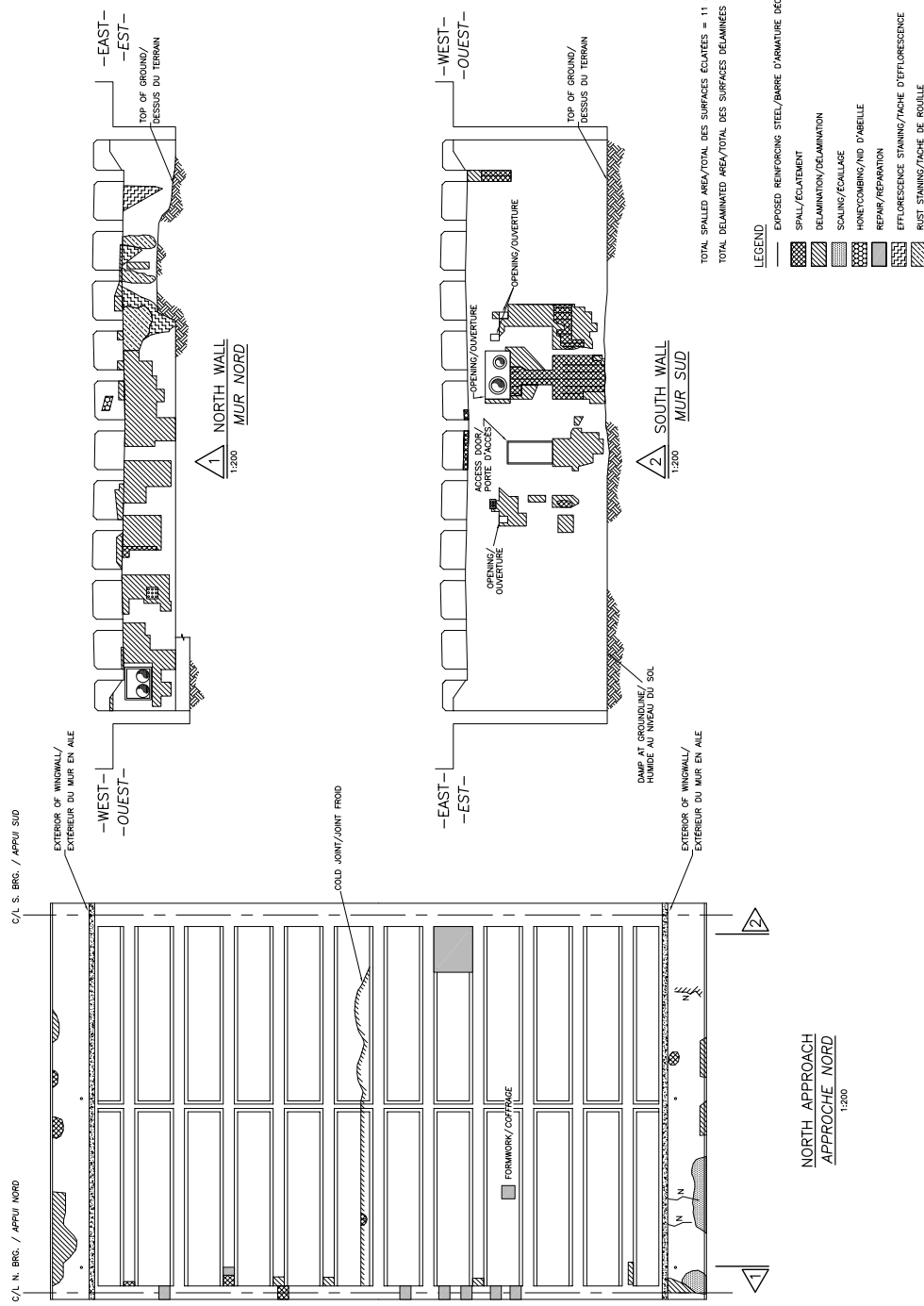

**MCCORMICK RANKIN
CORPORATION**

Drawn by: TN
Designé par:
Checked by: JT/WRB
Vérifié par:
Date: DEC. 2011
Scale: 1:200
Échelle:

PUBLIC WORKS AND GOVERNMENT SERVICES CANADA
TRAVAUX PUBLICS ET SERVICES GOUVERNEMENTAUX CANADA
MACDONALD CARTIER BRIDGE - PONT MACDONALD CARTIER
COMPREHENSIVE DETAILED INSPECTION
INSPECTION COMPLÈTE ET DÉTAILLÉE
U/S DECK AT NORTH APPROACH / DESSOUS DU TABLIER À L'APPROCHE NORD

PLATE NO.
NO. DE FEUILLE
UD9