

CLEANING PROFILE

ASC



A.S.C.	AREA
LEVEL 1	14 096 m ²
LEVEL 2	7 683 m ²
LEVEL 3	5 922 m ²
LEVEL 4	1 560 m ²
TOTAL	29 261 m ²

EXTERIOR A.S.C.	AREA
EXTERIOR CLEANING	2 526 m ²
ANTENNA, WATER-TANK ENCLOSURE, ESF	249 m ²
TOTAL	2 775 m ²

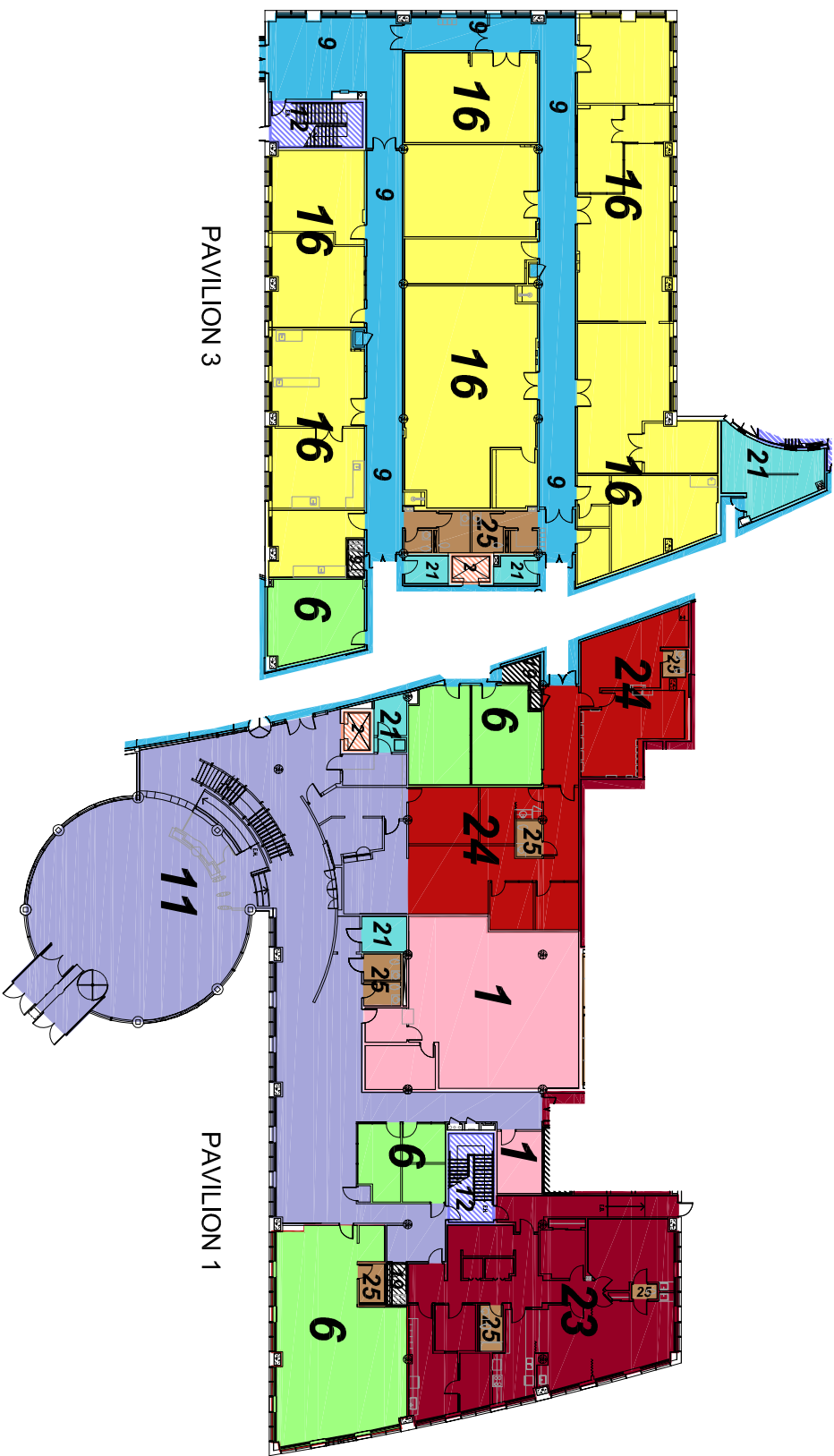

ZONES	AREA
01 ARCHIVES, LIBRARY	154 m ²
02 ELEVATORS	10 m ²
03 CARPENTRY WORKSHOP	--- m ²
04 PROTOTYPE WORKSHOP	--- m ²
05 ANTENNA / WATER-TANK ENCLOSURE / ESP	--- m ²
06 OFFICES	230 m ²
07 CAFETERIA	--- m ²
08 POWER AND HEATING PLANT	--- m ²
09 CORRIDORS	231 m ²
10 COMPUTER ROOM	--- m ²
11 ENTRANCES/ RECEPTION AREA	527 m ²
12 SECONDARY STAIRCASES	36 m ²
13 N.A.	--- m ²
14 GYMNASIUM	--- m ²
15 HIGH BAYS	--- m ²
16 LABORATORIES	703 m ²
17 EXTERIOR CLEANING	--- m ²
18 SHIPPING/ RECEIVING	--- m ²
19 SHEDS	12 m ²
20 COMPACTOR ROOM	--- m ²
21 ELECTRICAL ROOMS	52 m ²
22 EXECUTIVE AREA	--- m ²
23 CONFERENCE ROOM AREA	201 m ²
24 CONTROL/ SECURITY	178 m ²
25 WASHROOMS	51 m ²
TOTAL AREA	2 385 m²

Agence spatiale
 Canadian Space Agency
 Centre spatial John H. Chapman
 6767 route de l'aéroport
 331 8V9

Canadian Space Agency
 Security and Facilities
 John H. Chapman Space Centre
 Tel. (450) 926-4800
 Fax. (450) 926-4894

A.S.C. LEVEL 1

project/projet
CLEANING PROFILE
 No piece/room n°
 PAVILIONS 1 AND 3, LEVEL 1

conçu/dessiné
 M. THÉROUX
 date
 MAI 2013

approuvé/approuvée
 B. HACHÉ
 dernière révision/last updated

1/12

ZONES	AREA
01 ARCHIVES, LIBRARY	180 m ²
02 ELEVATORS	9 m ²
03 CARPENTRY WORKSHOP	78 m ²
04 PROTOTYPE WORKSHOP	452 m ²
05 ANTENNA / WATER-TANK ENCLOSURE / ESP	--- m ²
06 OFFICES	1479 m ²
07 CAFETERIA	--- m ²
08 POWER AND HEATING PLANT	2 m ²
09 CORRIDORS	601 m ²
10 COMPUTER ROOM	339 m ²
11 ENTRANCES/ RECEPTION AREA	--- m ²
12 SECONDARY STAIRCASES	26 m ²
13 DANCARE	--- m ²
14 GYMNASIUM	--- m ²
15 HIGH BAYS	491 m ²
16 LABORATORIES	677 m ²
17 EXTERIOR CLEANING	--- m ²
18 SHIPPING/ RECEIVING	1126 m ²
19 SHEDS	62 m ²
20 COMPACTOR ROOM	49 m ²
21 ELECTRICAL ROOMS	46 m ²
22 EXECUTIVE AREA	--- m ²
23 CONFERENCE ROOM AREA	--- m ²
24 CONTROL SECURITY	--- m ²
25 WASHROOMS	45 m ²
TOTAL AREA	5 662 m ²



Agence spatiale
Canadian Space
Agence
Security and Facilities
Centre spatial John H. Chapman
John H. Chapman Space Centre
 6761, route de l'aéroport
 6761, route de l'aéroport
 351, 819
 Montréal (Québec)
 Tel. (450) 926-4800
 Fax. (450) 926-4894

A.S.C. LEVEL 1

project/project
CLEANING PROFILE
 No piece/room nr
PAVILIONS 2, 8 AND 9 LEVEL 1

conçu/designé
 M. THÉROUX
 date
 MAI 2013
 dernière révision/last updated
 approuvé/approved
 B. HACHE
 échelle
 2/12

ZONES	AREA
01 ARCHIVES, LIBRARY	3.1 m ²
02 ELEVATORS	5 m ²
03 CARPENTRY WORKSHOP	--- m ²
04 PROTOTYPE WORKSHOP	--- m ²
05 ANTENNA / WATER TANK ENCLOSURE / ESP	--- m ²
06 OFFICES	1 177 m ²
07 CAFETERIA	--- m ²
08 POWER AND HEATING PLANT	805 m ²
09 CORRIDORS	49 m ²
10 COMPUTER ROOM	--- m ²
11 ENTRANCES/ RECEPTION AREA	--- m ²
12 SECONDARY STAIRCASES	24 m ²
13 DAYCARE	--- m ²
14 GYMNASIUM	395 m ²
15 HIGH BAYS	--- m ²
16 LABORATOIRES	--- m ²
17 EXTERIOR CLEANING	--- m ²
18 SHIPPING/ RECEIVING	--- m ²
19 SHEDS	91 m ²
20 COMPACTOR ROOM	--- m ²
21 ELECTRICAL ROOMS	254 m ²
22 EXECUTIVE AREA	--- m ²
23 CONFERENCE ROOM AREA	--- m ²
24 CONTROL SECURITY	--- m ²
25 WASHROOMS	51 m ²
TOTAL AREA	2 882m ²

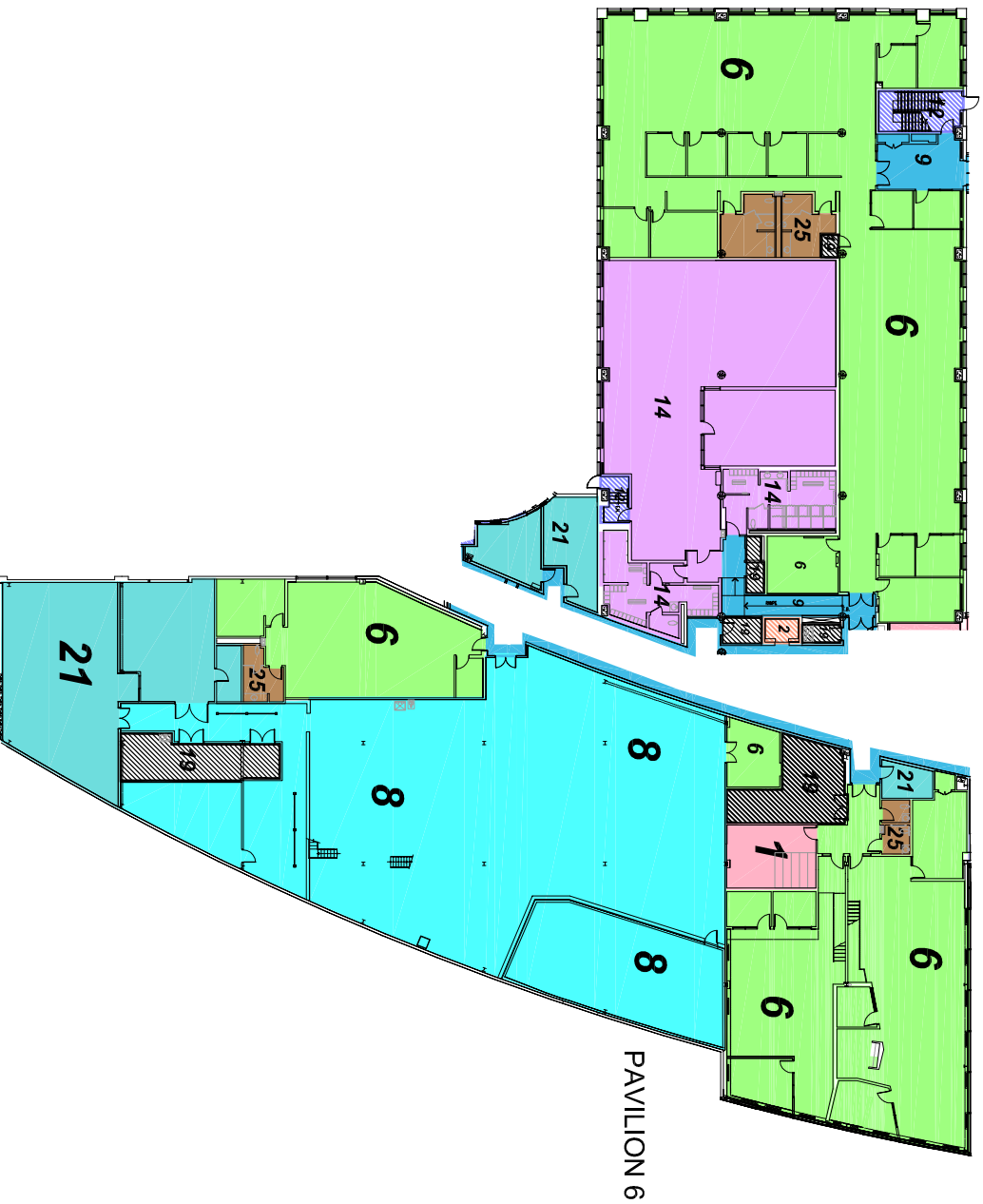

PAVILLON 4

PAVILLON 6

Agence spatiale
 Canadian Space
 Agency
 Sécurité et Installations
 Security and Facilities
 Centre spatial John H. Chapman
 John H. Chapman Space Centre
 6761, route de l'aéroport
 Tel. (450) 926-4800
 3311, route de l'aéroport
 Fax. (450) 926-4894
 331 819

A.S.C. LEVEL 1

project/projet
CLEANING PROFILE
 No pièce/room nr
 PAVILLONS 4 AND 6, LEVEL 1

conçu/designé
 M. THÉROUX
 date
 MAI 2013
 dernière révision/last updated

approuvé/approved
 B. HACHÉ
 échelle

3 / 12

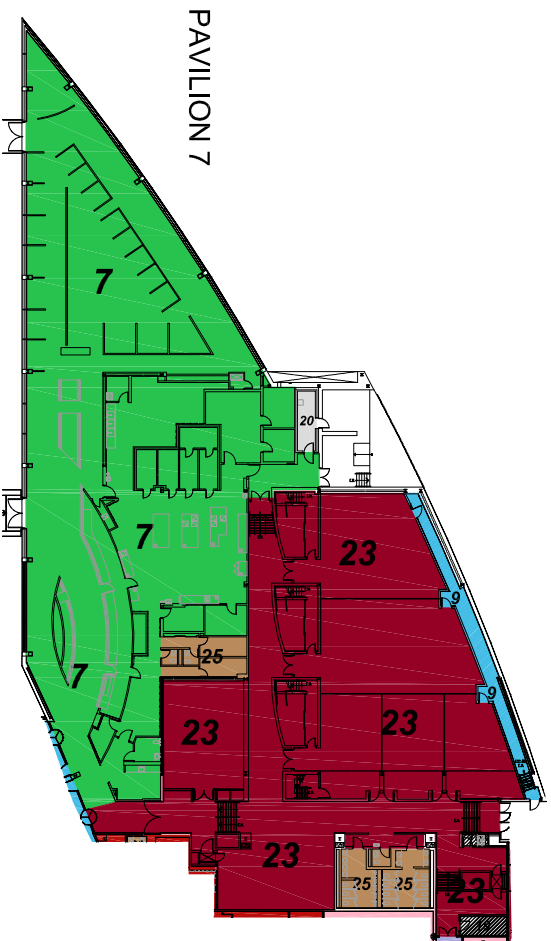
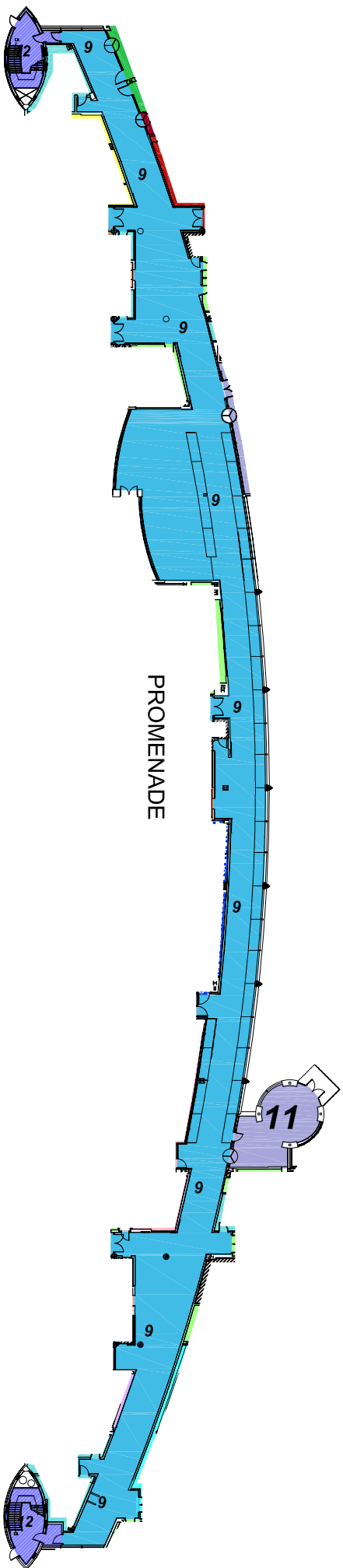

PAVILION 5

ZONES	AREA	ZONES	AREA
01 ARCHIVES, LIBRARY	— m ²	14 GYMNASIUM	— m ²
02 ELEVATORS	— m ²	15 HIGH BAYS	— m ²
03 CARPENTRY WORKSHOP	— m ²	16 LABORATORIES	— m ²
04 PROTOTYPE WORKSHOP	— m ²	17 EXTERIOR CLEANING	— m ²
05 ANTENNA / WATER-TANK ENCLOSURE / ESF	— m ²	18 SHIPPING RECEIVING	— m ²
06 OFFICES	— m ²	19 SHEDS	11 m ²
07 CAFETERIA	1 126 m ²	20 COMPACTOR ROOM	10 m ²
08 POWER AND HEATING PLANT	— m ²	21 ELECTRICAL ROOMS	— m ²
09 CORRIDORS	877 m ²	22 EXECUTIVE AREA	— m ²
10 COMPUTER ROOM	— m ²	23 CONFERENCE ROOM AREA	989 m ²
11 ENTRANCES/ RECEPTION AREA	52 m ²	24 CONTRÔLE / SECURITY	— m ²
12 SECONDARY STAIRCASES	53 m ²	25 WASHROOMS	79 m ²
13 DAYCARE	— m ²	TOTAL AREA	3 167 m ²

CLEANING PROFILE

projet/projet
No pièce/room nr
PAV. 5, 7 AND PROMENADE LEVEL 1

conçu/designé
M. THÉROUX
date
MAY 2013
dernière révision/last updated

approuvé/approved
B. HACHÉ
échelle

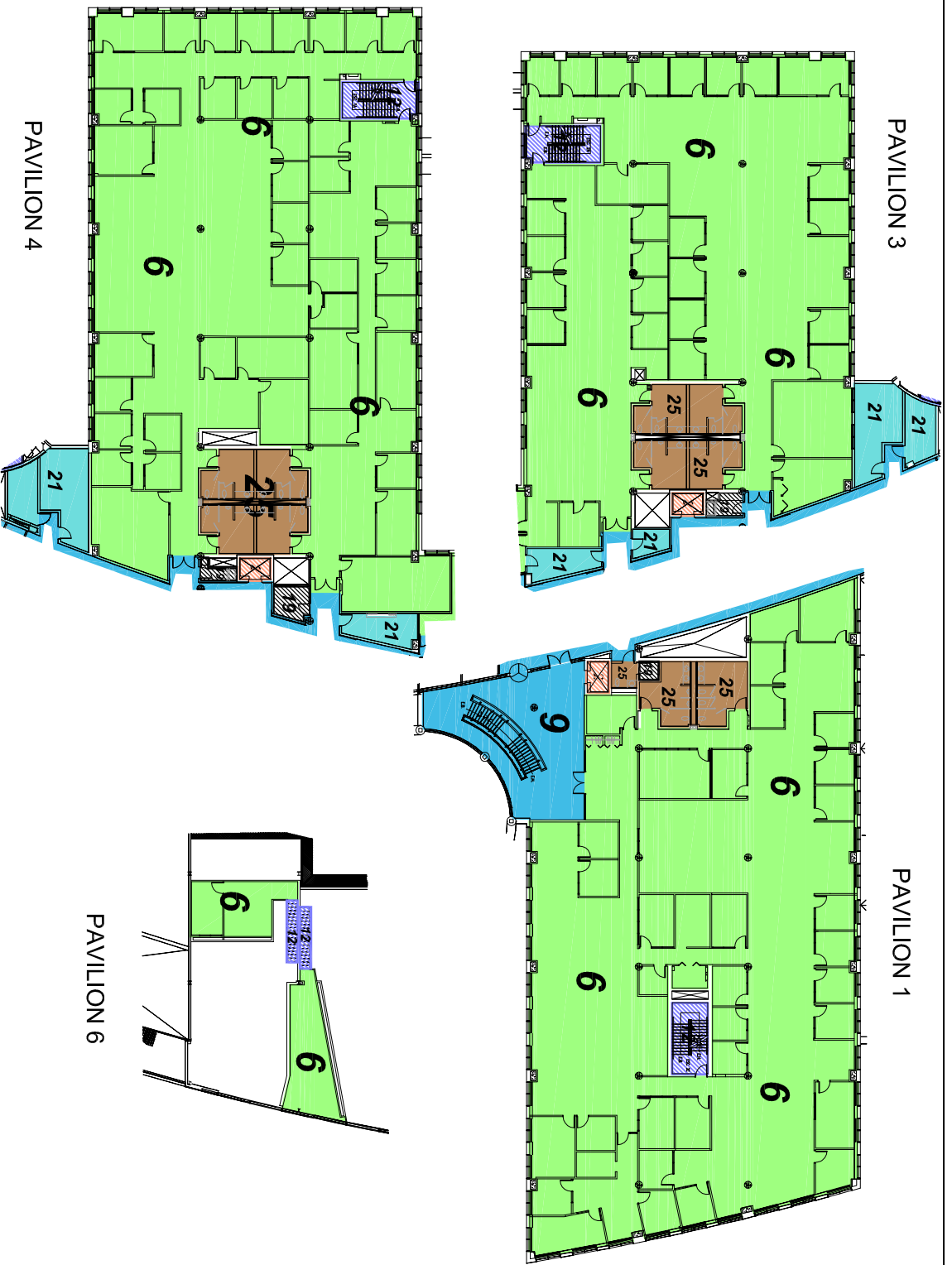

ZONES	AREA
01 ARCHIVES, LIBRARY	--- m ²
02 ELEVATORS	15 m ²
03 CARPENTRY WORKSHOP	--- m ²
04 PROTOTYPE WORKSHOP	--- m ²
05 ANTENNA / WATER-TANK ENCLOSURE / ESB	--- m ²
06 OFFICES	3 266 m ²
07 CAFETERIA	--- m ²
08 POWER AND HEATING PLANT	--- m ²
09 CORRIDORS	113 m ²
10 COMPUTER ROOM	--- m ²
11 ENTRANCES/ RECEPTION AREA	--- m ²
12 SECONDARY STAIRCASES	63 m ²
13 DAYCARE	--- m ²
14 GYMNASIUM	--- m ²
15 HIGH BAYS	--- m ²
16 LABORATORIES	--- m ²
17 EXTERIOR CLEANING	--- m ²
18 SHIPPING/ RECEIVING	--- m ²
19 SHEDS	21 m ²
20 COMPACTOR ROOM	--- m ²
21 ELECTRICAL ROOMS	114 m ²
22 EXECUTIVE AREA	--- m ²
23 CONFERENCE ROOM AREA	--- m ²
24 CONTROL / SECURITY	--- m ²
25 WASHROOMS	162 m ²
TOTAL AREA	3 754 m ²

Agence spatiale
 Canadienne
 Sécurité et Installations
 Centre spatial John H. Chapman
 6767 route de l'aéroport
 31^e arrondissement (Québec)
 J3L 8Y9

Canadian Space
 Agency
 Security and Facilities
 John H. Chapman Space Centre
 Tel. (450) 926-4800
 Fax. (450) 926-4894

A.S.C. LEVEL 2

project/projet
CLEANING PROFILE
 No pièce/room nr
 PAVILIONS 1, 3, 4 AND 6, LEVEL 2

conçu/designé
 M. THÉROUX
 date
 MAI 2013

approuvé/approuvé
 B. HACHÉ
 dernière révision/last updated

5/12

ZONES	AREA
01 ARCHIVES, LIBRARY	50 m ²
02 ELEVATORS	--- m ²
03 CARPENTRY WORKSHOP	117 m ²
04 PROTOTYPE WORKSHOP	--- m ²
05 ANTENNA / WATER-TANK ENCLOSURE / ESF	--- m ²
06 OFFICES	880 m ²
07 CAFETERIA	30 m ²
08 POWER AND HEATING PLANT	93 m ²
09 CORRIDORS	244 m ²
10 COMPUTER ROOM	208 m ²
11 ENTRANCES/ RECEPTION AREA	--- m ²
12 SECONDARY STAIRCASES	97 m ²
13 DAYCARE	--- m ²
14 GYMNASIUM	--- m ²
15 HIGH BAYS	431 m ²
16 LABORATORIES	37 m ²
17 EXTERIOR CLEANING	--- m ²
18 SHIPPING/ RECEIVING	116 m ²
19 SHEDS	9 m ²
20 COMPACTOR ROOM	--- m ²
21 ELECTRICAL ROOMS	27 m ²
22 EXECUTIVE AREA	--- m ²
23 CONFERENCE ROOM AREA	137 m ²
24 CONTROL SECURITY	719 m ²
25 WASHROOMS	28 m ²
TOTAL AREA	3 220 m ²

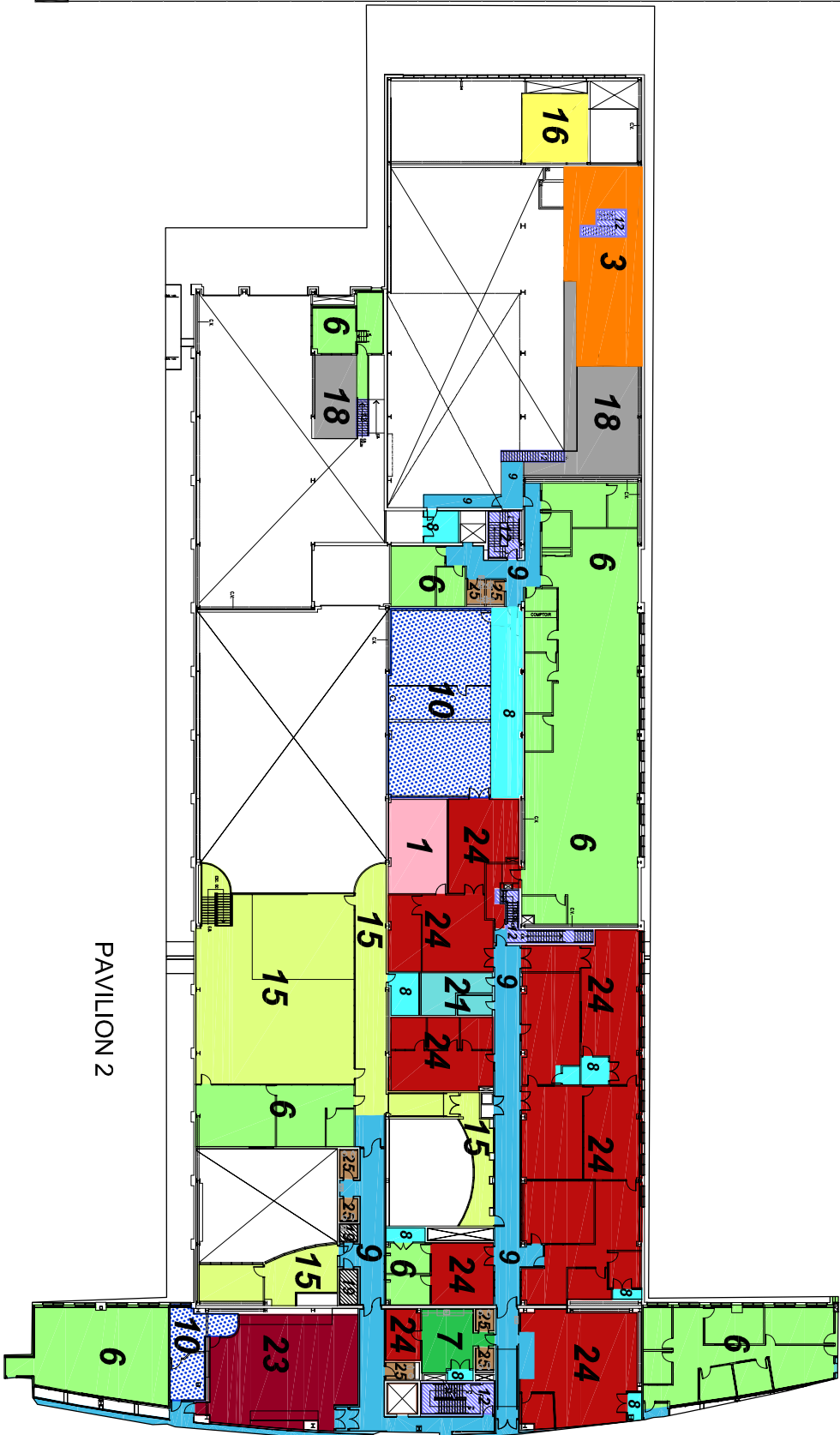

PAVILION 2

Agence spatiale
 Canadienne
 Sécurité et Installations
 Centre spatial John H. Chapman
 6761, route de l'aéroport
 331, boulevard (Québec)

Canadian Space
 Agency
 Security and Facilities
 John H. Chapman Space Centre
 Tel. (450) 926-4800
 Fax. (450) 926-4894

A.S.C. LEVEL 2

project/projct
CLEANING PROFILE
 No pièce/room nr
 PAVILION 2, LEVEL 2

conçu/designé
 M. THÉROUX
 date
 MAI 2013
 dernière révision/last updated

approuvé/approved
 B. HACHE
 échelle
 6/12

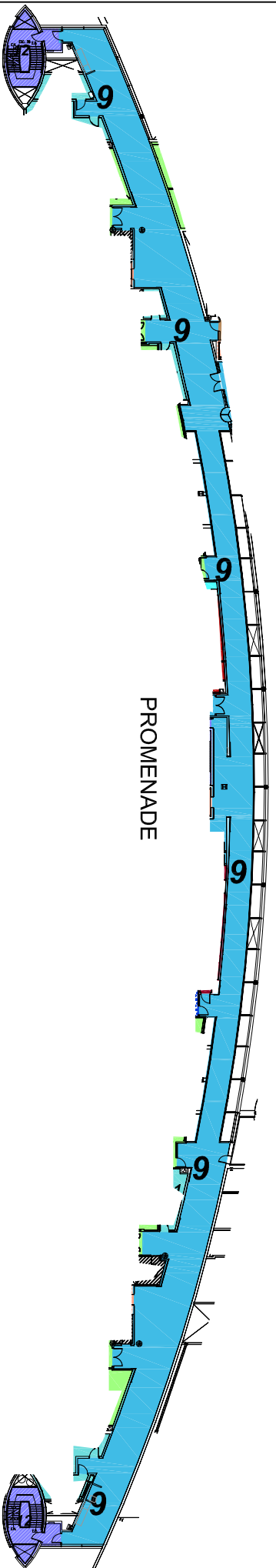

ZONES	AREA	ZONES	AREA
01 ARCHIVES, LIBRARY	--- m ²	14 GYMNASIUM	--- m ²
02 ELEVATORS	--- m ²	15 HIGH BAYS	--- m ²
03 CARPENTRY WORKSHOP	--- m ²	16 LABORATORIES	--- m ²
04 PROTOTYPE WORKSHOP	--- m ²	17 EXTERIOR CLEANING	--- m ²
05 ANTENNA / WATER-TANK ENCLOSURE / ESF	--- m ²	18 SHIPPING/RECEIVING	--- m ²
06 OFFICES	97 m ²	19 SHEDS	--- m ²
07 CAFETERIA	--- m ²	20 COMPACTOR ROOM	--- m ²
08 POWER AND HEATING PLANT	--- m ²	21 ELECTRICAL ROOMS	--- m ²
09 CORRIDORS	564 m ²	22 EXECUTIVE AREA	--- m ²
10 COMPUTER ROOM	--- m ²	23 CONFERENCE ROOM AREA	--- m ²
11 ENTRANCES/ RECEPTION AREA	--- m ²	24 CONTROL SECURITY	--- m ²
12 SECONDARY STAIRCASES	47 m ²	25 WASHROOMS	--- m ²
13 DAYCARE	--- m ²	TOTAL AREA	708 m ²

Agence spatiale
 Canadienne
 Sécurité et Installations
 Centre spatial John H. Chapman
 6767, route de l'aéroport
 3^e étage, Montréal (Québec)
 H3M 1S1

Canadian Space
 Agency
 Security and Facilities
 John H. Chapman Space Centre
 Tel. (450) 926-4800
 Fax. (450) 926-4894

A.S.C. LEVEL 2

projet/projct
CLEANING PROFILE
 No pièce/room nr
PAV. 5 AND PROMENADE LEVEL 2

conçu/designé
 M. THÉROUX
 date
 MAI 2013
 dernière révision/last updated

approuvé/approved
 B. HACHÉ
 échelle

7/12

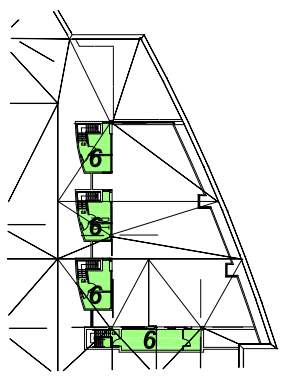

PAVILION 5

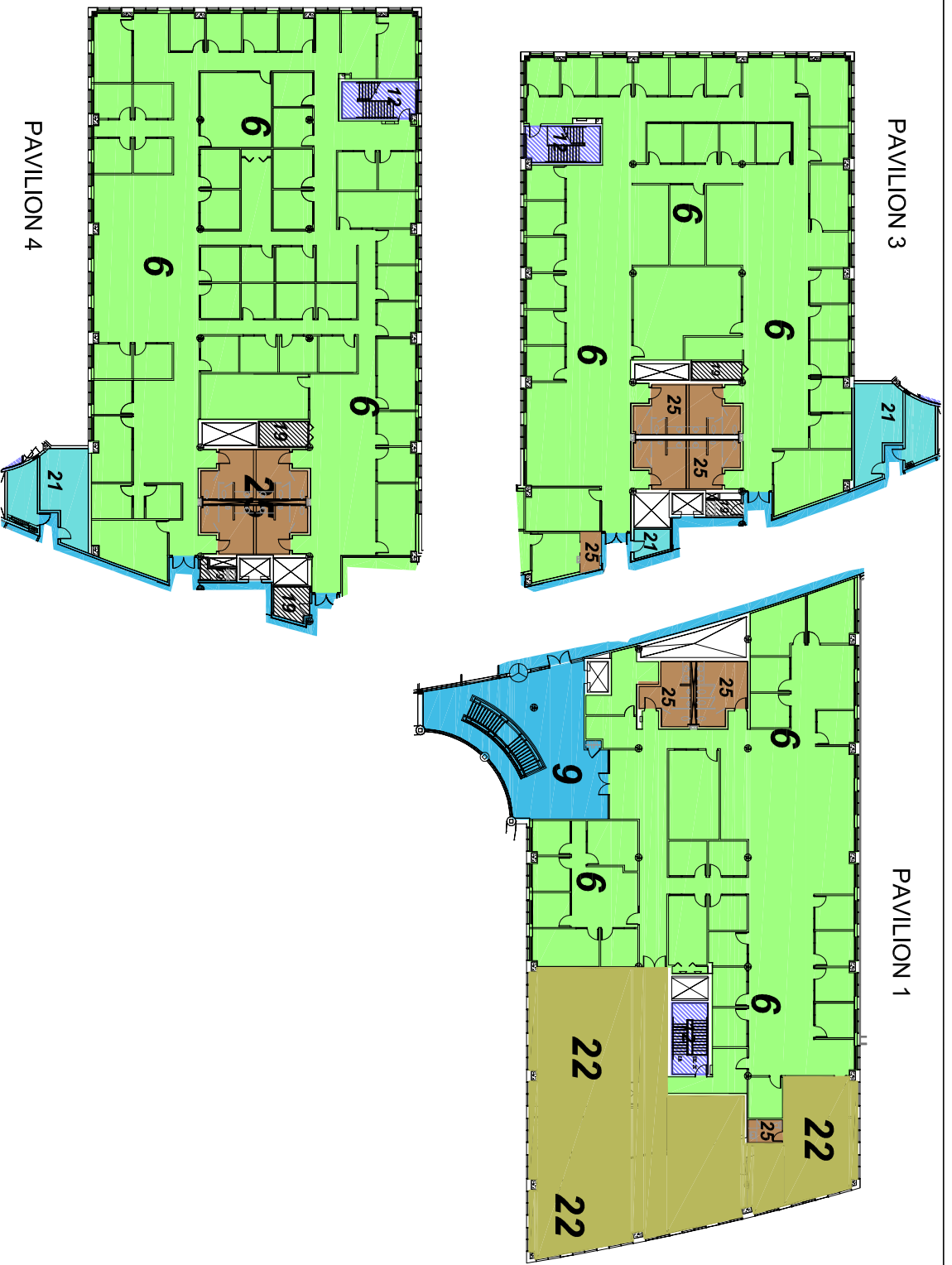

ZONES	AREA
01 ARCHIVES, LIBRARY	--- m ²
02 ELEVATORS	--- m ²
03 CARPENTRY WORKSHOP	--- m ²
04 PROTOTYPE WORKSHOP	--- m ²
05 ANTENNA BUILDING/ WATER-TANK ENCLOSURE	--- m ²
06 OFFICES	2 728 m ²
07 CAFETERIA	--- m ²
08 POWER AND HEATING PLANT	--- m ²
09 CORRIDORS	107 m ²
10 COMPUTER ROOM	--- m ²
11 ENTRANCES/ RECEPTION AREA	--- m ²
12 SECONDARY STAIRCASES	53 m ²
13 DAYCARE	--- m ²
14 GYMNASIUM	--- m ²
15 HIGH BAYS	--- m ²
16 LABORATORIES	--- m ²
17 EXTERIOR CLEANING	--- m ²
18 SHIPPING/ RECEIVING	--- m ²
19 SHEDS	30 m ²
20 COMPACTOR ROOM	--- m ²
21 ELECTRICAL ROOMS	86 m ²
22 EXECUTIVE AREA	409 m ²
23 CONFERENCE ROOM AREA	--- m ²
24 CONTROL/ SECURITY	--- m ²
25 WASHROOMS	155 m ²
TOTAL AREA	3 588 m²

Agence spatiale
 Canadienne
 Sécurité et Installations
 Centre spatial John H. Chapman
 6767, route de l'aéroport
 Miramichi (Québec)
 J3Y 8Y9

Canadian Space
 Agency
 Security and Facilities
 John H. Chapman Space Centre
 Tel: (430) 926-4800
 Fax: (430) 926-4894

A.S.C. LEVEL 3

project/projet
CLEANING PROFILE
 No pièce/room nr
PAVILIONS 1, 3, AND 4 LEVEL 3

conçu/designed
 M. THÉROUX
 date
 AOÛT 2013

approuvé/approved
 B. HACHÉ
 dernière révision/last updated

échelle
 8/12



ZONES	AREA
01 ARCHIVES, LIBRARY	— m²
02 ELEVATORS	— m²
03 CARPENTRY WORKSHOP	— m²
04 PROTOTYPE WORKSHOP	— m²
05 ANTENNA BUILDING/ WATER-TANK ENCLOSURE	— m²
06 OFFICES	830 m²
07 CAFETERIA	— m²
08 POWER AND HEATING PLANT	646 m²
09 CORRIDORS	586 m²
10 COMPUTER ROOM	112 m²
11 ENTRANCES/ RECEPTION AREA	— m²
12 SECONDARY STAIRCASES	89 m²
13 DAYCARE	— m²

ZONES	AREA
14 GYMNASIUM	— m²
15 HIGH BAYS	— m²
16 LABORATOIRES	— m²
17 EXTERIOR CLEANING	— m²
18 SHIPPING/RECEIVING	— m²
19 SHEDS	24 m²
20 COMPACTOR ROOM	— m²
21 ELECTRICAL ROOMS	57 m²
22 EXECUTIVE AREA	— m²
23 CONFERENCE ROOM AREA	— m²
24 CONTROL/SECURITY	— m²
25 WASHROOMS	11 m²
TOTAL AREA	2 354 m²

**Agence spatiale
Canadienne**
Sécurité et Installations
Centre spatial John H. Chapman
6761, route de l'aéroport
3^e étage, bureau 300
Montréal (Québec)
H3T 1B7

**Canadian Space
Agency**
Security and Facilities
John H. Chapman Space Centre
Tel: (450) 926-4800
Fax: (450) 926-4894

A.S.C. LEVEL 3

pro-jkt/pro-ject
CLEANING PROFILE
No pièce/room nr
PAV. 2 AND PROMENADE LEVEL 3

conçu/designé date A.O.U.T. 2013	approuvé/approuvé écrit/e B. HACHE
dernière révision/last updated	
9/12	

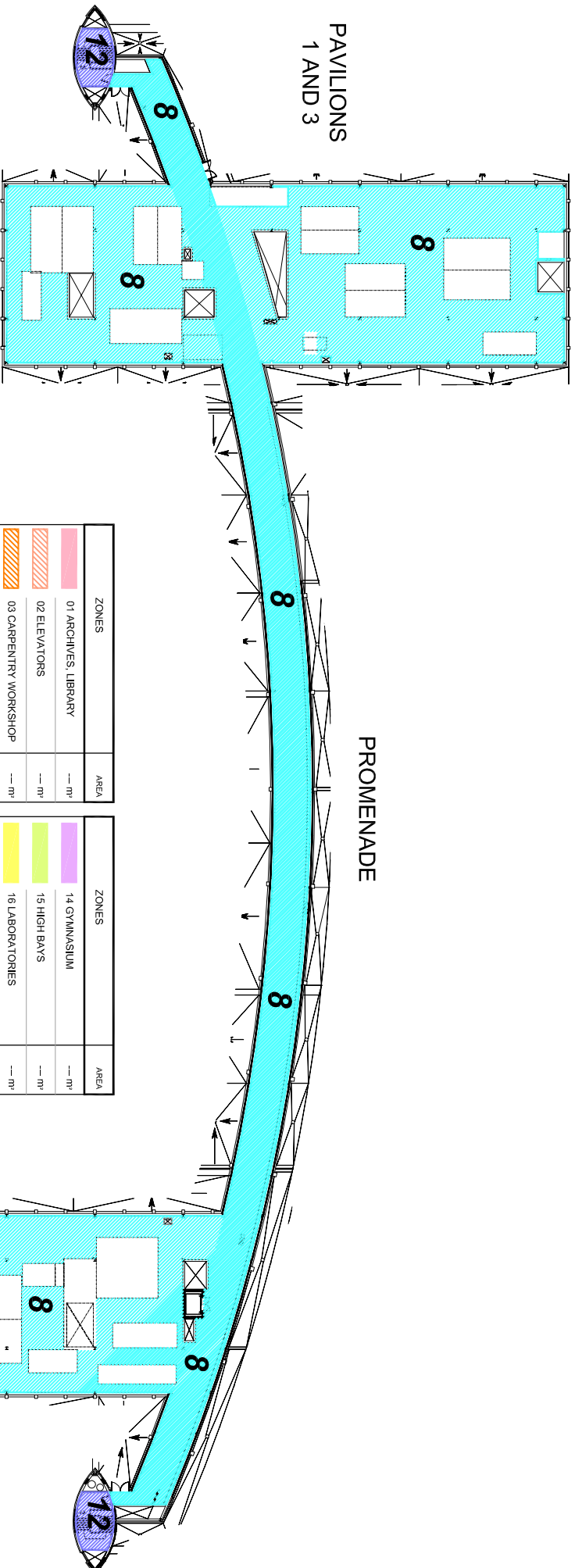

ZONES	AREA
01 ARCHIVES, LIBRARY	--- m ²
02 ELEVATORS	--- m ²
03 CARPENTRY WORKSHOP	--- m ²
04 PROTOTYPE WORKSHOP	--- m ²
05 ANTENNA / WATER-TANK ENCLOSURE / ESF	--- m ²
06 OFFICES	--- m ²
07 CAFETERIA	--- m ²
08 POWER AND HEATING PLANT	1 521 m ²
09 CORRIDORS	--- m ²
10 COMPUTER ROOM	--- m ²
11 ENTRANCES/ RECEPTION AREA	--- m ²
12 SECONDARY STAIRCASES	39 m ²
13 DAYCARE	--- m ²

ZONES	AREA
14 GYMNASIUM	--- m ²
15 HIGH BAYS	--- m ²
16 LABORATORIES	--- m ²
17 EXTERIOR CLEANING	--- m ²
18 SHIPPING/ RECEIVING	--- m ²
19 SHEDS	--- m ²
20 COMPACTOR ROOM	--- m ²
21 ELECTRICAL ROOMS	--- m ²
22 EXECUTIVE AREA	--- m ²
23 CONFERENCE ROOM AREA	--- m ²
24 CONTROL SECURITY	--- m ²
25 WASHROOMS	--- m ²
TOTAL AREA	1 560 m ²

Agence spatiale
 Canadienne
 Sécurité et Installations
 Centre spatial John H. Chapman
 6767, route de l'aéroport
 3^e étage, Montréal (Québec)
 H3T 1B7

Canadian Space
 Agency
 Security and Facilities
 John H. Chapman Space Centre
 Tel. (438) 926-4800
 Fax. (438) 926-4894

A.S.C. LEVEL 4

CLEANING PROFILE

No pièce/room nr
PAV. 1, 3, 4 AND DORSAL LEVEL 4

conçu/designé date dernière révision/last updated	approuvé/approved écrite
M. THÉROUX MAI 2013	B. HACHÉ

10/12

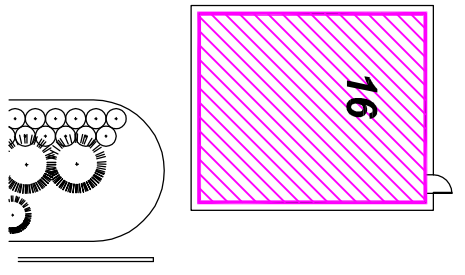
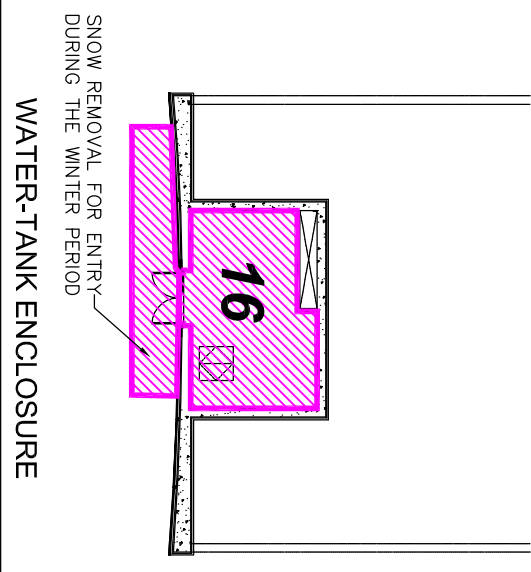
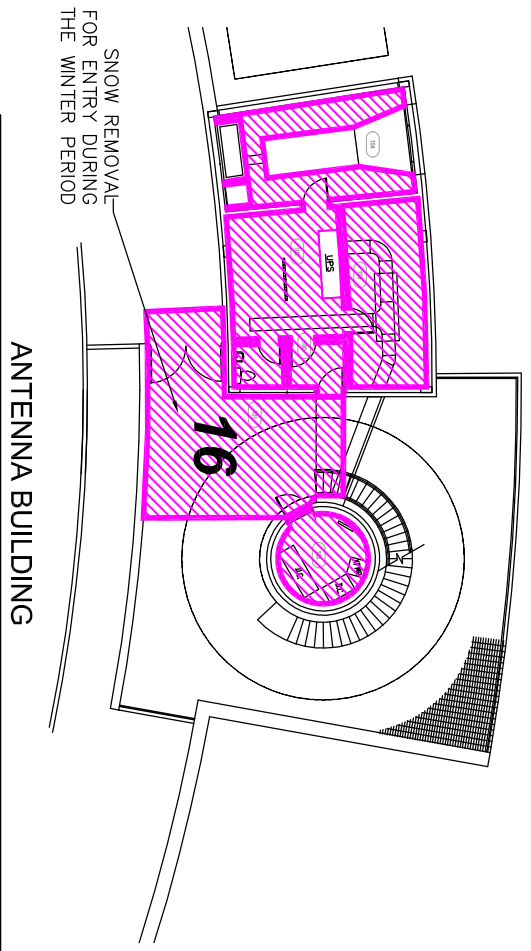

ZONES	AREA
01 ARCHIVES, LIBRARY	--- m ²
02 ELEVATORS	--- m ²
03 CARPENTRY WORKSHOP	--- m ²
04 PROTOTYPE WORKSHOP	--- m ²
05 ANTENNA / WATER-TANK ENCLOSURE / ESF	249 m ²
06 OFFICES	--- m ²
07 CAFE/TERIA	--- m ²
08 POWER AND HEATING PLANT	--- m ²
09 CORRIDORS	--- m ²
10 COMPUTER ROOM	--- m ²
11 ENTRANCES/ RECEPTION AREA	--- m ²
12 SECONDARY STAIRCASES	--- m ²
13 DAYCARE	--- m ²
14 GYMNASIUM	--- m ²
15 HIGH BAYS	--- m ²
16 LABORATORIES	--- m ²
17 EXTERIOR CLEANING	--- m ²
18 SHIPPING/ RECEIVING	--- m ²
19 SHEDS	--- m ²
20 COMPACTOR ROOM	--- m ²
21 ELECTRICAL ROOMS	--- m ²
22 EXECUTIVE AREA	--- m ²
23 CONFERENCE ROOM AREA	--- m ²
24 CONTROL/ SECURITY	--- m ²
25 WASHROOMS	--- m ²
TOTAL AREA	249 m²

Agence spatiale
 Canadian Space
Agence
 Agency
 Sécurité et Installations
 Security and Facilities
 Centre spatial John H. Chapman
 John H. Chapman Space Centre
 6767, route de l'aéroport
 Tel. (430) 926-4800
 331, route de l'aéroport (Québec)
 Fax. (430) 926-4834
 J3L 8Y9

**A.S.C. ANTENNA BUILDING/
 WATER-TANK ENCLOSURE**

projet/projct
CLEANING PROFILE
 pièce/pièce nr
 ANTENNA BUILDING/WATER-TANK ENCLOSURE

conçu/dessiné
 M. THÉROUX
 date
 MAI 2013
 dernière révision/cost updated
 E. HACHÉ
 schéme
 11/12

A.S.C. EXTERIOR

projet/proj.ect
 No pièce/room nr
CLEANING PROFILE
 EXTERIOR CLEANING

conçu/designé
 M. THÉROUX
 date
 MAI 2013
 dernière révision/last updated
 ECHÉLLE
 B. HACHÉ
 12/12

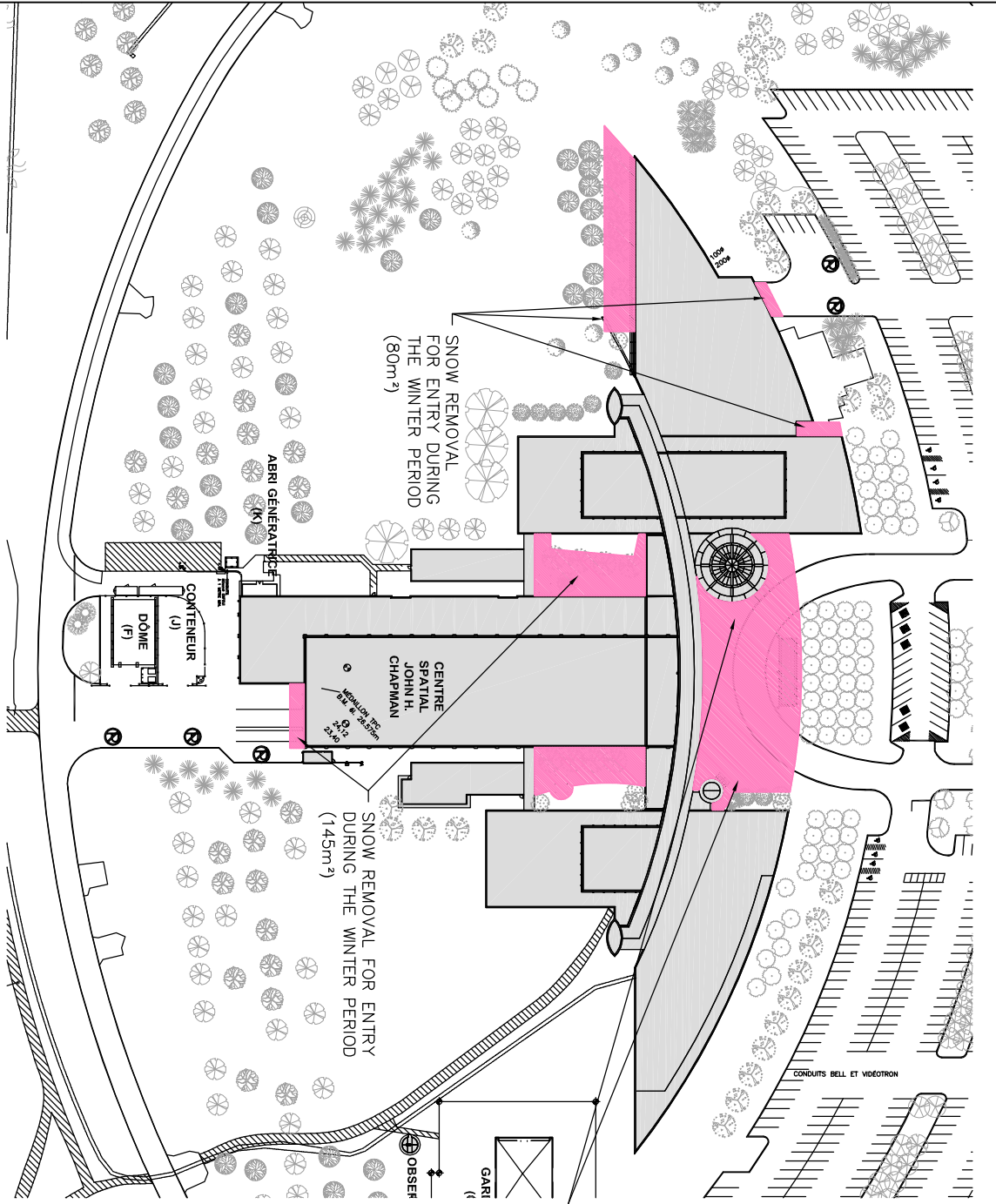

ZONES	AREA
01 ARCHIVES, LIBRARY	--- m²
02 ELEVATORS	--- m²
03 CARPENTRY WORKSHOP	--- m²
04 PROTOTYPE WORKSHOP	--- m²
05 ANTENNA / WATER TANK ENCLOSURE / ESH	--- m²
06 OFFICES	--- m²
07 CAFETERIA	--- m²
08 POWER AND HEATING PLANT	--- m²
09 CORRIDORS	--- m²
10 COMPUTER ROOM	--- m²
11 ENTRANCES/ RECEPTION AREA	--- m²
12 SECONDARY STAIRCASES	--- m²
13 DAYCARE	--- m²
14 GYMNASIUM	--- m²
15 HIGH BAYS	--- m²
16 LABORATORIES	--- m²
17 EXTERIOR CLEANING	2 526 m²
18 SHIPPING/ RECEIVING	--- m²
19 SHEDS	--- m²
20 COMPACTOR ROOM	--- m²
21 ELECTRICAL ROOMS	--- m²
22 EXECUTIVE AREA	--- m²
23 CONFERENCE ROOM AREA	--- m²
24 CONTROL SECURITY	--- m²
25 WASHROOMS	--- m²
TOTAL AREA	2 526 m²