

Project
Location

Kent Institution

Location Plan

General Notes

1. EXISTING COOLER AT Q105 TO BE REMOVED & DISPOSED OF. INSTALL -1° WALK-IN FREEZER (13.0 SQM USABLE SPACE).
2. CONFIRM ALL DIMENSIONS ON SITE BEFORE ORDER WALK-IN UNIT.
3. DECOMMISSION, DISASSEMBLE AND REMOVE EXISTING WALK-IN UNIT (ROOM Q105) AND REFRIGERATION SYSTEM.
4. MAKE GOOD AREA TO ACCEPT NEW WALK-IN UNIT.
5. INSTALL & COMMISSION NEW WALK-IN & REFRIGERATION SYSTEM.
6. WALK-IN UNIT COMES WITH INTEGRAL FLOORS. CONTRACTOR TO MAKE LEVEL EXISTING CONCRETE FLOOR UNDER WALK-IN BOX
7. EXISTING COOLER SHELVING/DUNNAGE RACKS TO BE POWER WASHED & REUSED.
8. CONDENSER FOR WALK-IN UNIT IS LOCATED ONE FLOOR ABOVE THE UNIT. REPLACE EXISTING WITH NEW.
9. COOLER HEIGHT TO MATCH EXISTING.

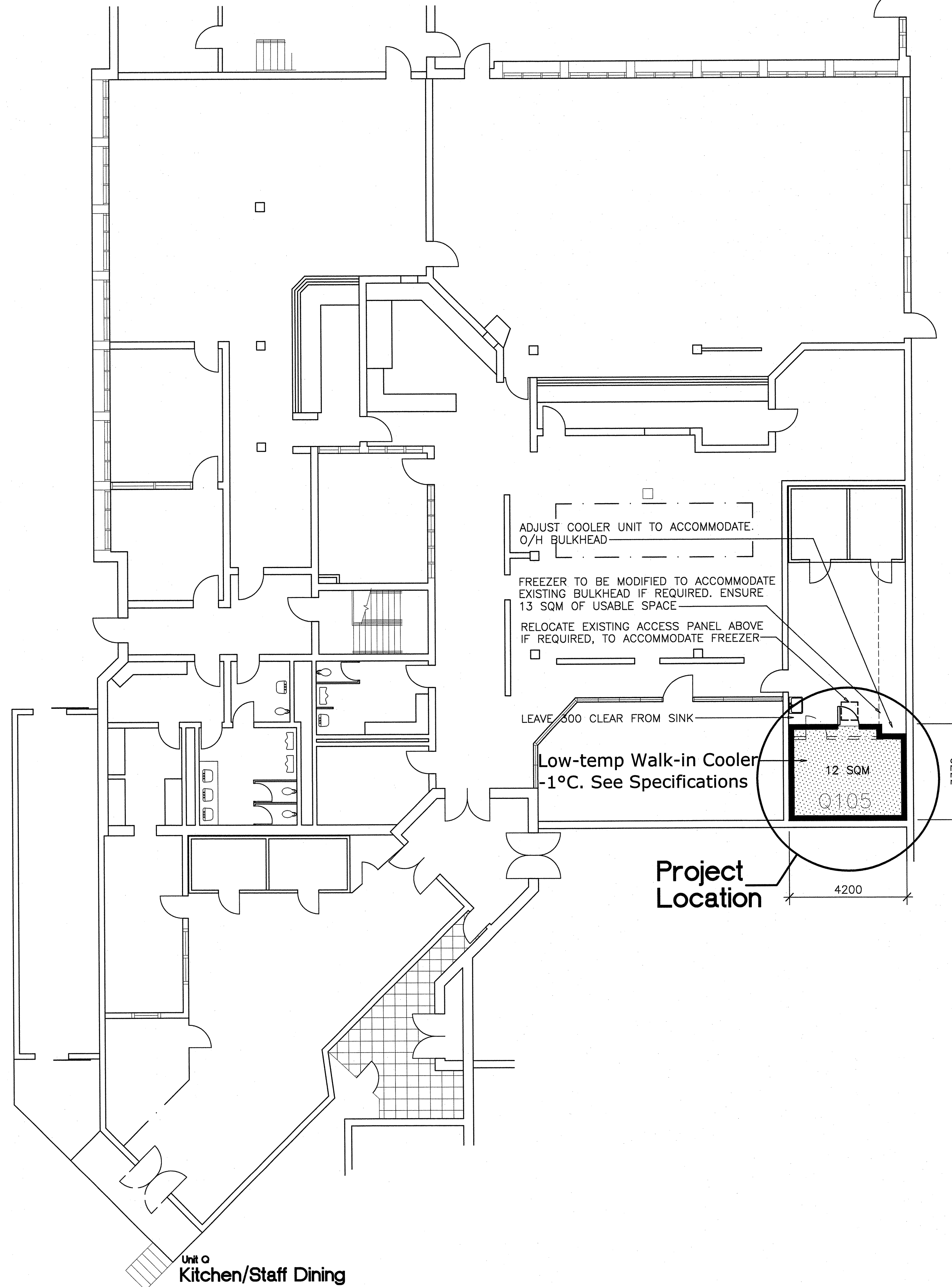

Unit Q
Kitchen/Staff Dining
Existing
Main Floor Plan

Revision/ Révision	Description/Description	Date/Date
Client/client		
Correction Service Canada Various Institutions		
Project title/Titre du projet		
Agassiz BC Kent Institution Finishing Kitchen		
Consultant Signature Only		
Designed by/Concept par D. Burns		
Drawn by/Dessiné par D. Burns February 2014		
PWSC Project Manager/Administrateur de Projets TPSGC S. Leslie		
Regional Manager, Architectural and Engineering Services Gestionnaire régionale, Services d'architecture et de génie, TPSGC		
Drawing title/Titre du dessin		
Kent Institution Location Plan Existing Main Floor Plan		
Project No./No. du projet	Sheet/Feuille La	Revision no./ La Révision no.
R.067189.001	A2	