

LEGEND

- EX. EDGE OF ASPHALT
- PROP. EDGE OF ASPHALT
- - - EX. EDGE OF GRAVEL
- - - PROP. EDGE OF GRAVEL
- ~ EX. TREE LINE
- ~ PROP. TREE LINE
- EX. OVERHEAD WIRE
- - - PROP. OVERHEAD WIRE
- SILT FENCE
- 20.00 — EX. CONTOUR
- 27.00 FINISHED GRADE ELEVATION
- - - EX. ROAD CENTRE LINE
- - - EX. CL. OF DITCH
- ~ TOP OF SLOPE
- ~ TOP OF BANK
- - - PROP. WATER
- - - PROP. SANITARY
- CONCRETE
- HEAVY DUTY ASPHALT
- STANDARD DUTY ASPHALT
- CLEARING AND GRUBBING

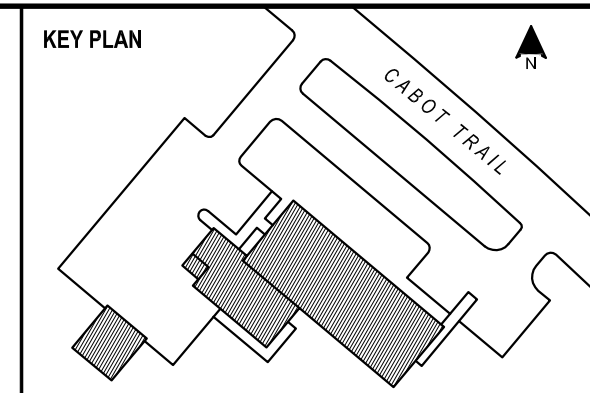

- NOTES:**
1. CONTOUR INTERVALS ARE 0.5m.
 2. FOR GEOTECHNICAL AND TEST PIT INFORMATION, REFER TO THE REPORT BY BGC ENGINEERING INC., DATED JUNE, 2014, IN SPECIFICATION.
 3. CONTRACTOR TO ERECT 1.82M TEMPORARY WORKSITE SECURITY FENCING LIMITING UNAUTHORIZED ACCESS TO PROJECT SITE BEFORE PERFORMING ANY WORK. EXTENTS OF FENCING TO BE ADJUSTED AS REQUIRED TO SUIT THE EXTENT OF THE WORK BEING PERFORMED. IN ADDITION, PROVIDE SECURE, RIGID GUARD RAILS AND BARRICADES AROUND DEEP EXCAVATIONS AND OPEN HAZARDS.
 4. ALL TOPOGRAPHIC INFORMATION PROVIDED BY C. J. MACLELLAN & ASSOCIATES INC., CARRIED OUT IN MAY 2014.
 5. ALL SURVEY INFORMATION REFERENCES NSCM 15650; AT577
N: 5174503.738
E: 4587131.674
ELEV: 46.781

AREA OF POTENTIAL UNSUITABLE MATERIAL REQUIRING REMOVAL. MINIMUM OF 5 TEST EXCAVATIONS TO BE CONDUCTED AT BOUNDARY CORNERS AND CENTER TO A DEPTH OF 3.5m TO IDENTIFY LATERAL AND VERTICAL EXTEND OF UNSUITABLE MATERIALS. REFER TO GEOTECHNICAL REPORT INCLUDED WITH SPECIFICATION. REFER TO DRAWINGS 101 FOR LOCATION RELATIVE TO SITE/BUILDING LAYOUT.

C01	ISSUED FOR TENDER	18 JUL 2014
NO.	REVISION	DATE

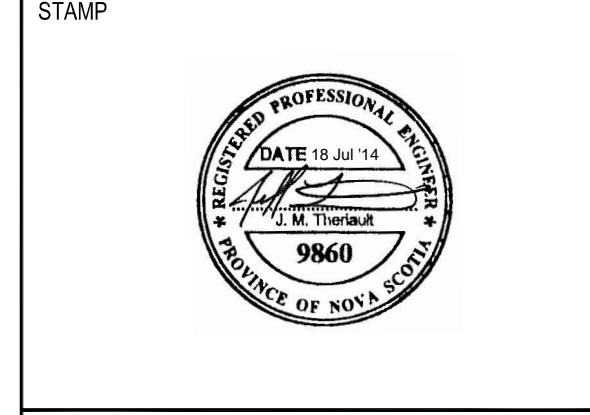

INGONISH CIVIC BUILDING

Project Address

DSRA JOB #: 12169

DRAWN BY: B.C.

CHECKED BY: J.T.

SCALE: AS INDICATED

EXISTING CONDITIONS AND REMOVALS PLAN



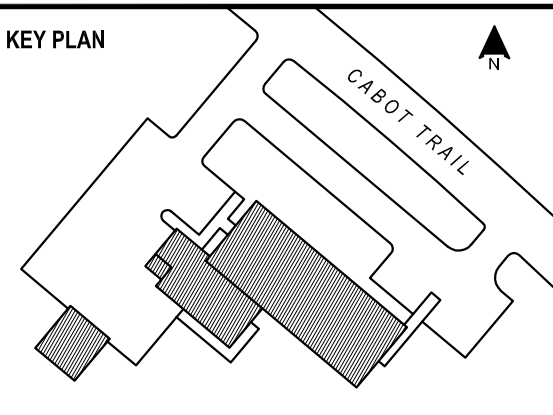
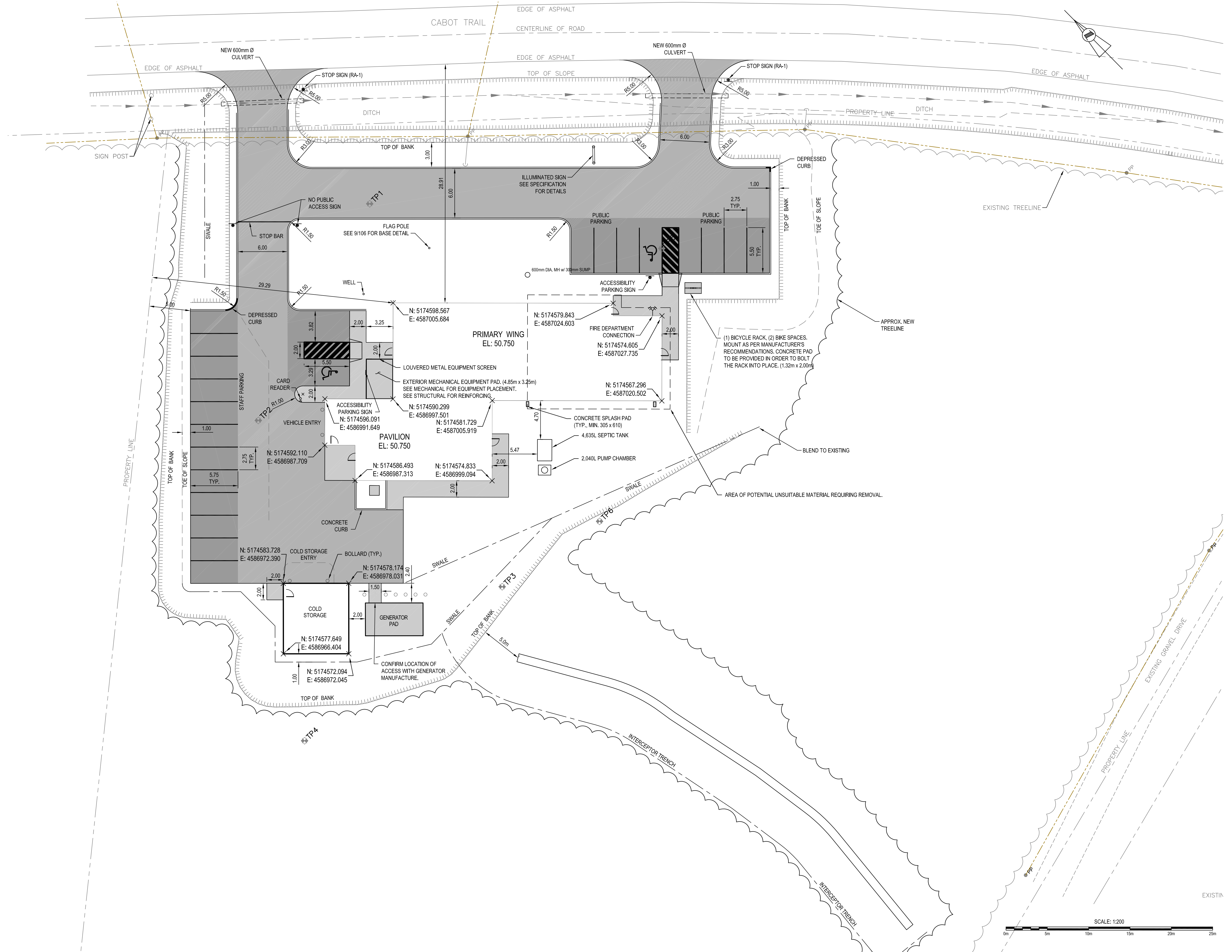

SNC-LAVALIN
 SNC-LAVALIN Inc.
 Halifax, Nova Scotia, Canada
 ISO 9001 Member of the SNC-LAVALIN Group

- NOTES:**
- FOR LEGEND SEE DRAWING 100.
 - CONTRACTOR TO ERECT 1.82M TEMPORARY WORKSITE SECURITY FENCING LIMITING UNAUTHORIZED ACCESS TO PROJECT SITE BEFORE PERFORMING ANY WORK. EXTENTS OF FENCING TO BE ADJUSTED AS REQUIRED TO SUIT THE EXTENT OF THE WORK BEING PERFORMED. IN ADDITION, PROVIDE SECURE, RIGID GUARD RAILS AND BARRICADES AROUND DEEP EXCAVATIONS AND OPEN HAZARDS.
 - REFER TO DRAWING 110 FOR LANDSCAPING REQUIREMENTS

C01	ISSUED FOR TENDER	18 JUL 2014
NO.	REVISION	DATE

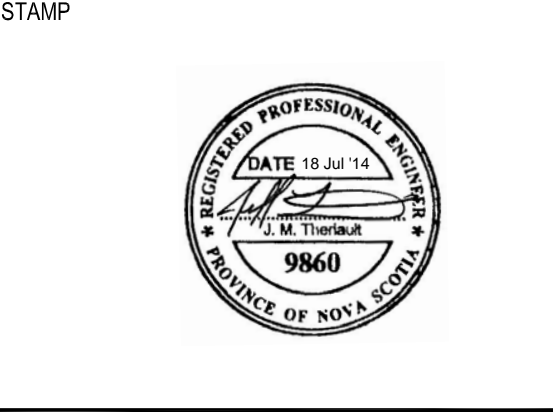

INGONISH CIVIC BUILDING
 Project Address
 DSRA JOB #: 12169
 DRAWN BY: B.C.
 CHECKED BY: J.T.
 SCALE: AS INDICATED

SITE PLAN
 101

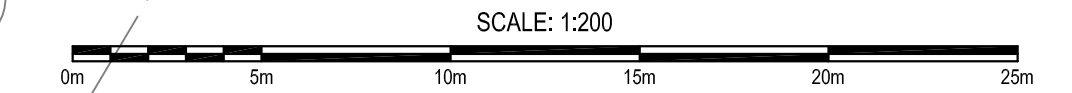

03/14/14 11:30:28 AM

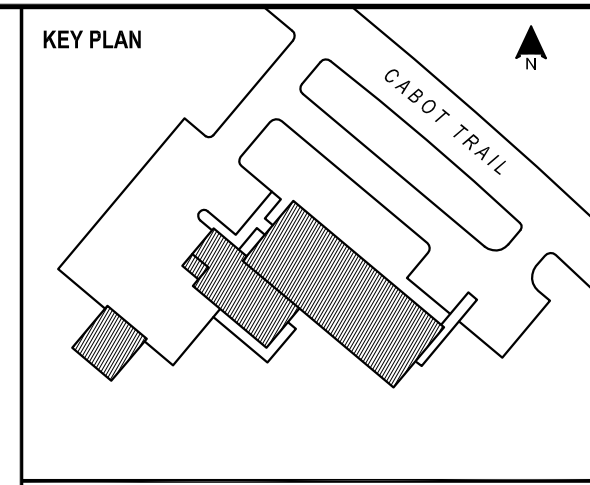
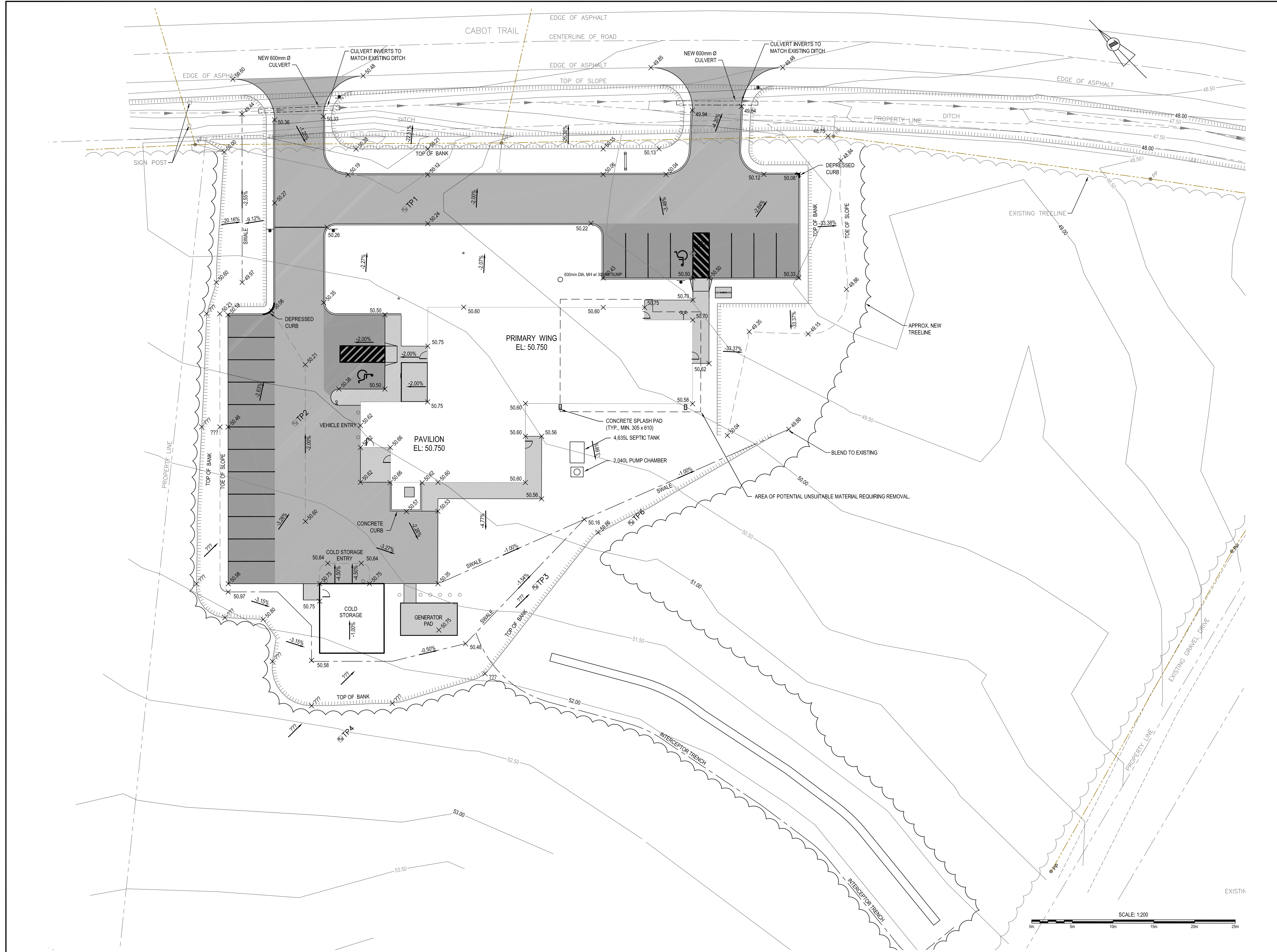

- NOTES:
- FOR LEGEND SEE DRAWING 100.
 - CONTOUR INTERVALS ARE 0.50m.
 - ALL TOPOGRAPHIC INFORMATION PROVIDED BY C. J. MACLELLAN & ASSOCIATES INC., CARRIED OUT IN MAY 2014.
 - ALL SURVEY INFORMATION REFERENCES NSCM 15650; AT577 N: 5174503.738 E: 4587131.674 ELEV: 46.781

C01	ISSUED FOR TENDER	18 JUL 2014
NO.	REVISION	DATE

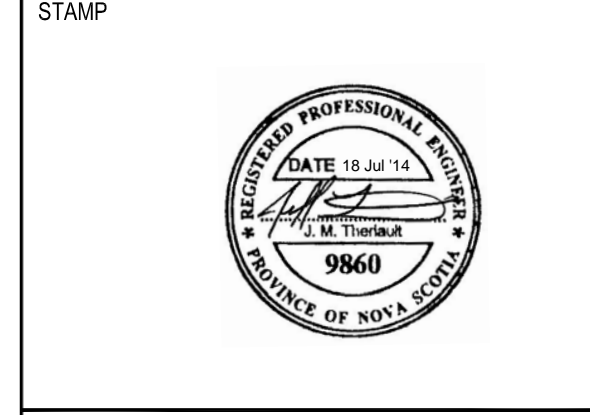

INGONISH CIVIC BUILDING	
Project Address	
DSRA JOB #:	12169
DRAWN BY:	B.C.
CHECKED BY:	J.T.
SCALE:	AS INDICATED

SITE GRADING PLAN

102

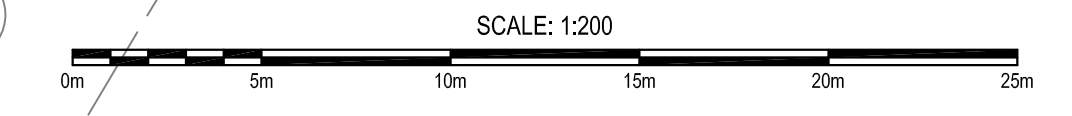

6/25/2014 10:00 AM C:\Users\jct\Documents\102\102.dwg

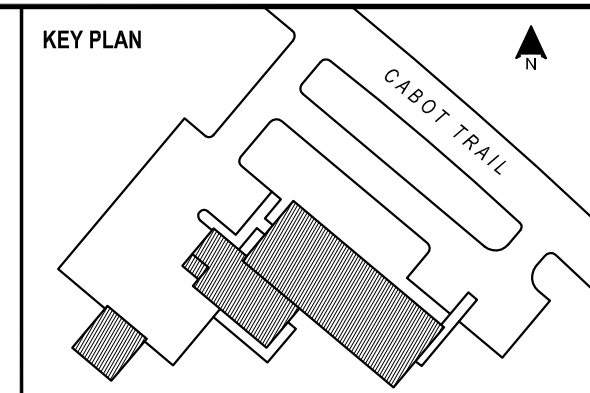
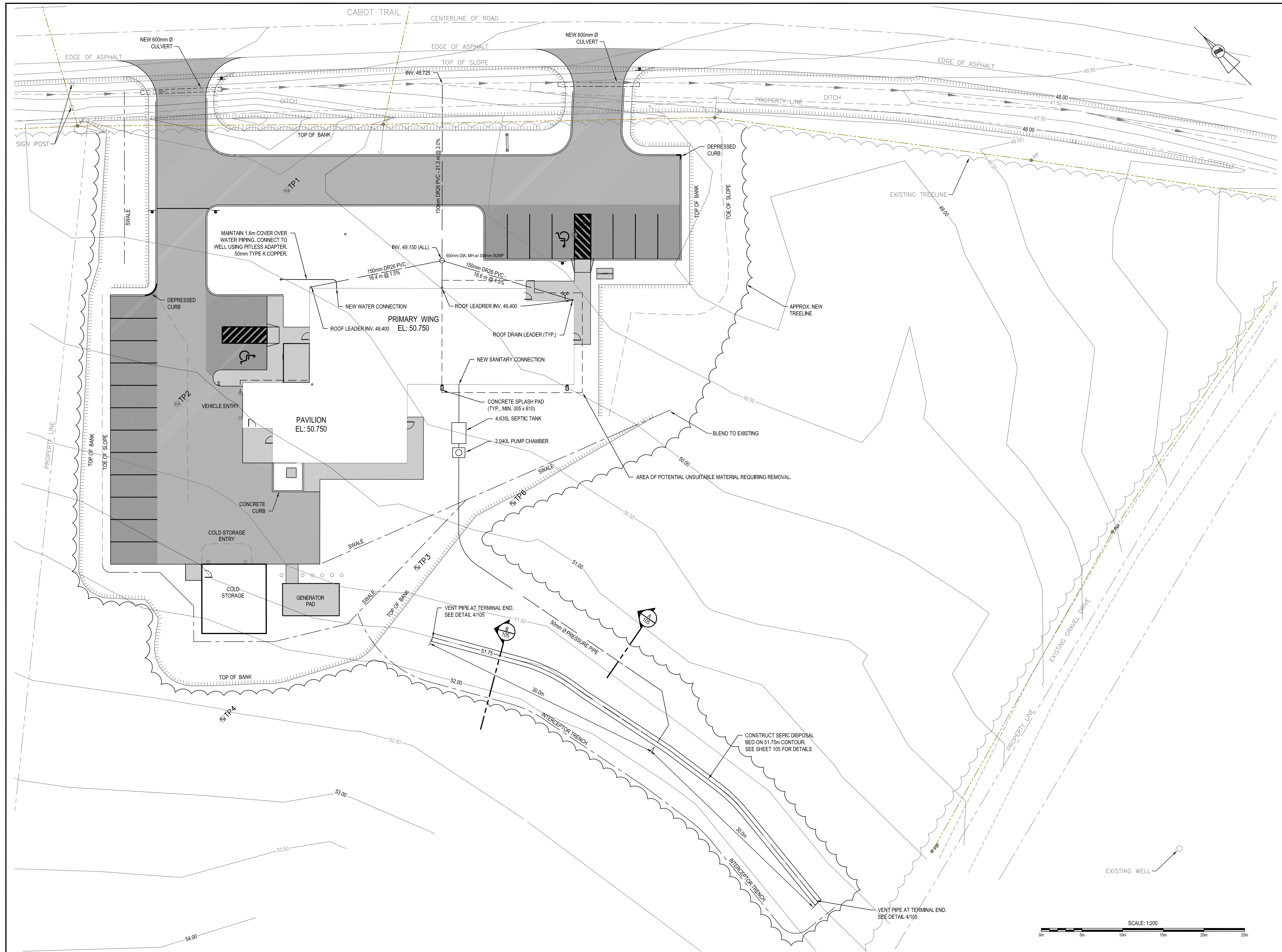

- NOTES:
- FOR LEGEND SEE DRAWING 100.
 - CONTOUR INTERVALS ARE 0.50m.
 - 600mm MANHOLE CONNECTING ROOF DRAIN LEADERS TO DITCH DISCHARGE PIPING TO BE MADE OF HDPE OR CONCRETE WITH MINIMUM 300mm SUMP AND CAST IRON COVER.

C01	ISSUED FOR TENDER	18 JUL 2014
NO.	REVISION	DATE

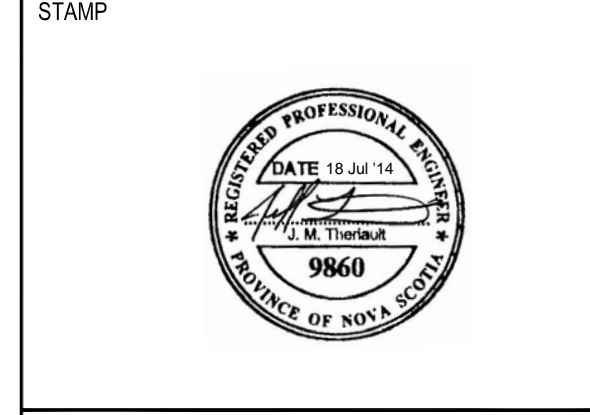

INGONISH CIVIC BUILDING
Project Address
DSRA JOB #: 12169
DRAWN BY: B.C.
CHECKED BY: J.T.
SCALE: AS INDICATED

SITE SERVICES PLAN
103

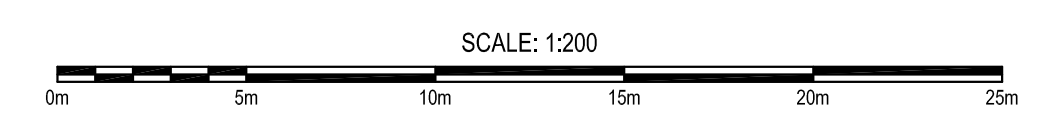

649395-0000-00-000000000000

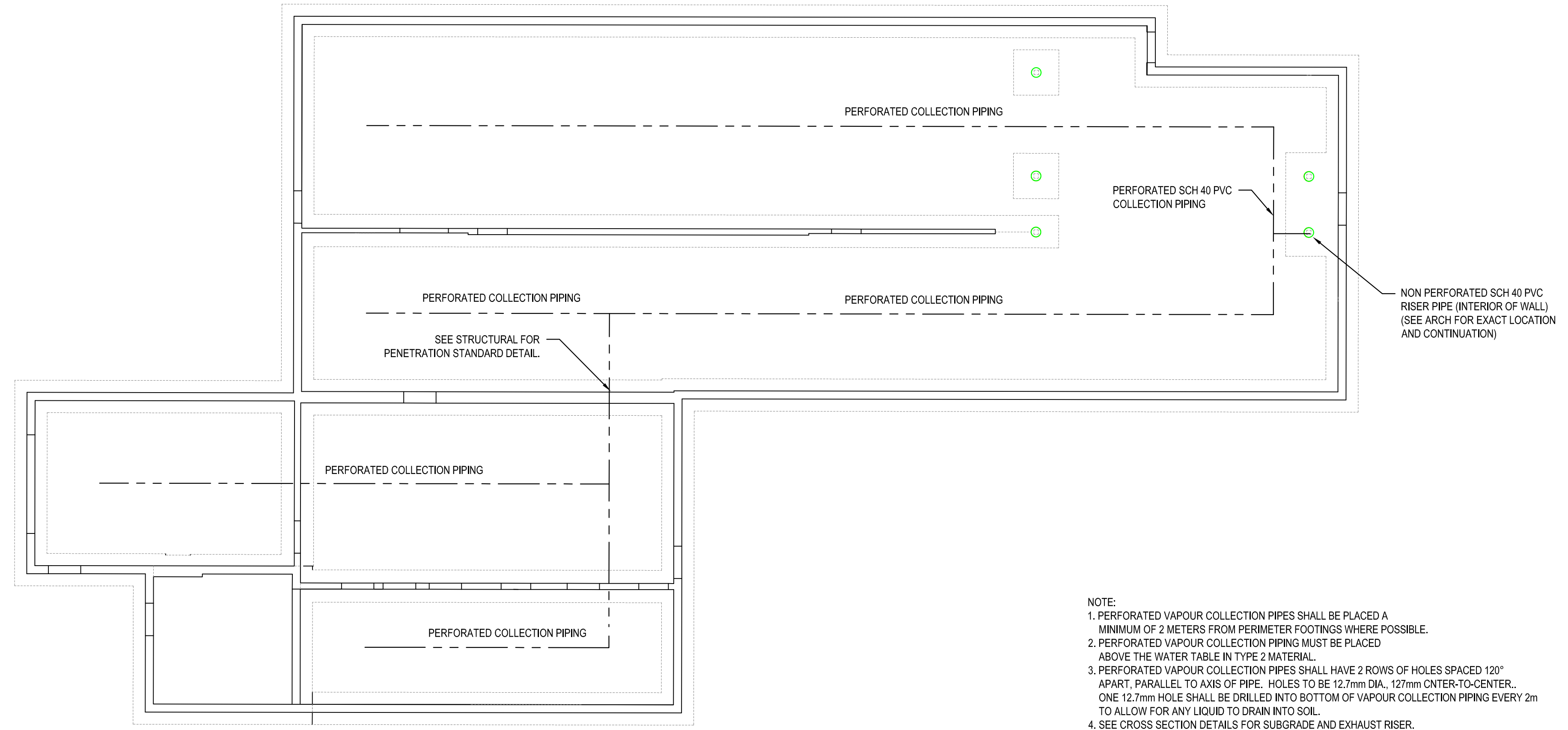
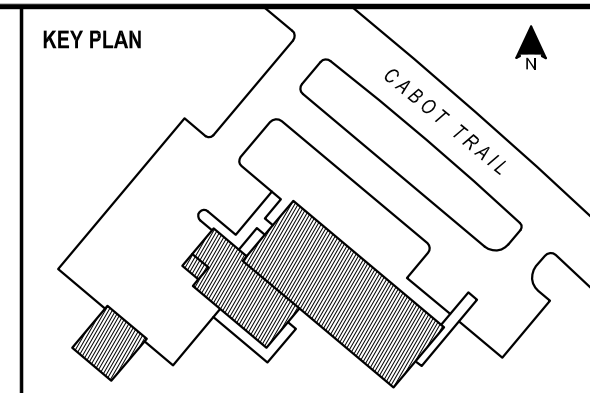

- NOTE:
1. PERFORATED VAPOUR COLLECTION PIPES SHALL BE PLACED A MINIMUM OF 2 METERS FROM PERIMETER FOOTINGS WHERE POSSIBLE.
 2. PERFORATED VAPOUR COLLECTION PIPING MUST BE PLACED ABOVE THE WATER TABLE IN TYPE 2 MATERIAL.
 3. PERFORATED VAPOUR COLLECTION PIPES SHALL HAVE 2 ROWS OF HOLES SPACED 120° APART, PARALLEL TO AXIS OF PIPE. HOLES TO BE 12.7mm DIA., 127mm CENTER-TO-CENTER. ONE 12.7mm HOLE SHALL BE DRILLED INTO BOTTOM OF VAPOUR COLLECTION PIPING EVERY 2m TO ALLOW FOR ANY LIQUID TO DRAIN INTO SOIL.
 4. SEE CROSS SECTION DETAILS FOR SUBGRADE AND EXHAUST RISER.

VAPOUR EXTRACTION SYSTEM LAYOUT

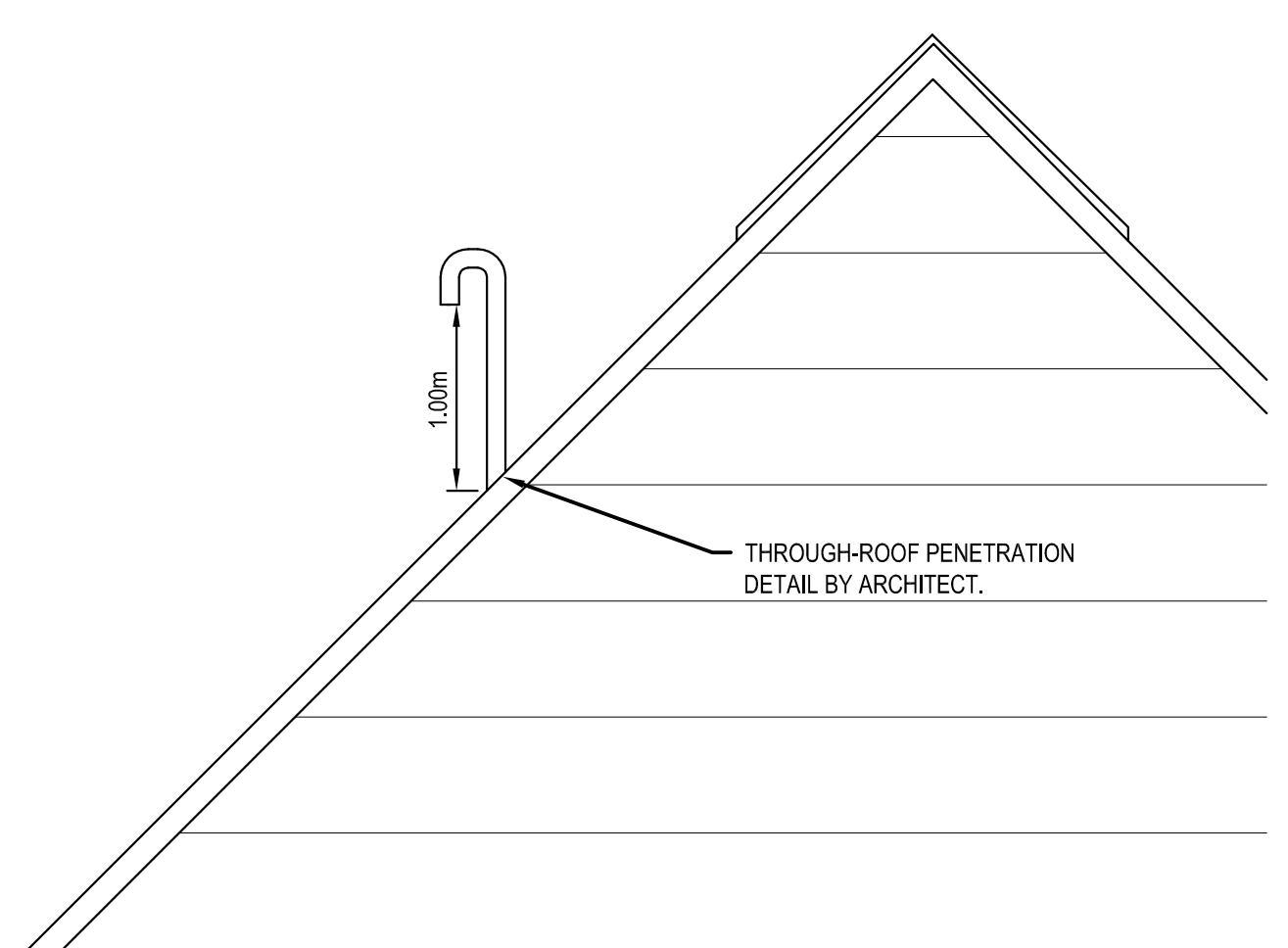
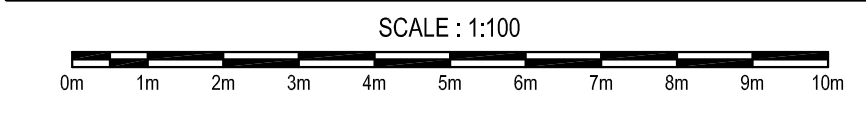

VENT PIPE DETAIL

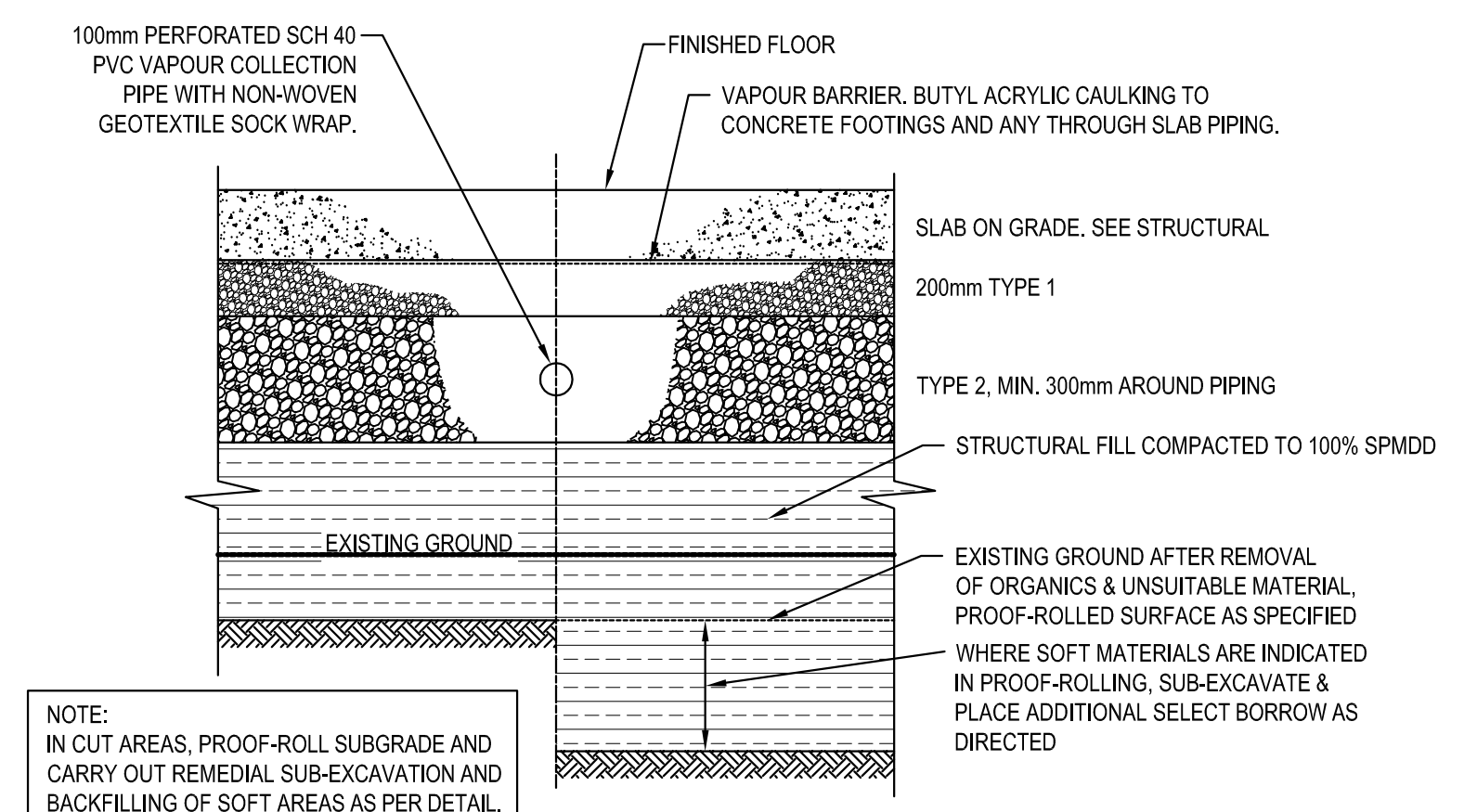

NOTE:
 IN CUT AREAS, PROOF-ROLL SUBGRADE AND CARRY OUT REMEDIAL SUB-EXCAVATION AND BACKFILLING OF SOFT AREAS AS PER DETAIL.

TYPICAL SECTION OF FILL PLACEMENT UNDER SLAB ON GRADE

SCALE : N.T.S.

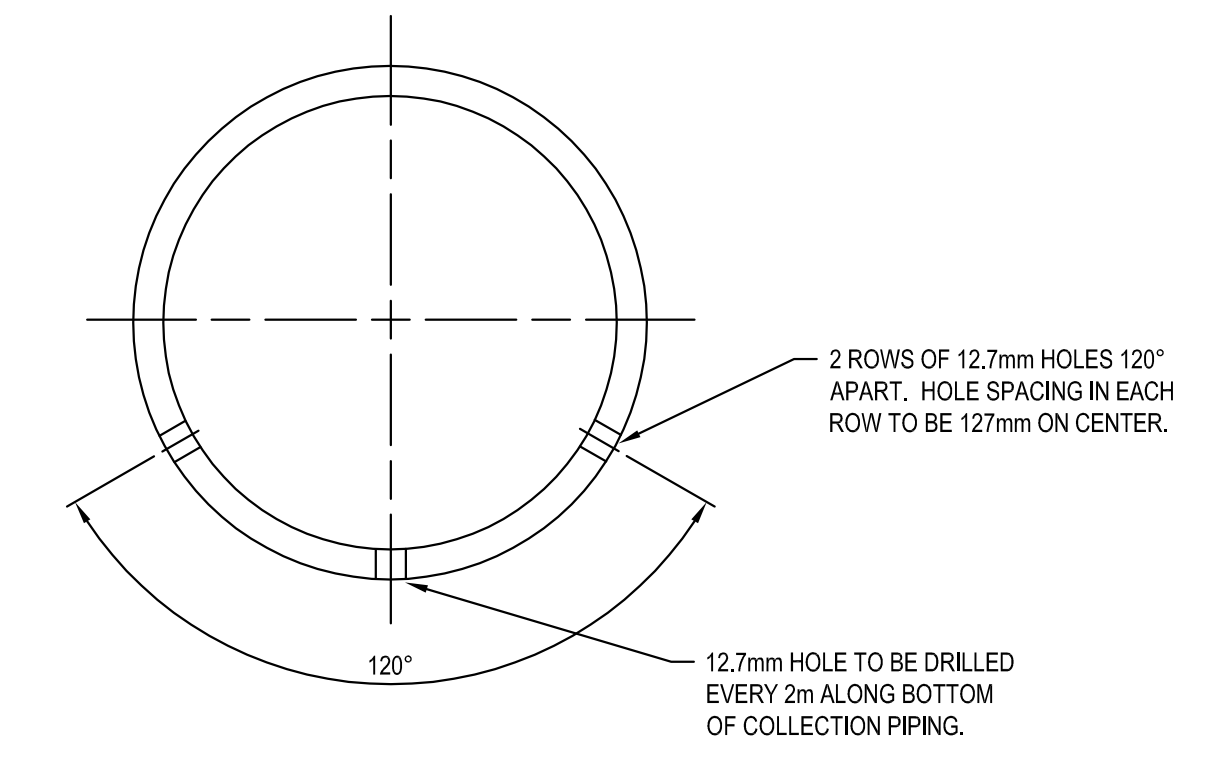

PIPE PERFORATION ARRANGEMENT

SCALE : N.T.S.

C01	ISSUED FOR TENDER	18 JUL 2014
NO.	REVISION	DATE

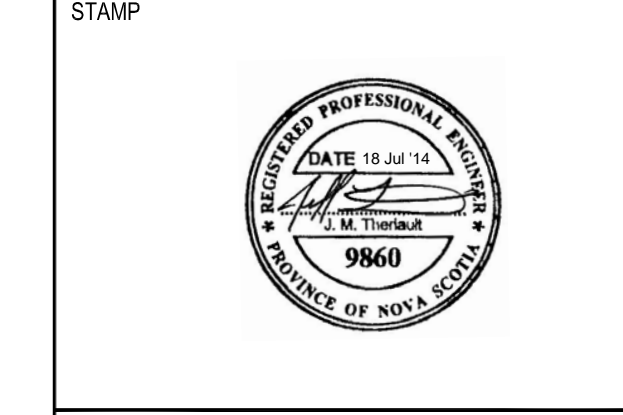

INGONISH CIVIC BUILDING

Project Address

DSRA JOB #: 12169

DRAWN BY: B.C.

CHECKED BY: J.T.

SCALE: AS INDICATED

SUB-SLAB VAPOUR EXTRACTION SYSTEM

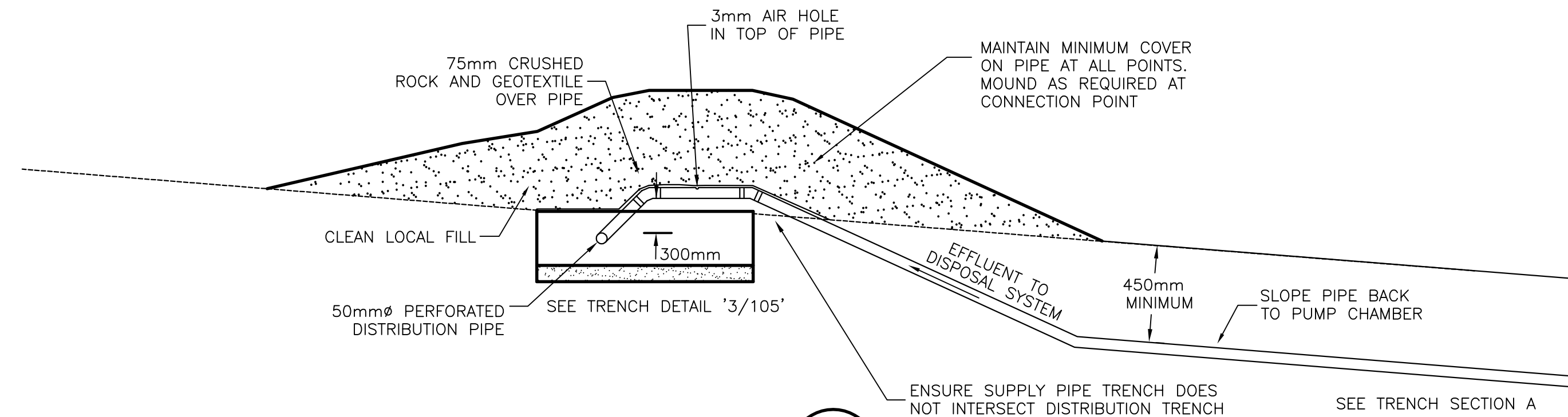

SEPTIC FIELD PIPING CONNECTION (1/105)

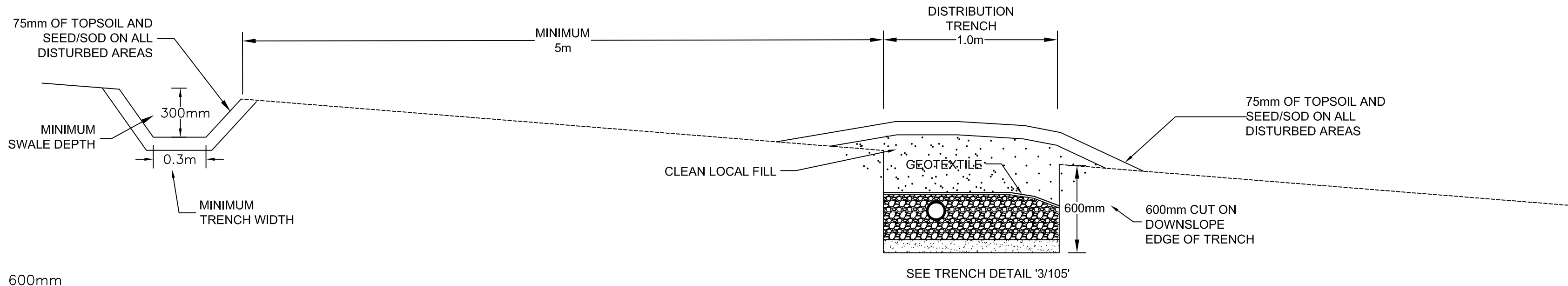

SEPTIC FIELD SECTION (TYP.) (B/103)

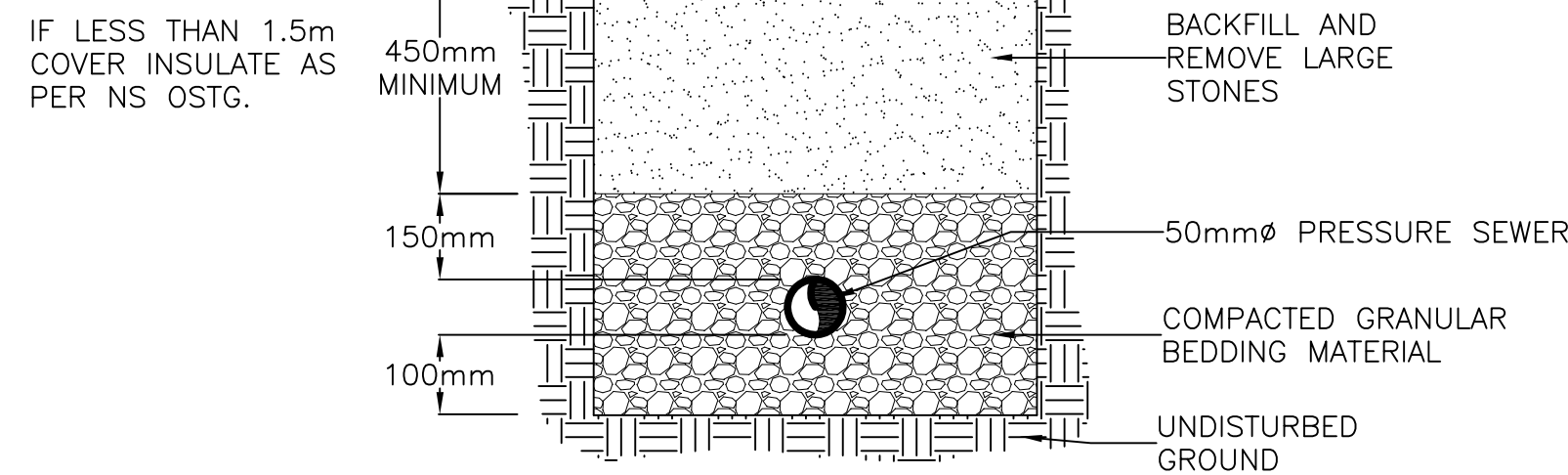

TRENCH DETAILS (TYP.) (A/103)

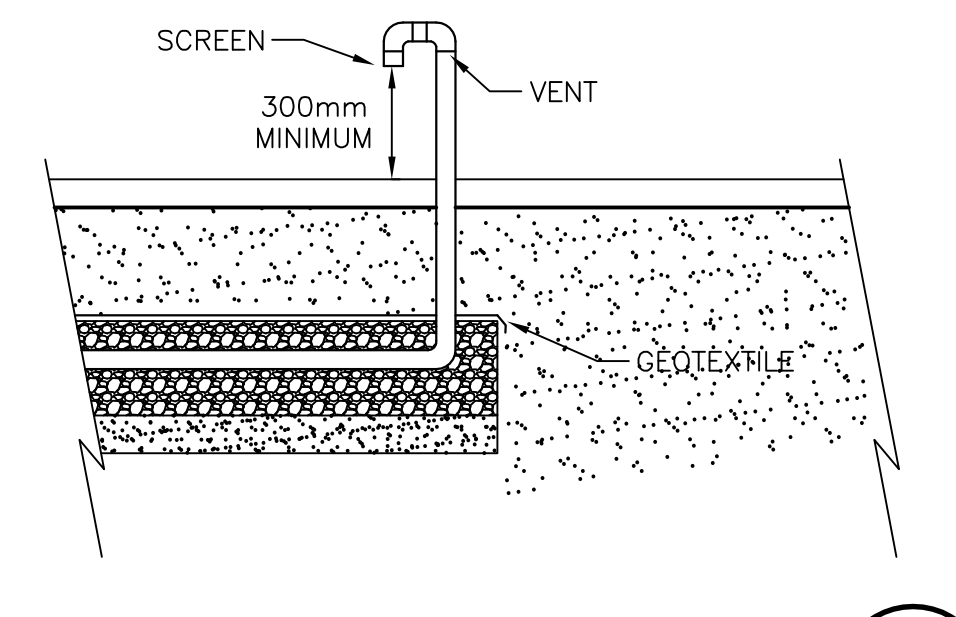

VENT PIPE DETAIL (TYP.) (4/105)

MATERIAL SPECIFICATIONS (FOR REFERENCE ONLY - REFER TO GUIDELINES AND/OR REGULATIONS FOR COMPLETE SPECIFICATIONS)

GRAVITY SEWER FROM BUILDING TO NEW SEPTIC TANK AND BETWEEN NEW SEPTIC TANK AND PUMP CHAMBER SHALL BE 100mmØ PVC OR ABS TO CAN/CSA B-182.1 WITH A MINIMUM SLOPE OF 2%

EFFLUENT DISTRIBUTION PIPE SHALL BE 50mmØ PVC OR ABS TO CSA B137 LAID LEVEL AND BE PERFORATED WITH 13mmØ HOLES ON THE INVERT SPACED AS PER THE HOLE SPACING NOTES

BARRIER MATERIAL SHALL BE A POLYESTER OR POLYPROPYLENE, NON-WOVEN, FELTED, NEEDLE PUNCHED OR HEAT BONDED FIBRE, PORE SIZE LESS THAN 700µm AND HAVE A PERMEABILITY OF LESS THAN 0.001m/s

CRUSHED ROCK SHALL BE CLEAN, WASHED, OR SCREENED STONE FREE OF SOFT OR FRIABLE MATERIAL; 98% BY WEIGHT SHALL PASS AS 35mm SCREEN AND 98% BY WEIGHT SHALL BE RETAINED ON A 12mm SCREEN

FILTER SAND SHALL BE EITHER A MANUFACTURED SAND THAT MEETS THE CURRENT ASTM-33 OR CSA A23.1 SPECIFICATIONS OR A NATURALLY OCCURRING OR MANUFACTURED SAND HAVING A PERMEABILITY, AS PLACED ON SITE, BETWEEN 0.0001 AND 0.0005m/s AS DETERMINED BY THE FALLING HEAD PERMEABILITY TEST AND HAVE A MAXIMUM PARTICLE SIZE CORRESPONDING TO THE APPROPRIATE ASTM-33 OR CSA A23.1 SPECIFICATION FOR FINE AGGREGATE

FINAL COVER MATERIAL SHALL CONSIST OF AN IMPORTED, MANUFACTURED OR SITE PREPARED MATERIAL CONSISTING OF FRIABLE SANDY SILT OR SILTY SAND WITH A 4 TO 25% ORGANIC MATTER CONTENT. THE MATERIAL MUST BE FREE OF DEBRIS, VEGETATION AND ROOTS WITH NO STONES GREATER THAN 25mm IN SIZE. THE MATERIAL MUST BE CAPABLE OF SUPPORTING GRASS OR SIMILAR VEGETATION

SEPTIC TANK TO BE WATERTIGHT, REINFORCED CONCRETE, FIBERGLASS, OR POLYETHYLENE TO CAN/CSA B-66-M90; TANK TO HAVE A MINIMUM OF 150mm AND A MAXIMUM OF 1500mm SOIL COVER; PROVIDE A RISER TO FINISHED GRADE WITH LOCKING FIBERGLASS COVER ON END ACCESS OPENING CLOSEST TO PUMP CHAMBER; TANK TO HAVE A VOLUMES, EFFLUENT FILTER AND BAFFLES AS SPECIFIED

HOLE SPACING NOTES
DISPOSAL SYSTEM LENGTH: 60m
CENTER FED SYSTEM, 38 HOLES PER SIDE

HOLES SHALL BE SPACED AS FOLLOWS:
STARTING AT THE TEE WHERE PRESSURE HEADER CONNECTS TO DISTRIBUTION PIPE,
FIRST HOLE: 1.08m
SECOND HOLE: 2.17m FROM FIRST HOLE
THIRD HOLE: 2.17m FROM SECOND HOLE
NEXT HOLE: 1.83m
THEN 3 HOLES SPACED 1.5m
NEXT HOLE 1.25m
THEN 5 HOLES SPACED 1.0m
NEXT HOLE 0.8m
THEN 9 HOLES SPACED 0.6m
NEXT HOLE 0.46m
THEN 14 HOLES SPACED 0.37m
REPEAT HOLE SPACING ON OPPOSITE SIDE OF TEE

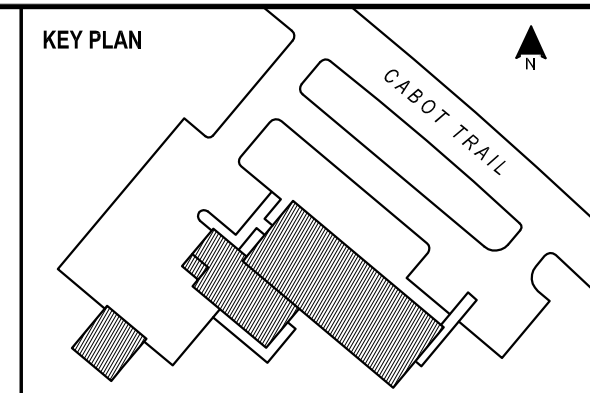

NOTES:
1) CONTRACTOR TO FOLLOW THE NOVA SCOTIA ENVIRONMENT REGULATIONS AND TECHNICAL GUIDELINES WITH RESPECT TO THE CONSTRUCTION OF AN ON-SITE WASTEWATER DISPOSAL SYSTEM

2) SITE PLAN IS FOR GRAPHICAL REPRESENTATION ONLY AND IS NOT A LEGAL SURVEY; THE PROPERTY OWNER IS RESPONSIBLE FOR VERIFYING PROPERTY BOUNDARIES PRIOR TO CONSTRUCTION TO ENSURE ALL SEPARATION DISTANCES CAN BE MET. ANY DEVIATION FROM THIS DRAWING MUST BE APPROVED BY THE DEPARTMENTAL REPRESENTATIVE PRIOR TO CONSTRUCTION

3) CONTRACTOR MUST VERIFY THIS DRAWING WITH SITE CONDITIONS AND REPORT ALL DISCREPANCIES TO THE DEPARTMENTAL REPRESENTATIVE PRIOR TO PROCEEDING WITH CONSTRUCTION

4) CONTRACTOR TO NOTIFY DEPARTMENTAL REPRESENTATIVE AT LEAST 48 HOURS IN ADVANCE OF A REQUIREMENT FOR INSPECTION; HOLE SPACING SHALL BE VISIBLE FOR INSPECTION

5) SYSTEM TO BE INSTALLED BY A CONTRACTOR LICENSED TO DO SO BY NOVA SCOTIA ENVIRONMENT

6) ENSURE THAT ALL TANKS, RISERS, AND PIPING ARE WATERTIGHT

C01	ISSUED FOR TENDER	18 JUL 2014
NO.	REVISION	DATE

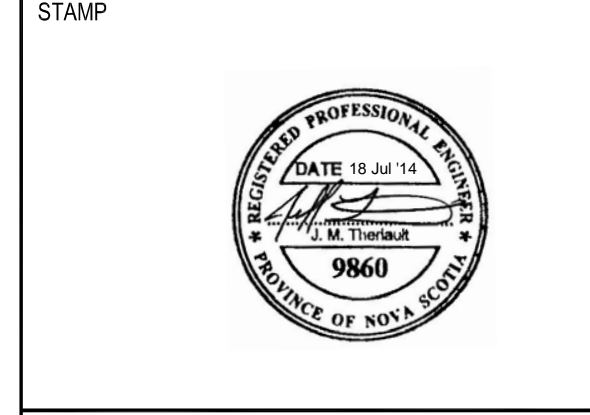

INGONISH CIVIC BUILDING

Project Address
DSRA JOB #: 12169
DRAWN BY: B.C.
CHECKED BY: J.T.
SCALE: AS INDICATED

ON-SITE SEPTIC DISPOSAL SYSTEM DETAILS

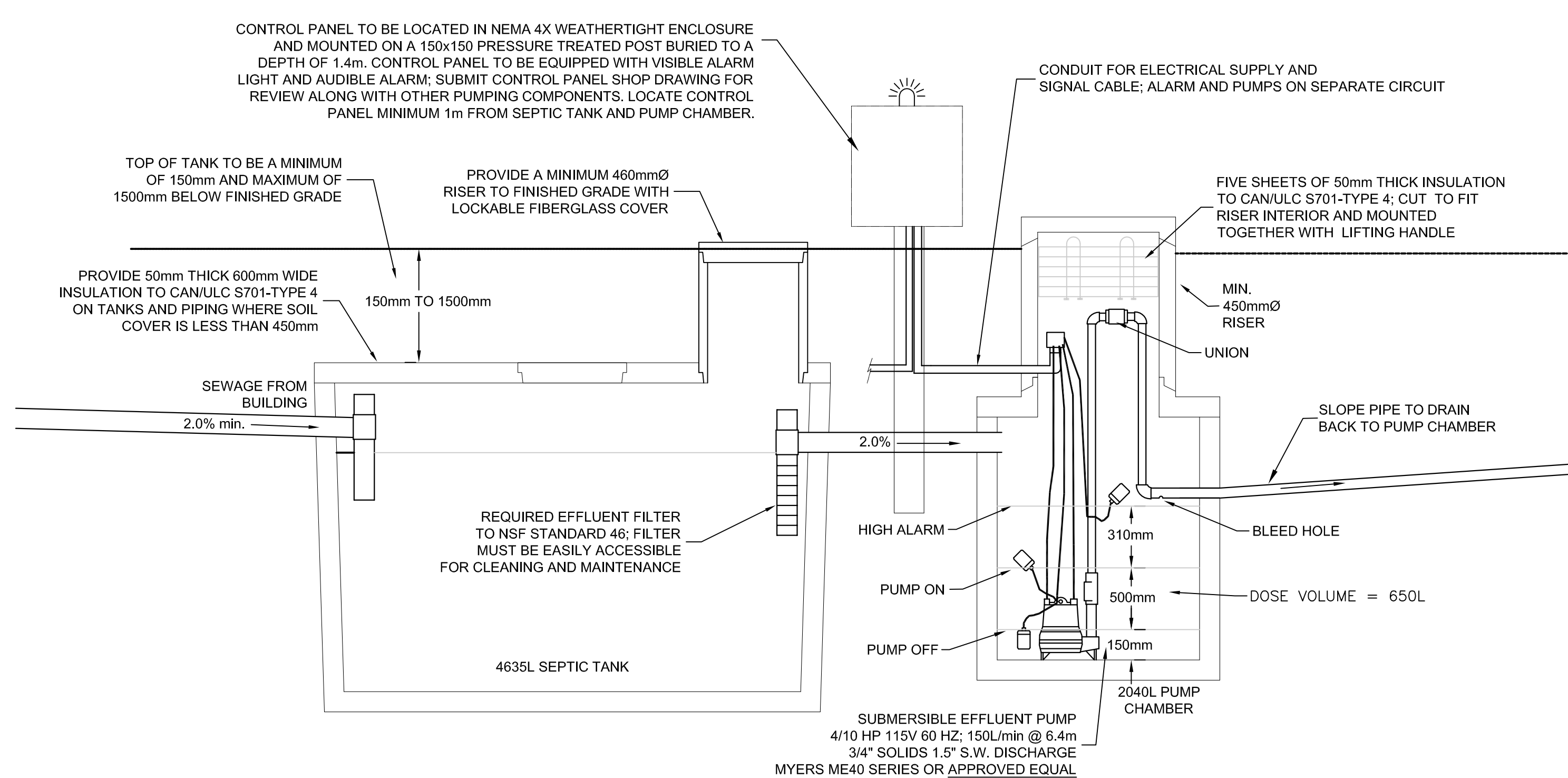

SEPTIC TANK & PUMPING CHAMBER DETAIL (TYP.) (2/105)

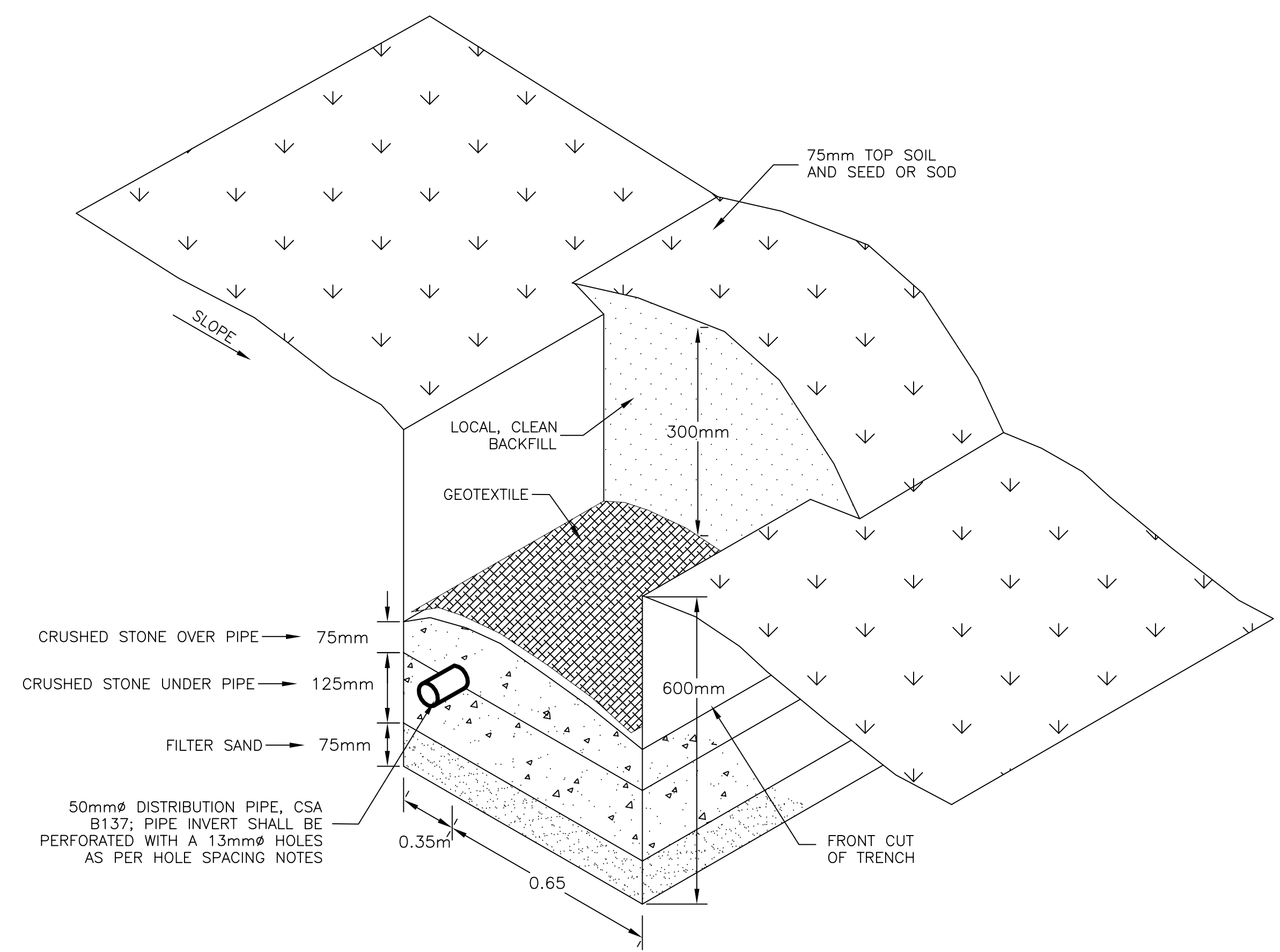

SEPTIC FIELD PIPE TRENCH (TYP.) (3/105)

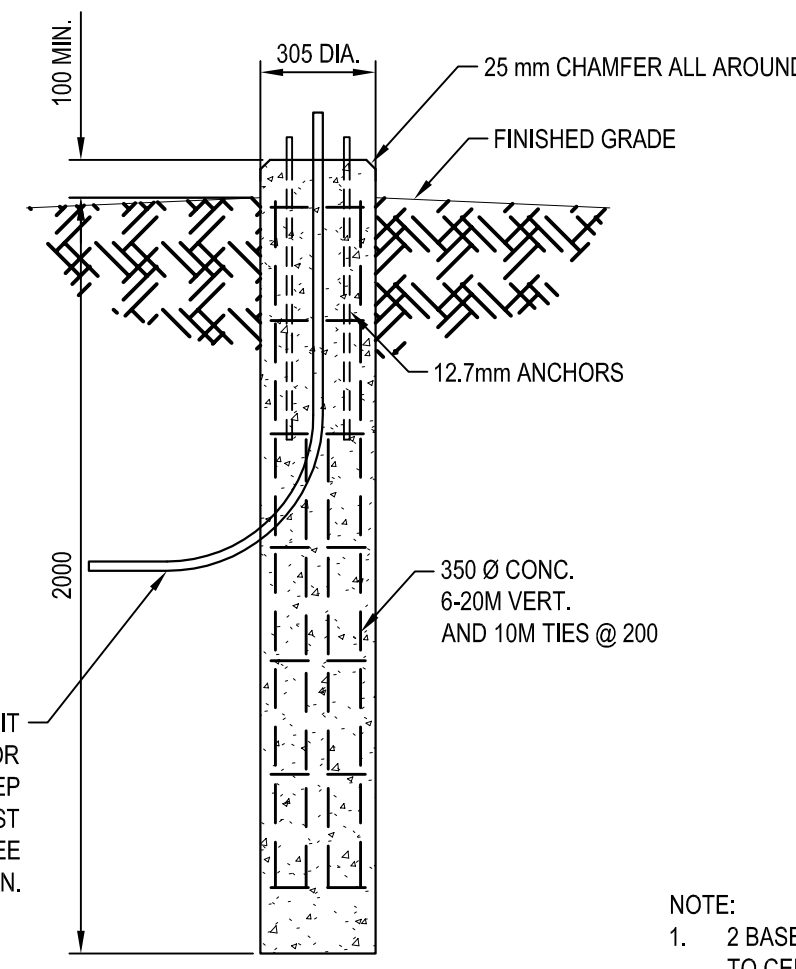

ILLUMINATED SIGN BASE INSTALLATION 1/106

NOTE:
1. 2 BASES REQUIRED, SPACED AT 2059mm CENTER TO CENTER.
2. REFER TO SPECIFICATION FOR SIGN AND BASE PLATE DETAILS.

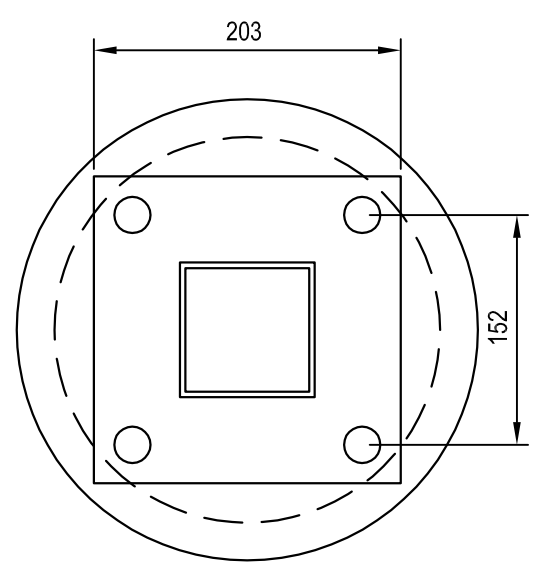

TABLE 1: STANDARD DUTY PAVEMENT

ASPHALT - NSTIR TYPE C	65
GRANULAR BASE NSTIR TYPE 1	150
GRANULAR SUB-BASE NSTIR TYPE 2	300

TABLE 2: HEAVY DUTY PAVEMENT

ASPHALT - NSTIR TYPE C	90
GRANULAR BASE NSTIR TYPE 1	200
GRANULAR SUB-BASE NSTIR TYPE 2	300

NOTE:
IN CUT AREAS, PROOF-ROLL SUBGRADE AND CARRY OUT REMEDIAL SUB-EXCAVATION AND BACKFILLING OF SOFT AREAS AS PER DETAIL.

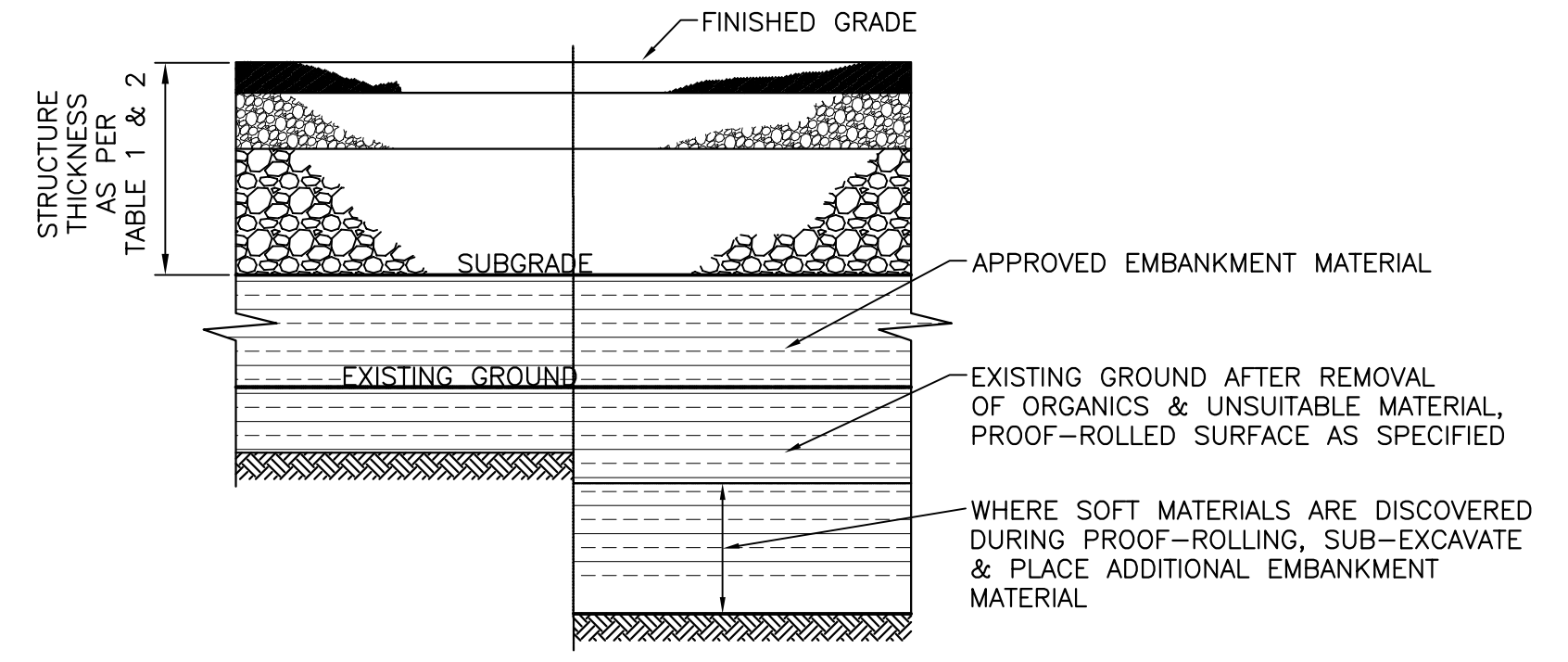

SECTION OF TOTAL PAVEMENT CONSTRUCTION 2/106
SCALE : N.T.S.

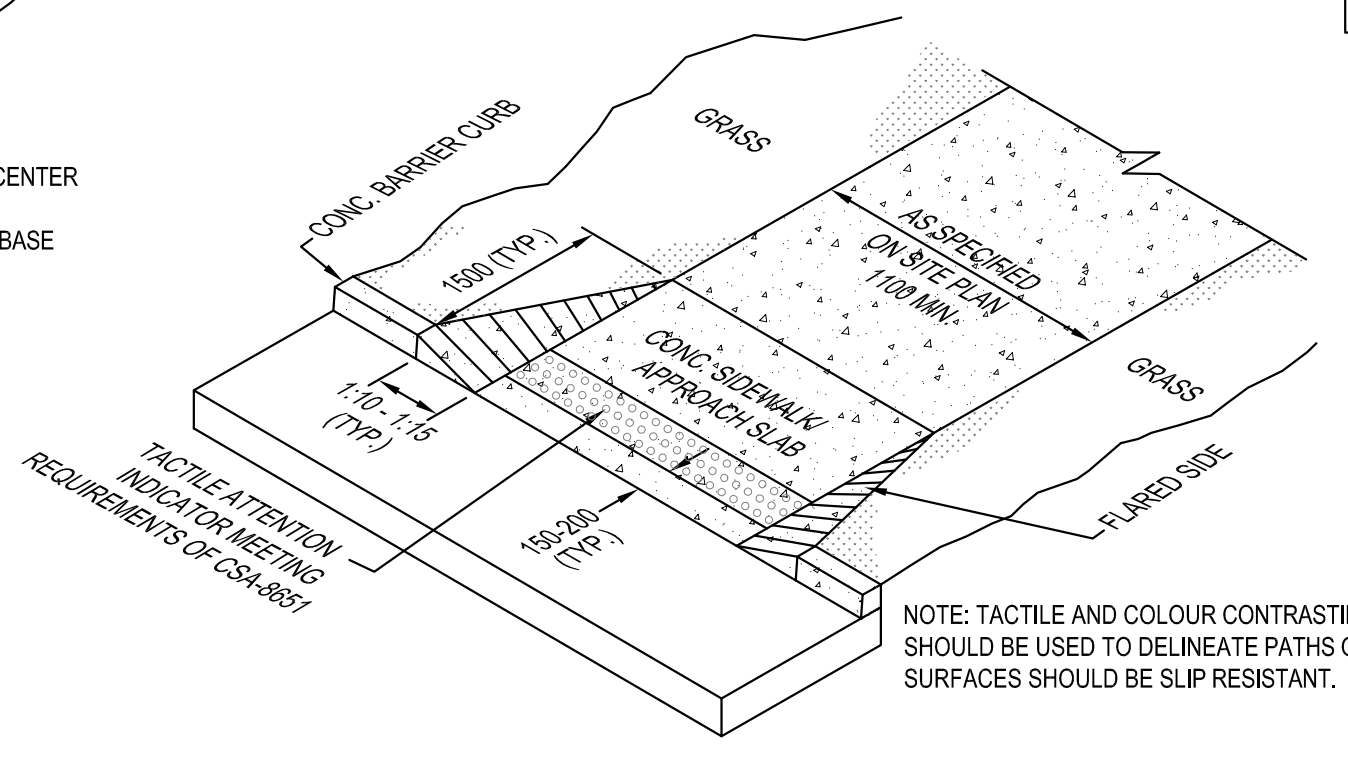

DETAIL - CONC. CURB DROP 3/106

NOTE: TACTILE AND COLOUR CONTRASTING SURFACES SHOULD BE USED TO DELINEATE PATHS OF TRAVEL. SURFACES SHOULD BE SLIP RESISTANT.

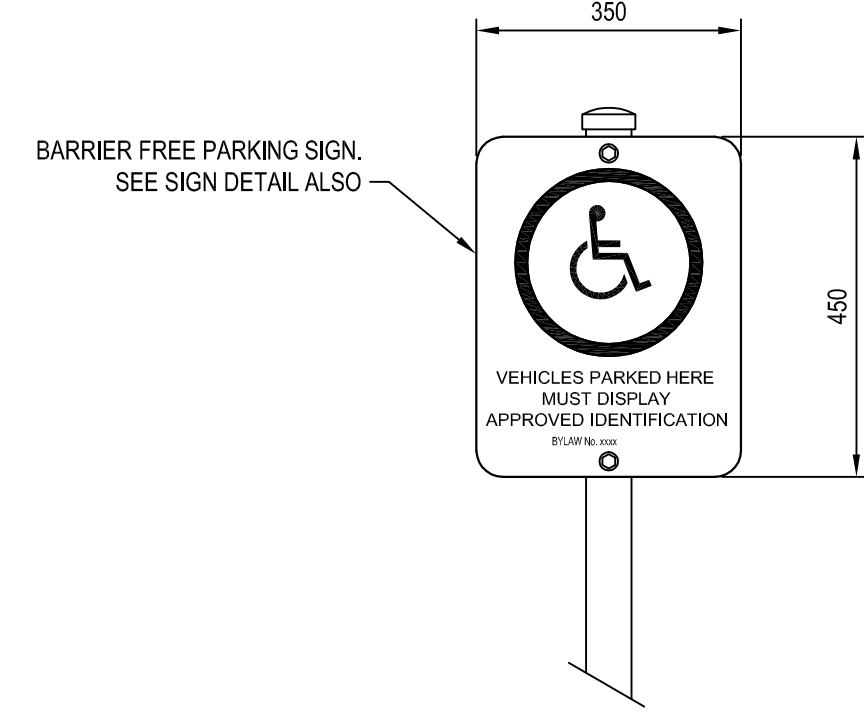

ACCESSIBILITY PARKING SIGN (TYP.) 4/106

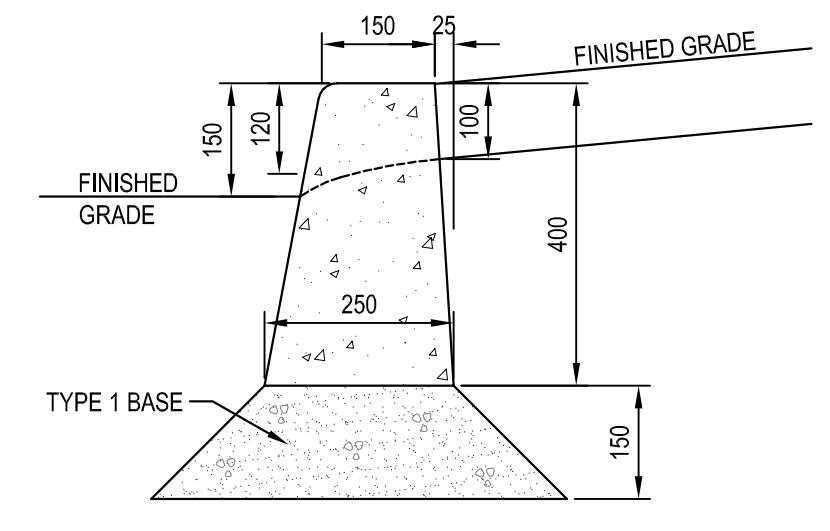

BARRIER CURB DETAIL 7/106

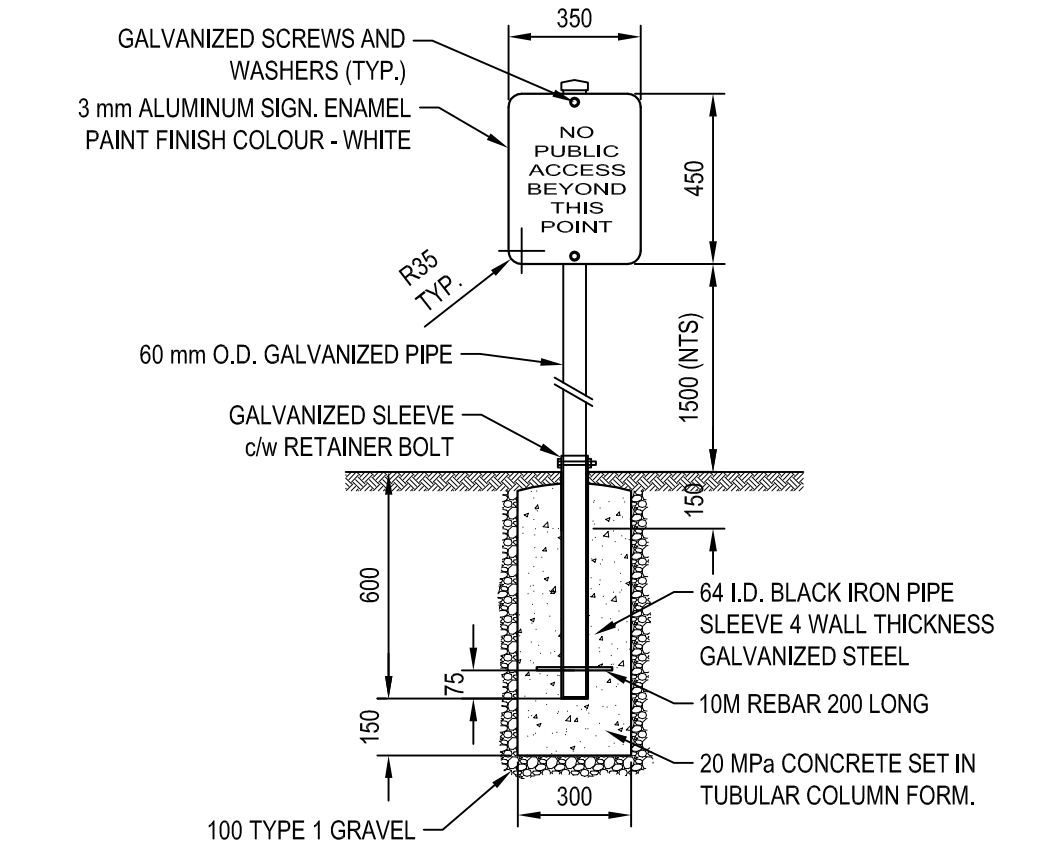

PARKING DESIGNATION SIGN (TYP.) 8/106

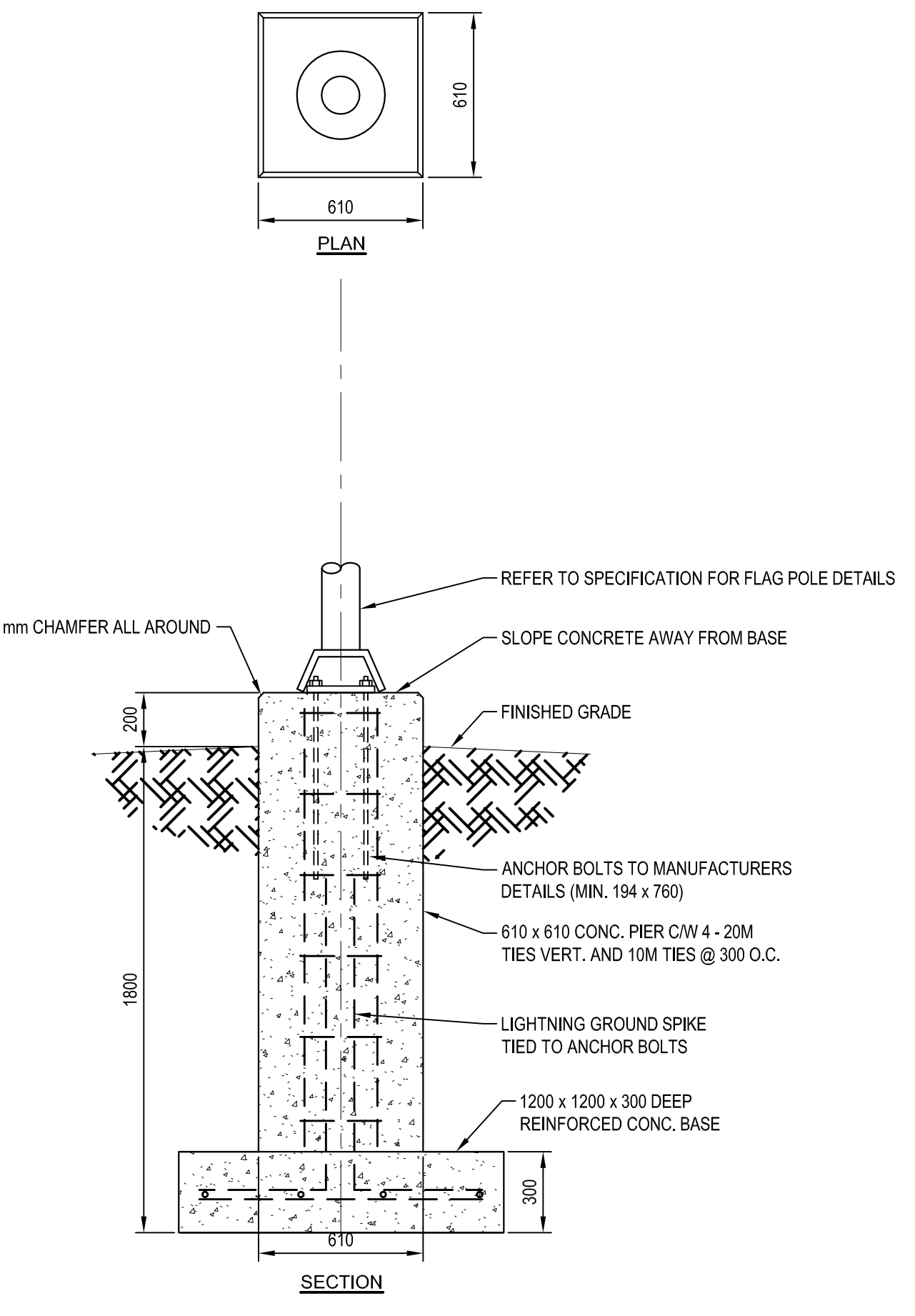

FLAGPOLE BASE INSTALLATION (TYP.) 9/106

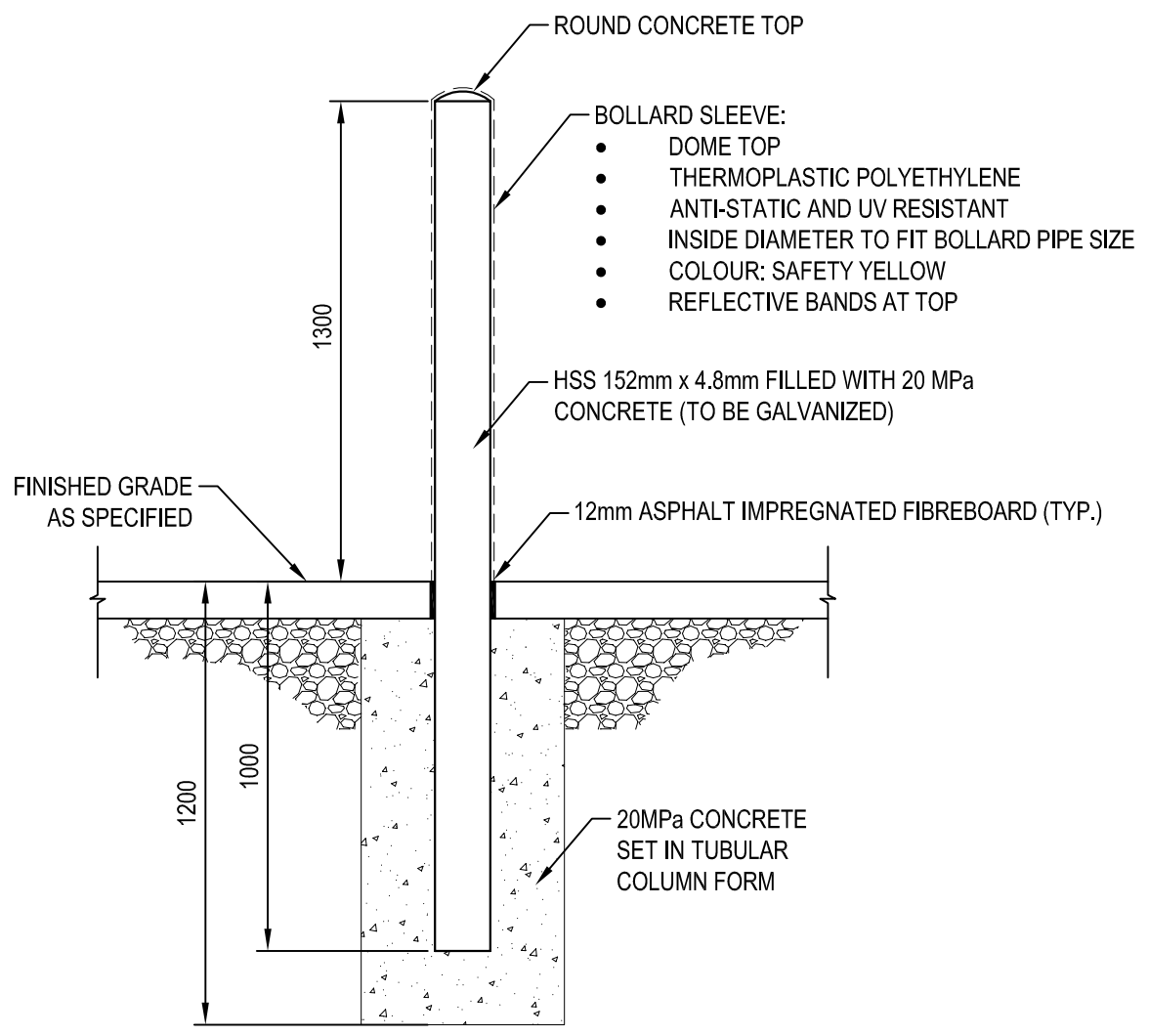

BOLLARD DETAIL (TYP.) 5/106

SCALE : 1:20

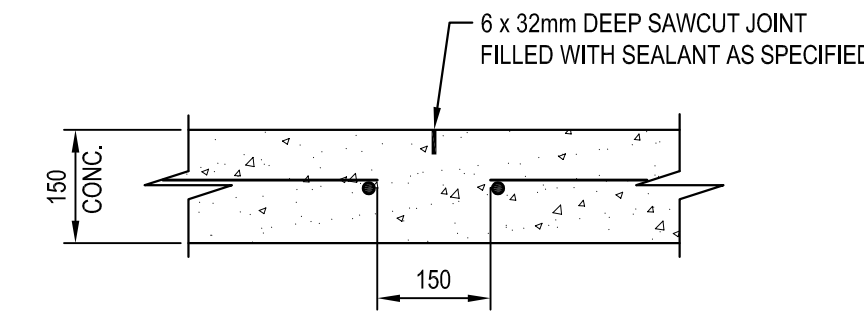

TYP. SAWCUT CONTROL JOINT - SIDEWALK 6/106

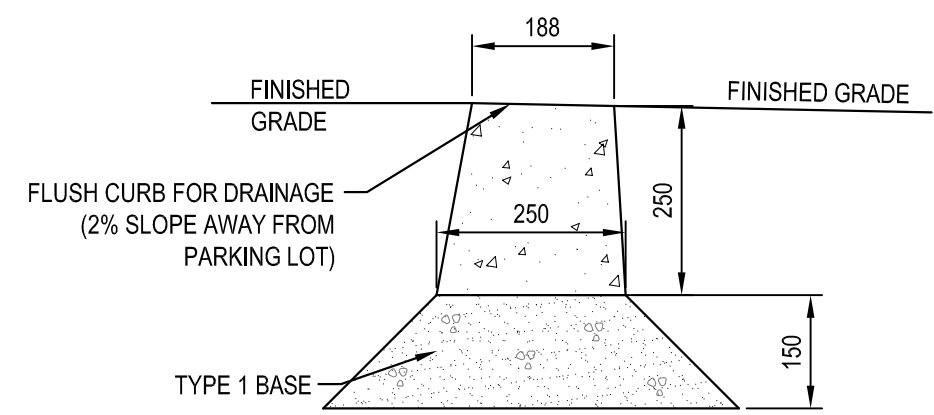

FLUSH CURB DETAIL 10/106

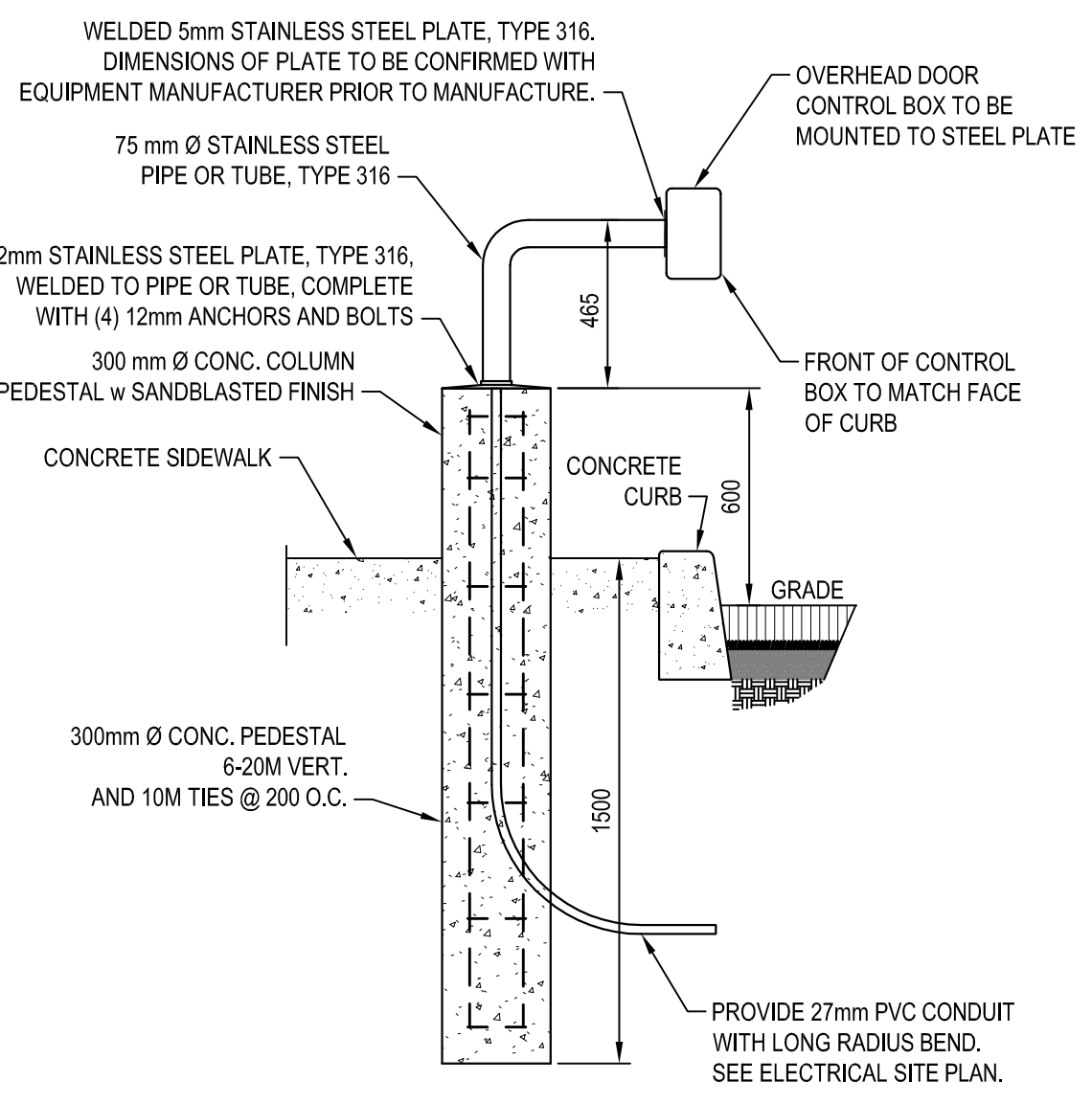

CARD READER AND POST (TYP.) 12/106

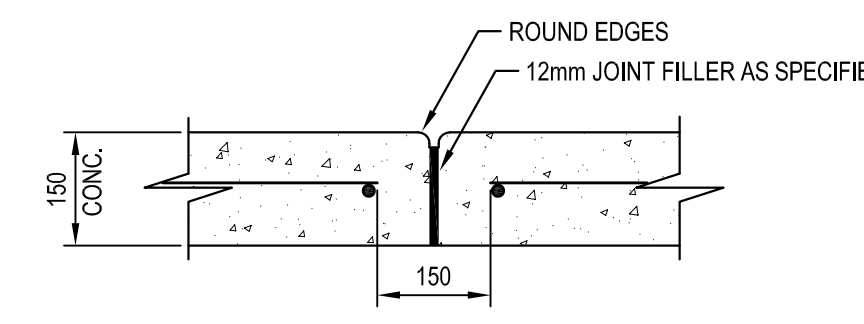

TYP. FORMED CONTROL JOINT - SIDEWALK 11/106

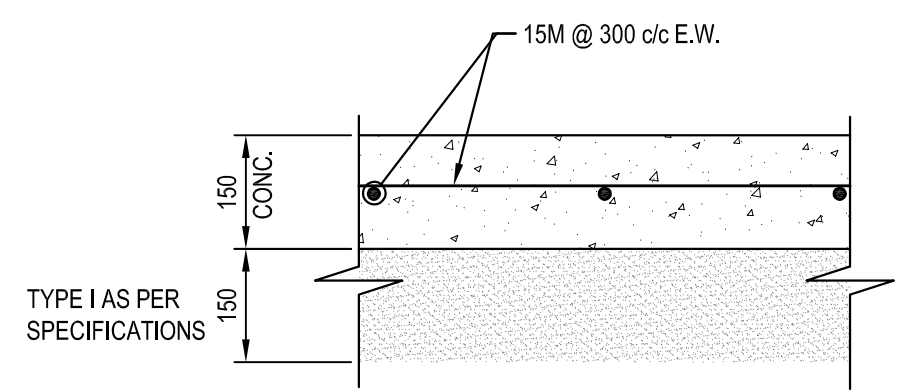

TYP. CONCRETE SIDEWALK & PERSONNEL DOOR PAD DETAIL 13/106

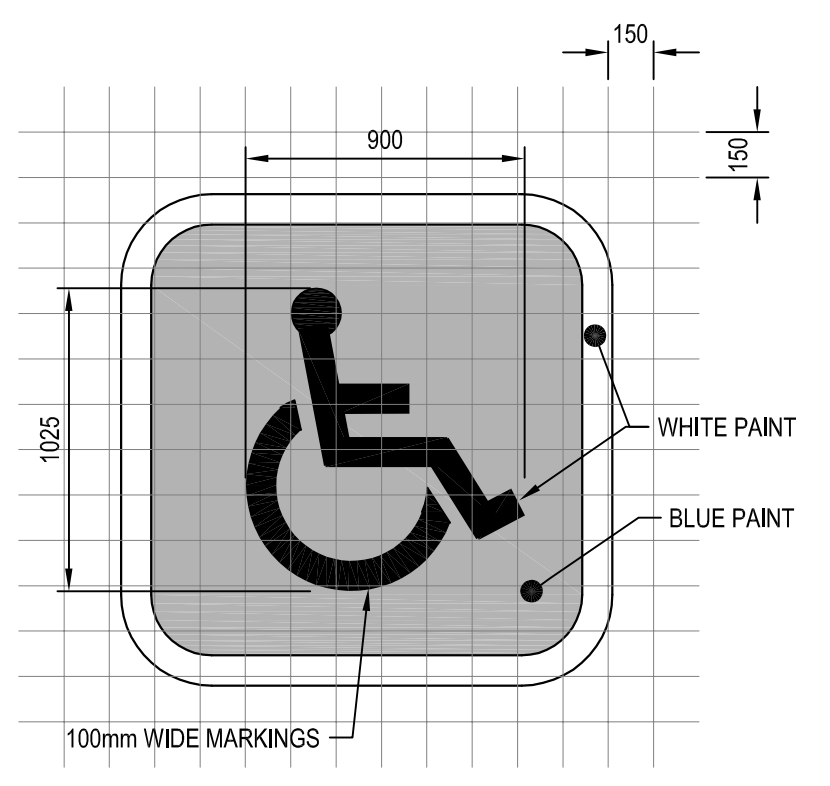

PAVEMENT MARKING ACCESSIBLE PARKING 14/106

LINE TYPE	DIMENSIONS	COLOR:
PARKING STALL AND SOLID LINE	100mm	WHITE/YELLOW AS INDICATED
STOP BAR	600mm	WHITE
DIAGONAL LINES	300mm width, 300mm spacing, 45° angle	YELLOW
CROSSWALK LINES	600mm width, 1000mm spacing, 45° angle	YELLOW

PAVEMENT MARKINGS 15/106

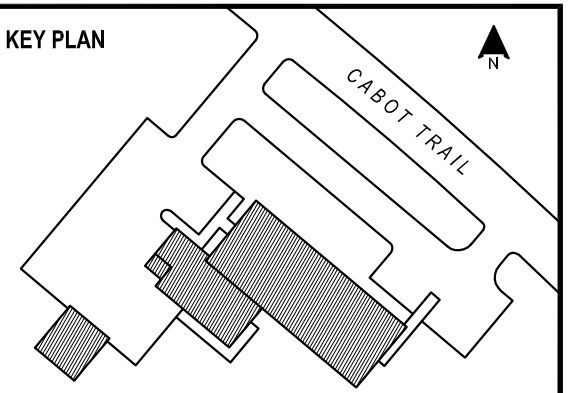

NOTES:
1. SEE DRAWINGS 504 FOR LIGHT STANDARD CONCRETE BASE DETAIL.

C01	ISSUED FOR TENDER	18 JUL 2014
NO.	REVISION	DATE



INGONISH CIVIC BUILDING
Project Address
DSRA JOB #: 12169
DRAWN BY: B.C.
CHECKED BY: J.T.
SCALE: AS INDICATED

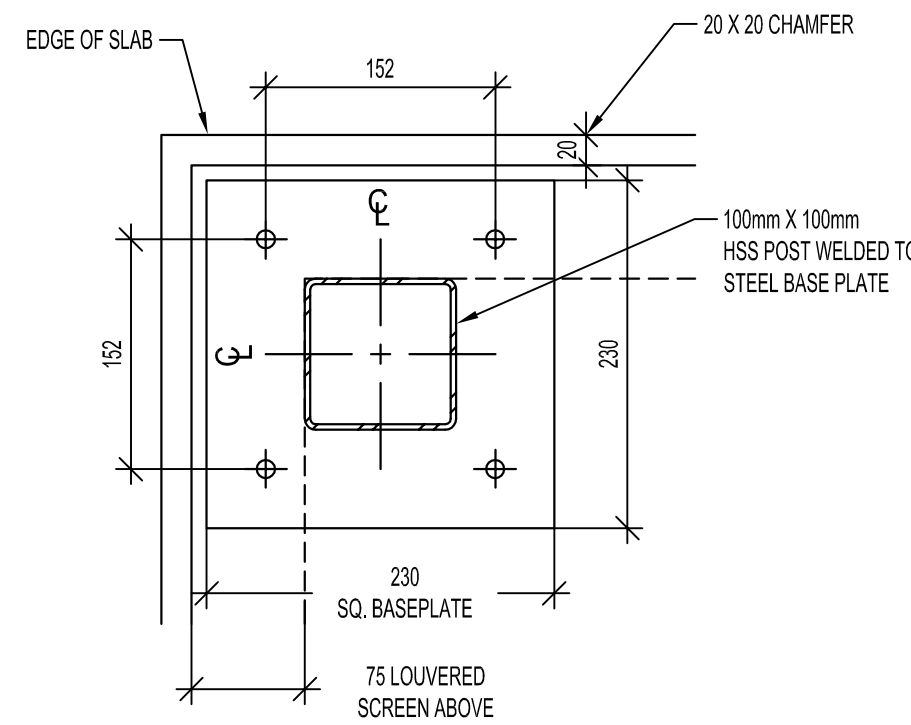

NOTE: ALL STEEL IS TO BE GALVANIZED

TYPICAL POST BASE DETAIL @ EQUIPMENT SCREEN

1
107

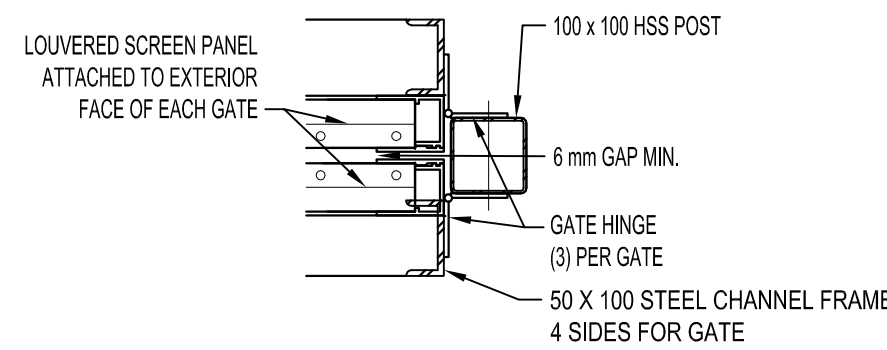

NOTE: ALL STEEL IS TO BE GALVANIZED
GATES ARE SHOWN IN THE OPEN POSITION

GATE HINGE - PLAN DETAIL

2
107

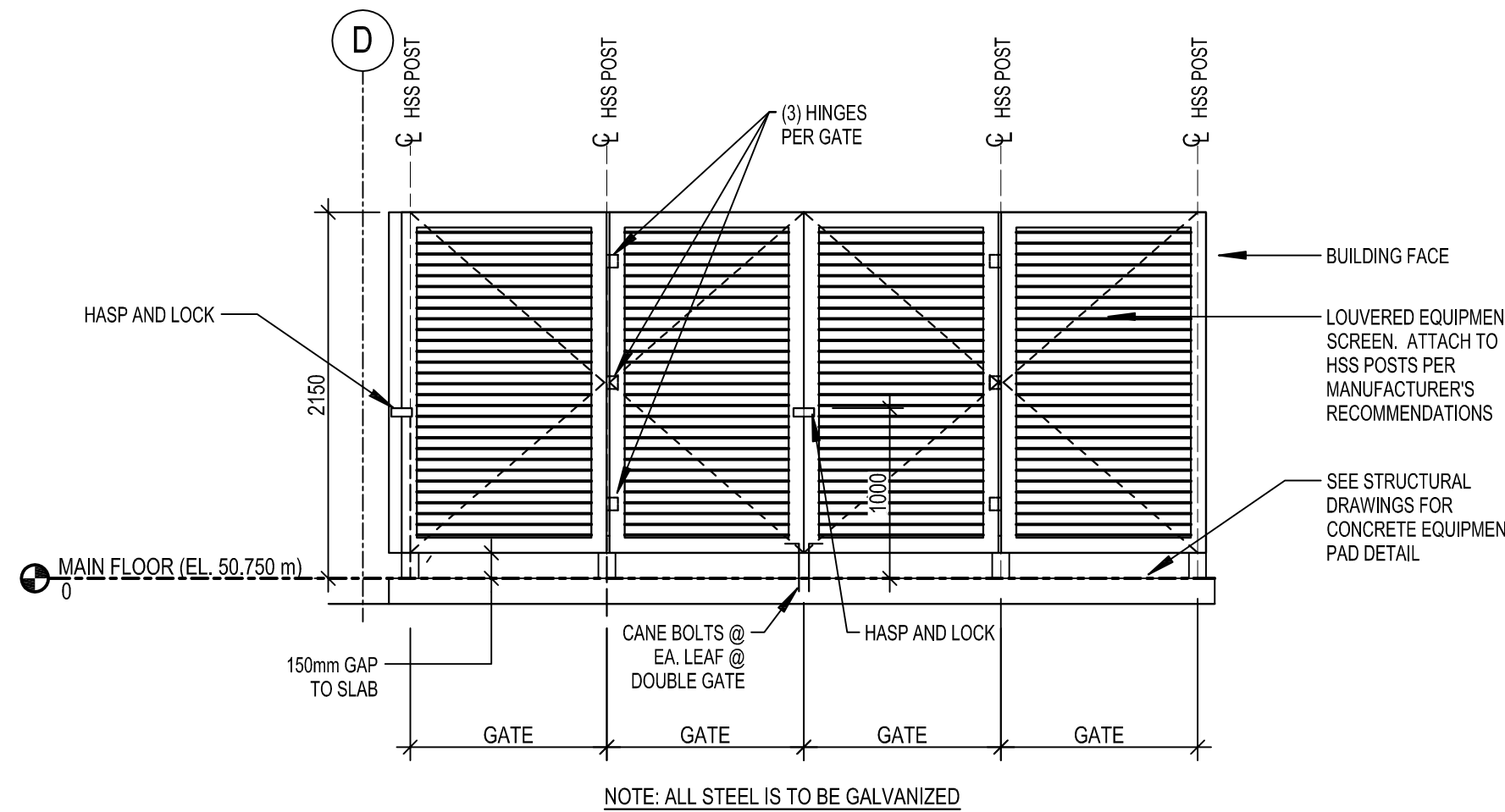

WEST ELEVATION - MECH. EQUIP. ENCLOSURE (NORTH ELEV. SIM.)

3
107

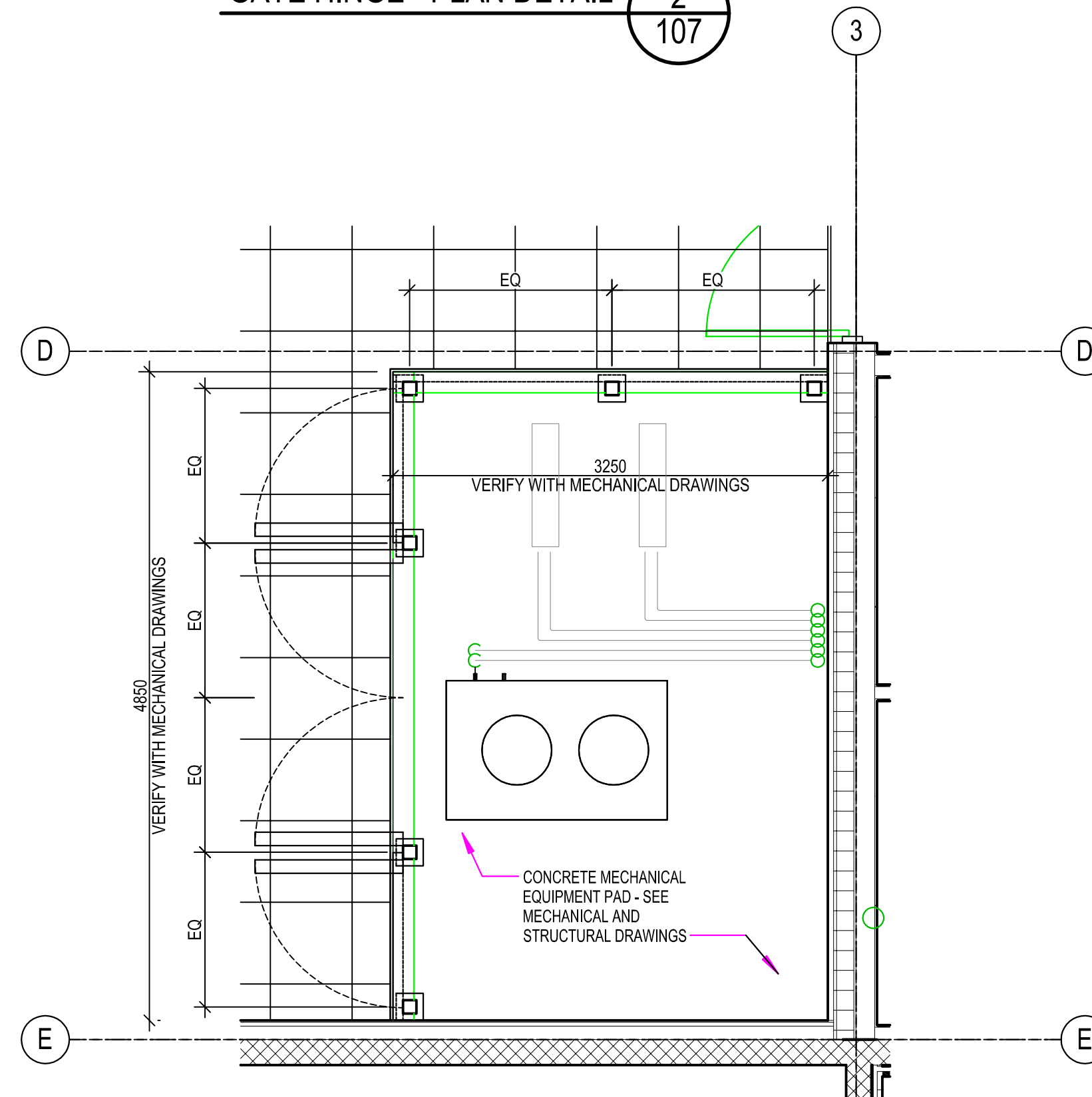

PLAN - LOUVERED MECH. EQUIP. ENCLOSURE

4
107

GENERAL NOTES:

- THE FOLLOWING NOTES APPLY UNLESS OTHERWISE INDICATED. SPECIFICATIONS AND STANDARD DETAILS ISSUED WITH THESE DRAWINGS FORM AN INTEGRAL PART OF THIS CONTRACT.
- ALL CONSTRUCTION WORK TO BE IN ACCORDANCE WITH THE CONTRACT DOCUMENTS.
- ALL ELEVATIONS ARE GEODETIC. ALL DISTANCES AND ELEVATIONS ARE IN METRES UNLESS OTHERWISE NOTED. ALL DIMENSIONS ARE IN METRES OR MILLIMETRES. CONTRACTOR MUST VISIT THE SITE PRIOR TO TENDERING TO BECOME FAMILIAR WITH THE NATURE AND EXTENT OF WORK REQUIRED.
- CONTRACTOR TO PROTECT ALL CONTROL MONUMENTS FROM DAMAGE DURING CONSTRUCTION. IF ANY MONUMENT IS DISTURBED, IT MUST BE RESET AND RESURVEYED AT THE CONTRACTOR'S EXPENSE TO THE SATISFACTION OF THE DEPARTMENTAL REPRESENTATIVE.
- CONTRACTOR SHALL OBTAIN ALL NECESSARY PERMITS REQUIRED TO PERFORM WORK, AND SHALL COMPLY WITH THE PERMIT REQUIREMENTS AND CONDITIONS.
- THE CONTRACTOR SHALL ARRANGE FOR AND PAY FOR ALL TEMPORARY SERVICES SUCH AS POWER, SANITARY SEWER AND WATER SUPPLY REQUIRED DURING CONSTRUCTION. THE GEOTECHNICAL REPORT FOR THIS SITE IS PROVIDED IN AN APPENDIX TO THE SPECIFICATIONS.
- CONTRACTOR TO CARRY OUT ENVIRONMENTAL PROTECTION METHODS IN ACCORDANCE WITH LOCAL CODES AND REGULATIONS. CONTRACTOR SHALL PREPARE AND SUBMIT AN EROSION AND SEDIMENT CONTROL PLAN TO THE DEPARTMENTAL REPRESENTATIVE FOR REVIEW PRIOR TO COMMENCEMENT OF SITE DISTURBANCE.
- THE CONTRACTOR SHALL PROTECT ALL DOWNSTREAM AREAS FROM ANY NEGATIVE IMPACT WHATSOEVER FROM THE CONSTRUCTION ACTIVITIES. THE CONTRACTOR SHALL PROTECT ALL AREAS DOWNSTREAM FROM DAMAGE DUE TO SILTATION RUN-OFF AND DEWATERING PROCEDURES FROM THE CONSTRUCTION SITE.
- CONTRACTOR TO CONTACT UTILITY PROVIDERS AND CONFIRM THE LOCATION OF ALL UNDERGROUND, SURFACE AND OVERHEAD UTILITIES.
- CONTRACTOR SHALL EXERCISE EXTREME CAUTION WHEN EXCAVATING NEAR EXISTING UNDERGROUND SERVICES TO PREVENT DAMAGE TO SAME. CONTRACTOR TO REPAIR ANY DAMAGE AT THE CONTRACTOR'S EXPENSE.
- MAINTAIN MINIMUM DISTURBANCE IN ALL AREAS. CONTRACTOR SHALL RESTORE ALL AREAS DISTURBED TO A CONDITION EQUAL TO OR BETTER THAN EXISTED BEFORE CONSTRUCTION, ALL TO THE SATISFACTION OF THE DEPARTMENTAL REPRESENTATIVE. PROVIDE PROTECTION FOR ALL VEGETATION THAT IS TO REMAIN INCLUDING ROOTS FROM DAMAGE OR DISTURBANCE WHENEVER POSSIBLE.
- CONTRACTOR SHALL PROTECT EXISTING STRUCTURES AND PROVIDE ADEQUATE SUPPORT WHILE EXCAVATING.
- CONTRACTOR SHALL SUBMIT SCHEDULE, METHODOLOGY AND SEQUENCING OF CONSTRUCTION ACTIVITIES TO THE DEPARTMENTAL REPRESENTATIVE FOR REVIEW PRIOR TO START OF CONSTRUCTION.
- REMOVE ALL UNSUITABLE MATERIALS SUCH AS ORGANIC ROOT MAT, TOPSOIL, PEAT, ETC., FROM BENEATH PROPOSED WORKS UNTIL A SUITABLE SUBGRADE IS ENCOUNTERED. ACQUIRE APPROVAL TO PROCEED AND NOTIFY DEPARTMENTAL REPRESENTATIVE WHEN ALL UNSUITABLE MATERIAL IS REMOVED.
- IN AREAS REQUIRING FILL, ONLY SITE EXCAVATED MATERIAL OR IMPORTED MATERIALS APPROVED BY THE DEPARTMENTAL REPRESENTATIVE WILL BE PERMITTED.
- IN CUT AREAS AND PRIOR TO PLACEMENT OF FILL, THE SUB-GRADE SURFACE MUST BE COMPACTED AND PROOF-ROLLED TO SATISFACTION OF DEPARTMENTAL REPRESENTATIVE. INFORM THE DEPARTMENTAL REPRESENTATIVE PRIOR TO THIS WORK BEING PERFORMED.
- EXCAVATE ZONES OF GRUBBING OR OTHER HIGHLY ORGANIC MATERIALS, EXCESSIVELY WET SOILS, AND/OR DEBRIS AND REPLACE WITH APPROVED SUITABLE COMPACTED MATERIAL AS DIRECTED BY DEPARTMENTAL REPRESENTATIVE.
- CONTRACTOR SHALL COMPACT IN MAX. 150mm LIFTS TO 95% STANDARD PROCTOR DENSITY UNDER ALL LANDSCAPED AREAS, TO 100% STANDARD PROCTOR DENSITY UNDER ASPHALT PAVEMENT, CONCRETE SIDEWALKS, AND ALL OTHER AREAS TO BE COMPACTED TO 100% STANDARD PROCTOR DENSITY.
- ROADWAYS AND PARKING AREAS SHALL BE CONSTRUCTED IN ACCORDANCE WITH THE TYPICAL SECTIONS SHOWN.
- FINISH GRADES SHALL BE AS INDICATED ON THE DRAWINGS OR AS DIRECTED BY THE DEPARTMENTAL REPRESENTATIVE.
- ALL CONCRETE, CONCRETE MATERIALS, FORMS, PRACTICE, ETC. SHALL CONFORM TO CAN3-A23.1 UNLESS NOTED OTHERWISE. ALL CONCRETE TESTING SHALL CONFORM TO CAN3-A23.2.

HOT-MIX ASPHALT CONCRETE PAVING:

- ALL ASPHALT MATERIALS ARE TO BE TO THE PROVINCE OF NOVA SCOTIA DEPARTMENT OF TRANSPORTATION AND INFRASTRUCTURE RENEWAL SPECIFICATION - HIGHWAY CONSTRUCTION AND MAINTENANCE, LATEST EDITION.
- THE INTENT OF THE SPECIFICATION IS TO PROVIDE A HARD-WEARING, DURABLE, PROPERLY ROLLED DENSE ASPHALTIC PAVEMENT THAT IS SMOOTH, TRUE-TO-LINE WITH THE ESTABLISHED GRADE.
- THE CONTRACTOR SHALL BE RESPONSIBLE FOR REPAIRING ANY DEFECTIVE AREAS, DAMAGED LOW OR HIGH AREAS, EXISTING DISTURBED AREAS OR OTHER NON-ACCEPTABLE PAVEMENT.
- THE ASPHALT CONCRETE AND SUBGRADE SHALL BE PROVIDED BY THE CONTRACTOR TO MATCH THE PROVIDED STRUCTURE AND ASPHALT THICKNESS, ALL TO THE APPROVAL OF THE DEPARTMENTAL REPRESENTATIVE.
- THE CONTRACTOR SHALL USE WORKERS SKILLED IN THE PLACEMENT OF ASPHALT CONCRETE.
- THE CONTRACTOR IS TO PROVIDE DUST CONTROL MEASURES AS REQUIRED AND TO THE APPROVAL OF DEPARTMENTAL REPRESENTATIVE.
- THE CONTRACTOR SHALL PROVIDE ANY BARRIERS, LIGHTS, TRAFFIC CONTROL MEASURES AND OTHER EQUIPMENT AND SERVICES TO PROTECT THE WORKFORCE AND THE PUBLIC IN THE AREA OF THE WORK.
- ALL DAMAGE TO SURFACES AND LANDSCAPING SHALL BE REPAIRED AT THE CONTRACTOR'S EXPENSE.
- THE CONTRACTOR SHALL PLACE THE ASPHALT TO GRADES SHOWN AND THE CONTRACTOR SHALL TAKE EXTREME CARE TO ENSURE THAT NO PONDING OF WATER OCCURS ON THE NEWLY LAID ASPHALT. THE CONTRACTOR SHALL BE FULLY RESPONSIBLE TO REPAIR AND REGRADE ANY AREAS WHERE PONDING OCCURS.
- THE CONTRACTOR SHALL FINE GRADE THE GRANULAR BASE SURFACE PRIOR TO PLACEMENT OF ASPHALT MATERIALS. ADD OR REMOVE GRANULAR MATERIALS AS REQUIRED.
- TRANSPORT, PLACE AND COMPACT ASPHALT CONCRETE MIX TO THE PROVINCE OF NOVA SCOTIA DEPARTMENT OF TRANSPORTATION AND INFRASTRUCTURE RENEWAL STANDARD SPECIFICATION - 2011, HIGHWAY CONSTRUCTION AND MAINTENANCE.
- CONSTRUCT PAVEMENT WITHIN SPECIFIED TOLERANCES. CROSS SECTIONS AND DIMENSIONS AT LOCATIONS INDICATED.
- THE FINISHED ASPHALT SURFACE IS NOT TO HAVE IRREGULARITIES EXCEEDING 6mm WHEN CHECKED WITH A 3m STRAIGHT-EDGE PLACED IN ANY DIRECTION.

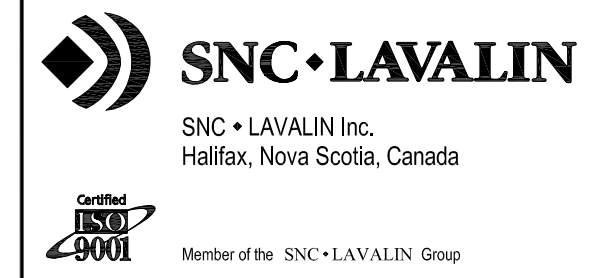
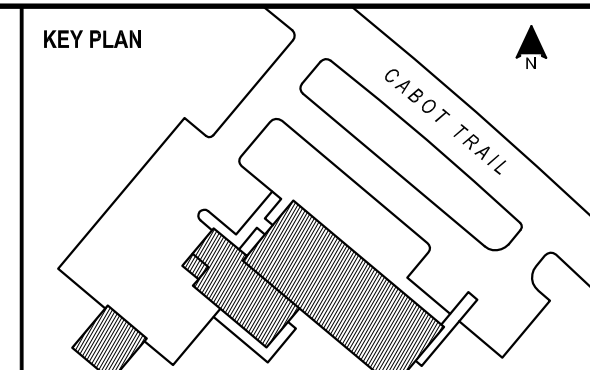

NOTES:
1. SEE DRAWINGS 504 FOR LIGHT STANDARD CONCRETE BASES.

C01	ISSUED FOR TENDER	18 JUL 2014
NO.	REVISION	DATE

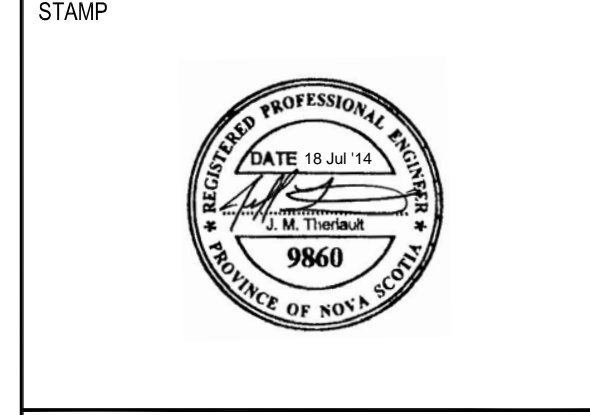

INGONISH CIVIC BUILDING
Project Address
DSRA JOB #: 12169
DRAWN BY: B.C.
CHECKED BY: J.T.
SCALE: AS INDICATED

SITE DETAILS AND GENERAL NOTES

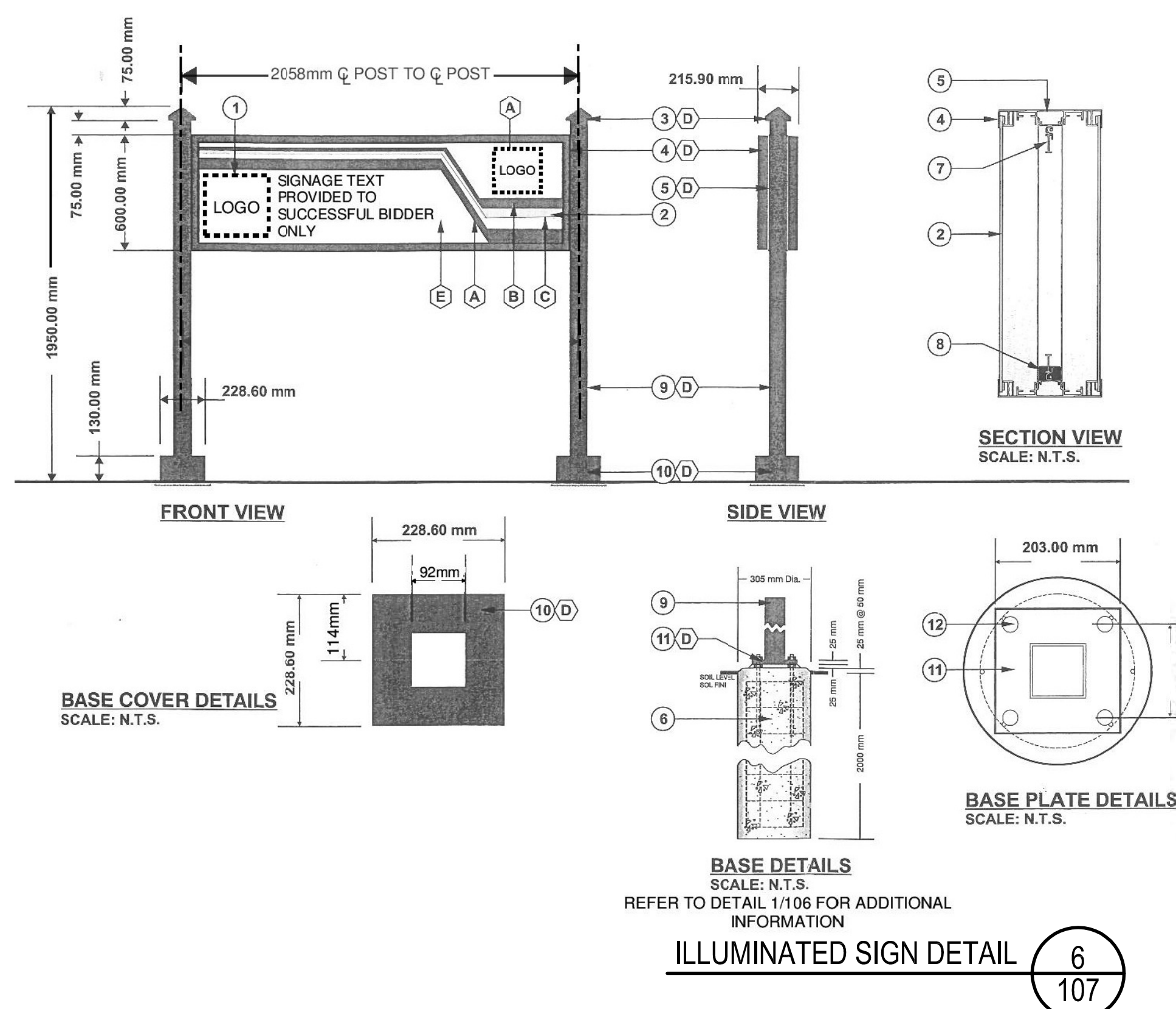

Installation:	Interior:	<input checked="" type="checkbox"/> Exterior:
Electrical specifications:		
Volts:	120	Amp.: 1.1 Circ.: 1
#	Description:	
1	LOGO PROVIDED BY OWNER TO SUCCESSFUL BIDDER	
2	5mm CLEAR LEXAN FACE WITH GRAPHIC APPLICATION ON SECOND SURFACE	
3	5mm ABS MOLDED END CAP	
4	ALUM. RETAINER	
5	ALUM. FILLER WITH RACEWAY COVER	
6	CONCRETE BASE	
7	WHITE LED GE TETRA STRIP SS WITH EXTRUSION	
8	POWER SUPPLY	
9	HSS 89 x 89 x 8mm x 1900mm (H) POST	
10	BASE COVER METAL 24 GA.	
11	203 x 203 x 25mm STEEL BASE PLATE	
12	19mm DIA. HOLE FOR 13mm DIA. ANCHORS	
#	Colors:	
A	BLUE VINYL #3630-167	
B	RED VINYL #3630-33	
C	YELLOW VINYL #3630-015	
D	PAINTED TO MATCH BLUE VINYL #3630-167	
E	WHITE VINYL # 3630-20	

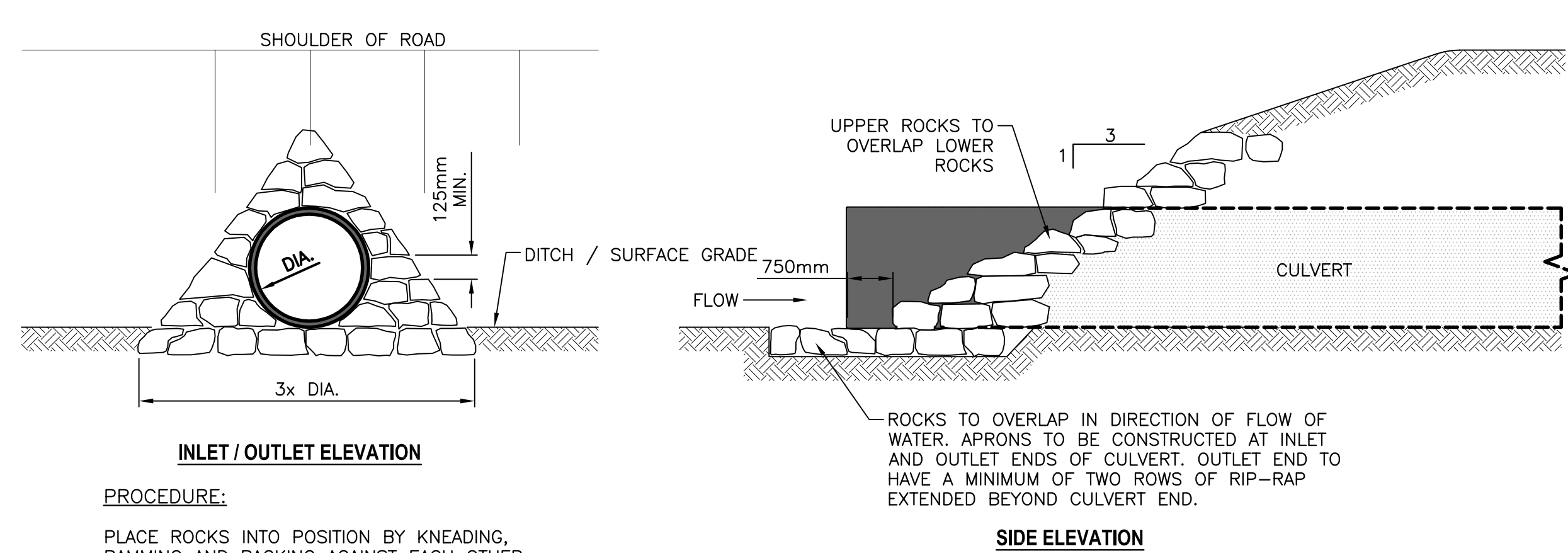

INLET / OUTLET ELEVATION
PROCEDURE:
PLACE ROCKS INTO POSITION BY KNEADING, RAMMING AND PACKING AGAINST EACH OTHER TO FORM A CLOSELY MOULDED AND UNIFORM LAYER AVERAGING NOT LESS THAN 125 mm IN THICKNESS. PLACE ROCKS IN A STAGGERED PATTERN SUCH THAT ANY ROCK (EXCEPT AT THE BOTTOM) WILL REST ON TWO OR MORE OTHER ROCKS.

SIDE ELEVATION
ROCKS TO OVERLAP IN DIRECTION OF FLOW OF WATER. APRONS TO BE CONSTRUCTED AT INLET AND OUTLET ENDS OF CULVERT. OUTLET END TO HAVE A MINIMUM OF TWO ROWS OF RIP-RAP EXTENDED BEYOND CULVERT END.

CULVERT END RIP-RAP

5
107