

**NORR Limited**  
As part of the NORR Group  
175 Bloor St. East, Suite 1000  
Toronto, Ontario M4W 3B8  
www.norr.com

This drawing shall not be used for construction purposes without the approval of the architect and the engineer.

2	ALUMINUM	2017.08.02
revision	description	date
1	ALUMINUM	2017.08.02

A	C	A	C
no. de l'élément	no. de l'élément	no. de l'élément	no. de l'élément
no. de l'élément	no. de l'élément	no. de l'élément	no. de l'élément

**WELLINGTON BUILDING  
RENOVATION**

**180 WELLINGTON STREET  
OTTAWA, ONTARIO**

**SIXTH FLOOR FURNITURE  
PLAN OVERALL/ SIXIEME  
ETAGE PLAN DE MEUBLES  
GLOBALE**

Designed By: D. LUSK  
Drawn By: A. SAMONTI / C. LEWIS  
Reviewed By: M. DE JEAN  
Approved By: S. KASASAKA  
Date: 2017.08.02

Project Manager: T. MONTFORT  
Project no.: R.009790.059

Drawing no.: A90-06-00  
No. du dessin

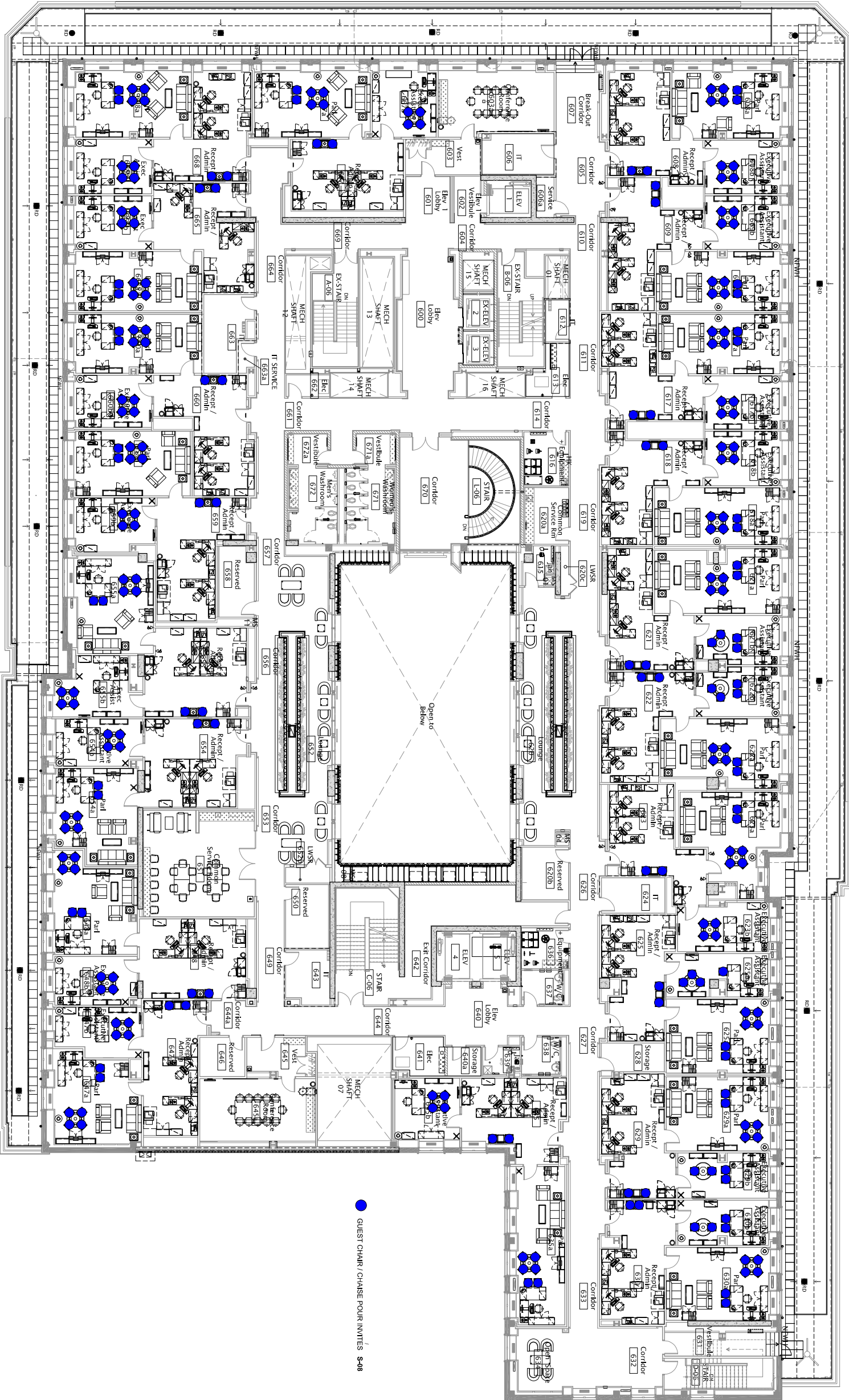

● GUEST CHAIR / CHAISE POUR INVITES S-08

**RFP PACKAGE/ DOCUMENT 4  
SIXTH FLOOR INSTALL PLAN/  
SIXIEME ETAGE INSTALLER PLAN**

A90-06-00

SCALE: 1/8" = 1'-0"