

The following amendments to drawings and specifications shall be incorporated into, and forms part of, the contract.

SPECIFICATIONS

ARCHITECTURAL

08 71 00 – Hardware

1. Item 40
 - a. Revise to read “SINGLE DOOR TYPE-H CORRIDOR 201 TO ROOM 211”
2. Item 41
 - a. Revise to read “SINGLE DOOR TYPE-H CORRIDOR 201 TO ROOM 212”

07 44 33 – Glass-Fibre Reinforced Cementitious Panels

1. Section 2.1, Article 2, Item 1, Changed to Read: Product: EQUITONE-Tectiva, manufactured by Euro Panels/Etex Group.

07 61 00 – Metal Roofing

1. Section 2.1, Replace wording of Article 1 with the following: Roof assembly to be engineered to comply with a UL 580, Class 90 performance.
2. Section 2.1, Delete Articles 2, 3, and 4.

09 30 00 – Porcelain Tile Products

1. Section 2.1, Article 1, add the following note: “The following series by Olympia are also pre-approved alternates: Quebec series for shower/washroom/locker room floors, Ontario series for shower/washroom/locker room walls, and Unicolour series for vestibules and lobby”.
2. Section 2.1, Article 1, add the following note: “All tile of same colour, whether floor, wall, trims, bases and coved bases, must be from same dye-lot.”
3. Section 2.1, Article 3.1, add the following note: “50mm x 50mm mosaic is also acceptable”
4. Section 2.1, Article 2, Coefficient of Friction, change to read: 0.45 or greater per the DCOF AcuTest.
5. Section 2.1, Delete Articles 2, 3, and 4.

36 13 – Sectional Doors

1. Section 2.1, Article 1, change text ‘422 Series’ to read ‘418 Series’. Delete sentence “Steelcraft Series ‘ThermoDoor 134’ or Richard Wilcox Overhead Sectional Door Model T175 are pre-approved alternates.”
2. Section 2.1, Article 2 Sectional Door Assembly to read:

- a. Panel thickness: minimum 45mm (1 3/4")
 - b. Exterior Surface: Ribbed or flush
 - c. Sheet Steel: Minimum 1.6mm (16 gauge) galvanized exterior, inside cover 20 gauge steel.
 - d. Centre and End Stiles of 16 gauge steel.
 - e. Standard Springs: 10,000 cycles.
 - f. Reinforcing Provide vertical steel stiffeners at maximum 762mm o.c.
3. Section 2.1, Article 5 revise to read: 'Insulation: insulation will be composed of Polyiso Insulation with a minimum R-Value of 7.35.'
 4. Section 2.1, Article 9 revise to read: 'Hinges: heavy duty, minimum of four per section, bolted and spaced at a maximum of 450 mm o.c.'
 5. Section 2.1, Article 10, delete in its entirety.
 6. Section 2.1, Article 13, item 3 revise to read: 'High cycle springs rated at a minimum 10,000 cycles.'

MECHANICAL

21 30 00 - Fire Pumps

1. Revise 2.2.3.4 to delete requirement for main relief and open waste cone.
2. Revise 2.3.5 to read "Electrical: 575V, 1PH
3. Revise 2.3.7 to read "Capacity: 0.3 l/s at 275 kPa (40 PSI) total head.

DRAWINGS

ARCHITECTURAL

Drawing 301

1. At exterior door near Grids 6/D, Add Door Tag: '112A' w/ sub-note 'RC'

Drawing 303

1. Revise R1 Roof Assembly to read:

Standing Seam Metal Roof System
Air Barrier
16mm T&G Plywood Sheathing
200mm (Two Layers) Polyiso Insulation w/ criss-crossed z-girts
Air Vapour Barrier
16mm T&G Plywood Sheathing
Wood Trusses (See Structural)

Drawing 360

1. DOOR SCHEDULE
 - a. 111A, Frame Type - Revise to read "PSF"

- b. 111A, Door Type - Revise to read "HM"
- c. Revisions to Door Elevations per ASK 30

MECHANICAL

Drawing 413

- 1. Revisions to diffuser grill designations per attached MSK-413-02

END OF ADDENDUM NO. 6

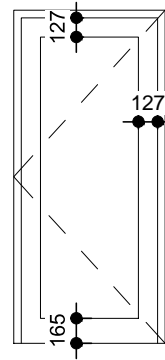

A

900 x 2150 x 45
HEAVY DUTY INSTITUTIONAL
ALUMINUM DOOR
SEALED DOUBLE SECURITY
GLASS - SEE GLAZING
SCHEDULE
ALUM. FRAME

Aa

AS ABOVE EXCEPT SINGLE GLAZED
6mm SECURITY GLASS - SEE
GLAZING SCHEDULE

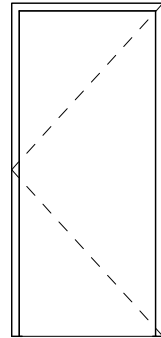

B

900 x 2150 x 45
INSULATED HOLLOW
METAL DOOR
THERMALLY BROKEN
P.S.F.

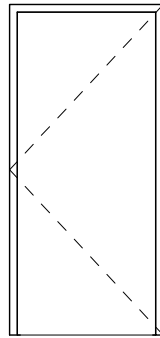

C

900 x 2150 x 45
HOLLOW METAL DOOR
P.S.F.
45 MIN. ULC FIRE RATING

Ca

AS ABOVE EXCEPT
1 1/2 HR ULC RATING

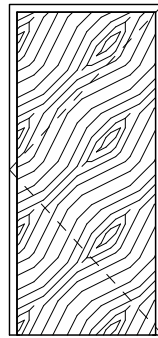

D

900 x 2150 x 45
SOLID CORE WOOD
P.S.F.

Da

AS ABOVE EXCEPT
750 x 2150 x 45

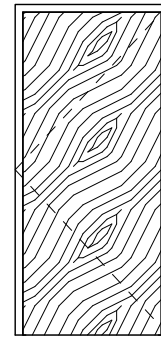

E

900 x 2150 x 45
SOLID CORE WOOD
SOUND RATED DOOR & FRAME
ASSEMBLY AS SPECIFIED
ACOUSTICAL STC-50
NOTE FILL DOOR FRAME W/ SPRAY
FOAM INSULATION

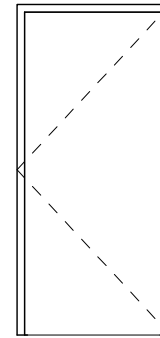

Ea

900 x 2150 x 45
METAL
SOUND RATED DOOR & FRAME
ASSEMBLY AS SPECIFIED
ACOUSTICAL STC-50
NOTE FILL DOOR FRAME W/ SPRAY
FOAM INSULATION

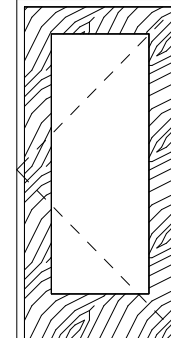

F

900 x 2150 x 45
SOLID CORE WOOD
SINGLE GLAZED
ALUMINUM FRAME

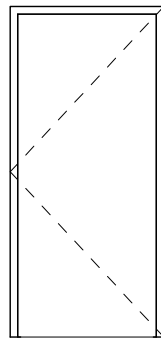

G

900 x 2150 x 45
HOLLOW METAL DOOR
P.S.F.

Ga

AS ABOVE EXCEPT
700X2150X45

Gb

AS ABOVE EXCEPT
1065X2150X45

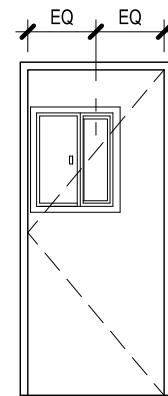

H

900 x 2150 x 45
HOLLOW METAL DOOR
P.S.F.
SWING, RECESSED BUTT FRAME
W/ VIEWPORT
(PRISONER SHOWER, BREATH
TEST, AND PHOTO FINGERPRINT)

Ha

AS ABOVE EXCEPT
810 x 2100 x 45
W/O VIEWPORT
(MECHANICAL CHASE DOOR)

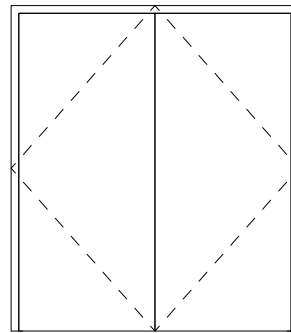

J

2 - 900 x 2150 x 45
HOLLOW METAL DOOR
P.S.F.
W/ WELDED STEEL ASTRAGAL

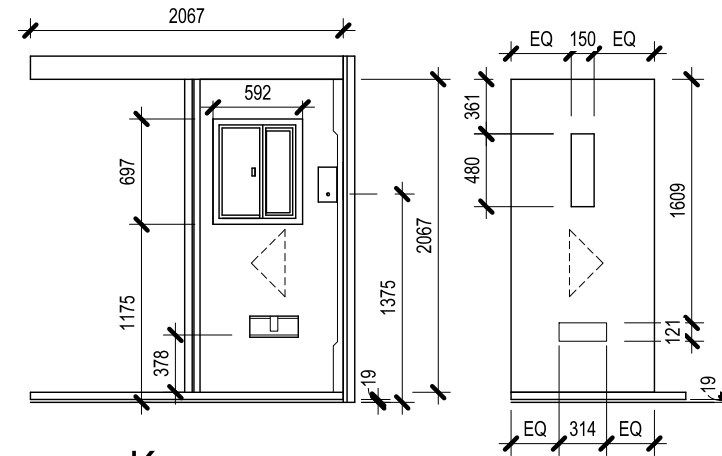

K

978 x 2067 x 52
DETENTION CELL DOOR
W/ VIEWPORT
45 DEGREE ANGLED FRAME

DETENTION CELL DOOR (K)
INTERIOR

REFERENCE DRAWING: DOOR SCHEDULE ELEVATION SHEET 360

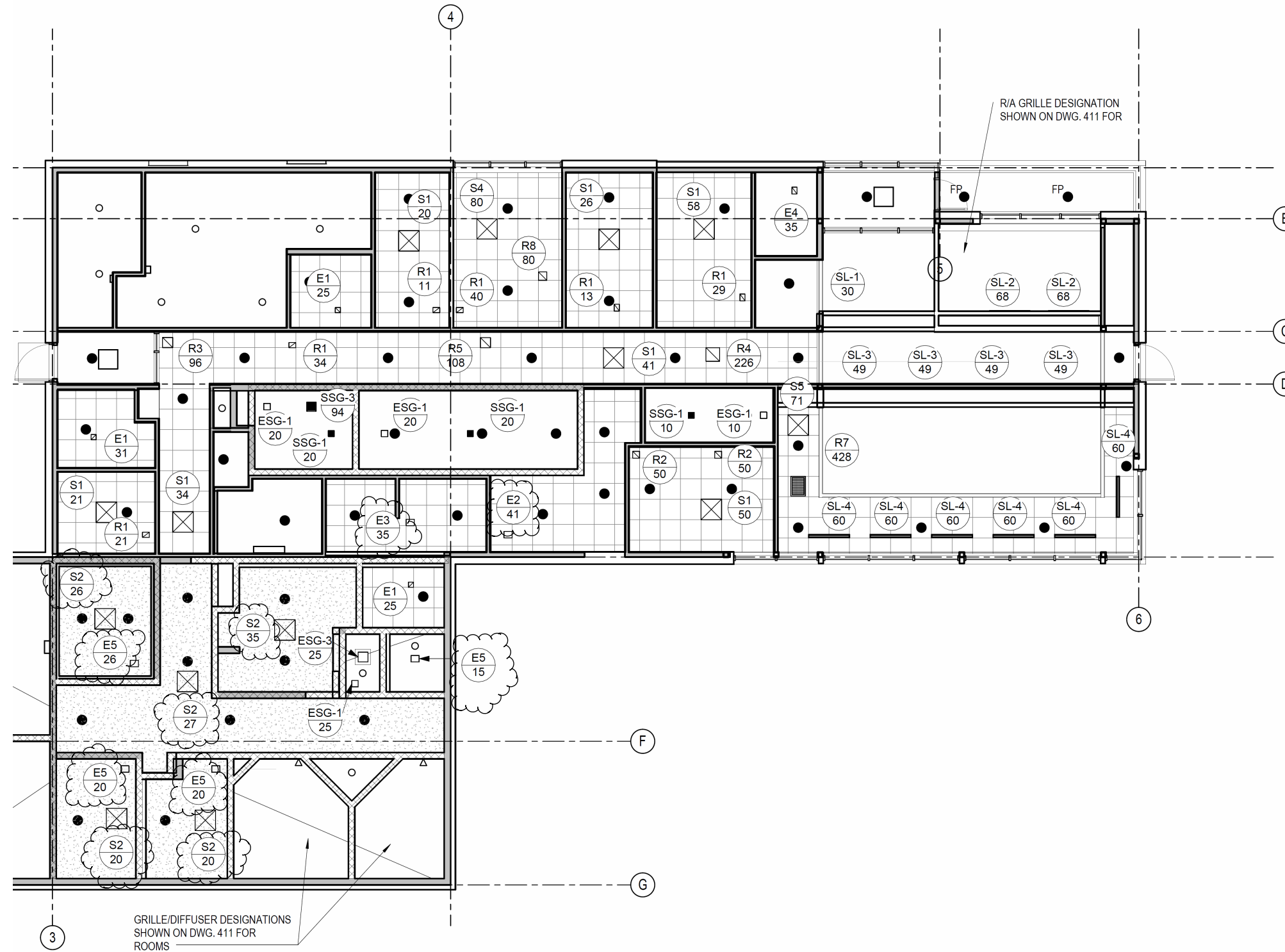

REF. DWG NO. 413

REV.	DATE	DESCRIPTION	APPR.
C02	2014/09/02	ISSUED FOR ADDENDUM # 6	PG
C01	2014/08/18	ISSUED FOR ADDENDUM #1	PG

SNC • LAVALIN
 SNC LAVALIN Inc.
 Halifax, Nova Scotia, Canada
 Certified ISO 9001
 Member of the SNC-Lavalin Group

PROJECT: INGONISH CIVIC BUILDING
 SUBJECT: GRILLE DIFFSUER DESIGNATIONS
 DATE: 15 AUG 2014

APPROVED: APPROUVÉ: PAR:	PG	<i>P.D.</i>
SCALE: ÉCHELLE:	N.T.S.	
DRAWING NO.: NUMÉRO DU DESSIN:	MSK-413-02	