

1. PROPONENTS ARE TO BID ON PERSONAL STORAGE TOWERS ONLY. ALL OTHER FURNITURE ITEMS INCLUDED IN DRAWINGS ARE FOR INFORMATION ONLY AND WILL NOT FORM PART OF THE CONTRACT.
2. NIC = NOT IN CONTRACT.
3. REFER TO DRAWINGS F-1A; F-1B & F-2 FOR PERSONAL STORAGE TOWER QUANTITIES, LOCATIONS AND RIGHT/LEFT HANDED WARDROBE DOOR HINGE ORIENTATIONS.

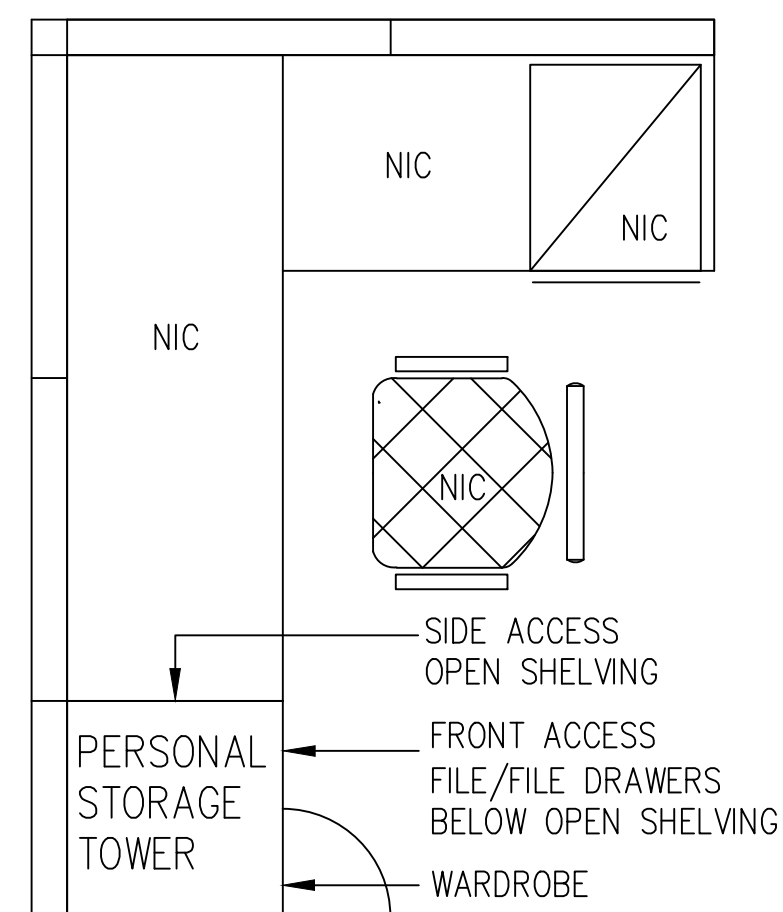

1 PERSONAL STORAGE TOWER LEGEND
F-2 SCALE: NOT TO SCALE

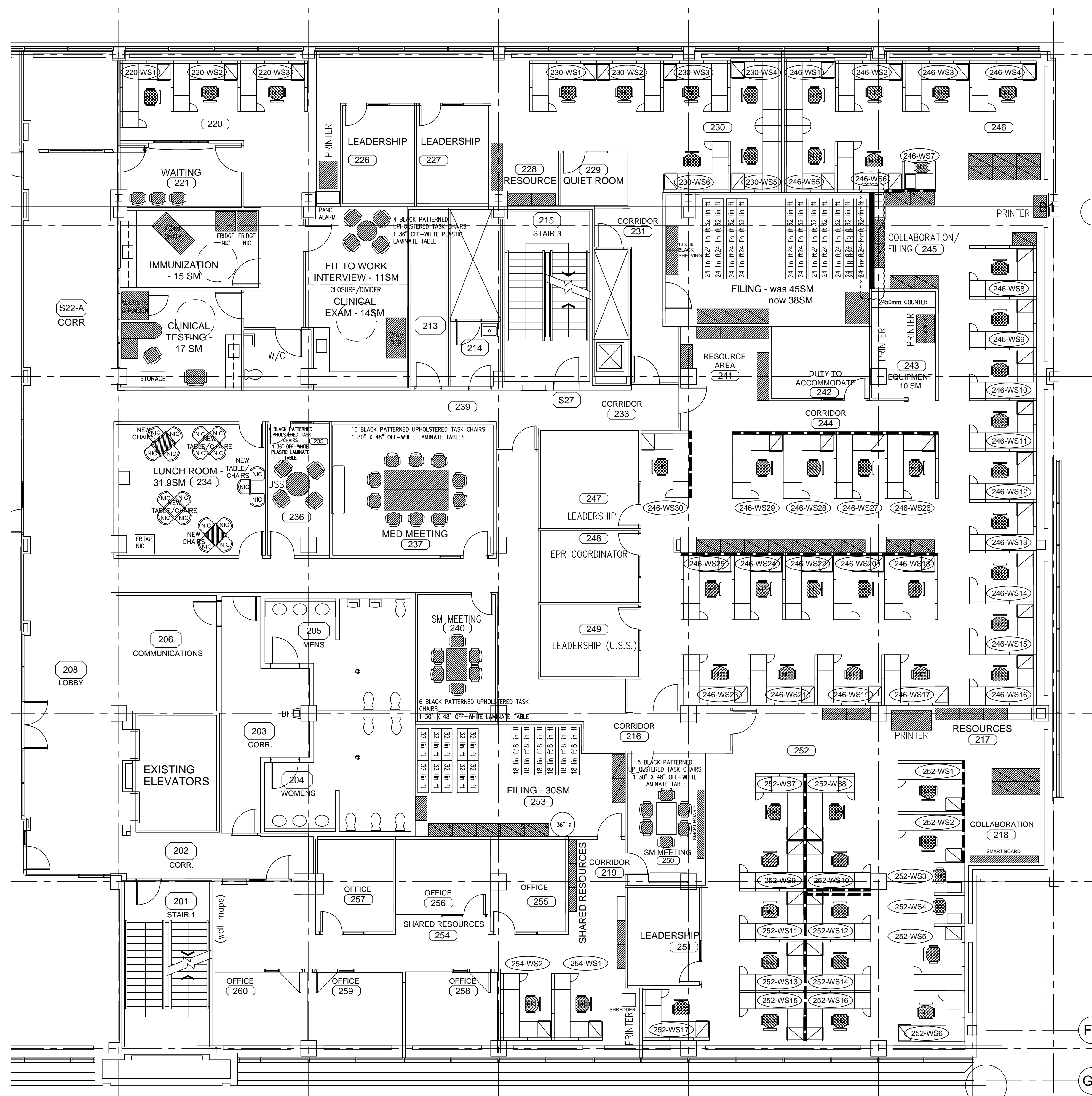

3 FURNITURE LAYOUT (2ND FLOOR - EAST)
F-2 SCALE: 1:80

DO NOT SCALE DRAWINGS		
5		
4	FURNITURE LAYOUT	JAN. 6, 2014
3	FURNITURE LAYOUT	DEC. 9, 2013
2	FURNITURE LAYOUT	NOV. 26, 2013
1	FURNITURE LAYOUT	NOV. 26, 2013
0	FURNITURE LAYOUT	SEP. 18, 2013
Revision/ Revision	Description/Description	Date/Date
Client/client		

**PUBLIC WORKS CANADA
GOVERNMENT SERVICES
CANADA**

100-167 LOMBARD AVENUE
PO BOX 1408
WINNIPEG, MANITOBA R3C 2Z1

Project title/Titre du projet

STANLEY KNOWLES FIT-UP
391 YORK AVENUE

Approved by/Approuvé par
JK

Designed by/Concept par
IDEATE DESIGN/PRAIRIE ARCHITECTS INC.

Drawn by/Dessine par	
----------------------	--

RA
PWGSC Project Manager/Administrateur de Projets TPSGC
OH

PWGSC, Architectural and Engineering Resources Manager/
Ressources Architectural et de Directeur d'Ingénierie, TPSGC

Client/client

PWGSC

Drawing title/Titre du dessin

2ND FLOOR FURNITURE LAYOUT / TYPICAL WORKSTATIONS & PRIVATE OFFICES LAYOUT

Project No./No. du projet 2012.49	Sheet/Feuille F-2	Revision no./La Révision no. 4
---	-----------------------------	--