



OVERALL
SITE PLAN

A	A. detail no.	A
C	B. location drawing no.	B/C
	C. drawing no.	

INSTITUTION
PE SAKASTEW CENTER
HOBBEMA, AB

DESCRIPTION
OVERALL SITE PLAN

SCALE
1: 1500

LAST UPDATE
SEPTEMBER 10 2013

DRAWN BY: MIKE GUININE
UPDATED BY: R. RAWL K

LEGEND

R100	LIVING LODGE B-F	F	ELDERS LODGE/FPV
R200	LIVING LODGE	G	SWEAT LODGE
R300	LIVING LODGE	H	MAINTENANCE/STORAGE
R400	LIVING LODGE	J	STORAGE QUANCET
R500	LIVING LODGE	K	MECHANICS SHOP
R600	LIVING LODGE	M	MAINTENANCE BUILDING
C	CEREMONIAL LODGE	P	PROGRAMS BUILDING
D	WATER/SEWAGE TREATMENT PLANT	R	FINANCE TRAILER
E	MAIN LODGE	S	PROGRAMS TRAILER

Existing DWAS Cable runs
(Cable is 2 strand, 16ga with 1 drain wire)

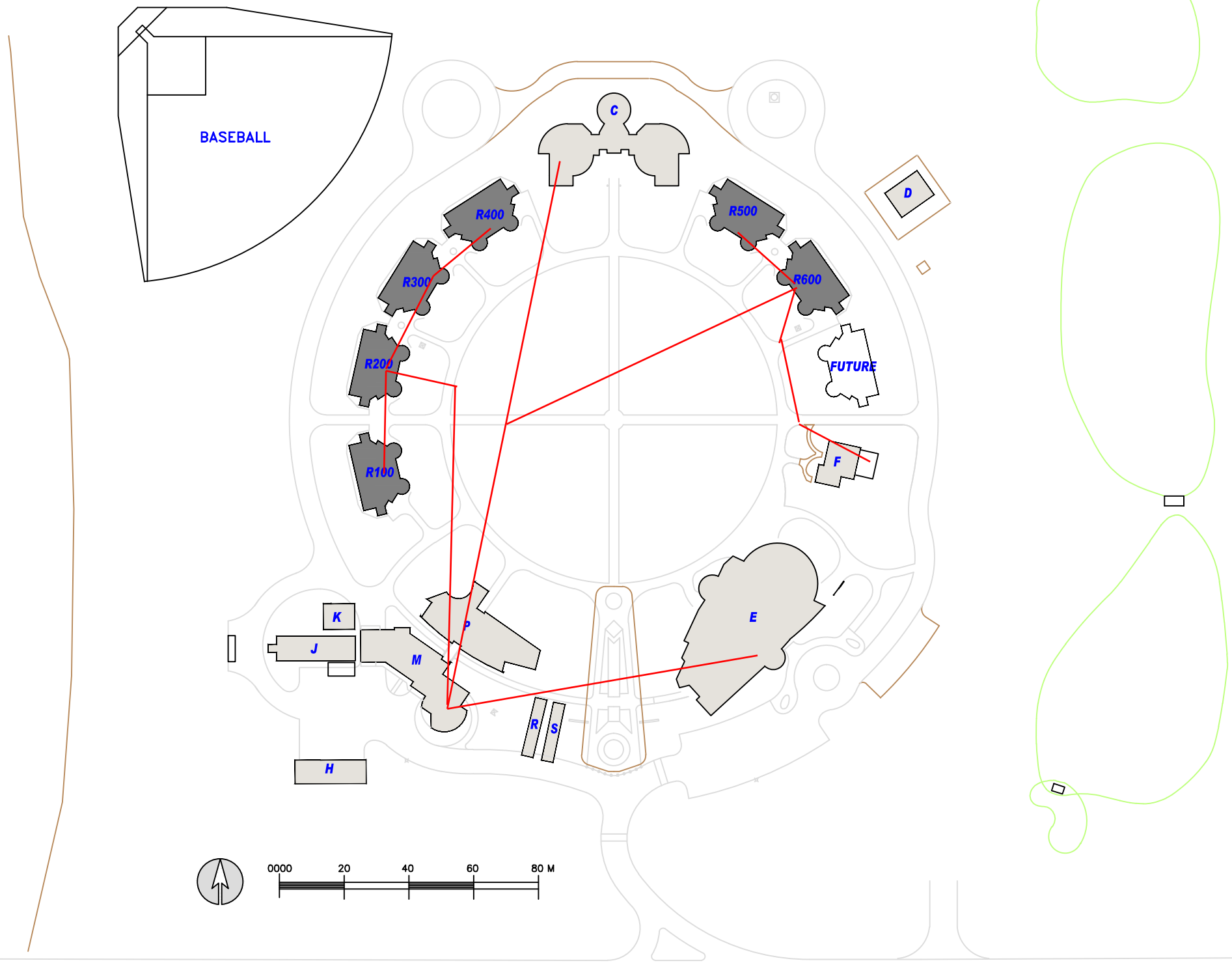



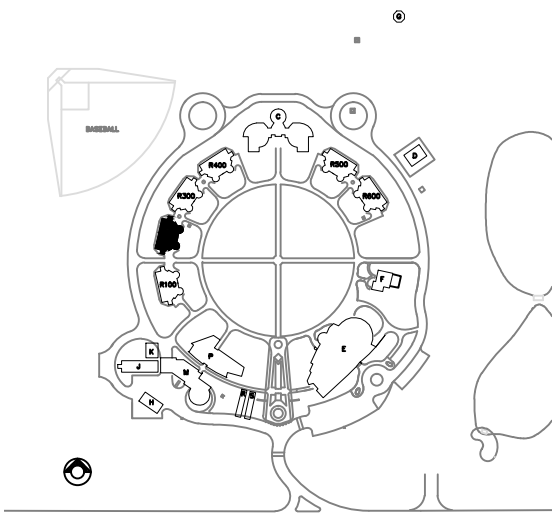



KEYPLAN

LEGEND

-  Existing Magnetic Door contact
-  New Magnetic Door Contact

ROOM LEGEND

- R216 LAUNDRY
- R217 WASHROOM
- R218 SHOWER
- R219 SHOWER
- R220 CORRIDOR
- R221 BEDROOM
- R222 BEDROOM
- R223 BEDROOM
- R224 BEDROOM
- R225 BEDROOM
- R226 VESTIBULE
- R227 BARRIER FREE WASHROOM
- R228 DINING ROOM
- R229 LIVING ROOM
- R230 KITCHEN
- R231 ENTRY
- R232 MECHANICAL ROOM

ROOM LEGEND

- R200 ENTRY
- R201 KITCHEN
- R202 LIVING ROOM
- R203 DINING ROOM
- R204 VESTIBULE
- R205 WASHROOM
- R206 CORRIDOR
- R207 BEDROOM
- R208 BEDROOM
- R209 BEDROOM
- R210 BEDROOM
- R211 BEDROOM
- R212 LAUNDRY
- R213 SHOWER
- R214 SHOWER
- R215 WASHROOM

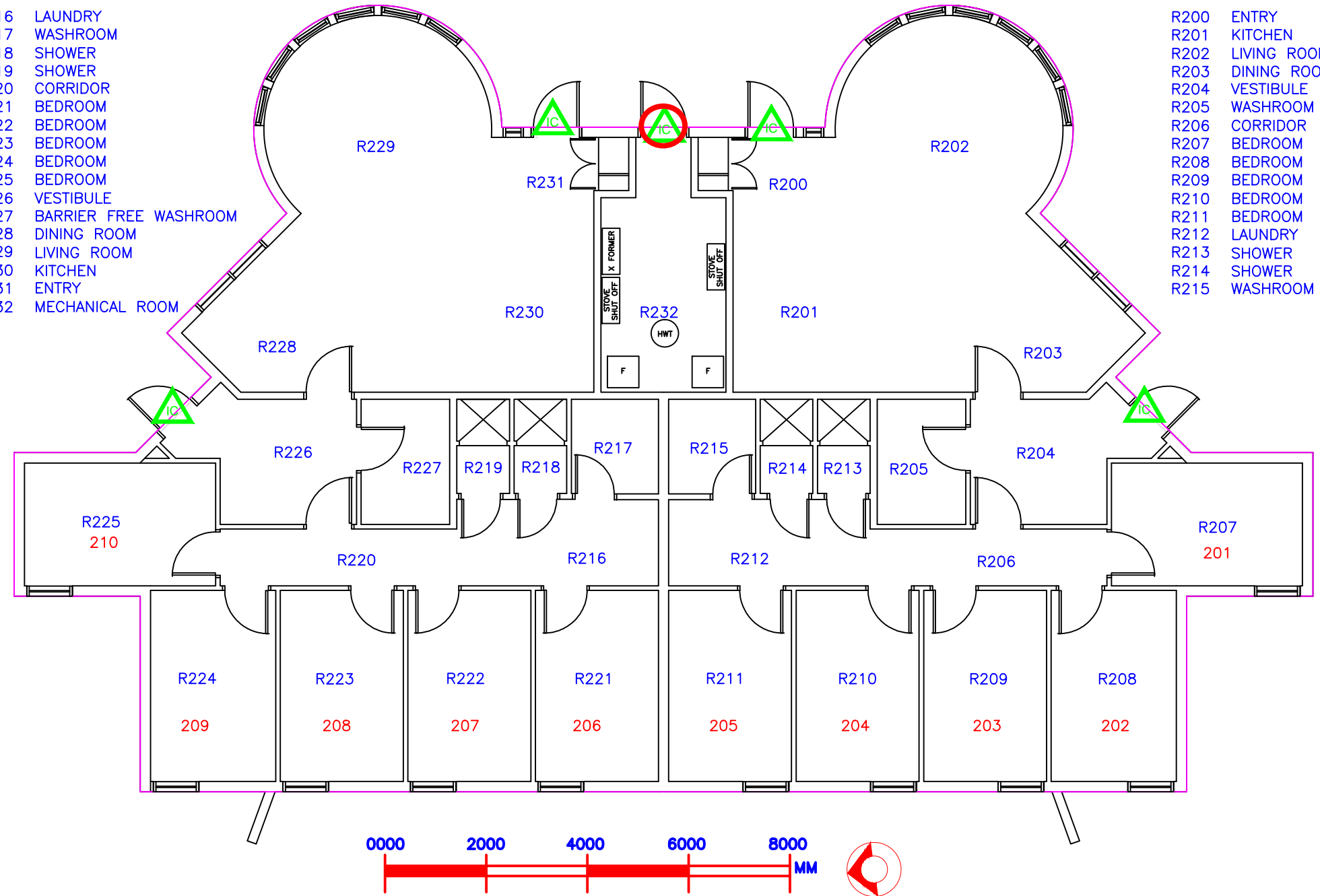

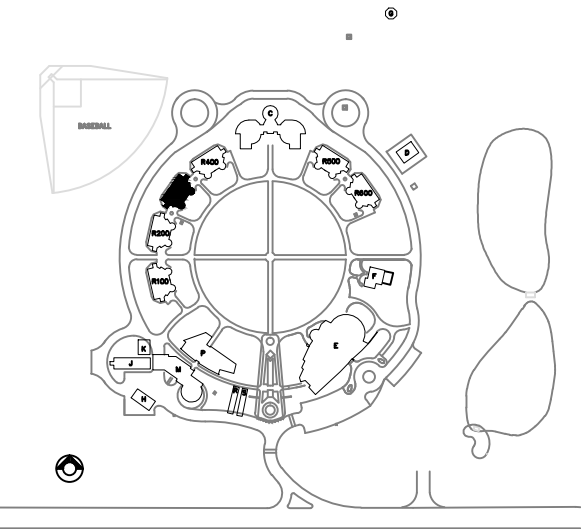

INSTITUTION	
Pê Sâkâstêw Centre HOBBEWA, AB	
TAG #	BUILDING #
535-12	R200
BUILDING NAME	
LIVING LODGE 2	
FLOOR	GROUND
AREA	284.18 SQ.M
SCALE	1:100
DATE SIGNED:	
APPROVED BY:	
LAST UPDATE	
MARCH 6 2012	
DRAWN BY:	D. GADDES
UPDATED BY:	R. RAWLYN



KEYPLAN

LEGEND

-  Existing Magnetic Door contact
-  New Magnetic Door Contact

ROOM LEGEND

- R316 LAUNDRY
R317 WASHROOM
R318 SHOWER
R319 SHOWER
R320 CORRIDOR
R321 BEDROOM
R322 BEDROOM
R323 BEDROOM
R324 BEDROOM
R325 BEDROOM
R326 VESTIBULE
R327 BARRIER FREE WASHROOM
R328 DINING ROOM
R329 LIVING ROOM
R330 KITCHEN
R331 ENTRY
R332 MECHANICAL ROOM

ROOM LEGEND

- R300 ENTRY
R301 KITCHEN
R302 LIVING ROOM
R303 DINING ROOM
R304 VESTIBULE
R305 WASHROOM
R306 CORRIDOR
R307 BEDROOM
R308 BEDROOM
R309 BEDROOM
R310 BEDROOM
R311 BEDROOM
R312 LAUNDRY
R313 SHOWER
R314 SHOWER
R315 WASHROOM

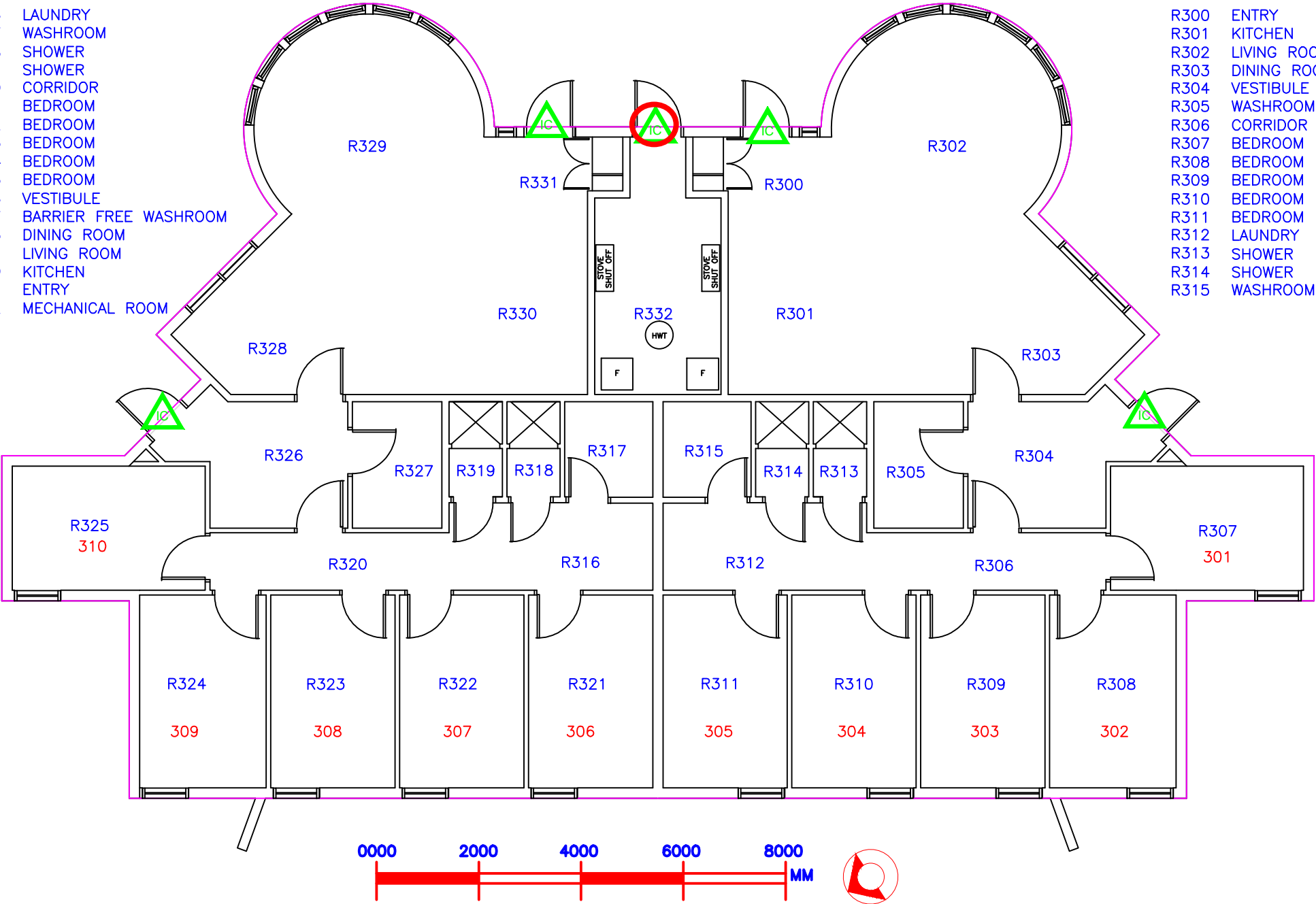

INSTITUTION

**Pê Sâkâstêw Centre
HOBBEMA, AB**

TAG # **535-11** BUILDING # **R300**

BUILDING NAME
LIVING LODGE 3

FLOOR **GROUND**

AREA **284.18 SQ.M**

SCALE **1:100**

DATE SIGNED:



APPROVED BY:

LAST UPDATE

FEBRUARY 24 2013

DRAWN BY: D.GADDES
UPDATED BY: R.RAWLYN

LEGEND

-  Existing Magnetic Door contact
-  New Magnetic Door Contact

ROOM LEGEND

- R416 LAUNDRY
- R417 WASHROOM
- R418 SHOWER
- R419 SHOWER
- R420 CORRIDOR
- R421 BEDROOM
- R422 BEDROOM
- R423 BEDROOM
- R424 BEDROOM
- R425 BEDROOM
- R426 VESTIBULE
- R427 BARRIER FREE WASHROOM
- R428 DINING ROOM
- R429 LIVING ROOM
- R430 KITCHEN
- R431 ENTRY
- R432 MECHANICAL ROOM

ROOM LEGEND

- R400 ENTRY
- R401 KITCHEN
- R402 LIVING ROOM
- R403 DINING ROOM
- R404 VESTIBULE
- R405 WASHROOM
- R406 CORRIDOR
- R407 BEDROOM
- R408 BEDROOM
- R409 BEDROOM
- R410 BEDROOM
- R411 BEDROOM
- R412 LAUNDRY
- R413 SHOWER
- R414 SHOWER
- R415 WASHROOM

KEYPLAN

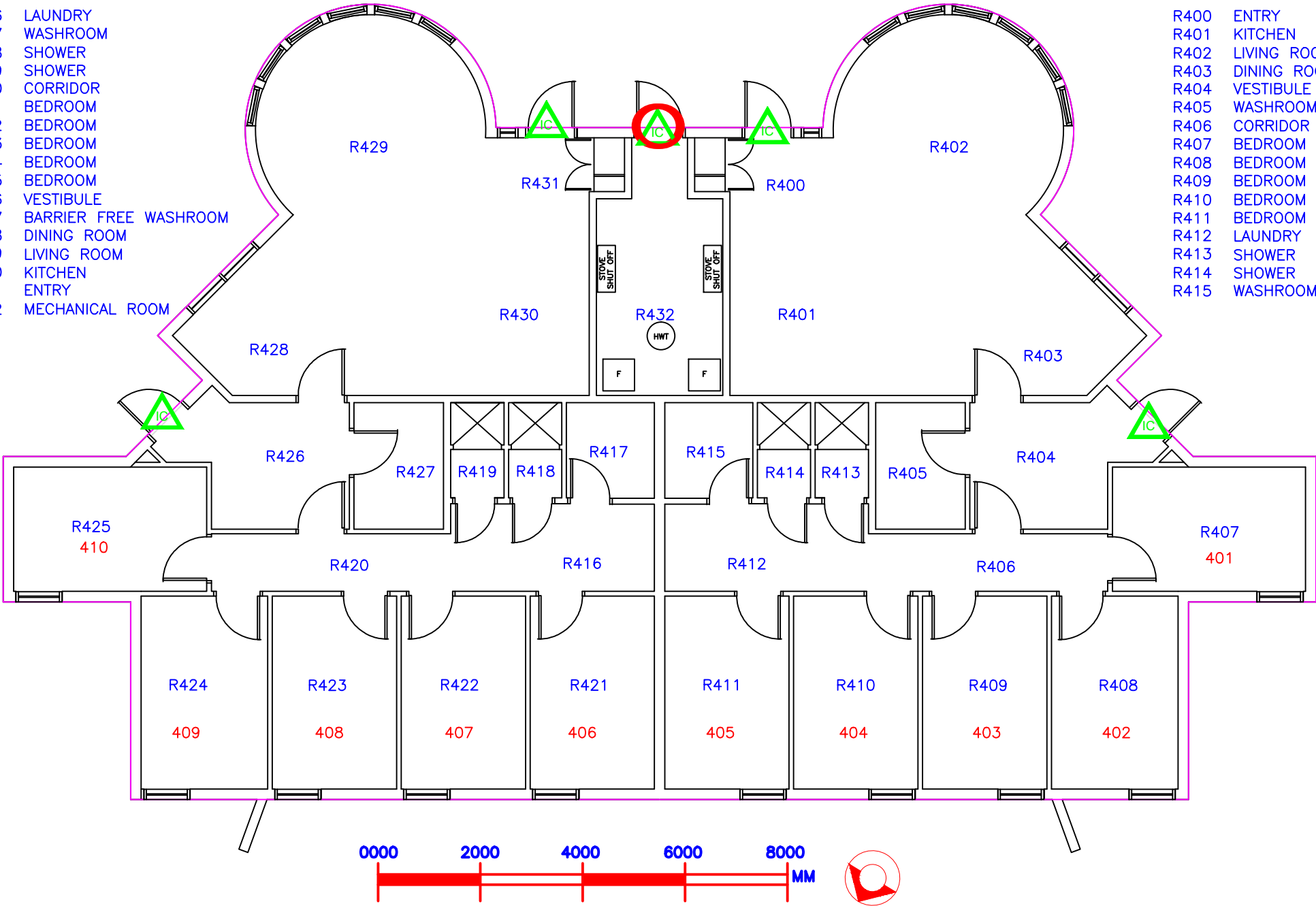

INSTITUTION
**Pê Sâkâstêw Centre
HOBBEWA, AB**

TAG # **535-10** BUILDING # **R400**

BUILDING NAME
LIVING LODGE 4

FLOOR **GROUND**

AREA **284.18 SQ.M**

SCALE **1:100**

DATE SIGNED: _____

APPROVED BY: _____

LAST UPDATE **FEBRUARY 24 2013**

DRAWN BY: D.GADDES
UPDATED BY: R.RAWLYN

LEGEND



Existing Magnetic
door contact



New Magnetic
Door Contact

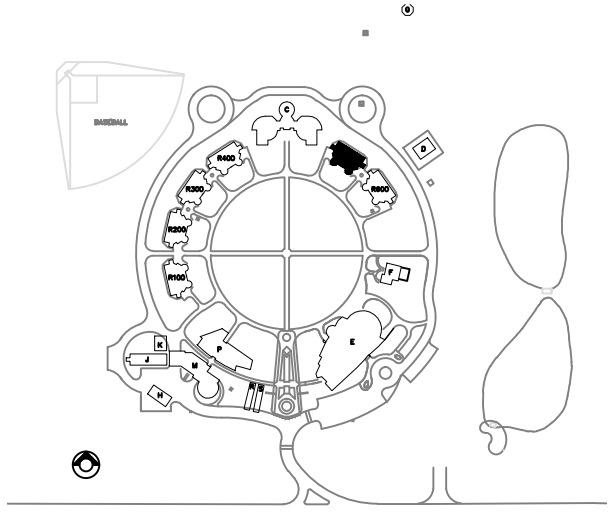

KEYPLAN

ROOM LEGEND

- R516 LAUNDRY
- R517 WASHROOM
- R518 SHOWER
- R519 SHOWER
- R520 CORRIDOR
- R521 BEDROOM
- R522 BEDROOM
- R523 BEDROOM
- R524 BEDROOM
- R525 BEDROOM
- R526 VESTIBULE
- R527 BARRIER FREE WASHROOM
- R528 DINING ROOM
- R529 LIVING ROOM
- R530 KITCHEN
- R531 ENTRY
- R532 MECHANICAL ROOM

ROOM LEGEND

- R500 ENTRY
- R501 KITCHEN
- R502 LIVING ROOM
- R503 DINING ROOM
- R504 VESTIBULE
- R505 WASHROOM
- R506 CORRIDOR
- R507 BEDROOM
- R508 BEDROOM
- R509 BEDROOM
- R510 BEDROOM
- R511 BEDROOM
- R512 LAUNDRY
- R513 SHOWER
- R514 SHOWER
- R515 WASHROOM

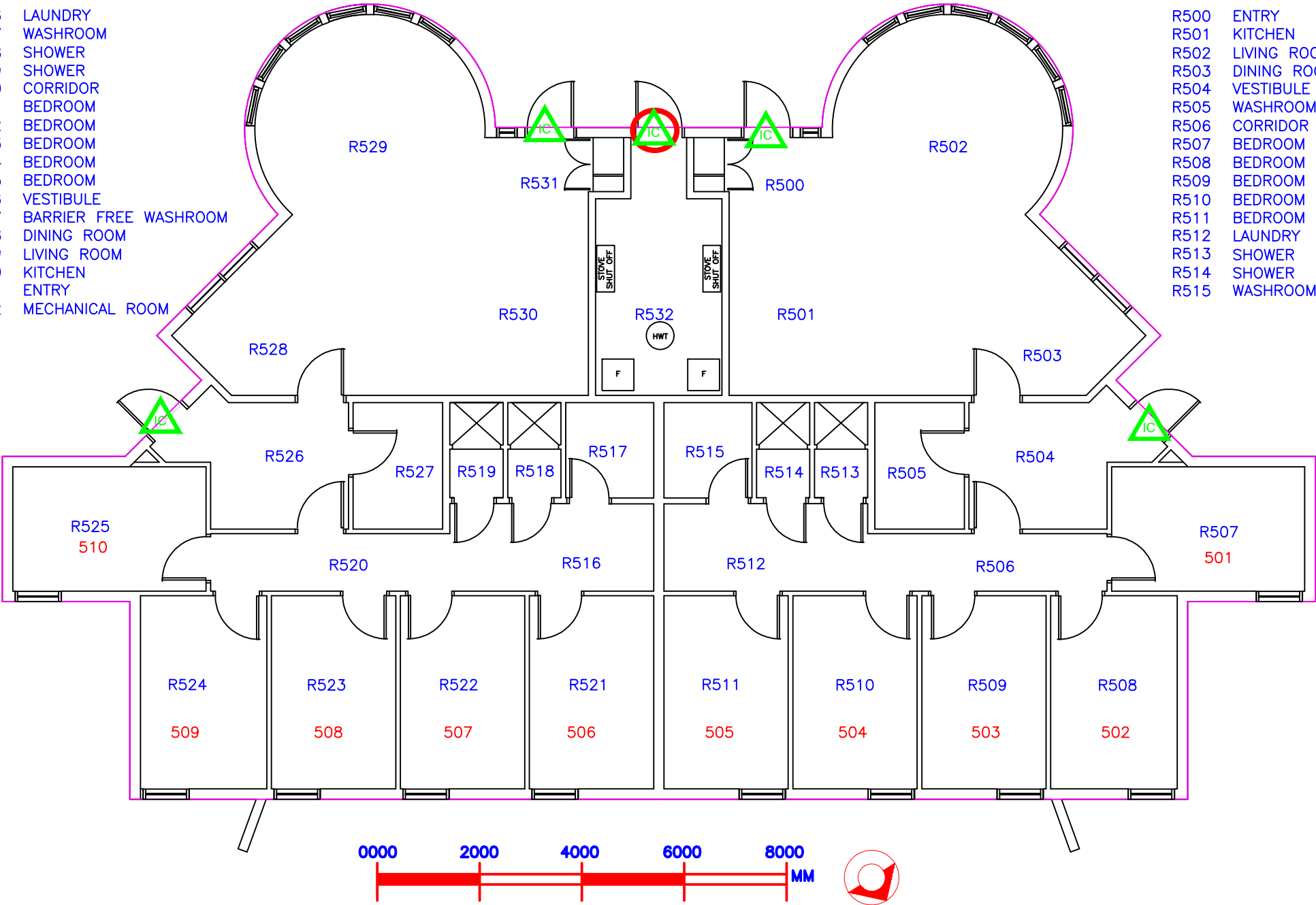

INSTITUTION

**Pê Sâkâstêw Centre
HOB BEMA, AB**

TAG # **535-07** BUILDING # **R500**

BUILDING NAME
LIVING LODGE 5

FLOOR **GROUND**

AREA **284.18 SQ.M**

SCALE **1:100**

DATE SIGNED:



APPROVED BY:

LAST UPDATE

FEBRUARY 24 2013

DRAWN BY: D.GADDES
UPDATED BY: R.RAWLYN

LEGEND

-  Existing Magnetic Door contact
-  New Magnetic Door Contact

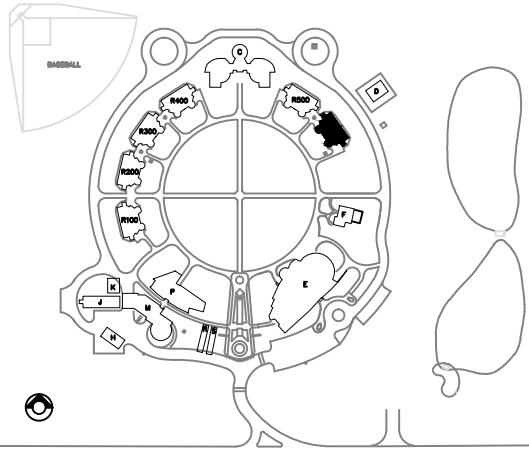

KEYPLAN

ROOM LEGEND

- R616 LAUNDRY
- R617 WASHROOM
- R618 SHOWER
- R619 SHOWER
- R620 CORRIDOR
- R621 BEDROOM
- R622 BEDROOM
- R623 BEDROOM
- R624 BEDROOM
- R625 BEDROOM
- R626 VESTIBULE
- R627 BARRIER FREE WASHROOM
- R628 DINING ROOM
- R629 LIVING ROOM
- R630 KITCHEN
- R631 ENTRY
- R632 MECHANICAL ROOM

ROOM LEGEND

- R600 ENTRY
- R601 KITCHEN
- R602 LIVING ROOM
- R603 DINING ROOM
- R604 VESTIBULE
- R605 WASHROOM
- R606 CORRIDOR
- R607 BEDROOM
- R608 BEDROOM
- R609 BEDROOM
- R610 BEDROOM
- R611 BEDROOM
- R612 LAUNDRY
- R613 SHOWER
- R614 SHOWER
- R615 WASHROOM

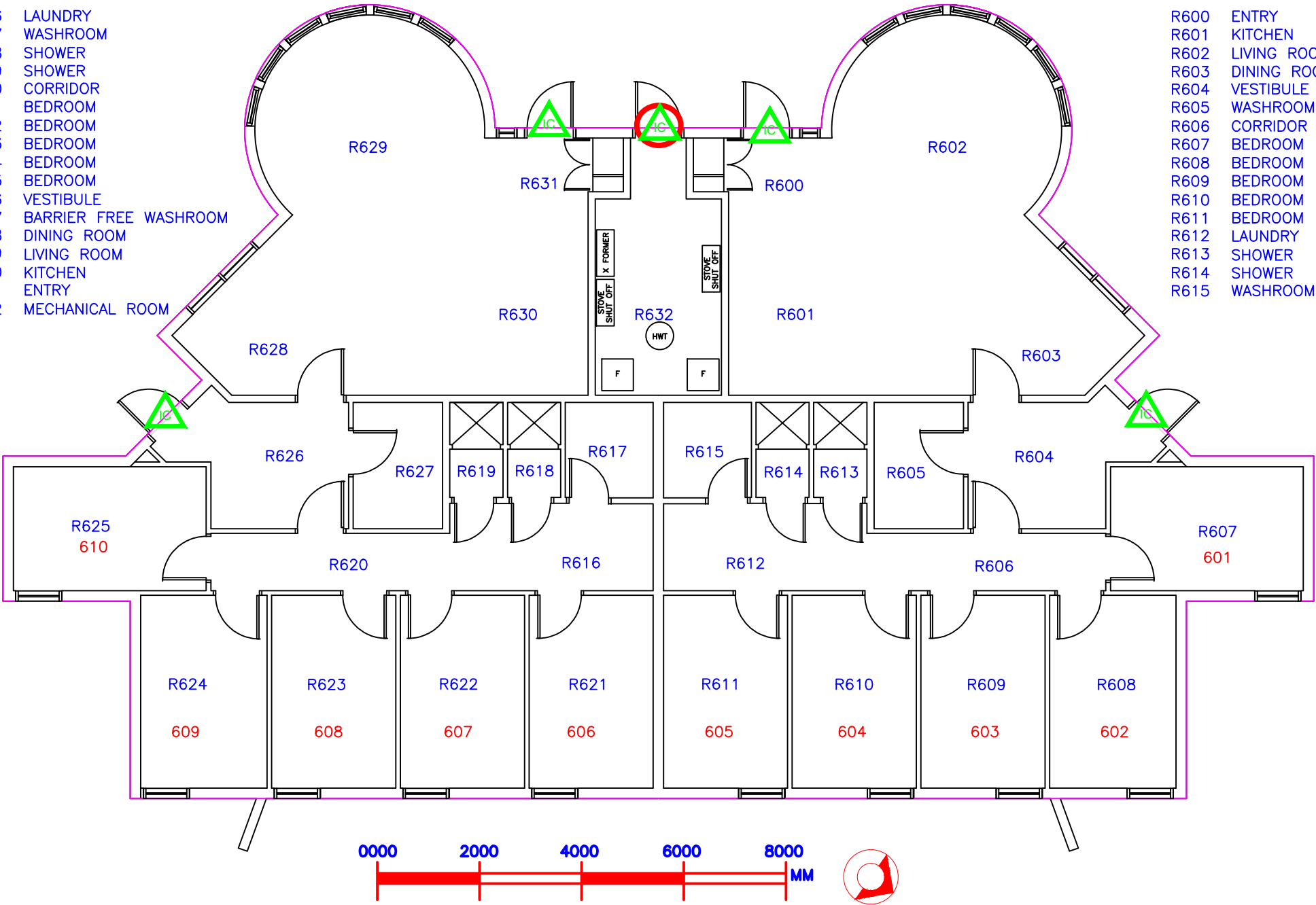

INSTITUTION

Pê Sâkâstêw Centre
HOB BEMA, AB

TAG # 535-06 BUILDING # R600

BUILDING NAME
LIVING LODGE 6

FLOOR GROUND

AREA 284.18 SQ.M

SCALE 1:100

DATE SIGNED:

APPROVED BY:

LAST UPDATE

DRAWN BY: D. GADDES

UPDATED BY: R. RAWLYN

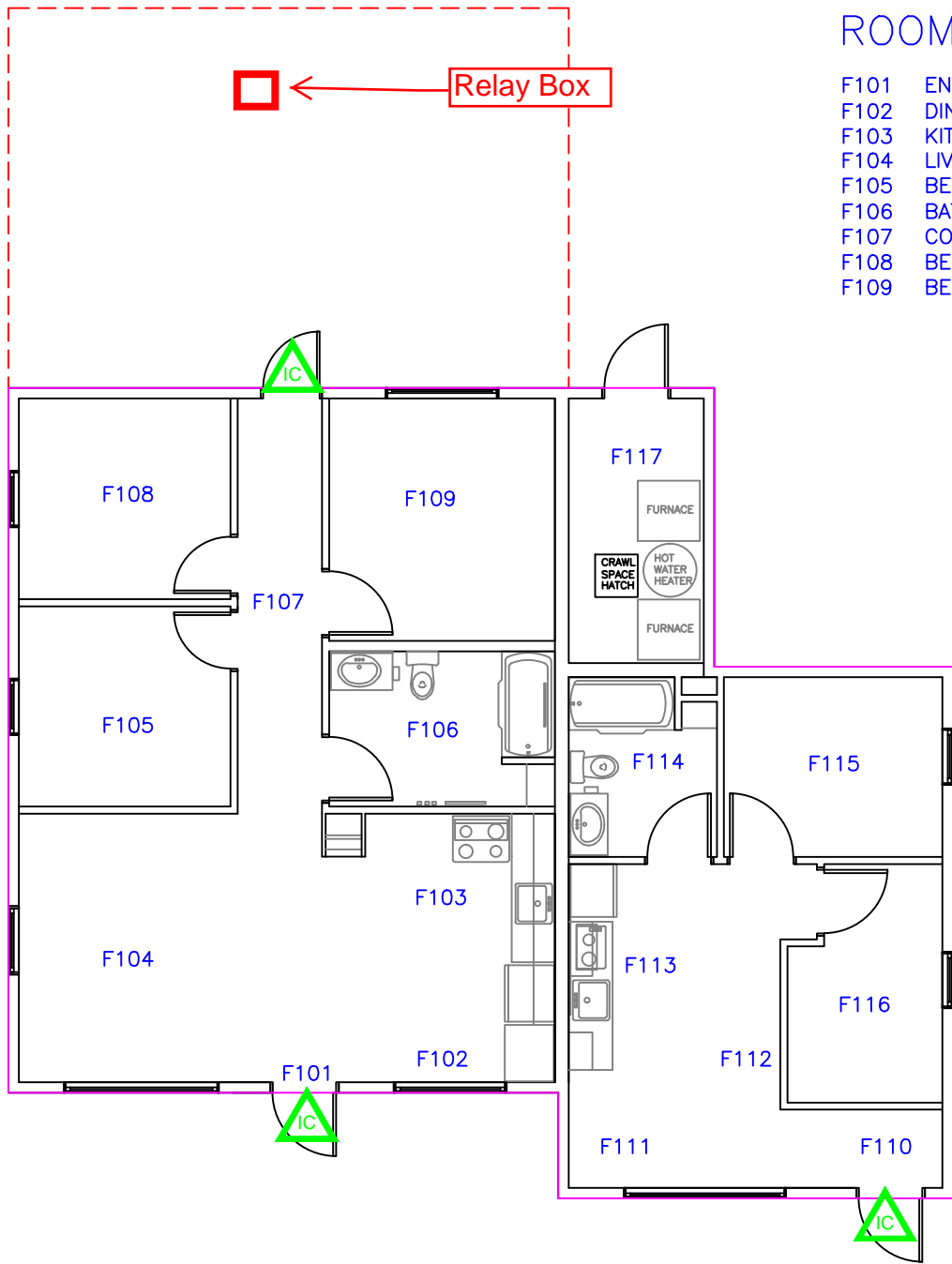

ROOM LEGEND

- | | | | |
|------|-------------|------|-----------------|
| F101 | ENTRY | F110 | ENTRY |
| F102 | DINING | F111 | LIVING ROOM |
| F103 | KITCHEN | F112 | DINING |
| F104 | LIVING UNIT | F113 | KITCHEN |
| F105 | BEDROOM | F114 | BATHROOM |
| F106 | BATHROOM | F115 | BEDROOM |
| F107 | CORRIDOR | F116 | BEDROOM |
| F108 | BEDROOM | F117 | MECHANICAL ROOM |
| F109 | BEDROOM | | |

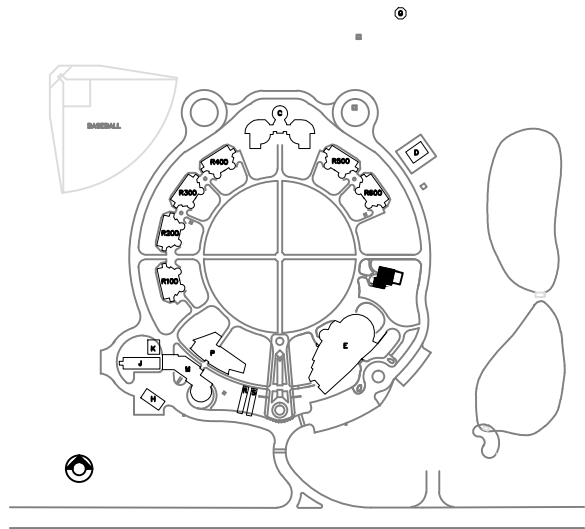

KEYPLAN

LEGEND

 Existing Magnetic door contact

INSTITUTION

**Pê Sâkâstêw Centre
HOBBEMA, AB**

TAG # **535-05** BUILDING # **F**

BUILDING NAME
ELDERS LODGE/PFV

FLOOR **GROUND**

AREA **129.00 SQ.M**

SCALE **1:100**

DATE SIGNED:

APPROVED BY:

LAST UPDATE

FEBRUARY 24 2013

ROOM LEGEND

- C124

ELECTRICAL ROOM
- C125

STORAGE
- C126

COFFEE
- C127

CORRIDOR
- C128

CORRIDOR
- C129

PSYCHOLOGIST
- C130

EXAM ROOM
- C131

RESERVED
- C132

EXAM ROOM
- C133

OFFICE HEALTH CARE
- C134

OFFICE HEALTH CARE
- C135

MEDICAL STORAGE
- C136

CORRIDOR
- C137

MECHANICAL ROOM
- C138

SCHOOL CLASS ROOM
- C139

RESERVED

C140

RESERVED

C141

SCHOOL CLASS ROOM

C142

RESERVED

C143

SCHOOL ENTRANCE

C144

MALE WASHROOM

C145

ELDER'S OFFICE

C146

COATS

ROOM LEGEND

- C100

VESTIBULE
- C101

GATHERING
- C102

SACRED ROOM
- C103

COATS
- C104

CORRIDOR
- C105

ELDER'S OFFICE
- C106

RESERVED
- C107

MALE WASHROOM
- C108

FEMALE WASHROOM
- C109

ACTIVITY AREA
- C110

CORRIDOR

C111

STORAGE

C112

WAITING

C113

COUNSELLING

C114

CORRECTIONS SUPER.

C115

MECHANICAL ROOM

C116

JANITOR

C117

OFFICE

C118

CASE MGMT

C119

CASE MGMT

C120

CASE MGMT

C121

UNIT CLERK

C122

CORRIDOR

C123

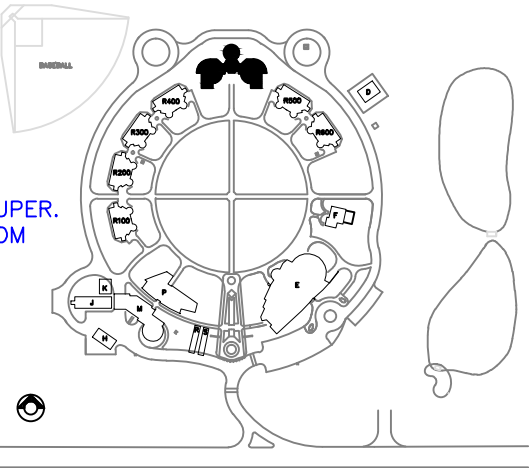
UNIT MANAGER

KEYPLAN

LEGEND

-  Existing Magnetic door contact

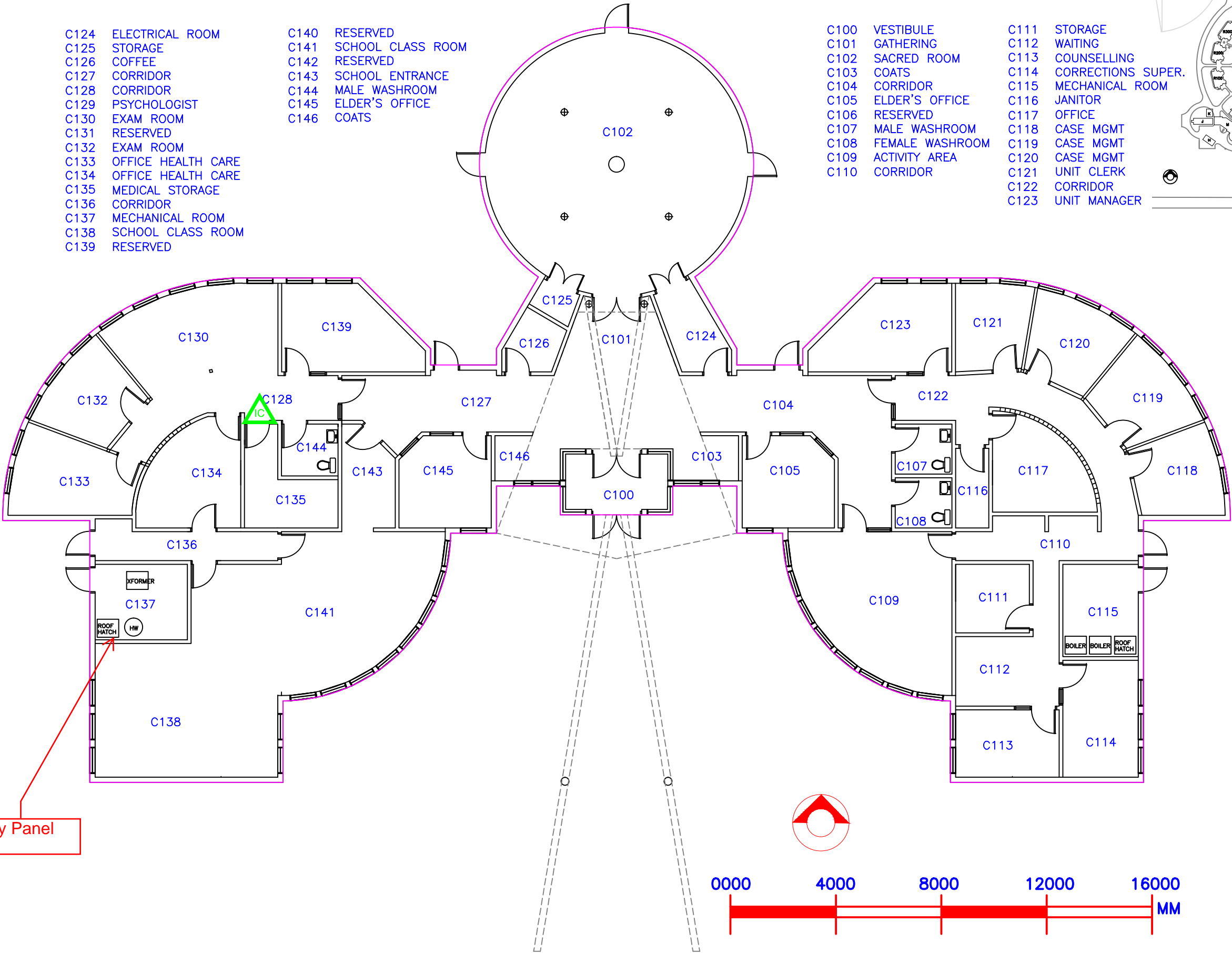

Relay Panel

INSTITUTION

Pê Sâkâstêw Centre
HOB BEMA, AB

TAG # 535-09 BUILDING # C

BUILDING NAME
CEREMONIAL LODGE

FLOOR GROUND

AREA 655.97 SQ.M

SCALE 1:150

DATE SIGNED:

APPROVED BY:

LAST UPDATE

MARCH 5 2013

DRAWN BY: D. GADDESS

UPDATED BY: R. RAWLYK

ROOM LEGEND

E100	VESTIBULE	E120	MECH ROOM	E137	CLOTHING STORAGE
E101	FOYER	E121	CORRIDOR	E138	VESTIBULE
E102	INTERVIEW CORR. MGR.	E122	FINANCE OFFICER	E139	FOYER
E102A	CORR. MANAGER	E123	ACC'T TERMINAL	E140	CHILDREN'S PLAY AREA
E103	WAITING	E124	CENTRAL COMPUTER RM.	E141	JANITOR
E104	DUTY OFFICE	E125	CORRIDOR	E142	KITCHEN
E105	DUTY OFFICE STORAGE	E126	STAFF WASHROOM	E143	COMMUNITY HALL
E106	CORRIDOR	E127	STAFF WASHROOM	E144	STORAGE
E107	BOARDROOM	E128	STAFF LOUNGE		
E108	RECEPTION	E129	HEALTH CARE		
E109	INTERVIEW	E130	STAIRWAY		
E110	DIR. MGMT. SERVICES	E131	VESTIBULE		
E111	CORRIDOR	E132	MENS WASHROOM		
E112	PHOTOCOPY ROOM	E133	WOMEN'S WASHROOM		
E113	RECORDS STORAGE	E134	ADMISSION/DISCHARGE		
E114	RECORD DESK	E135	WASHROOM		
E115	SECRETARY	E136	RESIDENT EFFECTS		
E116	ASSISTANT DIRECTOR				
E117	EXECUTIVE DIRECTOR				
E118	STORAGE				
E119	SECURE				

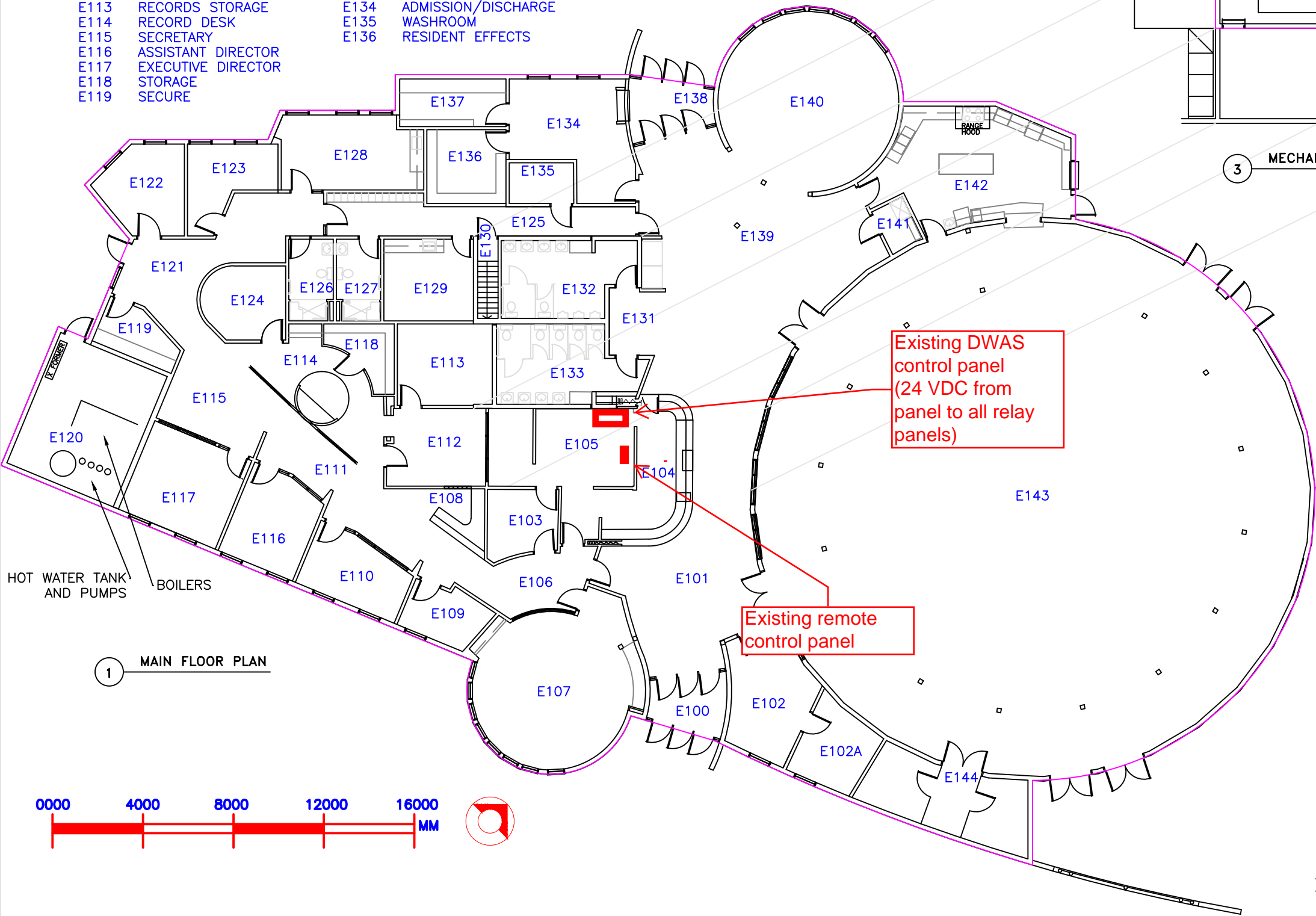

1 MAIN FLOOR PLAN

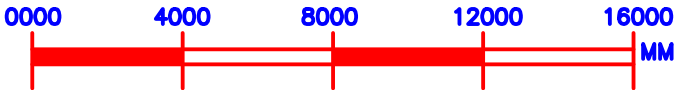

E200 MECHANICAL ROOM

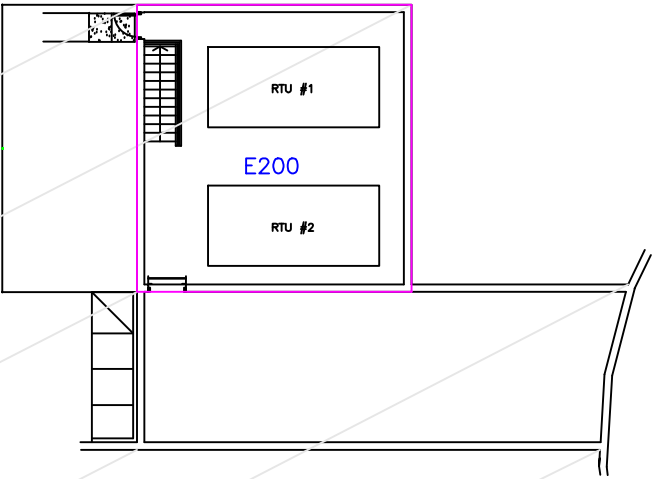

3 MECHANICAL PENTHOUSE PLAN

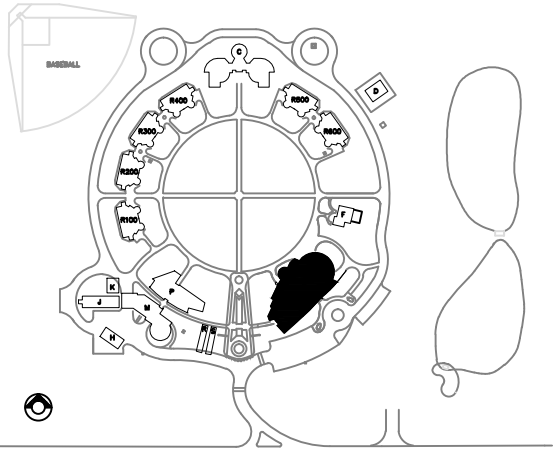

KEYPLAN

LEGEND

INSTITUTION	
Pê Sâkâstêw Centre HOBBEWA, AB	
TAG #	BUILDING #
535-04	E
BUILDING NAME	
MAIN LODGE	
FLOOR	GROUND, 2ND
AREA	1396.48+55.90 SQ.M
SCALE	1:200
DATE SIGNED:	
APPROVED BY:	
LAST UPDATE	
FEBRUARY 20 2013	
DRAWN BY: D. GADDES	
UPDATED BY: R. RAWLYN	

ROOM LEGEND

M100	VESTIBULE	M110	STAFF WASHROOM	M120	FOOD PREPARATION
M101	CORRIDOR	M111	VEG. STORAGE	M121	COMPRESSORS FOR COOLERS
M102	RECYCLING	M112	FREEZER	M122	SCHOOL ENTRANCE
M103	CLEANING SUPPLIES	M113	CORRIDOR	M123	TOOL CRIB
M104	GENERAL STORAGE	M114	CLEANING SUPPLIES	M124	-RESERVED-
M105	ELECTRICAL	M115	JANITOR	M125	DIESEL GENERATOR
M106	RECEIVING	M116	DRY FOOD	M126	TELEPHONE
M107	SIS OFFICE	M117	COLD STORAGE		
M108	RECEIVING	M118	OFFICE		
M109	SIS LAUNDRY	M119	WORKS OFFICE		

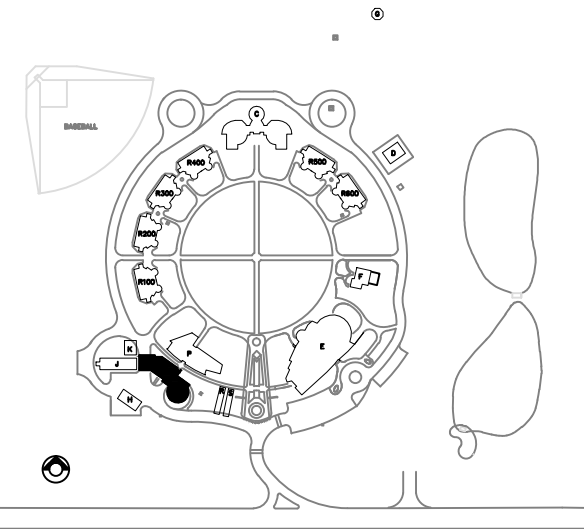

KEYPLAN

Panel where
cables split to all
locations (houses,
Healthcare, FVD,
Main Lodge)

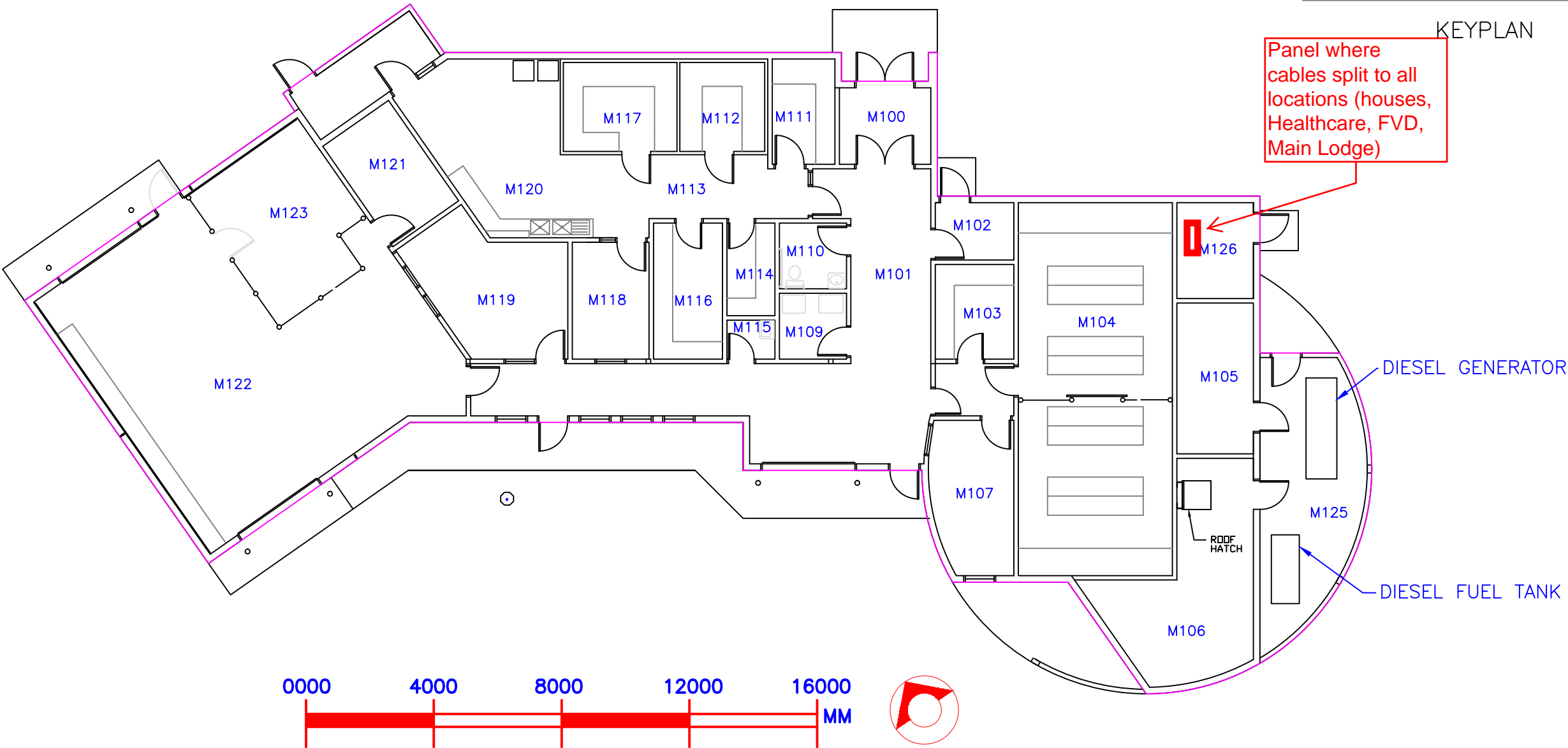

LEGEND

INSTITUTION	
Pê Sâkâstêw Centre HOBBEMA, AB	
TAG #	BUILDING #
535-15	M
BUILDING NAME	
MAINTENANCE BUILDING	

FLOOR	GROUND
AREA	479.20 SQ.M
SCALE	1:150

DATE SIGNED:	
APPROVED BY:	
LAST UPDATE	FEBRUARY 23 2012

DRAWN BY:	D.GADDES
UPDATED BY:	R.RAWLYK