

ONE REQUIRED FOR INSTALLATION ONLY
(WELDING OF EXIST. TIE ROD TO EXIST. H-PILE)

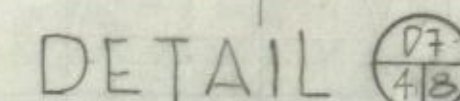
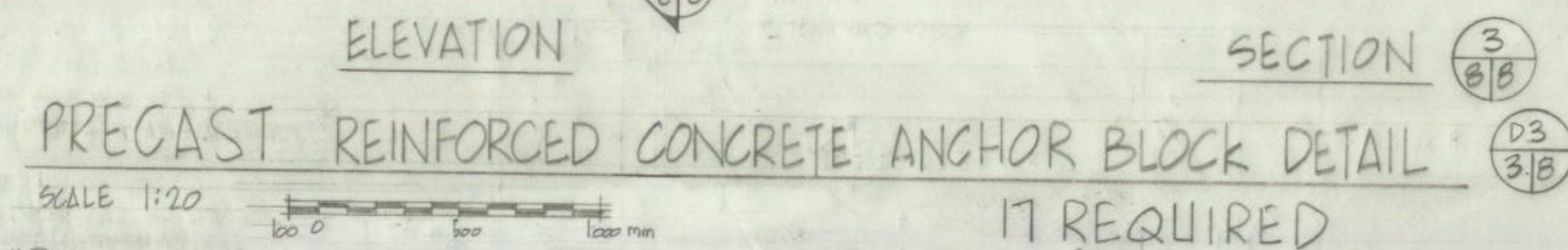
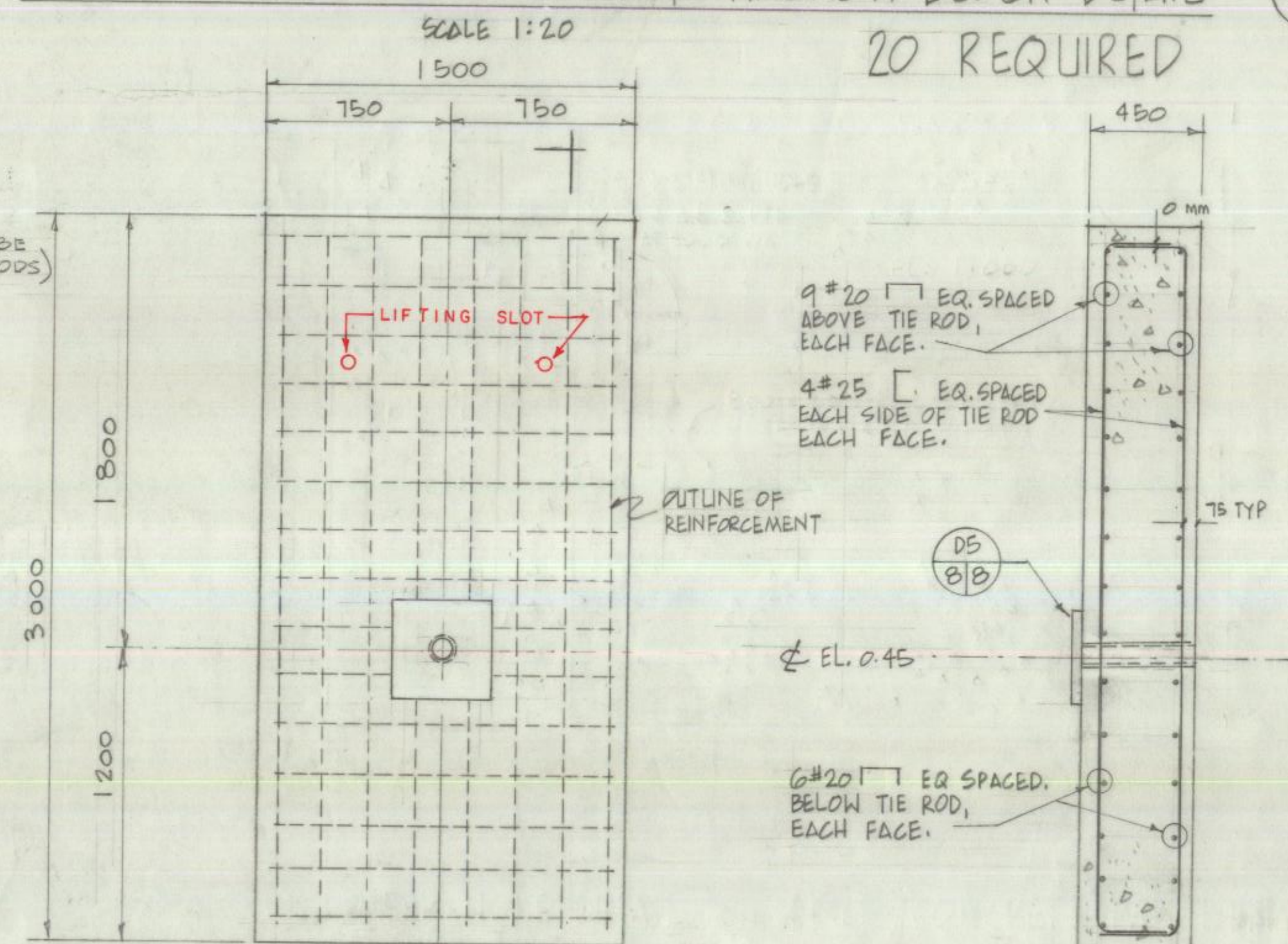
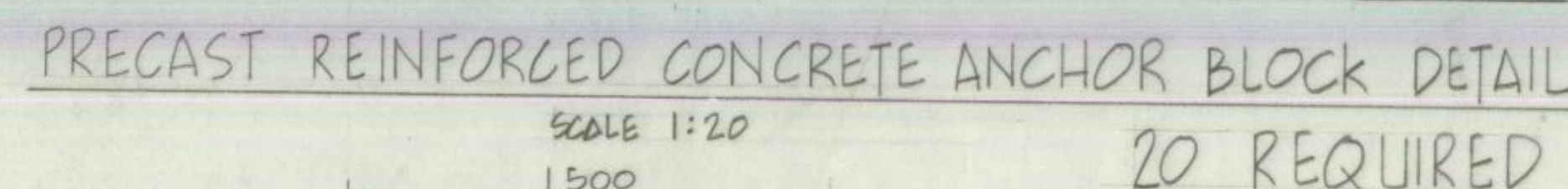

MODIFICATION TO KEY FOR
EXISTING PANELS - TYPE 'B' + 'C'

NOTE.
FOR MATERIALS SUPPLIED BY ENGINEER REFER TO DWG No 5