

RETURN BIDS TO:
RETOURNER LES SOUMISSIONS À:
Bid Receiving Public Works and Government
Services Canada/Réception des soumissions/Travaux
publics et Services gouvernementaux Canada
The Cambridge Building
3 Queen Street/3, rue Queen
Charlottetown
Prince Edward Island
C1A 4A2

SOLICITATION AMENDMENT MODIFICATION DE L'INVITATION

The referenced document is hereby revised; unless otherwise indicated, all other terms and conditions of the Solicitation remain the same.

Ce document est par la présente révisé; sauf indication contraire, les modalités de l'invitation demeurent les mêmes.

Comments - Commentaires

Vendor/Firm Name and Address
Raison sociale et adresse du
fournisseur/de l'entrepreneur

Issuing Office - Bureau de distribution
Public Works and Government Services Canada
The Cambridge Building
3 Queen Street/3 rue, Queen
PO Box 1268/CP 1268
Charlottetown
Prince Ed
C1A 4A2

Title - Sujet Recruiting Centre Fit-Up, JCB	
Solicitation No. - N° de l'invitation ED001-151689/A	Amendment No. - N° modif. 003
Client Reference No. - N° de référence du client R.070493/R.071965.1	Date 2015-01-20
GETS Reference No. - N° de référence de SEAG PW-\$PWC-010-3539	
File No. - N° de dossier PWC-4-37141 (010)	CCC No./N° CCC - FMS No./N° VME
Solicitation Closes - L'invitation prend fin at - à 02:00 PM on - le 2015-01-22	Time Zone Fuseau horaire Atlantic Standard Time AST
F.O.B. - F.A.B. Plant-Usine: <input type="checkbox"/> Destination: <input checked="" type="checkbox"/> Other-Autre: <input type="checkbox"/>	
Address Enquiries to: - Adresser toutes questions à: MacDonald, Anne (PWC) D.	Buyer Id - Id de l'acheteur pwc010
Telephone No. - N° de téléphone (902) 626-4949 ()	FAX No. - N° de FAX (902) 566-7514
Destination - of Goods, Services, and Construction: Destination - des biens, services et construction:	

Instructions: See Herein

Instructions: Voir aux présentes

Delivery Required - Livraison exigée	Delivery Offered - Livraison proposée
Vendor/Firm Name and Address Raison sociale et adresse du fournisseur/de l'entrepreneur	
Telephone No. - N° de téléphone Facsimile No. - N° de télécopieur	
Name and title of person authorized to sign on behalf of Vendor/Firm (type or print) Nom et titre de la personne autorisée à signer au nom du fournisseur/ de l'entrepreneur (taper ou écrire en caractères d'imprimerie)	
Signature	Date

Addendum # 3
January 20, 2015

THE FOLLOWING AMENDMENT TO THE TENDER DOCUMENTS IS EFFECTIVE IMMEDIATELY. THIS ADDENDA SHALL FORM PART OF THE CONTRACT DOCUMENTS.

1. Sign In Sheet - Site visit - January 15, 2015

PDF Attached

2. Clarification from site visit

Refer to drawing H-1, there are structural drop panels at the column locations. Contractor to coordinate penetration locations on site and offset services in access floor above to not require penetrations through these panels where practical.

3. Acceptable Products: The following manufacturers are accepted as suppliers of the items listed.

In each case, it is the responsibility of the manufacturer to select specific products that meet the specifications in significant respects. Products offered will be subject for review and acceptance at the shop drawing review stage. Contractors are to satisfy themselves that products offered meet the specifications and fit in the available space as no extra charge will be considered if they are found to be unsuitable.

- SECTION 23 34 00 HVAC Fans, Par 2.2 Cabinet Fans Loren Cook
- SECTION 23 82 19 2.2 Fan Coil Units, Par 2.2 Nailor Industries

4. Refer to drawing E-3, New Security and Fire Alarm Layout – Main Floor - Reference New Security Plan: Contractor to supply and install doorbell outside the entrance door to Reception 101. Doorbell to ring the same door chime as shown for the door contact.

Question:

5. It says to store removed components on-site. A location for storage is critical as anything other than storage on the main floor requires taking 1 component at a time in the elevator. Has a site been selected ?

ANSWER

Removed components will be stored at a location near the loading bay on the Main Floor.

Question:

6. Commissionaires (if required ?) paid by PWGSC or contractor?

ANSWER:

Paid by PWGSC.

7. PDF Attachment with clarifications

Drawing A-1, Demo Plan Details

Refer to Wall Type B, where it specifies Wire Mesh on Attack Side. The wire mesh shall be:

Flattened Metal Mesh: To EMMA 557-99. Style ¾-9F: nominal strand thickness of 0.120" (0.108" to 0.132"). Diamond opening of 0.563" x 1.688".

Mount on the outside (attack side) of the room. Support all edges by anti-spread bracing, studs or corners. Align the sheet edges at every vertical and horizontal seam on the centre line of the steel stud or anti-spread bracing and secure all sheets with welds or rivets.

Note: Screws (including "security screws") are **NOT** acceptable for permanently attaching the protection material (steel or steel mesh). Screws may be used to "tack" the sheets in place pending riveting or welding. Temporary screws do not need to be removed.

Mesh shall be riveted to steel studs as follows and as shown in diagram:

Rivet: 3/16" steel pop rivet: Speaneur part #301-440

Washers: 1 ½" OD, 3/16" ID "fender" washer: Fastenal part #1133204

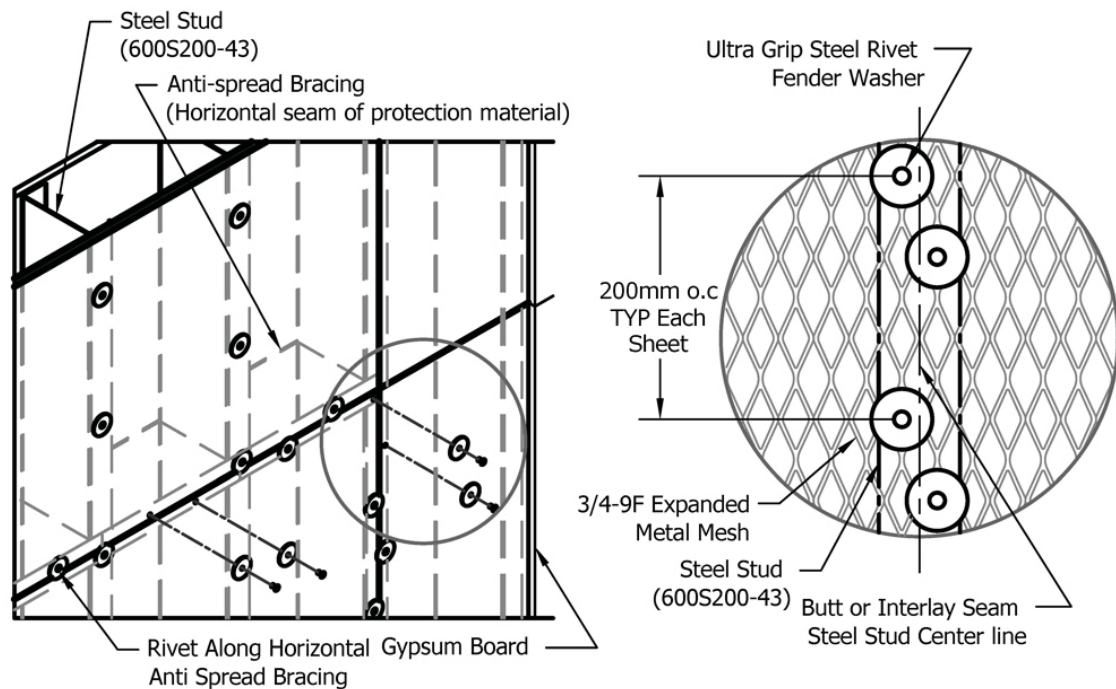

Drawing A-2, Main Floor Plan

Door #08 to Room 106 Medical should show a sidelite.

Drawing A-3, Schedules

Refer to Door Schedule and Door Types: The wood doors shall be solid particle core wood doors, with a paint grade hardboard face. Stiles shall be minimum of 107mm, and top and bottom rails shall be 85mm, with 22mm hardwood edge. Doors shall be equivalent to Baillargeon Model 8500-ME, 5 ply.

Refer to Finish Schedule: There should be a line for Room 116, Shared Equipment. The finishes shall be Vinyl Tile on Floors, Rubber Base, Painted Gypsum Board Walls, and No Finish Ceiling.

Refer to Door Hardware Sets:

The Hardware Set HW-1 shall be supplied and installed by Aluminum Door Supplier.

In Hardware Set HW-2, the electric strike shall be Type 1.

Refer to Door Hardware Specifications:

The Door Stops shall be all Floor Mounted Type.

The trim and rose design shall be equivalent to Sargent LL.

Morticed Lockset: Delete the requirement for concealed cylinders. Note: Removeable cores do not meet the Security Grade 1 requirements.

The electric strikes shall be HESS 1006, face plate to match lockset.

Refer to Finish Schedule:

Where the ceiling finish calls for no finished ceiling, that means that the existing exposed painted concrete deck and building services shall remain as is. But any new exposed ductwork, conduits, sprinkler pipes, etc. shall be painted to match the existing. Colour to be confirmed on site.

Wall Tile Specifications:

Change the Wall Tile Types A, B, and C as follows:

Wall Tile A – Centura, Vitra Arkitekt Color RAL9016 Super White, matt finish, 15x15cm

Wall Tile B – Centura, Vitra Arkitekt Color RAL0005500 Grey, matt finish, 15x15cm

Wall Tile C – Centura, Vitra Arkitekt Color RAL0001500 Super Black, matt finish,
15x15cm

Refer to Door Schedule:

Door #9 should read to Room Number 107, Medical

For Doors #8 and #9 only, contractor shall supply and install 25mm horizontal aluminum venetian blinds in the sidelites as noted in the Comments. Colour to be selected by Architect.

Door #11: Although the Door is Type D, it shall have a sidelite similar to a Type A door as shown on the floor plan.

Drawing A-5, Details

In Wall Section 3/A5, the walls that extend to 2700 off floor only apply to the walls alongside Corridors 108 and 100, and the walls within the Washrooms 111 and 112. The other walls against the File Room 113, Meeting Room 103, and Shared Equipment 116 shall extend to the underside of the roof deck, and shall be Wall Types as noted.

Wall Section 3/A5: The wall studs shall be 26 gauge.

Drawing A-7, Main Floor Paint Schedule

Re Note #3: The painting of the existing demountable partitions does not include the aluminum joiners.

Section 08 71 00, Door Hardware

Paragraph 1.3.6. Delete the reference to Leeds and Section 01 35 21.

Paragraph 2.3. The key control cabinet shall be Lund Model 1200.

Section 12 22 00, Privacy Curtains

This specification refers to a privacy curtain which shall be installed in Room 107, Medical .
Refer to Drawing A-6, Main Floor Furniture Layout where it is shown as a curved dashed line.

Section 08 11 00, Metal Doors

Paragraph 2.11.1: The thickness of the face sheets shall be 1.5mm. Delete the reference to honeycomb core.

Paragraph 2.13.3: The voids between steel stiffeners shall be fibreglass insulation.

Drawing E-3, New Security and Fire Alarm Layout – Main Floor:

- a. Reference Security Plan: Blue light system and panic buttons are a standalone system. Contact Morgan Fisher at Alliance Security.

PROJECT REPORT
RAPPORT DE PROJET

Date

2015.01.15

To - A		Your file - Votre référence																															
DND FIT UP		Our file - Notre référence																															
From - De		Action - Donner suite																															
SIGN IN SHEET		Information - Renseignements																															
		Approval - Approbation																															
Subject - Objet		Comments - Observations																															
Project - Projet		Action by Mesures pris par																															
<table border="1"><thead><tr><th>NAME</th><th>COMPANY</th></tr></thead><tbody><tr><td>1. Kevin Haynes</td><td>Olympia Electric</td></tr><tr><td>2. A. H. R. Y. McEwen</td><td>D.B.A. John Electric</td></tr><tr><td>3. Rod O'Connor</td><td>O'Connor Glass</td></tr><tr><td>4. Sharon Breau</td><td>Precision Mechanical</td></tr><tr><td>5. John Doiron</td><td>Belmont Metal</td></tr><tr><td>6. Douglas Matheson</td><td>MCA Consultants Inc.</td></tr><tr><td>7. Kevin G. Adams</td><td>Control Air Systems</td></tr><tr><td>8. Oliver Naumann</td><td>Bexan Bros Ltd</td></tr><tr><td>9. Dan Webster</td><td>Mr. Dumber</td></tr><tr><td>10. Rick Cusumano</td><td>R. Cusumano Electric</td></tr><tr><td>11. Mike Brothers</td><td>Entire Electrical</td></tr><tr><td>12. Scott McIntyre</td><td>EMC</td></tr><tr><td>13. Philip Jenkins</td><td>MIL</td></tr><tr><td>14. Mike McEwen</td><td>FITZ & SNOW</td></tr></tbody></table>		NAME	COMPANY	1. Kevin Haynes	Olympia Electric	2. A. H. R. Y. McEwen	D.B.A. John Electric	3. Rod O'Connor	O'Connor Glass	4. Sharon Breau	Precision Mechanical	5. John Doiron	Belmont Metal	6. Douglas Matheson	MCA Consultants Inc.	7. Kevin G. Adams	Control Air Systems	8. Oliver Naumann	Bexan Bros Ltd	9. Dan Webster	Mr. Dumber	10. Rick Cusumano	R. Cusumano Electric	11. Mike Brothers	Entire Electrical	12. Scott McIntyre	EMC	13. Philip Jenkins	MIL	14. Mike McEwen	FITZ & SNOW		
NAME	COMPANY																																
1. Kevin Haynes	Olympia Electric																																
2. A. H. R. Y. McEwen	D.B.A. John Electric																																
3. Rod O'Connor	O'Connor Glass																																
4. Sharon Breau	Precision Mechanical																																
5. John Doiron	Belmont Metal																																
6. Douglas Matheson	MCA Consultants Inc.																																
7. Kevin G. Adams	Control Air Systems																																
8. Oliver Naumann	Bexan Bros Ltd																																
9. Dan Webster	Mr. Dumber																																
10. Rick Cusumano	R. Cusumano Electric																																
11. Mike Brothers	Entire Electrical																																
12. Scott McIntyre	EMC																																
13. Philip Jenkins	MIL																																
14. Mike McEwen	FITZ & SNOW																																

Sheet
Feuilleof
de

