

MAIN FLOOR-ELECTRICAL DEMOLITION
1:100

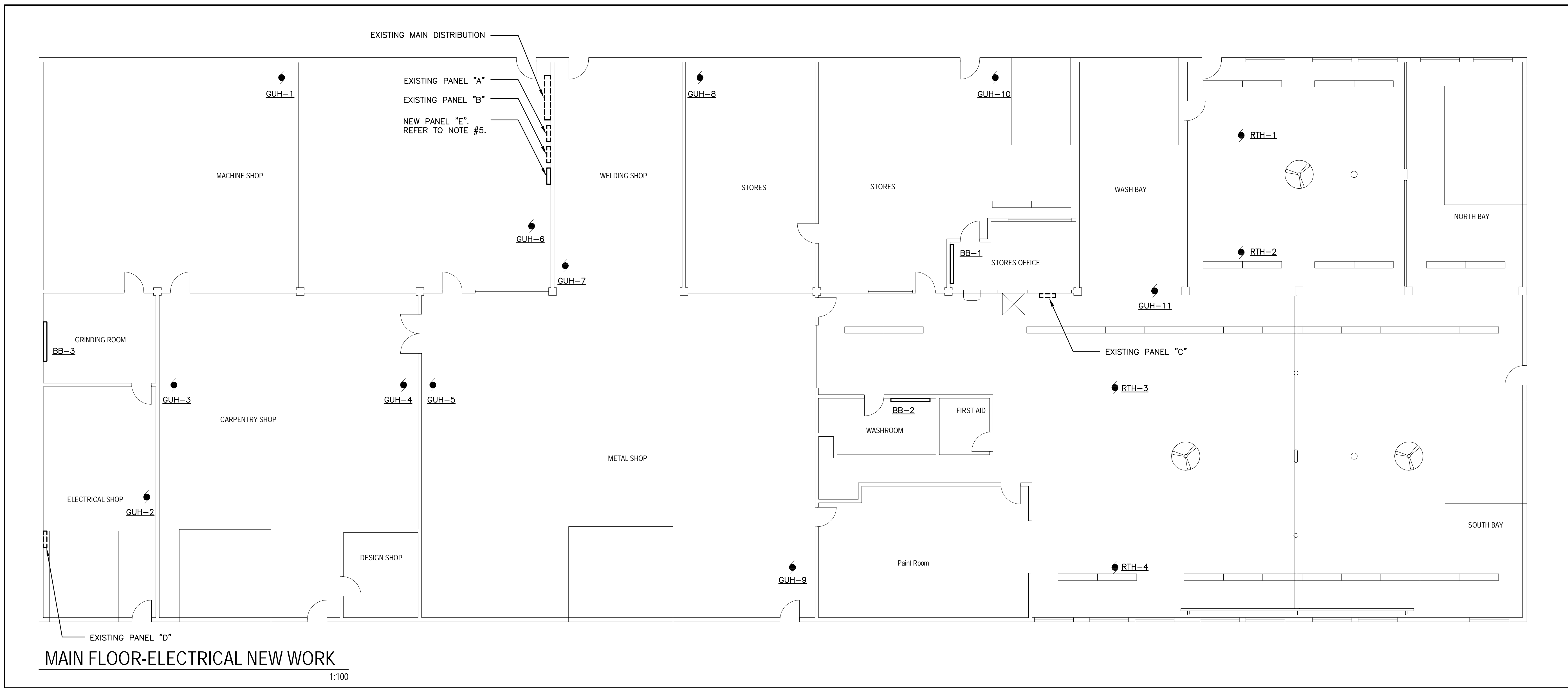

MAIN FLOOR-ELECTRICAL NEW WORK
1:100

- NOTES:
- COORDINATE PHASING OF MAINTENANCE SHOP WORK WITH DEPARTMENTAL REPRESENTATIVE AND CONTRACTOR.
 - SCHEDULING OF WORK IN BUILDING TO BE ARRANGED WITH DEPARTMENT REPRESENTATIVE TO MINIMIZE DISRUPTIONS TO OWNERS OPERATION DURING NORMAL WORKING HOURS. ANY SHUTDOWN OR INTERRUPTION TO SYSTEM TO BE AT TIMES ACCEPTABLE AND APPROVE D BY OWNER.
 - DISCONNECT AND REMOVE ALL EXISTING UNIT HEATERS, FURNACES ETC., IN RENOVATED AREAS NO LONGER REQUIRED TO REMAIN IN USE, UNLESS OTHERWISE INDICATED. CONFIRM EXISTING SITE CONDITIONS. REFER TO MECHANICAL DRAWING MM110 FOR EXACT SCOPE.
 - ALL ITEMS DENOTED WITH AN ASTERISK (*) ARE TO BE DISCONNECTED AND COMPLETELY REMOVED IN ITS ENTIRETY. CONFIRM EXISTING SITE CONDITIONS. WIRING AND CONDUIT IN RENOVATED AREAS REQUIRED TO REMAIN IN USE FOR ANY REASON SHALL BE RE-ROUTED, ALTERED AND/OR DIVERTED IN AN APPROVED MANNER:
 - ANY BRANCH CIRCUIT WIRING, OUTLET, ETC., FOR ANY SYSTEM TO REMAIN IN USE SHALL BE EXTENDED, RE-ROUTED AND RE-WIRED BACK TO NEAREST AVAILABLE ELECTRICAL PANEL. PROVIDE CIRCUIT BREAKERS TO SUIT. CONFIRM EXISTING SITE CONDITIONS.
 - ANY BRANCH CIRCUIT WIRING, OUTLET, ETC., FOR ANY SYSTEM NO LONGER REQUIRED IN USE SHALL BE REMOVED, OR IF THIS IS NOT POSSIBLE RENDERED PERMANENTLY INACCESSIBLE AND COMPLETELY DISCONNECTED FROM PANEL.
 - WIRE AND CONNECT NEW PANEL "E" TO EXISTING SQUARE D TYPE NQOB PANELBOARD "C" WITH 4#4 R900 CU WIRE IN 35MM CONDUIT AND PROVIDE 70A-3P CIRCUIT BREAKER TO SUIT. NEW BREAKER CHARACTERISTICS TO MATCH EXISTING, CONFIRM EXISTING PANELBOARD ON SITE.

PANEL DESIGNATION: PANEL "E"				LOCATION: MAINTENANCE SHOP						
				MOUNTING: SURFACE						
Voltage (L-L) : 120/208V				Phase & Wire : 3P/N/W						
Bus Ampacity (A) : 100				POWER: NORMAL POWER						
Description	LOAD	Br.	ckt	A	B	C	ckt	Br.	LOAD	Description
GUH-1	100	20A	1	1350			16	20A	1250	BB-1
GUH-2	100	20A	2				17	2P	1250	
GUH-3	100	20A	3			1350	18	20A	1250	BB-2
GUH-4	100	20A	4	1350			19	2P	1250	
GUH-5	100	20A	5		1350		20	20A	1250	BB-3
GUH-6	100	20A	6			1350	21	2P	1250	
GUH-7	100	20A	7	100			22	20A		SPARE
GUH-8	100	20A	8			100	23	20A		SPARE
GUH-9	100	20A	9			100	24	20A		SPARE
GUH-10	100	20A	10	100			25			SPACE
GUH-11	100	20A	11		100		26			SPACE
RTH-1	200	20A	12			200	27			SPACE
RTH-2	200	20A	13	200			28			SPACE
RTH-3	200	20A	14		200		29			SPACE
RTH-4	200	20A	15			200	30			SPACE
				3100	3100	3200				

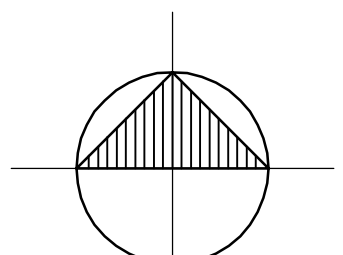

Revision/Revision	Description/Description	Date/Date
1	ADDENDUM 01	2015-01-20

Client/Client
**PWGSC
AGRICULTURE AND
AGRI-FOOD CANADA**
SWIFT CURRENT, SASKATCHEWAN

Project title/Titre du projet
**SEMIARID PRAIRIE
AGRICULTURAL
RESEARCH CENTRE
(SPARC) REHABILITATION PROJECT**
SWIFT CURRENT, SASKATCHEWAN

Approved by/Approuve par
P. KIEMENEY
Designed by/Concept par
P. KIEMENEY
Drawn by/Dessiné par
P. KIEMENEY
PWGSC Project Manager/Administrateur de Projets TPSGC
PWGSC-PM

PWGSC Architectural and Engineering Resources Manager/
Ressources Architectural et de Directeur d'ingénierie, TPSGC
PWGSC-ADM

Client/Client
Drawing title/Titre du dessin
**MAINTENANCE SHOP
POWER PLAN**

Project No./No. du projet
12C-12379-00
R.036324.001
Sheet/Feuille
EP107
OF XX
Revision no./
La Révision
no.
0

