

# ADDENDUM

PROJECT: <b>RCMP Loading Dock Central Heating Plant Regina, Saskatchewan</b>	ADDENDUM NUMBER: <b>M-1r</b>
PROJECT NO : <b>04.005.B</b>	DATE : <b>April 13, 2015</b>

The following amendments to the tender documents shall be incorporated in, and form part of, the tender documents the same as if these had been written into the original tender documents.

## REFER TO SPECIFICATIONS

### 1. Refer to Specifications Section 23 00 01 "Mechanical"

.1 Refer to the table associated with Paragraph 2.2 "Approved Alternate List"

.1 Add the following :

Product	Manufacturer
Glycol Fill Tank	Axiom, Hydronic System Sentry
Steam Traps and Steam Air Vents	Spirax Sarco
Condensate Return Units	Spirax Sarco
In-Slab Heating Manifold	Rahau, Caleffi, Roth
In-Slab Heating Piping	Raupex, Roth

.2 Delete the following "Product" rows :

.1 Circuit Balancing Valves

.2 Radiant Panel Manifold

## ADDENDUM

PROJECT: <b>RCMP Loading Dock Central Heating Plant Regina, Saskatchewan</b>	ADDENDUM NUMBER: <b>M-1r</b>
PROJECT NO : <b>04.005.B</b>	DATE : <b>April 13, 2015</b>

### REFER TO DRAWINGS

#### 2. Refer to Drawing M-2, Details 1, 2, and 3

- .1 The existing storm main exists the sub-basement at a 45 ° angle headed north, rather than a 90° angle headed north-east as shown (perpendicular to sub-basement wall). As the location of this line is unknown, when removing the existing catch basin and digging for new catch basin, excavate carefully by hand around where this pipe may be located so as not to disturb or damage the existing pipe.

-- END OF ADDENDUM --

## ADDENDUM

PROJECT: <b>RCMP Loading Dock Central Heating Plant Regina, Saskatchewan</b>	ADDENDUM NUMBER: <b>M-2</b>
PROJECT NO : <b>04.005.B</b>	DATE : <b>April 14, 2015</b>

The following amendments to the tender documents shall be incorporated in, and form part of, the tender documents the same as if these had been written into the original tender documents.

### REFER TO SPECIFICATIONS

#### 1. Refer to Specifications Section 23 00 01 "Mechanical"

.1 Refer to the table associated with Paragraph 2.2 "Approved Alternate List"

.1 Add the following :

Product	Manufacturer
Heat Exchanger	AIC
In-Line Pumps	Grundfos
Air Separator	Spirotherm, Amtrol
In-Slab Heating System Manifold	Uponor
In-Slab Heating Piping	Uponor

-- END OF ADDENDUM --

# ADDENDUM

PROJECT: <b>RCMP Loading Dock Central Heating Plant Regina, Saskatchewan</b>	ADDENDUM NUMBER: <b>M-3</b>
PROJECT NO : <b>04.005.B</b>	DATE : <b>April 15, 2015</b>

The following amendments to the tender documents shall be incorporated in, and form part of, the tender documents the same as if these had been written into the original tender documents.

## REFER TO SPECIFICATIONS

### 1. Refer to Specifications Section 23 00 01 "Mechanical"

.1 Refer to the table associated with Paragraph 2.2 "Approved Alternate List"

.1 Add the following :

Product	Manufacturer
Chemical Treatment	Emerald Industries

## REFER TO DRAWINGS

### 2. Refer to Drawing M-1

.1 Refer to "Equipment Schedule"

.1 CR-1 - Delete requirement for external adjustability on the float switches.

-- END OF ADDENDUM --

**Part 1 GENERAL**

**1.1 SECTION INCLUDES**

- .1 Self adhesive elastomeric sheet membrane waterproofing.
- .2 Drainage panels and protective cover.

**1.2 REFERENCES**

- .1 NRCA (National Roofing Contractors Association) - Waterproofing Manual.

**1.3 SYSTEM DESCRIPTION**

- .1 Waterproofing System: Capable of preventing moisture migration to interior. Apply to foundation wall between gridline 2 and gridline 3, from top of grade to top of foundation.

**1.4 QUALITY ASSURANCE**

- .1 Perform Work in accordance with NRCA Waterproofing Manual.
- .2 Applicator: Company specializing in performing the work of this section with minimum five years documented experience. Approved by manufacturer.
- .3 Ensure waterproofing system is inspected by Consultant prior to being covered up by other trades.

**1.5 ENVIRONMENTAL REQUIREMENTS**

- .1 Maintain ambient temperatures above 5 degrees C for 24 hours before and during application and until liquid or mastic accessories have cured.

**Part 2 PRODUCTS**

**2.1 MANUFACTURERS**

- .1 Bituthene 3000 - manufactured by W.R. Grace and Co
- .2 Other Acceptable Manufacturers:
  - .1 IKO Aquabarrier FP
  - .2 Bakor WP200

**2.2 MEMBRANE MATERIALS**

- .1 Modified Bituminous Membrane: Asphalt and polymer modifiers of styrene-butadiene-styrene (SBS) type, reinforced with non-woven cross laminated polyethylene; smooth surfaced; 60 mills thick; 36 inch wide roll.

**2.3 ACCESSORIES**

- .1 Sealant: mastic sealer as recommended by membrane manufacturer.

- .2 Primer: Water based surface conditioner as recommended by membrane manufacturer.
- .3 Fillet: latex modified cement mortar as recommended by membrane manufacturer.

### **Part 3 EXECUTION**

#### **3.1 EXAMINATION**

- .1 Verify substrate surfaces are durable; free of matter detrimental to adhesion or application of waterproofing system.
- .2 Verify surfaces are free of cracks, depressions, waves or projections which may be detrimental to successful installation.
- .3 Verify items which penetrate surfaces to receive waterproofing are securely installed.
- .4 Do not apply sheet waterproofing to damp, frozen, dirty, dusty or surfaces unacceptable to manufacturer.

#### **3.2 PREPARATION**

- .1 Protect adjacent surfaces not designated to receive waterproofing.
- .2 Clean and prepare surfaces to receive waterproofing in accordance with manufacturer's instructions.
- .3 Do not apply waterproofing to surfaces unacceptable to manufacturer
- .4 Seal cracks and joints with recommended material and sealant. Use proper depth-width ratio as recommended by sealant manufacturer.
- .5 Fillet inside corners with material compatible with sheet membrane.
- .6 Apply primer at a rate recommended by the materials manufacturer. Protect surface conditioner from rain or frost until dry.

#### **3.3 INSTALLATION**

- .1 Install membrane waterproofing in accordance with manufacturer's instructions.
- .2 Cover inside and outside corners with 12 inch wide strip of membrane.
- .3 Roll out membrane. Minimize wrinkles and bubbles.
- .4 Remove release paper layer. Roll out on substrate with a mechanical roller to encourage full contact bond.
- .5 Lap sides and ends in accordance with membrane manufacturer's instructions.
- .6 Reinforce membrane with multiple thickness of membrane material over joints, whether joints are static or dynamic.
- .7 Weather lap joints on sloped substrate in direction of drainage. Seal joints and seams.

- .8 Install elastomeric sheet waterproofing to all concrete basement walls below finish grade and where indicated.
- .9 Seal membrane and flashings to adjoining surfaces. Apply a trowelled bead of mastic to all vertical and horizontal terminations.
- .10 Seal items protruding to or penetrating through membrane and install counter flashing membrane material.
- .11 Seal all daily terminations with trowelled bead of mastic.

**3.4 PROTECTION OF FINISHED WORK**

- .1 Do not permit traffic over unprotected or uncovered membrane.

END OF SECTION

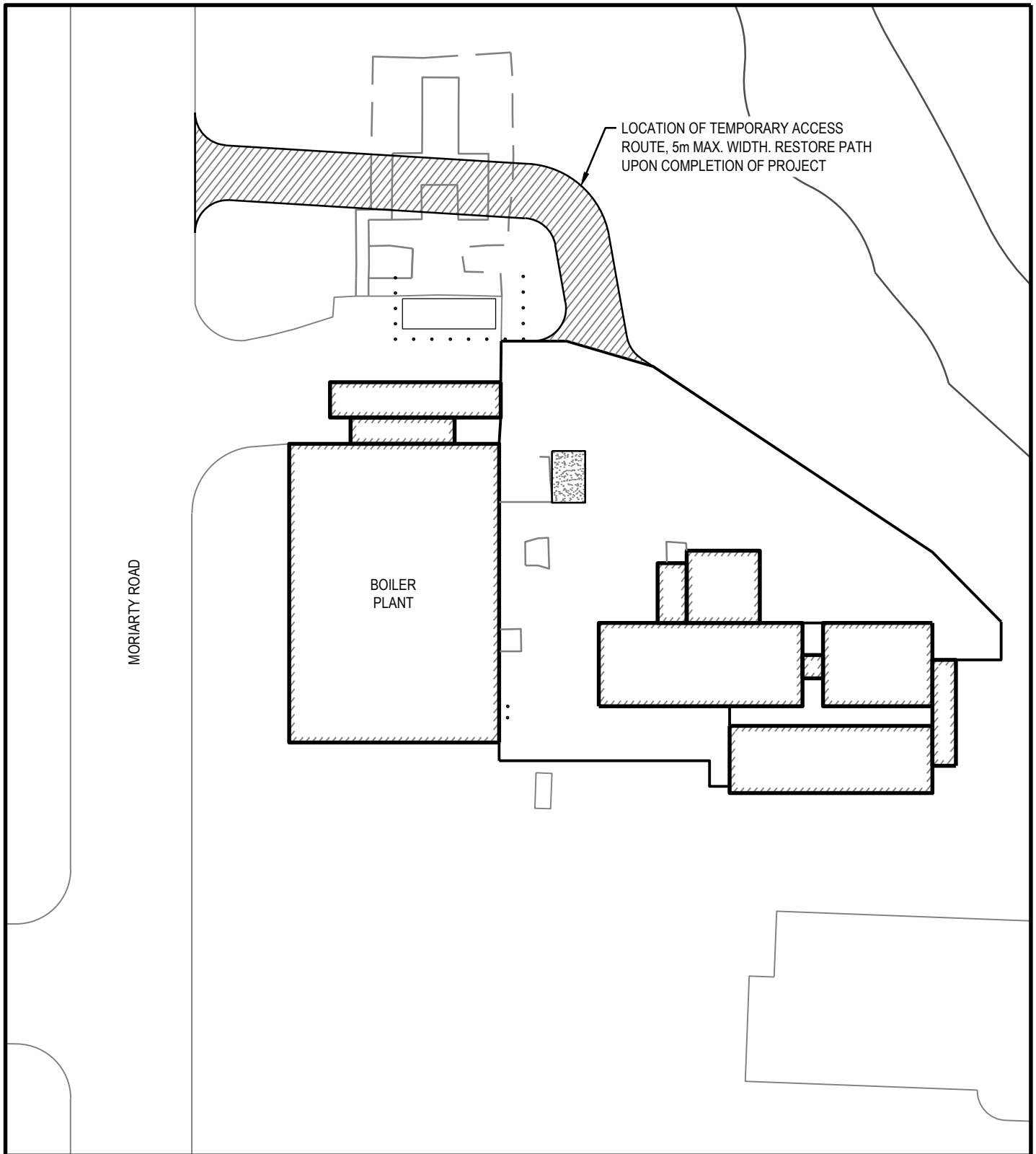

MORIARTY ROAD

BOILER PLANT

LOCATION OF TEMPORARY ACCESS ROUTE, 5m MAX. WIDTH. RESTORE PATH UPON COMPLETION OF PROJECT



395 MAXWELL CRESCENT  
 REGINA, SASKATCHEWAN, CANADA S4N 5X9  
 TEL.: 306-585-1990 | FAX: 306-586-9113 | WWW.WSPGROUP.CA

PROJECT: <b>LOADING DOCK AND SITE PAVING RENOVATION</b>		SUPPLEMENTAL:
TITLE: <b>TEMPORARY SITE ACCESS</b>		ADDENDUM: -- <input type="checkbox"/>
DRAWN BY: D.R.K.		DIRECTIVE: -- <input checked="" type="checkbox"/>
CHECKED BY: --		CHANGE ORDER: -- <input type="checkbox"/>
SCALE: 1:500	PROJECT NO: 17-076-00	REVISION: 0
		DATE: 2015-04-17
		SUPPLEMENTAL NO: SK01