

Q:\Hastings\Transportation\331\Projects\331\03085 - Highway Design km 738-750\CADD\2014 04 25 Detail Design Report\C501 - CONSTRUCTION STAGING.dwg [C501] April 20, 2015 - 12:30:30 pm (BY: MATSUDA, STAN)

GENERAL NOTES:  
1. MINIMUM TWO WAY TRAFFIC WIDTH  
3.3 m LANES + 0.5 m SHOULDERS = 7.6 m

TRAFFIC  
TRAFFIC FLOW  
CONSTRUCTION  
ALREADY CONSTRUCTED

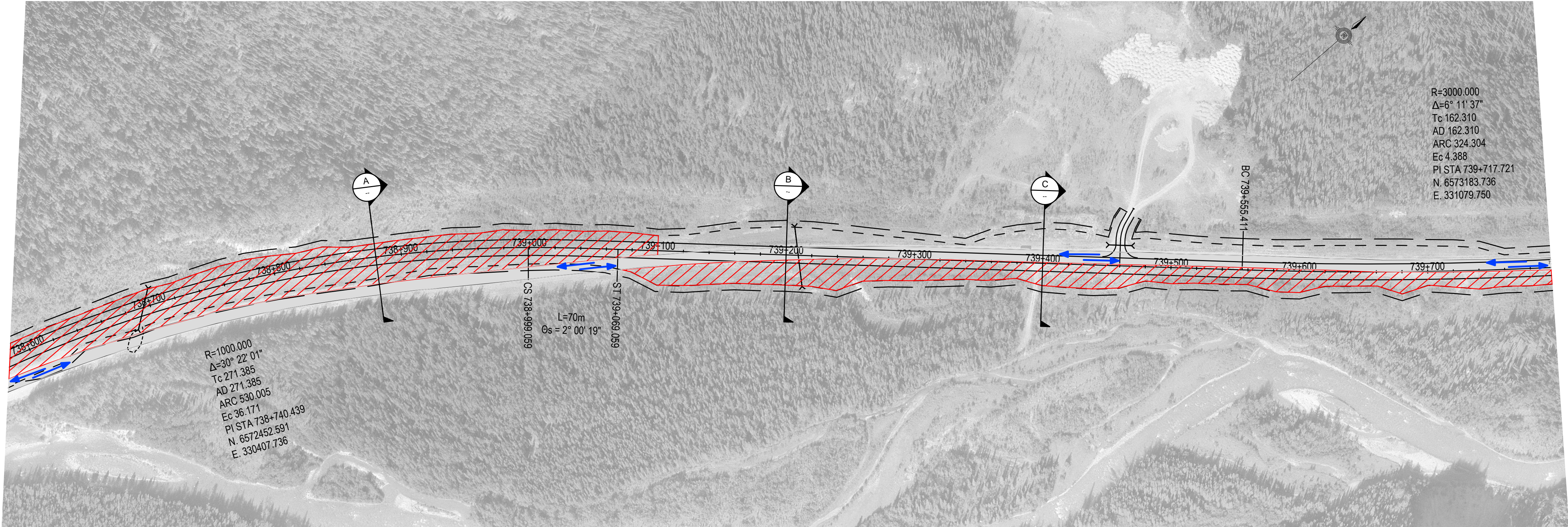

TRAFFIC:  
1. MAINTAIN ON EXISTING HIGHWAY

CONSTRUCTION:  
1. CONSTRUCT SUBGRADE, MATCH EXISTING HIGHWAY GRADE WHERE REQUIRED  
2. PULVERIZE (IF APPLICABLE)  
3. CONSTRUCT OUTLET PORTION OF CULVERT (739+209)

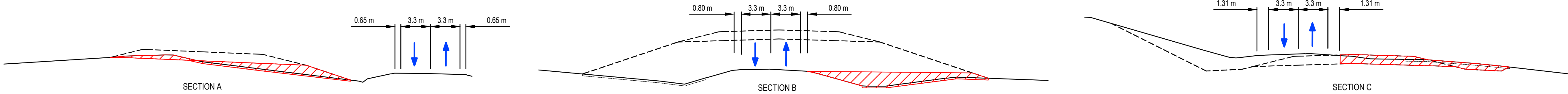





0	TENDER ADDENDUM No.1	15/04/20
Revision	Description/Description	Date/Date
Client/client		
PUBLIC WORKS AND GOVERNMENT SERVICES CANADA		
TETRA TECH EBA		
Project title/Titre du projet		
KM 737 - 750.3 HIGHWAY REALIGNMENT ALASKA HIGHWAY, BC		
Approved by/Approuvé par G.WILKINS		
Designed by/Concepté par A.HORWOOD / S.MATSUDA		
Drawn by/Dessiné par A.DEEPWELL		
PWGSC Project Manager/Administrateur de Projets TPSCG A. TAHERI		
PWGSC Architectural and Engineering Resources Manager/ Ressources Architectural et de Directeur d'ingénierie, TPSCG		
Client/client PUBLIC WORKS GOVERNMENT SERVICES CANADA		
Drawing title/Titre du dessin EXAMPLE REPRESENTATIVE CONSTRUCTION STAGING AND DETOUR DRAWINGS STAGE 1		
Project No./No. du projet R.017173.701	Sheet/Feuille C501	Revision no./ Lo Révision no. 0



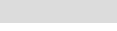

Q:\Hastings\Transportation\Projects\331\03085 - Highway Design km 738-750\CADD\2014 04 25 Detail Design Report\C501 - CONSTRUCTION STAGING.dwg [C502] April 20, 2015 - 12:30:50 pm (BY: MATSUDA, STAN)

GENERAL NOTES:  
1. MINIMUM TWO WAY TRAFFIC WIDTH  
3.3 m LANES + 0.5 m SHOULDERS = 7.6 m

 TRAFFIC  
 TRAFFIC FLOW  
 CONSTRUCTION  
 ALREADY CONSTRUCTED

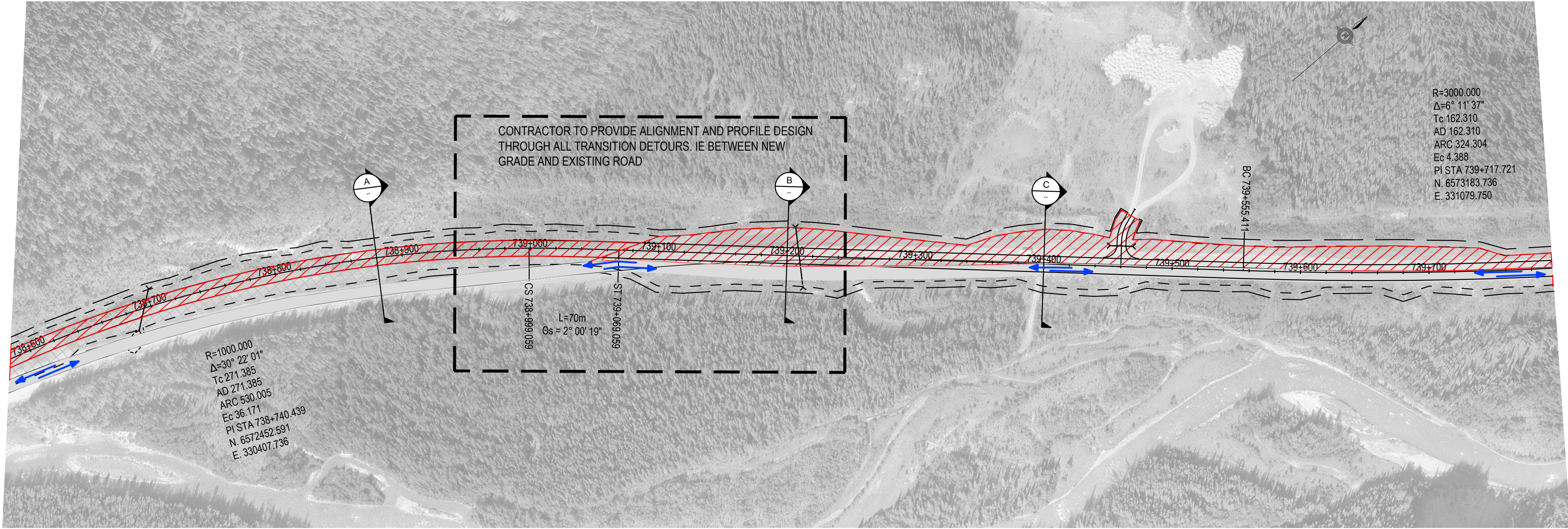

TRAFFIC:  
1. UTILIZE EXISTING HIGHWAY AND STAGE 1 CONSTRUCTION

CONSTRUCTION:  
1. CONSTRUCT ROAD EMBANKMENT AND GRAVELS TO FINAL GRADE AS SHOWN  
2. PULVERIZE EXISTING ROAD (IF APPLICABLE) AND CONSTRUCT BASE GRAVELS WHERE REQUIRED  
3. CONSTRUCT REMAINING PORTION OF CULVERT (739+209)

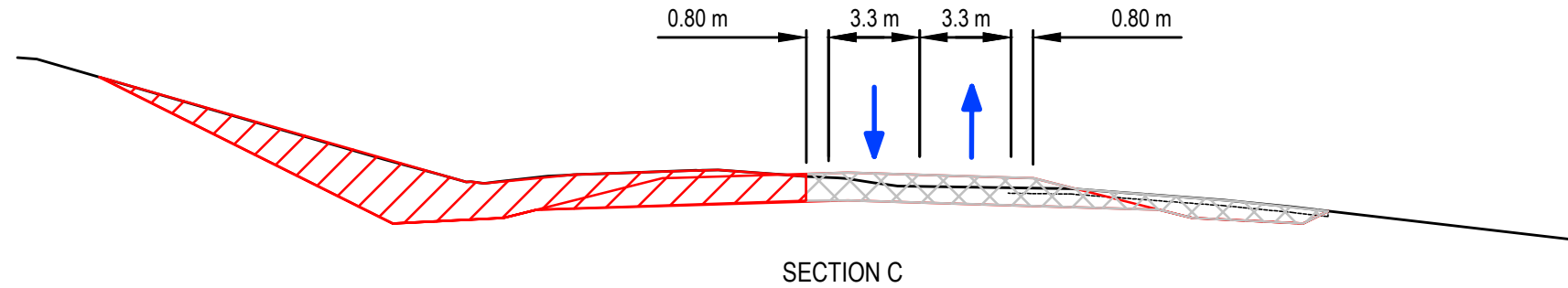
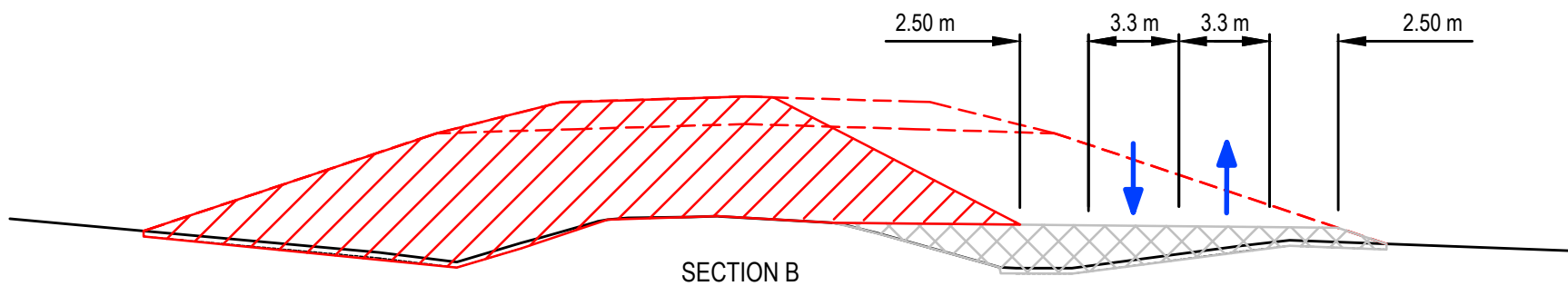
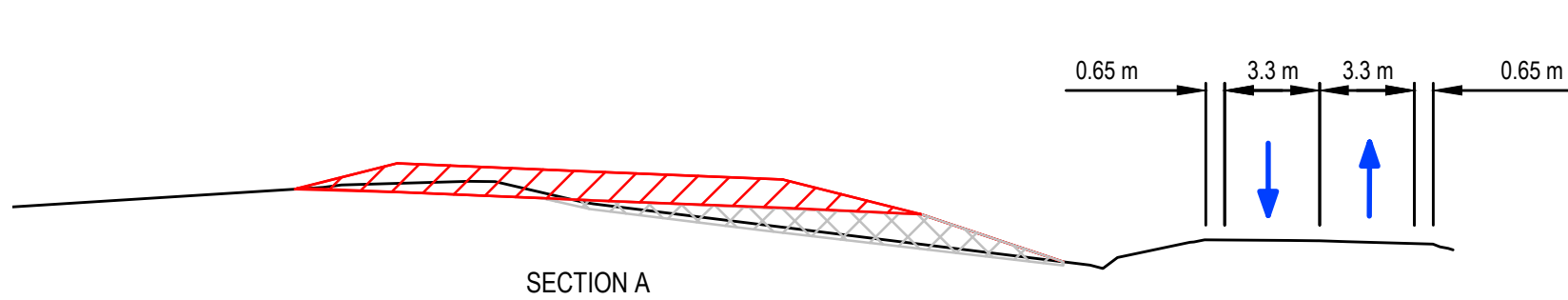

**PUBLIC WORKS AND  
GOVERNMENT SERVICES  
CANADA**



Project title/Titre du projet

**KM 737 - 750.3  
HIGHWAY REALIGNMENT  
ALASKA HIGHWAY, BC**

Approved by/Approuvé par  
**G.WILKINS**

Designed by/Concept par  
**A.HORWOOD / S.MATSUDA**

Drawn by/Dessiné par  
**A.DEEPWELL**

PWGSC Project Manager/Administrateur de Projets TPSCG  
**A. TAHERI**

PWGSC Architectural and Engineering Resources Manager/  
Ressources Architectural et de Directeur d'ingénierie, TPSCG

Client/client  
**PUBLIC WORKS GOVERNMENT SERVICES CANADA**

Drawing title/Titre du dessin  
**EXAMPLE REPRESENTATIVE  
CONSTRUCTION STAGING AND  
DETOUR DRAWINGS  
STAGE 2**

Project No./No. du  
projet  
**R.017173.701**

Sheet/Feuille  
**C502**

Revision no./  
Lo Révision  
no.  
**0**





Q:\Hastings\Transportation\Projects\33103085 - Highway Design km 738-750\CADD\2014 04 25 Detail Design Report\C501 - CONSTRUCTION STAGING.dwg [C503] April 20, 2015 - 12:31:05 pm (BY: MATSUDA, STAN)

GENERAL NOTES:  
1. MINIMUM TWO WAY TRAFFIC WIDTH  
3.3 m LANES + 0.5 m SHOULDERS = 7.6 m

TRAFFIC

TRAFFIC FLOW

CONSTRUCTION

ALREADY CONSTRUCTED

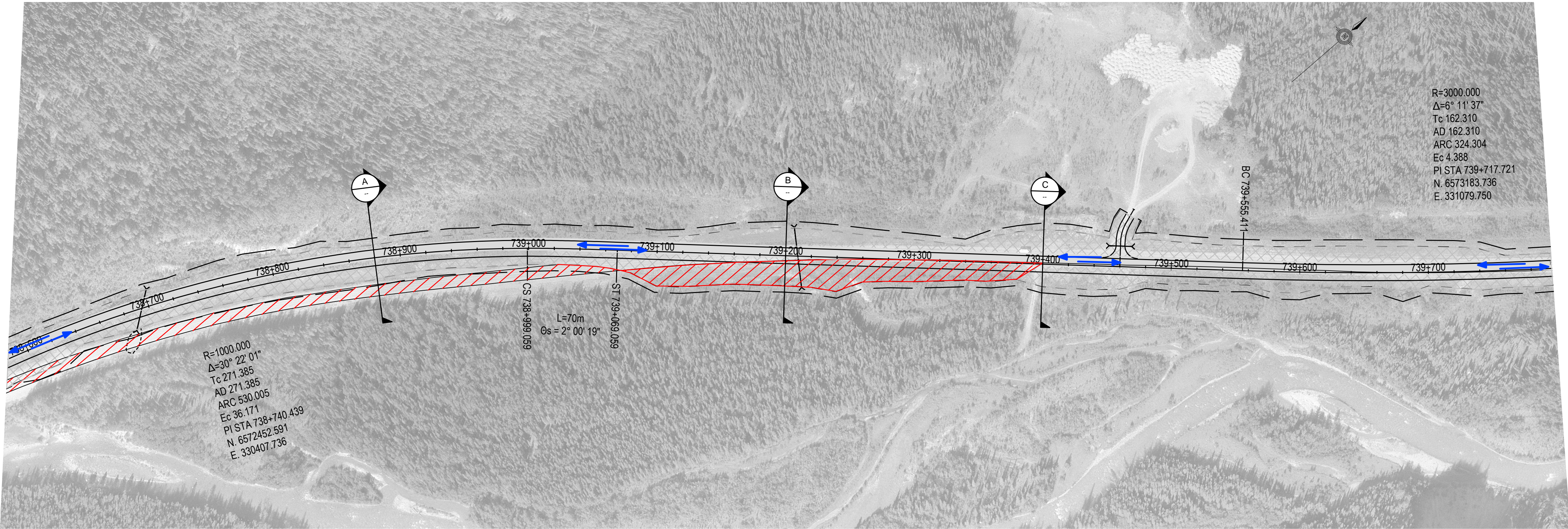

TRAFFIC:  
1. UTILIZE STAGE 2, AND STAGE 3 CONSTRUCTION

CONSTRUCTION:  
1. PULVERIZE EXISTING HIGHWAY (IF APPLICABLE)  
2. CONSTRUCT REMAINING ROAD EMBANKMENT AND GRAVELS

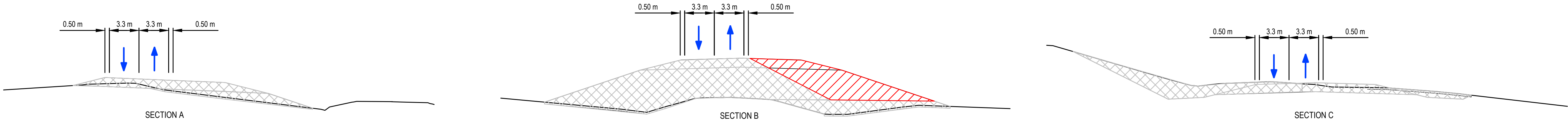

PUBLIC WORKS AND GOVERNMENT SERVICES CANADA		
TETRA TECH EBA		
Project title/Titre du projet		
KM 737 - 750.3 HIGHWAY REALIGNMENT ALASKA HIGHWAY, BC		
Approved by/Approuvé par G.WILKINS		
Designed by/Concept par A.HORWOOD / S.MATSUDA		
Drawn by/Dessiné par A.DEEPWELL		
PWGSC Project Manager/Administrateur de Projets TPSCG A. TAHERI		
PWGSC Architectural and Engineering Resources Manager/ Ressources Architectural et de Directeur d'ingénierie, TPSCG		
Client/client PUBLIC WORKS GOVERNMENT SERVICES CANADA		
Drawing title/Titre du dessin EXAMPLE REPRESENTATIVE CONSTRUCTION STAGING AND DETOUR DRAWINGS STAGE 3		
Project No./No. du projet R.017173.701	Sheet/Feuille C503	Revision no./ Lo Révision no. 0