

DO NOT SCALE DRAWINGS

Revision/ Révision	Description/ Description	Date/ Date

Client/ client

**Fisheries & Oceans Canada
Small Craft Harbours Branch
Pacific Division**

200 - 401 Burrard Street
Vancouver, Canada, V6C 3S4

Project title/Titre du projet

**COMOX VALLEY
SMALL CRAFT HARBOUR**

Approved by/ Approuvé par
M.B.

Designed by/ Concept par
J.A.

Drawn by/ Dessiné par
WSL

PWSC Project Manager/ Administrateur de Projets TPSGC

PWSC, Architectural and Engineering Resources Manager/
Ressources Architectural et de Directeur d'ingénierie, TPSGC

Client/ client

Drawing title/Titre du dessin

**TYPICAL FLOAT SECTIONS
FLOAT RECONSTRUCTION**

Project No./No. du projet	Sheet/Feuille	Revision no./ La Révision no.
---------------------------	---------------	----------------------------------

C-FR

002
OF

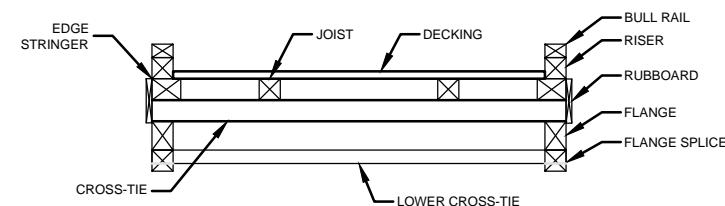

- BULL RAIL - 90 x 140
- RISER - 140 x 140
- EDGE STRINGER - 152 x 203
- CROSS-TIE - 152 x 152
- JOIST - 152 x 152

- FLANGE - 190 x 152
- LWR FLANGE SPLICE - 140 x 140 x 1200
- LOWER CROSS-TIE - 100 x 150

NOTE: LOWER CROSS TIES ARE TYPICALLY SECURED TO FLANGE TIMBER PROCEEDING AND FOLLOWING FLOTATION BLOCKS

FLOAT A - SECTION 1 COMPONENT DIMENSIONS [V X H(mm)]
SCALE 1:50

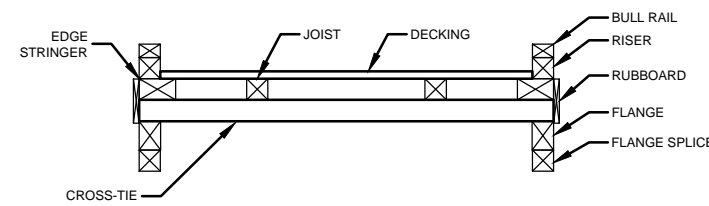

- BULL RAIL - 90 x 140
- RISER - 140 x 140
- EDGE STRINGER - 152 x 240
- CROSS-TIE - 152 x 152
- JOIST - 152 x 152
- FLANGE - 203 x 152
- LWR FLANGE BLOCK - 140 X 140 X 1200

FLOAT A - SECTION 2 COMPONENT DIMENSIONS [V X H(mm)]
SCALE 1:50

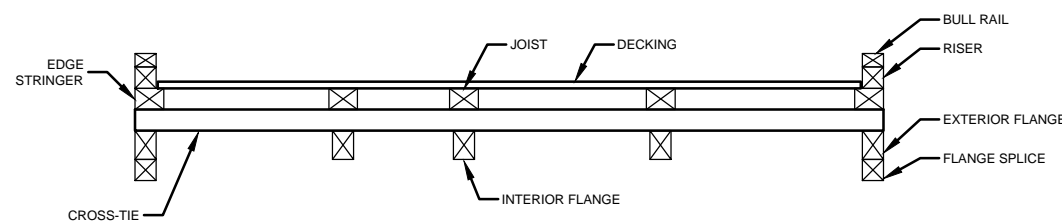

- BULL RAIL - 90 x 140
- RISER - 140 x 140
- EDGE STRINGER - 140 x 190
- CROSS-TIE - 152 x 152
- JOIST - 140 x 190
- EXTERIOR FLANGE - 190 x 140

- INTERIOR FLANGE - 190 x 140
 - LWR FLANGE SPLICE - 140 x 140 x 1200
- NOTE: INTERIOR FLANGE SPLICES ARE LOCATED ABOVE FLANGE TIMBERS BETWEEN CROSS TIE JOINS ASYMMETRICAL FLANGE LOCATION THE RESULT OF A PREVIOUS FLOAT EXPANSION

FLOAT B COMPONENT DIMENSIONS [V X H(mm)]
SCALE 1:50

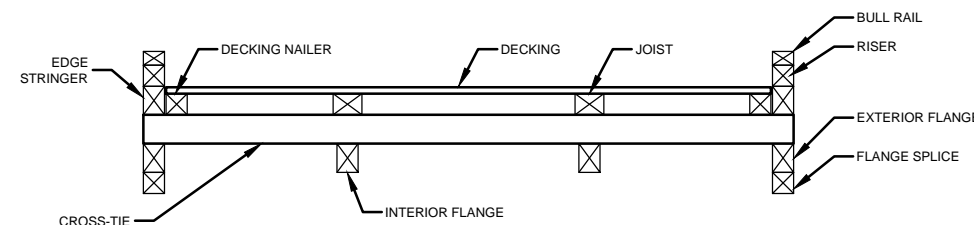

- BULL RAIL - 90 x 140
 - RISER - 140 x 140
 - EDGE STRINGER - 190 x 140
 - CROSS-TIE - 190 x 140
 - JOIST - 140 x 190
 - EXTERIOR FLANGE - 190 x 140
 - INTERIOR FLANGE - 190 X 140
 - LWR FLANGE SPLICE - 140 X 140 X 1200
 - DECKING NAILER - 140 X 140
- NOTE: INTERIOR FLANGE SPLICES ARE LOCATED ABOVE FLANGE TIMBERS BETWEEN CROSS TIE JOINTS

FLOAT C - SECTION 1 COMPONENT DIMENSIONS [V X H(mm)]
SCALE 1:50

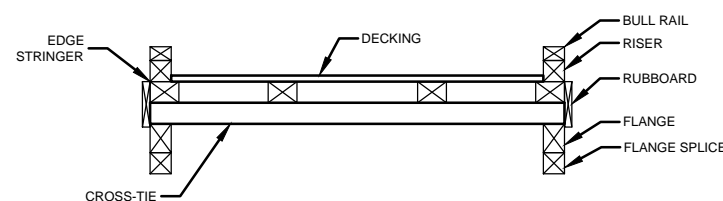

- BULL RAIL - 90 x 140
- RISER - 140 x 140
- EDGE STRINGER - 140 x 190
- CROSS-TIE - 152 x 203

- JOIST - 140 x 190
- FLANGE - 190 x 140
- LWR FLANGE SPLICE - 140 x 140 x 1200

FLOAT C - SECTION 2 COMPONENT DIMENSIONS [V X H(mm)]
SCALE 1:50

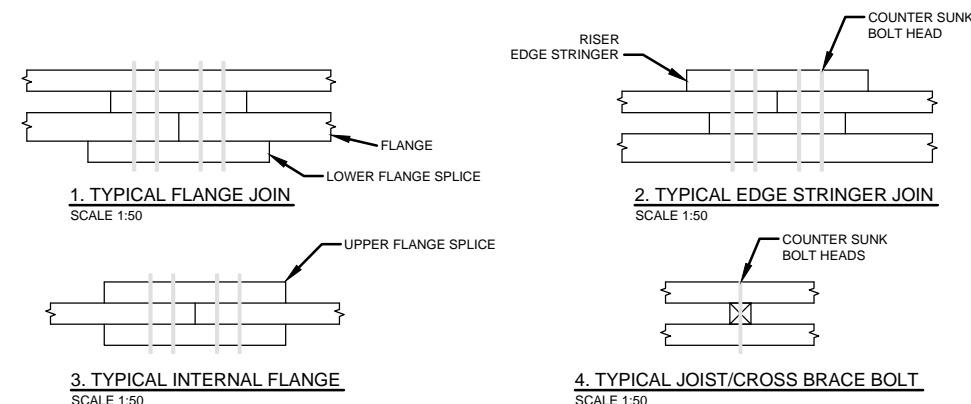

- DRAWING NOTES
- BULL RAILS NOT SHOWN FOR CLARITY
 - RISER BLOCKS ACT AS UPPER BLOCKS ON EDGE STRINGER JOINS
 - PROFILE #2 BOLTS ARE COUNTER SUNK IN RISER BLOCK
 - PROFILE #4 BOLT IS COUNTER SUNK IN JOIST TIMBER

