



RETURN BIDS TO:

RETOURNER LES SOUMISSIONS Á:

**Parks Canada Agency  
National Contracting Services  
Bid Receiving Unit  
111, Water Street East  
Cornwall ON K6H 6S3  
Attn: Céline morin**

## AMENDMENT N° 1

INVITATION TO TENDER

APPEL D'OFFRES

**Tender To: Parks Canada Agency**

We hereby offer to sell to Her Majesty the Queen in right of Canada, in accordance with the terms and conditions set out herein, referred to herein or attached hereto, the goods, services, and construction listed herein and on any attached sheets at the price(s) set out therefor.

**Soumission aux: l'Agence Parcs Canada**

Nous offrons par la présente de vendre à Sa Majesté la Reine du Chef du Canada, aux conditions énoncées ou incluses par référence dans la présente et aux annexes ci-jointes, les biens, services et construction énumérés ici et sur toute feuille ci-annexée, au(x) prix indiqué(s).

Comments - Commentaires

Vendor/Firm Name and Address

Raison sociale et adresse du fournisseur/de l'entrepreneur

Issuing Office - Bureau de distribution

**Parks Canada Agency  
111 Water Street East  
Cornwall ON K6H 6S3**

Title-Sujet <b>Design of Expansion Joints of Dam of Saint-Ours Island NHP, QC</b>		Date <b>July 14, 2015</b>
Solicitation No. - No. de l'invitation <b>5P300-15-5196</b>	Client Ref. No. - No. de réf du client.	
GETS Reference No. - No de reference de SEAG <b>5P300-15-5196</b>		
Solicitation Closes L'invitation prend fin -  <b>at - à 10:00 AM on - le 2015-07-17</b>	Time Zone Fuseau horaire -  <b>Eastern Daylight Time (EDT)</b>	
F.O.B. - F.A.B. <b>Plant-Usine: <input type="checkbox"/> Destination: <input type="checkbox"/> Other-Autre: <input type="checkbox"/></b>		
Address Inquiries to: - Adresser toute demande de renseignements à : <b>Céline Morin (celine.morin@pc.gc.ca)</b>		
Telephone No. - No de téléphone <b>613-938-5940</b>	Fax No. - No de FAX:	
Destination of Goods, Services, and Construction: Destinations des biens, services et construction:  <b>See Herein</b>		
Vendor/Firm Name and Address Raison sociale et adresse du fournisseur/de l'entrepreneur :		
Telephone No. - No de téléphone: _____		
Facsimile No. - N° de télécopieur: _____		
Email- Courriel : _____		
Name and title of person authorized to sign on behalf of the Vendor/Firm Nom et titre de la personne autorisée a signer au nom du fournisseur/ de l'entrepreneur		
_____ Name / Nom		_____ Title / Titre
_____ Signature		_____ Date

# **AMENDMENT N° 1**

**THE PURPOSE OF THIS AMENDMENT IS TO GIVE EFFECT TO THE FOLLOWING:**

1. Under “**APPENDIX 1 - BID AND ACCEPTANCE FORM (BA)**”

DELETE:

**BA06 CONSTRUCTION TIME**

The Contractor shall perform and complete the Work by August 26 2016.

and REPLACE WITH:

**BA06 CONSTRUCTION TIME**

The Contractor shall perform and complete the Work by October 30, 2016.

2. See attached SNC Lavalin document (Addendum1 – July 2015) which includes the following information and to:
  - Add Addendum 1 to the ITT
  - Find the answers to 2 Questions under “Questions from contractors”
  - Find Appendix A - Photos
  - Find Appendix B – “Quantity Take-Off” which MUST be returned with your bid once completed
  - Find Appendix C - Drawing
3. See attached PDF file (Plans annotés - noted - BIL - 2015 07 14) for the noted plans.

**ALL OTHER TERMS AND CONDITIONS OF THE ITT REMAIN THE SAME.**

---

**Signed copy of this amendment should accompany each tender. If your tender has already been submitted please sign and fax the amendment along with any revisions to tender price, to this office before the close of Tender.**

**Fax: 1-877-558-2349**



**PARKS CANADA**

**DAM OF SAINT-OURS ISLAND  
Quebec**

**Design of Expansion Joints of L.H.N.C.**

**Addendum 1**

**July 2015**

Prepared by : James Victor, Eng.

Approved by : Stephane Perron, Eng.

*Victor, eng.*  
*Perron, eng.*





**TABLE OF CONTENTS**

		<b>PAGE</b>
<b>1</b>	<b>ADDENDUM 1</b>	<b>1-1</b>
<b>2</b>	<b>QUESTIONS FROM CONTRACTORS</b>	<b>2-1</b>
<b>2.1</b>	<b>Question n° 1</b>	<b>2-1</b>
<b>2.1.1</b>	<b>Answer n° 1</b>	<b>2-1</b>
<b>2.2</b>	<b>Question n° 2</b>	<b>2-1</b>
<b>2.2.1</b>	<b>Answer n° 2</b>	<b>2-1</b>
<b>APPENDIX A</b>	<b>Photos</b>	
<b>APPENDIX B</b>	<b>Quantity Take-Off</b>	
<b>APPENDIX C</b>	<b>Drawing</b>	



**1 ADDENDUM 1**

- As shown on the attached sketch, the Contractor shall identify each expansion joint by numbering them from 1 to 16 starting from the side of the fish ladder (Saint-Roch-sur-Richelieu);
- the Contractor shall take the dimensions of each joint in order to manufacture an expansion joint for each individual bridge joint. The joint dimensions may vary from one another;
-  • the Contractor shall provide and deliver to Parks Canada warehouse sixteen (16) expansion joints;
-  • the Contractor shall install expansion joint no. 16 in 2015 under winter conditions (Phase 1). The remaining 15 expansion joints shall be installed in 2016 under non-winter conditions (Phase 2). The Contractor shall transport the joints from Parks Canada warehouse to site;
- electrical power shall be supplied to the Contractor for the purpose of feeding the Contractor's trailer:
  - 120/208 V (30 A),
  - 600 V (30 A);
- the attached drawing (Appendix C) indicates the area where the Contractor can temporarily install the trailer;
- after each work shift, the Contractor shall verify that sufficient access exists for the passage of emergency vehicles such as fire trucks and that all the handrails are securely fastened ;
- the working hours shall be from Monday to Friday 7:30 AM to 6:00 PM;
- the attached photographs are given to identify the general condition of the joints; they shall not be used for construction. The Contractor shall assess each joint individually;
- when required, Parks Canada will dismantle the emergency floodlights on any of the supporting piers;
- the working method of the Contractor shall be such as not to impede the passage by foot or by cart of the personnel of Parks Canada;
- the Contractor shall lock the bridge gates before their departure from the work site.



**2 QUESTIONS FROM CONTRACTORS**

**2.1 Question n° 1**

*The water tight rubber extrusion shall be installed on the job site. In order to install this rubber, we need a minimum of 50 mm under the Z-50 angle with a minimum opening width of 38 mm.*

*We only see an opening of 13 mm on section C-C of drawing 1 which is not enough to install the rubber. This will also prevent any future replacement.*

**2.1.1 Answer n° 1**

The drawing will be modified to show a demolition depth of 100 mm at center and 75 mm at the edge. The rubber must be installed at the workshop.

**2.2 Question n° 2**

Can the installation be done in one full section for the length of the joint?

**2.2.1 Answer n° 2**

Yes.



**SNC • LAVALIN**

---

**Appendix A**

**Photos**



Accès\_Côté St-Roch-sur-Richelieu



Barrière d'accès Est



Joint #1 Nord



Joint #1 Sud





Joint #2 Nord



Joint #2 Sud



Joint #3 et #4 Nord



Joint #3 Nord



Joint #3 Sud



Joint #13 et #14 Nord



Joint #15 Nord



Joint #15 Sud



Joint #16 Nord



Joint #16 Sud



Joints #5 et #6 Nord



Joints #5 et #6 Sud



Joints #7 et #8 Nord



Joints #7 et #8 Sud



Joints #9 et #10 Nord



Joints #9 et #10 Sud



Joints #11 et #12 Nord



Joints #11 et #12 Sud



Joints #13 et #14 Nord



Joints #13 et #14 Sud



Joints #15 et #16 Sud



Joints #16 et secteur entreposage\_St-Ours



Secteur entreposage St-Ours Nord



Secteur entreposage St-Ours Sud



**SNC • LAVALIN**

---

**Appendix B**

**Quantity Take-Off**

 <b>SNC•LAVALIN</b> Hydro Division	Document No.	Revision		Page
		N°	Date	
		01	2015-07-13	1

### Quantity Take-Off – Addendum 1

1

1

Art.	Ref.	Work Description	Qty	Unit	Unit Cost	Total Cost
1.0		<b>PHASE 1</b>				
1.1		Dimensional measurements for fabrication of a new joint	16	Unit		
1.2		Mobilization of the general contractor and site preparation	1	Lot		
1.3		Removal and reinstallation of guard rails in winter conditions	1	Lot		
1.4		Removal of existing joint (n° 16) and preparation for demolition in winter conditions	1	Unit		
1.5		Supply and delivery to Parks Canada warehouse of new joints, including premoulded extrusion seal installed by supplier	16	Unit		
1.6		Install new expansion joint (n° 16) in winter conditions, including transport of joint from Parks Canada warehouse	1	Unit		
1.7		Site cleaning and demobilization	1	Lot		
		<b>Subtotal Phase 1</b>				



 <b>SNC-LAVALIN</b> Hydro Division	Document No.	Revision		Page
		N°	Date	
		01	2015-07-13	2

### Quantity Take-Off – Addendum 1

Art.	Ref.	Work Description	Qty	Unit	Unit Cost	Total Cost
2.0		<b>PHASE 2</b>				
2.1		Mobilization of the general contractor and site preparation	1	Lot		
2.2		Removal and reinstallation of guard rails	1	Lot		
2.3		Removal of existing joint and preparation for demolition	15	Unit		
2.4		Concrete demolition and preparation of surfaces	1	Lump Sum		
2.5		Supply and delivery to Parks Canada warehouse of extra premoulded extrusion seal as spare part	1	Unit		
2.6		Install new expansion joint in non winter conditions, including transport of joint from Parks Canada warehouse	15	Unit		
2.7		Site cleaning and demobilization	1	Lot		
		<b>Subtotal Phase 2</b>				
		<b>Total</b>				

1



**SNC • LAVALIN**

---

**APPENDIX C**

**Drawing**

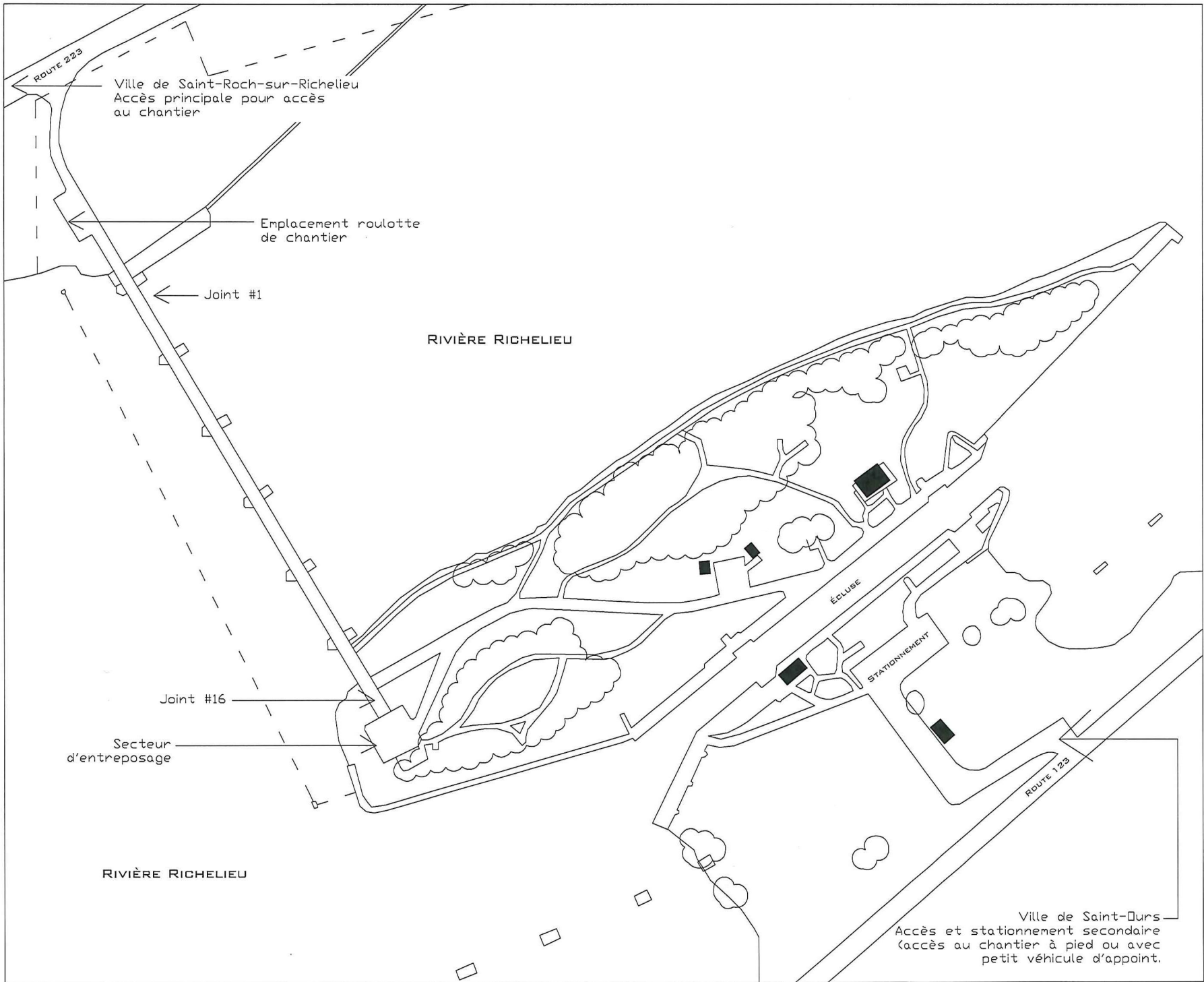

ROUTE 223  
Ville de Saint-Roch-sur-Richelieu  
Accès principale pour accès  
au chantier

Emplacement roulotte  
de chantier

Joint #1

RIVIÈRE RICHELIEU

Joint #16

Secteur  
d'entreposage

RIVIÈRE RICHELIEU

ÉCLUSE

STATIONNEMENT

ROUTE 123

Ville de Saint-Durs  
Accès et stationnement secondaire  
(accès au chantier à pied ou avec  
petit véhicule d'appoint.)