

File Name: P:\Projects\2014\14-1538-003\dwg\issued FOR TENDER\DWG\14-1538-003_S01-S05_Rev 0.dwg - Tab: S05 Plotted By: JCarlos 15/07/22 [Wed 4:50pm]
 1:1x17 PLOT SCALE: 1:20

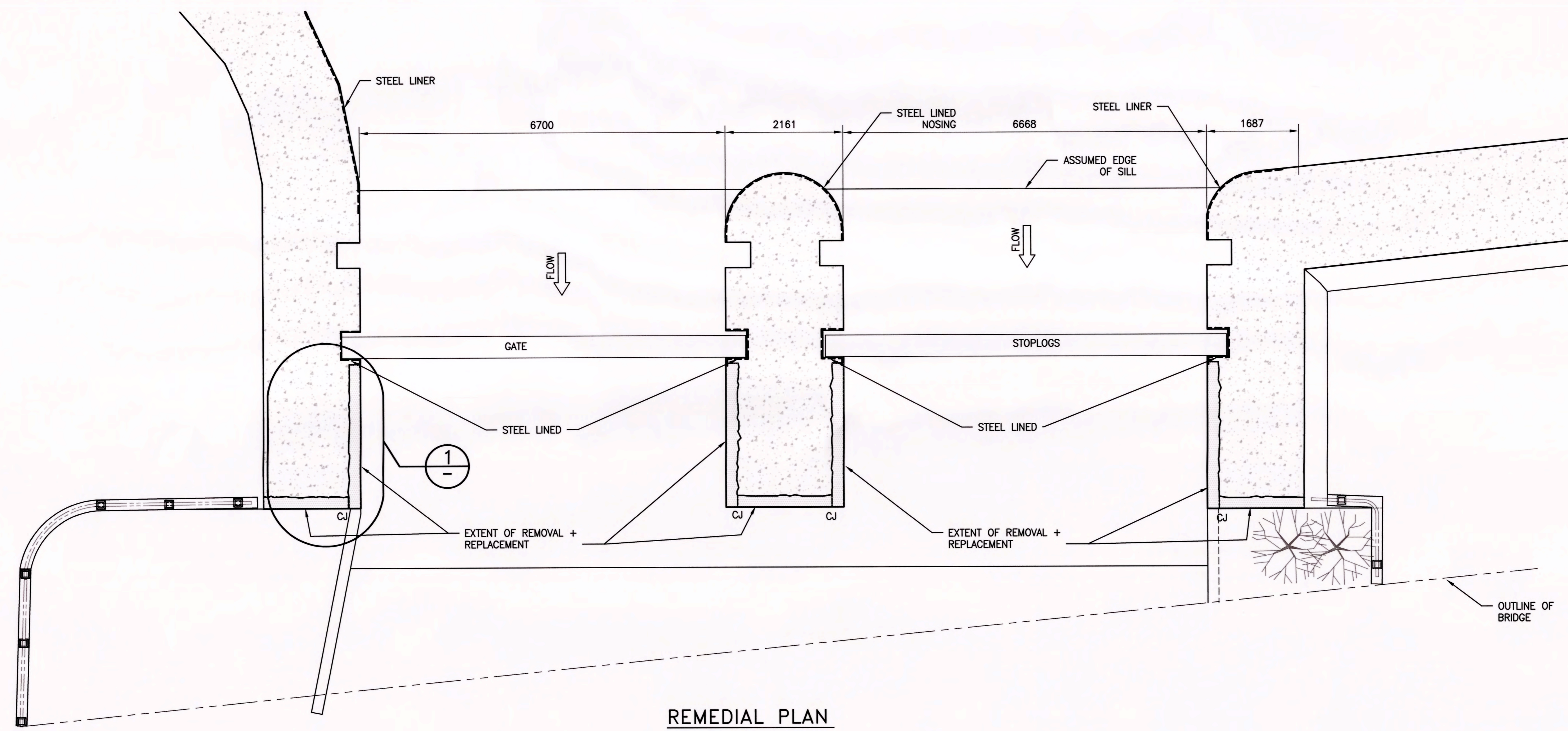

REMEDIAL PLAN
SCALE: 1:50

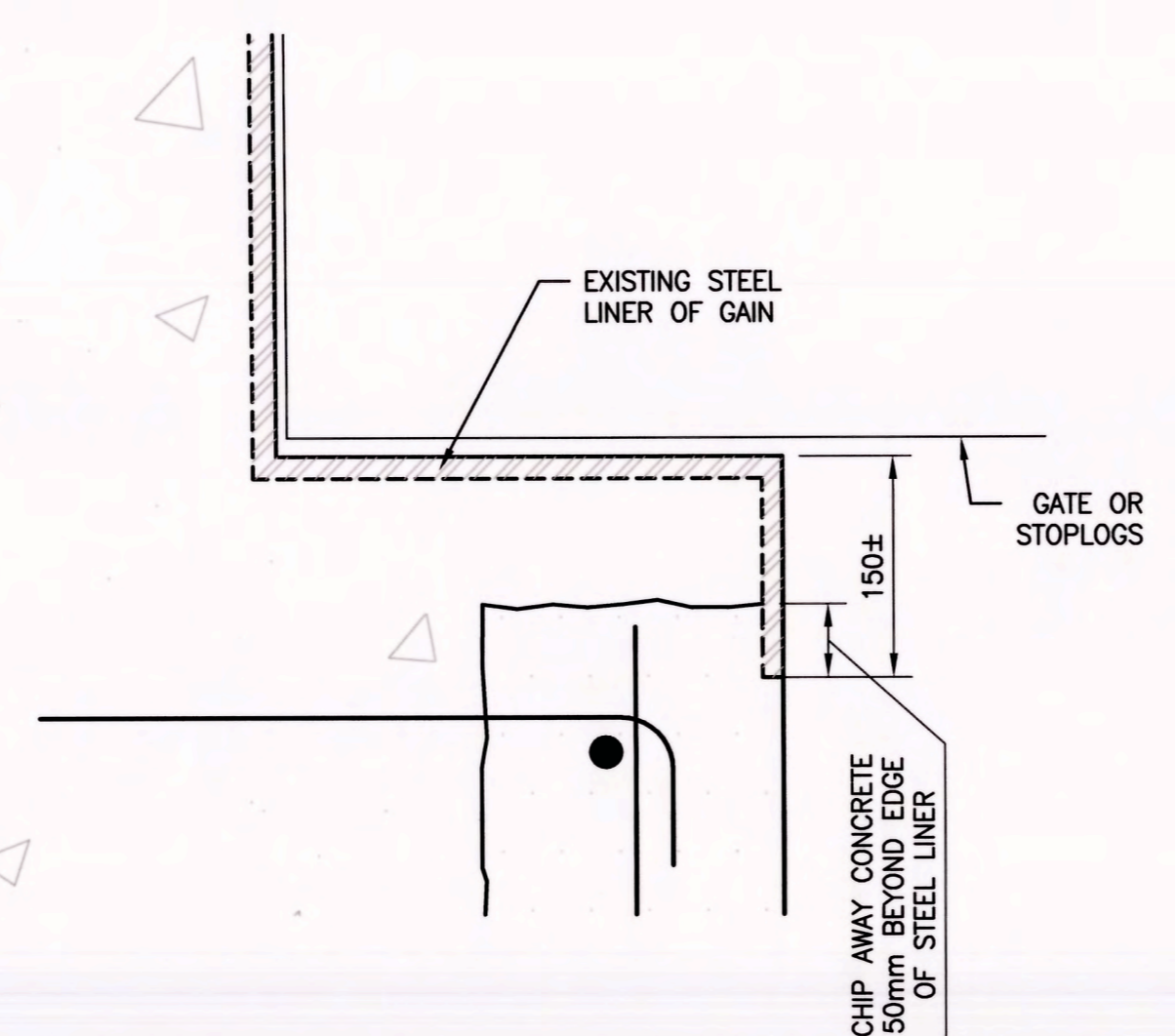

2 TYPICAL DETAIL
SCALE: 1:5

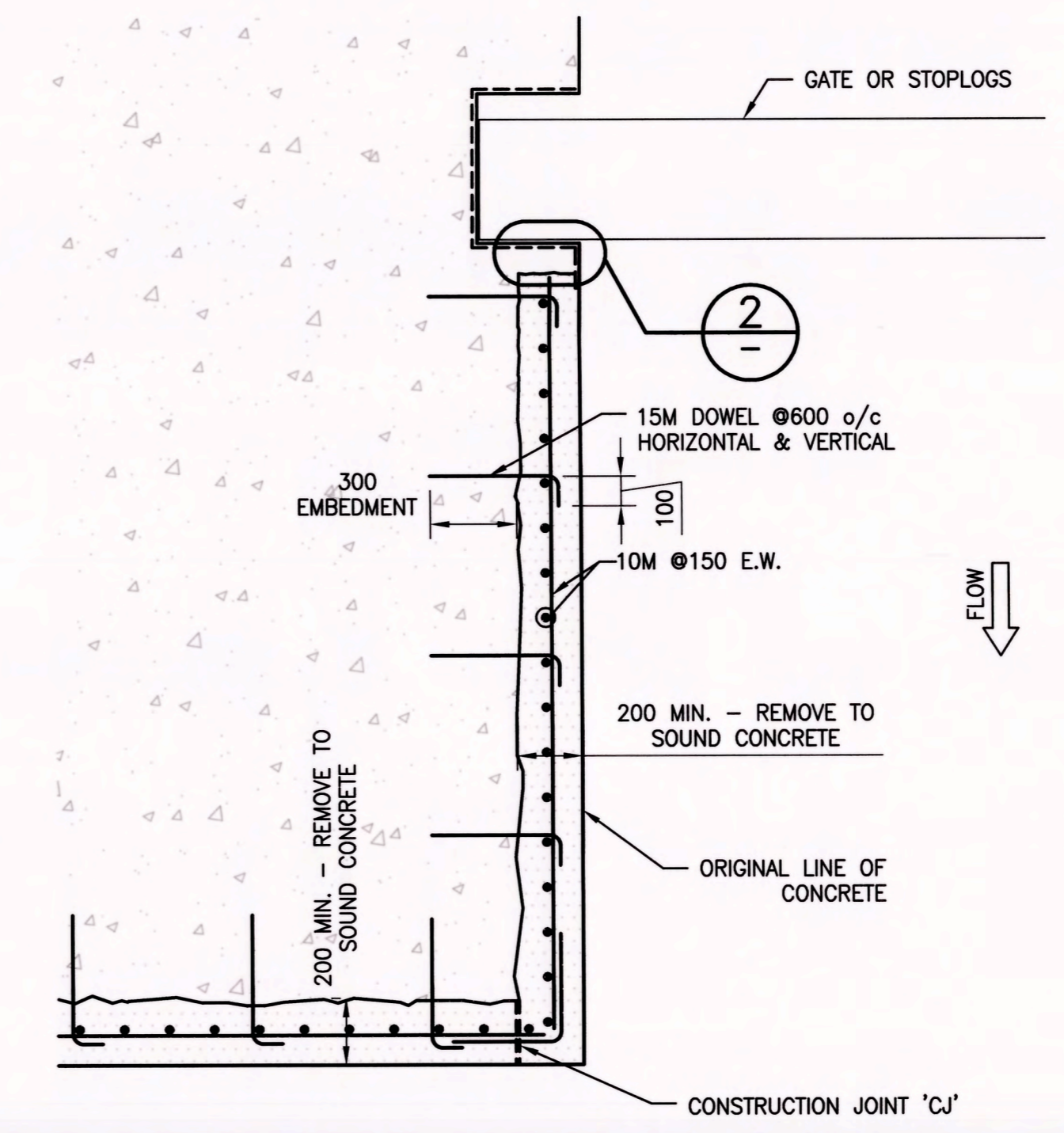

1 TYPICAL DETAIL
SCALE: 1:20

- NOTES:**
- DRAWING IS BASED ON SURVEY CONDUCTED AT SITE BY T. A. BUNKER SURVEYING LTD ON FEBRUARY 2015 + OBSERVATIONS FROM UNDERWATER SURVEY BY LOWER LAKE MARINE.
 - ELEVATIONS REPORTED HEREON ARE REFERRED TO THE GEODETIC DATUM CGVD28 (Canadian Geodetic Vertical Datum 1928) FRAMEWORK, AND ARE DERIVED FROM CONTROL MONUMENT 0011948U606G, HAVING AN ELEVATION OF 103.387.
 - ALL DRILLED IN PLACE ANCHORS SHALL BE INSTALLED IN STRICT ACCORDANCE WITH HILTI RECOMMENDATIONS.
 - CONCRETE STRENGTH: 30 MPa @28 DAYS TO MEET THE REQUIREMENTS OF SPECIFICATION SECTION 03300.
 - MINIMUM COVER TO REINFORCEMENT 60mm.

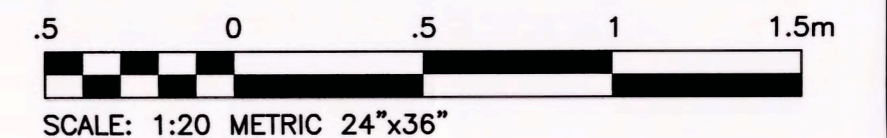
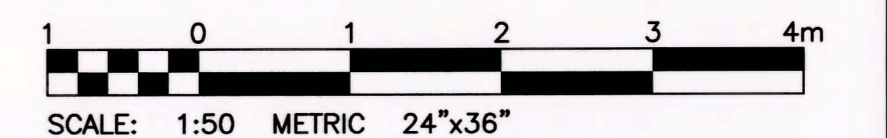

0	15/07/22	ISSUED FOR TENDER	KH
NO.	YY/MM/DD	DESCRIPTION	BY
REVISIONS / ISSUE			
CLIENT: Parks Canada			
PROJECT: MERRICKVILLE DAM			
DWG. DESCRIPTION: CONCRETE REPAIR PLAN AND DETAILS			
DESIGN BY:	PHR	DATE (YY/MM/DD):	15/03/02
DESIGN CHECK:	H. Hampton	DATE:	22/07/15
DRAWN BY:	JTC	DATE:	15/03/04
DWG. CHECK:	H. Hampton	DATE:	22/07/15
DWG. NO.	14-1538-003	S05	0

