

The following change(s) to the tender documents are effective immediately, and will form part of the contract documents:

1. GENERAL

1.1	The Bidding Documents are amended as noted in this Addendum, which consists of 5 pages.
1.2	This Addendum is issued prior to bid closing to incorporate revisions noted herein. Include in the Bid price all such revisions which will become part of the Work. Perform all such Work in accordance with the Contract Documents.
1.3	All affected drawings, schedules and panel changes shall be reflected in final as-built and manual submissions.

2. CHANGES TO PREVIOUS ADDENDA

2.1	N/A
-----	-----

3. DRAWINGS

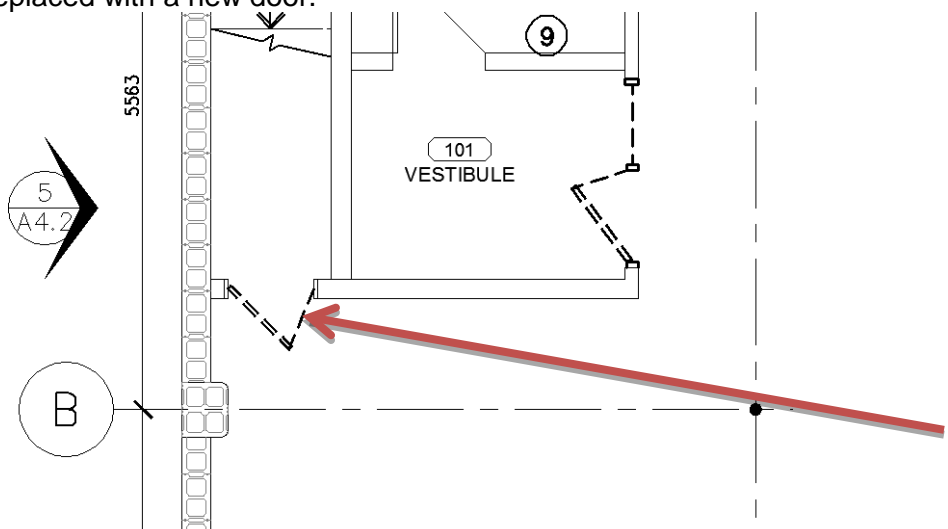
3.1	<p><u>Refer to Drawing 1/A2.1 – Demolition Floor Plan</u></p> <p>Door (D105AA in Room D105A Under Stair) east of Room 101 Vestibule is to be removed and replaced with a new door.</p>  <p>Partial plan: 1/A2.1 – Demolition Floor Plan</p>
3.2	<p><u>Refer to 1/A6.1 Door, Window, Frame & Hardware Schedule.</u></p> <p>Add "FRAME" to the table cell to the right of Hardware.</p>

3.3

Refer to 1/A6.1 Door, Window, Frame & Hardware Schedule.

Revise **Door D101A** as follow:

D101A – Existing aluminum glass door with sidelite to be removed and replaced with new.

Door

Hardware Group - 9

Size - 914mm x 2083mm x 45mm

Material – HM

Thickness – 1.6

Acoustic Insulation – YES

Thermal Insulation – no

Finish – PT

Colour – C04

Glazing – no

Partial Hardware Requirements

Hinges – PINNED

Viewer – Yes

Closer – Yes

Weatherstripping – Yes

Door Sweep – Yes

Threshold – Yes

Lockset – F15

Frame

Material – HM

Thickness – 1.6

Acoustic Insulation – YES

Thermal Insulation – no

Finish – PT

Colour – C04

Glazing – no

Window Coverings – no

Remarks – 5

3.4	<p><u>Refer to 1/A6.1 Door, Window, Frame & Hardware Schedule.</u></p> <p>Revise Door D101B as follow:</p> <p>D101B – Add door closer.</p> <p><u>Partial Hardware Requirements</u> Closer – Yes</p>
3.5	<p><u>Refer to 1/A6.1 Door, Window, Frame & Hardware Schedule.</u></p> <p>Revise Door D104A as follow:</p> <p><u>Partial Hardware Requirements</u> Hinges – NOT pinned Viewer – not required</p> <p>Note: Lockset function is to be F13 as indicated.</p>
3.6	<p><u>Refer to 1/A6.1 Door, Window, Frame & Hardware Schedule.</u></p> <p>ADD Door D105AA to Schedule as follows:</p> <p><u>Door</u> Hardware Group – 4 Size – Existing – Confirm Material – HM Thickness – 1.6 Acoustic Insulation – no Thermal Insulation – no Finish – PT Colour – C04 Glazing – no</p> <p><u>Hardware</u> Hinges – NOT pinned Viewer – no Closer – YES Weatherstripping – YES Door Sweep – YES Threshold – YES Lockset – F04</p> <p><u>Frame</u> Existing to remain Finish – PT Colour – C04</p>

3.7	<p><u>Refer to 1/A6.1 Door, Window, Frame & Hardware Schedule.</u></p> <p>Revise Door D105A as follow:</p> <p><u>Partial Hardware Requirements</u> Hinges – NOT pinned</p>
3.8	<p><u>Refer to 1/A6.1 Door, Window, Frame & Hardware Schedule.</u></p> <p>Revise Door D106A as follow:</p> <p><u>Partial Hardware Requirements</u> Viewer – not required Weatherstripping – not required</p>
3.9	<p><u>Refer to 1/A6.1 Door, Window, Frame & Hardware Schedule.</u></p> <p>Revise Door D110A as follow:</p> <p><u>Partial Hardware Requirements</u> Closer – YES Lockset – Revise to F07</p>
3.10	<p><u>Refer to 1/A6.1 Door, Window, Frame & Hardware Schedule.</u></p> <p>Revise Door D113B (interior) as follow:</p> <p><u>Partial Hardware Requirements</u> Hinges – NOT pinned Viewer – not required Door Sweep – not required Threshold – not required Weatherstripping – not required</p>
3.11	<p><u>Refer to 1/A6.1 Door, Window, Frame & Hardware Schedule.</u></p> <p>Revise Door D114A as follow:</p> <p><u>Partial Hardware Requirements</u> Hinges – NOT pinned Viewer – not required Door Closer – not required</p>

3.12	<p><u>Refer to 1/A6.1 Door, Window, Frame & Hardware Schedule.</u></p> <p>Revise Door D116A as follow:</p> <p><u>Partial Hardware Requirements</u></p> <p>Lockset – Revise to F07</p>
3.13	<p><u>Refer to Drawing Sheet A6.2 and Section 12 21 13</u></p> <p>Add general note:</p> <p>4. Provide HORIZONTAL LOUVRE BLINDS for all glazing interior and exterior glazing units including door glazing unless noted otherwise.</p>

4. SPECIFICATIONS

4.1.	<p>Refer to Section 08 71 00 – Door Hardware</p> <p>1. Ensure All Doors are equipped with LEVERS; no knobs.</p>
------	---

5. ATTACHMENTS

5.1	Sheet A6.1 r01 - DOORS, WINDOWS & FRAMES
-----	--

End of Addendum No.3.

			FIRE RATING (U/C LABEL)	HARDWARE GROUP	SIZE (CONFIRM ON SITE)	DOOR					HARDWARE													FRAME		WINDOW COVERINGS			
						MATERIAL	THICKNESS	ACOUSTIC INSULATION	THERMAL INSULATION	FINISH	COLOUR	GLAZING	HINGES	VIEWER	CLOSER	WEATHER STRIPPING	DOOR SWEEP	THRESHOLD	LOCKSET	MATERIAL	THICKNESS	ACOUSTIC INSULATION	THERMAL INSULATION	FINISH	COLOUR	GLAZING		REMARKS	
D100A	EXTERIOR	-	1	EXISTING - CONFIRM		HM	1.6	-	YES	PT	C04	-	PINNED	YES	YES	YES	YES	YES	F13	HM	1.6	-	YES	PT	C04	-	-	5	
D101B	VESTIBULE	-	2	EXISTING - CONFIRM	EXISTING DOOR TO REMAIN	HM	1.6	-	-	PT	C04	-	-	YES	YES	YES	YES	YES	F13	EXISTING FRAME TO REMAIN	PT	C04	-	PT	C04	-	-	1	
D101A	VESTIBULE	-	9	914mm x 2083mm x 45mm		HM	1.6	YES	-	PT	C04	-	PINNED	YES	YES	YES	YES	YES	F15	HM	1.6	YES	-	PT	C04	-	-	5	
D104A	PROJECT ROOM	-	3	914mm x 2083mm x 45mm		HM	1.6	YES	-	PT	C04	-	-	-	YES	YES	YES	YES	F13	HM	1.6	YES	-	PT	C04	-	YES	3	
D105AA	UNDER STAIR	-	4	EXISTING - CONFIRM		HM	1.6	-	-	PT	C04	-	-	-	YES	YES	YES	YES	F04	EXISTING FRAME TO REMAIN	PT	C04	-	PT	C04	-	-		
D105A	NCO I/C TRAFFIC UNIT OFFICE	-	4	914mm x 2083mm x 45mm		HM	1.6	-	-	PT	C04	T1	-	-	YES	YES	YES	YES	F04	HM	1.6	-	-	PT	C04	T1	YES		
G105A	NCO I/C TRAFFIC UNIT OFFICE	-	-	-		-	-	-	-	-	-	-	-	-	-	-	-	-	-	HM	1.6	-	YES	PT	C04	T1	YES		
G105B	NCO I/C TRAFFIC UNIT OFFICE	-	-	-		-	-	-	-	-	-	-	-	-	-	-	-	-	-	HM	1.6	-	YES	PT	C04	T1	YES		
G105C	NCO I/C TRAFFIC UNIT OFFICE	-	-	-		-	-	-	-	-	-	-	-	-	-	-	-	-	-	HM	1.6	-	YES	PT	C04	T1	YES		
D106A	EXHIBIT ROOM	45	5	914mm x 2083mm x 45mm		HM	1.6	-	-	PT	C04	-	PINNED	-	YES	-	YES	YES	F15K	HM	1.6	-	-	PT	C04	-	-	4	
D107A	WOMEN CHANGE	-	6	914mm x 2083mm x 45mm		HM	1.6	-	-	PT	C04	-	-	-	YES	-	-	-	F01	HM	1.6	-	-	PT	C04	-	-		
D108A	MEN CHANGE	-	6	914mm x 2083mm x 45mm		HM	1.6	-	-	PT	C04	-	-	-	YES	-	-	-	F01	HM	1.6	-	-	PT	C04	-	-		
D110A	STORAGE/ JANITOR	45	7	914mm x 2083mm x 45mm		HM	1.6	-	-	PT	C04	-	-	-	YES	-	-	-	F07	HM	1.6	-	-	PT	C04	-	-		
D111A	WOMEN WC	-	8	914mm x 2083mm x 45mm		HM	1.6	-	-	PT	C04	-	-	-	YES	-	-	-	F22	HM	1.6	-	-	PT	C04	-	-		
D112A	MEN WC	-	8	914mm x 2083mm x 45mm		HM	1.6	-	-	PT	C04	-	-	-	YES	-	-	-	F22	HM	1.6	-	-	PT	C04	-	-		
D113A	EXTERIOR	45	9	EXISTING - CONFIRM		HM	1.6	-	YES	PT	C04	-	PINNED	YES	YES	YES	YES	YES	F15	HM	1.6	-	YES	PT	C04	-	-	5	
D113B	ENTRY	-	10	914mm x 2083mm x 45mm		HM	1.6	-	-	PT	C04	T1	-	-	YES	-	-	-	F01	HM	1.6	-	YES	PT	C04	-	YES		
D114A	COLLUSION/ RECONSTRUCTION OFFICE	-	11	914mm x 2083mm x 45mm		HM	1.6	-	-	PT	C04	-	-	-	YES	YES	YES	YES	F04	HM	1.6	-	-	PT	C04	-	-		
D116A	MECHANICAL/ ELECTRICAL	45	6	914mm x 2083mm x 45mm		HM	1.6	-	-	PT	C04	-	-	-	YES	-	-	-	F07	HM	1.6	-	-	PT	C04	-	-		
D116B	MECHANICAL/ ELECTRICAL	45	12	EXISTING - CONFIRM		HM	1.6	-	YES	PT	C04	-	PINNED	YES	YES	YES	YES	YES	F15	HM	1.6	-	YES	PT	C04	-	-	5	
WD102A	TRAFFIC SERVICES OPEN OFFICE AREA	45	-	-		-	-	-	-	-	-	-	-	-	-	-	-	-	-	ALUM	-	-	YES	ALUM	-	SU1	YES		
WD102B	TRAFFIC SERVICES OPEN OFFICE AREA	45	-	-		-	-	-	-	-	-	-	-	-	-	-	-	-	-	ALUM	-	-	YES	ALUM	-	SU1	YES		
WD102C	TRAFFIC SERVICES OPEN OFFICE AREA	45	-	-		-	-	-	-	-	-	-	-	-	-	-	-	-	-	ALUM	-	-	YES	ALUM	-	SU1	YES		
WD102D	TRAFFIC SERVICES OPEN OFFICE AREA	-	-	-		-	-	-	-	-	-	-	-	-	-	-	-	-	-	ALUM	-	-	YES	ALUM	-	SU2	YES		
WD102E	TRAFFIC SERVICES OPEN OFFICE AREA	-	-	-		-	-	-	-	-	-	-	-	-	-	-	-	-	-	ALUM	-	-	YES	ALUM	-	SU2	YES		
WD102F	TRAFFIC SERVICES OPEN OFFICE AREA	-	-	-		-	-	-	-	-	-	-	-	-	-	-	-	-	-	ALUM	-	-	YES	ALUM	-	SU2	YES		
WD114A	COLLUSION/ RECONSTRUCTION OFFICE	45	-	-		-	-	-	-	-	-	-	-	-	-	-	-	-	-	GLB	-	-	-	-	-	GLB	YES		
WD118A	COPY	45	-	-		-	-	-	-	-	-	-	-	-	-	-	-	-	-	GLB	-	-	-	-	-	GLB	YES		
				REMARKS																									
			1	ADD HARDWARE TO EXISTING																									
			2	EXISTING TO REMAIN																									
			3	ACOUSTIC DOOR - FRAME AND HARDWARE																									
			4	with 1.2 mm CRS. 1.6 mm steel having a strike bucket which will accept a 25 mm throw dead bolt. Wedge in the area of the strike bucket to prevent																									
			5	ONE HAND EGRESS																									
F01	Passage or Closet Latch:					Latchbolt operated by knob from either side at all times.																							
F07	Store Room or Closet Lock:					Latchbolt operated by key from outside or by rotating inside knob. Outside knob is always inoperative. Auxiliary deadlatch.																							
F13	Dormitory or Exit Lock:					Latchbolt operated by knob from either side. Deadbolt projected by key from outside and turn from inside. Rotating inside knob																							
F15	Hotel Guest Room Lock:					Latchbolt operated by key from outside or by rotating inside knob. Outside knob is always inoperative. Deadbolt operated by turn																							
F15K	Hotel Guest Room Lock w. Knob					Latchbolt operated by key from outside or by rotating inside knob. Outside knob is always inoperative. Deadbolt operated by turn																							
F22	Bath/Bedroom/Privacy Lock:					Latchbolt retracted/operated by knob/lever from either side unless outside is locked by the inside thumbturn. Turning inside knob/lever																							

1 DOOR, WINDOW, FRAME & HARDWARE SCHEDULE
A6.1 SCALE :

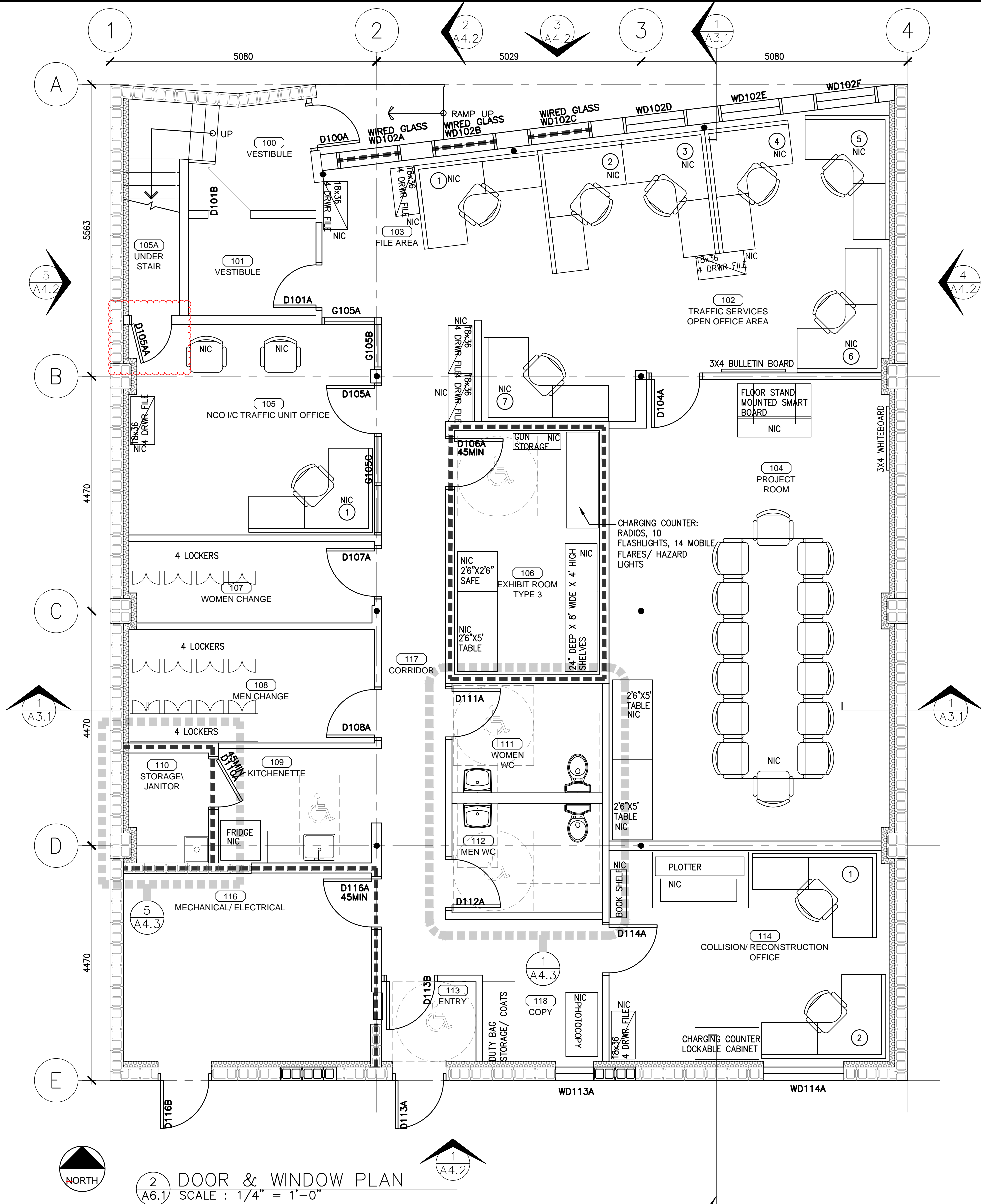

2 DOOR & WINDOW PLAN
A6.1 SCALE : 1/4" = 1'-0"

Public Works and Government Services Canada

Travaux publics et Services gouvernementaux Canada

REAL PROPERTY SERVICES
Western Region

Client

Client

Client

Client

PRELIMINARY
NOT FOR CONSTRUCTION

CK

A + ID

COUPLAND KRAEMER
ARCHITECTURE + INTERIOR DESIGN Inc.

101, 4832 1ST SE, CALGARY, AB, CANADA, T2G 2L3
TEL: 403.269.7109
FAX: 403.269.7595

DAVID R. COUPLAND
Reg. No. 642 Calgary

D	ISSUED WITH ADDENDUM #03	2015/08/21
C	ISSUED FOR TENDER	2015/07/11
B	ISSUED FOR 99% REVIEW	15/04/08
A	ISSUED FOR 50% REVIEW	15/02/24
REVISIONS	DESCRIPTION	DATE
A	detail number	
B	number of detail	
C	source drawing no.	
	de dessin no.	
	detail on drawing no.	
	detail sur dessin no.	
project title	RCMP ESTEVAN TENANT FIT-UP	
drawing title	1320 4TH STREET ESTEVAN, SASKATCHEWAN	
designed by	conçu par	
drawn by	dessiné par	
approved by	approuvé par	
PM/OSC Project Manager	Administrateur de Projets TPSGC	
scale	échelle	sheet
project no.	R.063116.001	project no.
date	AUGUST 21, 2015	date
		OF XX