

1 COMMERCIAL BUILDING EXTERIOR LIGHTING PLAN
SCALE 1:100

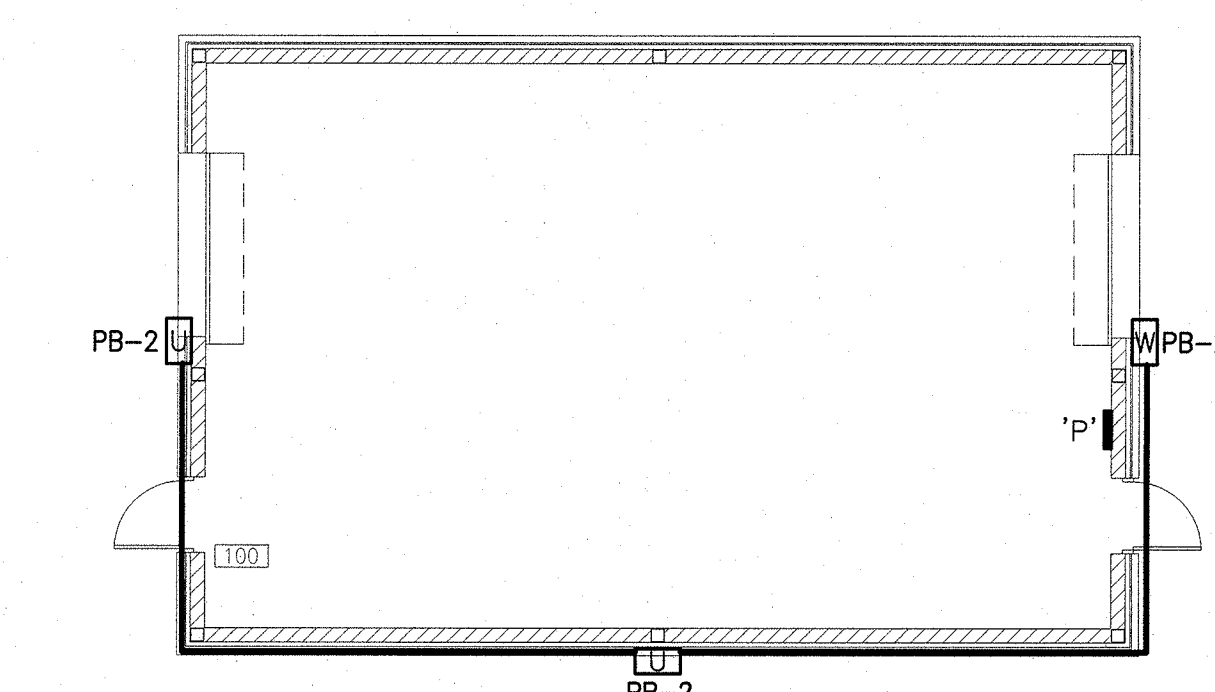

2 TERTIARY GARAGE EXTERIOR LIGHTING LAYOUT
SCALE 1:100

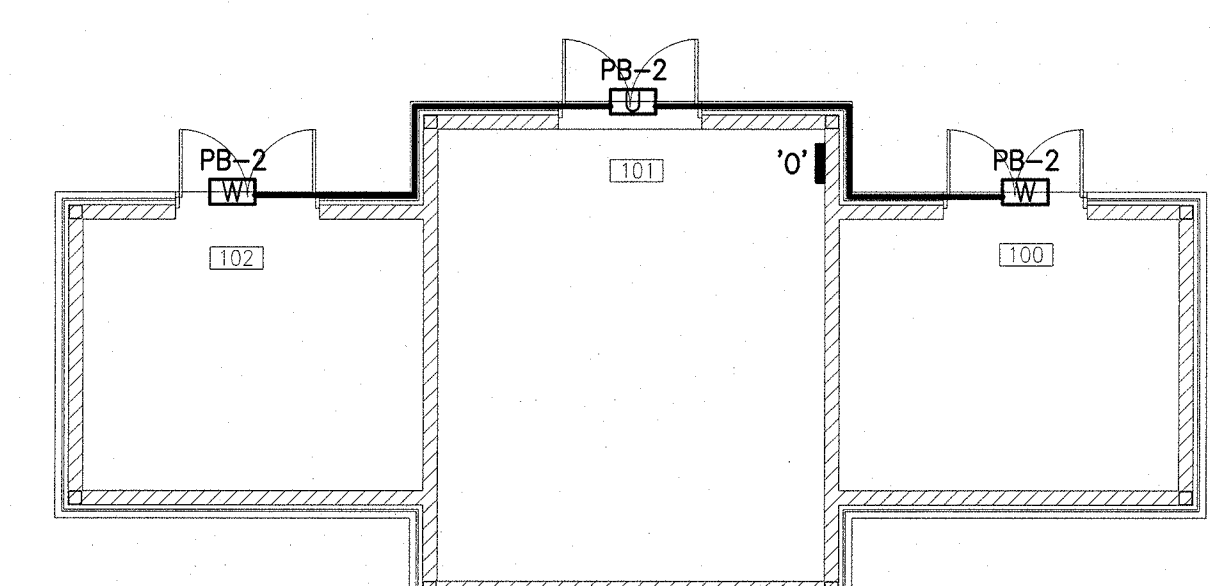

3 SERVICE BUILDING EXTERIOR LIGHTING LAYOUT
SCALE 1:100

NOTES

1. LIGHTING OVERRIDE SWITCH FOR INSPECTION BAY LIGHTING.

2. LIGHTING OVERRIDE SWITCH.

3. ALL LUMINAIRE LOCATIONS ARE EXISTING. EXISTING FIXTURES TO BE REPLACED WITH NEW TYPE AS INDICATED.

4. GENERAL: FOR ALL BUILDING MOUNTED LUMINAIRES: ENSURE FINAL INSTALLATION CONSISTS OF A FIXTURE THAT COVERS ALL EXISTING BACK BOXES & PENETRATIONS OR PROVIDE MEANS TO COVER OR SEAL ANY UNCOVERED BOXES AND/OR PENETRATIONS.

Public Works and
Government Services
Canada

Travaux Publics et
Services gouvernementaux
Canada

electrical consultant

RSEI

Electrical Consulting Engineers
564 Prospect St, Fredericton, NB Canada E3B 9M3 • 506.451.0005

North

Nord

Stamp

Etampe

M7604

2015.03.31

2015.03.31

2015.03.31

0

ISSUED FOR TENDER

2015.03.31

revisions

description

date

project

EXTERIOR LIGHTING REPLACEMENT

PORT OF ST. STEPHEN

drawing

desin

EXTERIOR LIGHTING LAYOUTS – COMMERCIAL BUILDING, TERTIARY GARAGE & SERVICE BUILDING

designed

GLENN MACMULLIN, P.ENG

conçu

date

2015.03.31

drawn

JODI PARKER

dessiné

date

2015.03.31

approved

TRACEY MCDONALD, P.ENG

approuvé

date

2015.03.31

Tender

Submission

PWSSC Project Manager

Administrateur de projets TPSSC

project number

R.073546.001

drawing no.

E3 of/de 4

no. du dessin

1455

E-DRM/GDD-E: 141223