

2 PARTIAL BASEMENT FURNITURE AND EQUIPMENT PLAN
A-04 SCALE: 1:50

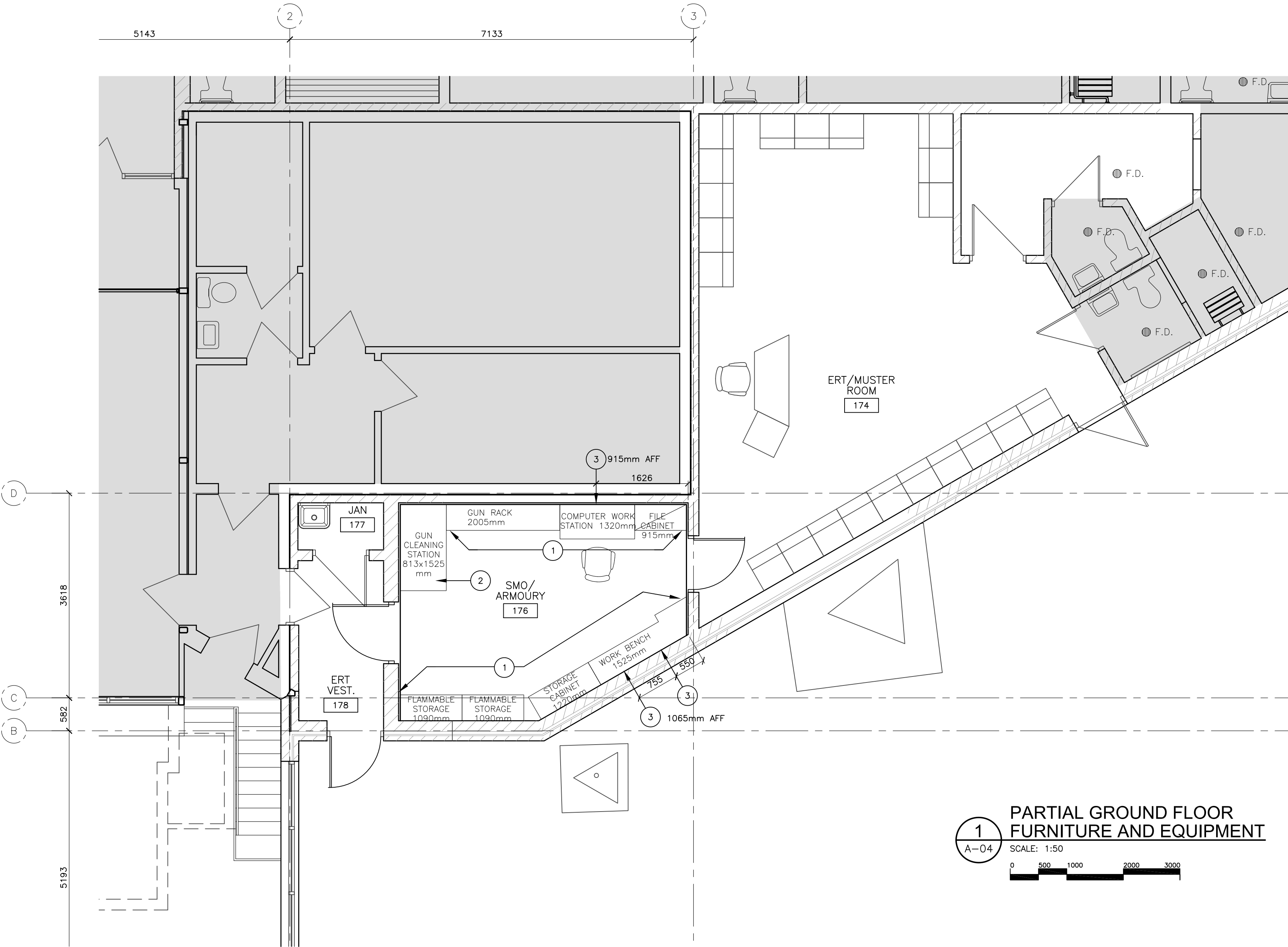

1 PARTIAL GROUND FLOOR FURNITURE AND EQUIPMENT
A-04 SCALE: 1:50

- KEY NOTES
- 1 RELOCATED ARMOURY EQUIPMENT BY CSC (OWNER).
 - 2 NEW FH-1 FUMEHOOD EQUIPMENT BY GC. REFER ALSO TO MECHANICAL AND ELECTRICAL DRAWINGS FOR INFORMATION.
 - 3 LOCATION OF POWER AND COMMUNICATIONS OUTLET. REFER TO ELECTRICAL DRAWINGS FOR SPECIFICATION.
AFF = ABOVE FINISHED FLOOR.

DIALOG®

stamp

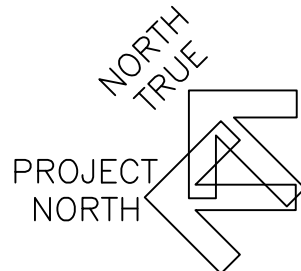

1	BID	2015-08-05
revision	issue	date

Do not scale drawings.
Verify all dimensions and conditions on site and immediately
notify the Departmental Representative of all discrepancies.

- A Detail No.
No. du détail
B drawing no. - where detail required
dessin no. - où détail exigé
C drawing no. - where detailed
dessin no. - où détaillé

project title
titre du projet
CAMPBELLFORD, ONTARIO
WARKWORTH INSTITUTION BLDG WW27
CORRECTIONAL SERVICES CANADA
15847 County Road 29, KOL 1L0
**RETROFIT ARMOURY &
SMO WORK AREA**

drawing title
titre du dessin
**PARTIAL BASEMENT AND
GROUND FLOOR FURNITURE
AND EQUIPMENT PLANS**

drawn by
dessiné par
K MENIER

designed by
conçu par
NA

approved by
approuvé par
R NORTHCOTT

bid
offre
K HAQUE

project manager
administrateur
de projets

project date
date du projet
2015-06-15

project no.
no. du projet
R.069651.001

drawing no.
dessiné no.
A-04