

FISHERIES AND OCEANS



CAPE PINE ACCESS ROAD UPGRADES

CAPE PINE, NL

PROJECT NO.: F6879-154016

ISSUED FOR TENDER

DATE: SEPTEMBER 04, 2015

CLIENT/OWNER:
DEPARTMENT OF FISHERIES & OCEANS,
REAL PROPERTY SAFETY & SECURITY

PRIME CONSULTANTS:
NEWFOUNDLAND DESIGN ASSOCIATES LIMITED

DRAWING LIST:

<u>TITLE</u>	
DWG. # 01K1201A026C0	COVER
DWG. # 01K1201A026C1	GENERAL LOCATION PLAN
DWG. # 01K1201A026C2	PLAN—ACCESS ROAD — STA. 0+000 TO STA. 2+040
DWG. # 01K1201A026C3	PLAN—ACCESS ROAD — STA. 2+040 TO STA. 4+000
DWG. # 01K1201A026C4	PLAN—ACCESS ROAD — STA. 4+000 TO STA. 6+030
DWG. # 01K1201A026C5	PLAN—ACCESS ROAD — STA. 6+030 TO STA. 8+470



GENERAL LOCATION PLAN 0 0.2 0.4 0.6 0.8 1.0km

GENERAL NOTES:

1. EXISTING CULVERTS SCHEDULED TO BE REMOVED SHALL BE LEGALLY DISPOSED OF OFF SITE.
2. CONTRACTOR SHALL CLEAR AND GRUB AREAS OF ROAD REALIGNMENT AS NECESSARY.
3. CONTRACTOR SHALL REPAIR VARIOUS POTHoles LOCATED OUTSIDE AREAS NOTED TO BE SCARIFIED AND GRADED AND OR RECONSTRUCTED AS DIRECTED BY THE ENGINEER.
4. CONTRACTOR SHALL TIE EXISTING DRIVEWAYS, TRAILS, SIDE ROADS INTO NEW ROAD SURFACE.
5. LOCATIONS SCHEDULED FOR REMOVAL OF EXISTING CULVERTS SHALL BE CHANNLED TO CONVEY EXISTING FLOW.

LEGEND:

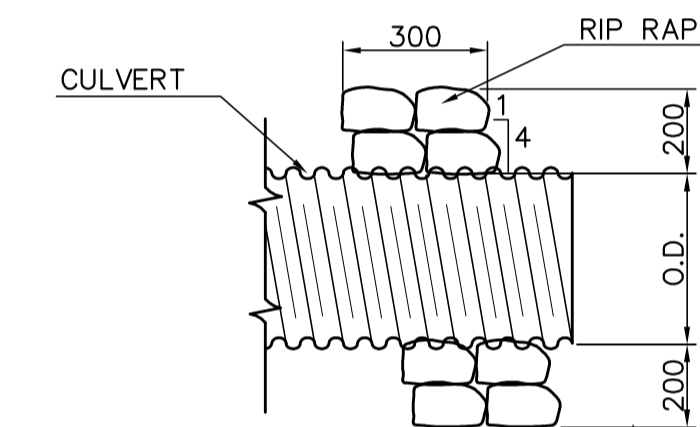
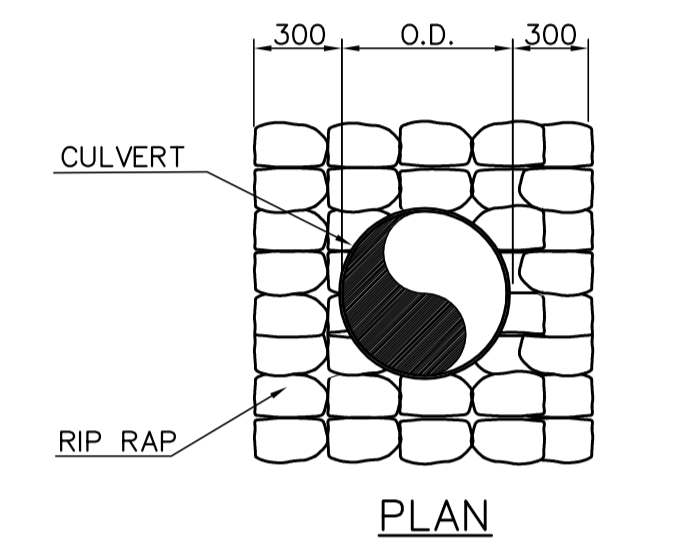
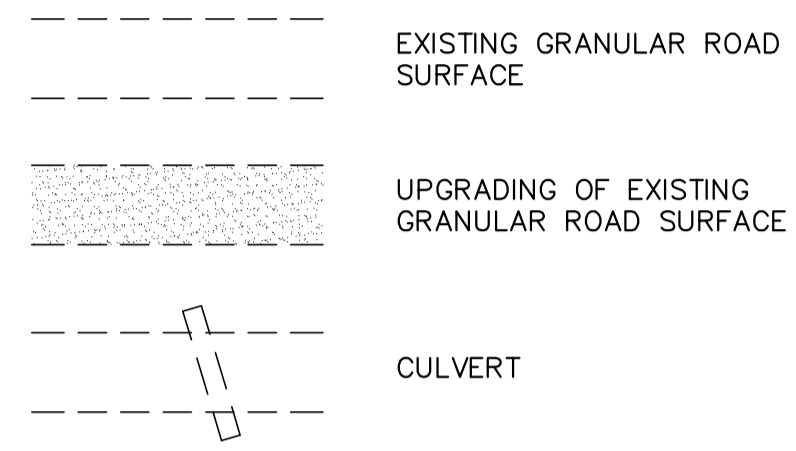

TYPICAL RIP RAP PROTECTION FOR CULVERTS

NOT TO SCALE

Prime Consultant

NEWFOUNDLAND DESIGN ASSOCIATES LIMITED
CONSULTING ENGINEERS

BALLY ROU PLACE
370 TORBAY ROAD
ST. JOHN'S, NL
CANADA A1A 3W8
TELEPHONE: (709) 726-4499
TELEFAX: (709) 726-4499
e-mail: gadmin@ndal.com

PROVINCE OF NEWFOUNDLAND AND LABRADOR

PERMIT HOLDER
This Permit Allows
NEWFOUNDLAND DESIGN ASSOCIATES LIMITED
To practice Professional Engineering in Newfoundland and Labrador.
Permit No. as issued by PEG 00184,
which is valid for the year 2015.

0	ISSUED FOR TENDER	04 SEPT 2015	LM	PP
B	ISSUED FOR 99% REVIEW	01 SEPT 2015	LM	JA
A	ISSUED FOR 66% REVIEW	21 AUG 2015	LM	PP
no.	revision	date	by	approved
	revision	date	par	approve

Project - projet

CAPE PINE ACCESS ROAD UPGRADES

Drawing - dessin

GENERAL LOCATION PLAN

drawn - dessiné	L. J. MEANEY	designed - dessiné par	P. T. PORTER
date - date	AUGUST 2015	checked - vérifié	P. T. PORTER
scale - échelle	AS SHOWN	approved - approuvé	
project no. - projet no.	F8879-154016	drawing no. - no du dessin	01K1201A026C1
		sheet - feuille	1/5

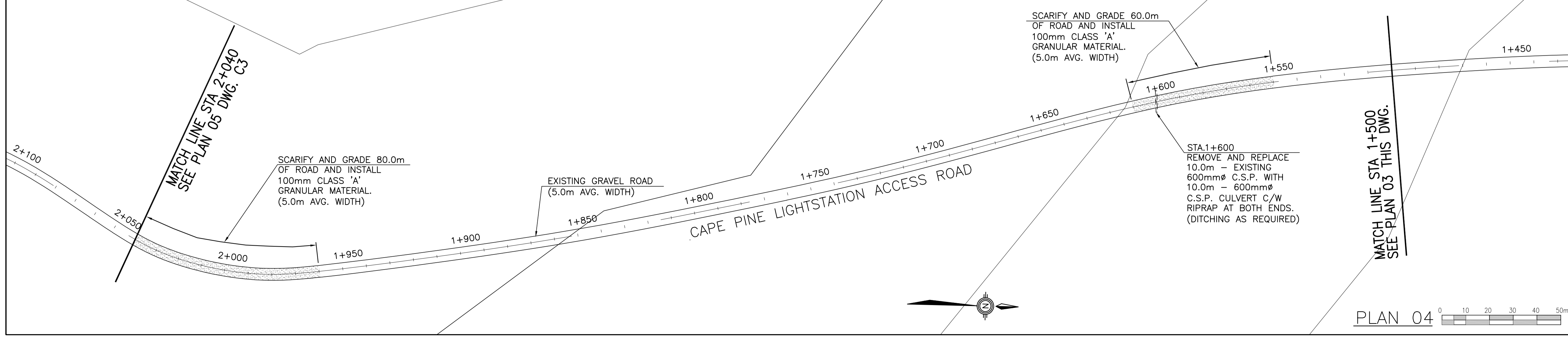
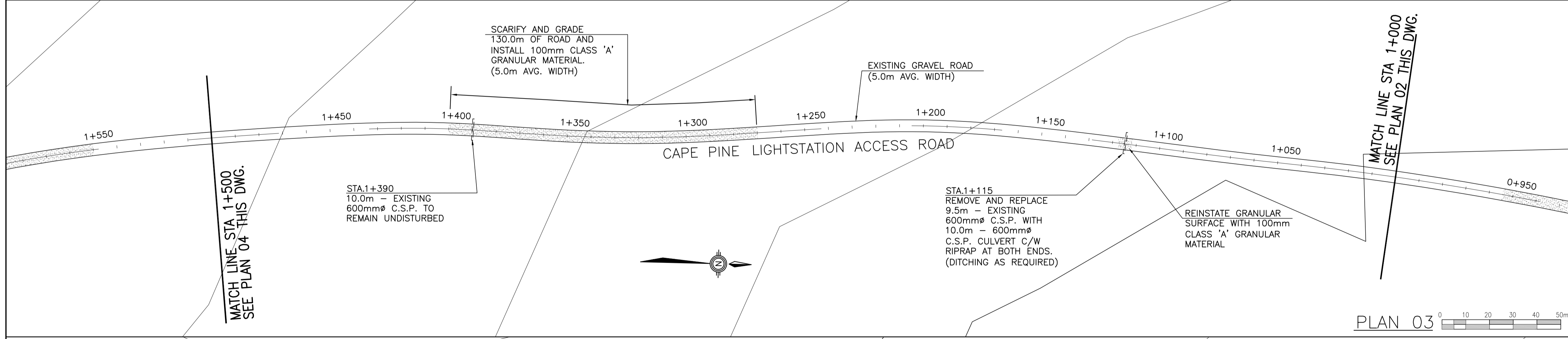
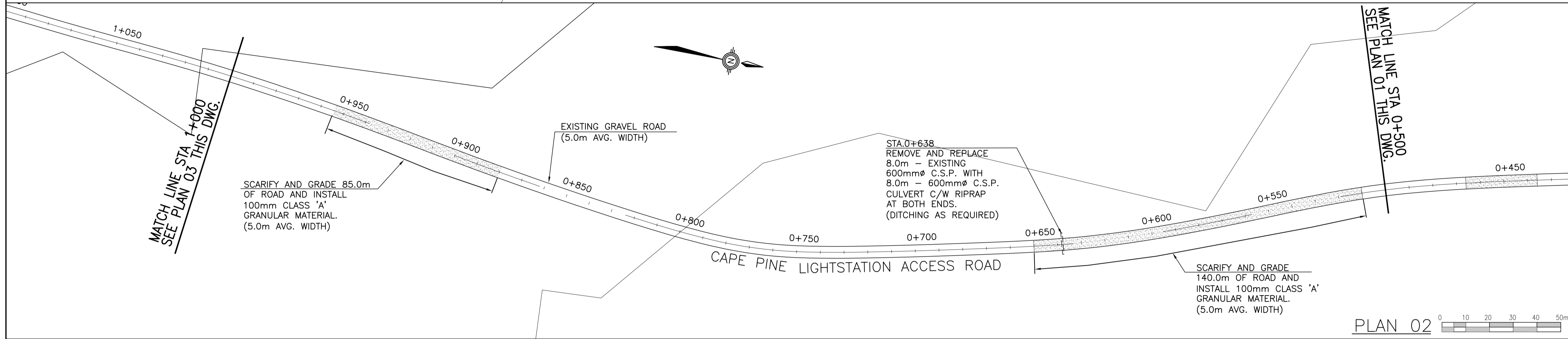
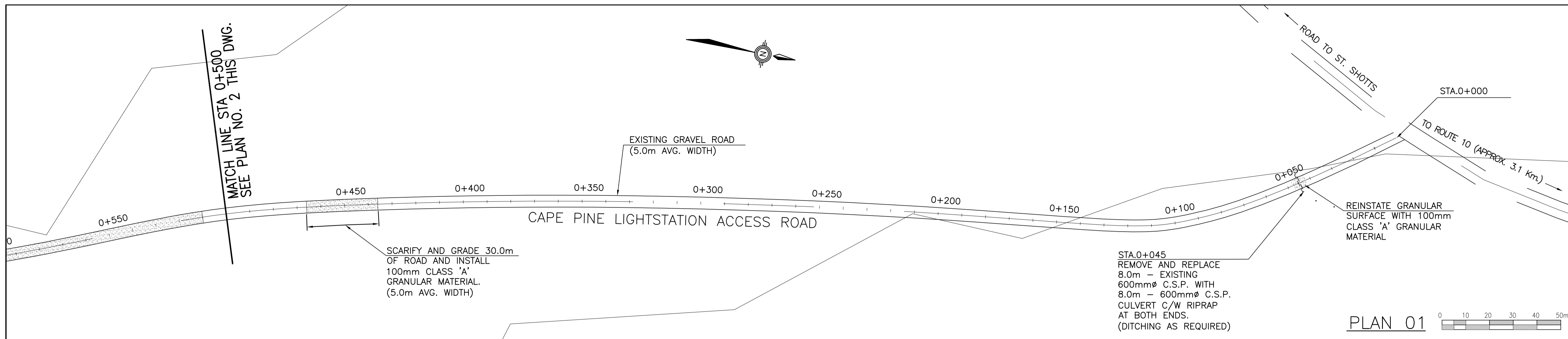

Prime Consultant

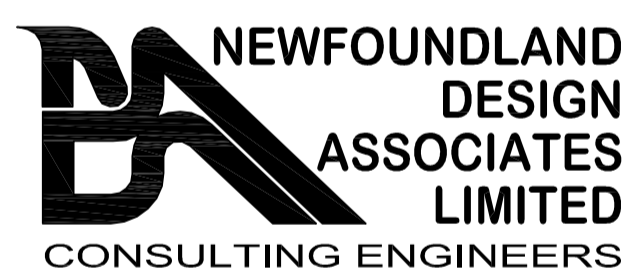

NEWFOUNDLAND DESIGN ASSOCIATES LIMITED
CONSULTING ENGINEERS

BALLY ROU PLACE
370 TORBAY ROAD
ST. JOHN'S, NL
CANADA A1A 3W8
TELEPHONE: (709) 726-4490
TELEFAX: (709) 726-4499
e-mail: admin@ndal.com

PROVINCE OF NEWFOUNDLAND AND LABRADOR

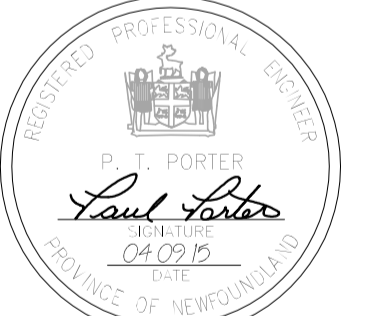

PERMIT HOLDER
This Permit Allows
NEWFOUNDLAND DESIGN ASSOCIATES LIMITED
To practice Professional Engineering
in Newfoundland and Labrador
Permit No. as issued by PEG 2018L,
which is valid for the year 2018.

O	ISSUED FOR TENDER	04 SEPT 2015	LM	PP
B	ISSUED FOR 99% REVIEW	01 SEPT 2015	LM	JA
A	ISSUED FOR 66% REVIEW	21 AUG 2015	LM	PP
no.	revision	date	by	approved
	revision	date	par	approve

Project - projet

**CAPE PINE
ACCESS ROAD UPGRADES**

Drawing - dessin

**PLAN - ACCESS ROAD
STA. 0+000 TO STA. 2+040**

drawn - dessiné	L. J. MEANEY	designed - dessiné par	P. T. PORTER
date - date	AUGUST 2015	checked - vérifié	P. T. PORTER
scale - échelle	AS SHOWN	approved - approuvé	
project no. - projet no.	F8879-154016	drawing no. - no du dessin	01K1201A026C2
		sheet - feuille	2/5

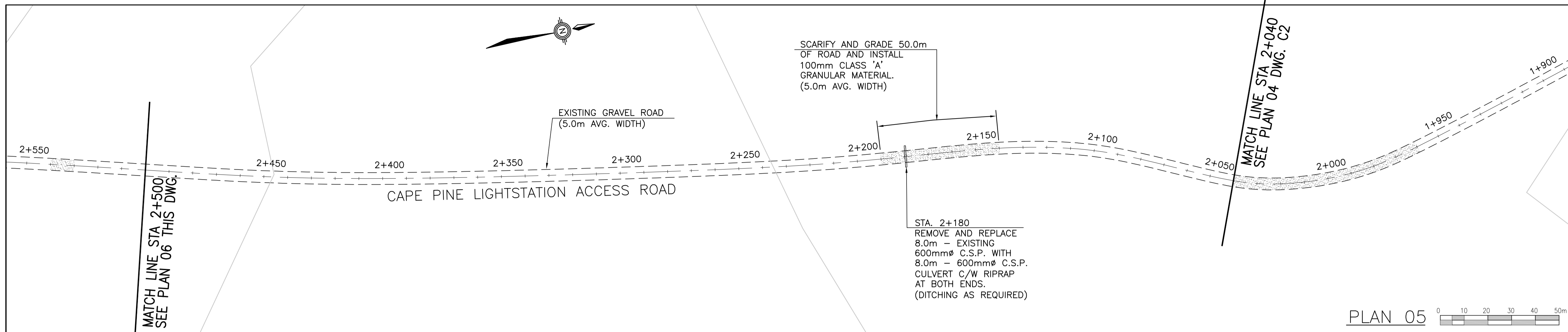

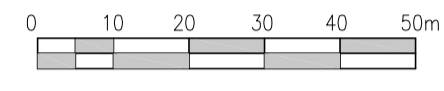
PLAN 05 

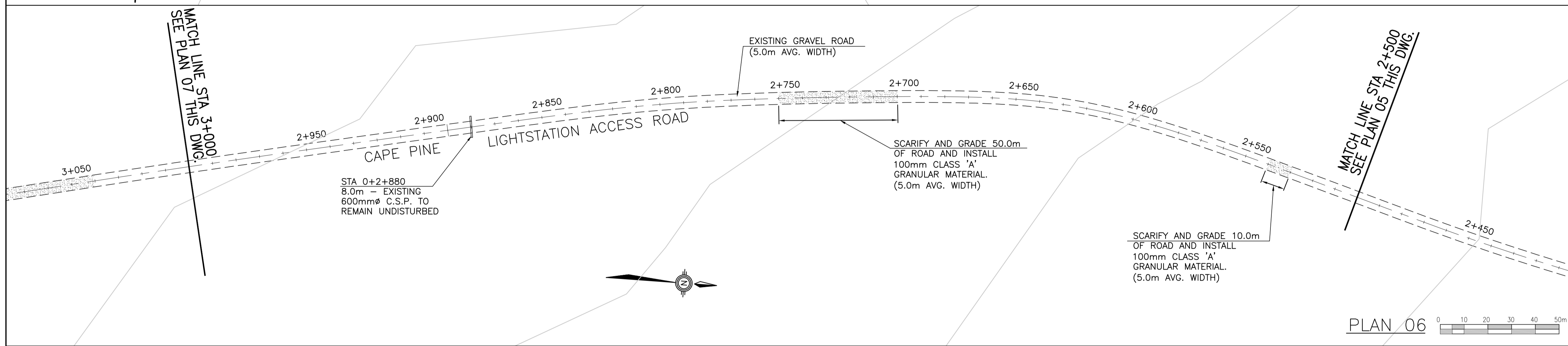

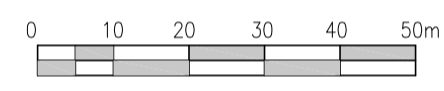
PLAN 06 

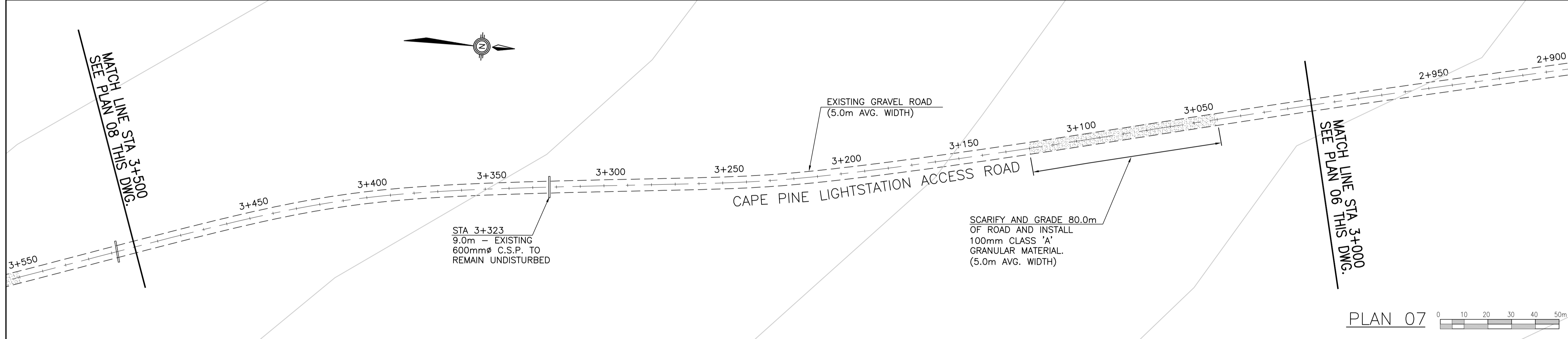

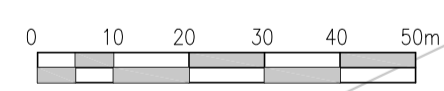
PLAN 07 

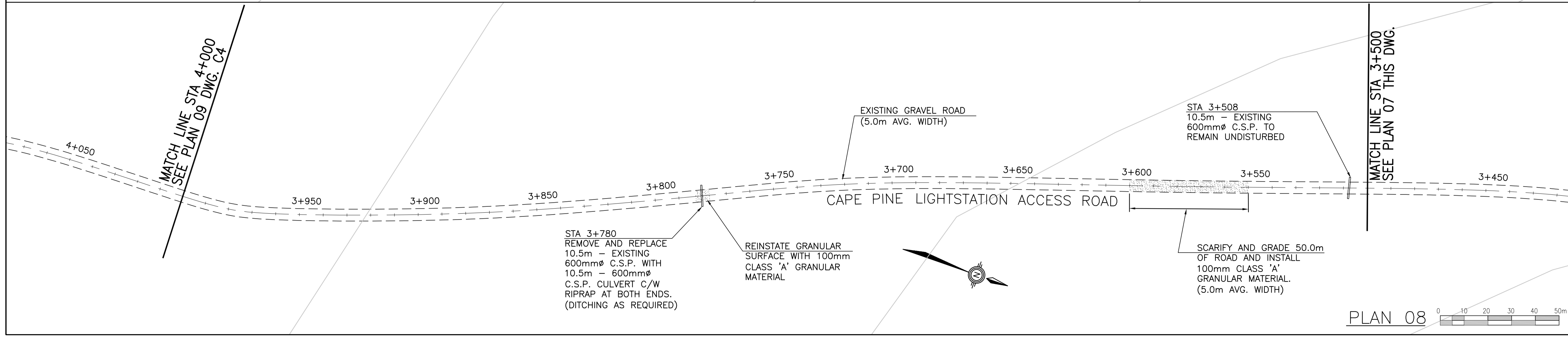

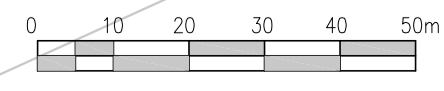
PLAN 08 

Prime Consultant

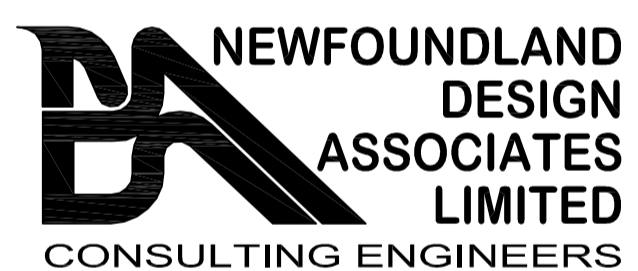

NEWFOUNDLAND DESIGN ASSOCIATES LIMITED
CONSULTING ENGINEERS

BALLY ROU PLACE
370 TORBAY ROAD
ST. JOHN'S, NL
CANADA A1A 3W8
TELEPHONE: (709) 726-4490
TELEFAX: (709) 726-4499
e-mail: admin@ndal.com

PROVINCE OF NEWFOUNDLAND AND LABRADOR

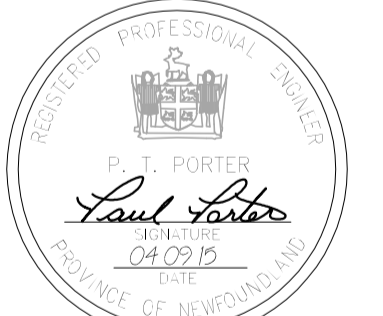

PERMIT HOLDER
This Permit Allows
NEWFOUNDLAND DESIGN ASSOCIATES LIMITED
To practice Professional Engineering
in Newfoundland and Labrador
Permit No. as issued by PEG 2018,
which is valid for the year 2018.

0	ISSUED FOR TENDER	04 SEPT 2015	LM	PP
B	ISSUED FOR 99% REVIEW	01 SEPT 2015	LM	JA
A	ISSUED FOR 66% REVIEW	21 AUG 2015	LM	PP
no.	revision	date	by	approved
	revision	date	par	approve

Project - projet

CAPE PINE ACCESS ROAD UPGRADES

Drawing - dessin

PLAN - ACCESS ROAD STA. 2+040 TO STA. 4+000

drawn - dessiné: L. J. MEANEY | designed - dessiné par: P. T. PORTER
 date - date: AUGUST 2015 | checked - vérifié: P. T. PORTER
 scale - échelle: AS SHOWN | approved - approuvé

project no. - projet no.: F8879-154016 | drawing no. - no du dessin: 01K1201A026C3 | sheet - feuille: 3/5

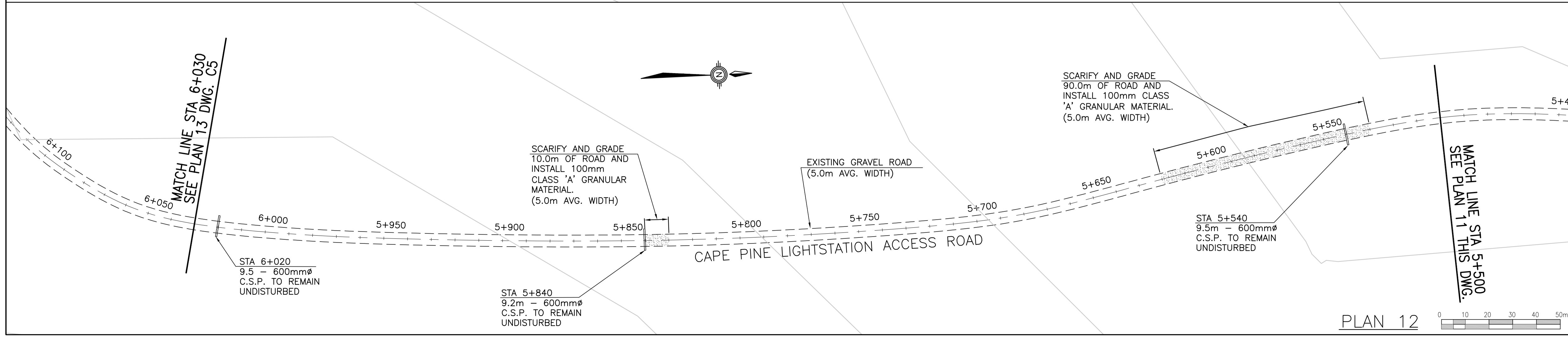
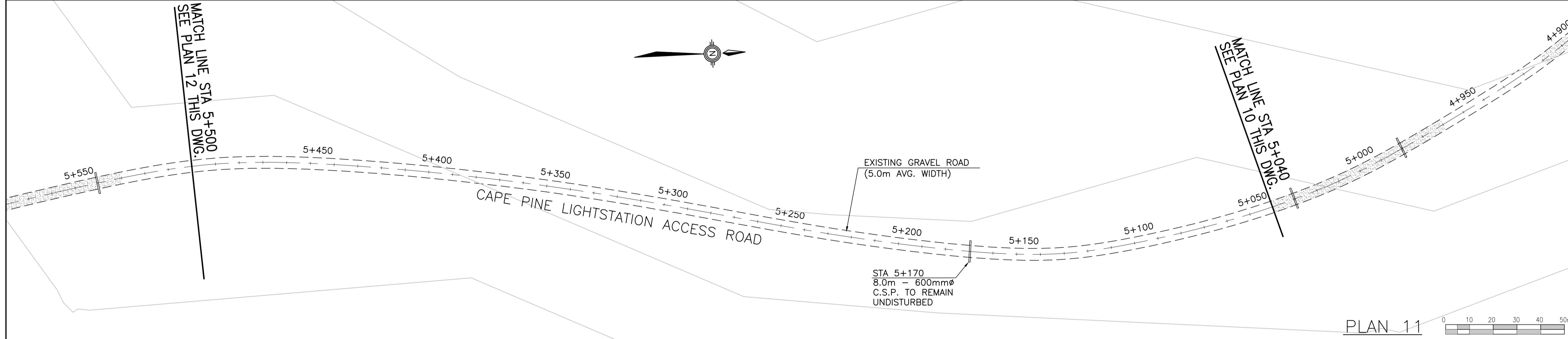
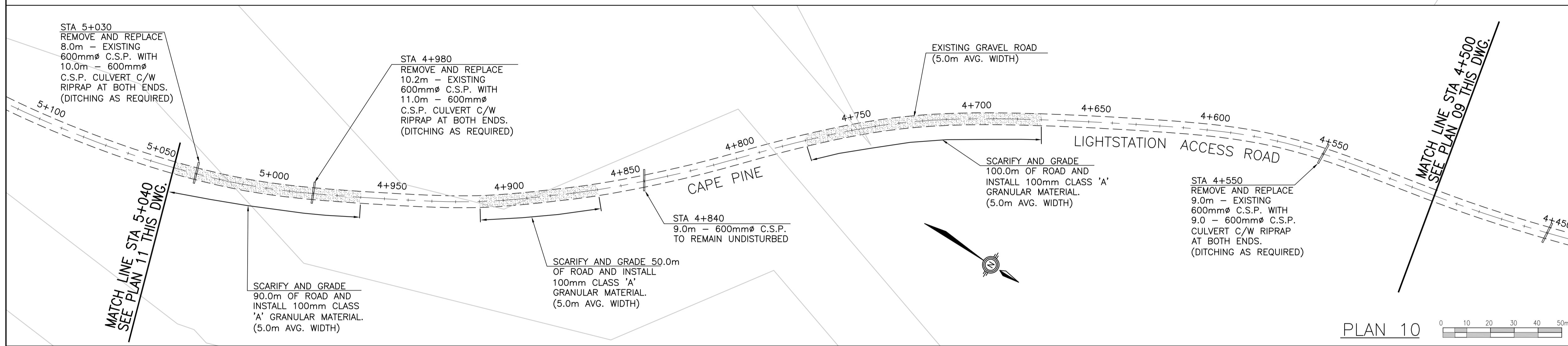
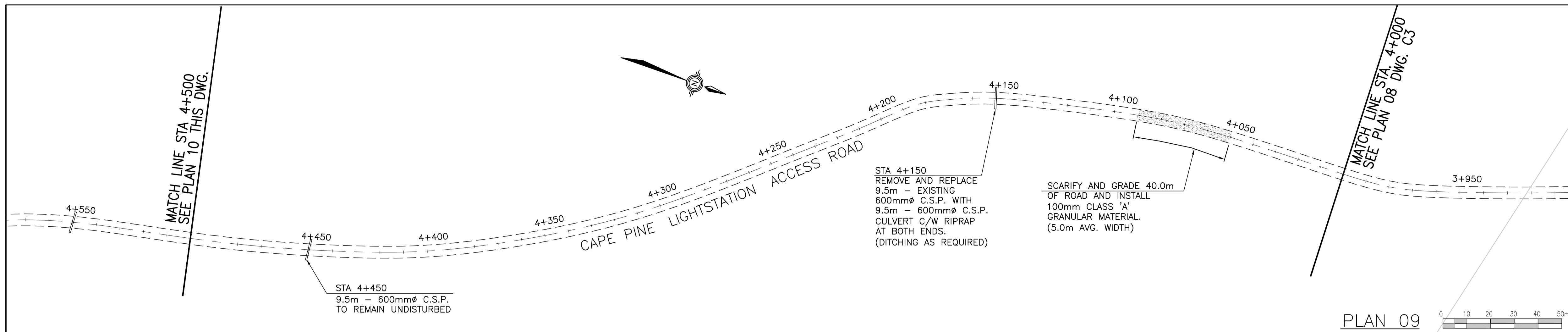

Prime Consultant

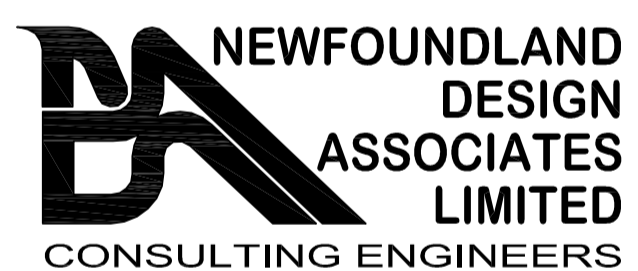

NEWFOUNDLAND DESIGN ASSOCIATES LIMITED
CONSULTING ENGINEERS

BALLY ROU PLACE
370 TORBAY ROAD
ST. JOHN'S, NL
CANADA A1A 3W8
TELEPHONE: (709) 726-4490
TELEFAX: (709) 726-4499
e-mail: admin@nfdal.com

PROVINCE OF NEWFOUNDLAND AND LABRADOR



PERMIT HOLDER
This Permit Allows
NEWFOUNDLAND DESIGN ASSOCIATES LIMITED
To practice Professional Engineering
in Newfoundland and Labrador
Permit No. as issued by PEG 2018,
which is valid for the year 2018.

O	ISSUED FOR TENDER	04 SEPT 2015	LM	PP
B	ISSUED FOR 99% REVIEW	01 SEPT 2015	LM	JA
A	ISSUED FOR 66% REVIEW	21 AUG 2015	LM	PP
no.	revision	date	by	approved
no.	revision	date	par	approve

Project - projet

CAPE PINE ACCESS ROAD UPGRADES

Drawing - dessin

PLAN - ACCESS ROAD
STA. 4+000 TO STA. 6+030

drawn - dessiné: L. J. MEANEY
designed - dessiné par: P. T. PORTER

date - date: AUGUST 2015
checked - vérifié: P. T. PORTER

scale - échelle: AS SHOWN
approved - approuvé

project no. - projet no.: F6879-154016
drawing no. - no du dessin: 01K1201A026C4
sheet - feuille: 4/5

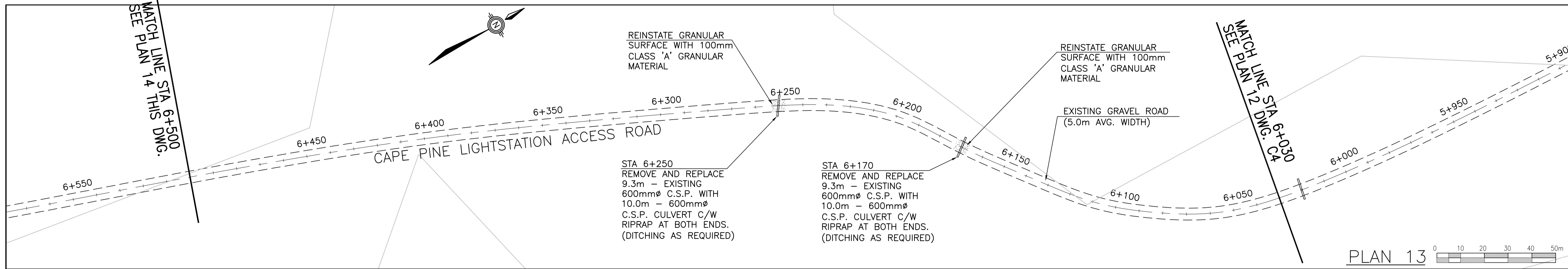

PLAN 13 0 10 20 30 40 50m

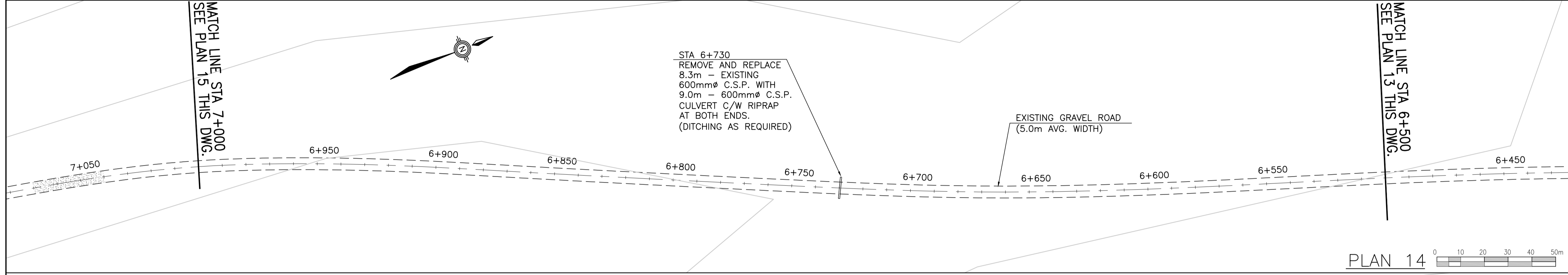

PLAN 14 0 10 20 30 40 50m

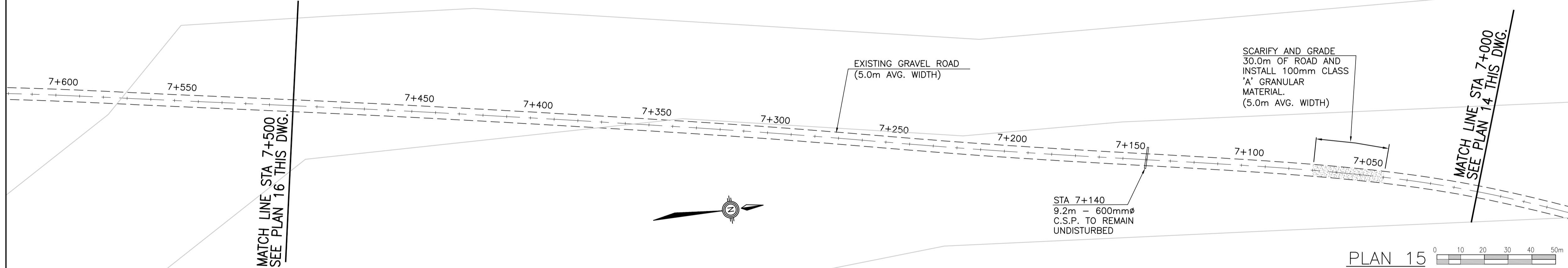

PLAN 15 0 10 20 30 40 50m

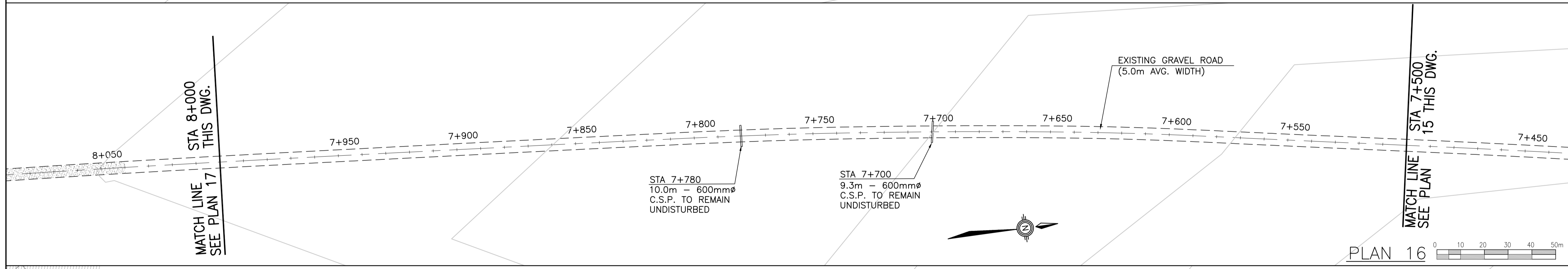

PLAN 16 0 10 20 30 40 50m

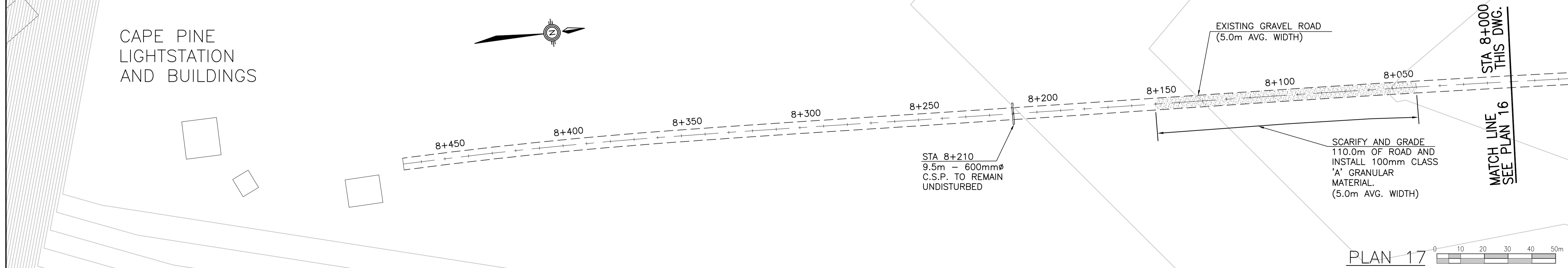

PLAN 17 0 10 20 30 40 50m

Prime Consultant

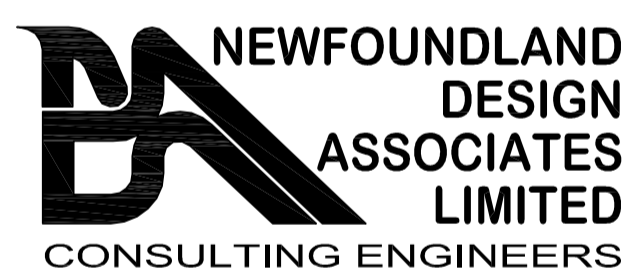

NEWFOUNDLAND DESIGN ASSOCIATES LIMITED
 CONSULTING ENGINEERS
 BALLY ROU PLACE
 370 TORBAY ROAD
 ST. JOHN'S, NL
 CANADA A1A 3W8
 TELEPHONE: (709) 726-4490
 TELEFAX: (709) 726-4499
 e-mail: gadmin@ndal.com

PROVINCE OF NEWFOUNDLAND AND LABRADOR



PERMIT HOLDER
 This Permit Allows
 NEWFOUNDLAND DESIGN ASSOCIATES LIMITED
 To practice Professional Engineering in Newfoundland and Labrador.
 Permit No. as issued by PEG 20184, which is valid for the year 2018.

O	ISSUED FOR TENDER	04 SEPT 2015	LM	PP
B	ISSUED FOR 99% REVIEW	01 SEPT 2015	LM	JA
A	ISSUED FOR 66% REVIEW	21 AUG 2015	LM	PP
no.	revision	date	by	approved
	revision	date	par	approve

Project - projet

CAPE PINE ACCESS ROAD UPGRADES

Drawing - dessin

PLAN - ACCESS ROAD STA. 6+030 TO STA. 8+470

drawn - dessiné	L. J. MEANEY	designed - dessiné par	P. T. PORTER
date - date	AUGUST 2015	checked - vérifié	P. T. PORTER
scale - échelle	AS SHOWN	approved - approuvé	
project no. - projet no.	F6879-154016	drawing no. - no du dessin	01K1201A026C5
		sheet - feuille	5/5