

CANADIAN COAST GUARD BASE

SEPTIC SYSTEM

Stephenville, NL

CLIENT:

DEPARTMENT OF FISHERIES AND OCEANS



DRAWING LIST

C1 - SITE SERVICING PLAN
D1 - CONSTRUCTION PROFILES AND DETAILS

Project No. 15021

AUGUST 2015

- NOTES
- CONTRACTOR RESPONSIBLE FOR LOCATING EXISTING UNDERGROUND INFRASTRUCTURE (IE. TELEPHONE, CABLE, POWER LINES, ETC.) BEFORE PROCEEDING WITH THIS WORK.
 - INSTALLATION OF SECONDARY SEWAGE TREATMENT PLANT IN ACCORDANCE WITH MANUFACTURERS SPECIFICATIONS. PROTECT PLANT AGAINST FLOTATION.
 - SECONDARY SEWAGE TREATMENT PLANT TO ADHERE TO GOVERNMENT OF NEWFOUNDLAND AND LABRADOR DEPARTMENT OF ENVIRONMENT AND CONSERVATION WATER RESOURCES MANAGEMENT DIVISION GUIDELINES OF THE DESIGN, CONSTRUCTION, AND OPERATION OF WATER AND SEWERAGE SYSTEMS. CONTRACTOR TO PROVIDE SHOP DRAWINGS AND ADVISE OWNERS REPRESENTATIVE OF ANY CHANGE OF INVERT ELEVATIONS OF INLET AND OUTLET.

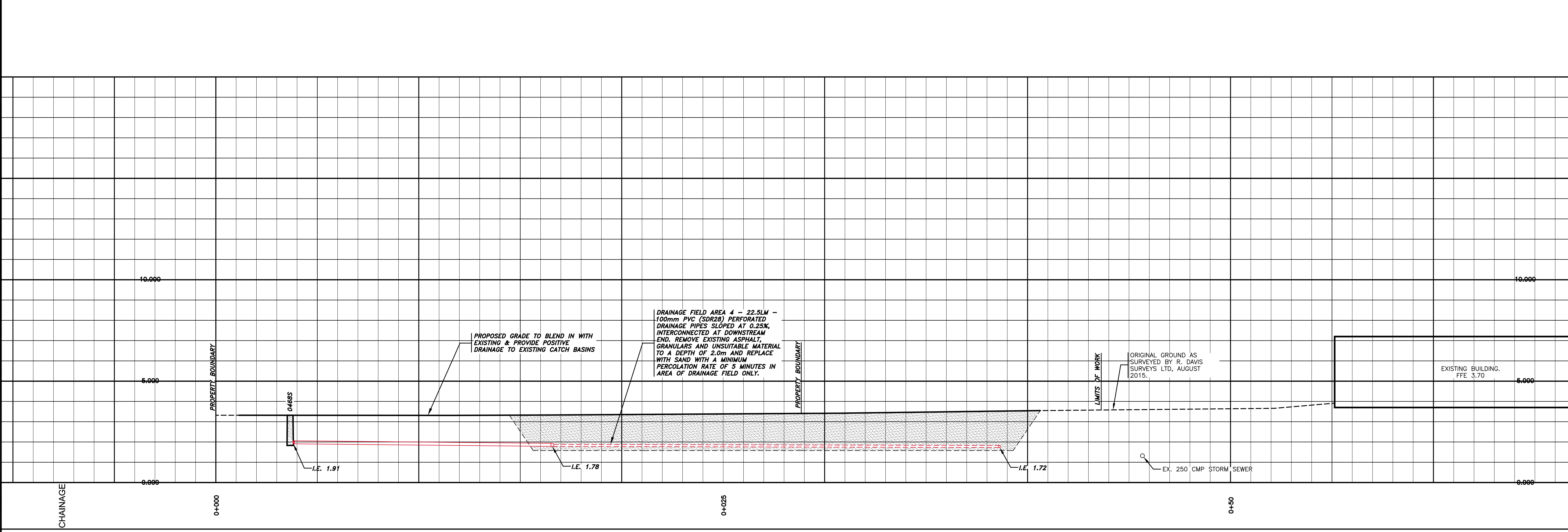

SITE PROFILE
SCALE: 1 : 100

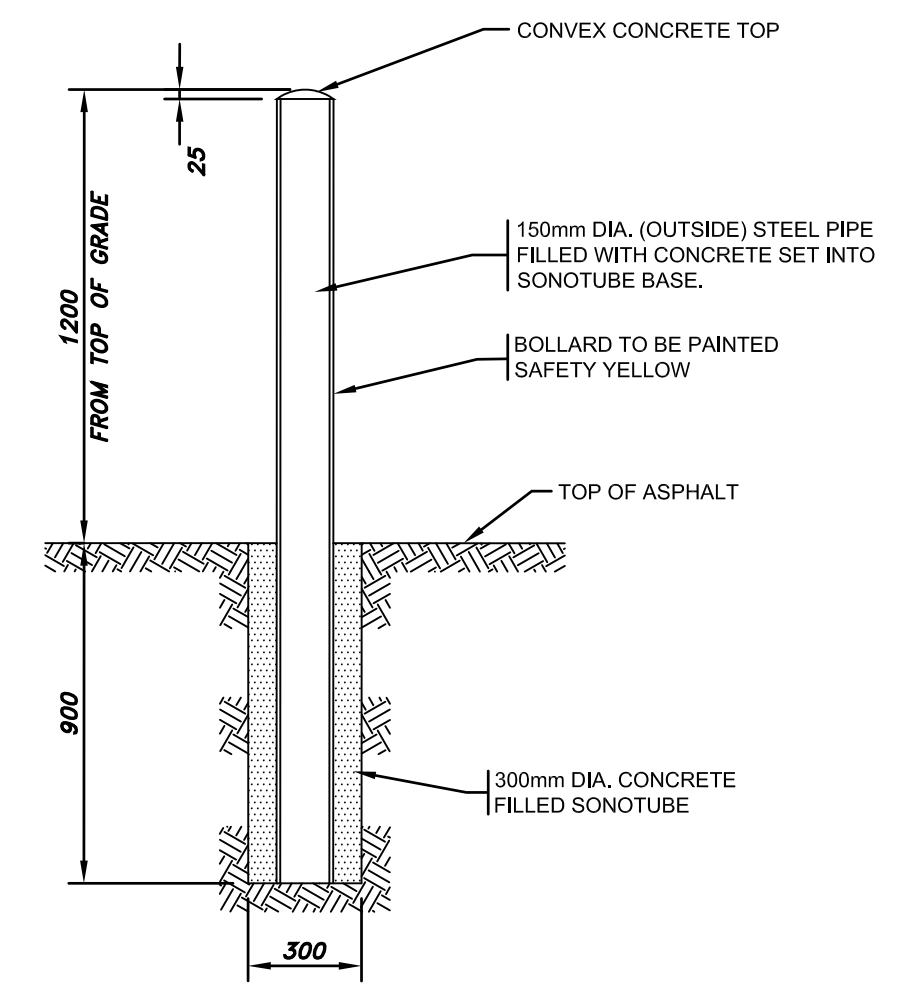

PROTECTION BOLLARD
SCALE: 1 : 20

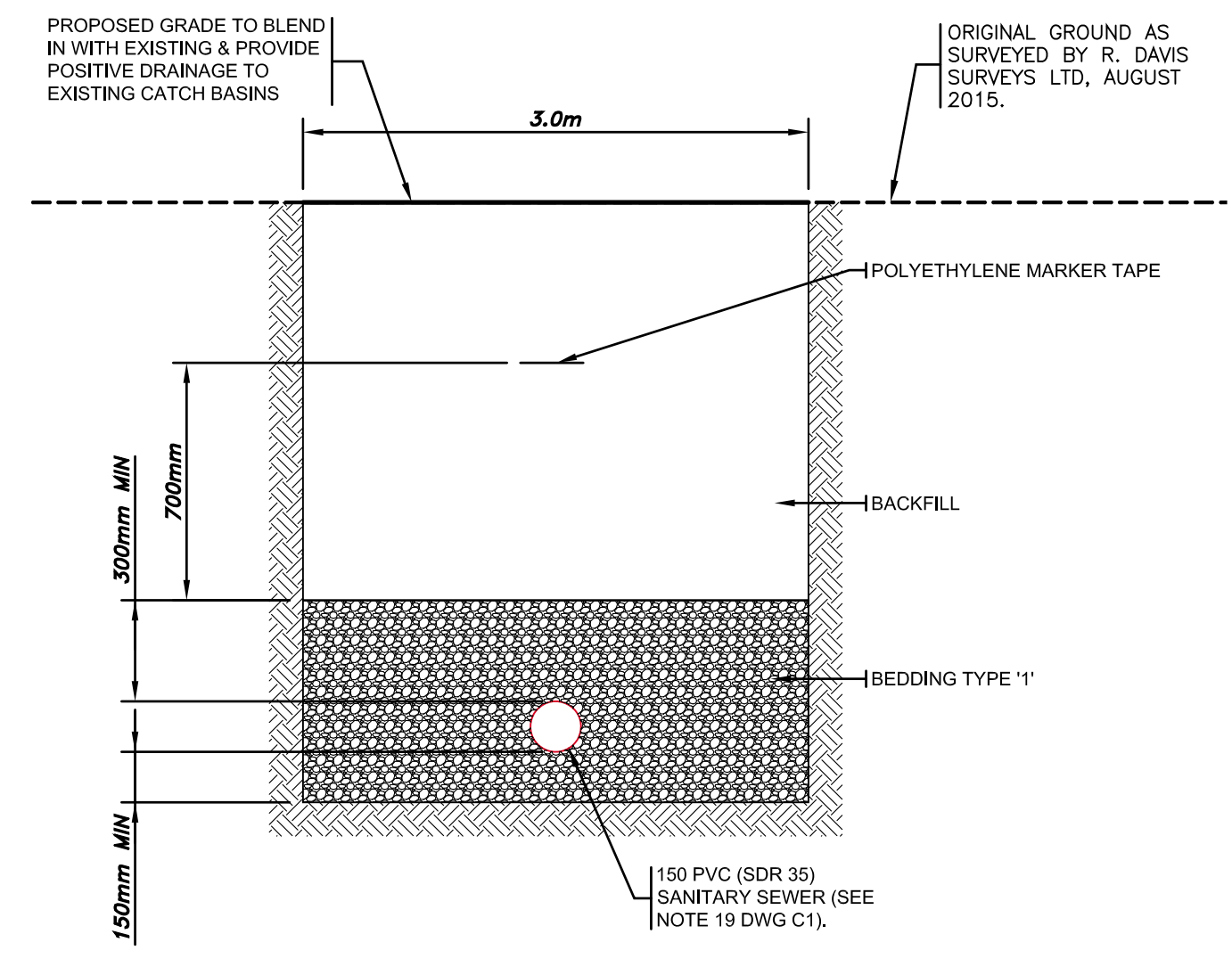

EXCAVATION CROSS-SECTION
SCALE: N.T.S.

3	ISSUED FOR ADDENDUM No. 1	10/30/15
2	ISSUED FOR TENDER	09/24/15
1	ISSUED FOR 99% REVIEW	09/21/15
0	ISSUED FOR 66% REVIEW	09/09/15
NO.	REVISIONS	DATE

PROFESSIONAL STAMP

PROFESSIONAL ENGINEER
PEG
MEMBER NO. 10331
SIGNATURE
M. A. MARTIN
DATE
30 OCT 2015
PROVINCE OF NEWFOUNDLAND

PROVINCE OF NEWFOUNDLAND
PERMIT HOLDER
Class "A"
This Permit Allows
PINNACLE ENGINEERING LIMITED
To practice Professional Engineering in Newfoundland and Labrador.
Permit No. as issued by PEGNL L0331 which is valid for the year 2015.

CLIENT
DEPARTMENT OF FISHERIES AND OCEANS

PROJECT TITLE
CCG BASE STEPHENVILLE SEPTIC SYSTEM

SHEET TITLE
CONSTRUCTION PROFILES AND DETAILS

PROJECT NO.
15021

DRAWN BY
BERP

CHECKED BY
KHH

DATE
AUGUST 2015

DRAWING NO.
D1

SCALE
AS NOTED

