



## RETURN BIDS TO:

## RETOURNER LES SOUMISSIONS À:

Bid Receiving - PWGSC / Réception des soumissions  
- TPSGC

11 Laurier St./11, rue Laurier

Place du Portage, Phase III

Core 0B2 / Noyau 0B2

Gatineau, Québec K1A 0S5

Bid Fax: (819) 997-9776

## Revision to a Request for a Standing Offer

## Révision à une demande d'offre à commandes

Regional Individual Standing Offer (RISO)

Offre à commandes individuelle régionale (OCIR)

The referenced document is hereby revised; unless otherwise indicated, all other terms and conditions of the Offer remain the same.

Ce document est par la présente révisé; sauf indication contraire, les modalités de l'offre demeurent les mêmes.

## Comments - Commentaires

## Vendor/Firm Name and Address

Raison sociale et adresse du  
fournisseur/de l'entrepreneur

## Issuing Office - Bureau de distribution

Furniture Division/Division des produits de  
l'ameublement

11 Laurier St. / 11, rue Laurier

6B1, Place du Portage

Gatineau

Québec

K1A 0S5

<b>Title - Sujet</b> Office Furniture-Meubles - Carling		
<b>Solicitation No. - N° de l'invitation</b> EP837-161021/A		<b>Date</b> 2015-11-06
<b>Client Reference No. - N° de référence du client</b> 20161021		<b>Amendment No. - N° modif.</b> 001
<b>File No. - N° de dossier</b> pq956.EP837-161021	<b>CCC No./N° CCC - FMS No./N° VME</b>	
<b>GETS Reference No. - N° de référence de SEAG</b> PW-\$\$PQ-956-68135		
<b>Date of Original Request for Standing Offer</b> Date de la demande de l'offre à commandes originale		2015-10-08
<b>Solicitation Closes - L'invitation prend fin</b> <b>at - à 02:00 PM</b> <b>on - le 2015-11-20</b>		<b>Time Zone</b> <b>Fuseau horaire</b> Eastern Standard Time EST
<b>Address Enquiries to: - Adresser toutes questions à:</b> Goyette, J-F		<b>Buyer Id - Id de l'acheteur</b> pq956
<b>Telephone No. - N° de téléphone</b> (613) 219-0728 ( )		<b>FAX No. - N° de FAX</b> (819) 956-5706
<b>Delivery Required - Livraison exigée</b>		
<b>Destination - of Goods, Services, and Construction:</b> <b>Destination - des biens, services et construction:</b> Carling Campus 3500 Carling Avenue Ottawa, On K2H 8E9		
<b>Security - Sécurité</b> This revision does not change the security requirements of the Offer. Cette révision ne change pas les besoins en matière de sécurité de la présente offre.		

Instructions: See Herein

Instructions: Voir aux présentes

<b>Acknowledgement copy required</b> <b>Accusé de réception requis</b>	<b>Yes - Oui</b> <input type="checkbox"/>	<b>No - Non</b> <input type="checkbox"/>
<b>The Offeror hereby acknowledges this revision to its Offer.</b> <b>Le proposant constate, par la présente, cette révision à son offre.</b>		
<b>Signature</b>	<b>Date</b>	
Name and title of person authorized to sign on behalf of offeror. (type or print) Nom et titre de la personne autorisée à signer au nom du proposant. (taper ou écrire en caractères d'imprimerie)		
<b>For the Minister - Pour le Ministre</b>		

## Tender Questions #1

Solicitation No. EP837-161021/A

Carling Campus – Department of National Defense

Workstation RISO

- Q1. Annex A-1 7.3.2. of the of the RFSO allows for the use of a monolithic frame when required to meet specifications of the 39" – 46" panel height. Given this is acceptable for the 39"- 46" panel height then section 7.4 must also allow for a 39" – 46" monolithic frame option and therefore a minimum of one (1) add-on to meet the requirements of the 50"-54" panel.

For section 7.5 the same issues apply. A monolithic base frame option of 39" – 46" would be used with a minimum two (2) add-ons to obtain the 60"- 66 panel height.

Proprietary: This change would be necessary for our company to meet the panel height requirements as well as the Power and Communications requirements as stated in section 8.1.1 of Annex A-1 and specifically 8.1.1.1 (raceway 1....above the work surface)

- A1. **Annex A-1 7.3.2 allows for the use of "monolithic frames, only if required to reach specified range of height" as detailed in 7.3 "Frame heights of 991mm – 1168mm (39" – 46")". This specified height is only for the use of transaction top areas.**

**Delete 7.4 in its entirety and replace with the following:**

**Frame heights of 1270mm – 1372mm (50" – 54") must be comprised of a monolithic base frame as per 7.2.1 and minimum one (1) add-on module.**

**Delete 7.5 in its entirety and replace with the following:**

**Frame heights of 1524mm – 1676mm (60"-66") must be comprised of a monolithic base frame as per 7.2.1 and minimum two (2) add-on modules.**

- Q2. Annex A-1 section 8.2.2.3 requires the use of three (3) duplex receptacles. Can we provide three (3) triplex receptacles, which meets and exceeds the requirements?
- A2. **No, the Government of Canada Workplace 2.0 Fit-Up Standards specifies three (3) duplex receptacles, the use of three (3) triplex receptacles is above the standards and thus considered non-compliant.**
- Q3. Annex A-3 indicates 2 outlets on the 24" wide panels. Our 24" wide panels can accommodate one outlet. We could relocate one of these outlets to the adjoining 24" wide panel and still meet functional requirements. (see sketch) Please confirm this is acceptable.

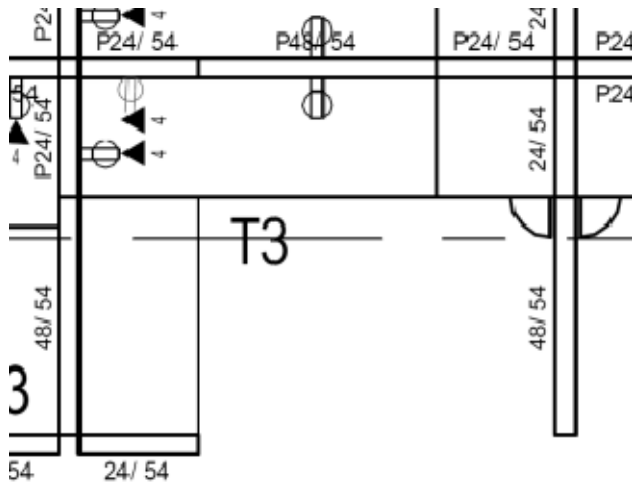

A3. **Location of the one (1) duplex receptacle on each of the 24" wide panels will be accepted as long as all other requirements are met.**

Q4. Annex A 10.1 requests that free-standing HA work surfaces must have crank, torsion or counter-balance height adjustment mechanism.

These options are often times the same price as an electric adjustable unit and are less functional due to adjustment requirements and weight restrictions.

Please confirm that an electric adjustable option would be acceptable.

A4. **The Department of National Defence has identified their requirements as stated in Annex A-1, 10.1. As a result, the building system has not been designed to accommodate this requirement and additional studies would need to be undertaken by electrical engineers to determine if the building electrical system load would need to be upgraded. This process would disrupt the tendering process and risk not meeting the overall project schedule. Annex A-1, 10.1 as stated is this projects requirement.**

Q5. Manufacturers build their panel systems based on a specific 'module', typically between 11" and 15". This module varies from manufacturer to manufacturer and all manufacturing is based on this module. The requirement in Section 7.4 and 7.5 make it virtually impossible for manufacturers with a 15" module to meet the spec using standard product. The specification noted in Section 7.4 and 7.5 states the base panel should be start with a monolithic frame as noted in Section 7.1 which is between 30 and 36" high and have a minimum of 2 stack on units (Section 7.4) and 3 stack on units (Section 7.5) respectively. Mathematically, it is impossible for any vendor with a module greater than 12" to meet the spec as show below. The aesthetic of 3 tiles for Section 7.4 and 4 tiles for Section 7.5 can easily be achieved if required with a Segmented panel which would achieve the aesthetic and save money for the crown.

30" base + 13" stack-on + 13"stack-on = 56" total height  
 30" base + 13" stack-on + 13" stack-on + 13" stack-on = 69" total height (DOES NOT MEET)

We respectfully request that you modify your requirement in Section 7.4 to a minimum of 1 stack-on to achieve 50-54" total height and a minimum of 2 stack-on units to achieve a total

height of 60-66" total height OR allow the use of segmented panels to achieve the desired requirements.

A5. **Refer to Q&A #1 for amendments to 7.4 and 7.5.**