

LOCATION PLAN - NAUFRAGE

SCALE : 1:500  
0m 5m 10m 20m 30m 40m 50m

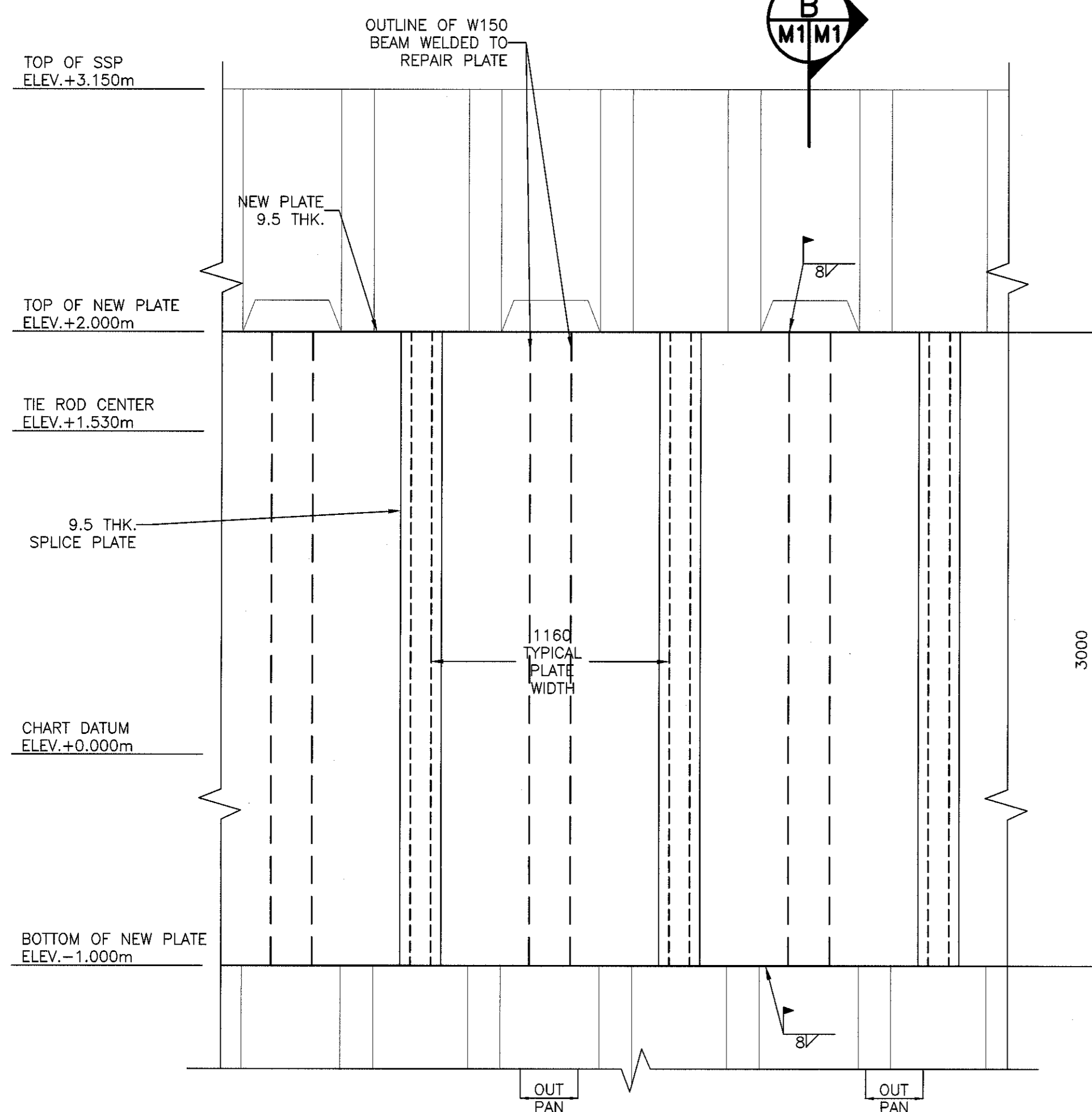
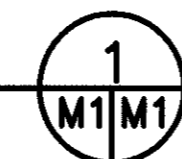

ELEVATION - REPAIR PLATE

SCALE : 1:20  
0mm 500mm 1000mm 1500mm 2000mm 2500mm

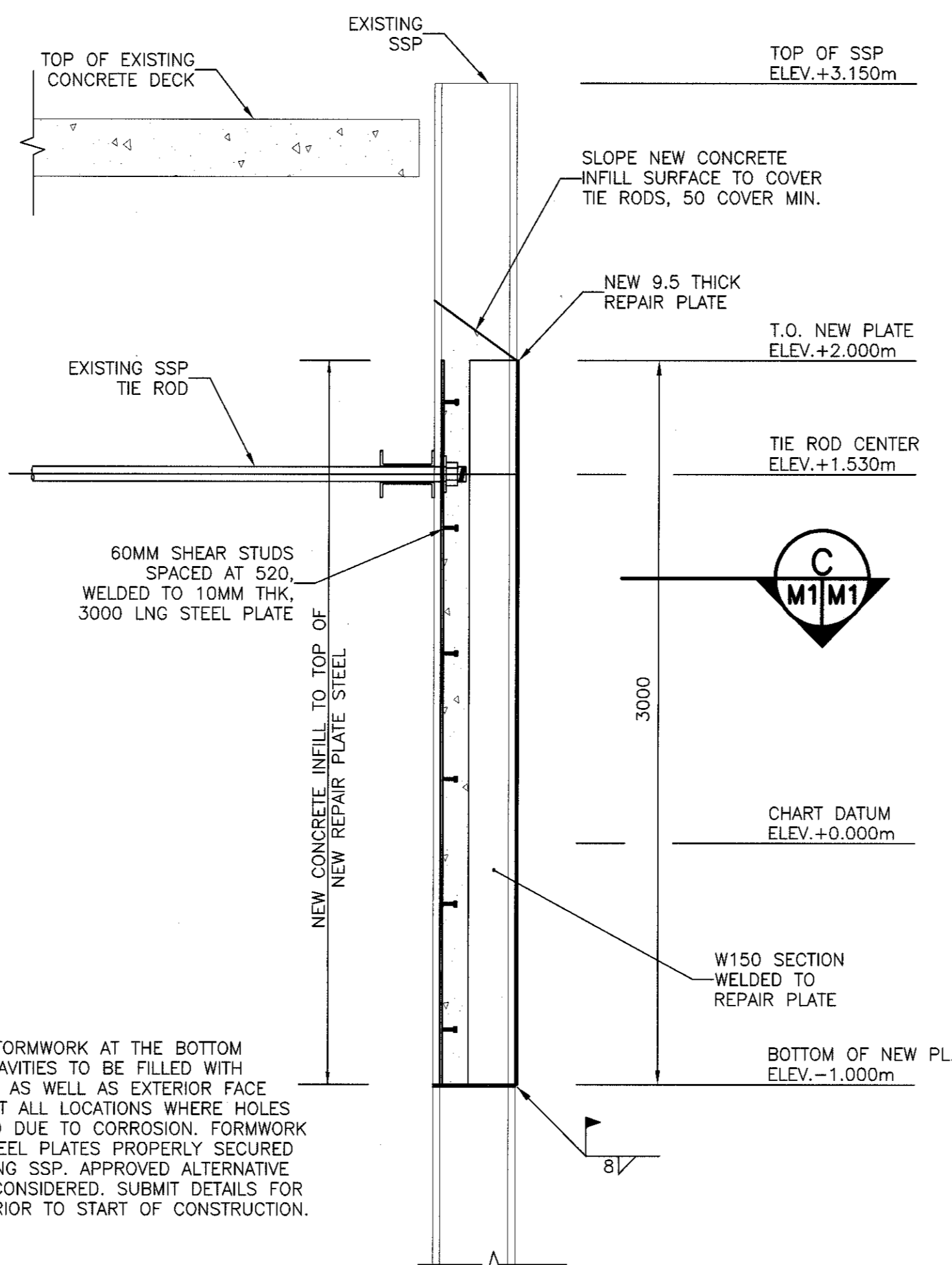

SECTION - REPAIR PLATE CONNECTION

SCALE : 1:20  
0mm 500mm 1000mm 1500mm 2000mm 2500mm

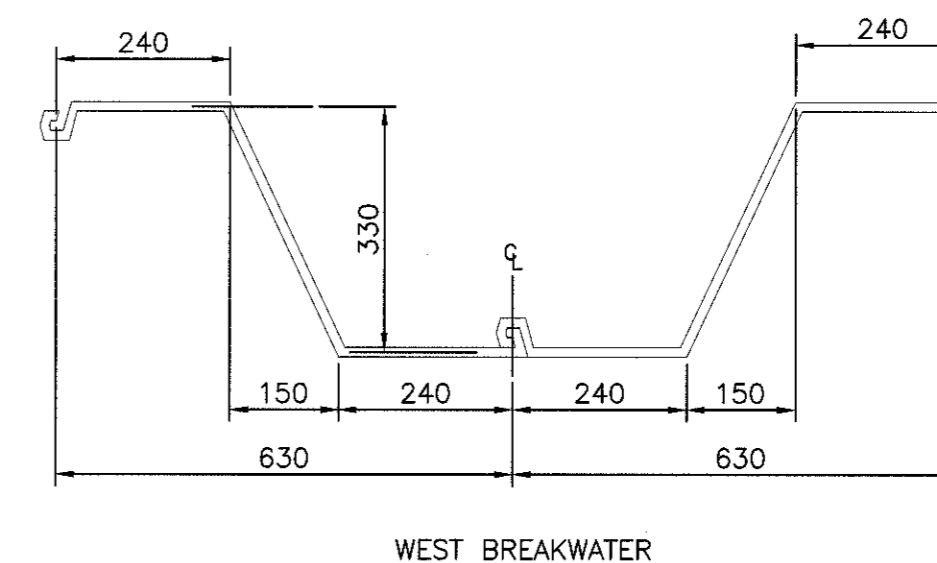

DETAIL - EXISTING SSP CROSS SECTIONS

SCALE : 1:10  
0mm 100 200 300 400 500 600 700 800 900 1000mm

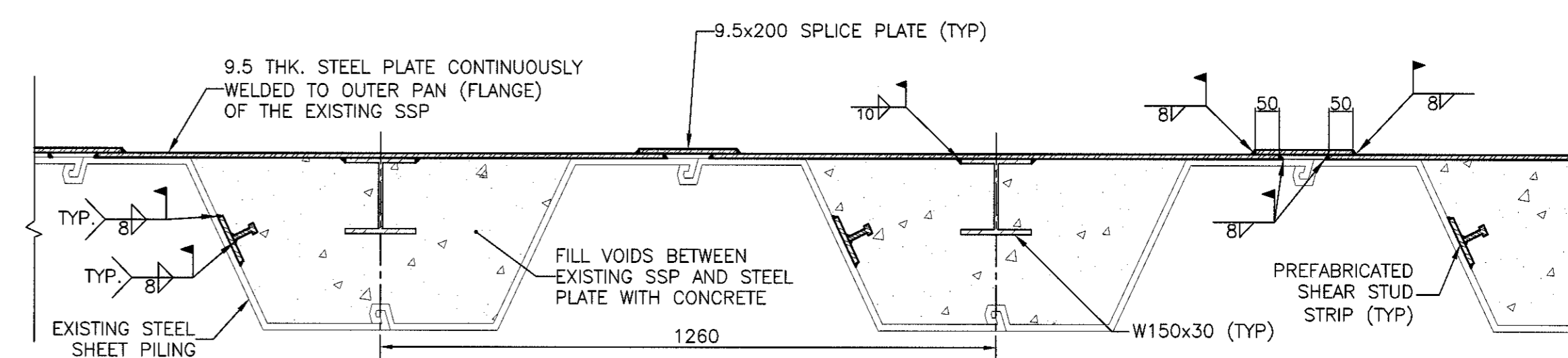

SECTION - WEST BREAKWATER SSP REPAIR

SCALE : 1:10  
0mm 100 200 300 400 500 600 700 800 900 1000mm



#### GENERAL NOTES:

1. THE WORK SHALL BE IN ACCORDANCE WITH 2010 NATIONAL BUILDING CODE OF CANADA (NBCC), LATEST REVISION, TO THE SATISFACTION OF THE ENGINEER UNLESS NOTES OTHERWISE ON THE DRAWING OR IN THE SPECIFICATIONS.
2. COMPLY WITH ALL ENVIRONMENTAL REGULATIONS AND PROVIDE ALL NECESSARY ENVIRONMENTAL PROTECTION INCLUDING SILT FENCES, SEDIMENT TRAPS, CHECK DAMS, DUST CONTROL, ETC. DO NOT DISPOSE OF OR BURN RUBBISH ON SITE.
3. COMPLY WITH ALL LOCAL, MUNICIPAL, AND PROVINCIAL BY-LAWS AND REGULATIONS.
4. ALL WORK SHALL BE PERFORMED IN ACCORDANCE WITH PEI OCCUPATIONAL HEALTH & SAFETY ACT, WORKPLACE HAZARDOUS MATERIALS INFORMATION SYSTEM AND APPLICABLE LABOR CODES.
5. CONTRACTOR MUST VISIT THE SITE AND BE FAMILIAR WITH EXISTING CONDITIONS, VERIFY EXACT LOCATION OF ALL EXISTING UTILITIES AND SERVICES WITHIN THE CONTRACT LIMIT.
6. CONTRACTOR SHALL COORDINATE WORK AND COOPERATE WITH OWNER AND AGENCIES HAVING JURISDICTION.
7. REPORT ANY DOUBTFUL CONDITIONS REQUIRING DECISIONS AND SECURE DIRECTIONS FROM THE ENGINEER BEFORE PROCEEDING WITH THE WORK.
8. VERIFY ALL DIMENSIONS AND ELEVATIONS AND REPORT ANY DISCREPANCIES TO THE ENGINEER BEFORE PROCEEDING WITH THE WORK.
9. ALL DIMENSIONS AND ELEVATIONS ARE IN METRIC UNITS UNLESS NOTED OTHERWISE.
10. PROPERLY DISPOSE AND REMOVE OFFSITE ALL DEBRIS AND MATERIALS TO BE REMOVED.

#### SCHEDULING OF WORK:

1. ALBERTON HARBOUR: GREATEST EXPENDITURE OF FUNDING IS REQUIRED BEFORE 31 MARCH 2016. THE WORK ON THIS WHARF SHALL START AFTER 1 APRIL 2016 DUE TO FISHING SEASON. WORK SHALL BE COMPLETED BY 17 JULY 2016.
2. NAUFRAGE HARBOUR: THE WORK ON THIS WHARF CAN BEGIN IMMEDIATELY AFTER AWARD AND MUST BE COMPLETED BEFORE 31 MARCH 2016.

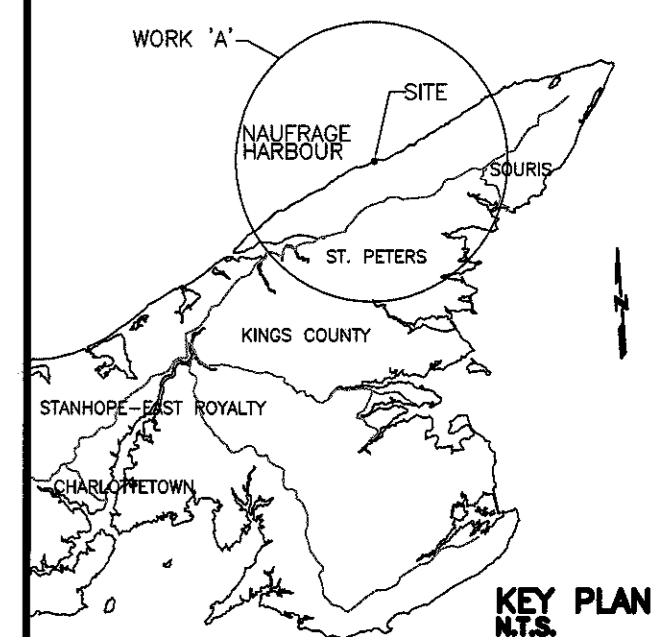

**Coles Associates**  
architecture, engineering, project management

Charlottetown, P.E.I., Canada, C1A 7L3  
Phone (902) 368-2300 Fax (902) 566-3768  
www.colesassociates.com



revisions: \_\_\_\_\_ date: \_\_\_\_\_

A detail no. no. du detail  
C location drawing no. sur dessin no.  
B drawing no. C dessin no.

project: **STEEL SHEET PILING REPAIRS NAUFRAGE AND NORTHPORT HARBOURS PEI** project

drawing: **NAUFRAGE HARBOUR WORK 'A' LOCATION SECTIONS & DETAILS** dessin

designed N.L. P.Eng concu  
date 08 Sept 2015  
drawn S.P.M. dessine  
date 08 Sept 2015  
approved [Signature] approuve  
date 08 Sept 2015  
Tender Soumission  
PWSC Project Manager Administrateur de projets TPSC  
project number no. du projet  
**R.076459.001**  
drawing no. no. du dessin  
**M1 OF 3**