

# FISHERIES AND OCEANS

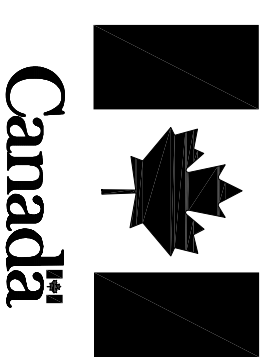

## CHANNEL HEAD WHARF DEMOLITION 2015

PORT AUX BASQUES, NL

PROJECT NO.: F6879-151003

ISSUED FOR TENDER

DATE: NOVEMBER 13, 2015

CLIENT/OWNER:  
DEPARTMENT OF FISHERIES & OCEANS,  
REAL PROPERTY, SAFETY & SECURITY

PRIME CONSULTANTS:  
AFN ENGINEERING INC.

### DRAWING LIST:

TITLE	
1101101D013C1	DEMOLITION SITE PLAN
1101101D013C2	EXISTING WHARF - ELEVATIONS AND SECTION
1101101D013C3	WALKWAY - PLAN, ELEVATION AND SECTION

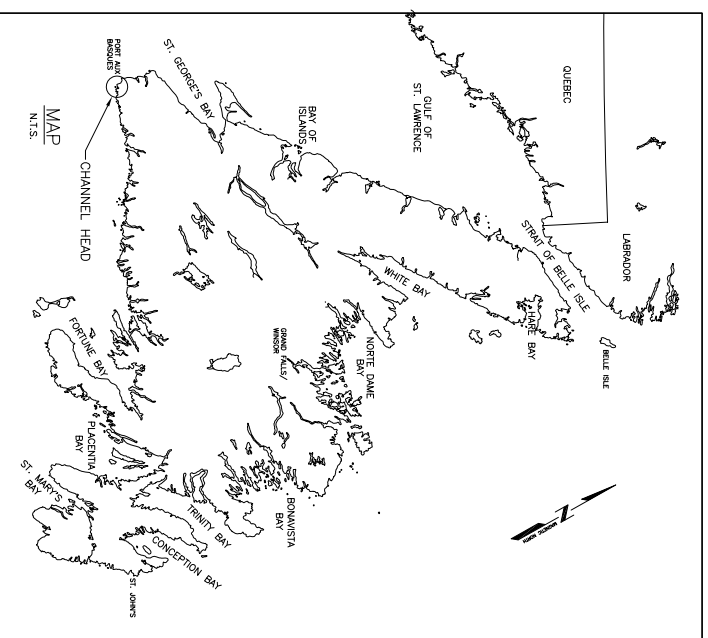

- NOTES:
1. SITE PLAN IS FOR GENERAL ILLUSTRATION PURPOSES ONLY AND MAY NOT REPRESENT SITE LAYOUT. VISIT SITE TO CONFIRM EXISTING CONDITIONS PRIOR TO TENDER CLOSE.
  2. THERE IS NO ROAD ACCESS TO THIS SITE. SITE IS ONLY ACCESSIBLE BY HELICOPTER OR BOAT.
  3. FOLLOWING WHARF REMOVAL SUBMIT UNDERWATER VIDEO OF WHARF FOOTPRINT CONFIRMING THAT ALL DEBRIS HAS BEEN REMOVED (INCLUDING TIMBER AND BALLAST ROCK).

LEGEND:

█ INDICATES ITEMS TO BE REMOVED

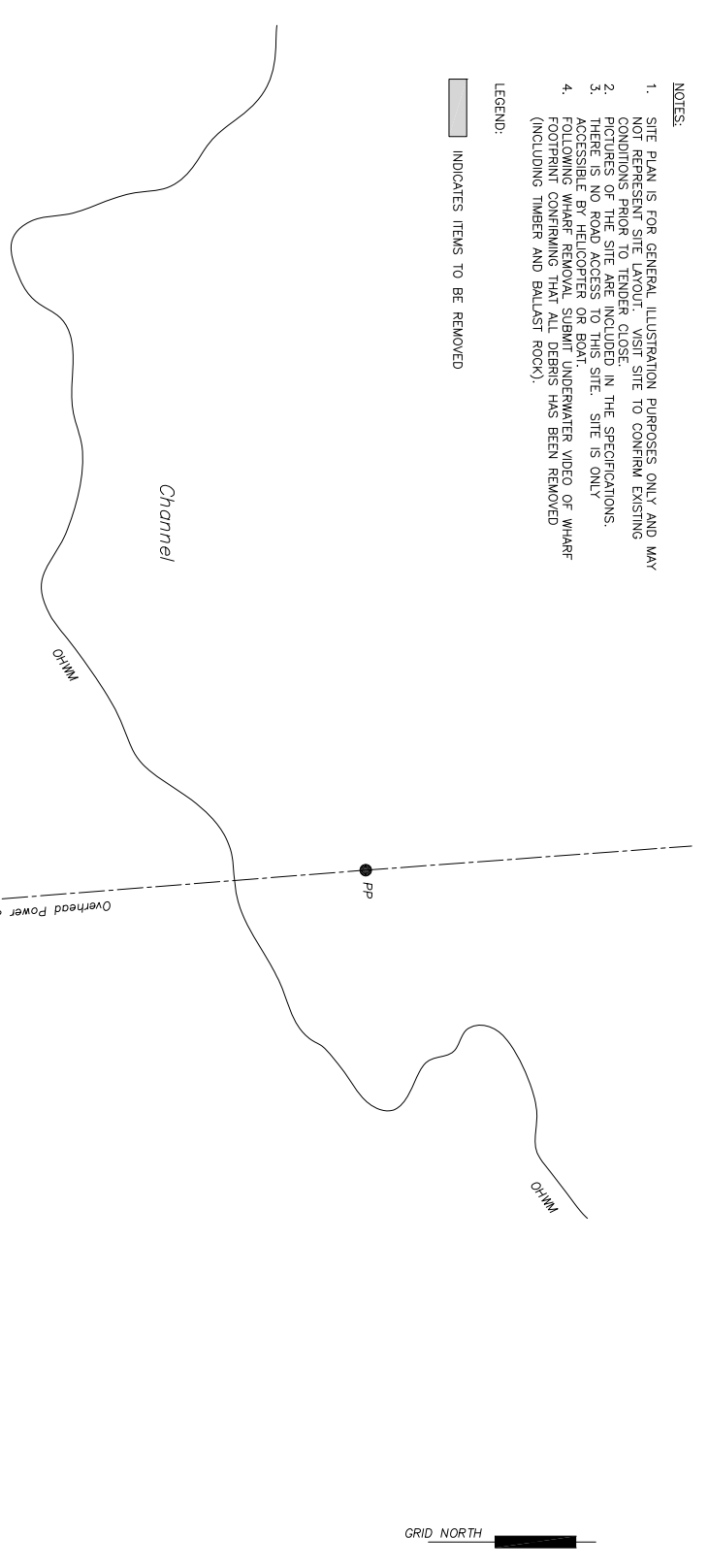

GRID NORTH

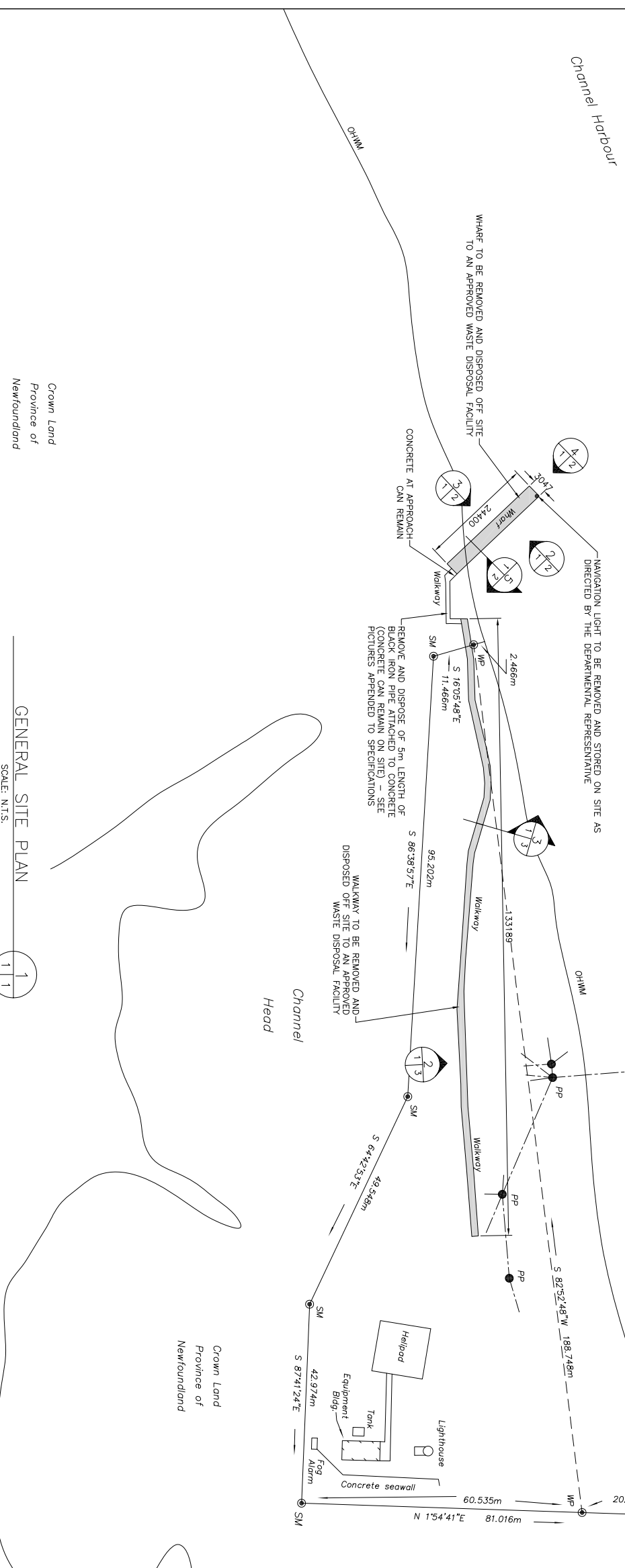

GENERAL SITE PLAN

SCALE: N.T.S.

Fisheries and Oceans / Pêches et Océans

Real Property, Safety & Security / Biens immobiliers, protection et sécurité

PROVINCE OF NEWFOUNDLAND PERMIT HOLDER  
This Permit Allows  
AN ENGINEERING INC.

REGISTERED PROFESSIONAL ENGINEERING  
N.L. ENGINEERING INC.  
13/11/15

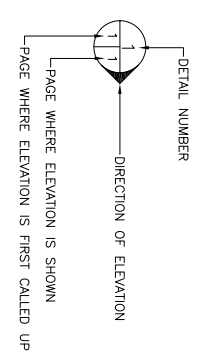

B	ISSUED FOR TENDER	13/11/15	P.H.	N.H.
A	ISSUED FOR REVIEW	27/07/15	P.H.	N.H.
no.	revision	date	by	approved
no.	revision	date	pr	approval

CHANNEL HEAD WHARF  
DEMOLITION 2015  
PORT AUX BASQUES, NL

DEMOLITION SITE PLAN

drawn - dessiné	designed - dessiné par	P.H.	N.H.
date - date	checked - vérifié	NOVEMBER 13, 2015	N.H.
scale - échelle	approved for tender - approuvé pour l'offre	AS SHOWN	
project no. - projet no.	drawing no. - no du dessin	F6879-151003	11011010013C1
	sheet - feuille		C1





Fisheries and Oceans  
Pêches et Océans  
Real Property, Safety & Security  
Biens immobiliers, protection et sécurité

PROVINCE OF NEWFOUNDLAND  
PERMIT HOLDER  
This Permit Allows  
APN ENGINEERING INC.

Registered Professional Engineering  
Permit No. as Issued by AENR, 201922  
which is valid for the year 2015.



- NOTES:
- DO NOT SCALE FROM DRAWINGS
  - DRAWINGS ARE FOR ILLUSTRATION PURPOSES ONLY AND ARE NOT TO SCALE.

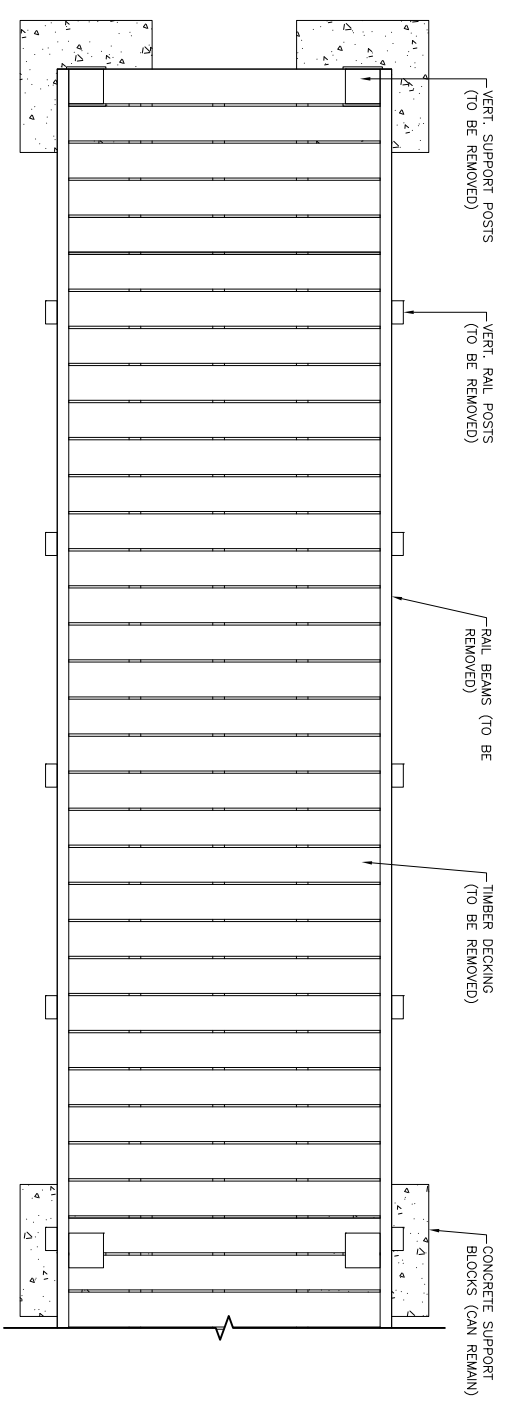

EXISTING WALKWAY - PLAN  
SCALE : N.T.S. 1/3

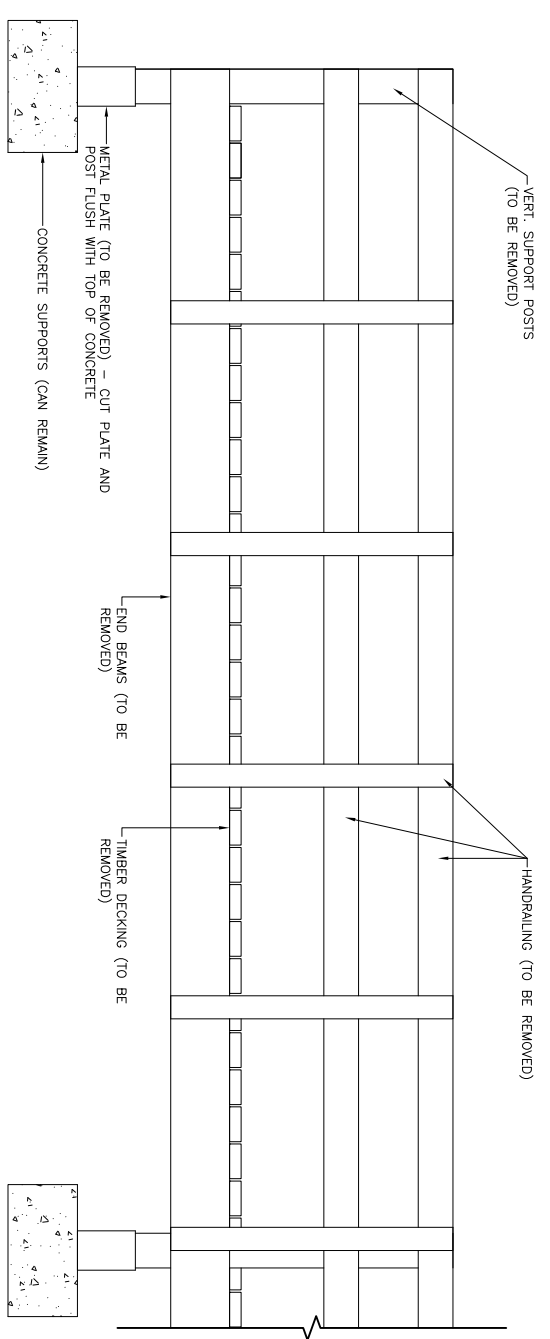

TYP. ELEVATION - WALKWAY  
SCALE : N.T.S. 2/3

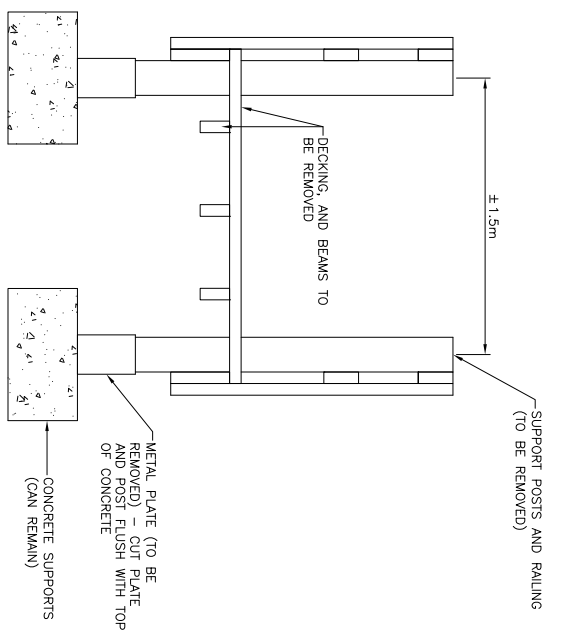

TYP. SECTION - WALKWAY  
SCALE : N.T.S. 3/3

NOTE:  
1. MUCH OF THE WALKWAY IS DILAPIDATED AND PARTS AND MATERIALS MISSING. THIS DRAWING IS APPROXIMATE SINCE AS-BUILT INFORMATION IS NOT AVAILABLE.

B	ISSUED FOR TENDER	13/11/15	P.H.	N.H.
A	ISSUED FOR REVIEW	27/07/15	P.H.	N.H.
no.	revision	date	by	approved
no.	revision	date	by	approved

Project - projet  
CHANNEL HEAD WHARF  
DEMOLITION 2015  
PORT AUX BASQUES, NL

Drawing - dessin  
WALKWAY - PLAN,  
ELEVATION AND SECTION

drawn - dessiné	designed - dessiné par	P.H.
date - date	checked - vérifié	N.H.
NOVEMBER 13, 2015	approved for tender - approuvé pour l'offre	AS SHOWN
scale - échelle	project no. - projet no.	drawing no. - no du dessin
1:3	F6879-151003	1101101D013C3
sheet - feuille		C3