



## RETURN BIDS TO:

## RETOURNER LES SOUMISSIONS À:

Public Works Government Services Canada-

Bid Receiving / Réception des soumissions

189 Prince William Street

Room 405

Saint John

New Brunswick

E2L 2B9

## INVITATION TO TENDER

## APPEL D'OFFRES

**Tender To: Public Works and Government Services  
Canada**

We hereby offer to sell to Her Majesty the Queen in right of Canada, in accordance with the terms and conditions set out herein, referred to herein or attached hereto, the goods, services, and construction listed herein and on any attached sheets at the price(s) set out therefor.

### Soumission aux: Travaux Publics et Services Gouvernementaux Canada

Nous offrons par la présente de vendre à Sa Majesté la Reine du chef du Canada, aux conditions énoncées ou incluses par référence dans la présente et aux annexes ci-jointes, les biens, services et construction énumérés ici et sur toute feuille ci-annexée, au(x) prix indiqué(s).

### Comments - Commentaires

### Vendor/Firm Name and Address

Raison sociale et adresse du

fournisseur/de l'entrepreneur

### Issuing Office - Bureau de distribution

Public Works Government Services Canada- Bid

Receiving / Réception des soumissions

189 Prince William Street

Room 405

Saint John

New Bruns

E2L 2B9

<b>Title - Sujet</b> Snow&Ice Control/Grass Cutting, PEI	
<b>Solicitation No. - N° de l'invitation</b> W0105-16E013/A	<b>Date</b> 2016-01-14
<b>Client Reference No. - N° de référence du client</b> W0105-16E013	<b>GETS Ref. No. - N° de réf. de SEAG</b> PW-\$PWB-022-3797
<b>File No. - N° de dossier</b> PWB-5-38184 (022)	<b>CCC No./N° CCC - FMS No./N° VME</b>
<b>Solicitation Closes - L'invitation prend fin</b> <b>at - à 02:00 PM</b> <b>on - le 2016-02-24</b>	
<b>Time Zone</b> <b>Fuseau horaire</b> Atlantic Standard Time AST	
<b>F.O.B. - F.A.B.</b> <b>Plant-Usine:</b> <input type="checkbox"/> <b>Destination:</b> <input checked="" type="checkbox"/> <b>Other-Autre:</b> <input type="checkbox"/>	
<b>Address Enquiries to: - Adresser toutes questions à:</b> MacDonald, Sherry	<b>Buyer Id - Id de l'acheteur</b> pwb022
<b>Telephone No. - N° de téléphone</b> (506) 639-3281 ( )	<b>FAX No. - N° de FAX</b> (506) 636-4376
<b>Destination - of Goods, Services, and Construction:</b> <b>Destination - des biens, services et construction:</b> DEPARTMENT OF NATIONAL DEFENCE 5 Engineer Svcs. Unit, BLDG B-18 5 CDSB GAGETOWN OROMCTO New Brunswick E2V4J5 Canada	

Instructions: See Herein

Instructions: Voir aux présentes

<b>Delivery Required - Livraison exigée</b> See Herein	<b>Delivery Offered - Livraison proposée</b>
<b>Vendor/Firm Name and Address</b> <b>Raison sociale et adresse du fournisseur/de l'entrepreneur</b>	
<b>Telephone No. - N° de téléphone</b> <b>Facsimile No. - N° de télécopieur</b>	
<b>Name and title of person authorized to sign on behalf of Vendor/Firm</b> <b>(type or print)</b> <b>Nom et titre de la personne autorisée à signer au nom du fournisseur/</b> <b>de l'entrepreneur (taper ou écrire en caractères d'imprimerie)</b>	
<b>Signature</b>	<b>Date</b>

Solicitation No. - N° de l'invitation  
W0105-16E013  
Client Ref. No. - N° de réf. du client  
W0105-16E013

Amd. No. - N° de la modif.  
File No. - N° du dossier  
pwb-5-38184

Buyer ID - Id de l'acheteur  
PWB 022  
CCC No./N° CCC - FMS No./N° VME

---

**SNOW & ICE CONTROL AND GRASS CUTTING/LANDSCAPE MAINTENANCE  
DND FACILITIES, CHARLOTTETOWN AND AREA, PE**

**TABLE OF CONTENTS**

**PART 1 - GENERAL INFORMATION**

- 1.1 Requirement
- 1.2 Debriefings

**PART 2 - BIDDER INSTRUCTIONS**

- 2.1 Standard Instructions, Clauses and Conditions
- 2.2 Submission of Bids
- 2.3 Former Public Servant
- 2.4 Enquiries - Bid Solicitation
- 2.5 Applicable Laws
- 2.6 Insurance Requirements
- 2.7 Workers Compensation Certification - Letter of Good Standing

**PART 3 - BID PREPARATION INSTRUCTIONS**

- 3.1 Bid Preparation Instructions

**PART 4 - EVALUATION PROCEDURES AND BASIS OF SELECTION**

- 4.1 Evaluation Procedures and Basis of Selection

**PART 5 – CERTIFICATIONS AND ADDITIONAL INFORMATION**

- 5.1 Certifications Required with Bid
- 5.2 Certifications Precedent to Contract Award and Additional Information

**PART 6 - RESULTING CONTRACT CLAUSES**

- 6.1 Security Requirement
- 6.2 Requirement
- 6.3 Standard Clauses and Conditions
- 6.4 Term of Contract
- 6.5 Authorities
- 6.6 Proactive Disclosure of Contracts with Former Public Servants
- 6.7 Payment
- 6.8 Invoicing Instructions
- 6.9 Certifications
- 6.10 Applicable Laws
- 6.11 Priority of Documents
- 6.12 Defence Contract
- 6.13 Insurance Specific Requirements

Solicitation No. - N° de l'invitation  
W0105-16E013  
Client Ref. No. - N° de réf. du client  
W0105-16E013

Amd. No. - N° de la modif.  
File No. - N° du dossier  
pwb-5-38184

Buyer ID - Id de l'acheteur  
PWB 022  
CCC No./N° CCC - FMS No./N° VME

---

**LIST OF ANNEXES:**

Annex A: Evaluation Criteria and Basis of Selection  
Annex B: Basis of Payment  
Annex C: Insurance Requirements  
Annex D: Complete List of Each Individual Who is currently on the Bidder's Board of Directors  
Annex E: Specification

## PART 1 - GENERAL INFORMATION

### 1.1 Requirement

The work covered under this Service Contract comprises the furnishing of all labour, materials, tools and equipment required to provide Snow and Ice Control (SNIC) and Grass Cutting/Landscape Maintenance at the Queen Charlotte Armoury, Alexandra Range, Brighton Compound, Support Detachment and HMCS Queen Charlotte Naval Reserve when requested and as specified herein.

The Service Contract is required for the period of May 01, 2016 to March 31, 2017 with an option to renew two-one year periods.

This agreement is subject to the provisions of the Agreement on Internal Trade, the North American Free Trade Agreement, Canada-Colombia, Canada-Chile and Canada-Panama Free Trade Agreement.

### 1.2 Debriefings

Bidders may request a debriefing on the results of the bid solicitation process. Bidders should make the request to the Contracting Authority within 15 working days from receipt of the results of the bid solicitation process. The debriefing may be in writing, by telephone or in person.

## PART 2 - BIDDER INSTRUCTIONS

### 2.1 Standard Instructions, Clauses and Conditions

All instructions, clauses and conditions identified in the bid solicitation by number, date and title are set out in the [Standard Acquisition Clauses and Conditions Manual](https://buyandsell.gc.ca/policy-and-guidelines/standard-acquisition-clauses-and-conditions-manual) (<https://buyandsell.gc.ca/policy-and-guidelines/standard-acquisition-clauses-and-conditions-manual>) issued by Public Works and Government Services Canada.

Bidders who submit a bid agree to be bound by the instructions, clauses and conditions of the bid solicitation and accept the clauses and conditions of the resulting contract.

The [2003](#) (2015/07/03) Standard Instructions - Goods or Services - Competitive Requirements, are incorporated by reference into and form part of the bid solicitation.

#### 2.1.1 SACC Manual Clauses

A0220T - Evaluation of Price (2014-06-26)

### 2.2 Submission of Bids

Bids must be submitted only to Public Works and Government Services Canada (PWGSC) Bid Receiving Unit by the date, time and place indicated on page 1 of the bid solicitation.

Late tenders will be returned unopened.

- (a) Bids must be complete and submitted on prescribed tender form;
- (b) Include the tender call number/project number and description of proposed work;
- (c) Include the closing date and time;
- (d) Must be received prior to bid closing time and at the designated place and facsimile number - FACSIMILE NUMBER IS (506-636-4376).

NOTE: FACSIMILE BIDS

Only incorrect handling by the Department of Public Works and Government Services will excuse the delay of responses transmitted by facsimile. Misrouting, traffic volume, weather disturbances, or any cause for the late receipt of such responses are not acceptable.

Bid Receiving  
Public Works and Government Services Canada  
Room 405  
189 Prince William Street  
Saint John, New Brunswick  
E2L 2B9

NOTE: THIS IS NOT A PUBLIC OPENING

2.3 Former Public Servant

Contracts awarded to former public servants (FPS) in receipt of a pension or of a lump sum payment must bear the closest public scrutiny, and reflect fairness in the spending of public funds. In order to comply with Treasury Board policies and directives on contracts awarded to FPSs, bidders must provide the information required below before contract award. If the answer to the questions and, as applicable the information required have not been received by the time the evaluation of bids is completed, Canada will inform the Bidder of a time frame within which to provide the information. Failure to comply with Canada's request and meet the requirement within the prescribed time frame will render the bid non-responsive.

Definitions

For the purposes of this clause,

"former public servant" is any former member of a department as defined in the [Financial Administration Act](#), R.S., 1985, c. F-11, a former member of the Canadian Armed Forces or a former member of the Royal Canadian Mounted Police. A former public servant may be:

- (a) An individual;
- (b) An individual who has incorporated;
- (c) A partnership made of former public servants; or
- (d) A sole proprietorship or entity where the affected individual has a controlling or major interest in the entity.

"lump sum payment period" means the period measured in weeks of salary, for which payment has been made to facilitate the transition to retirement or to other employment as a result of the implementation of various programs to reduce the size of the Public Service. The lump sum payment period does not include the period of severance pay, which is measured in a like manner.

"pension" means a pension or annual allowance paid under the [Public Service Superannuation Act](#) (PSSA), R.S., 1985, c. P-36, and any increases paid pursuant to the [Supplementary Retirement Benefits Act](#), R.S., 1985, c. S-24 as it affects the PSSA. It does not include pensions payable pursuant to the [Canadian Forces Superannuation Act](#), R.S., 1985, c. C-17, the [Defence Services Pension Continuation Act](#), 1970, c. D-3, the [Royal Canadian Mounted Police Pension Continuation Act](#), 1970, c. R-10, and the [Royal Canadian Mounted Police Superannuation Act](#), R.S., 1985, c. R-11, the [Members of Parliament Retiring Allowances Act](#), R.S. 1985, c. M-5, and that portion of pension payable to the [Canada Pension Plan Act](#), R.S., 1985, c. C-8.

---

#### Former Public Servant in Receipt of a Pension

As per the above definitions, is the Bidder a FPS in receipt of a pension? Yes ( ) No ( )

If so, the Bidder must provide the following information, for all FPSs in receipt of a pension, as applicable:

- (a) Name of former public servant;
- (b) Date of termination of employment or retirement from the Public Service.

By providing this information, Bidders agree that the successful Bidder's status, with respect to being a former public servant in receipt of a pension, will be reported on departmental websites as part of the published proactive disclosure reports in accordance with [Contracting Policy Notice: 2012-2](#) and the [Guidelines on the Proactive Disclosure of Contracts](#).

#### Work Force Adjustment Directive

Is the Bidder a FPS who received a lump sum payment pursuant to the terms of the Work Force Adjustment Directive? Yes ( ) No ( )

If so, the Bidder must provide the following information:

- (a) Name of former public servant;
- (b) Conditions of the lump sum payment incentive;
- (c) Date of termination of employment;
- (d) Amount of lump sum payment;
- (e) Rate of pay on which lump sum payment is based;
- (f) Period of lump sum payment including start date, end date, and number of weeks;
- (g) Number and amount (professional fees) of other contracts subject to the restrictions of a work force adjustment program.

For all contracts awarded during the lump sum payment period, the total amount of fees that may be paid to a FPS who received a lump sum payment is \$5,000, including Applicable Taxes.

(Derived from - Provenant de: A3025T, 2014/06/26)

#### 2.4 Enquiries - Bid Solicitation

All enquiries must be submitted in writing to the Contracting Authority no later than five (5) calendar days before the bid closing date. Enquiries received after that time may not be answered.

Bidders should reference as accurately as possible the numbered item of the bid solicitation to which the enquiry relates. Care should be taken by bidders to explain each question in sufficient detail in order to enable Canada to provide an accurate answer. Technical enquiries that are of a proprietary nature must be clearly marked "proprietary" at each relevant item. Items identified as "proprietary" will be treated as such except where Canada determines that the enquiry is not of a proprietary nature. Canada may edit the question(s) or may request that the Bidder do so, so that the proprietary nature of the question(s) is eliminated, and the enquiry can be answered to all bidders. Enquiries not submitted in a form that can be distributed to all bidders may not be answered by Canada.

## 2.5 Applicable Laws

Any resulting contract must be interpreted and governed, and the relations between the parties determined, by the laws in force in Prince Edward Island.

Bidders may, at their discretion, substitute the applicable laws of a Canadian province or territory of their choice without affecting the validity of their bid, by deleting the name of the Canadian province or territory specified and inserting the name of the Canadian province or territory of their choice. If no change is made, it acknowledges that the applicable laws specified are acceptable to the bidders.

## 2.6 Insurance Requirements – G1007T (2011-05-16)

The Bidder must provide a letter from an insurance broker or an insurance company licensed to operate in Canada stating that the Bidder, if awarded a contract as a result of the bid solicitation, can be insured in accordance with the Insurance Requirements specified in Annex “C”.

If the information is not provided in the bid, the Contracting Authority will so inform the Bidder and provide the Bidder with a time frame within which to meet the requirement. Failure to comply with the request of the Contracting Authority and meet the requirement within that time period will render the bid non-responsive.

## 2.7 Workers Compensation Certification - Letter of Good Standing – A0285T (2012-07-16)

The Bidder must have an account in good standing with the applicable provincial or territorial Workers' Compensation Board.

The Bidder must provide, within seven (7) days following a request from the Contracting Authority, a certificate or letter from the applicable Workers' Compensation Board confirming the Bidder's good standing account. Failure to comply with the request may result in the bid being declared non-responsive.

# PART 3 - BID PREPARATION INSTRUCTION

## 3.1 Bid Preparation Instructions

If there is a discrepancy between the wording of the soft copy and the hard copy, the wording of the hard copy will have priority over the wording of the soft copy.

Prices must appear in the financial bid only. No prices must be indicated in any other section of the bid.

Canada requests that Bidders follow the format instructions described below in the preparation of their bid:

- (a) Use 8.5 x 11 inch (216 mm x 279 mm) paper;
- (b) Use a numbering system that corresponds to the bid solicitation.

In April 2006, Canada issued a policy directing federal departments and agencies to take the necessary steps to incorporate environmental considerations into the procurement process [Policy on Green Procurement](http://www.tpsgc-pwgsc.gc.ca/ecologisation-greening/achats-procurement/politique-policy-eng.html) (<http://www.tpsgc-pwgsc.gc.ca/ecologisation-greening/achats-procurement/politique-policy-eng.html>). To assist Canada in reaching its objectives, Bidders should:

- 1) Use 8.5 x 11 inch (216 mm x 279 mm) paper containing fibre certified as originating from a sustainably-managed forest and containing minimum 30% recycled content; and

- 2) Use an environmentally-preferable format including black and white printing instead of colour printing, printing double sided/duplex, using staples or clips instead of cerlox, duotangs or binders.

Section I: Technical Bid

No technical bid required as part of this requirement.

Section II: Financial Bid

Bidders must submit their financial bid in accordance with the Basis of Payment. The total amount of Applicable Taxes must be shown separately.

3.1.1 SACC Manual Clauses

Section III: Certifications

Bidders must submit the certifications required under Part 5.

## PART 4 - EVALUATION PROCEDURES AND BASIS OF SELECTION

### 4.1 Evaluation Procedures and Basis of Selection

Bids will be evaluated in accordance with the Evaluation Criteria and Basis of Selection specified in Annex "A" and Basis of Payment specified in Annex "B". Bids will be assessed in accordance with the entire requirement of the bid solicitation including the technical and financial evaluation criteria.

## PART 5 – CERTIFICATIONS AND ADDITIONAL INFORMATION

Bidders must provide the required certifications and associated information to be awarded a contract.

The certifications provided by bidders to Canada are subject to verification by Canada at all times. Canada will declare a bid non-responsive, or will declare a contractor in default in carrying out any of its obligations under the Contract, if any certification made by the Bidder is found to be untrue, whether made knowingly or unknowingly, during the bid evaluation period or during the contract period.

The Contracting Authority will have the right to ask for additional information to verify the Bidder's certifications. Failure to comply and to cooperate with any request or requirement imposed by the Contracting Authority may render the bid non-responsive or constitute a default under the Contract

### 5.1 Certifications Required with the Bid

Bidders must submit the following duly completed certifications as part of their bid.

#### 5.1.1 Declaration of Convicted Offences

As applicable, pursuant to subsection Declaration of Convicted Offences of section 01 of the Standard Instructions, the Bidder must provide with its bid, a completed Declaration Form, to be given further consideration in the procurement process

### 5.2 Certifications Precedent to Contract Award and Additional Information

The certifications and additional information listed below should be submitted with the bid, but may be submitted afterwards. If any of these required certifications or additional information is not completed and submitted as requested, the Contracting Authority will inform the Bidder of a time frame within which to



provide the information. Failure to provide the certifications or the additional information listed below within the time frame provided will render the bid non-responsive.

#### 5.2.1 Integrity Provisions – List of Names

Bidders who are incorporated, including those bidding as a joint venture, must provide a complete list of names of all individuals who are currently directors of the Bidder.

Bidders bidding as sole proprietorship, as well as those bidding as a joint venture, must provide the name of the owner(s).

Bidders bidding as societies, firms or partnerships do not need to provide lists of names.

#### 5.2.2 Federal Contractors Program for Employment Equity - Bid Certification

By submitting a bid, the Bidder certifies that the Bidder, and any of the Bidder's members if the Bidder is a Joint Venture, is not named on the Federal Contractors Program (FCP) for employment equity "[FCP Limited Eligibility to Bid](http://www.labour.gc.ca/eng/standards_equity/eq/emp/fcp/list/inelig.shtml)" list ([http://www.labour.gc.ca/eng/standards\\_equity/eq/emp/fcp/list/inelig.shtml](http://www.labour.gc.ca/eng/standards_equity/eq/emp/fcp/list/inelig.shtml)) available from [Employment and Social Development Canada \(ESDC\) - Labour's](#) website.

Canada will have the right to declare a bid non-responsive if the Bidder, or any member of the Bidder if the Bidder is a Joint Venture, appears on the "[FCP Limited Eligibility to Bid](#)" list at the time of contract award.

#### 5.2.3 Additional Certifications Precedent to Contract Award

Contractor must be registered with Worker Compensation Board of PEI. Proof of such is required within seven (7) days of request from Contracting Authority and prior to award of Contract.

### PART 6 - RESULTING CONTRACT CLAUSES

The following clauses and conditions apply to and form part of any contract resulting from the bid solicitation.

#### 6.1 Security Requirements

6.1.1 The following security requirements apply and form part of the Contract.

- The Contractor shall maintain an up to date roster of all employees involved in the Service Contract including managers, supervisors, and labourers.
- The Contractor shall provide proof of the information contained within the roster to the Engineer upon demand. The Engineer reserves the right to have removed from the site those personnel who do not meet security requirements, as laid down by the Military Police Section.

#### 6.2 Requirement

The Contractor must perform the Work in accordance with the Statement of Work at Annex "E".

#### 6.3 Standard Clauses and Conditions

All clauses and conditions identified in the Contract by number, date and title are set out in the [Standard Acquisition Clauses and Conditions Manual](https://buyandsell.gc.ca/policy-and-guidelines/standard-acquisition-clauses-and-conditions-manual) (<https://buyandsell.gc.ca/policy-and-guidelines/standard-acquisition-clauses-and-conditions-manual>) issued by Public Works and Government Services Canada.

Solicitation No. - N° de l'invitation  
W0105-16E013  
Client Ref. No. - N° de réf. du client  
W0105-16E013

Amd. No. - N° de la modif.  
File No. - N° du dossier  
pwb-5-38184

Buyer ID - Id de l'acheteur  
PWB 022  
CCC No./N° CCC - FMS No./N° VME

---

#### 6.3.1 General Conditions

2010C (2015/09/03), General Conditions - Services (Medium Complexity) apply to and form part of the Contract.

#### 6.4 Term of Contract

##### 6.4.1 Period of the Contract

The Work is to be performed from May 01, 2016 to March 31, 2017

##### 6.4.2 Option to Extend the Contract

The Contractor grants to Canada the irrevocable option to extend the term of the Contract by up to two (2) additional one (1) year period(s) under the same conditions. The Contractor agrees that, during the extended period of the Contract, it will be paid in accordance with the applicable provisions as set out in the Basis of Payment.

Canada may exercise this option at any time by sending a written notice to the Contractor at least thirty (30) calendar days before the expiry date of the Contract. The option may only be exercised by the Contracting Authority, and will be evidenced for administrative purposes only, through a contract amendment

#### 6.5 Authorities

##### 6.5.1 Contracting Authority

The Contracting Authority for the Contract is:

Name: Sherry MacDonald  
Title: Supply Officer  
Organization: Public Services and Procurement Canada  
Acquisitions Branch  
Directorate: Real Property Contracting  
Address: 189 Prince William Street  
Saint John, New Brunswick  
E2L 2B9  
Telephone: (506) 639-3281  
Facsimile: (506) 636-4376  
E-mail address: sherry.macdonald@pwgsc.gc.ca

##### 6.5.2 Project Authority

The Project Authority for the Contract is: Will be made available at time of award

Name:  
Title:  
Organization:  
Address:  
  
Telephone:  
Facsimile:  
E-mail address:

The Project Authority is the representative of the department or agency for whom the Work is being carried out under the Contract and is responsible for all matters concerning the technical content of the Work under the Contract. Technical matters may be discussed with the Project Authority, however the Project Authority has no authority to authorize changes to the scope of the Work. Changes to the scope of the Work can only be made through a contract amendment issued by the Contracting Authority.

#### 6.5.3 Contractor's Representative

Name:  
Title:  
Organization:  
Address:

Telephone:  
Facsimile:  
E-mail address:

#### 6.6 Proactive Disclosure of Contracts with Former Public Servants

By providing information on its status, with respect to being a former public servant in receipt of a [Public Service Superannuation Act](#) (PSSA) pension, the Contractor has agreed that this information will be reported on departmental websites as part of the published proactive disclosure reports, in accordance with [Contracting Policy Notice: 2012-2](#) of the Treasury Board Secretariat of Canada.

#### 6.7 Payment

##### 6.7.1 Basis of Payment

Basis of payment is in accordance with Annex "B" and section 12, Payment Period, of the 2010C (2014-09-25), General Conditions - Services (Medium Complexity).

##### 6.7.2 Limitation of Price

SACC Manual clause [C6000C](#) (2011-05-16) Limitation of Price

##### 6.7.3 Monthly Payment

SACC Manual clause H1008C (2008-05-12) Monthly Payment

#### 6.8 Invoicing Instructions

The Contractor must submit invoices in accordance with the information required in section 10, Invoice Submission, of the 2010C (2015-09-03), General Conditions - Services (Medium Complexity).

#### 6.9 Certifications

##### 6.9.1 Compliance

The continuous compliance with the certifications provided by the Contractor in its bid and the ongoing cooperation in providing associated information are conditions of the Contract. Certifications are subject to verification by Canada during the entire period of the Contract. If the Contractor does not comply with any certification, fails to provide the associated information, or if it is determined that any certification made by the Contractor in its bid is untrue, whether made knowingly or unknowingly, Canada has the right, pursuant to the default provision of the Contract, to terminate the Contract for default.

#### 6.10 Applicable Laws

The Contract must be interpreted and governed, and the relations between the parties determined, by the laws in force in Prince Edward Island

#### 6.11 Priority of Documents

If there is a discrepancy between the wording of any documents that appear on the list, the wording of the document that first appears on the list has priority over the wording of any document that subsequently appears on the list.

- (a) The Articles of Agreement;
- (b) The 2010C (2015-09-03), General Conditions - Services (Medium Complexity).
- (c) Annex E, Requirement;
- (d) Annex B, Basis of Payment
- (e) Any Amendment issued or any allowable bid revision received before the date and time set for solicitation closing;
- (f) The Contractor's bid dated \_\_\_\_\_

#### 6.12 Defence Contract

SACC Manual clause [A9006C](#) (2012-07-16) Defence Contract

#### 6.13 Insurance Specific Requirements

The Contractor must comply with the insurance requirements specified in Annex "C". The Contractor must maintain the required insurance coverage for the duration of the Contract. Compliance with the insurance requirements does not release the Contractor from or reduce its liability under the Contract.

The Contractor is responsible for deciding if additional insurance coverage is necessary to fulfill its obligation under the Contract and to ensure compliance with any applicable law. Any additional insurance coverage is at the Contractor's expense, and for its own benefit and protection.

The Contractor must forward to the Contracting Authority within seven (7) days after request from the Contracting Authority and prior to award of Service Contract, a Certificate of Insurance evidencing the insurance coverage and confirming that the insurance policy complying with the requirements is in force. Coverage must be placed with an Insurer licensed to carry out business in Canada. The Contractor must, if requested by the Contracting Authority, forward to Canada a certified true copy of all applicable insurance policies.

---

**ANNEX "A"**  
**EVALUATION CRITERIA AND BASIS OF SELECTION**

Bids received will be assessed in accordance with the entire requirement of the bid solicitation.

1. Mandatory Criteria

1. Submission of firm prices/rates for one (1) year including two (2) option years in accordance with Invitation to Tender.
2. A duly completed and signed Invitation to Tender including all Addenda.
3. Within seven (7) days of request from contracting authority and prior to award of Service Contract, provide proof that Bidder has an account in good standing with the Provincial Workers' Compensation Board/Commission.
4. Within seven (7) days of request from Contracting Authority and prior to award of the Service Contract, Contractor must provide proof of \$2 Million General Liability Insurance in accordance with Paragraph 6.13 and Annex "C".
5. Within seven (7) days and prior to award of Service Contract, the bidder shall be required to provide proof of Public Liability and Property Damage Insurance in the amount of \$2,000,000.00 in accordance with Section 00 21 13, Paragraph 1.13.9 of the Specification located at Annex "E".
6. Within seven (7) days and prior to award of Service Contract, the bidder must provide proof that Contractor is an established Grounds Keeping Service Company with a minimum of three (3) years experience in Commercial Snow and Ice Control and Grass Cutting/Landscape Maintenance in accordance with Section 00 21 13, Paragraph 1.04.1 of the Specification located at Annex "E".
7. Within seven (7) days and prior to award of Service Contract, the bidder must provide a list of equipment, including the manufacturer, model, and capacity. Equipment is subject to inspection and approval by the Department of National Defence (DND) prior to award of Service Contract.
8. Within seven (7) days and prior to award of Service Contract, the bidder must provide a complete list of all individuals who are on the current Board of Directors in accordance with Paragraph 5.2.1 and Annex "D".
9. Within seven (7) days and prior to award of Service Contract, the bidder must provide proof of licensing for all vehicles and operators used for this Service Contract in accordance with regulations of the Province of Prince Edward Island in accordance with Section 00 21 13, Paragraph 1.13.09 of the Specification located at Annex "E".
10. Within seven (7) days and prior to award of Service Contract, the bidder must provide proof of registration with Worker Compensation Board of Prince Edward Island in accordance with Section 00 21 13, Paragraph 1.09.2 of the Specification located at Annex "E".

2. 2007/05/07 A0069T Basis of Selection - Mandatory Requirements Only

A bid must comply with all requirements of the bid solicitation to be declared responsive. The responsive bid with the lowest evaluated price will be recommended for award of a contract.

Solicitation No. - N° de l'invitation  
W0105-16E013  
Client Ref. No. - N° de réf. du client  
W0105-16E013

Amd. No. - N° de la modif.  
File No. - N° du dossier  
pwb-5-38184

Buyer ID - Id de l'acheteur  
PWB 022  
CCC No./N° CCC - FMS No./N° VME

---

**ANNEX "B"**  
**BASIS OF PAYMENT**

The following requirement must be strictly adhered to: Failure to do so shall render the bidder's proposal as non-responsive.

It is mandatory that the bidders submit firm rates for the Period of the Service Contract for all items listed hereafter. Unit Price Tables, will be considered as the bidder's Financial Proposal.

Each item specified in the Unit Price Tables, includes wages, traveling time and costs, allowances, supervision, liabilities as employer, insurance, and the use of all tools, tackle, etc., overhead, profit, and all other liabilities whatsoever.

The prices inserted in the Unit Price Tables, includes all applicable federal, provincial and municipal taxes. However, they do not include any amount for the Goods and Services Tax (GST)/Harmonized Sales Tax (HST). The appropriate GST/HST amounts will be paid by Her Majesty to the Offeror in addition to the amount paid against the amount of the contract.

**W0105-16E013**

**The estimated quantity entered in column four, on the following spreadsheets, for each item is an estimate only for service as and when required and does not infer all the quantities for that item will be utilized or that the quantities may not be exceeded.**

**NOTE: TENDERS WILL BE EVALUATED ON THE TOTAL BID FOR THE FIRST TERM OF THE CONTRACT PLUS THE OPTION YEARS. HOWEVER, ANY CONTRACT AWARD WILL BE FOR THE TERM OF MAY 01, 2016 TO MARCH 31, 2017.**

Solicitation No. - N° de l'invitation  
W0105-16E013  
Client Ref. No. - N° de réf. du client  
W0105-16E013

Amd. No. - N° de la modif.  
File No. - N° du dossier  
pwb-5-38184

Buyer ID - Id de l'acheteur  
PWB 022  
CCC No./N° CCC - FMS No./N° VME

**TERM "A": MAY 01, 2016 to MARCH 31, 2017**

No.	CLASS OF SERVICE	U of M	Est. Quantity	Price per Unit	Est. Total Price
1	Price per month for Snow & Ice Control Services on all roadways, parking areas, vehicle compounds, fire hydrants, doorways, & walkways including application of ice control mixture, after each snow or ice event or as required at Queen Charlotte Armoury as shown in Annex A of the Specification for the months of November to March.	Per Month	5		
2	Price per month for Snow & Ice Control Services on all roadways, parking areas, vehicle compounds, fire hydrants, doorways, & walkways including application of ice control mixture, after each snow or ice event or as required at Alexandra Range as shown in Annex B of the Specification for the months of November to March.	Per Month	5		
3	Price per month for Snow & Ice Control Services on all roadways, parking areas, vehicle compounds, fire hydrants, doorways, & walkways including application of ice control mixture, after each snow or ice event or as required at Brighton Compound as shown in Annex C of the Specification for the months of November to March.	Per Month	5		
4	Price per month for Snow & Ice Control Services on all roadways, parking areas, vehicle compounds, fire hydrants, doorways, & walkways including application of ice control mixture, after each snow or ice event or as required at Support Detachment as shown in Annex D of the Specification for the months of November to March.	Per Month	5		
5	Price per month for Snow & Ice Control Services on all roadways, parking areas, vehicle compounds, fire hydrants, doorways, & walkways including application of ice control mixture, after each snow or ice event or as required at HMCS Queen Charlotte as shown in Annex E of the Specification for the months of November to March.	Per Month	5		
6	Price per occurrence for Snow & Ice Control Services on all roadways, parking areas, vehicle compounds, fire hydrants, doorways, & walkways including application of ice control mixture, as and when requested by the Engineer at Queen Charlotte Armoury as shown in Annex A of the Specification during the months of October and April.	Per Occurrence	5		
7	Price per occurrence for Snow & Ice Control Services on all roadways, parking areas, vehicle compounds, fire hydrants, doorways, & walkways including application of ice control mixture, as and when requested by the Engineer at Alexandra Range as shown in Annex B of the Specification during the months of October and April.	Per Occurrence	5		

8	Price per occurrence for Snow & Ice Control Services on all roadways, parking areas, vehicle compounds, fire hydrants, doorways, & walkways including application of ice control mixture, as and when requested by the Engineer at Brighton Compound as shown in Annex C of the Specification during the months of October and April.	Per Occurrence	5		
9	Price per occurrence for Snow & Ice Control Services on all roadways, parking areas, vehicle compounds, fire hydrants, doorways, & walkways including application of ice control mixture, as and when requested by the Engineer at Support Detachment as shown in Annex D of the Specification during the months of October and April.	Per Occurrence	5		
10	Price per occurrence for Snow & Ice Control Services on all roadways, parking areas, vehicle compounds, fire hydrants, doorways, & walkways including application of ice control mixture, as and when requested by the Engineer at H as shown in Annex B of the Specification during the months of October and April.	Per Occurrence	5		
11	Price per hour for a loader to remove snow from DND Property and dispose of at a Provincially approved site as and when requested by the Engineer.	Per Hour	500		
12	Price per hour for a tandem dump truck to remove snow from DND Property and dispose of at a Provincially approved site as and when requested by the Engineer.	Per Hour	500		
13	Price per month for Grass Cutting Services on all areas at Queen Charlotte Armoury as shown in Annex F of the Specification for the months of mid-May to end-September.	Per Month	5		
14	Price per month for Grass Cutting Services on all areas at Alexandra Range as shown in Annex G of the Specification for the months of mid-May to end-September.	Per Month	5		
15	Price per month for Grass Cutting Services on all areas at Brighton Compound as shown in Annex H of the Specification for the months of mid-May to end-September.	Per Month	5		
16	Price per month for Grass Cutting Services on all areas at Support Detachment as shown in Annex J of the Specification for the months of mid-May to end-September.	Per Month	5		
17	Price per month for Grass Cutting Services on all areas at HMCS Queen Charlotte as shown in Annex K of the Specification for the months of mid-May to end-September.	Per Month	5		
18	Unit price for Grass Cutting Services at Queen Charlotte Armoury as shown in Annex F of the Specification as and when requested by the Engineer.	Per Occurrence	5		
19	Unit price for Grass Cutting Services at Alexandra Range as shown in Annex G of the Specification as and when requested by the Engineer.	Per Occurrence	5		



Solicitation No. - N° de l'invitation  
W0105-16E013  
Client Ref. No. - N° de réf. du client  
W0105-16E013

Amd. No. - N° de la modif.  
File No. - N° du dossier  
pwb-5-38184

Buyer ID - Id de l'acheteur  
PWB 022  
CCC No./N° CCC - FMS No./N° VME

20	Unit price for Grass Cutting Services at Brighton Compound as shown in Annex H of the Specification as and when requested by the Engineer.	Per Occurrence	5		
21	Unit price for Grass Cutting Services at Support Detachment as shown in Annex J of the Specification as and when requested by the Engineer.	Per Occurrence	5		
22	Unit price for Grass Cutting Services at HMCS Queen Charlotte as shown in Annex K of the Specification as and when requested by the Engineer.	Per Occurrence	5		
23	Hourly rate for Landscape Maintenance Services as and when requested by the Engineer.	Per Hour	40		
24	Hourly rate for a two (2) meter Rotary Field Mower with operator as and when requested by the Engineer.	Per Hour	40		
25	All product and materials will be invoiced at the Contractor's wholesale cost plus a percentage for mark-up, estimated at \$10,000. The Contractor is to submit a percent of mark-up for tendering purposes: _____% <b>Allowance + Mark-up = Total Price</b>	Allowance	10,000	Mark-up in \$ _____	Allowance + Mark-up = % _____
<b>Total Estimated Amount used for Evaluation Term "A"</b>					

**TERM "B": APRIL 01, 2017 to MARCH 31, 2018**

No.	CLASS OF SERVICE	U of M	Est. Quantity	Price per Unit	Est. Total Price
1	Price per month for Snow & Ice Control Services on all roadways, parking areas, vehicle compounds, fire hydrants, doorways, & walkways including application of ice control mixture, after each snow or ice event or as required at Queen Charlotte Armoury as shown in Annex A of the Specification for the months of November to March.	Per Month	5		
2	Price per month for Snow & Ice Control Services on all roadways, parking areas, vehicle compounds, fire hydrants, doorways, & walkways including application of ice control mixture, after each snow or ice event or as required at Alexandra Range as shown in Annex B of the Specification for the months of November to March.	Per Month	5		
3	Price per month for Snow & Ice Control Services on all roadways, parking areas, vehicle compounds, fire hydrants, doorways, & walkways including application of ice control mixture, after each snow or ice event or as required at Brighton Compound as shown in Annex C of the Specification for the months of November to March.	Per Month	5		
4	Price per month for Snow & Ice Control Services on all roadways, parking areas, vehicle compounds, fire hydrants, doorways, & walkways including application	Per Month	5		

	of ice control mixture, after each snow or ice event or as required at Support Detachment as shown in Annex D of the Specification for the months of November to March.				
5	Price per month for Snow & Ice Control Services on all roadways, parking areas, vehicle compounds, fire hydrants, doorways, & walkways including application of ice control mixture, after each snow or ice event or as required at HMCS Queen Charlotte as shown in Annex E of the Specification for the months of November to March.	Per Month	5		
6	Price per occurrence for Snow & Ice Control Services on all roadways, parking areas, vehicle compounds, fire hydrants, doorways, & walkways including application of ice control mixture, as and when requested by the Engineer at Queen Charlotte Armoury as shown in Annex A of the Specification during the months of October and April.	Per Occurrence	5		
7	Price per occurrence for Snow & Ice Control Services on all roadways, parking areas, vehicle compounds, fire hydrants, doorways, & walkways including application of ice control mixture, as and when requested by the Engineer at Alexandra Range as shown in Annex B of the Specification during the months of October and April.	Per Occurrence	5		
8.	Price per occurrence for Snow & Ice Control Services on all roadways, parking areas, vehicle compounds, fire hydrants, doorways, & walkways including application of ice control mixture, as and when requested by the Engineer at Brighton Compound as shown in Annex C of the Specification during the months of October and April.	Per Occurrence	5		
9	Price per occurrence for Snow & Ice Control Services on all roadways, parking areas, vehicle compounds, fire hydrants, doorways, & walkways including application of ice control mixture, as and when requested by the Engineer at Support Detachment as shown in Annex D of the Specification during the months of October and April.	Per Occurrence	5		
10	Price per occurrence for Snow & Ice Control Services on all roadways, parking areas, vehicle compounds, fire hydrants, doorways, & walkways including application of ice control mixture, as and when requested by the Engineer at H as shown in Annex B of the Specification during the months of October and April.	Per Occurrence	5		
11	Price per hour for a loader to remove snow from DND Property and dispose of at a Provincially approved site as and when requested by the Engineer.	Per Hour	500		
12	Price per hour for a tandem dump truck to remove snow from DND Property and dispose of at a Provincially approved site as and when requested by the Engineer.	Per Hour	500		

Solicitation No. - N° de l'invitation  
W0105-16E013  
Client Ref. No. - N° de réf. du client  
W0105-16E013

Amd. No. - N° de la modif.  
File No. - N° du dossier  
pwb-5-38184

Buyer ID - Id de l'acheteur  
PWB 022  
CCC No./N° CCC - FMS No./N° VME

13	Price per month for Grass Cutting Services on all areas at Queen Charlotte Armoury as shown in Annex F of the Specification for the months of mid-May to end-September.	Per Month	5		
14	Price per month for Grass Cutting Services on all areas at Alexandra Range as shown in Annex G of the Specification for the months of mid-May to end-September.	Per Month	5		
15	Price per month for Grass Cutting Services on all areas at Brighton Compound as shown in Annex H of the Specification for the months of mid-May to end-September.	Per Month	5		
16	Price per month for Grass Cutting Services on all areas at Support Detachment as shown in Annex J of the Specification for the months of mid-May to end-September.	Per Month	5		
17	Price per month for Grass Cutting Services on all areas at HMCS Queen Charlotte as shown in Annex K of the Specification for the months of mid-May to end-September.	Per Month	5		
18	Unit price for Grass Cutting Services at Queen Charlotte Armoury as shown in Annex F of the Specification as and when requested by the Engineer.	Per Occurrence	5		
19	Unit price for Grass Cutting Services at Alexandra Range as shown in Annex G of the Specification as and when requested by the Engineer.	Per Occurrence	5		
20	Unit price for Grass Cutting Services at Brighton Compound as shown in Annex H of the Specification as and when requested by the Engineer.	Per Occurrence	5		
21	Unit price for Grass Cutting Services at Support Detachment as shown in Annex J of the Specification as and when requested by the Engineer.	Per Occurrence	5		
22	Unit price for Grass Cutting Services at HMCS Queen Charlotte as shown in Annex K of the Specification as and when requested by the Engineer.	Per Occurrence	5		
23	Hourly rate for Landscape Maintenance Services as and when requested by the Engineer.	Per Hour	40		
24	Hourly rate for a two (2) meter Rotary Field Mower with operator as and when requested by the Engineer.	Per Hour	40		
13	All product and materials will be invoiced at the Contractor's wholesale cost plus a percentage for mark-up, estimated at \$10,000. The Contractor is to submit a percent of mark-up for tendering purposes: _____% <b>Allowance + Mark-up = Total Price</b>	Allowance	10,000	Mark-up in \$ _____	Allowance + Mark-up = % _____
<b>Total Estimated Amount used for Evaluation Term "B"</b>					

Solicitation No. - N° de l'invitation  
W0105-16E013  
Client Ref. No. - N° de réf. du client  
W0105-16E013

Amd. No. - N° de la modif.  
File No. - N° du dossier  
pwb-5-38184

Buyer ID - Id de l'acheteur  
PWB 022  
CCC No./N° CCC - FMS No./N° VME

**TERM "C": MAY 01, 2018 to MARCH 31, 2019**

No.	CLASS OF SERVICE	U of M	Est. Quantity	Price per Unit	Est. Total Price
1	Price per month for Snow & Ice Control Services on all roadways, parking areas, vehicle compounds, fire hydrants, doorways, & walkways including application of ice control mixture, after each snow or ice event or as required at Queen Charlotte Armoury as shown in Annex A of the Specification for the months of November to March.	Per Month	5		
2	Price per month for Snow & Ice Control Services on all roadways, parking areas, vehicle compounds, fire hydrants, doorways, & walkways including application of ice control mixture, after each snow or ice event or as required at Alexandra Range as shown in Annex B of the Specification for the months of November to March.	Per Month	5		
3	Price per month for Snow & Ice Control Services on all roadways, parking areas, vehicle compounds, fire hydrants, doorways, & walkways including application of ice control mixture, after each snow or ice event or as required at Brighton Compound as shown in Annex C of the Specification for the months of November to March.	Per Month	5		
4	Price per month for Snow & Ice Control Services on all roadways, parking areas, vehicle compounds, fire hydrants, doorways, & walkways including application of ice control mixture, after each snow or ice event or as required at Support Detachment as shown in Annex D of the Specification for the months of November to March.	Per Month	5		
5	Price per month for Snow & Ice Control Services on all roadways, parking areas, vehicle compounds, fire hydrants, doorways, & walkways including application of ice control mixture, after each snow or ice event or as required at HMCS Queen Charlotte as shown in Annex E of the Specification for the months of November to March.	Per Month	5		
6	Price per occurrence for Snow & Ice Control Services on all roadways, parking areas, vehicle compounds, fire hydrants, doorways, & walkways including application of ice control mixture, as and when requested by the Engineer at Queen Charlotte Armoury as shown in Annex A of the Specification during the months of October and April.	Per Occurrence	5		
7	Price per occurrence for Snow & Ice Control Services on all roadways, parking areas, vehicle compounds, fire hydrants, doorways, & walkways including application of ice control mixture, as and when requested by the Engineer at Alexandra Range as	Per Occurrence	5		

	shown in Annex B of the Specification during the months of October and April.				
8.	Price per occurrence for Snow & Ice Control Services on all roadways, parking areas, vehicle compounds, fire hydrants, doorways, & walkways including application of ice control mixture, as and when requested by the Engineer at Brighton Compound as shown in Annex C of the Specification during the months of October and April.	Per Occurrence	5		
9	Price per occurrence for Snow & Ice Control Services on all roadways, parking areas, vehicle compounds, fire hydrants, doorways, & walkways including application of ice control mixture, as and when requested by the Engineer at Support Detachment as shown in Annex D of the Specification during the months of October and April.	Per Occurrence	5		
10	Price per occurrence for Snow & Ice Control Services on all roadways, parking areas, vehicle compounds, fire hydrants, doorways, & walkways including application of ice control mixture, as and when requested by the Engineer at H as shown in Annex B of the Specification during the months of October and April.	Per Occurrence	5		
11	Price per hour for a loader to remove snow from DND Property and dispose of at a Provincially approved site as and when requested by the Engineer.	Per Hour	500		
12	Price per hour for a tandem dump truck to remove snow from DND Property and dispose of at a Provincially approved site as and when requested by the Engineer.	Per Hour	500		
13	Price per month for Grass Cutting Services on all areas at Queen Charlotte Armoury as shown in Annex F of the Specification for the months of mid-May to end-September.	Per Month	5		
14	Price per month for Grass Cutting Services on all areas at Alexandra Range as shown in Annex G of the Specification for the months of mid-May to end-September.	Per Month	5		
15	Price per month for Grass Cutting Services on all areas at Brighton Compound as shown in Annex H of the Specification for the months of mid-May to end-September.	Per Month	5		
16	Price per month for Grass Cutting Services on all areas at Support Detachment as shown in Annex J of the Specification for the months of mid-May to end-September.	Per Month	5		
17	Price per month for Grass Cutting Services on all areas at HMCS Queen Charlotte as shown in Annex K of the Specification for the months of mid-May to end-September.	Per Month	5		
18	Unit price for Grass Cutting Services at Queen Charlotte Armoury as shown in Annex F of the Specification as and when requested by the Engineer.	Per Occurrence	5		

Solicitation No. - N° de l'invitation  
W0105-16E013  
Client Ref. No. - N° de réf. du client  
W0105-16E013

Amd. No. - N° de la modif.  
  
File No. - N° du dossier  
pwb-5-38184

Buyer ID - Id de l'acheteur  
PWB 022  
CCC No./N° CCC - FMS No./N° VME

19	Unit price for Grass Cutting Services at Alexandra Range as shown in Annex G of the Specification as and when requested by the Engineer.	Per Occurrence	5		
20	Unit price for Grass Cutting Services at Brighton Compound as shown in Annex H of the Specification as and when requested by the Engineer.	Per Occurrence	5		
21	Unit price for Grass Cutting Services at Support Detachment as shown in Annex J of the Specification as and when requested by the Engineer.	Per Occurrence	5		
22	Unit price for Grass Cutting Services at HMCS Queen Charlotte as shown in Annex K of the Specification as and when requested by the Engineer.	Per Occurrence	5		
23	Hourly rate for Landscape Maintenance Services as and when requested by the Engineer.	Per Hour	40		
24	Hourly rate for a two (2) meter Rotary Field Mower with operator as and when requested by the Engineer.	Per Hour	40		
13	All product and materials will be invoiced at the Contractor's wholesale cost plus a percentage for mark-up, estimated at \$10,000. The Contractor is to submit a percent of mark-up for tendering purposes: _____% <b>Allowance + Mark-up = Total Price</b>	Allowance	10,000	Mark-up in \$ _____	Allowance + Mark-up = % _____
<b>Total Estimated Amount used for Evaluation Term "C"</b>					

<b>TOTAL for TERM "A"</b>	
<b>TOTAL for TERM "B"</b>	
<b>TOTAL for TERM "C"</b>	
<b>GRAND TOTAL AMOUNT OF CONTRACT INCLUDING OPTION YEARS</b>	

---

## **ANNEX "C"**

### **INSURANCE REQUIREMENTS**

#### Commercial General Liability Insurance

1. The Contractor must obtain Commercial General Liability Insurance, and maintain it in force throughout the duration of the Contract, in an amount usual for a contract of this nature, but for not less than \$2,000,000 per accident or occurrence and in the annual aggregate.
2. The Commercial General Liability policy must include the following:
  - (a) Additional Insured: Canada is added as an additional insured, but only with respect to liability arising out of the Contractor's performance of the Contract. The interest of Canada should read as follows: Canada, as represented by Public Works and Government Services Canada.
  - (b) Bodily Injury and Property Damage to third parties arising out of the operations of the Contractor.
  - (c) Products and Completed Operations: Coverage for bodily injury or property damage arising out of goods or products manufactured, sold, handled, or distributed by the Contractor and/or arising out of operations that have been completed by the Contractor.
  - (d) Personal Injury: While not limited to, the coverage must include Violation of Privacy, Libel and Slander, False Arrest, Detention or Imprisonment and Defamation of Character.
  - (e) Cross Liability/Separation of Insureds: Without increasing the limit of liability, the policy must protect all insured parties to the full extent of coverage provided. Further, the policy must apply to each Insured in the same manner and to the same extent as if a separate policy had been issued to each.
  - (f) Blanket Contractual Liability: The policy must, on a blanket basis or by specific reference to the Contract, extend to assumed liabilities with respect to contractual provisions.
  - (g) Employees and, if applicable, Volunteers must be included as Additional Insured.
  - (h) Employers' Liability (or confirmation that all employees are covered by Worker's compensation (WSIB) or similar program)
  - (i) Broad Form Property Damage including Completed Operations: Expands the Property Damage coverage to include certain losses that would otherwise be excluded by the standard care, custody or control exclusion found in a standard policy.
  - (j) Notice of Cancellation: The Insurer will endeavor to provide the Contracting Authority thirty (30) days written notice of policy cancellation.
  - (k) If the policy is written on a claims-made basis, coverage must be in place for a period of at least twelve (12) months after the completion or termination of the Contract.
  - (l) Owners' or Contractors' Protective Liability: Covers the damages that the Contractor becomes legally obligated to pay arising out of the operations of a subcontractor.
  - (m) Non-Owned Automobile Liability - Coverage for suits against the Contractor resulting from the use of hired or non-owned vehicles.
  - (n) Sudden and Accidental Pollution Liability (minimum 120 hours): To protect the Contractor for liabilities arising from damages caused by accidental pollution incidents.
  - (o) Litigation Rights: Pursuant to subsection 5(d) of the [Department of Justice Act](#), S.C. 1993, c. J-2, s.1, if a suit is instituted for or against Canada which the Insurer would, but for this clause, have the right to pursue or defend on behalf of Canada as an Additional Named Insured under the insurance policy, the Insurer must promptly contact the Attorney General of Canada to agree on the legal strategies by sending a letter, by registered mail or by courier, with an acknowledgement of receipt.

Solicitation No. - N° de l'invitation  
W0105-16E013  
Client Ref. No. - N° de réf. du client  
W0105-16E013

Amd. No. - N° de la modif.  
File No. - N° du dossier  
pwb-5-38184

Buyer ID - Id de l'acheteur  
PWB 022  
CCC No./N° CCC - FMS No./N° VME

---

For the province of Quebec, send to:

Director Business Law Directorate,  
Quebec Regional Office (Ottawa),  
Department of Justice,  
284 Wellington Street, Room SAT-6042,  
Ottawa, Ontario, K1A 0H8

For other provinces and territories, send to:

Senior General Counsel,  
Civil Litigation Section,  
Department of Justice  
234 Wellington Street, East Tower  
Ottawa, Ontario K1A 0H8

A copy of the letter must be sent to the Contracting Authority. Canada reserves the right to co-defend any action brought against Canada. All expenses incurred by Canada to co-defend such actions will be at Canada's expense. If Canada decides to co-defend any action brought against it, and Canada does not agree to a proposed settlement agreed to by the Contractor's insurer and the plaintiff(s) that would result in the settlement or dismissal of the action against Canada, then Canada will be responsible to the Contractor's insurer for any difference between the proposed settlement amount and the amount finally awarded or paid to the plaintiffs (inclusive of costs and interest) on behalf of Canada.



Solicitation No. - N° de l'invitation  
W0105-16E013  
Client Ref. No. - N° de réf. du client  
W0105-16E013

Amd. No. - N° de la modif.  
File No. - N° du dossier  
pwb-5-38184

Buyer ID - Id de l'acheteur  
PWB 022  
CCC No./N° CCC - FMS No./N° VME

---

**ANNEX "D" Complete List of Each Individual Who is currently on the Board of Directors**

**NOTE TO BIDDERS: WRITE DIRECTORS SURNAMES AND GIVEN NAMES IN BLOCK LETTERS**

Solicitation No. - N° de l'invitation  
W0105-16E013  
Client Ref. No. - N° de réf. du client  
W0105-16E013

Amd. No. - N° de la modif.  
File No. - N° du dossier  
pwb-5-38184

Buyer ID - Id de l'acheteur  
PWB 022  
CCC No./N° CCC - FMS No./N° VME

---

**ANNEX "E"**  
**SPECIFICATION**



**DEPARTMENT OF NATIONAL DEFENCE  
5 ENGINEER SERVICES SQUADRON  
5 ENGINEER SERVICES UNIT  
5 CDSB GAGETOWN**

**SPECIFICATION**

**SERVICE CONTRACT  
SNOW AND ICE CONTROL AND GRASS  
CUTTING/LANDSCAPE MAINTENANCE  
DND FACILITIES, CHARLOTTETOWN AND AREA, PE  
01 MAY 2016 TO 31 MARCH 2017  
WITH AN OPTION TO RENEW  
TWO - ONE YEAR PERIODS**

  
Designed by

  
Fire Inspector

  
Project O

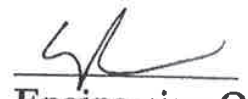
  
Engineering O

PF No:

Job No: L-C135-9301/42

Date: 2015-09-01

<u>Section</u>	<u>Title</u>	<u>Pages</u>
<u>Division 00 - Procurement and Contracting Requirements</u>		
00 21 13	Instructions to Bidders	9
<u>Division 01 - General Requirements</u>		
01 35 30	Health and Safety Requirements	2
01 35 35	DND Fire Safety Requirements	3
01 35 43	Environmental Procedures	1
<u>Annexes</u>		
Annex A	Queen Charlotte Armoury SNIC Site Plan	1
Annex B	Alexandra Rifle Range SNIC Site Plan	1
Annex C	Brighton Compound SNIC Site Plan	1
Annex D	Support Detachment SNIC Site Plan	1
Annex E	HMCS Queen Charlotte SNIC Site Plan	1
Annex F	Queen Charlotte Armoury Grass Site Plan	1
Annex G	Alexandra Range Grass Site Plan	1
Annex H	Brighton Compound Grass Site Plan	1
Annex J	Support Detachment Grass Site Plan	1
Annex K	HMCS Queen Charlotte Grass Site Plan	1

**END OF SECTION**

## **1 GENERAL**

### **1.01 DESCRIPTION OF WORK**

- .1 The work covered under this Service Contract comprises the furnishing of all labour, materials, tools and equipment required to provide Snow and Ice Control (SNIC) and Grass Cutting/Landscape Maintenance at the Queen Charlotte Armoury, Alexandra Range, Brighton Compound, Support Detachment and HMCS Queen Charlotte Naval Reserve when requested and as specified herein.
- .2 Queen Charlotte Armoury is located at 3 Haviland Street, Charlottetown, PE.
- .3 Alexandra Rifle Range is located at Alexandra Road, Alexandra, PE.
- .4 Brighton Compound is located at 129 Brighton Road, Charlottetown, PE.
- .5 Support Detachment is located at 88 Watts Avenue, West Royalty Industrial Park, Charlottetown, PE.
- .6 HMCS Queen Charlotte is located at 210 Water Street Parkway, Charlottetown, PE.

### **1.02 DURATION OF CONTRACT**

- .1 This Service Contract will extend from 01 May 2016 to 31 March 2017, with two one-year option periods.

### **1.03 REFERENCES**

- .1 Canada Labour Code Part II.
- .2 Province of Prince Edward Island Occupational Health and Safety Act, R.S.P.E.I 1988.
- .3 The Canadian Electrical Code, CSA C22.1-12.

### **1.04 QUALIFICATIONS**

- .1 The Contractor will be an established Groundskeeping Service Company with a minimum of three (3) years experience in Commercial Snow and Ice Control and Grass Cutting/Landscape Maintenance. Proof of such must be provided to PWGSC prior to award of this Service Contract.
- .2 All snow and ice control equipment operators must be trained in the proper operation of the Contractors snow and ice control machinery and equipment.
- .3 All grass cutting equipment and trimmer operators must be trained in the proper operation of the Contractors grass cutting machinery and equipment.
- .4 All employees must be trained in proper fueling methods, spill control and mandatory use of personal protective equipment.

#### 1.05 ENGINEER

- .1 The Engineer as defined and stated in this specification will be the Commanding Officer 5 Engineer Services Unit or a designated representative. The address of the Engineer is:
  - Contracts Office
  - 5 Engineer Services Unit
  - Building B18
  - 5 CDSB Gagetown
  - PO Box 17000 Station
  - Oromocto, NB E2V 4J5
  - Tel (506) 422-2677
  - Fax (506) 422-1248

#### 1.06 DOCUMENTS REQUIRED

- .1 Maintain at the job site one copy each of the following:
  - .1 Specifications; and
  - .2 Addenda.

#### 1.07 CONTRACTOR'S USE OF SITE

- .1 Work site access will be as directed by the Engineer.
- .2 Movement around the site is subject to restrictions laid down by the Engineer.
- .3 Do not unreasonably encumber the site with materials or equipment.
- .4 On-site storage of snow and ice control and grass cutting equipment will be at the discretion of and determined by the Engineer.

#### 1.08 POWER AND WATER

- .1 DND can provide, free of charge, temporary electric power and water for the purposes of this agreement.
- .2 Engineer will determine delivery points and quantitative limits. Engineer's written permission is required before any connection is made. Connect to existing power supply in accordance with Canadian Electrical Code, CSA C22.1-12.
- .3 Supply of temporary services by DND is subject to DND requirements and may be discontinued by Engineer at any time without notice or acceptance of any liability for damage or delay caused by such withdrawal of temporary services.

#### 1.09 CODES AND STANDARDS

- .1 Perform work to and enforce safety measures in accordance with the Canadian Labour Code Part II and the Province of Prince Edward Island Occupational Health and Safety Act.
- .2 Contractor must be registered with Workers Compensation Board of Prince Edward Island. Proof of such must be provided to PWGSC prior to award of this Service Contract.

- .3 Comply with the requirements of Workplace Hazardous Materials Information System (WHMIS) regarding use, handling, storage and disposal of hazardous materials; and labelling and provision of Material Safety Data Sheets acceptable to Human Resources and Skills Development Canada and Health Canada.
- .4 The Contractor will take all necessary precautions to protect and prevent damage to all vehicles, trees, structures, surrounding property and installations. Damage to property and installations caused by the Contractor will be repaired without delay to the satisfaction of the Engineer. Damage to any vehicles will be the Contractors responsibility.
- .5 Work to meet or exceed requirements of specified standards, codes and referenced documents. In event of conflict between any provisions of above authorities, the most stringent provision will apply.

#### **1.10 TEMPORARY STRUCTURES**

- .1 The Contractor will furnish and maintain all equipment such as temporary ramps, ladders, scaffolds, hoists, chutes, etc, as may be required for the proper execution of the work.
- .2 Temporary structures erected by the Contractor will remain their property and will be removed by them from the site on completion of the work.

#### **1.11 CLEAN UP**

- .1 On completion of all work, the Contractor will remove all surplus equipment and debris. The site must be left in a clean and tidy condition which meets the satisfaction of the Engineer. The Contractor will not remove any salvageable material or equipment from the job site without permission from the Engineer.

#### **1.12 SCOPE OF WORK**

- .1 The Snow and Ice Control (SNIC) Service will include, as a minimum:
  - .1 clear all snow from, and apply an ice control mixture to all roadways, parking areas, vehicle compounds, fire hydrants, doorways and walkways within the gray shaded boundary area as shown on Annex A,B,C,D, and E after each snow or ice event or as required from the month of November to the month of March;
  - .2 clear all snow from, and apply an ice control mixture to all roadways, parking areas, vehicle compounds, fire hydrants, doorways and walkways within the gray shaded boundary area as shown on Annex A,B,C,D, and E as and when requested by the Engineer for the months of October and April; and
  - .3 removal of snow from DND property and dispose of at a Provincially approved site as and when requested by the Engineer.
- .2 Ice control mixture is to consist of a mixture of one 9.7 kg bag of calcium chloride and one 9.7 kg bag of sodium chloride to .75 cubic metres of sand at a rate of 60 to 120 mL per m<sup>2</sup>.
- .3 The Contractor will be responsible to maintain all areas shown in Annex A,B,C,D and E passable and safe for vehicular and pedestrian traffic at all times from the months of November to March on a (7) seven day per week

basis, Sunday to Saturday inclusive.

- .4 The Contractor will install snow stakes at locations of obstructions within the service area that may interfere with the Snow and Ice Control process or may be damaged by equipment.
  - .1 Snow stakes must be installed before the ground freezes and well in advance of the first anticipated snowfall.
  - .2 Snow stakes may be made from wood or metal and must be long enough to extend above the anticipated depth of snow in the area. The top 150mm of the stake should be painted, flagged, taped, or have an appropriate coloured delineator in place, to provide better visibility.
  - .3 All solid objects within the service area that are likely to be covered with snow, will be identified by snow stakes. These include, but are not limited to: hydrants, gutters, isolated curb sections, catch basins, drop inlets and other drainage structures.
  - .4 The Contractor will monitor the snow stakes throughout the season and replace them as and when required. Snow stakes will be removed at the end of the snow season.
- .5 The Contractor will be responsible to repair all damage to structures, surrounding property and installations caused by their snow clearing equipment at the end of the snow clearing season. This will also include removing all sand, stones and debris from grassed areas and repairing any damage to sod.
- .6 The Contractor will be responsible to remove all accumulated sand, stones and debris from all roadways, parking areas, vehicle compounds, fire hydrants, doorways and walkways and the end of the snow clearing season.
- .7 The Grass Cutting Service will include, as a minimum:
  - .1 mowing to 75mm;
  - .2 trimming to 75mm;
  - .3 removal of clippings from sidewalks and paved areas; and
  - .4 clean up of all areas shown within the gray shaded boundary area as shown on Annex F,G,H,J and K.
- .8 The Contractor will be responsible to:
  - .1 cut grass, at bi-weekly intervals between mid-May and the end of September, within the gray shaded boundary area as shown on Annex F,G,H,J and K; and
  - .2 trim grass and weeds, at bi-weekly intervals between mid-May and the end of September, growing in or around the base off all buildings, fences (both sides), hydrants, poles, car heater posts, signs, flower beds, hedges, trees, and any physical obstruction within the gray shaded boundary area as shown on Annex F,G,H,J and K.
- .9 Trimming and Grass Cutting is to be completed within 4 hours of each other.
- .10 Remove and dispose of, in the dumpster located on site, any debris on the grass before cutting or trimming.
- .11 The Contractor is to ensure that grass clippings are not directed onto roadways, sidewalks, and plant beds.
- .12 Ditch bottoms and slopes are included in the Service Contract and must be cut to 75mm.



- .13 The Snow and Ice Control (SNIC) and Grass Cutting/Landscape Maintenance Service will be performed to the complete satisfaction of the Engineer.

### 1.13 EQUIPMENT

- .1 The Contractor must have sufficient personnel and equipment to be able to perform Snow and Ice Control Service and Restore Traction on all areas shown in Annex A, B, C, D, and E within 3 hours after a snow or ice event or as required.
- .2 Contractors will present with their Tender, a list of all equipment that they propose to use for the Snow and Ice Control Service. The equipment list is to include the manufacturer's name, model, and capacity.
- .1 Minimum equipment requirements for Snow and Ice Control Services are:
- .1 926M Cat Loader or equivalent with a rated net power 148.0 hp, equipped with a bucket (minimum size 1.9 m<sup>3</sup>) and snow blower attachment (minimum width 152 cm);
- .2 tandem dump truck with an 8 m<sup>3</sup> box;
- .3 3/4 ton four-wheel drive truck equipped with hydraulically-operated snow plow and a sander attachment capable of spreading the ice control mixture specified in para 1.12.2; and
- .4 ten HP or larger walk behind snowblower.
- .3 The Contractor must have sufficient personnel and equipment to be able to perform Grass Cutting Service on all areas shown in Annex F, G, H, J and K within one (1) calendar day.
- .4 Contractors will present with their Tender, a list of all equipment that they propose to use for the Grass Cutting Service. The equipment list is to include the manufacturer's name, model, and capacity.
- .5 Mowers will be calibrated and capable of being adjusted on site to give mowing heights required by these specifications. All guards and protective devices on all equipment shall be properly maintained and utilized according to manufacturer's design at all times. Mowers that cause scalping or turf damage will not be used.
- .6 Prior to award of this Service Contract, the Contractor will make arrangements with the Engineer for inspection of their equipment. If the equipment does not meet the approval of the Engineer the Contractor will replace the equipment to the satisfaction of the Engineer before award of this Service Contract.
- .7 Vehicles and operators used for this Service Contract will be licensed in accordance with regulations of the Province of Prince Edward Island. Proof of such must be provided to PWGSC prior to award of this Service Contract.
- .8 Vehicles used for this Service Contract will be inspected in accordance with regulations of the Province of Prince Edward Island.
- .9 Vehicles used for this Service Contract will carry Public Liability and Property Damage Insurance (PL&PD) to a minimum value of Two Million Dollars (\$2,000,000). Proof of such must be provided to PWGSC prior to award of this Service Contract.
- .10 Vehicles used for this Service Contract will be equipped with lights, horn, signal lights, rear view mirrors, clearly audible back-up alarm and roof

mounted 360 degree rotating beacon.

- .11 All equipment will be maintained in first class condition at all times throughout this Service Contract. The equipment will be inspected frequently and must be maintained to the satisfaction of the Engineer.

#### 1.14 QUANTITIES AND BASIS OF PAYMENT

- .1 The work performed under this Service Contract will be paid for on a unit price and hourly rate basis. The Contractor will accept the payment as full consideration for everything furnished and done by them in respect of the work.
- .2 The Contractor will submit unit prices and an hourly rate for the following in accordance with the specifications. Such prices will include labour, supervision, expenses, tools, equipment, transportation (travel time to and from the contractors base of operation will be included in the rates provided) and profit.
- .1 Price per month for Snow and Ice Control Services on all roadways, parking areas, vehicle compounds, fire hydrants, doorways and walkways including application of ice control mixture, after each snow or ice event or as required at Queen Charlotte Armoury as shown in Annex A for the months of November to March. **Guaranteed Quantities: (Five Months)**
- .2 Price per month for Snow and Ice Control Services on all roadways, parking areas, vehicle compounds, fire hydrants, doorways and walkways including application of ice control mixture, after each snow or ice event or as required at Alexandra Range as shown in Annex B for the months of November to March. **Guaranteed Quantities: (Five Months)**
- .3 Price per month for Snow and Ice Control Services on all roadways, parking areas, vehicle compounds, fire hydrants, doorways and walkways including application of ice control mixture, after each snow or ice event or as required at Brighton Compound as shown in Annex C for the months of November to March. **Guaranteed Quantities: (Five Months)**
- .4 Price per month for Snow and Ice Control Services on all roadways, parking areas, vehicle compounds, fire hydrants, doorways and walkways including application of ice control mixture, after each snow or ice event or as required at Support Detachment as shown in Annex D for the months of November to March. **Guaranteed Quantities: (Five Months)**
- .5 Price per month for Snow and Ice Control Services on all roadways, parking areas, vehicle compounds, fire hydrants, doorways and walkways including application of ice control mixture, after each snow or ice event or as required at HMCS Queen Charlotte as shown in Annex E for the months of November to March. **Guaranteed Quantities: (Five Months)**
- .6 Price per occurrence for Snow and Ice Control Services on all roadways, parking areas, vehicle compounds, fire hydrants, doorways and walkways including application of ice control mixture, as and when requested by the Engineer at Queen Charlotte Armoury as shown in Annex A during the months of October and April. **Estimated Quantities: (Five)**
- .7 Price per occurrence for Snow and Ice Control Services on all roadways, parking areas, vehicle compounds, fire hydrants, doorways and walkways including application of ice control mixture, as and when

- requested by the Engineer at Alexandra Range as shown in Annex B during the months of October and April. **Estimated Quantities: (Five)**
- .8 Price per occurrence for Snow and Ice Control Services on all roadways, parking areas, vehicle compounds, fire hydrants, doorways and walkways including application of ice control mixture, as and when requested by the Engineer at Brighton Compound as shown in Annex C during the months of October and April. **Estimated Quantities: (Five)**
- .9 Price per occurrence for Snow and Ice Control Services on all roadways, parking areas, vehicle compounds, fire hydrants, doorways and walkways including application of ice control mixture, as and when requested by the Engineer at Support Detachment as shown in Annex D during the months of October and April. **Estimated Quantities: (Five)**
- .10 Price per occurrence for Snow and Ice Control Services on all roadways, parking areas, vehicle compounds, fire hydrants, doorways and walkways including application of ice control mixture, as and when requested by the Engineer at HMCS Queen Charlotte as shown in Annex E during the months of October and April. **Estimated Quantities: (Five)**
- .11 Price per hour for a loader to remove snow from DND Property and dispose of at a Provincially approved site as and when requested by the Engineer. **Estimated Quantities: (500 hours)**
- .12 Price per hour for a tandem dump truck to remove snow from DND Property and dispose of at a Provincially approved site as and when requested by the Engineer. **Estimated Quantities: (500 hours)**
- .13 Price per month for Grass Cutting Services on all areas at Queen Charlotte Armoury as shown in Annex F for the months of mid-May to end September. **Guaranteed Quantities: (Five Months)**
- .14 Price per month for Grass Cutting Services on all areas at Alexandra Range as shown in Annex G for the months of mid-May to end September. **Guaranteed Quantities: (Five Months)**
- .15 Price per month for Grass Cutting Services on all areas at Brighton Compound as shown in Annex H for the months of mid-May to end September. **Guaranteed Quantities: (Five Months)**
- .16 Price per month for Grass Cutting Services on all areas at Support Detachment as shown in Annex J for the months of mid-May to end September. **Guaranteed Quantities: (Five Months)**
- .17 Price per month for Grass Cutting Services on all areas at HMCS Queen Charlotte as shown in Annex K for the months of mid-May to end September. **Guaranteed Quantities: (Five Months)**
- .18 Unit price for Grass Cutting Services at Queen Charlotte Armoury as shown in Annex F as and when requested by the Engineer. **Estimated Quantity: (Five)**
- .19 Unit price for Grass Cutting Services at Alexandra Range as shown in Annex G as and when requested by the Engineer. **Estimated Quantity: (Five)**
- .20 Unit price for Grass Cutting Services at Brighton Compound as shown in Annex H as and when requested by the Engineer. **Estimated Quantity: (Five)**
- .21 Unit price for Grass Cutting Services at Support Detachment as shown in Annex J as and when requested by the Engineer. **Estimated Quantity: (Five)**
- .22 Unit price for Grass Cutting Services at HMCS Queen Charlotte as shown in Annex K as and when requested by the Engineer. **Estimated Quantity: (Five)**
- .23 Hourly rate for Landscape Maintenance Services as and when requested by the Engineer. **Estimated Quantity: (40 Hours)**
- .24 Hourly rate for a two (2) meter Rotary Field Mower with operator as

and when requested by the Engineer. **Estimated Quantity: (40 Hours)**

- .3 All material will be invoiced at the Contractor's wholesale cost, plus a percentage of mark-up. Contractor shall submit all invoices for materials as supporting documentation when submitting invoices for work completed. For tendering purposes, the Contractor will submit their percent of mark-up on material. **Estimated Quantity: Ten Thousand Dollars (\$10,000.00)**
- .4 The quantities described above may increase or decrease and are used only as a guide for tendering. The quantities are not guaranteed and the Contractor will have no claim for loss of anticipated profits as a result of these estimated quantities.
- .5 Time charged and contract prices may be verified by Government Audit before or after payment is made under the terms of this Service Contract.
- .6 For Snow and Ice Control Services the Contractor will provide service as required on a seven (7) day per week basis Sunday to Saturday inclusive.
- .7 For Grass Cutting Services the Contractor will provide service during normal working hours on an eight (8) hour per day, five (5) days per week basis 0730hrs to 1600hrs Monday to Friday inclusive.
- .8 The Contractor will advise the Engineer of the telephone number or location at which they or their representative may be contacted at all times.
- .9 The Contractor, upon receipt of an Acceptance of Tender, will be advised by the Engineer in writing of the names of persons authorized to request service. Work undertaken at the request of others, such as building occupants, will be entirely at the Contractor's risk with regard to payment.
- .10 The Contractor will not refuse any call for service by the Engineer and will initiate the work within 24 hours. When extra service is required, the authorized person will notify the Contractor and detail the job to be performed.
- .11 The Contractor will report to the Engineer or authorized person prior to starting work and upon completion of work on a daily basis to sign in and out.
- .12 The Contractor will submit one invoice monthly covering all charges. The invoice will identify the type of service provided, location and the hourly rate. In addition, the invoice shall reference the Contract, work order and requisition numbers. Any invoices for extra work must itemize technicians' names, dates and hours worked.

#### 1.15 SECURITY CLEARANCE

- .1 The Contractor shall maintain an up-to-date roster of all employees involved in this contract including managers, supervisors, operators and labourers. This roster must be made available to the Engineer upon request.
- .2 The Contractor shall provide proof of the information contained within the roster to the Engineer upon request. The Engineer reserves the right to have removed from the site those personnel who do not meet security requirements as laid down by the Military Police Section.

NATIONAL DEFENCE  
JOB NO.L-C135-9301/42  
5 CDSB GAGETOWN, N.B.

INSTRUCTIONS TO BIDDERS

SECTION 00 21 13  
PAGE 9  
2015-09-01

- .3 Security procedures require, that when requested by the Engineer, the Contractor will provide to the Engineer at no cost to DND, a copy of a Canadian Police Certificate for Employment for each employee who will work on this Service Contract.

END OF SECTION

## 1 GENERAL

### 1.01 REFERENCES

- .1 Canada Labour Code, Part II, Canada Occupational Safety and Health Regulations.
- .2 Province of Prince Edward Island Occupational Health and Safety Act, R.S.P.E.I 1988.
- .3 National Building Code of Canada, 2010.

### 1.02 REGULATORY REQUIREMENTS

- .1 Do work in accordance with the safety measures of the National Building Code of Canada 2010, the Canada Labour Code Part II, the Prince Edward Island Occupational Health and Safety Act and Workers Compensation Board of Prince Edward Island provided that in any case of conflict or discrepancy the more stringent requirements shall apply.

### 1.03 RESPONSIBILITY

- .1 Contractor is responsible for the health and safety of all persons on site. Contractor is also responsible for the protection of property, persons and the environment on or adjacent to the site in so far as the work may affect these.
- .2 Contractor and all contractor's employees are to comply with all safety requirements specified in the Contract Documents as well as all applicable federal, provincial and local statutes, regulations, ordinances and with Contractor's site-specific Health and Safety Plan.
- .3 As outlined in the Canada Labour Code Part II, the Contractor is responsible to provide a site-specific Health and Safety Plan that includes a Confined Space Entry Procedure in the event that work is deemed by the Engineer to be in a confined space. Work is not to begin until this Health and Safety Plan is submitted and approved by the Engineer.
- .4 5 CDSB Gagetown 5 Engineer Services Unit employs a Lock Out/Tag Out program to prevent work related injuries due to electrical or mechanical systems being energized while personnel are working in or around these systems. The Contractor must respect these locks and tags when encountered. Do not forcibly remove these locks and/or tags at any time. If the Contractor requires that these be removed to perform work, a request is to be made to the Engineer for such removal.
- .5 As per the Canada Labour Code Part II, it is the Contractor's responsibility to employ their own Lock Out/Tag Out program to ensure that equipment is not energized by other personnel while they are working in or around equipment.
- .6 It is the Contractor's responsibility to ensure that all their employees are provided all Personal Protective Equipment (PPE) necessary to perform all work. Hard hats and safety glasses are to be worn at all times.

#### 1.04 UNFORESEEN HAZARDS

- .1 Should any unforeseen or peculiar safety-related factor, hazard, or condition become evident during performance of work, the Contractor must have procedures in place to facilitate the Employee's Right to Refuse Work in accordance with Acts and Regulations of New Brunswick. The Contractor is to advise the Engineer verbally and in writing of any employee who exercises this right.

#### 1.05 CORRECTION OF NON-COMPLIANCE

- .1 Immediately address health and safety non-compliance issues identified by authority having jurisdiction or by Engineer.
- .2 Provide Engineer with written report of action taken to correct non-compliance of health and safety issues identified.
- .3 Engineer may stop work if non-compliance of health and safety regulations is not corrected.

#### 1.06 WORK STOPPAGE

- .1 Give precedence to safety and health of public and site personnel and protection of environment over cost and schedule considerations for work.

END OF SECTION



## **1 GENERAL**

### **1.01 REPORTING FIRES**

- .1 Know location of nearest fire alarm box and telephone, including emergency phone number.
- .2 Report immediately all fire incidents to Fire Department as follows:
  - .1 telephone 911.
- .3 When reporting fire by telephone, give location of fire, name or number of building and be prepared to verify the location.

### **1.02 INTERIOR AND EXTERIOR FIRE PROTECTION AND ALARM SYSTEMS**

- .1 Fire protection and alarm system will not be:
  - .1 obstructed;
  - .2 shut-off; and
  - .3 left inactive at end of working day or shift without authorization from Fire Chief.
- .2 Fire hydrants, standpipes and hose systems will not be used for other than fire-fighting purposes unless authorized by Fire Chief.

### **1.03 FIRE EXTINGUISHERS**

- .1 Supply fire extinguishers, as scaled by Fire Chief, necessary to protect work in progress and contractor's physical plant on site.

### **1.04 BLOCKAGE OF ROADWAYS**

- .1 Advise Fire Chief of any work that would impede fire apparatus response. This includes violation of minimum overhead clearance, as prescribed by Fire Chief, erecting of barricades and digging of trenches.

### **1.05 SMOKING PRECAUTIONS**

- .1 Observe smoking regulations at all times.

### **1.06 RUBBISH AND WASTE MATERIALS**

- .1 Rubbish and waste materials are to be kept to a minimum.
- .2 Burning of rubbish is prohibited.
- .3 Removal:
  - .1 Remove all rubbish from work site at end of work day or shift or as directed.
- .4 Storage:
  - .1 Store oily waste in approved receptacles to ensure maximum cleanliness and safety.
  - .2 Deposit greasy or oily rags and materials subject to spontaneous combustion in approved receptacles and remove.



#### 1.07 FLAMMABLE AND COMBUSTIBLE LIQUIDS

- .1 Handling, storage and use of flammable and combustible liquids are to be governed by the current National Fire Code of Canada.
- .2 Flammable and combustible liquids such as gasoline, kerosene and naphtha will be kept for ready use in quantities not exceeding 45 litres provided they are stored in approved safety cans bearing Underwriters' Laboratory of Canada or Factory Mutual seal of approval. Storage of quantities of flammable and combustible liquids exceeding 45 litres for work purposes requires permission of Fire Chief.
- .3 Transfer of flammable and combustible liquids is prohibited within buildings or jetties.
- .4 Transfer of flammable and combustible liquids will not be carried out in vicinity of open flames or any type of heat-producing devices.
- .5 Flammable liquids having a flash point below 38° C such as naphtha or gasoline will not be used as solvents or cleaning agents.
- .6 Flammable and combustible waste liquids, for disposal, will be stored in approved containers located in a safe ventilated area. Quantities are to be kept to a minimum and Fire Department is to be notified when disposal is required.

#### 1.08 HAZARDOUS SUBSTANCES

- .1 Work entailing use of toxic or hazardous materials, chemicals and/or explosives, or otherwise creating hazard to life, safety or health, will be in accordance with National Fire Code of Canada.
- .2 Obtain from Fire Chief a "Hot Work" permit for work involving welding, burning or use of blow torches and salamanders in buildings or facilities.
- .3 When Work is carried out in dangerous or hazardous areas involving use of heat, provide fire watchers equipped with sufficient fire extinguishers. Determination of dangerous or hazardous areas along with level of protection necessary for Fire Watch is at discretion of the Fire Chief. Contractors are responsible for providing fire watch service for work on a scale established and in conjunction with Fire Chief at pre-work conference.
- .4 Where flammable liquids, such as lacquers or urethanes are to be used, proper ventilation will be assured and all sources of ignition are to be eliminated. Fire Chief is to be informed prior to and at cessation of such work.

#### 1.09 QUESTIONS AND/OR CLARIFICATION

- .1 Direct any questions or clarification on Fire Safety in addition to above requirements to Fire Chief through the Engineer.

#### 1.10 FIRE INSPECTION

- .1 Site inspections by Fire Chief will be coordinated through Engineer.
- .2 Allow Fire Chief unrestricted access to work site.

NATIONAL DEFENCE  
JOB NO.L-C135-9301/42  
5 CDSB GAGETOWN, N.B.

DND FIRE SAFETY REQUIREMENTS SECTION 01 35 35  
PAGE 3  
2015-09-01

- .3 Co-operate with Fire Chief during routine fire safety inspection of work site.
- .4 Immediately remedy all unsafe fire situations observed by Fire Chief.

END OF SECTION

## **1 GENERAL**

### **1.01 GENERAL**

- .1 Contractor will take all reasonable steps to ensure that they and their employees have complied with all pertinent legislation and have protected the environment.

### **1.02 FIRES**

- .1 Fires and burning of rubbish on site not permitted.

### **1.03 DISPOSAL OF WASTES**

- .1 Do not bury rubbish and waste materials on site unless approved by Engineer.
- .2 Do not dispose of waste or volatile materials, such as mineral spirits, oil or paint thinner into waterways, storm or sanitary sewers.

### **1.04 SPILL PROTECTION**

- .1 The Contractor must have adequate clean up materials for any potential hazardous materials used in the completion of the work (ie. Foams, fuels, oils, lubricants, etc).

**END OF SECTION**



Government  
of Canada

Gouvernement  
du Canada

# ANNEX A

## LEGEND / LÉGENDE

- AREA OF SNOW & ICE CONTROL  
BOUNDARY LINE / LIMITE LIGNE DE  
CONTRÔLE DE NEIGE ET DE GLACE
- PROPERTY LINE / LIMITE DE PROPRIÉTÉ

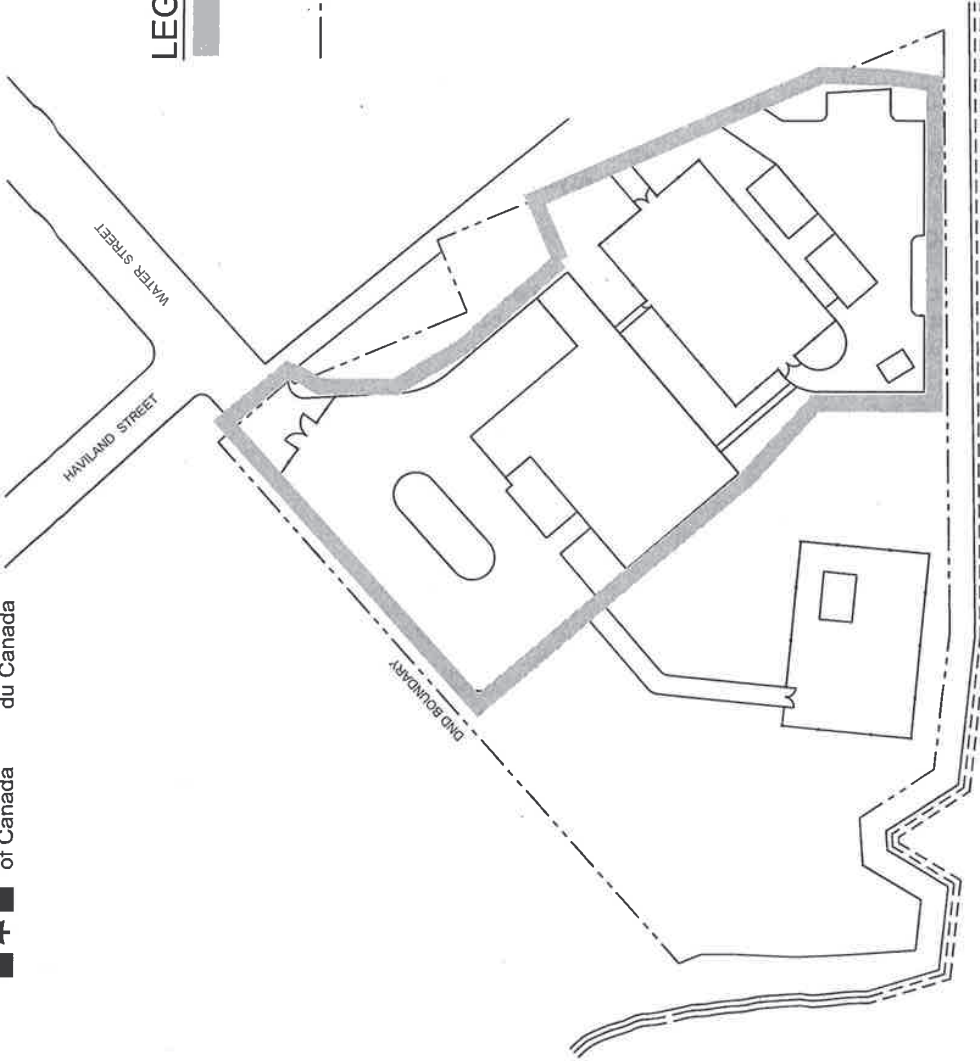

PROJECT: SNOW & ICE CONTROL/LANDSCAPE MAINTENANCE  
PROJET: DÉNEIGEMENT ET DE DÉGLAÇAGE / ENTRETIEN PAYSAGER  
SUBJECT: CHARLOTTETOWN, PEI & AREA (ET RÉGION)  
SUJET: QUEEN CHARLOTTE ARMOURY  
SITE PLAN / PLAN D'EMPLACEMENT

DATE: 2015/09/01

APPROVED:  
APPROUVÉ  
PAR:

SCALE:  
ÉCHELLE: NTS Pas d'échelle

WBS NO.:

NO. OTP:

PF NO.:

NO. DP:

DWG NO.:  
NO. DESSIN:

SC

L-C135-9301/42

# ANNEX B

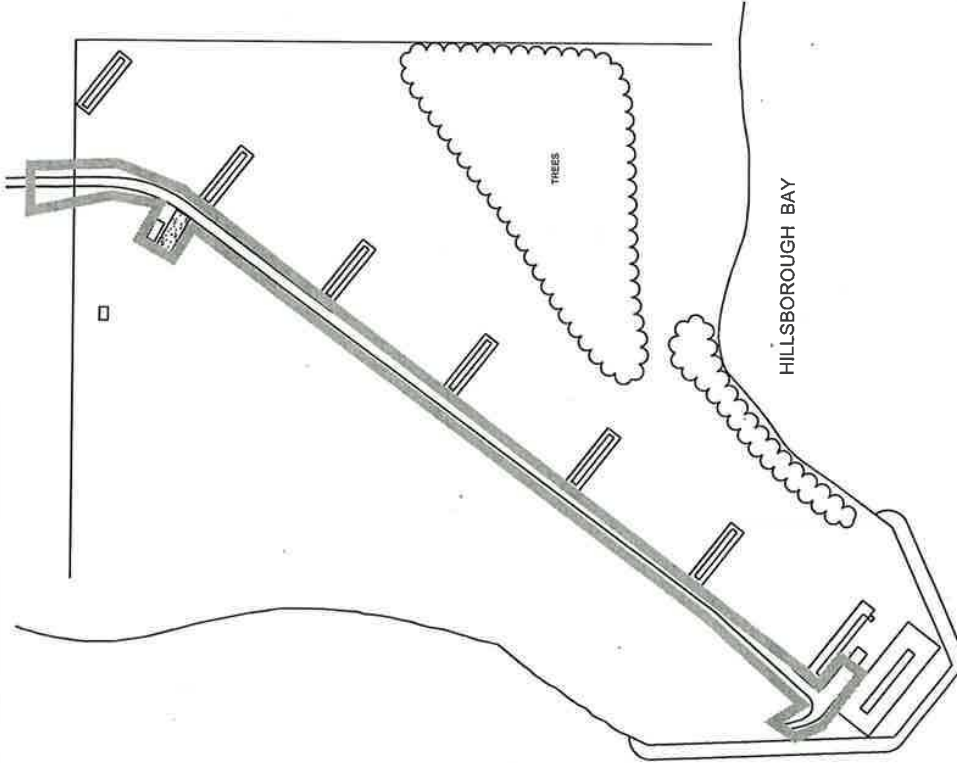

## LEGEND / LÉGENDE

AREA OF SNOW & ICE CONTROL  
BOUNDARY LINE / LIMITE LIGNE DE  
CONTRÔLE DE NEIGE ET DE GLACE

## NOTE:

-AREA OF SNOW & ICE CONTROL STARTS AT POWNAL ROAD AND CONTINUES ALONG ALEXANDRA ROAD TO INCLUDE ALEXANDRA RIFLE RANGE  
-LA LIMITE LIGNE DE CONTRÔLE DE NEIGE ET DE GLACE À LA RUE POWNAL ET CONTINUE LE LONG LA RUE ALEXANDRA D'INCLURE STAND TIR ALEXANDRA

PROJECT: SNOW & ICE CONTROL/LANDSCAPE MAINTENANCE  
PROJET: DÉNEIGEMENT ET DE DÉGLAÇAGE /ENTRETIEN PAYSAGER  
SUBJECT: CHARLOTTETOWN, PEI & AREA ( ET RÉGION )  
SUIJET: ALEXANDRA RIFLE RANGE  
SITE PLAN / PLAN D'EMPLACEMENT

DATE: 2015/09/01

APPROVED:  
APPROUVÉ  
PAR:

SCALE: NTS  
ÉCHELLE: Pas d'échelle

WBS NO.:

NO. OTP:

PF NO.:

NO. DP:

DWG NO.:

NO. DESSIN:

SC

2

of 10

L-C135-9301/42

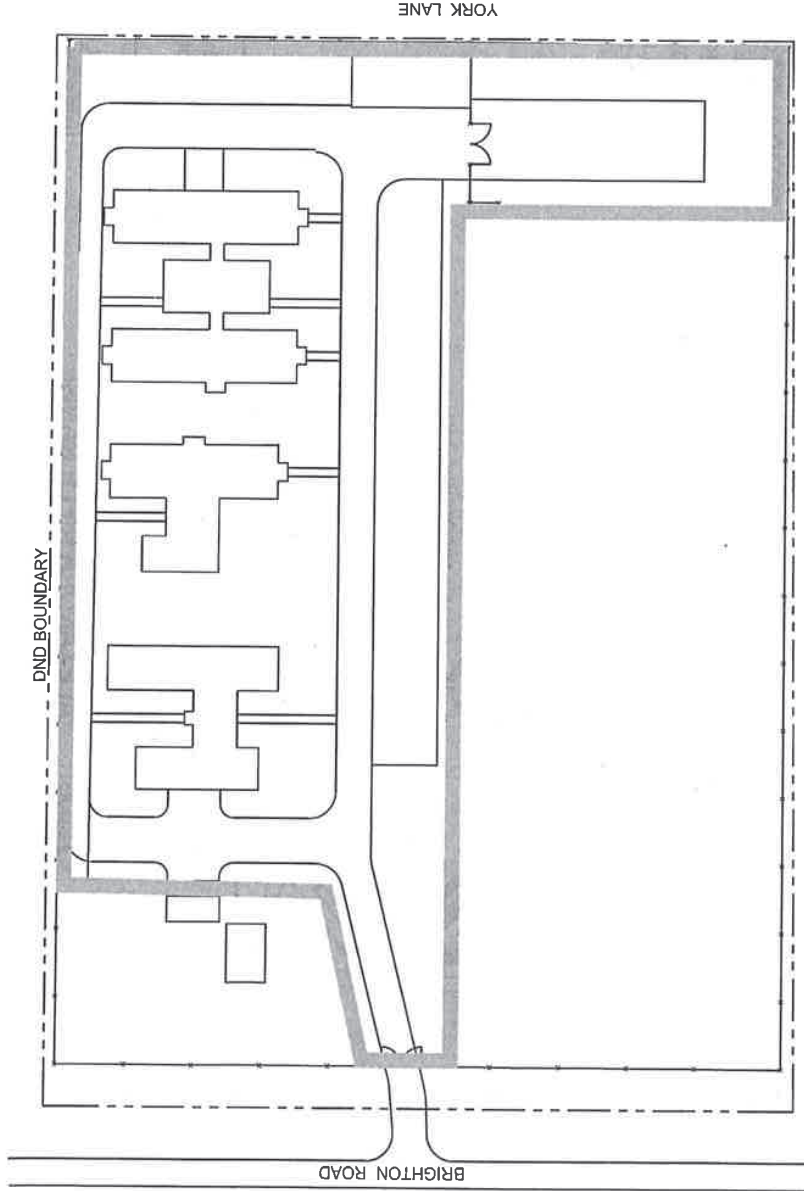

**LEGEND**

AREA OF SNOW & ICE  
CONTROL BOUNDARY LINE

PROPERTY LINE

**Légende**

Limite ligne de contrôle  
de neige et de glace

Limite de propriété

PROJECT: SNOW & ICE CONTROL/LANDSCAPE MAINTENANCE  
PROJET: DÉNEIGEMENT ET DE DÉGLAÇAGE /ENTRETIEN PAYSAGER  
SUBJECT: CHARLOTTETOWN, PEI & AREA ( ET RÉGION )  
SUJET: BRIGHTON COMPOUND /  
COMPOSÉ BRIGHTON  
SITE PLAN / PLAN D'EMPLACEMENT

DATE: 2015/09/01

APPROVED:  
APPROUVÉ  
PAR:

SCALE: NTS Pas d'échelle  
ÉCHELLE:

WBS NO.:

NO. OTP:

PF NO.:

NO. DP:

DWG NO. NO. DESSIN:

SC

L-C-135-9301/42

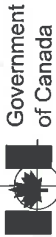

Government  
of Canada

Gouvernement  
du Canada

# ANNEX D

BORDER LAST UPDATED 2011/11-11

FIRST AVENUE

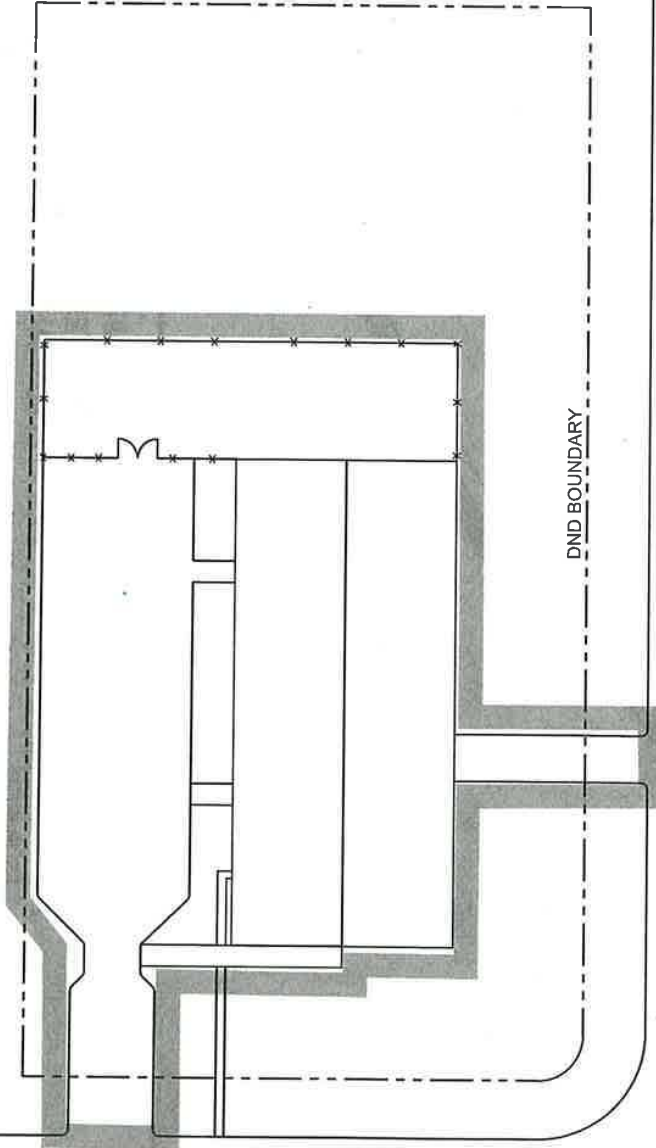

DND BOUNDARY

THIRD STREET

## LEGEND

AREA OF SNOW &  
ICE CONTROL  
BOUNDARY LINE

PROPERTY LINE

## Légende

Limite ligne de  
contrôle de neige  
et de glace

Limite de propriété

APPROVED:  
APPROUVÉ  
PAR:

SCALE:  
ÉCHELLE:

NTS

Pas d'échelle

WBS NO.:

NO. OTP:

PF NO.:

NO. DP:

DWG NO.:

NO. DESSIN:

PROJECT: SNOW & ICE CONTROL/LANDSCAPE MAINTENANCE  
PROJET: DÉNEIGEMENT ET DE DÉGLAÇAGE /ENTRETIEN PAYSAGER

SUBJECT: CHARLOTTETOWN, PEI & AREA ( ET RÉGION )

SUJET: WEST ROYALTY SUPPORT DETACHMENT HQ

WEST ROYALTY QUARTIER GÉNÉRAL DU

DÉTACHEMENT DE SOUTIEN

SITE PLAN / PLAN D'EMPLACEMENT

DATE: 2015/09/01

SC

4

of 5

L-C-135-9301/42





Government  
of Canada

Gouvernement  
du Canada

# ANNEX E

## LEGEND

AREA OF SNOW & ICE CONTROL  
BOUNDARY LINE

## Légende

Limite ligne de contrôle de  
neige et de glace

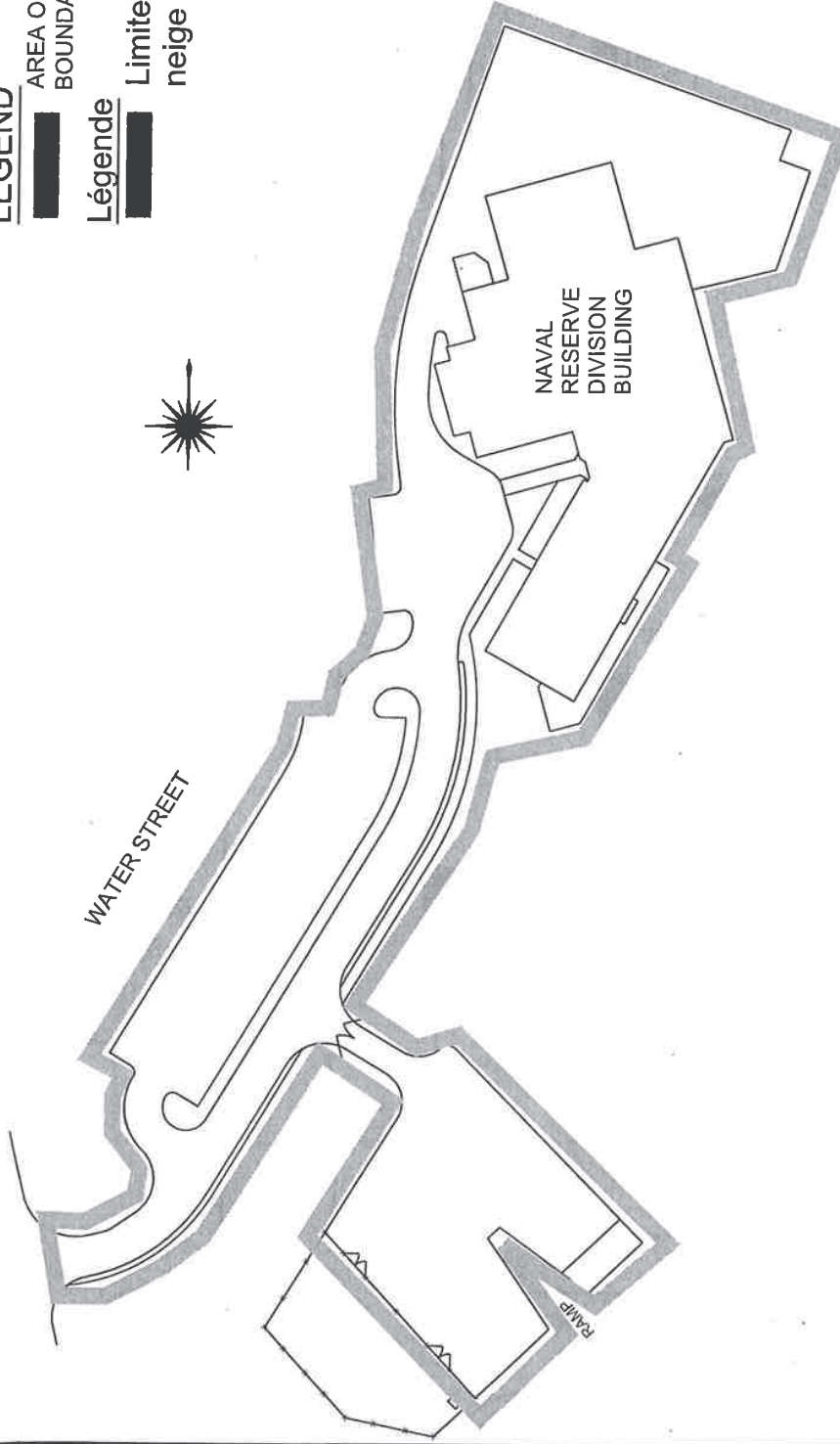

PROJECT: SNOW & ICE CONTROL/LANDSCAPE MAINTENANCE  
PROJET: DÉNEIGEMENT ET DE DÉGLAÇAGE /ENTRETIEN PAYSAGER  
SUBJECT: CHARLOTTETOWN, PEI & AREA ( ET RÉGION )  
SUIJET: HMCS QUEEN CHARLOTTE  
SITE PLAN/PLAN D'EPLACEMENT

DATE: 2015/09/01

APPROVED:  
APPROUVÉ  
PAR:

SCALE:  
ÉCHELLE: NTS

WBS NO.:

NO. OTP:

PF NO.:

NO. DP:

DWG NO.:

NO. DESSIN:

SC

L-C135-9301/42





Government  
of Canada

Gouvernement  
du Canada

# ANNEX F

## LEGEND / LÉGENDE

- AREA OF GRASS CUTTING  
BOUNDARY LINE / LIMITE LIGNE  
DE TONDEUSE POUR LA GAZON
- PROPERTY LINE / LIMITE DE  
PROPRIÉTÉ

### NOTE:

TRIM GRASS BOTH SIDES OF FENCE /  
COUPER L'HERBE DEUX CÔTÉS DE CLÔTURE

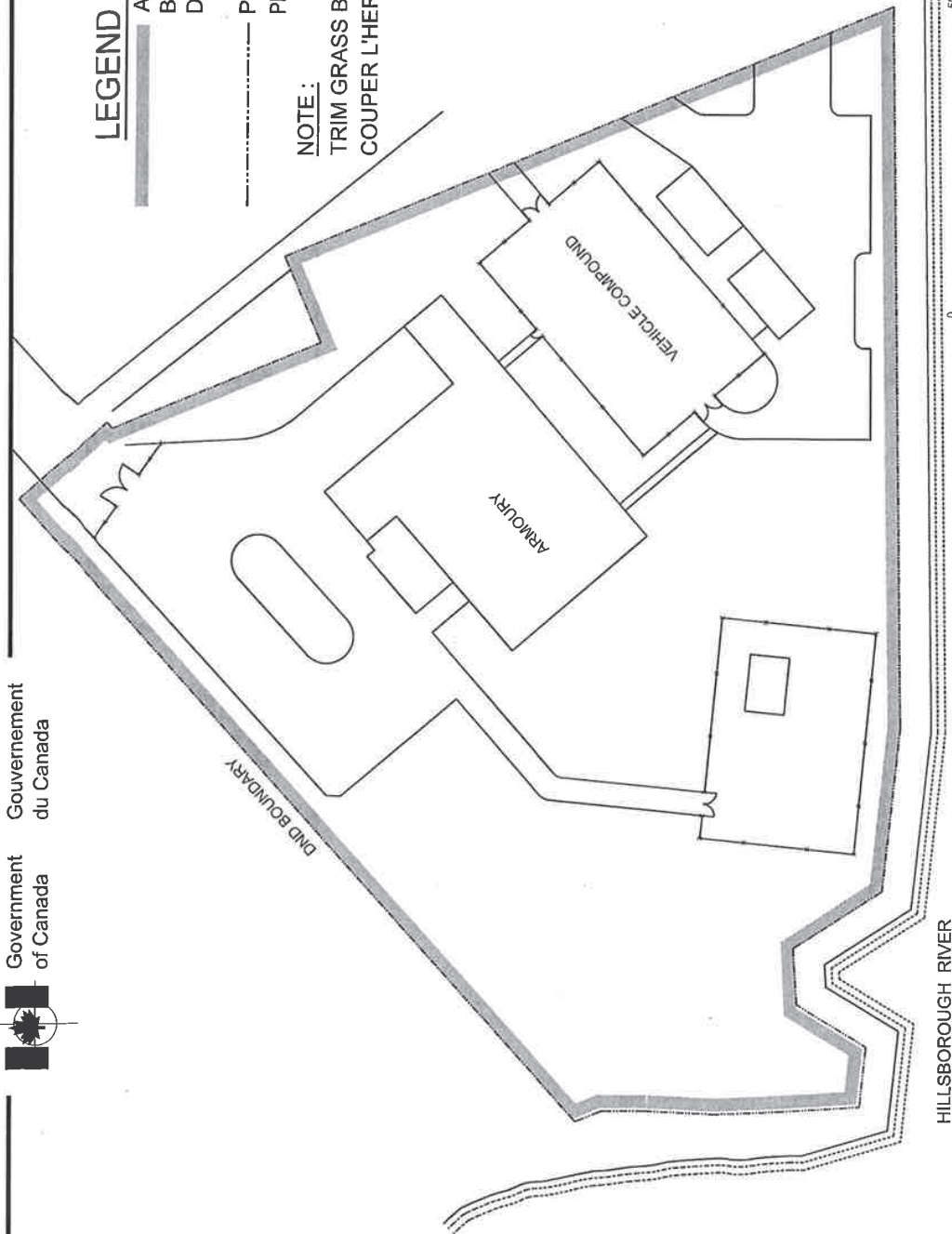

PROJECT:  
PROJET:

SNOW & ICE CONTROL/LANDSCAPE MAINTENANCE  
DÉNEIGEMENT ET DE DÉGLACAGE / ENTRETIEN PAYSAGER  
CHARLOTTETOWN, PEI & AREA (ET REGION)

SUBJECT:  
SUJET:

QUEEN CHARLOTTE ARMOURY  
SITE PLAN / PLAN D'EMPLACEMENT

DATE: 2015/09/01

APPROVED:  
APPROUVÉ  
PAR:

SCALE:  
ÉCHELLE:

NTS  
Pas d'échelle

WBS NO.:

NO. OTP:

PF NO.:

NO. DP:

SC

6  
of 10

DWG NO.:

NO. DESSIN:

L-C135-9301-42



Government  
of Canada

Gouvernement  
du Canada

## LEGEND / LÉGENDE

AREA OF GRASS CUTTING  
BOUNDARY LINE / LIMITE LIGNE  
DE TONDEUSE POUR LA GAZON

PROPERTY LINE / LIMITE DE  
PROPRIÉTÉ

### NOTE:

TRIM GRASS BOTH SIDES OF FENCE /  
COUPER L'HERBE DEUX CÔTÉS DE CLÔTURE

## ANNEX G

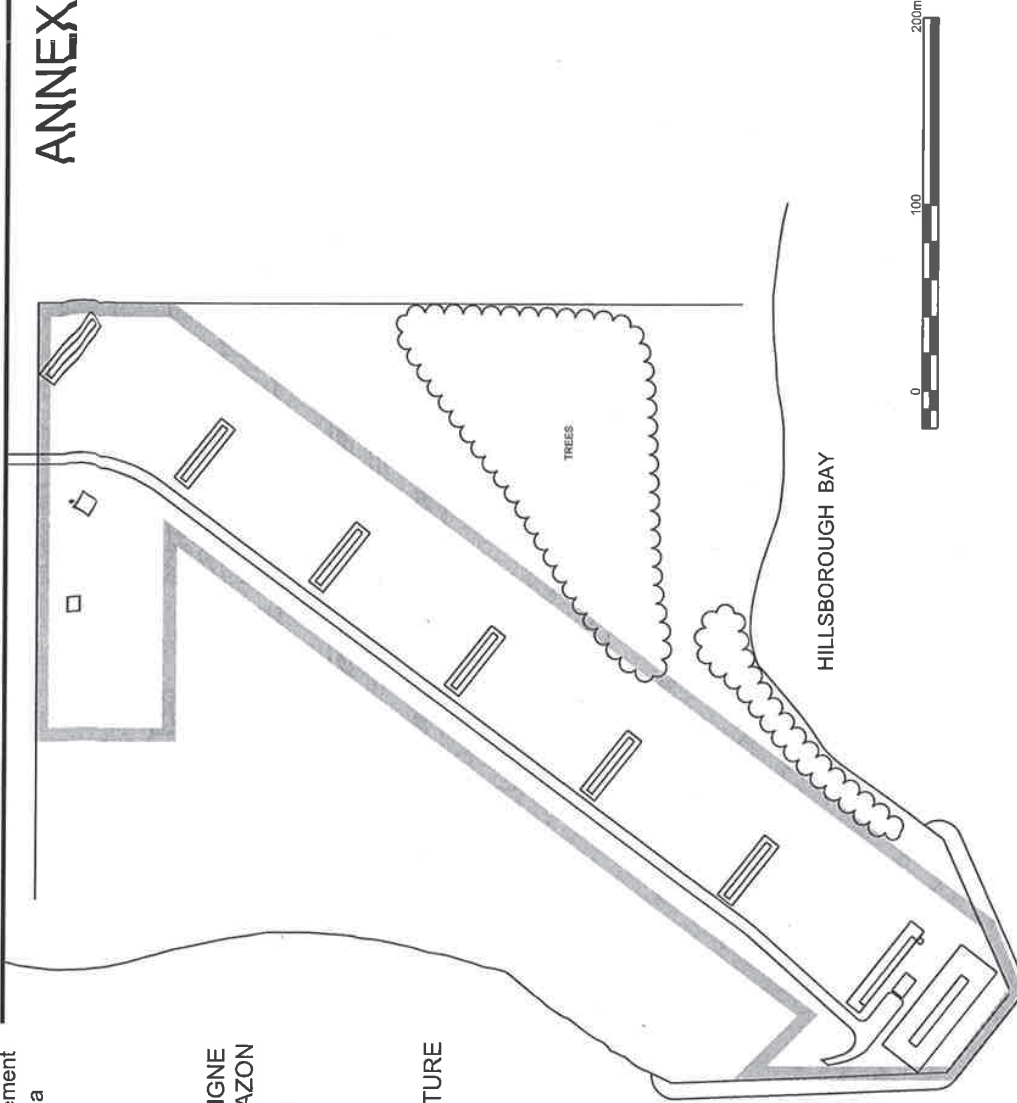

PROJECT:

PROJECT: SNOW & ICE CONTROL/LANDSCAPE MAINTENANCE  
DÉNEIGEMENT ET DE DÉGLACAGE/ENTRETIEN PAYSAGER  
SUBJECT: CHARLOTTETOWN, PEI & AREA ( ET REGION )

SUBJECT:

SUBJECT: ALEXANDRIA RIFLE RANGE  
SITE PLAN / PLAN D'EMPLACEMENT

DATE:

2015/09/01

APPROVED:

APPROUVÉ

PAR:

SCALE:

ÉCHELLE:

WBS NO.:

NO. OTP:

PF NO.:

NO. DP:

DWG NO.:

NO. DESSIN:

NTS

Pas d'échelle

SC

L-C135-9301-42



# ANNEX H

## LEGEND / LÉGENDE

AREA OF GRASS CUTTING  
BOUNDARY LINE / LIMITE LIGNE  
DE TONDEUSE POUR LA GAZON

PROPERTY LINE / LIMITE DE  
PROPRIÉTÉ

### NOTE:

TRIM GRASS BOTH SIDES OF FENCE /  
COUPER L'HERBE DEUX CÔTÉS DE CLÔTURE

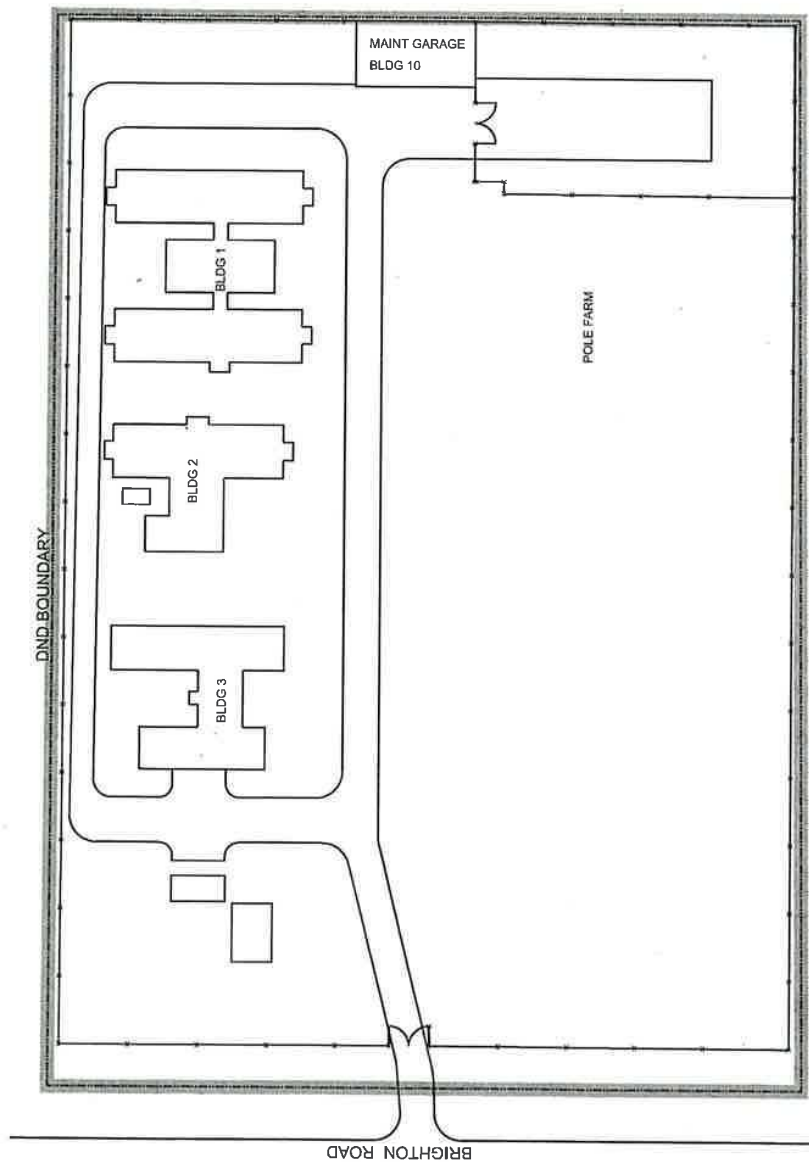

### PROJECT:

SNOW & ICE CONTROL/LANDSCAPE MAINTENANCE  
DÉNEIGEMENT ET DE DÉGLACAGE / ENTRETIEN PAYSAGER  
CHARLOTTETOWN, PEI & AREA ( ET REGION )

### SUBJECT:

BRIGHTON COMPOUND  
SITE PLAN / PLAN D'EMPLACEMENT

DATE: 2015/09/01

### APPROVED:

APPROUVÉ  
PAR:

### SCALE:

ÉCHELLE:

NTS

Pas d'échelle

WBS NO.:

NO. OTP:

PF NO.:

NO. DP:

DWG NO.:

NO. DESSIN:

SC

8

of 10

L-C135-9301-42



Gouvernement  
du Canada

# ANNEX J

## LEGEND / LÉGENDE

AREA OF GRASS CUTTING  
BOUNDARY LINE / LIMITE LIGNE  
DE TONDEUSE POUR LA GAZON

PROPERTY LINE / LIMITE DE  
PROPRIÉTÉ

### NOTE:

TRIM GRASS BOTH SIDES OF FENCE /  
COUPER L'HERBE DEUX CÔTÉS DE CLÔTURE

FIRST AVENUE

COMPOUND

SUPPORT DETACHMENT

DND BOUNDARY

THIRD STREET



PROJECT:

PROJECT: SNOW & ICE CONTROL/LANDSCAPE MAINTENANCE

DÉNEIGEMENT ET DE DÉGLAÇAGE/ENTRETIEN PAYSAGER

SUBJECT: CHARLOTTETOWN, PEI & AREA (ET REGION)

SUBJECT:

BUILDING #6 WEST ROYALTY SUPPORT

DETACHMENT HQ

SITE PLAN / PLAN D'EMPLACEMENT

DATE:

2015/09/01

APPROVED:

APPROUVE

PAR:

SCALE:

ÉCHELLE:

NTS

Pas d'échelle

WBS NO.:

NO. OTP:

PF NO.:

NO. DP:

DWG NO.:

NO. DESSIN:

SC

of 10

L-C135-9301-42

# LEGEND / LÉGENDE

## ANNEX K

AREA OF GRASS CUTTING  
BOUNDARY LINE / LIMITE LIGNE  
DE TONDEUSE POUR LA GAZON

PROPERTY LINE / LIMITE DE  
PROPRIÉTÉ

NOTE:  
TRIM GRASS BOTH SIDES OF FENCE /  
COUPER L'HERBE DEUX CÔTÉS DE CLÔTURE

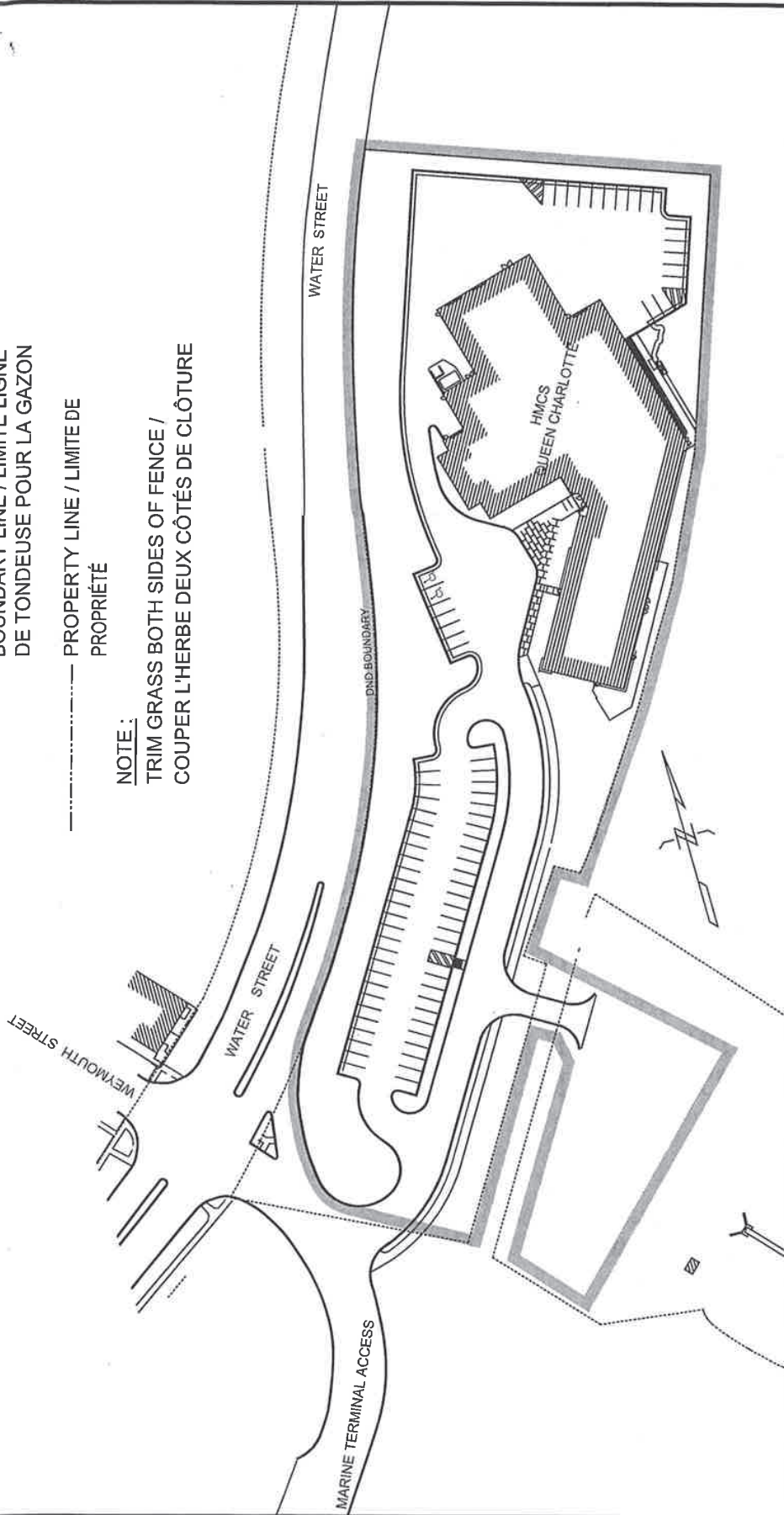

PROJECT: SNOW & ICE CONTROL/LANDSCAPE MAINTENANCE  
PROJET: DÉNEIGEMENT ET DE DÉGLACAGE/ENTRETIEN PAYSAGER  
SUBJECT: CHARLOTTETOWN, PEI & AREA (ET RÉGION)  
SUJET:

HMCS QUEEN CHARLOTTE  
SITE PLAN / PLAN D'EMPLACEMENT

DATE: 2015/09/01

APPROVED:  
APPROUVÉ  
PAR:

SCALE: NTS  
ÉCHELLE: Pas d'échelle

WBS NO.:

NO. OTP:

PF NO.:

NO. DP:

DWG NO.:

NO. DESSIN:

SC

10  
of 10

L-C135-9301-42