



**LEGEND**  
SOD/TOPSOIL REMOVAL (NOTE 4)

- GENERAL NOTES**
- ALL EXISTING UTILITIES SHOWN ON DRAWINGS ARE FOR REFERENCE PURPOSES ONLY. THE CONTRACTOR SHALL SATISFY THEMSELVES AS TO THE ACTUAL LOCATION AND DEPTH OF ANY UTILITY AND SHALL BE LIABLE FOR ALL OR ANY DAMAGES. INFORMATION REGARDING DEPTH AND LOCATION OF EXISTING UTILITIES ARE APPROXIMATE, TO BE VERIFIED IN THE FIELD BEFORE ANY CONSTRUCTION IN THE VICINITY.
  - DRAWING TO BE READ IN CONJUNCTION WITH ARCHITECTURAL, MECHANICAL, ELECTRICAL, AND STRUCTURAL DRAWINGS.
  - REFER TO ARCHITECTURAL DRAWINGS FOR BUILDING LAYOUT AND LOCATION.
  - CONTRACTOR IS RESPONSIBLE FOR PROVIDING OWNER A DETAILED STAGING AND TRAFFIC PLAN TO MAINTAIN TRAFFIC AND ACCESS TO THE SATISFACTION OF THE OWNER 4 WEEKS PRIOR TO CONSTRUCTION.
  - ANY AREA DISTURBED DURING CONSTRUCTION SHALL BE RESTORED TO EXISTING CONDITION OR BETTER TO THE SATISFACTION OF THE OWNER. THIS INCLUDES ASPHALT, GRANULAR OR PAVING STONE, TOPSOIL, SOD ETC.
  - C-SERIES PLANS ARE TO BE USED FOR GRADING ONLY. ANY OTHER INFORMATION SHOWN IS FOR ILLUSTRATION PURPOSES ONLY.
  - DRAWINGS ARE NOT FOR CONSTRUCTION UNTIL STAMPED BY DESIGN ENGINEER AND APPROVED BY THE LOCAL MUNICIPALITY.
  - ALL CONSTRUCTION WORK TO BE CARRIED OUT IN ACCORDANCE WITH THE REQUIREMENTS FOR THE OCCUPATIONAL HEALTH AND SAFETY ACT AND REGULATIONS FOR CONSTRUCTION PROJECTS.
  - THE CONTRACTOR WILL BECOME SOLE OWNER OF ALL EXCESS MATERIAL.
  - MAINTAIN FIRE ROUTE, VEHICULAR AND PEDESTRIAN TRAFFIC AROUND THE WORK ZONE.

- DRAWING NOTES**
- CONTRACTOR LAYDOWN AND PARKING AREA TO BE RESTRICTED TO THE WORK ZONE. ANY DAMAGED AREAS TO BE RESTORE UPON COMPLETION OF CONSTRUCTION.
  - REFER TO C-03 FOR TYPICAL CROSS SECTION THROUGH SITE.
  - LOCATION AND GRADE OF EXISTING SWALE TO BE VERIFIED IN THE FIELD. MAINTAIN DRAINAGE OF EXISTING SWALE, REGRADE AS REQUIRED TO PROVIDE POSITIVE DRAINAGE AWAY FROM BUILDING AND FILL PAD AND DRIVEWAY.
  - REFER TO ARCHITECTURAL FOR DETAILS ON CONSTRUCTION FENCING, CONSTRUCTION NOTES, AND TEMPORARY REQUIREMENTS.

Public Works and  
Government Services Canada  
Travaux publics et  
Services gouvernementaux Canada



2300 Yonge Street, Suite 2300, Toronto, ON, M4P 1E4  
Tel.: (416) 487-5256 Fax: (416) 487-9766  
DRAWINGS DEVELOPED FROM ELECTRONIC DRAWING FILES  
RECEIVED FROM:  
1. BETTER MEASURES - SITE SURVEY 0813.DWG  
2. TMA - A001 SITE PLAN & BUILDING PLANS  
3. PETO MACCALLUM LTD. - GEOTECHNICAL INVESTIGATIONS,  
DATED SEPT 2015 AND DEC 2015

COORDINATE SYSTEM  
UTM ZONE 17 - NAD 83 CSRS  
ELEVATIONS ARE RELATED TO THE CANADIAN GEODETIC VERTICAL  
DATUM 1972. A LOCAL BENCH MARK WAS ESTABLISHED ON A  
SPIKE ON THE NORTH SIDE OF THE LANEWAY, HAVING AN  
ELEVATION OF 249.44



FOR BID PURPOSES AND NOT FOR CONSTRUCTION

04		
03	ISSUED FOR TENDER	2016.01.29
02	ISSUED FOR 99% SUBMISSION	2016.01.08
01	ISSUED FOR 50% SUBMISSION	2015.12.18
revision		date

Do not scale drawings.  
Verify all dimensions and conditions on site and immediately  
notify the Departmental Representative of all discrepancies.

A	Detail No. No. du détail
B	drawing no. — where detail required dessin no. — où détail exigé
C	drawing no. — where detailed dessin no. — où détaillé

project title titre du projet	EGBERT	Ontario
	6248 8TH LINE, L0L 1N0	
	NEW HYDROGEN GENERATION (HOGEN) AND BALLOON LAUNCHING BUILDING	
drawing title titre du dessin	HOGEN — REMOVALS	
drawn by dessine par	PM	
designed by conc par	PM	
approved by approuve par	PM	
bid offre		project manager administrateur de projets
project date date du projet	2016-01-29	
project no. no. du projet	R.071909.001	
drawing no. dessine no.	C01	



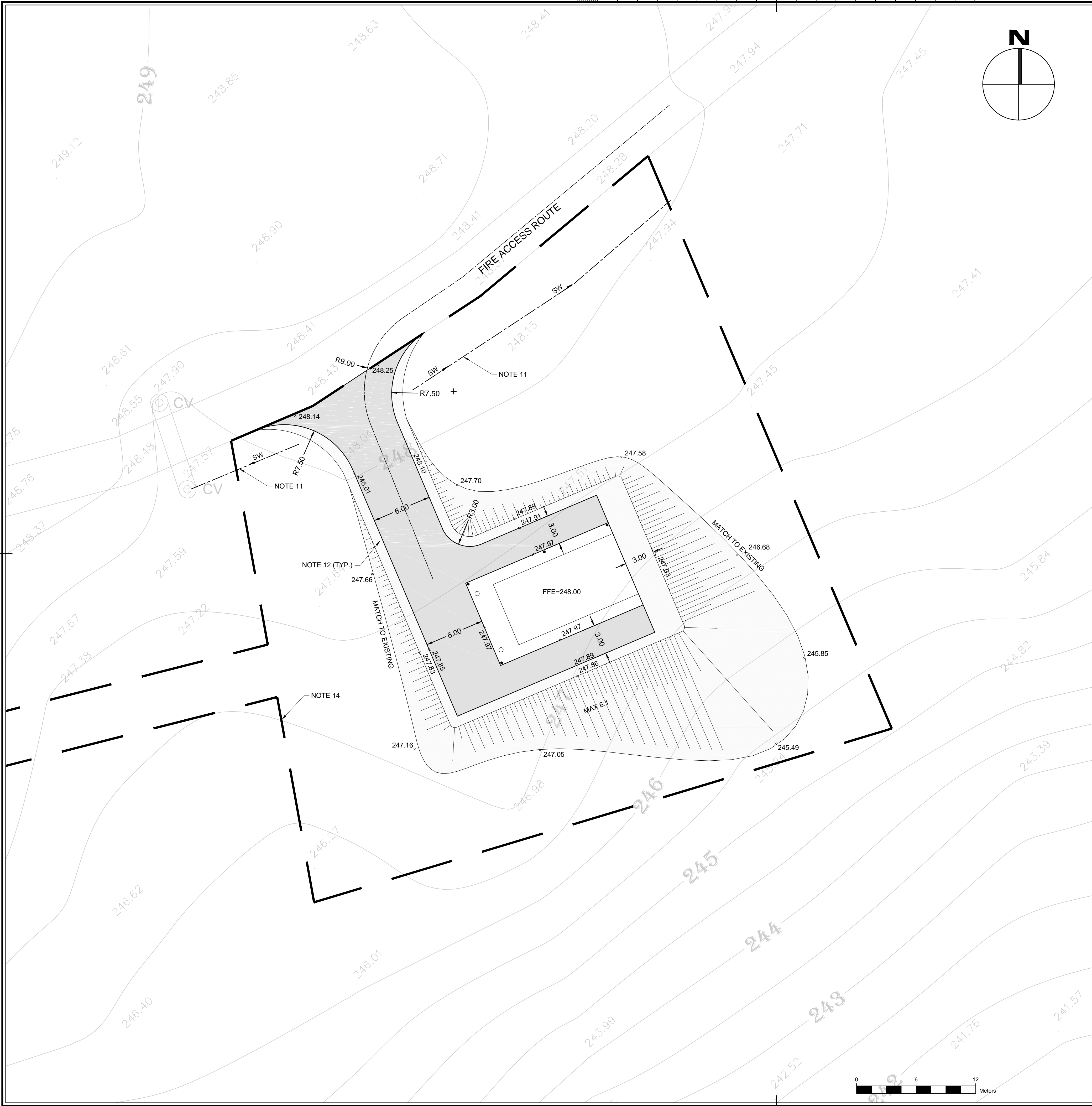

LEGEND

- HEAVY DUTY PAVEMENT (50mm HL3, 70mm HL8)
- 150mm TOPSOIL AND SOD
- 2.0% GRADE SLOPE
- SW SWALE
- 192.50 EXISTING ELEVATION
- 192.55 PROPOSED ELEVATION
- BOLLARD (NOTE 13)

DRAWING NOTES

- REFER TO C-01 FOR GENERAL NOTES.
- CONTRACTOR LAYDOWN AND PARKING AREA TO BE RESTRICTED TO THE WORK ZONE. ANY DAMAGED AREAS TO BE RESTORE UPON COMPLETION OF CONSTRUCTION.
- ALL AREAS OF REGRADING TO BE COMPACTED TO 98% SPMDD OR AS RECOMMEND BY THE GEOTECHNICAL CONSULTANT.
- ALL GRADED AREAS TO BE FINALIZED WITH 150mm OF TOPSOIL AND SOD.
- REMOVE AND LEVEL ANY DEPRESSED AREAS, PROVIDE MINIMUM 0.5% POSITIVE GRADE.
- PROVIDE MINIMUM 1.0% GRADE IN ALL SWALES.
- MAINTAIN POSITIVE DRAINAGE AWAY FROM BUILDINGS.
- REFER TO C-03 FOR TYPICAL CROSS SECTION THROUGH SITE.
- REFER TO MECHANICAL/ ELECTRICAL FOR SERVICE CONNECTIONS.
- REFER TO ARCHITECTURAL/ STRUCTURAL/ MECHANICAL/ ELECTRICAL DRAWINGS FOR BUILDING DETAILS.
- LOCATION AND GRADE OF EXISTING SWALE TO BE VERIFIED IN THE FIELD. MAINTAIN DRAINAGE OF EXISTING SWALE. REGRADE AS REQUIRED TO PROVIDE POSITIVE DRAINAGE AWAY FROM BUILDING AND FILL PAD AND DRIVEWAY.
- 1m ROUNDING AT 2% SLOPE.
- BOLLARD SETBACK 200mm FROM EDGE OF SIDEWALK TO CENTRE OF BOLLARD. REFER TO DETAIL ON C-03.
- REFER TO ARCHITECTURAL FOR DETAILS ON CONSTRUCTION FENCING, CONSTRUCTION NOTES, AND TEMPORARY REQUIREMENTS.



Public Works and  
Government Services Canada  
Travaux publics et  
Services gouvernementaux Canada



2300 Yonge Street, Suite 2300, Toronto, ON, M4P 1E4  
Tel.: (416) 487-5256 Fax: (416) 487-9766  
DRAWINGS DEVELOPED FROM ELECTRONIC DRAWING FILES  
RECEIVED FROM:  
1. BETTER MEASURES - SITE SURVEY 0813.DWG  
2. TMA - A001 SITE PLAN & BUILDING PLANS  
3. PETO MACCALLUM LTD. - GEOTECHNICAL INVESTIGATIONS, DATED SEPT 2015 AND DEC 2015  
COORDINATE SYSTEM  
UTM ZONE 17 - NAD 83 CSRS  
ELEVATIONS ARE RELATED TO THE CANADIAN GEODETIC VERTICAL DATUM 1972. A LOCAL BENCH MARK WAS ESTABLISHED ON A SPIKE ON THE NORTH SIDE OF THE LANEWAY, HAVING AN ELEVATION OF 249.44



FOR BID PURPOSES AND NOT FOR CONSTRUCTION

04		
03	ISSUED FOR TENDER	2016.01.29
02	ISSUED FOR 99% SUBMISSION	2016.01.08
01	ISSUED FOR 50% SUBMISSION	2015.12.18
revision		date

Do not scale drawings.  
Verify all dimensions and conditions on site and immediately notify the Departmental Representative of all discrepancies.

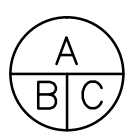

- A Detail No. No. du détail
- B drawing no. - where detail required dessin no. - où détail exigé
- C drawing no. - where detailed dessin no. - où détaillé

project title titre du projet	EGBERT	Ontario
	6248 8TH LINE, L0L 1N0	
	NEW HYDROGEN GENERATION (HOGEN) AND BALLOON LAUNCHING BUILDING	
drawing title titre du dessin	HOGEN - SITE PLAN	
drawn by dessiné par	PM	
designed by conc par	PM	
approved by approuvé par	PM	
bid offre		project manager administrateur de projets
project date date du projet	2016-01-29	
project no. no. du projet	R.071909.001	
drawing no. dessiné no.	C02	



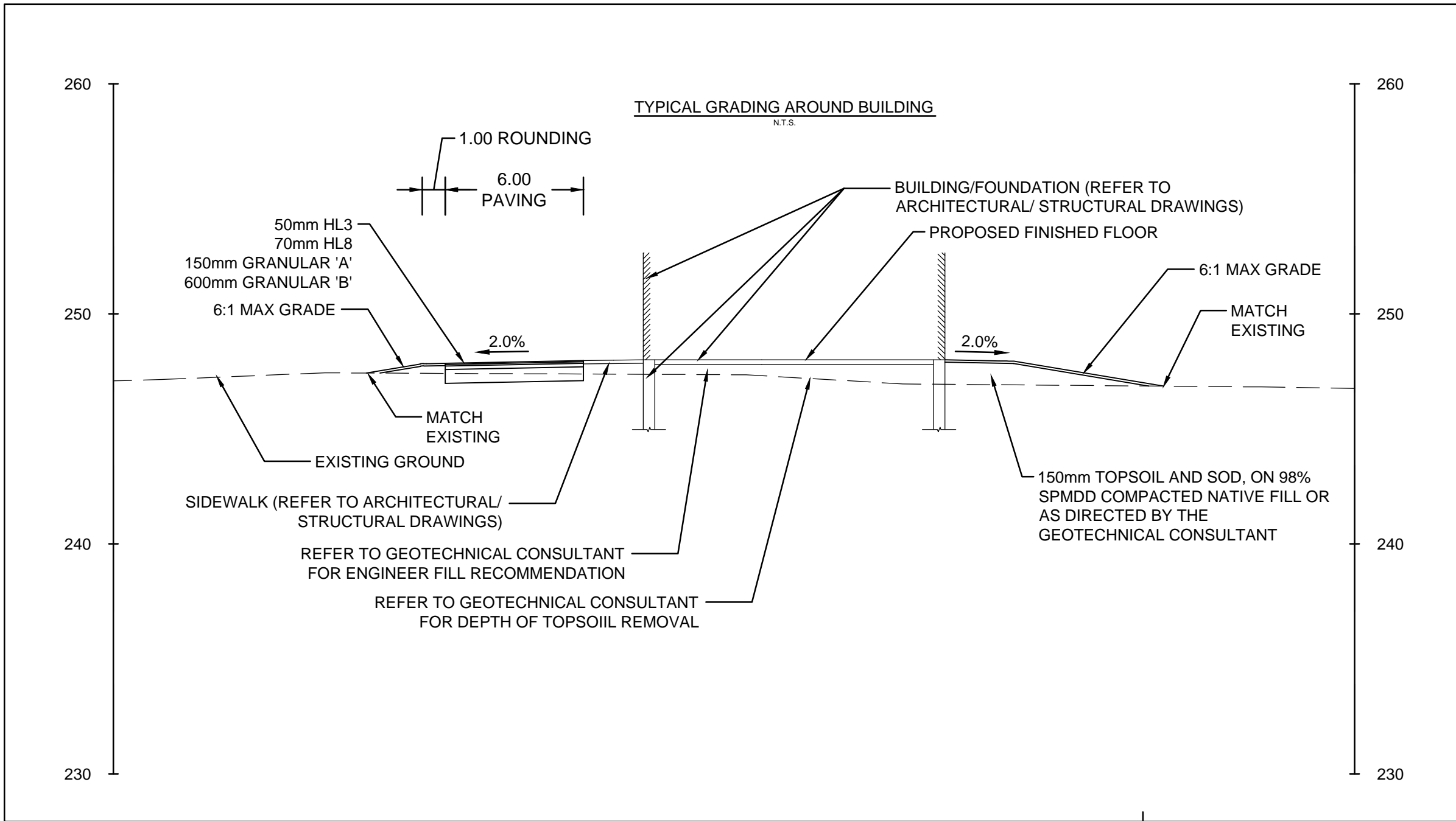
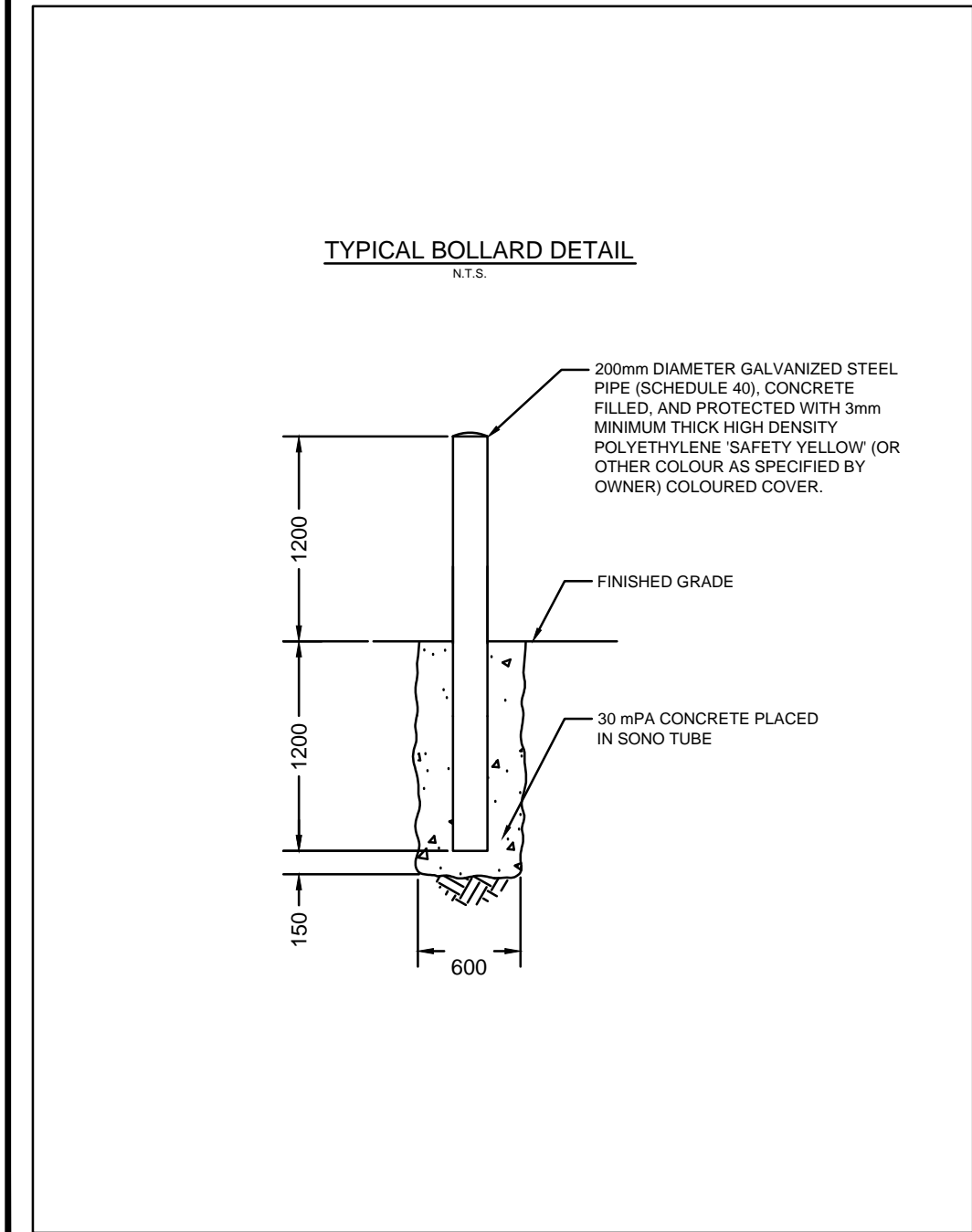
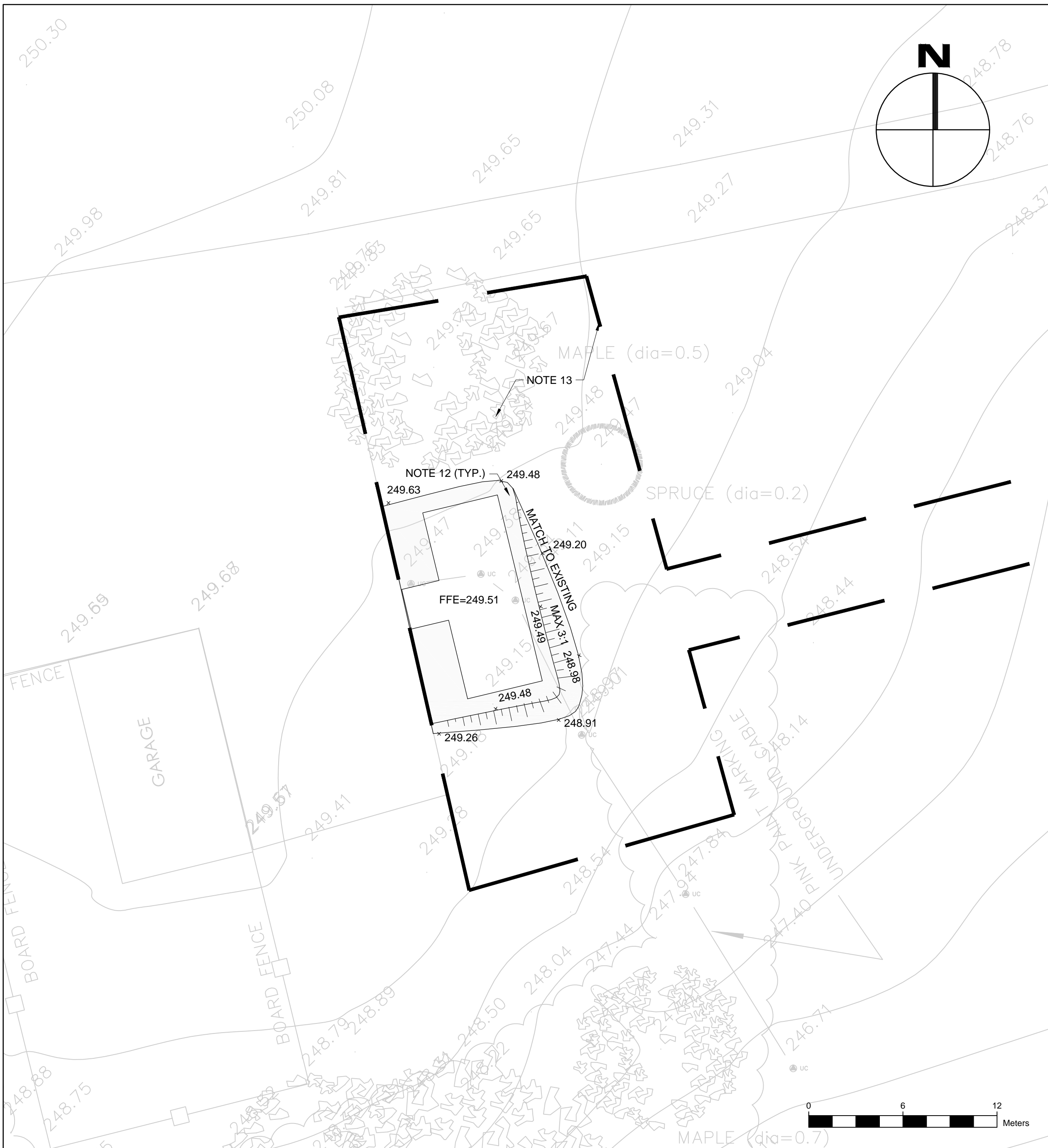

**LEGEND**

- SOD/TOPSOIL REMOVAL (NOTE 4)
- 150mm TOPSOIL AND SOD
- 2.0% GRADE SLOPE
- SW SWALE
- x 192.50 EXISTING ELEVATION
- x 192.55 PROPOSED ELEVATION

**DRAWING NOTES**

- REFER TO C-01 FOR GENERAL NOTES.
- CONTRACTOR LAYDOWN AND PARKING AREA TO BE RESTRICTED TO THE WORK ZONE. ANY DAMAGED AREAS TO BE RESTORE UPON COMPLETION OF CONSTRUCTION.
- ALL AREAS OF REGRADING TO BE COMPACTED TO 98% SPMD OR AS RECOMMEND BY THE GEOTECHNICAL CONSULTANT.
- ALL GRADED AREAS TO BE FINALIZED WITH 150mm OF TOPSOIL AND SOD.
- REMOVE AND LEVEL ANY DEPRESSED AREAS, PROVIDE MINIMUM 0.5% POSITIVE GRADE.
- PROVIDE MINIMUM 1.0% GRADE IN ALL SWALES.
- MAINTAIN POSITIVE DRAINAGE AWAY FROM BUILDINGS.
- REFER TO C-03 FOR TYPICAL CROSS SECTION THROUGH SITE.
- REFER TO MECHANICAL/ ELECTRICAL FOR SERVICE CONNECTIONS.
- REFER TO ARCHITECTURAL/ STRUCTURAL/ MECHANICAL/ ELECTRICAL DRAWINGS FOR BUILDING DETAILS.
- PROVIDE TREE PROTECTION WHEN WORKING IN VICINITY OF EXISTING TREES.
- 1m ROUNDING AT 2% SLOPE.
- REFER TO ARCHITECTURAL FOR DETAILS ON CONSTRUCTION FENCING, CONSTRUCTION NOTES, AND TEMPORARY REQUIREMENTS.



2300 Yonge Street, Suite 2300, Toronto, ON, M4P 1E4  
Tel.: (416) 487-5256 Fax: (416) 487-9766

DRAWINGS DEVELOPED FROM ELECTRONIC DRAWING FILES

- RECEIVED FROM:
- BETTER MEASURES - SITE SURVEY 0813.DWG
  - TMA - A001 SITE PLAN & BUILDING PLANS
  - PETO MACCALLUM LTD. - GEOTECHNICAL INVESTIGATIONS, DATED SEPT 2015 AND DEC 2015

COORDINATE SYSTEM  
UTM ZONE 17 - NAD 83 CSRS

ELEVATIONS ARE RELATED TO THE CANADIAN GEODETIC VERTICAL DATUM 1972. A LOCAL BENCH MARK WAS ESTABLISHED ON A SPIKE ON THE NORTH SIDE OF THE LANEWAY, HAVING AN ELEVATION OF 249.44



FOR BID PURPOSES AND NOT FOR CONSTRUCTION

04		
03	ISSUED FOR TENDER	2016.01.29
02	ISSUED FOR 99% SUBMISSION	2016.01.08
01	ISSUED FOR 50% SUBMISSION	2015.12.18
revision		date

Do not scale drawings.  
Verify all dimensions and conditions on site and immediately notify the Departmental Representative of all discrepancies.

A	Detail No.
B	No. du détail
C	drawing no. - where detail required dessin no. - où détail exigé
	drawing no. - where detailed dessin no. - où détaillé

project title  
titre du projet  
**EGBERT** Ontario

6248 8TH LINE, L0L 1N0

**NEW HYDROGEN GENERATION (HOGEN)  
AND BALLOON LAUNCHING BUILDING**

drawing title  
titre du dessin

**OPERATIONS TRAILER  
REMOVALS AND SITE PLAN**

drawn by  
dessiné par **PM**

designed by  
conc par **PM**

approved by  
approuvé par **PM**

bid  
offre

project date  
date du projet **2016-01-29**

project no.  
no. du projet **R.071909.001**

drawing no.  
dessiné no. **C03**