

# ISSUED FOR TENDER

- GENERAL NOTES:**
- DIMENSIONS, COORDINATES, ELEVATIONS ARE IN METRES NOTED OTHERWISE
  - TOPOGRAPHIC BASE PLAN SURVEY PROVIDED BY PWGSC (KM 205 - KM 210, SUMMER / FALL 2015, APEX SURVEY SOLUTIONS (KM 201 - KM 229, OCTOBER & NOVEMBER 2015))
  - THE CONTRACTOR IS RESPONSIBLE FOR VERIFYING THE LOCATION OF ALL UTILITIES PRIOR TO CONSTRUCTION

**PROFILE:**  
 TOP OF PROP. BST \_\_\_\_\_  
 TOP OF EX. BST \_\_\_\_\_  
**SUPERELEVATION:**  
 LEFT HAND SIDE \_\_\_\_\_  
 RIGHT HAND SIDE \_\_\_\_\_

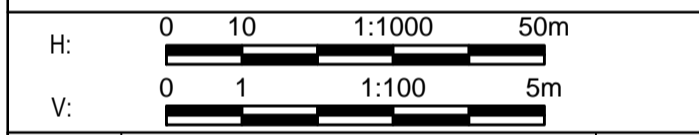
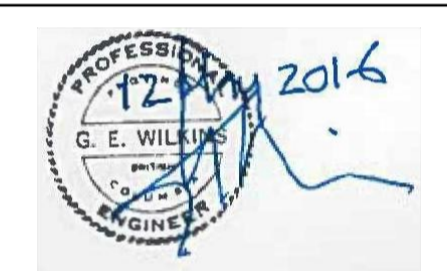

Revision/	Description/Description	Date/Date
1	ISSUED FOR ADDENDUM #1	16/05/12
0	ISSUED FOR TENDER	16/03/24

Client/client  
**PUBLIC WORKS AND GOVERNMENT SERVICES CANADA**



Project title/Titre du projet  
**KM 205 - 229  
 PAVEMENT REPLACEMENT  
 ALASKA HIGHWAY, BC**

Approved by/Approve par  
 G. WILKINS  
 Designed by/Concept par  
 E. YANG  
 Drawn by/Dessine par  
 A. DEEPWELL  
 PWGSC Project Manager/Administrateur de Projets TPSPGC  
 A. TAHERI  
 PWGSC, Architectural and Engineering Resources Manager/  
 Ressources Architectural et de Directeur d'Ingénierie, TPSPGC

Client/client  
**PUBLIC WORKS GOVERNMENT SERVICES CANADA**

Drawing title/Titre du dessin  
**PLAN  
 STA. 204+660 TO STA. 205+320**

Project No./No. du projet	Sheet/Feuille	Revision no./Revision no.
R.0173173.803	<b>C101</b>	<b>1</b>

OF C137

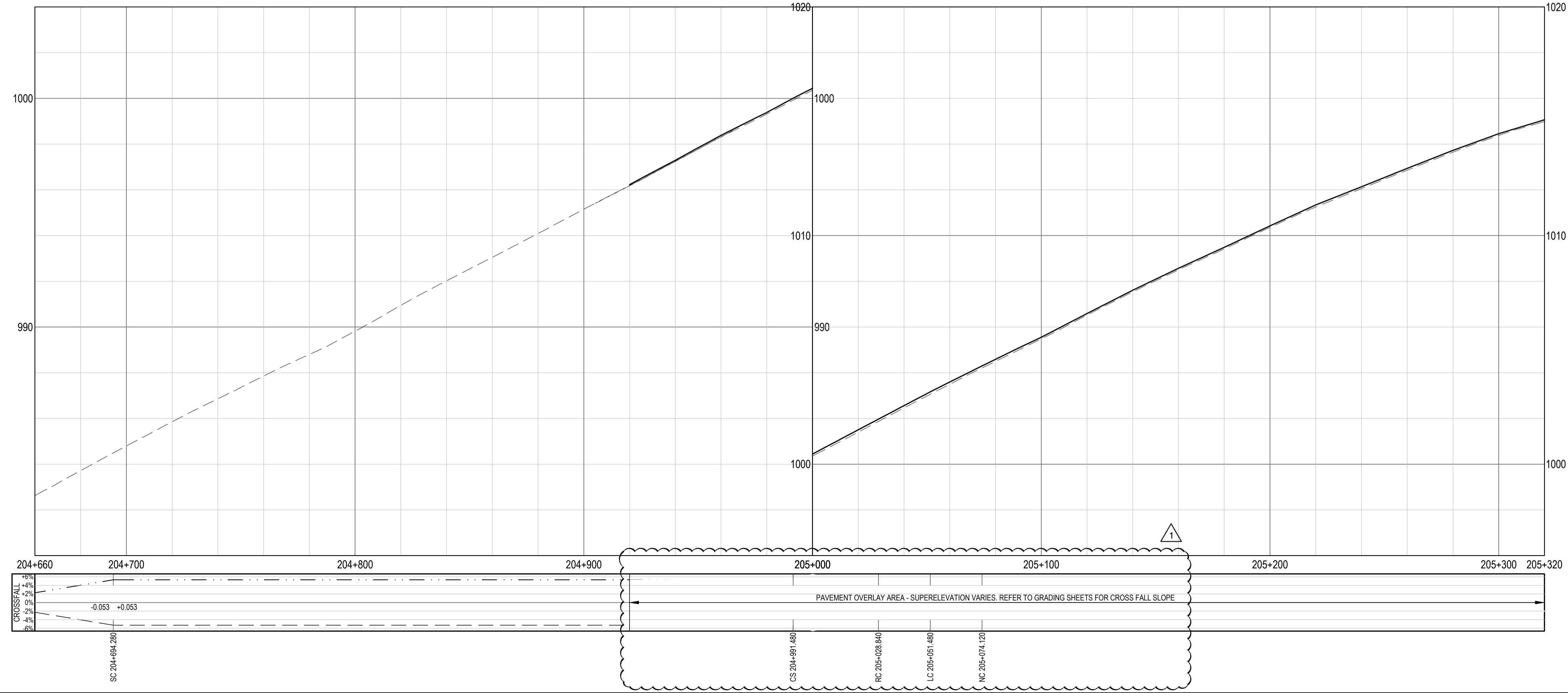
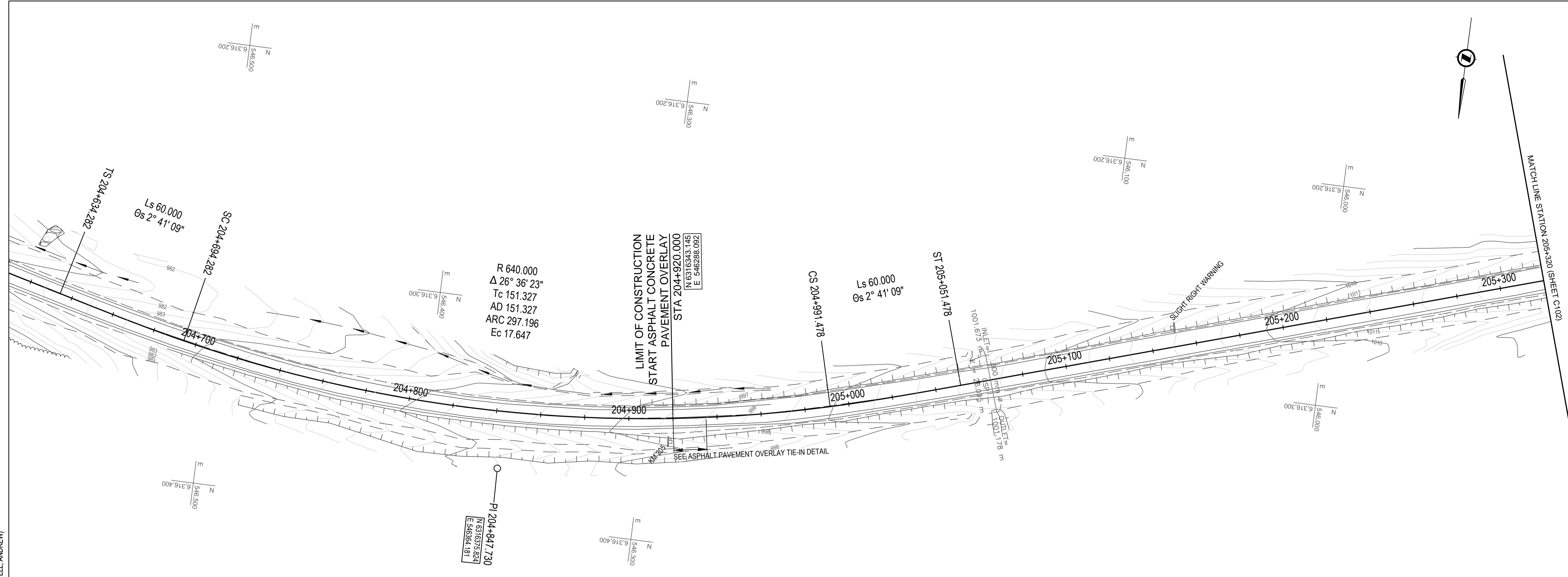

Q:\VancouverTransportation\TRN\WHY\03007-01 - Alaska Highway Km. 205 - 235\CADD\2016 03 24 Issued for Tender - Amendment 1\C101-110 PLAN PROFILES.dwg (C101) May 13, 2016 - 8:57:08 am (BY: DEEPWELL, ANDREW)

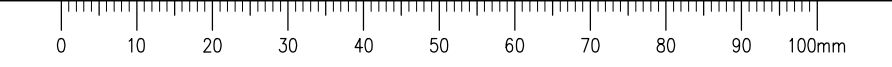

# ISSUED FOR TENDER

- GENERAL NOTES:
- DIMENSIONS, COORDINATES, ELEVATIONS ARE IN METRES NOTED OTHERWISE
  - TOPOGRAPHIC BASE PLAN SURVEY PROVIDED BY PWGSC (KM 205 - KM 210, SUMMER / FALL 2015, APEX SURVEY SOLUTIONS (KM 201 - KM 229, OCTOBER & NOVEMBER 2015))
  - THE CONTRACTOR IS RESPONSIBLE FOR VERIFYING THE LOCATION OF ALL UTILITIES PRIOR TO CONSTRUCTION

PROFILE:  
 TOP OF PROP. BST \_\_\_\_\_  
 TOP OF EX. BST \_\_\_\_\_  
 SUPERELEVATION:  
 LEFT HAND SIDE \_\_\_\_\_  
 RIGHT HAND SIDE \_\_\_\_\_

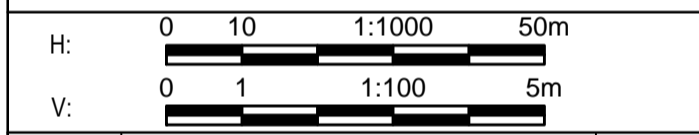
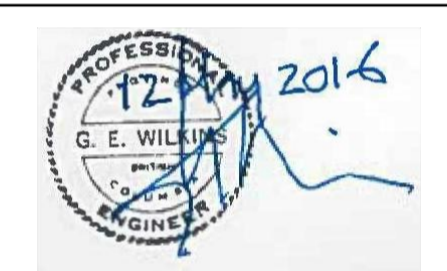

Revision/Revisión	Description/Description	Date/Date
1	ISSUED FOR ADDENDUM #1	16/05/12
0	ISSUED FOR TENDER	16/03/24

Client/client  
**PUBLIC WORKS AND GOVERNMENT SERVICES CANADA**



Project title/Titre du projet  
**KM 205 - 229  
 PAVEMENT REPLACEMENT  
 ALASKA HIGHWAY, BC**

Approved by/Approuve par  
 G. WILKINS  
 Designed by/Concept par  
 E. YANG  
 Drawn by/Dessine par  
 A. DEEPPWELL  
 PWGSC Project Manager/Administrateur de Projets TPSGC  
 A. TAHERI  
 PWGSC, Architectural and Engineering Resources Manager/  
 Ressources Architectural et de Directeur d'Ingénierie, TPSGC  
 Client/client  
 PUBLIC WORKS GOVERNMENT SERVICES CANADA

Drawing title/Titre du dessin  
**PLAN  
 STA. 204+320 TO STA. 205+980**

Project No./No. du projet	Sheet/Fauille	Revision no./Révision no.
R.0173173.803	<b>C102</b> OF C137	<b>1</b>

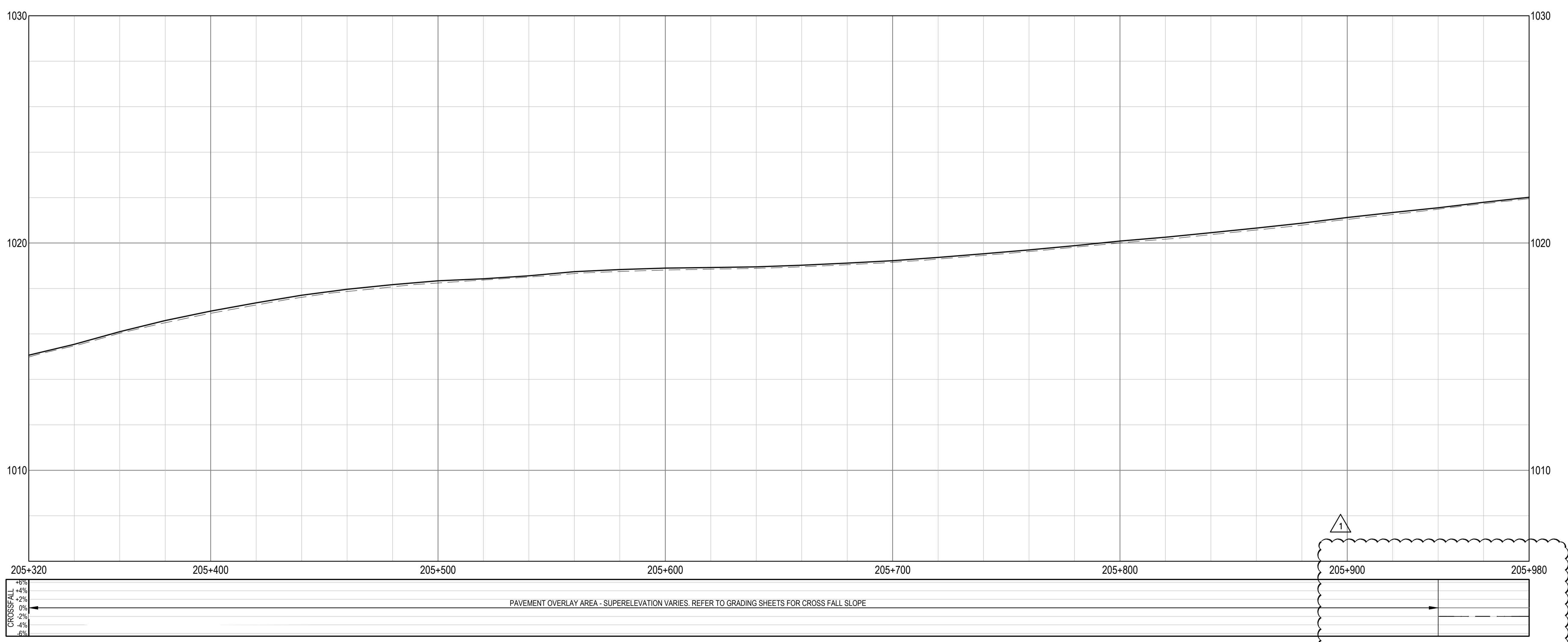
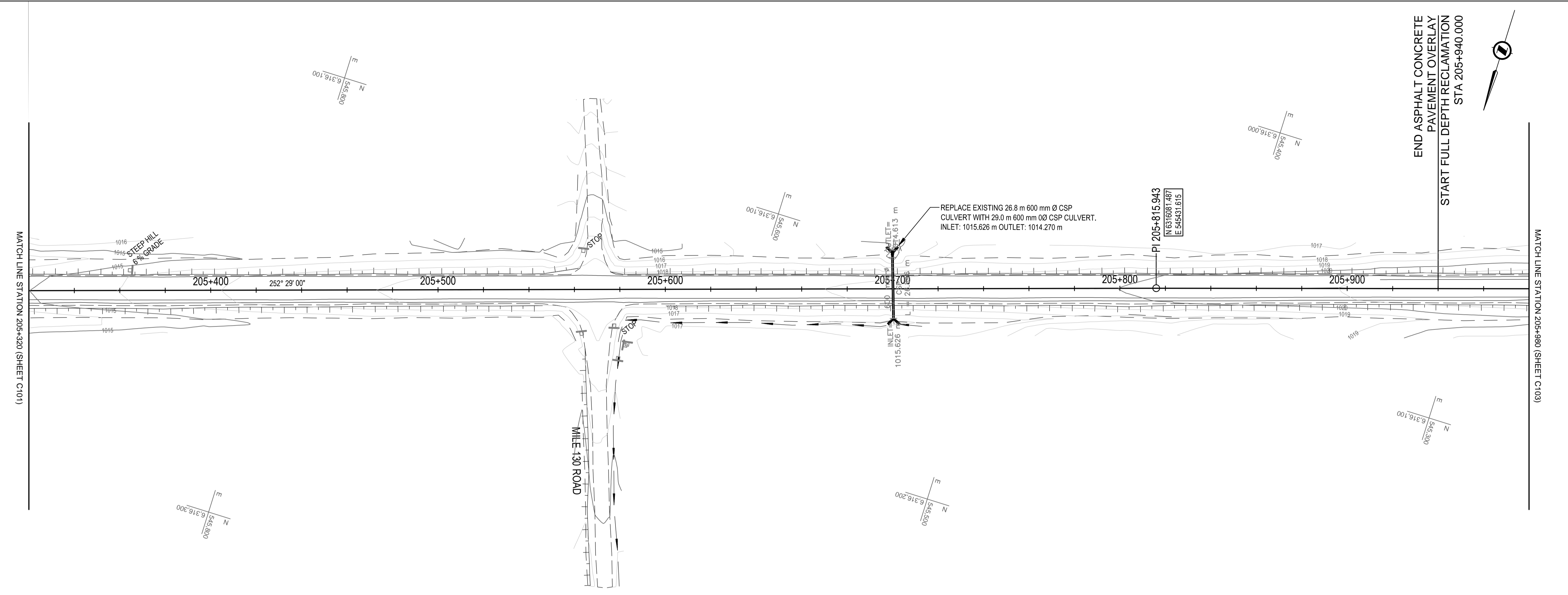

CROSS FALL  
 8%  
 4%  
 2%  
 0%  
 -2%  
 -4%  
 -8%

PAVEMENT OVERLAY AREA - SUPERELEVATION VARIES. REFER TO GRADING SHEETS FOR CROSS FALL SLOPE

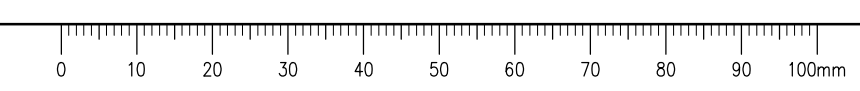

Q:\VancouverTransportation\TRN\VHW\03007-01 - Alaska Highway Km 205 - 235\CADD\2016 03 24 Issued for Tender - Amendment 1\C101-110 PLAN PROFILES.dwg C102 May 13, 2016 - 9:04:00 am (BY: DEEPPWELL, ANDREW)



# ISSUED FOR TENDER

- GENERAL NOTES:
- DIMENSIONS, COORDINATES, ELEVATIONS ARE IN METRES NOTED OTHERWISE
  - TOPOGRAPHIC BASE PLAN SURVEY PROVIDED BY PWGSC (KM 205 - KM 210, SUMMER / FALL 2015, APEX SURVEY SOLUTIONS (KM 201 - KM 229, OCTOBER & NOVEMBER 2015))
  - THE CONTRACTOR IS RESPONSIBLE FOR VERIFYING THE LOCATION OF ALL UTILITIES PRIOR TO CONSTRUCTION

PROFILE:  
 TOP OF PROP. BST \_\_\_\_\_  
 TOP OF EX. BST \_\_\_\_\_  
 SUPERELEVATION:  
 LEFT HAND SIDE \_\_\_\_\_  
 RIGHT HAND SIDE \_\_\_\_\_

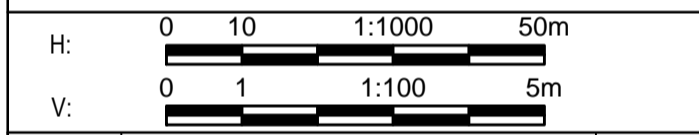
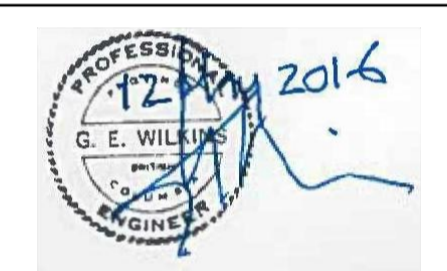

Revision/Revisión	Description/Description	Date/Date
1	ISSUED FOR ADDENDUM #1	16/05/12
0	ISSUED FOR TENDER	16/03/24

Client/client  
**PUBLIC WORKS AND GOVERNMENT SERVICES CANADA**



Project title/Titre du projet  
**KM 205 - 229  
 PAVEMENT REPLACEMENT  
 ALASKA HIGHWAY, BC**

Approved by/Approve par  
 G. WILKINS  
 Designed by/Concept par  
 E. YANG  
 Drawn by/Dessine par  
 A. DEEPPWELL  
 PWGSC Project Manager/Administrateur de Projets TPSPG  
 A. TAHERI  
 PWGSC, Architectural and Engineering Resources Manager/  
 Ressources Architecturales et de Directeur d'Ingénierie, TPSPG

Client/client  
 PUBLIC WORKS GOVERNMENT SERVICES CANADA

Drawing title/Titre du dessin  
**PLAN  
 STA. 205+980 TO STA. 206+640**

Project No./No. du projet <b>R.0173173.803</b>	Sheet/Fauille <b>C103</b> OF C137	Revision no./Révision no. <b>1</b>
---	---	---------------------------------------

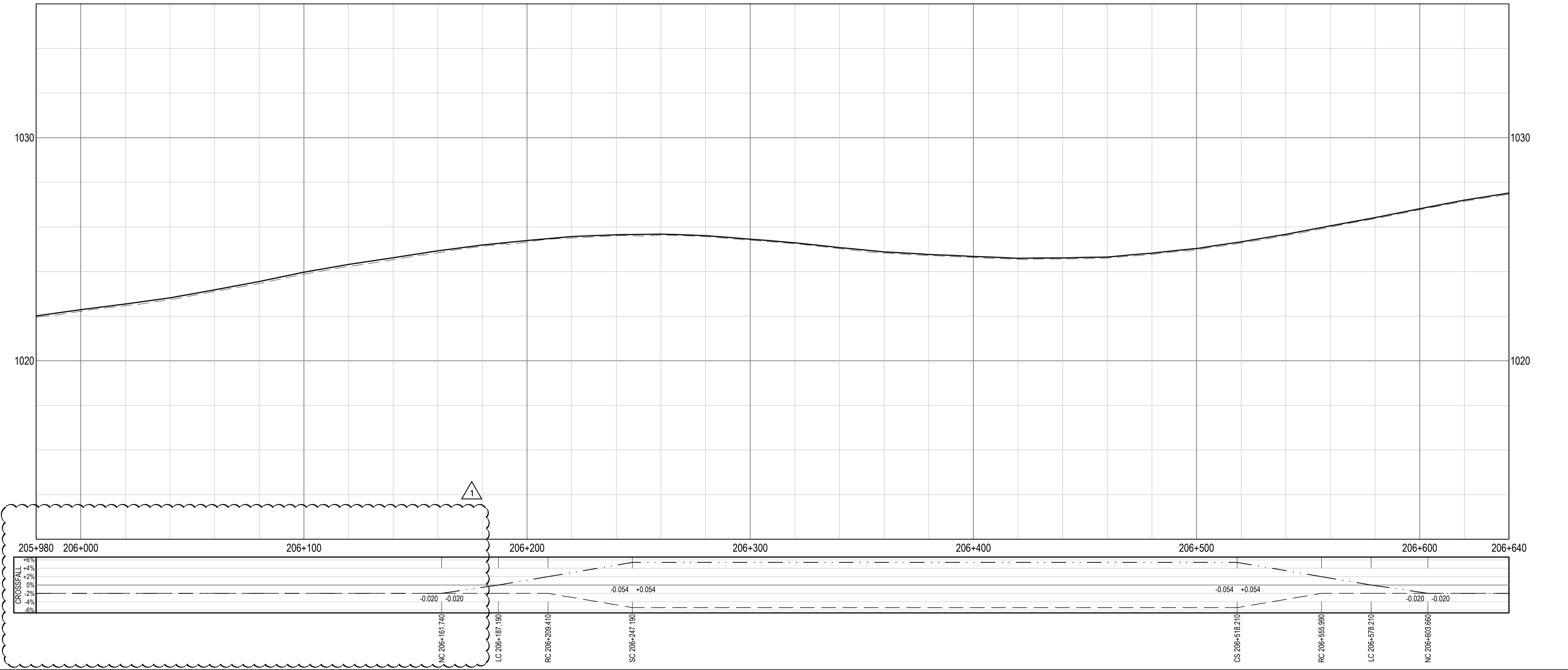
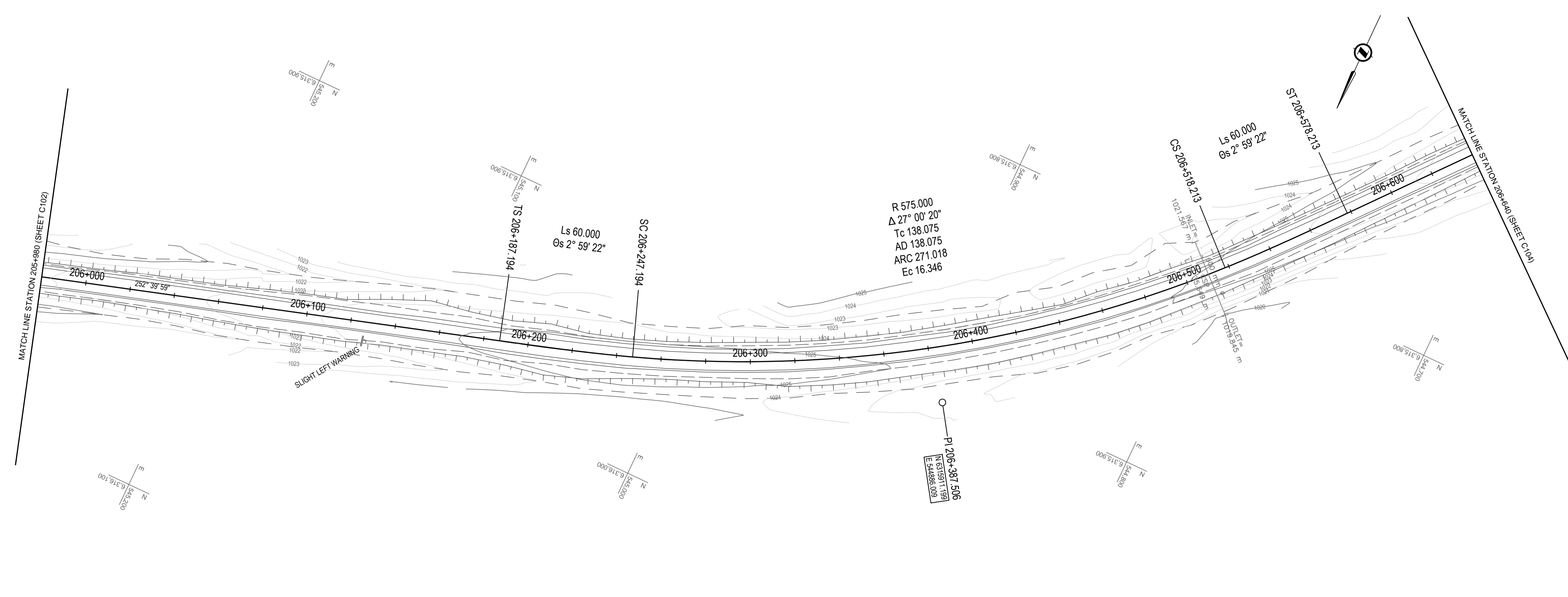

Q:\VancouverTransportation\TRN\VHWY03007-01 - Alaska Highway Km 205 - 229\CADD\2016 03 24 Issued for Tender - Amendment 1\C101-110 PLAN PROFILES.dwg C103 May 13, 2016 - 9:06:08 am (BY: DEEPPWELL, ANDREW)



# ISSUED FOR TENDER

- GENERAL NOTES:
- DIMENSIONS, COORDINATES, ELEVATIONS ARE IN METRES NOTED OTHERWISE
  - TOPOGRAPHIC BASE PLAN SURVEY PROVIDED BY PWGSC (KM 205 - KM 210, SUMMER / FALL 2015, APEX SURVEY SOLUTIONS (KM 201 - KM 229, OCTOBER & NOVEMBER 2015))
  - THE CONTRACTOR IS RESPONSIBLE FOR VERIFYING THE LOCATION OF ALL UTILITIES PRIOR TO CONSTRUCTION

PROFILE:  
 TOP OF PROP. BST \_\_\_\_\_  
 TOP OF EX. BST \_\_\_\_\_  
 SUPERELEVATION:  
 LEFT HAND SIDE \_\_\_\_\_  
 RIGHT HAND SIDE \_\_\_\_\_

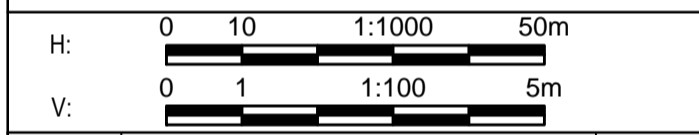
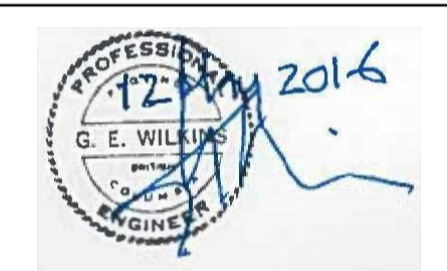

Revision/Revision	Description/Description	Date/Date
1	ISSUED FOR ADDENDUM #1	16/05/12
0	ISSUED FOR TENDER	16/03/24

Client/client

**PUBLIC WORKS AND GOVERNMENT SERVICES CANADA**



Project title/Titre du projet  
**KM 205 - 229  
 PAVEMENT REPLACEMENT  
 ALASKA HIGHWAY, BC**

Approved by/Approuvé par  
**G. WILKINS**  
 Designed by/Concept par  
**E. YANG**  
 Drawn by/Dessiné par  
**A. DEEPPWELL**  
 PWGSC Project Manager/Administrateur de Projets TPSPG  
**A. TAHERI**  
 PWGSC, Architectural and Engineering Resources Manager/  
 Ressources Architectural et de Directeur d'Ingénierie, TPSPG

Client/client  
**PUBLIC WORKS GOVERNMENT SERVICES CANADA**

Drawing title/Titre du dessin  
**PLAN  
 STA. 206+640 TO STA. 207+300**

Project No./No. du projet <b>R.0173173.803</b>	Sheet/Feuille <b>C104</b> OF C137	Revision no./ La Révision no. <b>1</b>
---	---	--

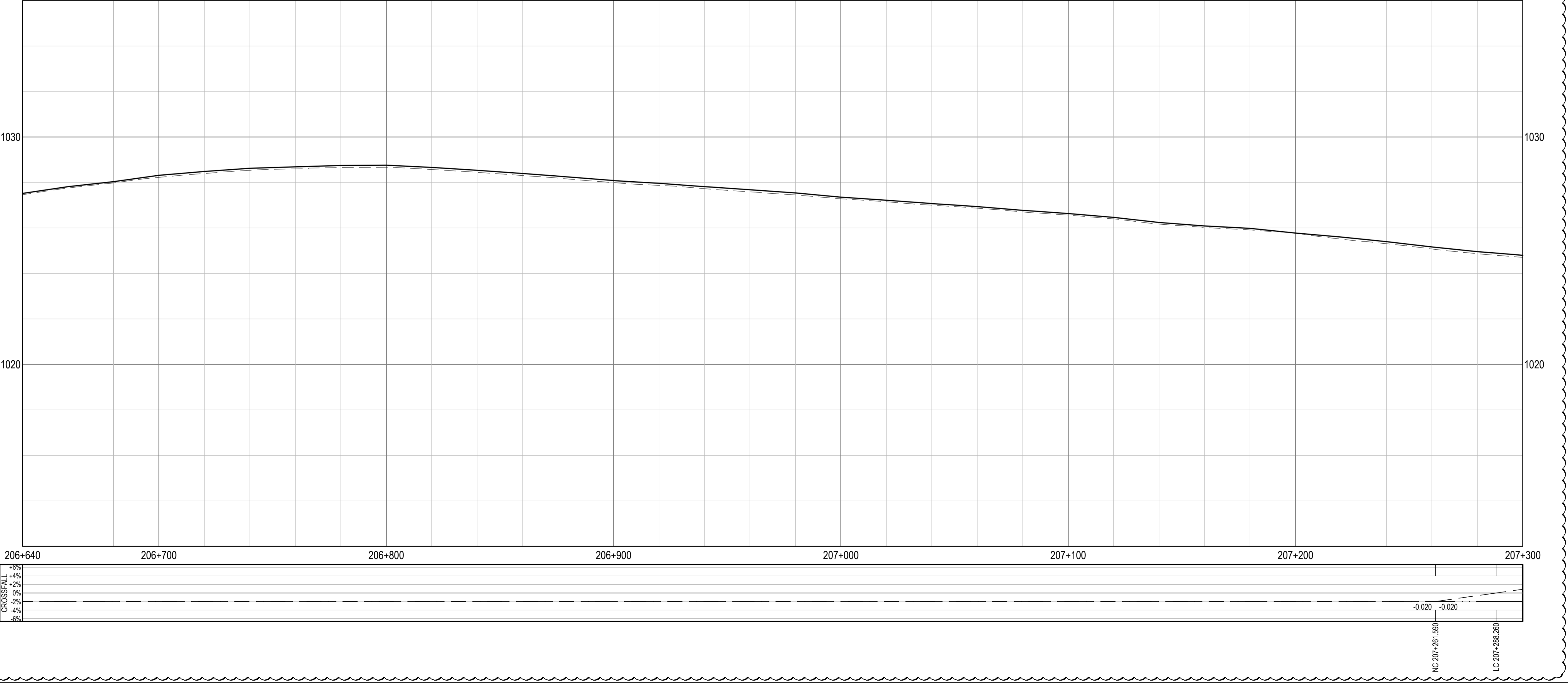
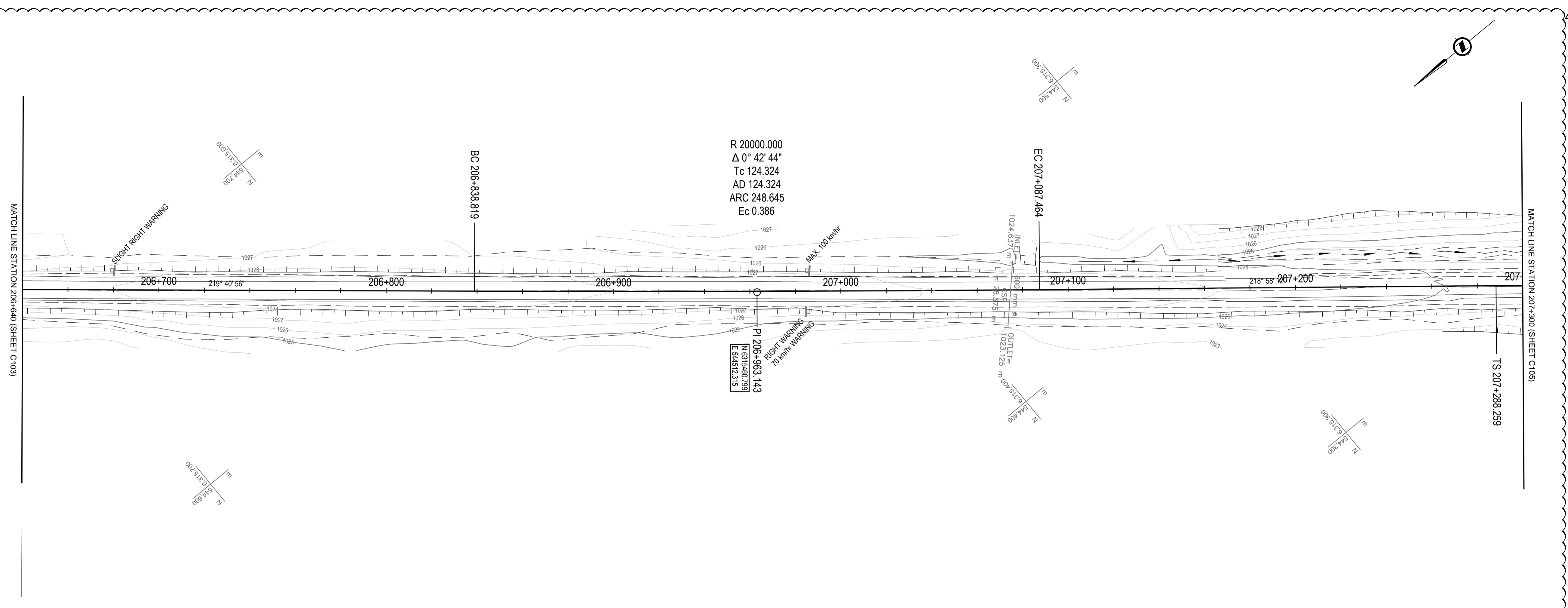

Q:\VancouverTransportation\TRN\VHWY03007-01 - Alaska Highway Km 205 - 235\CADD\2016 03 24 Issued for Tender - Amendment 1\C101-110 PLAN PROFILES.dwg (C104) May 13, 2016 - 9:10:14 am (BY: DEEPPWELL, ANDREW)

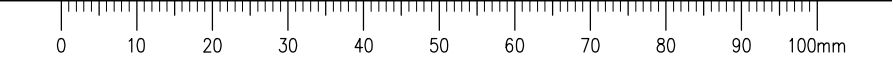

# ISSUED FOR TENDER

- GENERAL NOTES:**
- DIMENSIONS, COORDINATES, ELEVATIONS ARE IN METRES UNLESS OTHERWISE NOTED
  - TOPOGRAPHIC BASE PLAN SURVEY PROVIDED BY PWGSC (KM 205 - KM 210, SUMMER / FALL 2015, APEX SURVEY SOLUTIONS (KM 201 - KM 229, OCTOBER & NOVEMBER 2015))
  - THE CONTRACTOR IS RESPONSIBLE FOR VERIFYING THE LOCATION OF ALL UTILITIES PRIOR TO CONSTRUCTION

**PROFILE:**  
 TOP OF PROP. BST \_\_\_\_\_  
 TOP OF EX. BST \_\_\_\_\_  
**SUPERELEVATION:**  
 LEFT HAND SIDE \_\_\_\_\_  
 RIGHT HAND SIDE \_\_\_\_\_

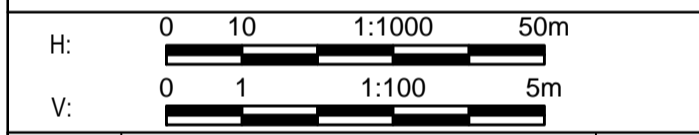
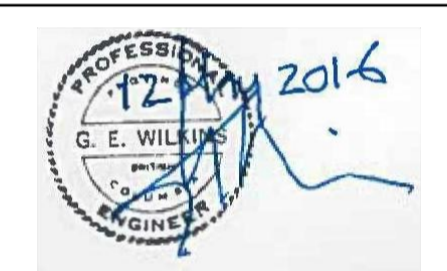

1	ISSUED FOR ADDENDUM #1	16/05/12
0	ISSUED FOR TENDER	16/03/24
Revision/	Description/Description	Date/Date
Client/client		

**PUBLIC WORKS AND GOVERNMENT SERVICES CANADA**



Project title/Titre du projet  
**KM 205 - 229  
 PAVEMENT REPLACEMENT  
 ALASKA HIGHWAY, BC**

Approved by/Approuve par  
**G. WILKINS**  
 Designed by/Concept par  
**E. YANG**  
 Drawn by/Dessine par  
**A. DEEPPWELL**  
 PWGSC Project Manager/Administrateur de Projets TPSCG  
**A. TAHERI**  
 PWGSC, Architectural and Engineering Resources Manager/  
 Ressources Architectural et de Directeur d'Ingénierie, TPSCG  
 Client/client  
**PUBLIC WORKS GOVERNMENT SERVICES CANADA**

Drawing title/Titre du dessin  
**PLAN  
 STA. 207+300 TO STA. 207+960**

Project No./No. du projet <b>R.0173173.803</b>	Sheet/Feuille <b>C105</b>	Revision no./ La Révision no. <b>1</b>
		OF C137

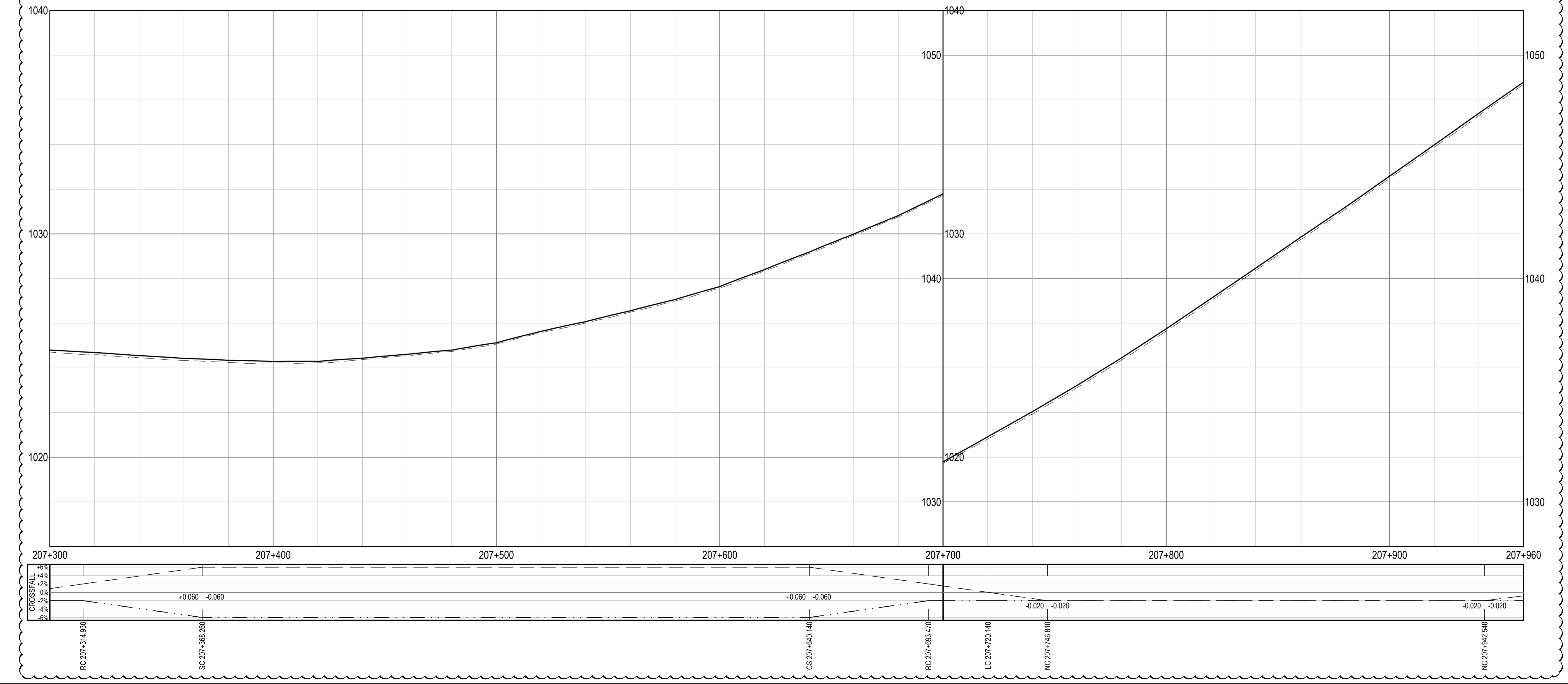
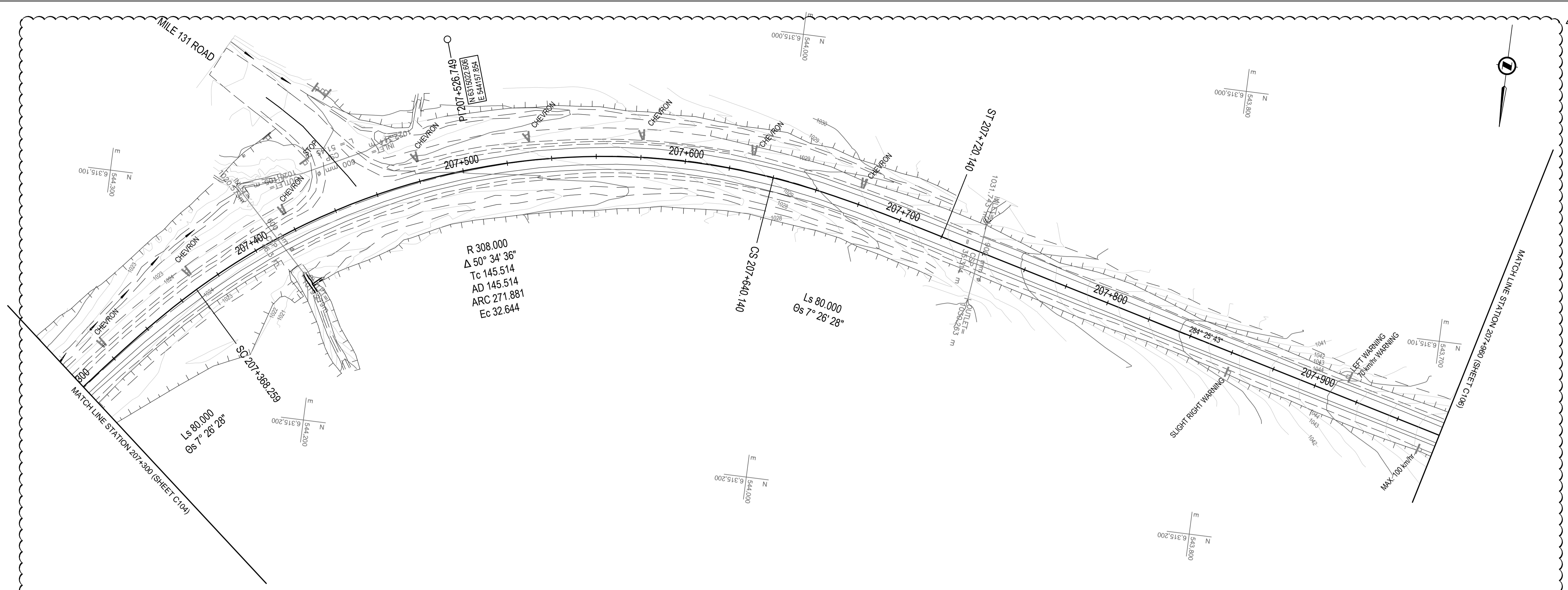

Q:\vancouver\Transportation\TRN\VHWY03007-01 - Alaska Highway Km 205 - 235\CADD\2016 03 24 Issued for Tender - Amendment 1\C101-110 PLAN PROFILES.dwg C105 May 13 2016 - 9:12:48 am (BY: DEEPPWELL, ANDREW)



# ISSUED FOR TENDER

GENERAL NOTES:  
1. DIMENSIONS, COORDINATES, ELEVATIONS ARE IN METRES UNLESS NOTED OTHERWISE AND RELATIVE TO GSC DATUM.

NOTES:  
(1) SEE SHOULDER WIDTH TABLE FOR CUSTOMIZED SHOULDER WIDTH LOCATIONS  
(2) SEE LANE WIDTH TABLE FOR CUSTOMIZED LANE WIDTH LOCATIONS  
(3) SLOPE TO ACHIEVE MIN. GRAVEL SHOULDERING WIDTH AND MAX. 3H:1V SLOPE (2.7H:1V AT 205+040 (RT) AND 205+040 (LT))  
(4) CHANGE IN SHOULDER WIDTHS OF 0.2m SHALL OCCUR BEFORE AND AFTER STATIONS (START STATION, END STATION) SHOWN OVER A LENGTH OF 3m  
(5) CHANGE IN SHOULDER AND LANE WIDTHS > 0.2m SHALL USE A TAPER RATE OF 50:1. THE TAPER SHALL OCCUR BEFORE AND AFTER THE STATIONS (START STATION, END STATION) SHOWN

SHOULDER WIDTHS			
STATION START	STATION END	LENGTH (m)	SHOULDER WIDTH / SIDE OF HWY (4)/(5)
205+020	205+060	40	1.8 m - RT
205+420	205+540	120	1.8 m - RT
205+640	205+720	80	1.8 m - LT
205+800	205+900	100	1.8 m - LT
205+880	205+940	60	1.8 m - RT
207+260	207+408.5	148.5	3.0 m - LT
207+260	207+700	440	3.0 m - RT
207+423.5	207+510	86.5	3.5 m - LT
207+540	207+700	160	3.0 m - LT
208+720	208+860	140	1.8 m - RT
214+840	214+880	40	1.8 m - LT
218+080	218+120	40	1.8 m - RT
218+460	218+720	260	1.8 m - RT
219+740	218+880	140	1.8 m - RT
220+560	220+600	40	1.8 m - RT
220+780	220+860	80	1.8 m - RT
222+660	222+700	40	1.8 m - RT
224+280	224+460	180	1.8 m - RT
225+220	225+260	40	1.8 m - LT
225+320	225+400	80	1.8 m - LT
225+830.5	226+024.5	194	2.5 m - LT

LANE WIDTHS			
STATION START	STATION END	LENGTH (m)	WIDTH / DIRECTION (5)
207+260	207+700	440	4.0 m - SB & NB

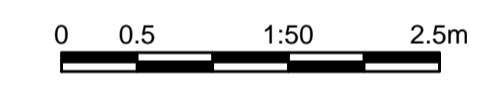
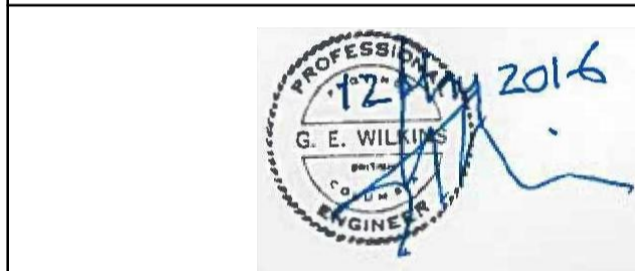
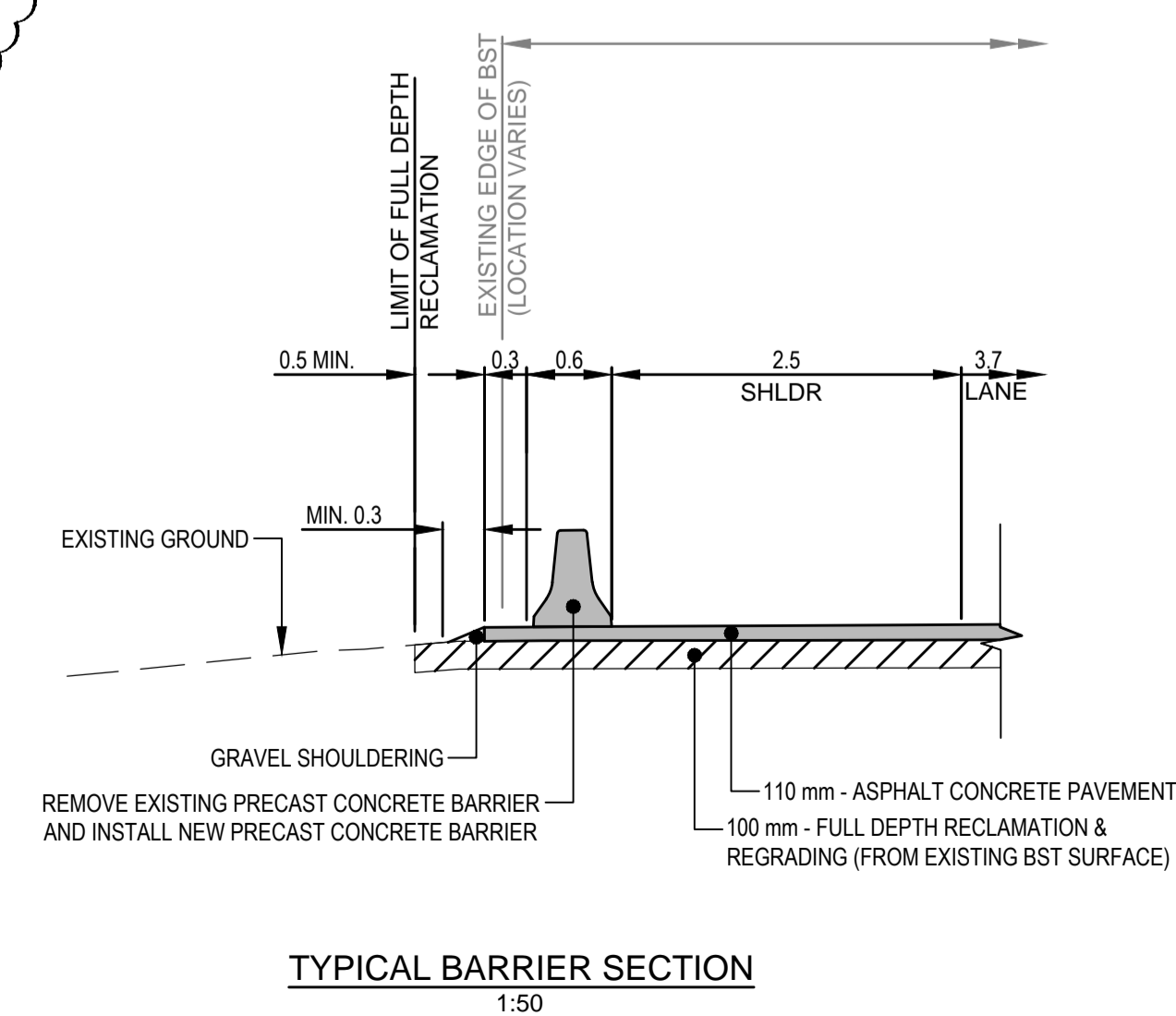
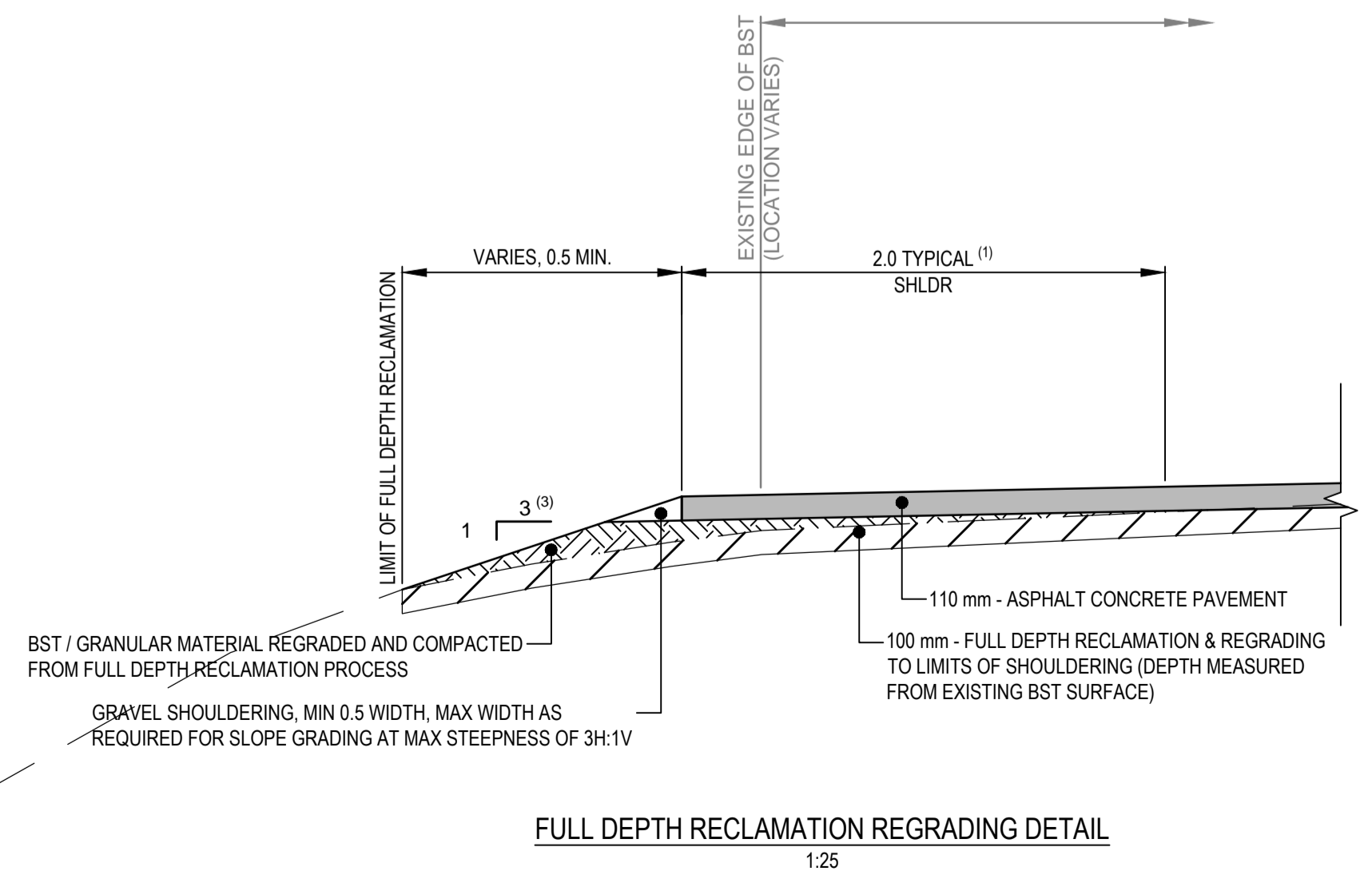
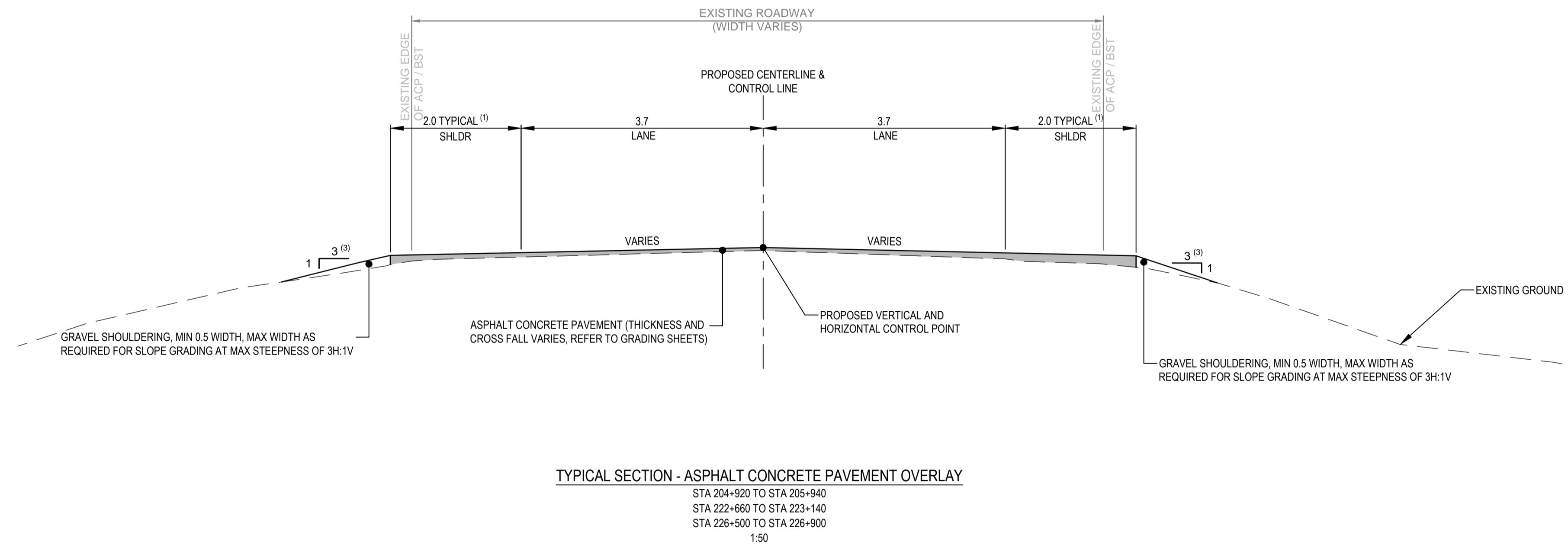
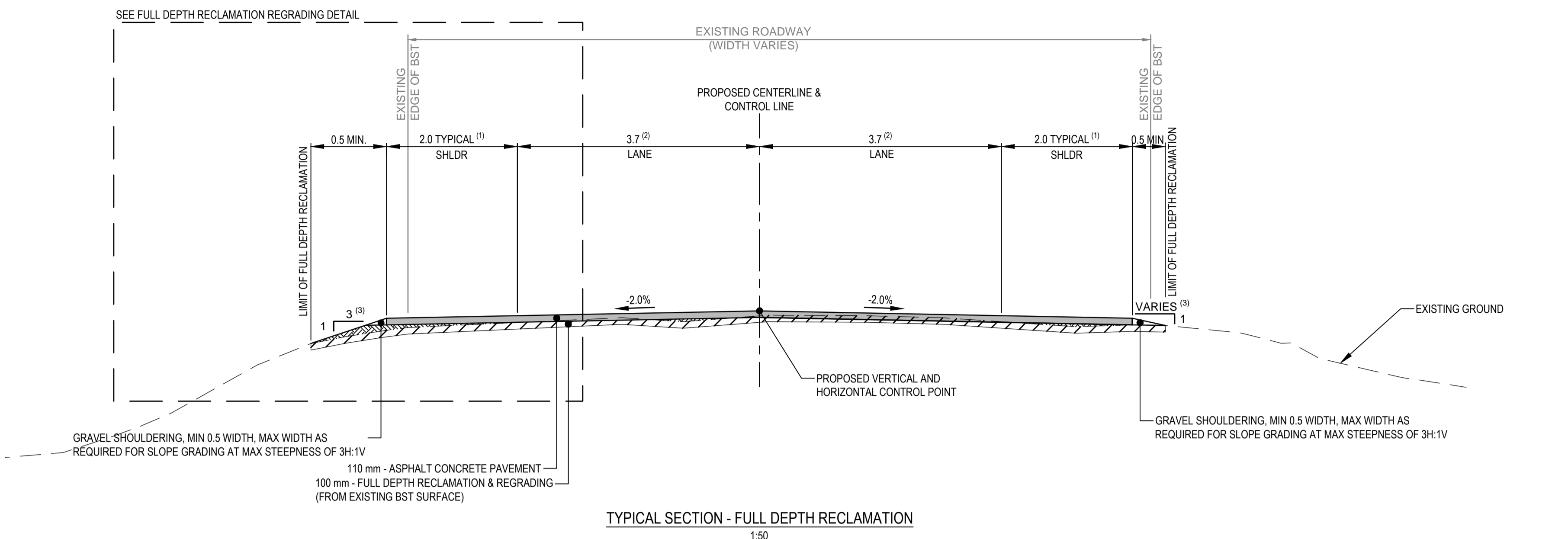

Revision/Revisión	Description/Description	Date/Date
1	ISSUED FOR ADDENDUM #1	16/05/12
0	ISSUED FOR TENDER	16/03/24

Client/client  
**PUBLIC WORKS AND GOVERNMENT SERVICES CANADA**



Project title/Titre du projet  
**KM 205 - 229 PAVEMENT REPLACEMENT ALASKA HIGHWAY, BC**

Approved by/Approve par  
G. WILKINS  
Designed by/Concept par  
E. YANG  
Drawn by/Dessine par  
A. DEEPWELL  
PWSC Project Manager/Administrateur de Projets TPSCG  
A. TAHERI  
PWSC, Architectural and Engineering Resources Manager/Ressources Architectural et de Directeur d'ingénierie, TPSCG

Client/client  
**PUBLIC WORKS GOVERNMENT SERVICES CANADA**

Drawing title/Titre du dessin  
**TYPICAL SECTIONS**

Project No./No. du projet	Sheet/Fauille	Revision no./Revision no.
R.0173173.803	C201 OF C204	1

Q:\VancouverTransportation\TRN\HWY03007-01 - Alaska Highway Km 205 - 229\CADD\2016 03 24 Issued for Tender - Amendment 1\C201-203 TYPICAL SECTIONS & DETAILS.dwg [C201] May 13, 2016 - 9:15:04 am (BY: DEEPWELL, ANDREW)

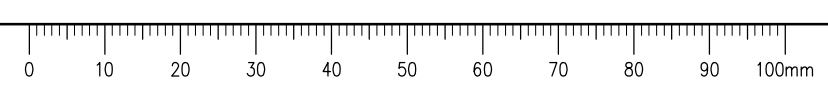

# ISSUED FOR TENDER

GENERAL NOTES:  
1. DIMENSIONS, COORDINATES, ELEVATIONS ARE IN METRES UNLESS NOTED OTHERWISE AND RELATIVE TO GSC DATUM.

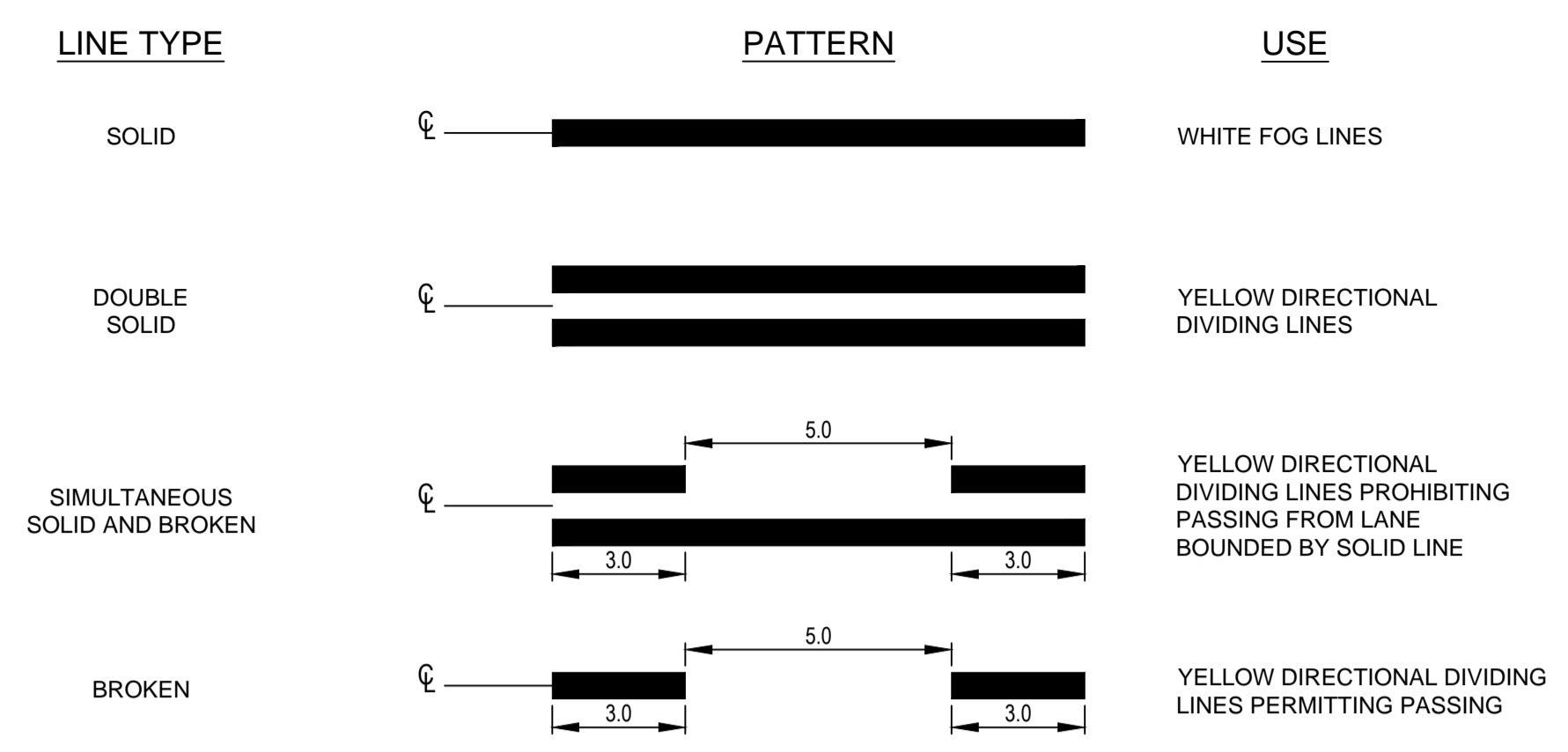

TYPICAL LONGITUDINAL PAVEMENT MARKINGS  
NTS

- NOTES:  
1. ALL PAINT LINES TO BE 110 mm WIDE  
2. WIDTH BETWEEN YELLOW DIRECTIONAL DIVIDING LINES SHALL BE 110 mm  
3. PAVEMENT MARKINGS TO BE INSTALLED PER LOCATIONS SHOWN ON TABLE. BREAKS IN PAINT LINES AT INTERSECTIONS SHALL BE AS PER TYPICAL ACCESS ROAD PAVEMENT MARKING DETAIL, C203

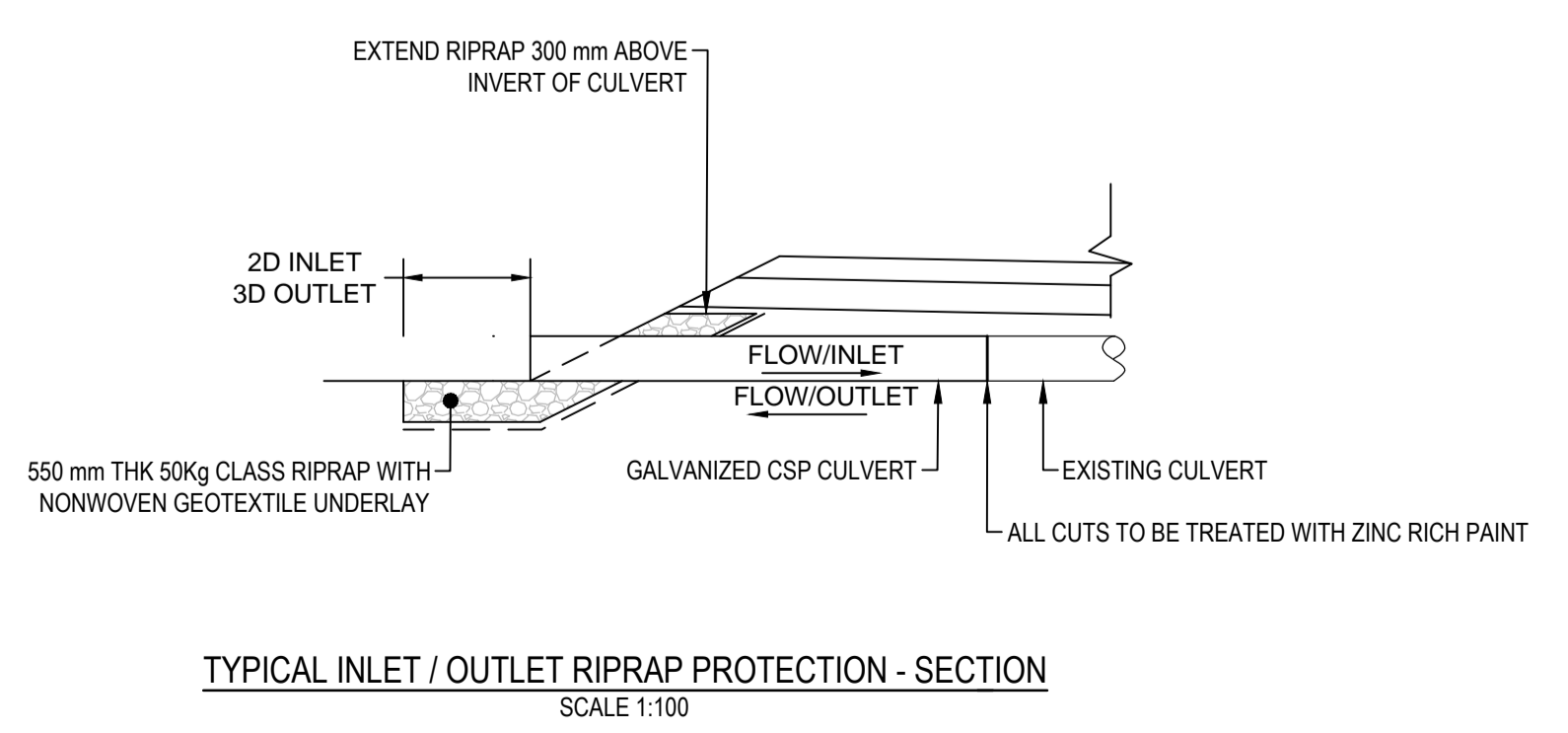
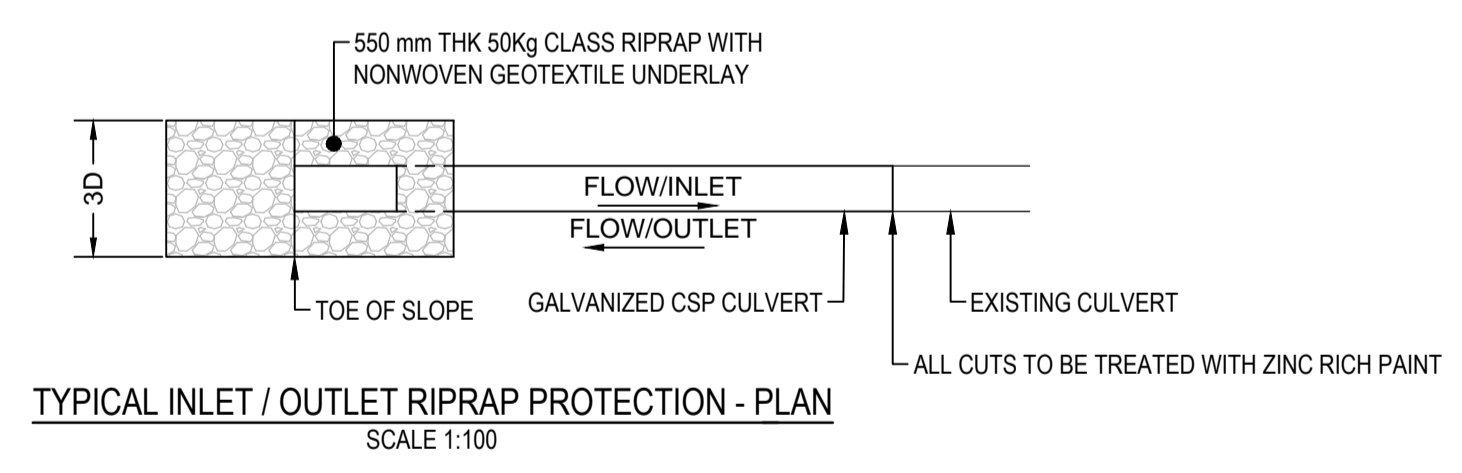
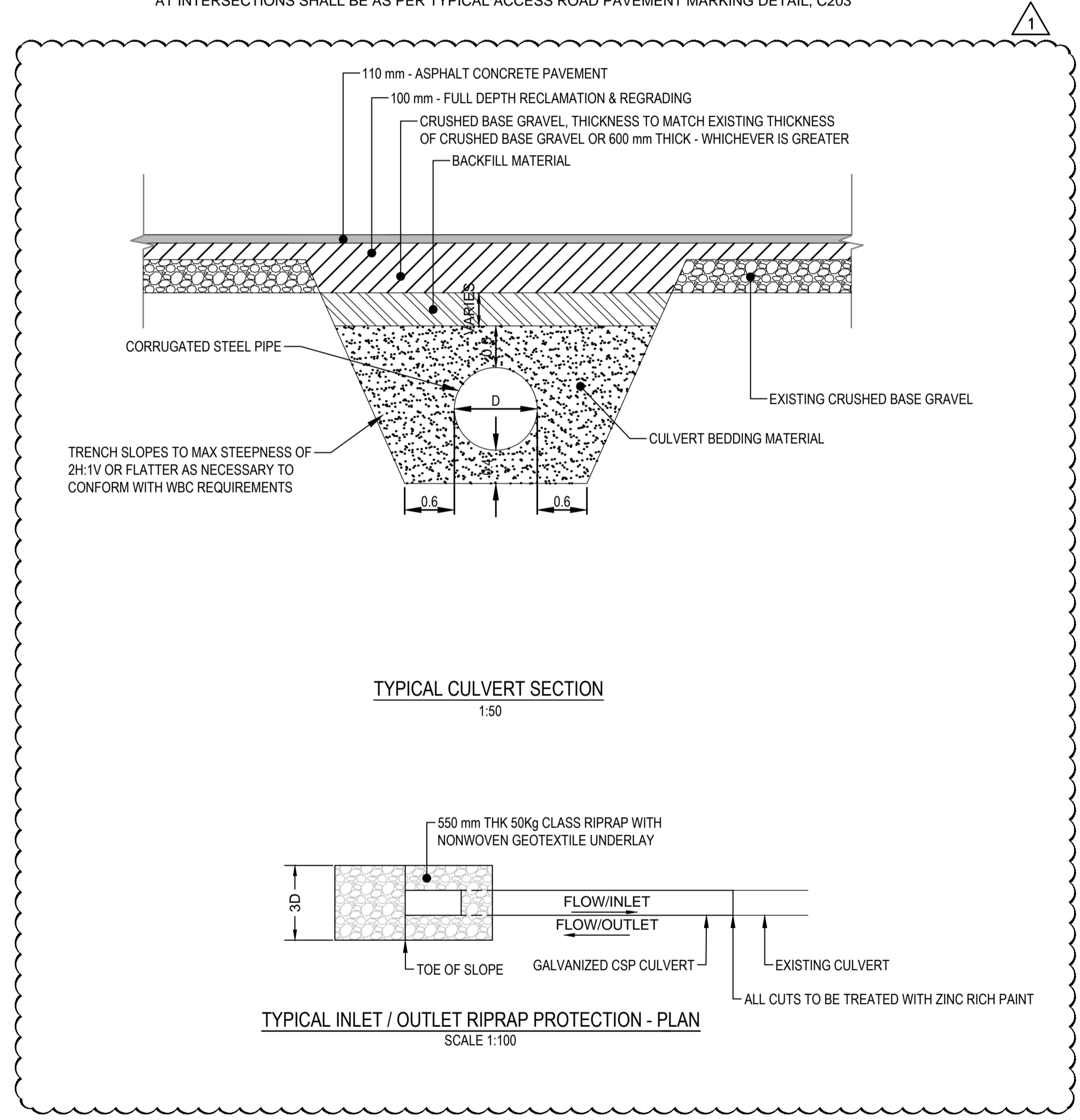

## LINE PAINTINGS ASSOCIATED WITH THIS PROJECT - CENTRELINE

START STATION	END STATION	LENGTH	LINETYPE	COLOUR	COMMENT
204+920	205+390	390	DOUBLE SOLID	YELLOW	MATCH AT START OF PROJECT
205+390	205+800	420	SOLID LT / BROKEN RT	YELLOW	
205+800	205+880	80	BROKEN	YELLOW	
205+880	206+270	390	BROKEN LT / SOLID RT	YELLOW	
206+270	206+232	1962	DOUBLE SOLID	YELLOW	
206+232	208+847	615	SOLID LT / BROKEN RT	YELLOW	
208+847	208+877	30	BROKEN	YELLOW	
208+877	209+318	441	BROKEN LT / SOLID RT	YELLOW	
209+318	209+822	504	DOUBLE SOLID	YELLOW	
209+822	210+071	249	SOLID LT / BROKEN RT	YELLOW	
210+071	210+241	170	DOUBLE SOLID	YELLOW	
210+241	210+462	221	BROKEN LT / SOLID RT	YELLOW	
210+462	210+624	162	DOUBLE SOLID	YELLOW	
210+624	211+167	543	SOLID LT / BROKEN RT	YELLOW	
211+167	211+500	333	BROKEN	YELLOW	
211+500	211+901	401	BROKEN LT / SOLID RT	YELLOW	
211+901	212+061	160	DOUBLE SOLID	YELLOW	
212+061	212+625	564	SOLID LT / BROKEN RT	YELLOW	
212+625	212+845	220	BROKEN	YELLOW	
212+845	213+257	412	BROKEN LT / SOLID RT	YELLOW	
213+257	214+229	972	DOUBLE SOLID	YELLOW	
214+229	214+512	283	SOLID LT / BROKEN RT	YELLOW	
214+512	214+723	211	DOUBLE SOLID	YELLOW	
214+723	214+945	222	BROKEN LT / SOLID RT	YELLOW	
214+945	215+105	160	DOUBLE SOLID	YELLOW	
215+105	215+528	423	SOLID LT / BROKEN RT	YELLOW	
215+528	215+599	71	BROKEN	YELLOW	
215+599	216+041	442	BROKEN LT / SOLID RT	YELLOW	
216+041	216+565	524	DOUBLE SOLID	YELLOW	
216+565	216+828	263	SOLID LT / BROKEN RT	YELLOW	
216+828	216+978	150	DOUBLE SOLID	YELLOW	
216+978	217+098	120	BROKEN LT / SOLID RT	YELLOW	
217+098	217+229	131	BROKEN	YELLOW	
217+229	217+421	192	SOLID LT / BROKEN RT	YELLOW	
217+421	217+492	71	DOUBLE SOLID	YELLOW	
217+492	217+841	349	BROKEN LT / SOLID RT	YELLOW	
217+841	218+828	987	DOUBLE SOLID	YELLOW	
218+828	219+230	402	SOLID LT / BROKEN RT	YELLOW	
219+230	219+531	301	BROKEN	YELLOW	
219+531	219+933	402	BROKEN LT / SOLID RT	YELLOW	
219+933	220+164	231	DOUBLE SOLID	YELLOW	
220+164	220+558	394	SOLID LT / BROKEN RT	YELLOW	
220+558	220+638	80	BROKEN	YELLOW	
220+638	221+030	392	BROKEN LT / SOLID RT	YELLOW	
221+030	221+120	90	DOUBLE SOLID	YELLOW	
221+120	221+502	382	SOLID LT / BROKEN RT	YELLOW	
221+502	221+522	20	DOUBLE SOLID	YELLOW	
221+502	221+903	401	BROKEN LT / SOLID RT	YELLOW	
221+903	222+144	241	DOUBLE SOLID	YELLOW	
222+144	222+367	223	SOLID LT / BROKEN RT	YELLOW	
222+367	222+567	200	DOUBLE SOLID	YELLOW	
222+567	222+756	189	BROKEN LT / SOLID RT	YELLOW	
222+756	223+339	583	DOUBLE SOLID	YELLOW	
223+339	223+744	405	SOLID LT / BROKEN RT	YELLOW	
223+744	224+075	331	BROKEN	YELLOW	
224+075	224+476	401	BROKEN LT / SOLID RT	YELLOW	
224+476	224+837	361	DOUBLE SOLID	YELLOW	
224+837	225+253	416	SOLID LT / BROKEN RT	YELLOW	
225+253	225+342	1089	BROKEN	YELLOW	
225+342	225+766	424	BROKEN LT / SOLID RT	YELLOW	
225+766	226+384	618	DOUBLE SOLID	YELLOW	
226+384	226+666	282	SOLID LT / BROKEN RT	YELLOW	
226+666	227+293	627	BROKEN	YELLOW	
227+293	227+704	411	BROKEN LT / SOLID RT	YELLOW	
227+704	227+826	122	DOUBLE SOLID	YELLOW	
227+826	228+190	364	SOLID LT / BROKEN RT	YELLOW	
228+190	228+714	524	BROKEN	YELLOW	
228+714	229+000	286	BROKEN LT / SOLID RT	YELLOW	MATCH END OF PROJECT

## LINE PAINTINGS ASSOCIATED WITH THIS PROJECT - SHOULDERS

START STATION	END STATION	LENGTH	LINETYPE	COLOUR	COMMENT
204+920	229+000	24080	SOLID	WHITE	LEFT SHOULDER LINE MATCH AT START AND END OF PROJECT
204+920	229+000	24080	SOLID	WHITE	RIGHT SHOULDER LINE MATCH AT START AND END OF PROJECT

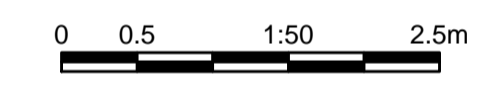
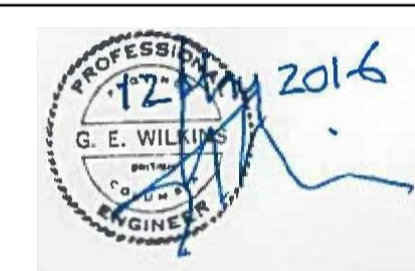

Revision/Revisión	Description/Description	Date/Date
1	ISSUED FOR ADDENDUM #1	16/05/12
0	ISSUED FOR TENDER	16/03/24

Client/client  
**PUBLIC WORKS AND GOVERNMENT SERVICES CANADA**



Project title/Titre du projet  
**KM 205 - 229 PAVEMENT REPLACEMENT ALASKA HIGHWAY, BC**

Approved by/Approve par  
G.WILKINS  
Designed by/Concept par  
E.YANG  
Drawn by/Dessine par  
A.DEEPWELL  
PWSC Project Manager/Administrateur de Projets TPSCG  
A.TAHERI  
PWSC, Architectural and Engineering Resources Manager/  
Ressources Architectural et de Directeur d'Ingénierie, TPSCG

Client/client  
**PUBLIC WORKS GOVERNMENT SERVICES CANADA**

Drawing title/Titre de dessin  
**CULVERT & PAINT MARKING DETAILS**

Project No./No. du projet	Sheet/Feuille	Revision no./Révision no.
R.0173173.803	C202 OF C204	1

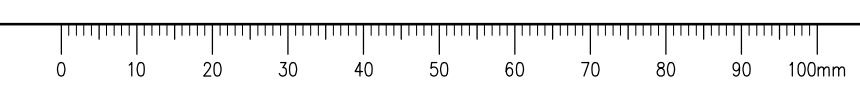

**ISSUED FOR TENDER**

GENERAL NOTES:  
1. DIMENSIONS, COORDINATES, ELEVATIONS ARE IN METRES UNLESS NOTED OTHERWISE AND RELATIVE TO GSC DATUM.

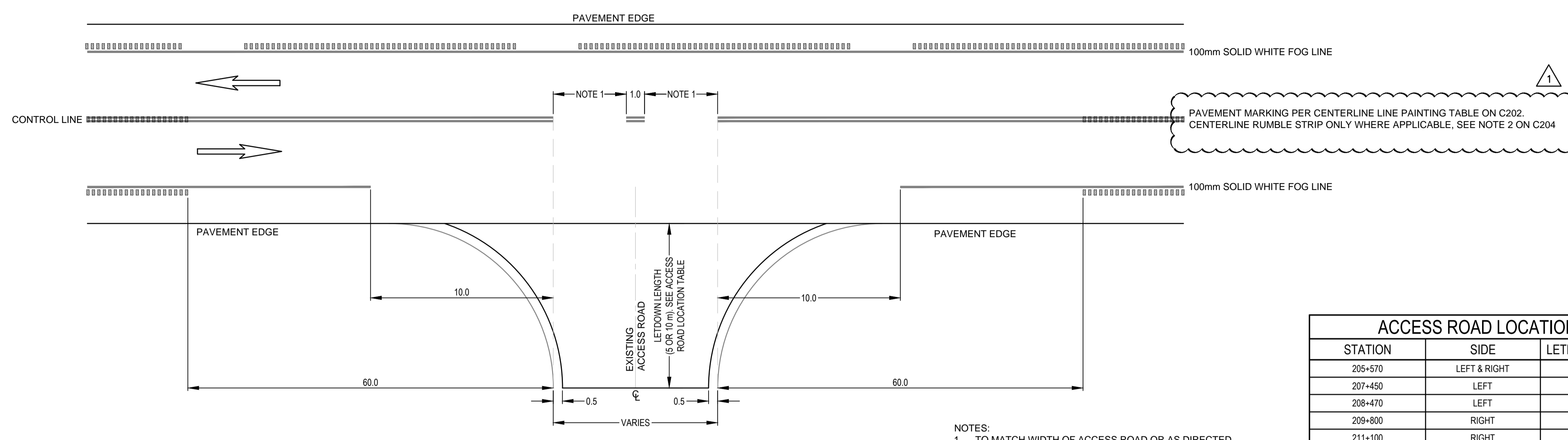

TYPICAL ACCESS ROAD PAVEMENT MARKING DETAIL  
NTS

NOTES:  
1. TO MATCH WIDTH OF ACCESS ROAD OR AS DIRECTED BY THE DEPARTMENTAL REPRESENTATIVE

ACCESS ROAD LOCATIONS		
STATION	SIDE	LETDOWN LENGTH
205+570	LEFT & RIGHT	5
207+450	LEFT	10
208+470	LEFT	10
209+800	RIGHT	5
211+100	RIGHT	5
213+400	RIGHT	10
213+450	LEFT	5
214+950	RIGHT	5
215+950	LEFT	5
217+220	LEFT	5
217+230	RIGHT	5
218+180	RIGHT	10
218+530	LEFT	5
221+940	RIGHT	5
222+810	RIGHT	5
224+850	RIGHT	5
225+560	LEFT	5
225+740	LEFT	10
225+890	RIGHT	5
225+990	LEFT & RIGHT	5
226+030	LEFT	5
226+460	RIGHT	5

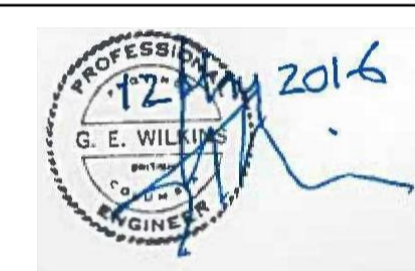

0 2 1:250 12m

Revision/Revisión	Description/Description	Date/Date
1	ISSUED FOR ADDENDUM #1	16/05/12
0	ISSUED FOR TENDER	16/03/24

**PUBLIC WORKS AND GOVERNMENT SERVICES CANADA**



Project Title/Titre du projet

**KM 205 - 229  
PAVEMENT REPLACEMENT  
ALASKA HIGHWAY, BC**

Approved by/Approve par  
G. WILKINS  
Designed by/Concept par  
E. YANG  
Drawn by/Dessine par  
A. DEEPWELL  
PWSC Project Manager/Administrateur de Projets TPSC  
A. TAHERI  
PWSC, Architectural and Engineering Resources Manager/  
Ressources Architectural et de Directeur d'Ingénierie, TPSC  
Client/client  
PUBLIC WORKS GOVERNMENT SERVICES CANADA  
Drawing Title/Titre du dessin

**ACCESS ROAD & ASPHALT PAVEMENT  
OVERLAY TIE-IN DETAILS**

Project No./No. du projet	Sheet/Feuille	Revision no./Révision no.
R.0173173.803	<b>C203</b> OF C204	<b>1</b>

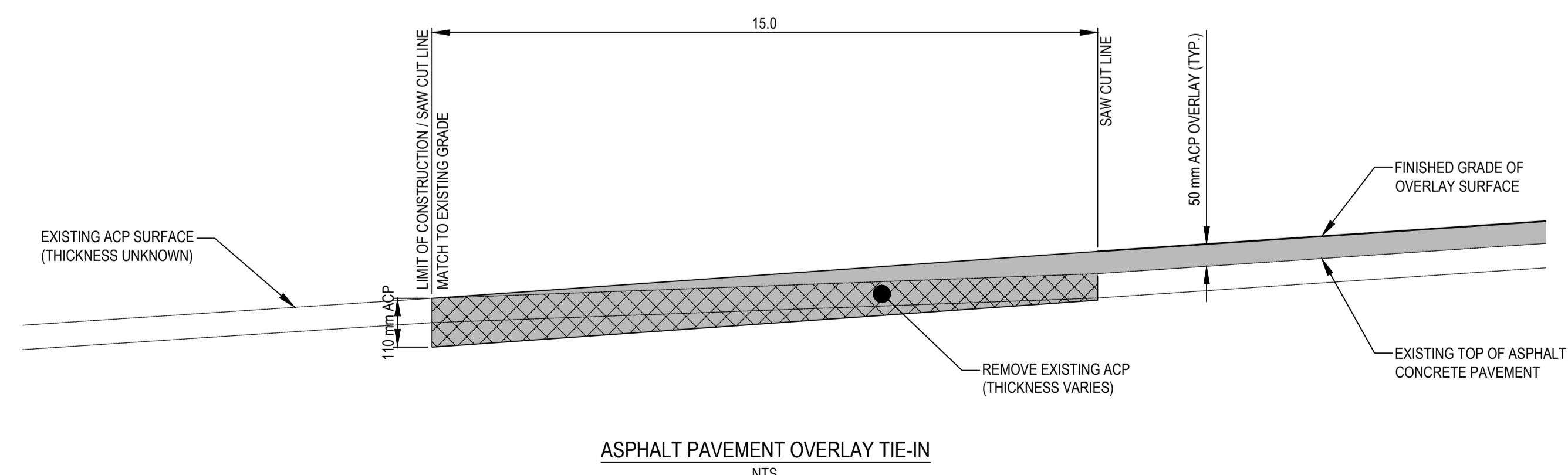

ASPHALT PAVEMENT OVERLAY TIE-IN  
NTS

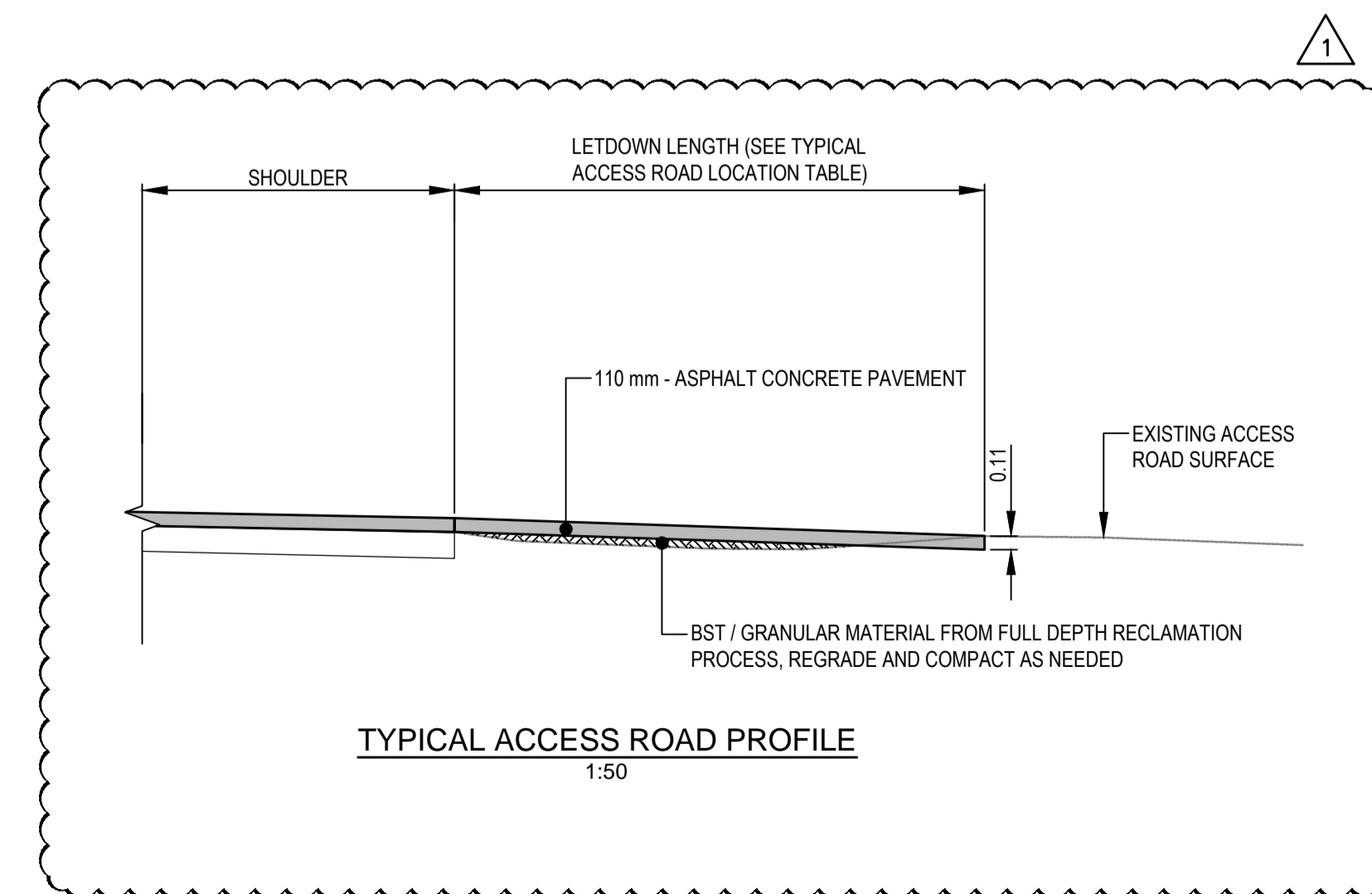

TYPICAL ACCESS ROAD PROFILE  
1:50

Q:\VancouverTransportation\TRN\VHWY03007-01 - Alaska Highway Km 205 - 235\CADD\2016 03 24 Issued for Tender - Amendment 1\C201-203 TYPICAL SECTIONS & DETAILS.dwg [C203] May 13, 2016 - 9:17:04 am (BY: DEEPWELL, ANDREW)

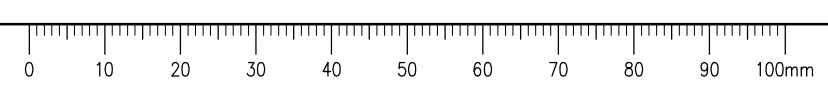



**ISSUED FOR TENDER**

GENERAL NOTES:  
1. DIMENSIONS, COORDINATES, ELEVATIONS ARE IN METRES UNLESS NOTED OTHERWISE AND RELATIVE TO GSC DATUM.

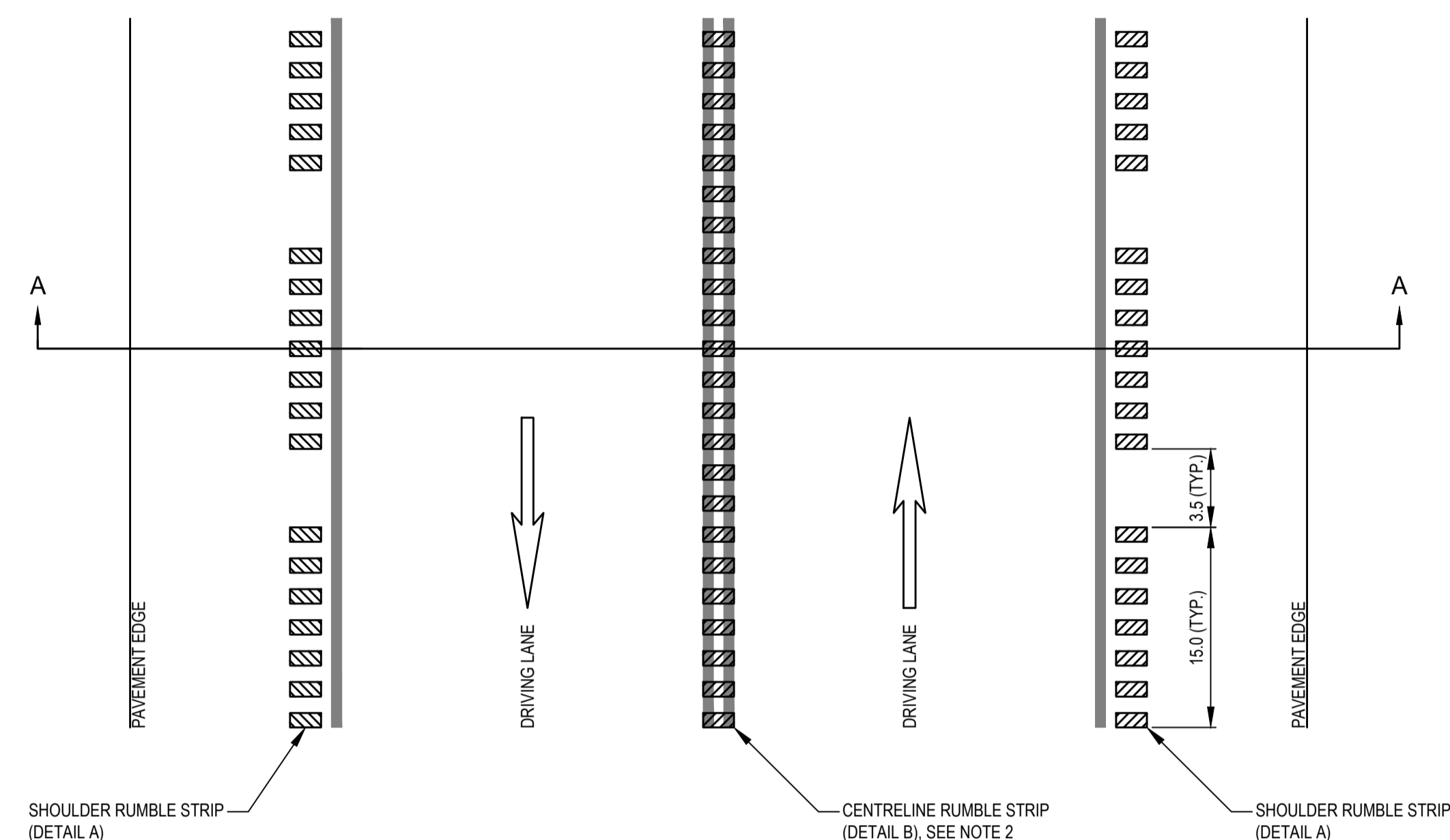

TYPICAL RUMBLE STRIPS  
NTS

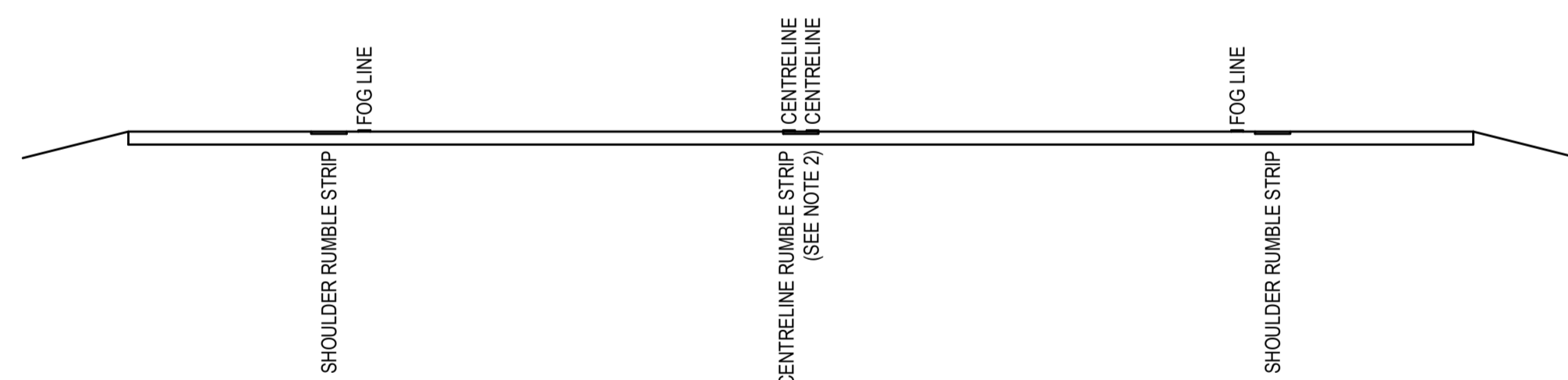

SECTION A-A RUMBLE STRIPS AND PAINT LINES  
NTS

- NOTES:
- SHOULDER RUMBLE STRIP TO BE INSTALLED WITHIN LIMITS OF CONSTRUCTION EXCEPT AT ACCESS ROAD LOCATIONS SHOWN ON ACCESS ROAD LOCATIONS TABLE ON C203
  - CENTRELINE RUMBLE STRIP TO BE INSTALLED FROM STA. 207+280 TO 207+720 EXCLUDING ACCESS ROAD, SEE TYPICAL ACCESS ROAD PAVEMENT MARKING DETAIL ON C203

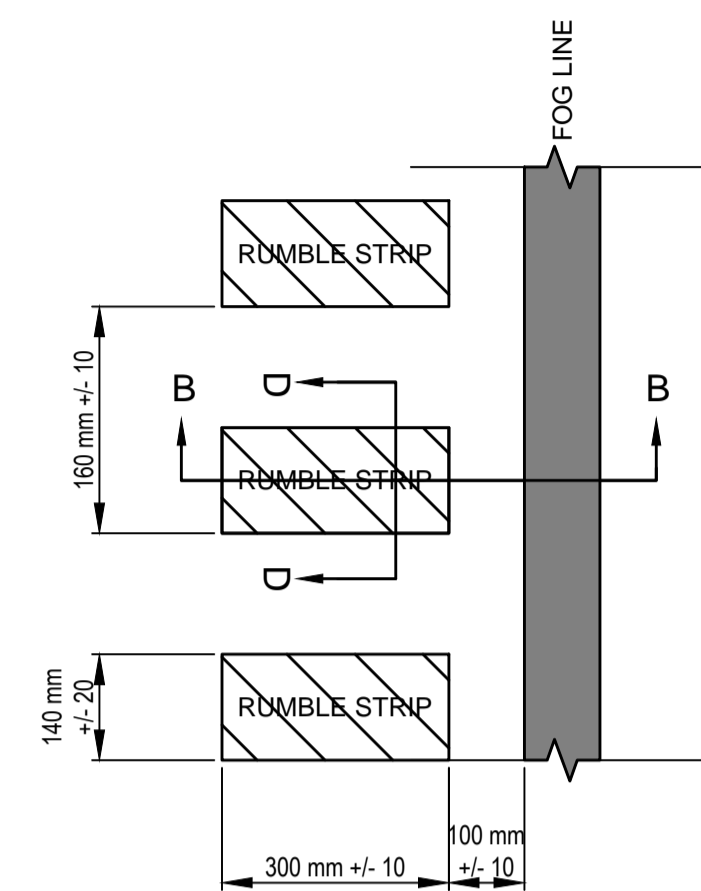

DETAIL A - SHOULDER RUMBLE STRIP  
(LEFT SIDE SHOWN, RIGHT SIDE MIRROR)  
1:10

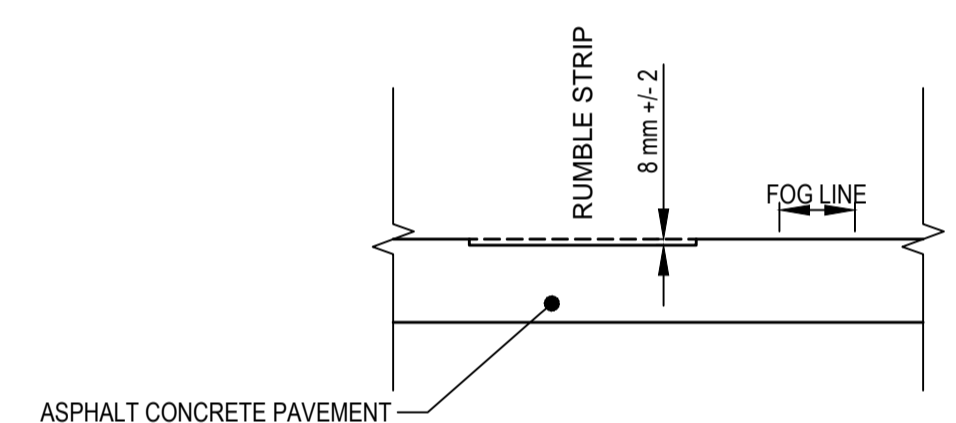

SECTION B-B SHOULDER RUMBLE STRIP  
1:10

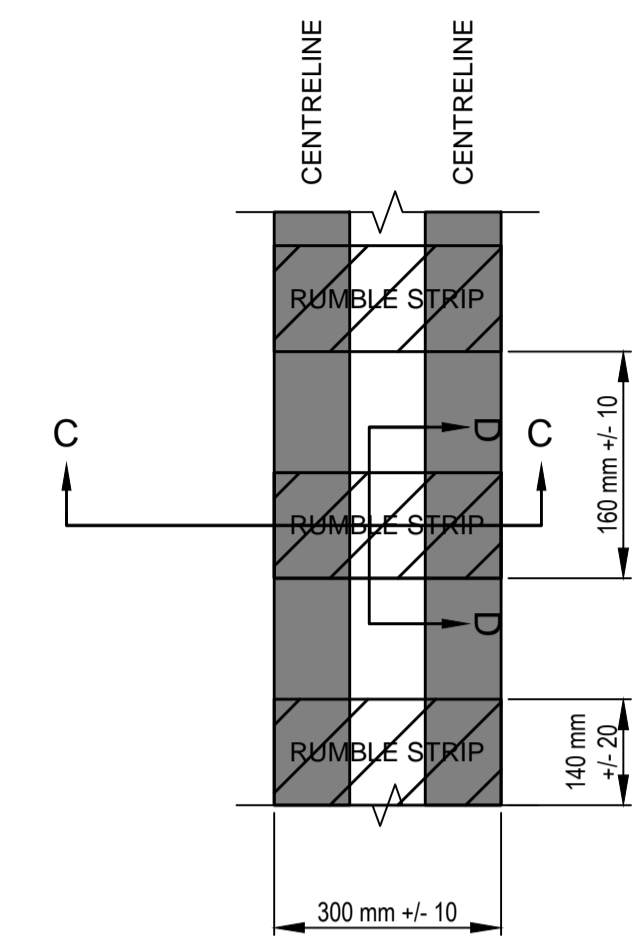

DETAIL B - CENTRELINE RUMBLE STRIP  
1:10

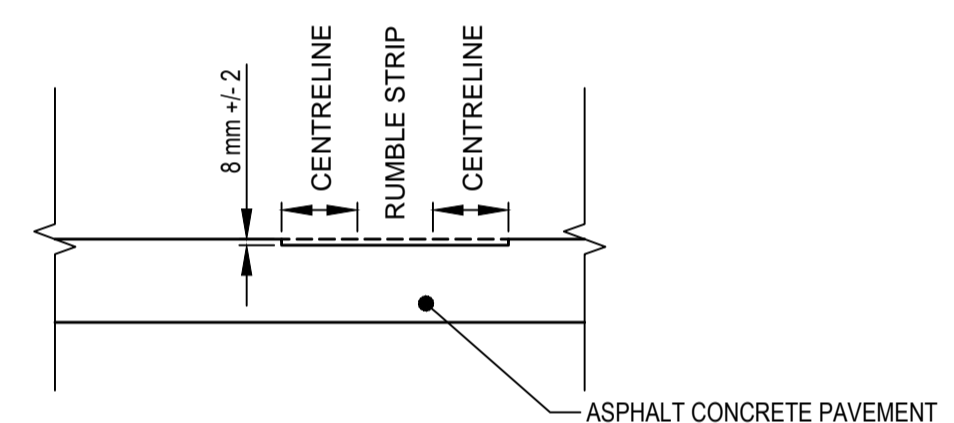

SECTION C-C CENTRELINE RUMBLE STRIP  
1:10

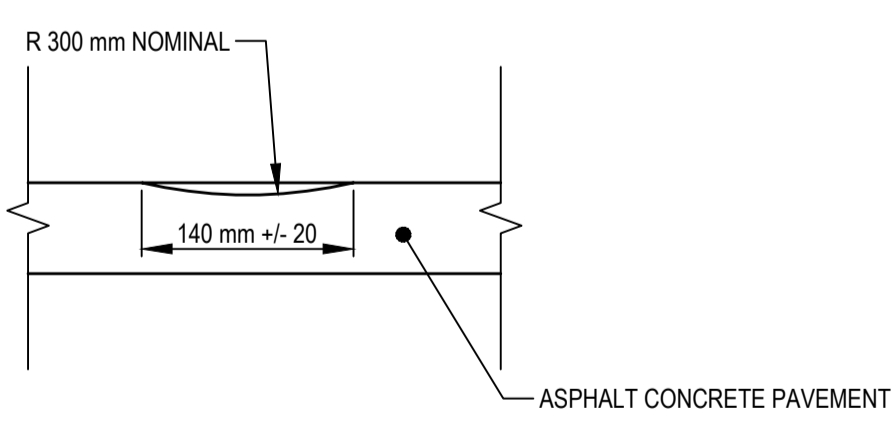

SECTION D-D  
1:5

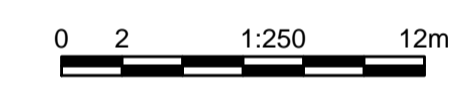

Revision/Revisión	Description/Description	Date/Date
1	ISSUED FOR ADDENDUM #1	16/05/12
0	ISSUED FOR TENDER	16/03/24

Client/client  
**PUBLIC WORKS AND GOVERNMENT SERVICES CANADA**



Project title/Titre du projet  
**KM 205 - 229 PAVEMENT REPLACEMENT ALASKA HIGHWAY, BC**

Approved by/Approve par  
G. WILKINS

Designed by/Concept par  
E. YANG

Drawn by/Dessine par  
A. DEEPWELL

PWSC Project Manager/Administrateur de Projets TPSCG  
A. TAHERI

PWSC, Architectural and Engineering Resources Manager/  
Ressources Architectural et de Directeur d'Ingénierie, TPSCG

Client/client  
PUBLIC WORKS GOVERNMENT SERVICES CANADA

Drawing title/Titre du dessin  
**RUMBLE STRIP DETAILS**

Project No./No. du projet	Sheet/Feuille	Revision no./Révision no.
R.0173173.803	<b>C204</b> OF C204	<b>1</b>

