

SMALL CRAFT HARBOURS
CENTRAL AND ARCTIC REGION

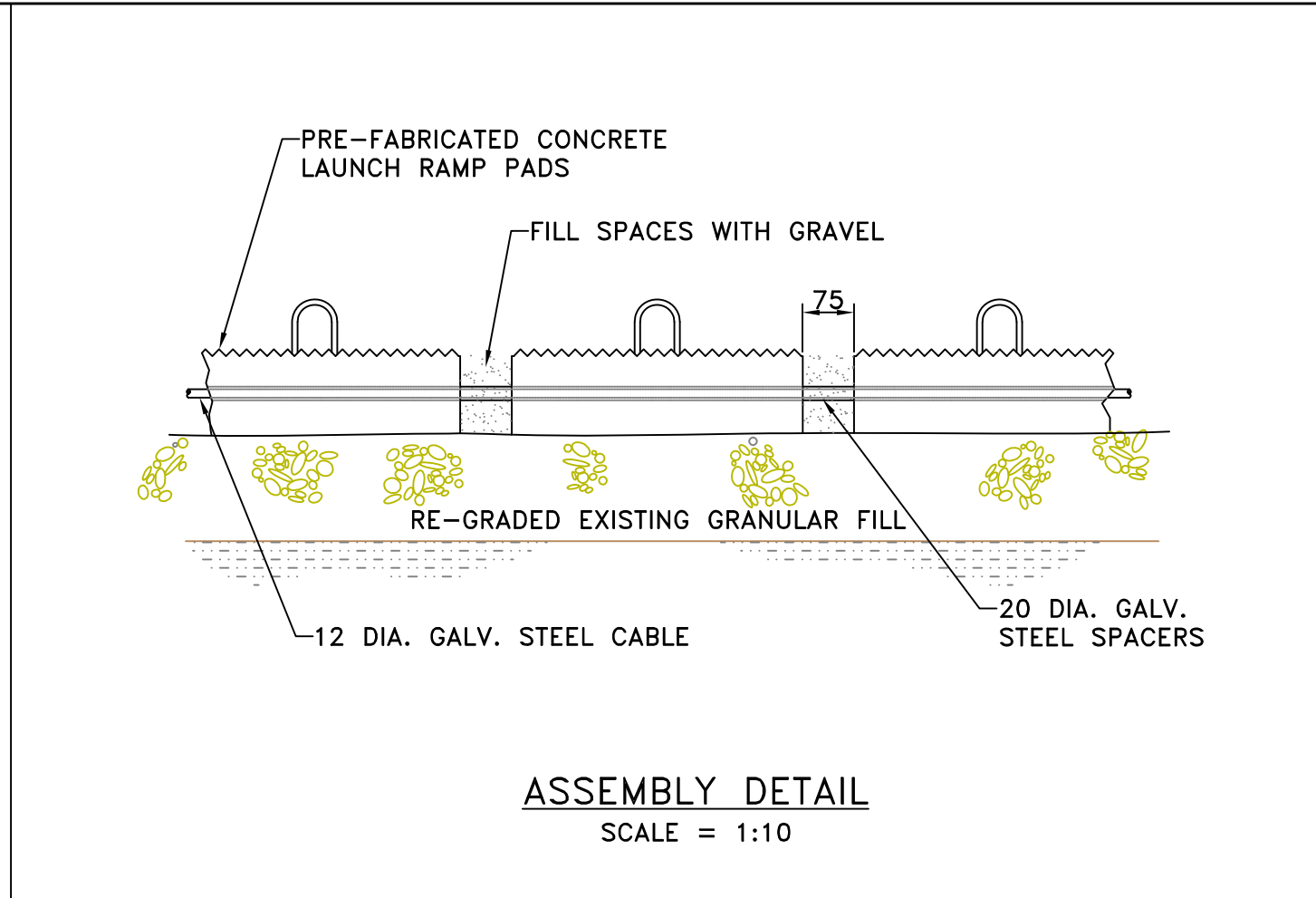

- NOTES:
- DIMENSIONS ARE IN MILLIMETRES UNLESS OTHERWISE STATED
 - ELEVATIONS ARE GIVEN USING THE CANADIAN VERTICAL GEODETIC DATUM OF 1927 (CVGD27)
 - SCH TO SUPPLY TRANSITION PLATE AND HINGE BOLTS REQUIRED FOR FLOAT CONNECTION CONTRACTOR TO PICK UP TRANSITION PLATE AND HINGE BOLTS AT 501 UNIVERSITY CRESCENT, WINNIPEG AND INSTALL ON SITE

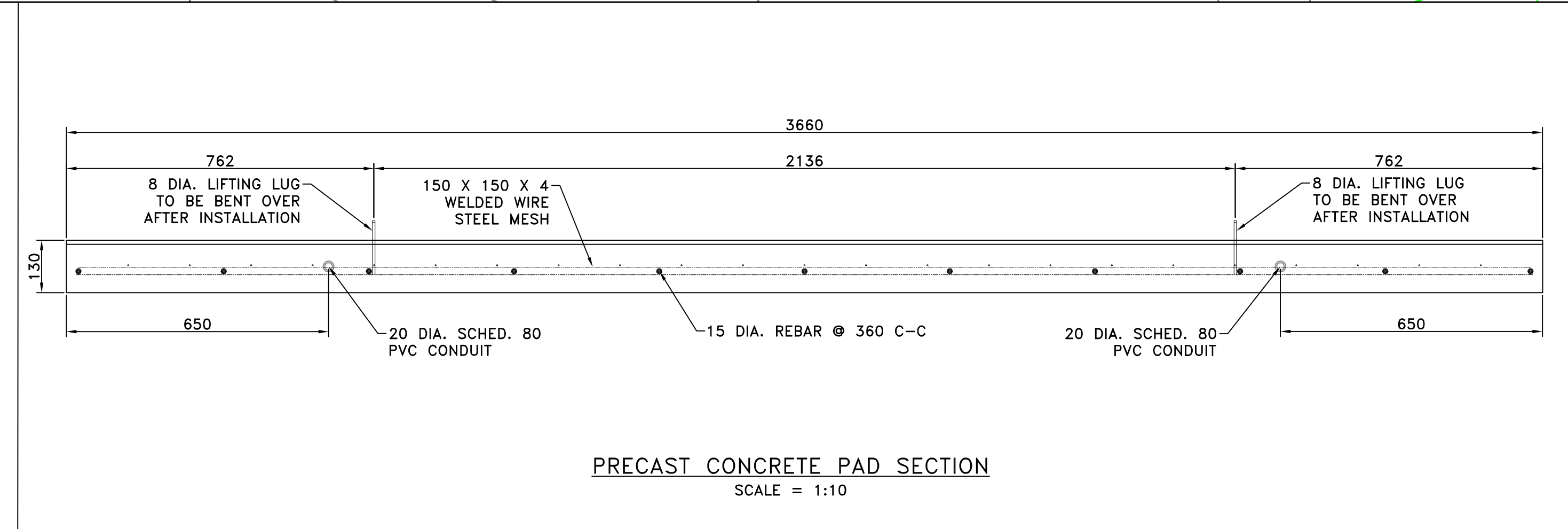
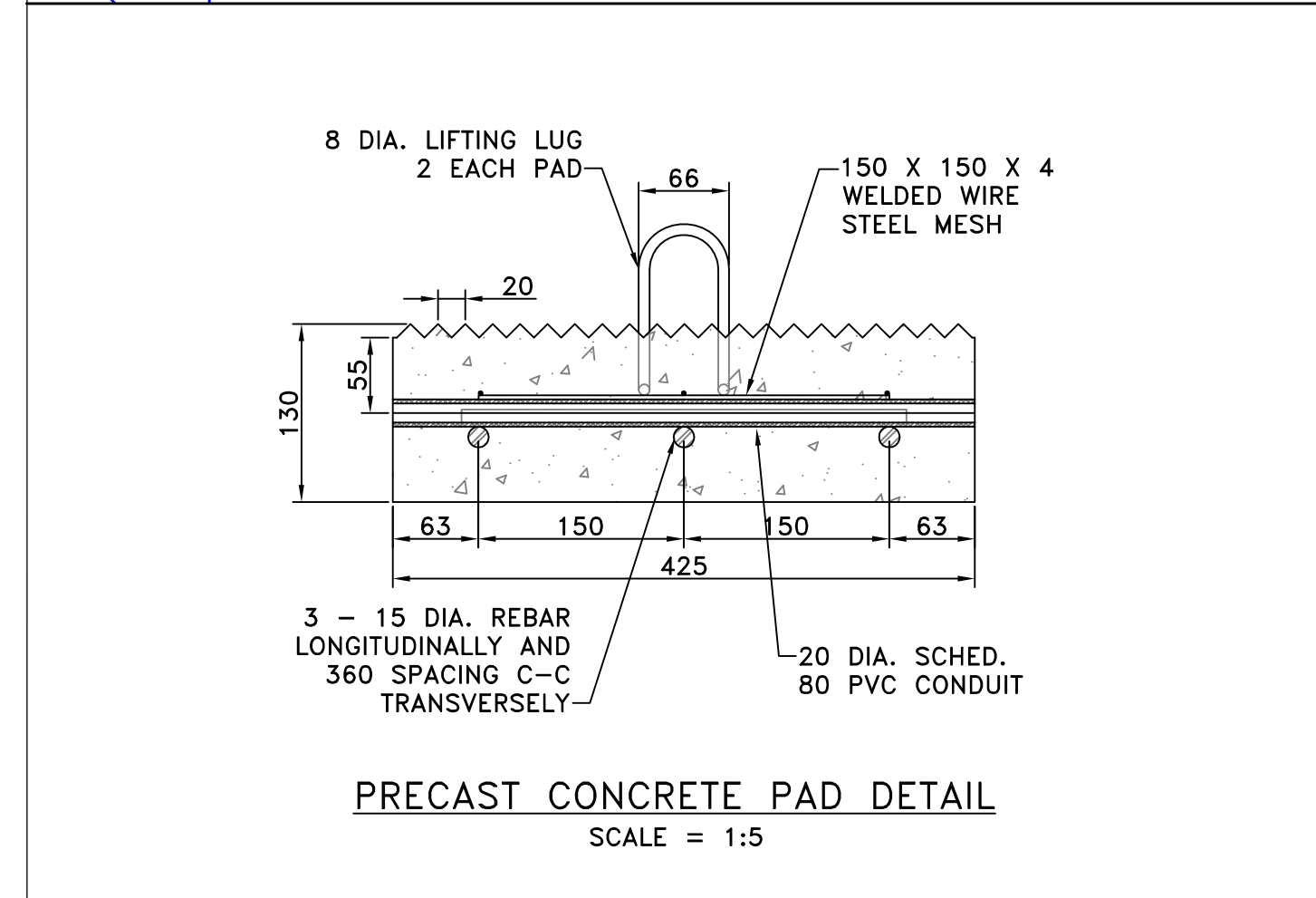
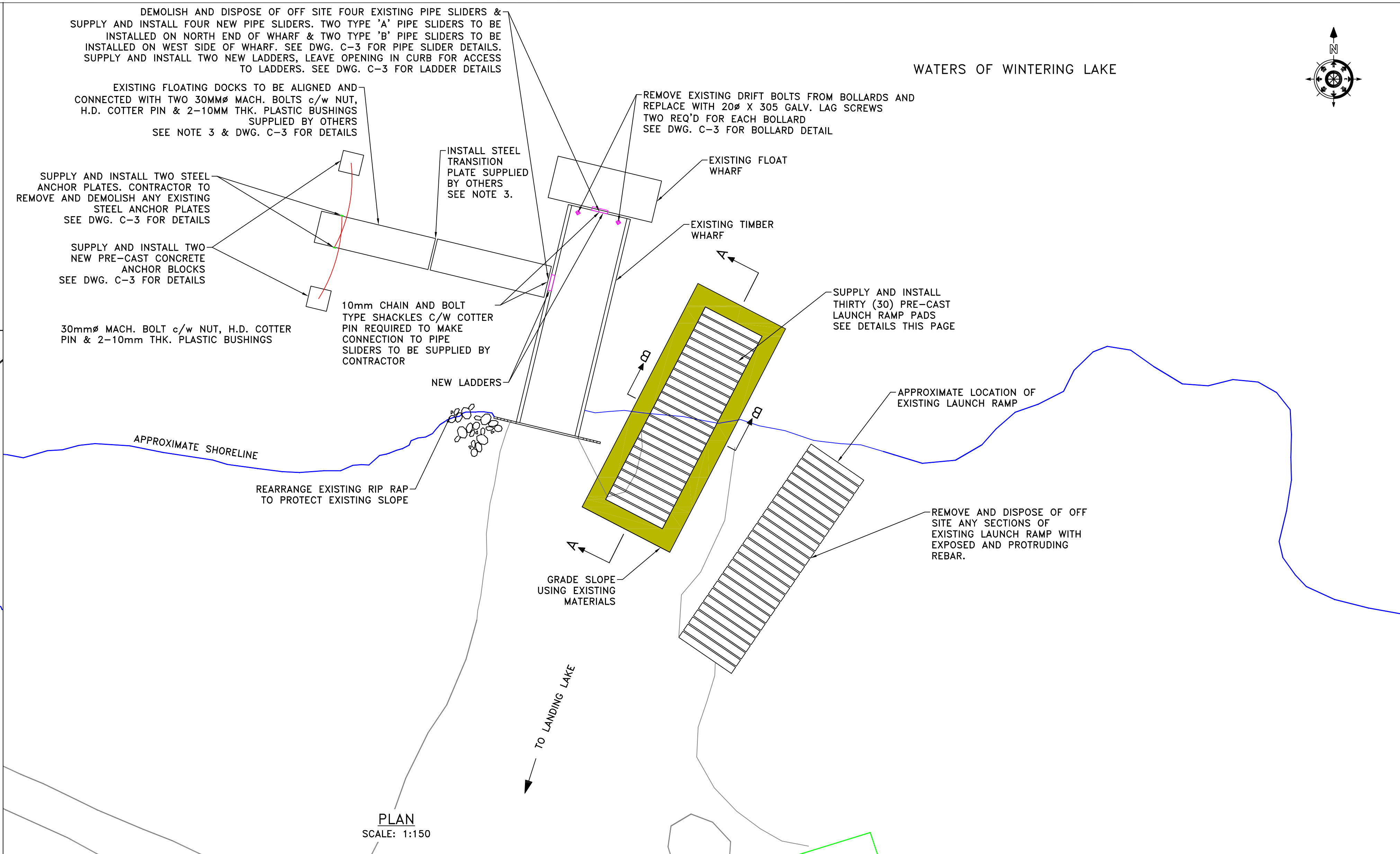
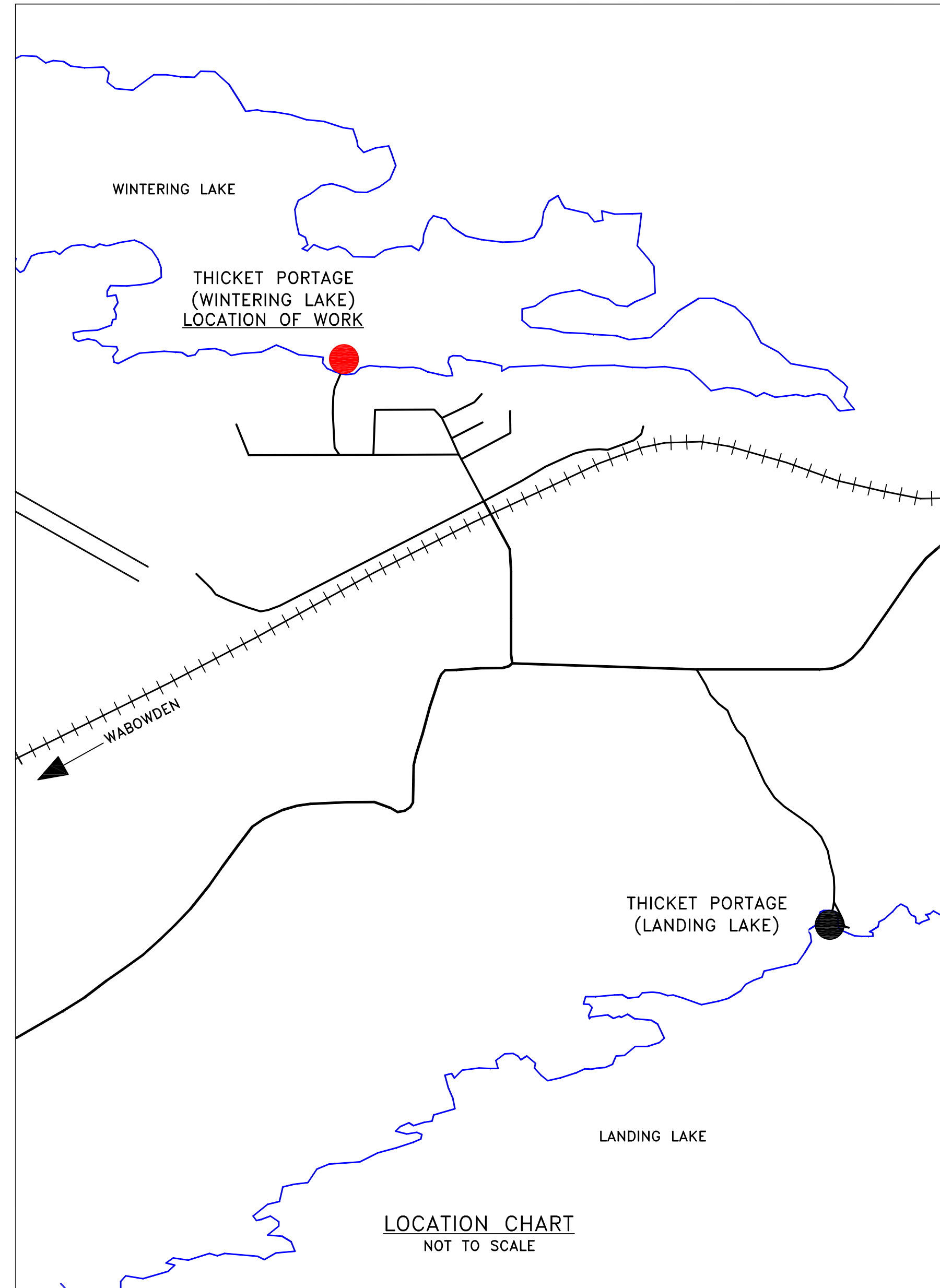

REVISIONS:	DATE:
0 ISSUED FOR TENDER	APRIL 2016

SCALE: AS SHOWN CLASS:

PROJECT:

HARBOUR IMPROVEMENTS

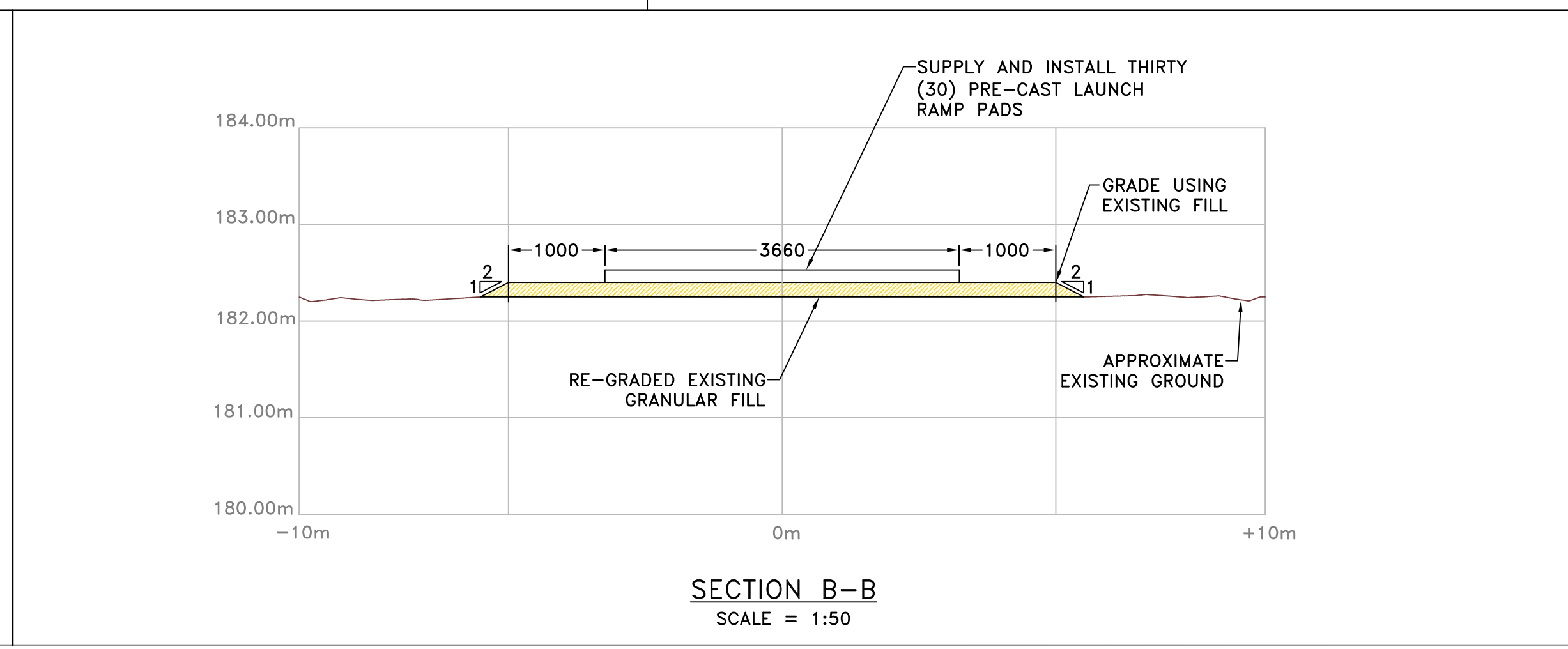
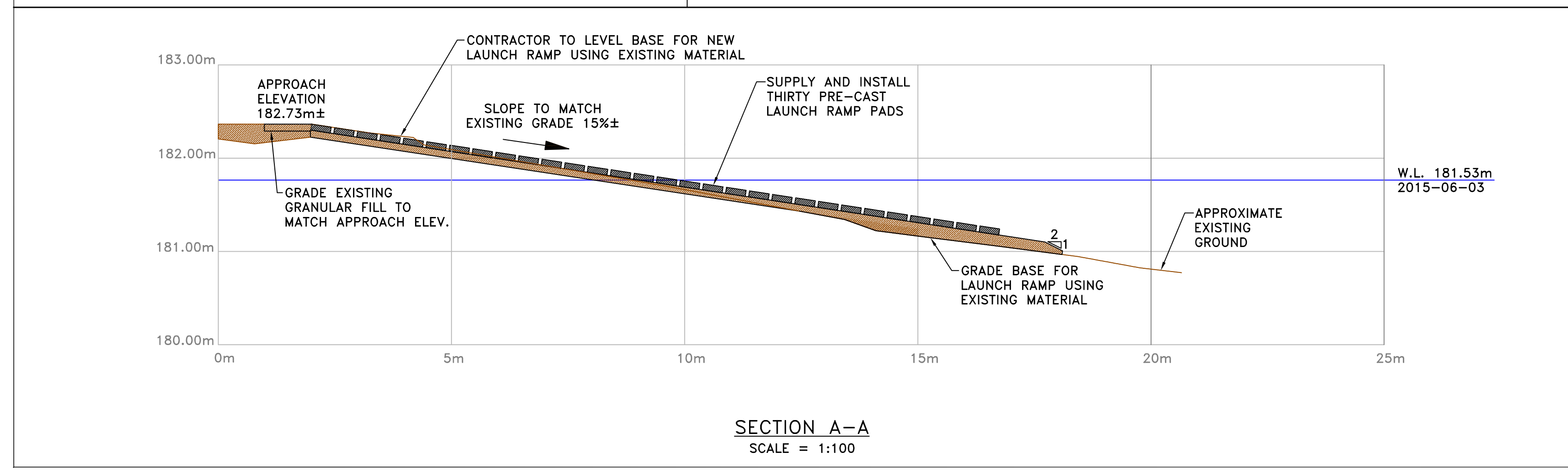

DESCRIPTION:
PLAN AND CONSTRUCTION DETAILS

DRAWN: D.S.	APPROVED: A.B.
DATE: APRIL 2016	DATE: APRIL 2016

LOCATION:
THICKET PORTAGE (WINTERING LAKE) MANITOBA

DRAWING NO.: C-2 OF 4	LOCATOR CODE: 5546
-----------------------	--------------------