

Project # 133375-2
 Natural Resources Canada
 Bells Corners Building 2
 Panels
 Date: July 7, 16

NOTES:

Panels cannot exceed 54" in height.
 Panels consist of base panel with add on.
 Supplier is responsible to include all connecting
 and finishing hardware for the panels.

Base panels must be available with fabric and/or
 Laminate tiles

All add on frames to be finished with frosted glass tiles.

Frame Design Legend:

AA53 - Both base tiles in laminate with frosted glass
 in add on (Stack on) frame.

BB53 - Both base tiles in fabric with frosted glass
 in add on (stack on) frame.

CB53 - 1 base tile in laminate, opposite tile in fabric,
 frosted glass in add on (Stack on) frame.

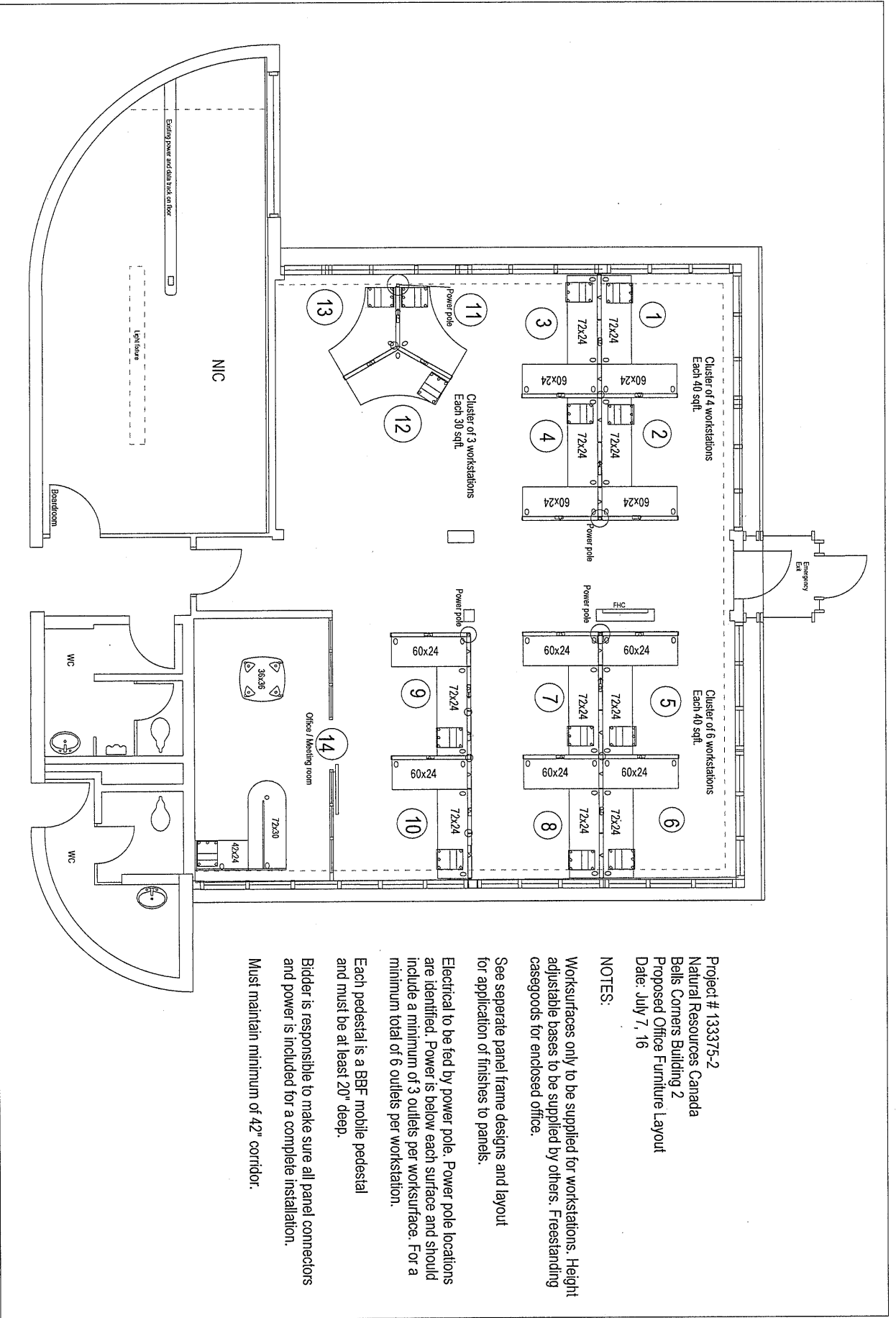

Project # 133375-2
 Natural Resources Canada
 Bells Corners Building 2
 Proposed Office Furniture Layout
 Date: July 7, 16

NOTES:

Worksurfaces only to be supplied for workstations. Height adjustable bases to be supplied by others. Freestanding casegoods for enclosed office.

See separate panel frame designs and layout for application of finishes to panels.

Electrical to be fed by power pole. Power pole locations are identified. Power is below each surface and should include a minimum of 3 outlets per worksurface. For a minimum total of 6 outlets per workstation.

Each pedestal is a BBF mobile pedestal and must be at least 20" deep.

Bidder is responsible to make sure all panel connectors and power is included for a complete installation.

Must maintain minimum of 42" corridor.