

TEMPORARY BENCH MARKS

T.B.M. #	ELEVATION (m)	DESCRIPTION
TBM #3	111.61	CUT COSS ON CONCRETE BASE OF FLAG POLE

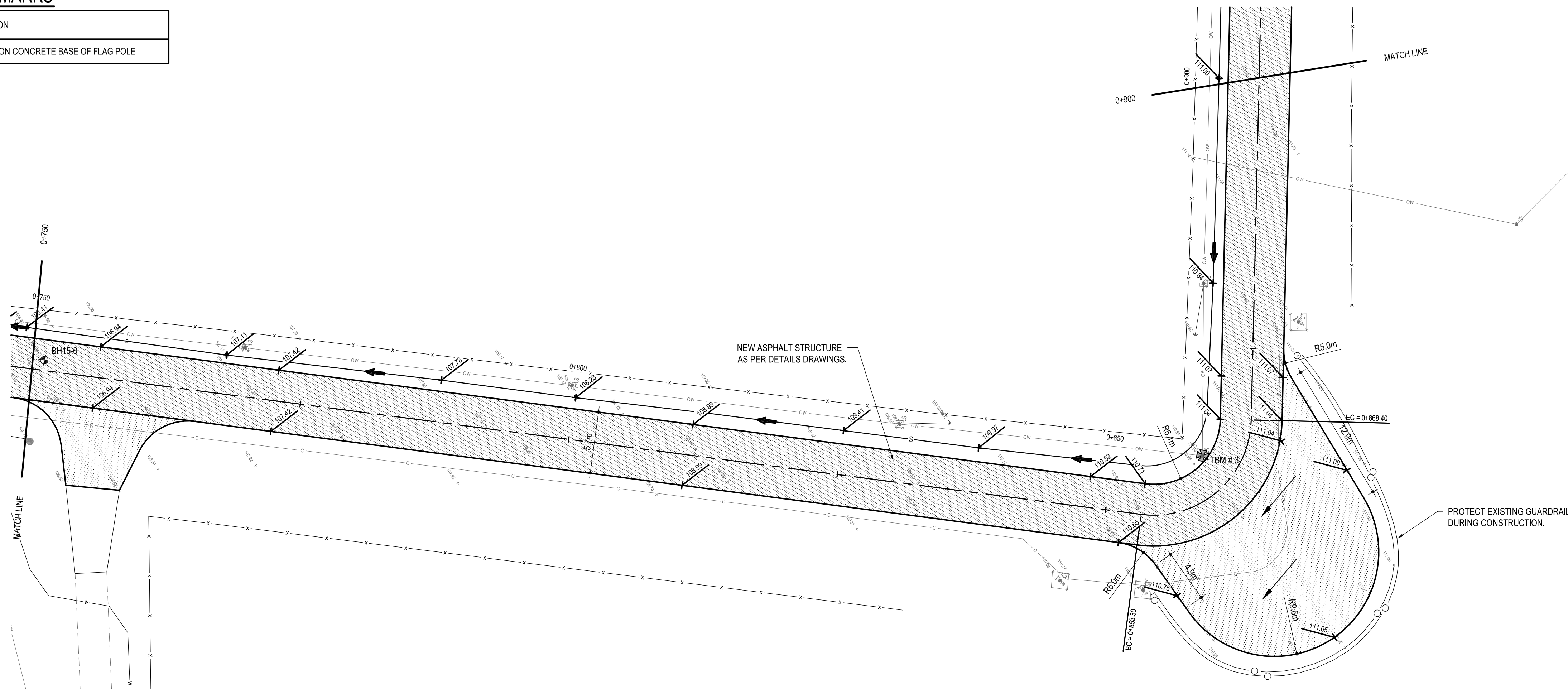

NOTES:

- CONTRACTOR TO VERIFY LOCATION OF ALL BURIED SERVICES PRIOR TO START OF CONSTRUCTION
- TOPOGRAPHIC INFORMATION PROVIDED BY LESLIE M. HIGGINSON SURVEYING LTD.
- ELEVATIONS ARE GEODETIC
- ALL DISTURBED AREAS TO BE REINSTATED USING 100mm OF TOPSOIL AND SOD UNLESS OTHERWISE NOTED.

LEGEND:

	EXISTING CENTERLINE OF ROAD
	EXISTING EDGE OF PAVEMENT
	EXISTING CONCRETE BARRIER
	EXISTING GRAVEL ROAD
	EXISTING SWALE
	NEW SWALE
	EXISTING TOP OF SLOPE
	NEW TOP OF SLOPE
	EXISTING BOTTOM OF SLOPE
	EXISTING FENCE
	EXISTING GUARD RAIL
	EXISTING SANITARY SEWER
	EX. ABANDONED SANITARY SEWER
	EXISTING STORM SEWER
	NEW STORM SEWER
	EXISTING WATER
	EXISTING ABANDONED WATER
	EXISTING ABANDONED STEAM
	EXISTING BELL LINE
	EXISTING CABLE LINE
	EXISTING GAS LINE
	EXISTING UNDERGROUND CONDUIT
	EX. ABANDONED UNDERGROUND CONDUIT
	EXISTING OVERHEAD WIRE
	EXISTING SANITARY MANHOLE
	EXISTING STORM MANHOLE
	EXISTING CATCH BASIN
	NEW CATCH BASIN
	EXISTING HYDRANT
	EXISTING UTILITY POLE
	EXISTING LIGHT STANDARD
	EXISTING CAMERA TOWER
	EXISTING CAMERA CABINET
	EXISTING BOLLARD
	EXISTING FLAG POLE
	EXISTING GUY WIRE
	EXISTING BORE HOLE LOCATION
	EXISTING BENCHMARK
	EXISTING CONCRETE SIDEWALK
	NEW GRADE
	EXISTING BUILDING
	EXISTING CONCRETE BASE/PAD
	NEW ASPHALT (RECLAMATION)
	NEW ASPHALT (LIGHT DUTY)
	NEW ASPHALT (FULL DEPTH RECONSTRUCTION)

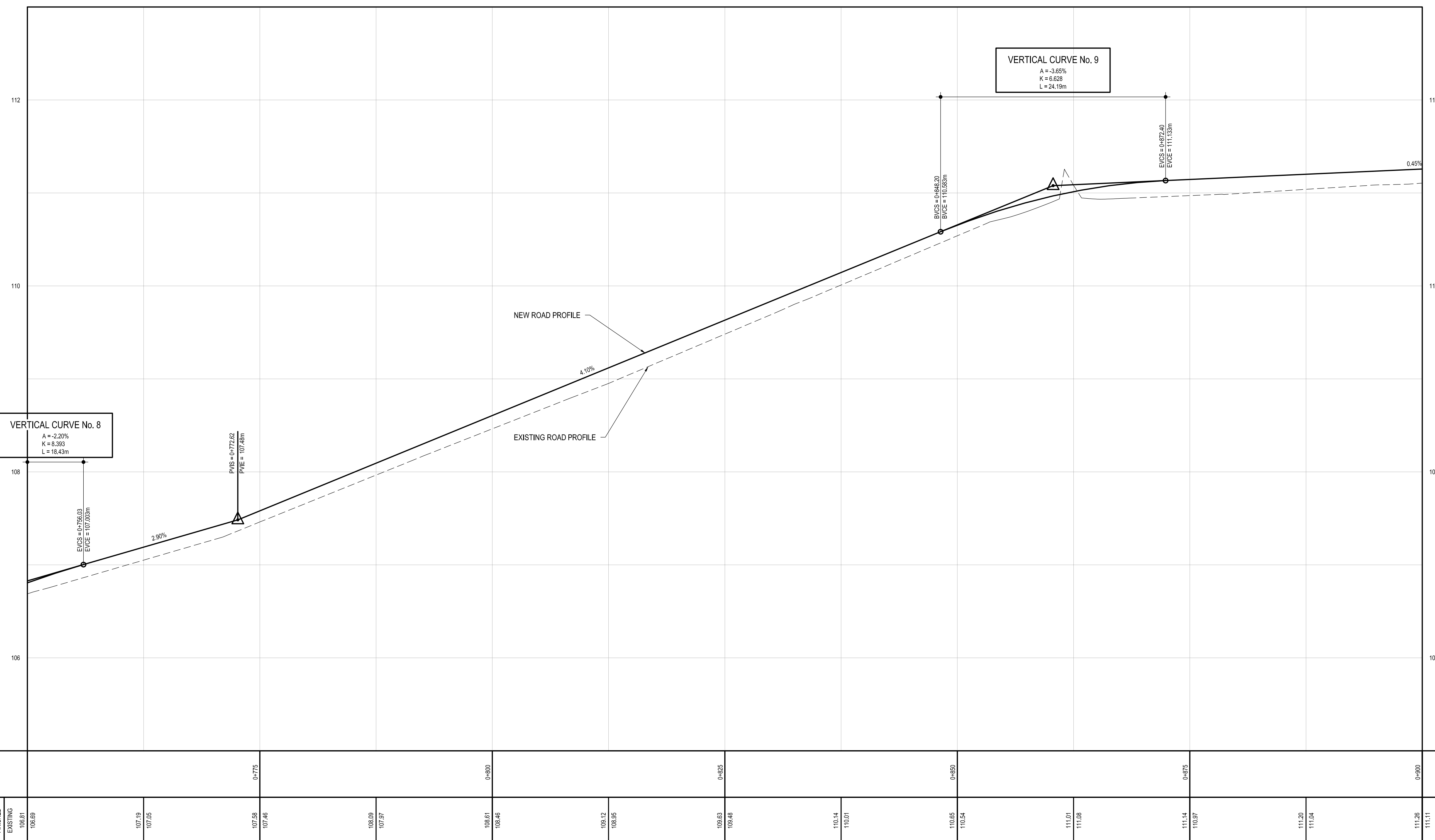

consultant



1224 GARDINERS ROAD, SUITE 201
KINGSTON, ONTARIO
CANADA K7P 0G2
PHONE: 613-634-7373 FAX: 613-634-3523
WWW.WSPGROUP.COM

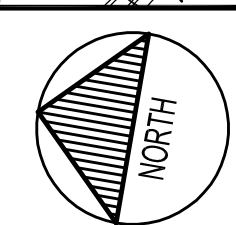
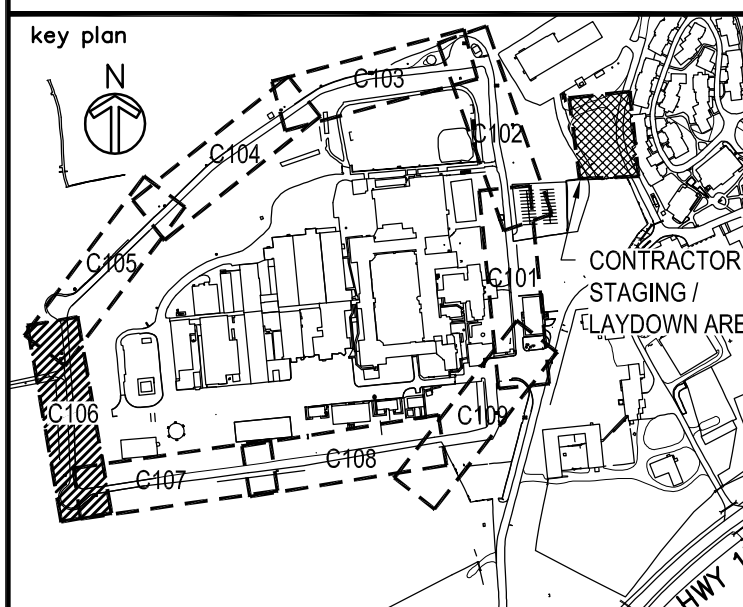

04		
03		
02		
01	ISSUED FOR TENDER	06-27-16
revision		date

Do not scale drawings.
Verify all dimensions and conditions on site and immediately
notify the Departmental Representative of all discrepancies.

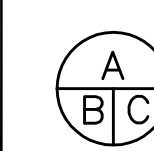

A Detail No.
No. du détail
B drawing no. - where detail required
dessin no. - où détail exigé
C drawing no. - where detailed
dessin no. - où détaillé

project title
titre du projet
KINGSTON Ontario
CORRECTIONAL SERVICE OF CANADA
JOYCEVILLE INSTITUTION
HIGHWAY. 15, NO. 376
RESURFACE PERIMETER ROAD

drawing title
titre du dessin
**PERIMETER ROAD
PLAN & PROFILE**
FROM STA 0+750 TO 0+900

drawn by
dessiné par **STEPHANIE T-RUMSEY**

designed by
conc par **IAN CHORNOBY / MATT SCANLAN**

approved by
approuvé par **MATT MORKEM**

bid
offre project manager
administrateur de projets

project date
date du projet **JUNE 2016**

project no.
no. du projet **R.078391.001**

drawing no.
dessiné no. **C-106**