

CONTRACT 16012
CYPRUS LAKE ROAD RECAPITALIZATION
PARKS CANADA
BRUCE PENINSULA NATIONAL PARK
JULY 2016

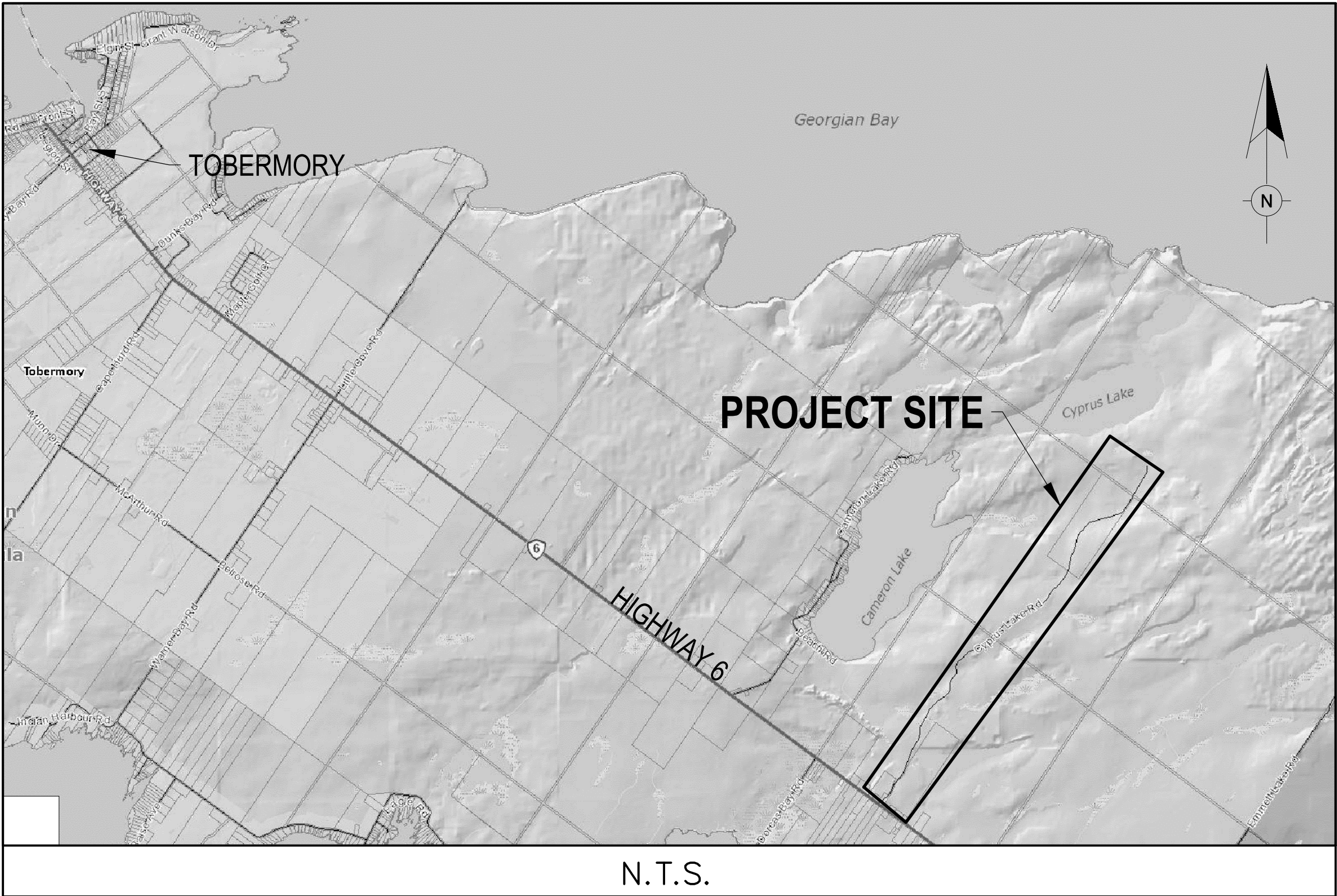

DRAWING INDEX	
DRAWING No.	DRAWING NAME
16012-01	TITLE SHEET AND INDEX
16012-02	PLAN VIEW STA 0+000 – 0+675 AND DETAILS
16012-03	PLAN VIEW STA 0+675 – 1+350 AND DETAILS
16012-04	PLAN VIEW STA 1+350 – 2+025 AND DETAILS
16012-05	PLAN VIEW STA 2+025 – 2+725 AND DETAILS
16012-06	PLAN VIEW STA 2+725 – 3+400 AND DETAILS
16012-07	PLAN VIEW STA 3+400 – 4+075 AND DETAILS
16012-08	PLAN VIEW STA 4+075 – 4+717 AND DETAILS
16012-09	PLAN VIEW STA 4+717 – 5+350 AND DETAILS

DRAWING INDEX	
DRAWING No.	DRAWING NAME
16012-10	PLAN VIEW STA 5+350 – 5+455 AND DETAILS
16012-11	CROSS SECTIONS STA 0+018.45 – 5+406
16012-12	ROAD CROSS SECTIONS, STANDARDS AND DETAILS
16012-13	ECO-STRUCTURE CROSS SECTIONS, STANDARDS AND DETAILS
16012-14	GENERAL NOTES

3	07/18/16	TENDER ISSUE	T.D.L.	J.T.G.
2	07/08/16	2ND SUBMISSION	T.D.L.	JD
1	06/03/16	FOR REVIEW	T.D.L.	
NO.	DATE	DESCRIPTION	Drawn by Dessine par	Approved Approuvé

REVISIONS

ENGINEERING
CONSULTANTS LTD.

Unit 104D
1010 9th Ave. West
Owen Sound, On
N4K 5R7

Parcs
Canada

Parks
Canada

Canada

PARKS CANADA
EASTERN ONTARIO FIELD UNIT

Type of Record /
Type d'enregistrement

Project title / Titre du projet
CYPRUS LAKE ROAD
RECAPITALIZATION

Drawing title / Titre du dessin
TITLE SHEET &
INDEX

Plot Scale / Echelle
1:500 (Arch D 24x36 Plot Size)

Drawn by/ Dessine par
T.D.L.

Date
07/18/2016

Field Recording by /
Releve-Témoin par
N/A

Date
N/A

Approved by / Approuvé par
J.T.G.

Date
07/18/2016

Checked by/ Verifié par
J.D.

Date
07/18/2016

Project No./ No. du projet
16012

Asset No.
??

Sheet No./
Feuille No.

16012-01

01

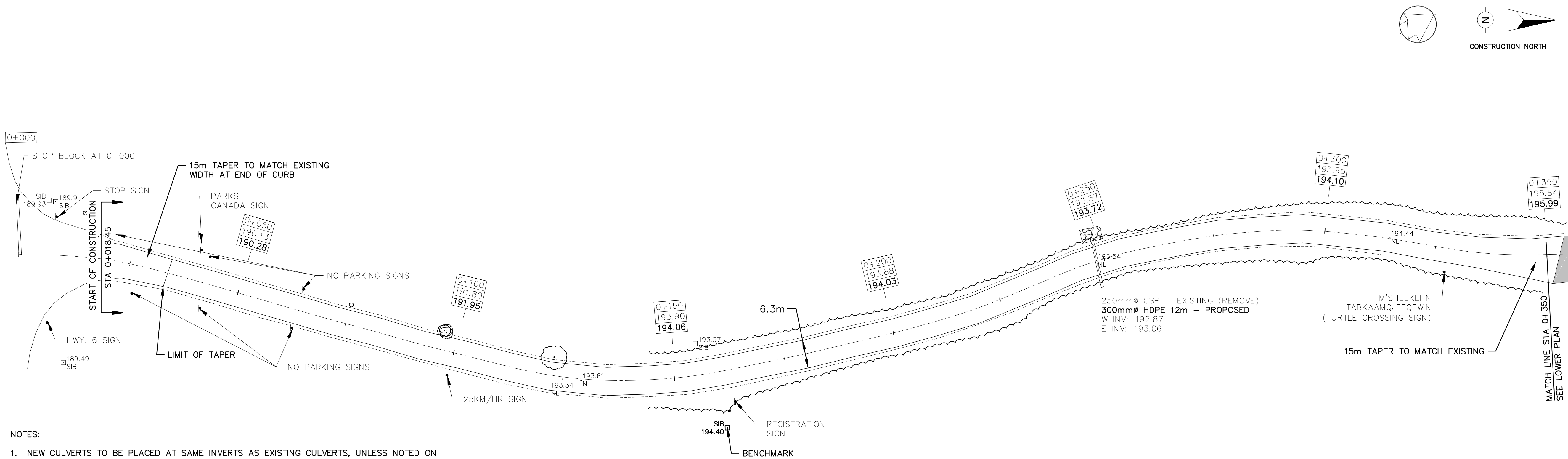

NOTES:

1. NEW CULVERTS TO BE PLACED AT SAME INVERTS AS EXISTING CULVERTS, UNLESS NOTED ON DRAWING. INVERT ELEVATIONS SHOWN ARE EXISTING.
2. PROPOSED CENTRELINE ELEVATIONS ARE TOP OF ASPHALT.
3. MINIMUM 300mm COVER ON ALL CULVERTS.
4. ROCK EXCAVATION WILL NOT BE REQUIRED FOR ROADWAY WIDENING OR ROADSIDE DITCHES. IT MAY BE REQUIRED FOR PLACING OF CULVERTS OR ECO-STRUCTURES.
5. FOR ADDITIONAL NOTES SEE DRAWING 16012-14.
6. ALL TREES WITHIN CLEARING AND GRUBBING LIMITS MARKED SPECIFICALLY BY PARKS CANADA STAFF **SHALL NOT** BE REMOVED.

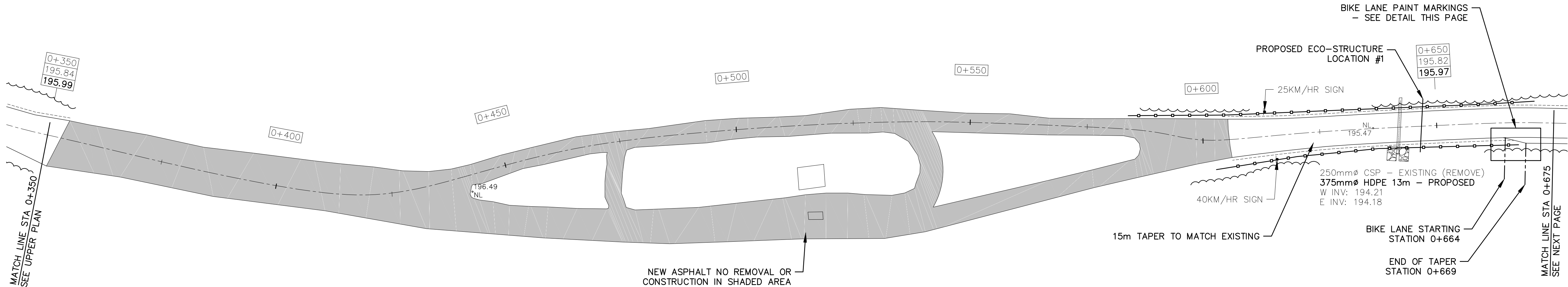
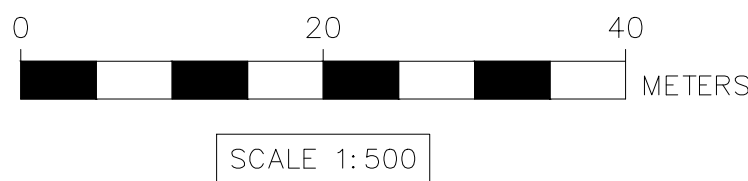

NOTES:

1. FROM STATION 0+350 TO 0+600 NO TOPOGRAPHIC INFORMATION. SOURCED FROM BRUCE COUNTY AERIAL PHOTOGRAPHY. (APPROX. ONLY)
2. NEW CULVERTS TO BE PLACED AT SAME INVERTS AS EXISTING CULVERTS, UNLESS NOTED ON DRAWING. INVERT ELEVATIONS SHOWN ARE EXISTING.
3. PROPOSED CENTRELINE ELEVATIONS ARE TOP OF ASPHALT.
4. MINIMUM 300mm COVER ON ALL CULVERTS.
5. ROCK EXCAVATION WILL NOT BE REQUIRED FOR ROADWAY WIDENING OR ROADSIDE DITCHES. IT MAY BE REQUIRED FOR PLACING OF CULVERTS OR ECO-STRUCTURES.
6. FOR ADDITIONAL NOTES SEE DRAWING 16012-14.
7. ALL TREES WITHIN CLEARING AND GRUBBING LIMITS MARKED SPECIFICALLY BY PARKS CANADA STAFF **SHALL NOT** BE REMOVED.

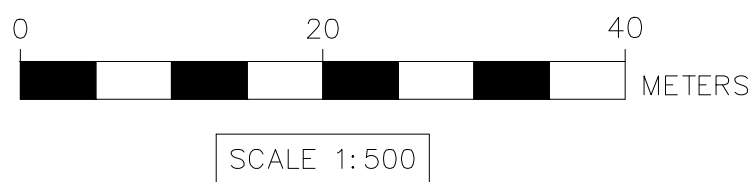
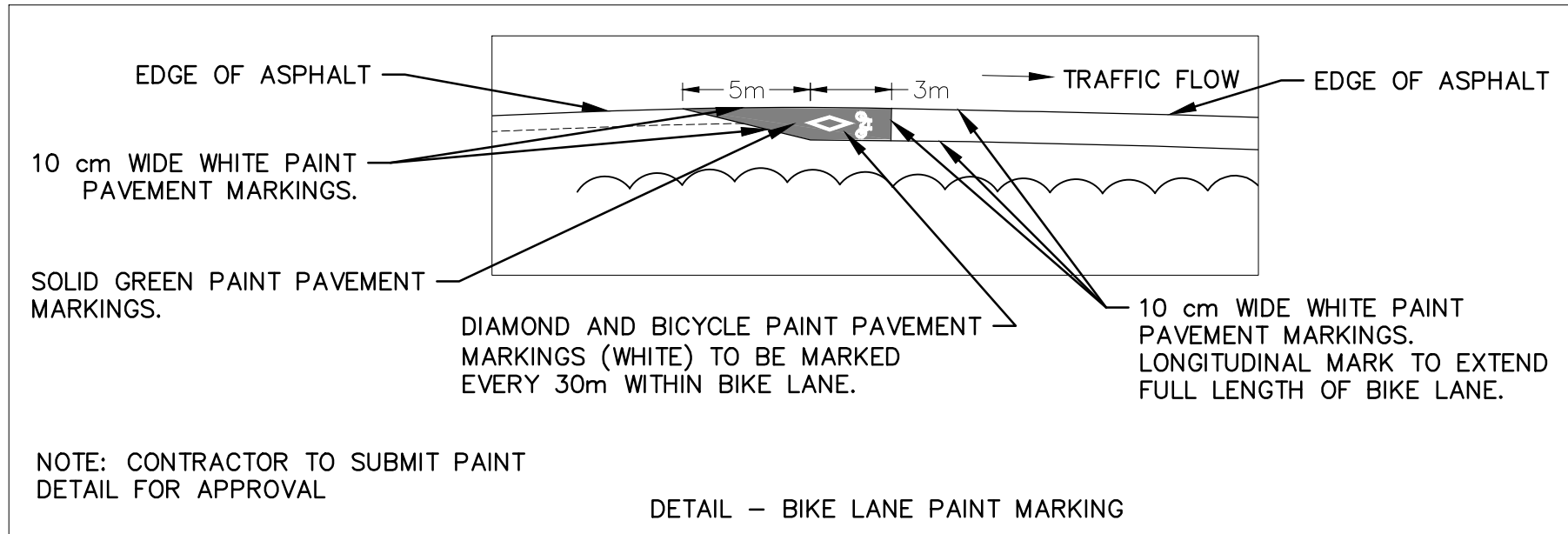

LEGEND

<div>1+000</div> <div>200.67</div> <div>200.82</div>	STATION
<div>---</div>	ORIGINAL & ELEVATION
<div>---</div>	PROPOSED & ELEVATION
<div>---</div>	EXISTING & PROPOSED
<div>---</div>	& OF ROAD
<div>---</div>	PROPOSED EDGE OF ASPHALT*
<div>---</div>	PROPOSED EDGE OF SHOULDER**
<div>---</div>	EXISTING TREE LINE
<div>---</div>	EXISTING ROCK OUT CROP
<div>---</div>	EXISTING NAIL & ELEVATION
<div>---</div>	PROPOSED SILT FENCING
<div>---</div>	RIPRAP AT DOWNSTREAM END
<div>---</div>	OF CULVERTS

* EXISTING EDGE OF SURFACE TREATMENT NOT SHOWN

** EXISTING EDGE OF SHOULDER NOT SHOWN

BENCHMARK: 194.40 - SIB AT STA 0+160 ON EAST SIDE OF ROAD



3	07/18/16	TENDER ISSUE	T.D.L.	J.T.G.
2	07/08/16	2ND SUBMISSION	T.D.L.	J.D.
1	06/13/16	FOR REVIEW	T.D.L.	
NO.	DATE	DESCRIPTION	Drawn by Dessine par	Approved Approuvé

REVISIONS



ENGINEERING
CONSULTANTS LTD

Unit 104D
1010 9th Ave West
Owen Sound, On
N4K 5R7



Parcs
Canada

Parcs
Canada



Canada

PARKS CANADA
EASTERN ONTARIO FIELD UNIT

Type of Record /
Type d'enregistrement

Project title / Titre du projet

CYPRUS LAKE ROAD
RECAPITALIZATION

Drawing title / Titre du dessin

PLAN VIEW
STA 0+000 - 0+675
AND DETAILS

Plot Scale / Echelle

1:500 (Arch D 24x36 Plot Size)

Drawn by/ Dessine par T.D.L. Date 07/18/2016

Field Recording by /
Releve-Témoin par N/A Date 07/18/2016

Approved by / Approuvé par J.T.G. Date ??

Checked by/ Verifié par J.D. Date 07/18/2016

Project No./ No. du projet 16012 Asset No. ?? Sheet No./
Feuille No.

Drawing Re No./No. du Dessin 16012-02

02

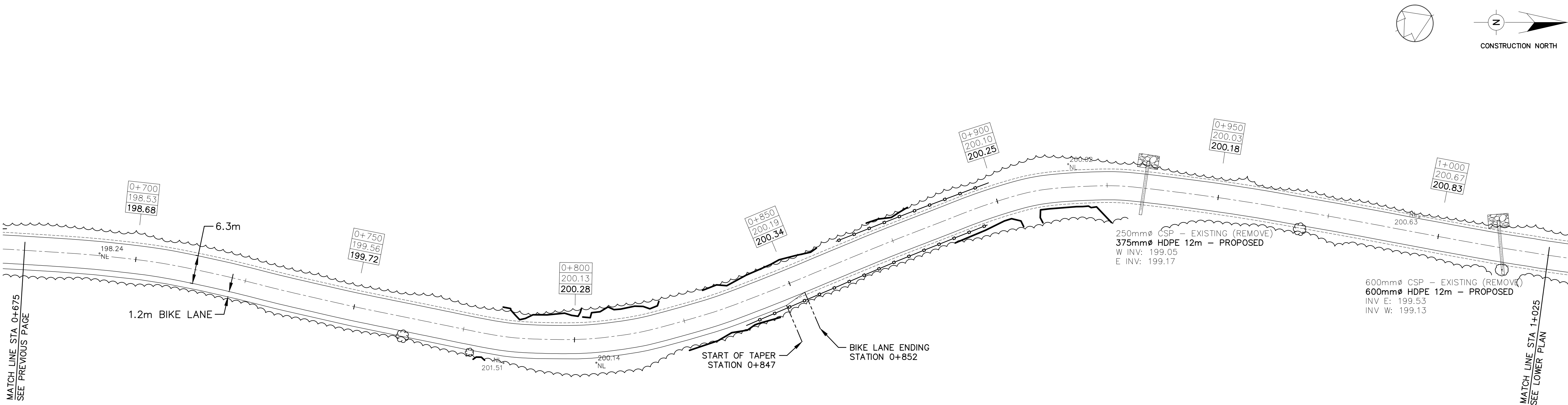

- NOTES:
1. NEW CULVERTS TO BE PLACED AT SAME INVERTS AS EXISTING CULVERTS, UNLESS NOTED ON DRAWING. INVERT ELEVATIONS SHOWN ARE EXISTING.
 2. PROPOSED CENTRELINE ELEVATIONS ARE TOP OF APSHALT.
 3. MINIMUM 300mm COVER ON ALL CULVERTS.
 4. ROCK EXCAVATION WILL NOT BE REQUIRED FOR ROADWAY WIDENING OR ROADSIDE DITCHES. IT MAY BE REQUIRED FOR PLACING OF CULVERTS OR ECO-STRUCTURES.
 5. FOR ADDITIONAL NOTES SEE DRAWING 16012-14.
 6. ALL TREES WITHIN CLEARING AND GRUBBING LIMITS MARKED SPECIFICALLY BY PARKS CANADA STAFF SHALL NOT BE REMOVED.

1+000 200.67 200.82	STATION ORIGINAL & ELEVATION PROPOSED & ELEVATION
---	EXISTING & PROPOSED & OF ROAD
---	PROPOSED EDGE OF ASPHALT*
---	PROPOSED EDGE OF SHOULDER**
---	EXISTING TREE LINE
---	EXISTING ROCK OUT CROP
---	EXISTING NAIL & ELEVATION
---	PROPOSED SILT FENCING
---	RIPRAP AT DOWNSTREAM END OF CULVERTS

* EXISTING EDGE OF SURFACE TREATMENT NOT SHOWN

** EXISTING EDGE OF SHOULDER NOT SHOWN

BENCHMARK: 194.40 - SIB AT STA 0+160 ON EAST
SIDE OF ROAD



3	07/18/16	TENDER ISSUE	T.D.L.	J.T.G.
2	07/08/16	2ND SUBMISSION	T.D.L.	J.D.
1	06/13/16	FOR REVIEW	T.D.L.	
NO.	DATE	DESCRIPTION	Drawn by Dessine par	Approved Approuvé

REVISIONS



ENGINEERING
CONSULTANTS LTD

Unit 104D
1010 9th Ave West
Owen Sound, On
N4K 5R7

Parcs
Canada

Parks
Canada



Canada

PARKS CANADA
EASTERN ONTARIO FIELD UNIT

Type of Record /
Type d'enregistrement

Project title / Titre du projet

CYPRUS LAKE ROAD
RECAPITALIZATION

Drawing title / Titre du dessin

PLAN VIEW
STA 0+675 - 1+350
AND DETAILS

Plot Scale / Echelle

1:500 (Arch D 24x36 Plot Size)

Drawn by/ Dessine par
T.D.L. 07/18/2016

Field Recording by /
Releve-Temoin par
N/A N/A

Approved by / Approuve par
J.T.G. 07/18/2016

Checked by/ Verifie par
J.D. 07/18/2016

Project No./ No. du projet
16012 ??

Drawing Re No./No. du Dessin
16012-03

03

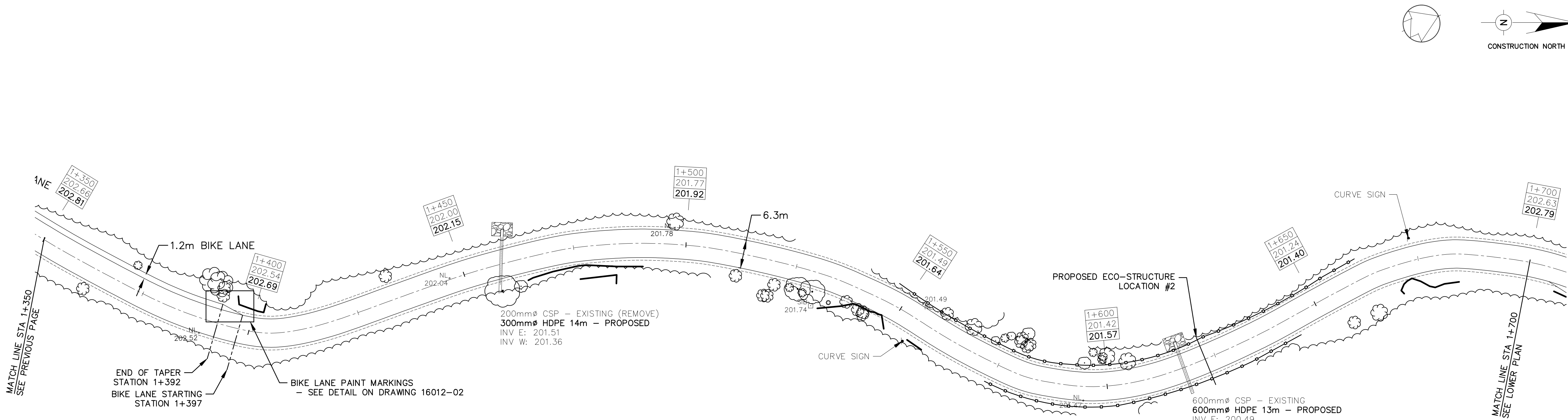

NOTES:

1. NEW CULVERTS TO BE PLACED AT SAME INVERTS AS EXISTING CULVERTS, UNLESS NOTED ON DRAWING. INVERT ELEVATIONS SHOWN ARE EXISTING.
2. PROPOSED CENTRELINE ELEVATIONS ARE TOP OF ASPHALT.
3. MINIMUM 300mm COVER ON ALL CULVERTS.
4. ROCK EXCAVATION WILL NOT BE REQUIRED FOR ROADWAY WIDENING OR ROADSIDE DITCHES. IT MAY BE REQUIRED FOR PLACING OR CULVERTS OR ECO-STRUCTURES.
5. FOR ADDITIONAL NOTES SEE DRAWING 16012-14.
6. ALL TREES WITHIN CLEARING AND GRUBBING LIMITS MARKED SPECIFICALLY BY PARKS CANADA STAFF SHALL NOT BE REMOVED.

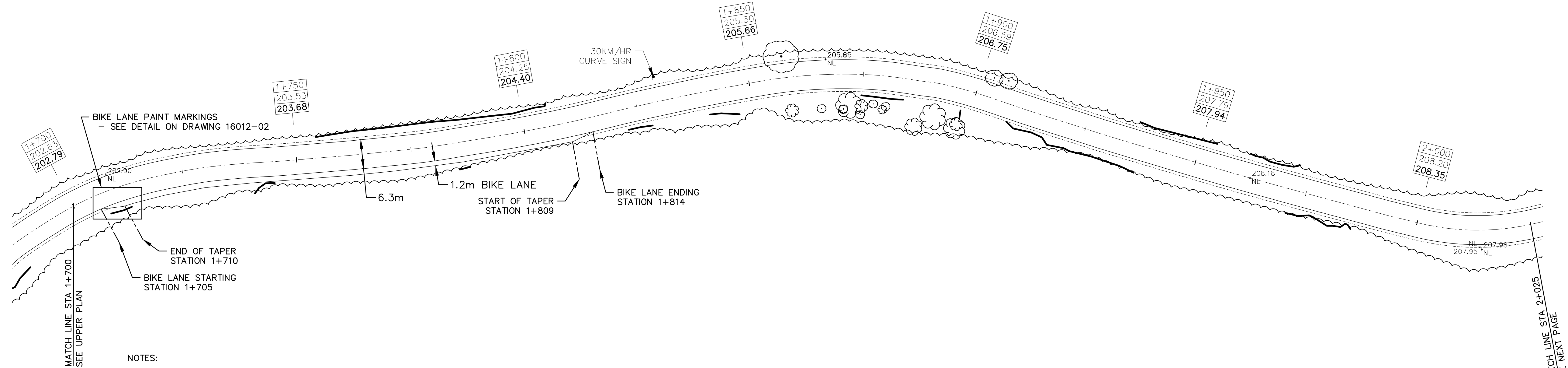
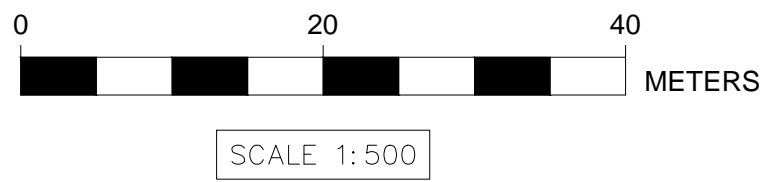

NOTES:

1. NEW CULVERTS TO BE PLACED AT SAME INVERTS AS EXISTING CULVERTS, UNLESS NOTED ON DRAWING. INVERT ELEVATIONS SHOWN ARE EXISTING.
2. PROPOSED CENTRELINE ELEVATIONS ARE TOP OF ASPHALT.
3. MINIMUM 300mm COVER ON ALL CULVERTS.
4. ROCK EXCAVATION WILL NOT BE REQUIRED FOR ROADWAY WIDENING OR ROADSIDE DITCHES. IT MAY BE REQUIRED FOR PLACING OR CULVERTS OR ECO-STRUCTURES.
5. FOR ADDITIONAL NOTES SEE DRAWING 16012-12.
6. ALL TREES WITHIN CLEARING AND GRUBBING LIMITS MARKED SPECIFICALLY BY PARKS CANADA STAFF SHALL NOT BE REMOVED.

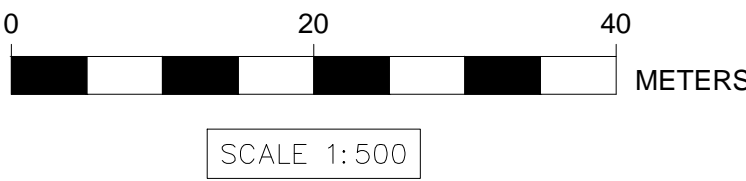

LEGEND

1+000 200.67 200.82	STATION ORIGINAL ϕ ELEVATION PROPOSED ϕ ELEVATION
---	EXISTING & PROPOSED ϕ OF ROAD
---	PROPOSED EDGE OF ASPHALT*
---	PROPOSED EDGE OF SHOULDER**
---	EXISTING TREE LINE
---	EXISTING ROCK OUT CROP
202.89 NL	EXISTING NAIL & ELEVATION
---	PROPOSED SILT FENCING
---	RIPRAP AT DOWNSTREAM END OF CULVERTS

* EXISTING EDGE OF SURFACE TREATMENT NOT SHOWN

** EXISTING EDGE OF SHOULDER NOT SHOWN

BENCHMARK: 194.40 - SIB AT STA 0+160 ON EAST
SIDE OF ROAD



3	07/18/16	TENDER ISSUE	T.D.L.	J.T.G.
2	07/08/16	2ND SUBMISSION	T.D.L.	J.D.
1	06/13/16	FOR REVIEW	T.D.L.	
NO.	DATE	DESCRIPTION	Drawn by Dessine par	Approved Approuve

REVISIONS



ENGINEERING
CONSULTANTS LTD

Unit 104D
1010 9th Ave West
Owen Sound, On
N4K 5R7



Parcs
Canada

Parks
Canada



Canada

PARKS CANADA
EASTERN ONTARIO FIELD UNIT

Type of Record /
Type d'enregistrement

Project title / Titre du projet

CYPRUS LAKE ROAD
RECAPITALIZATION

Drawing title / Titre du dessin

PLAN VIEW
STA 1+350 - 2+025
AND DETAILS

Plot Scale / Echelle

1:500 (Arch D 24x36 Plot Size)

Drawn by/ Dessine par
T.D.L.

Date
07/18/2016

Field Recording by /
Releve-Temoin par
N/A

Date
N/A

Approved by / Approuve par
J.T.G.

Date
07/18/2016

Checked by/ Verifie par
J.D.

Date
07/18/2016

Project No./ No. du projet
16012

Asset No.
??

Sheet No./
Feuille No.

Drawing Re No./No. du Dessin
16012-04

04

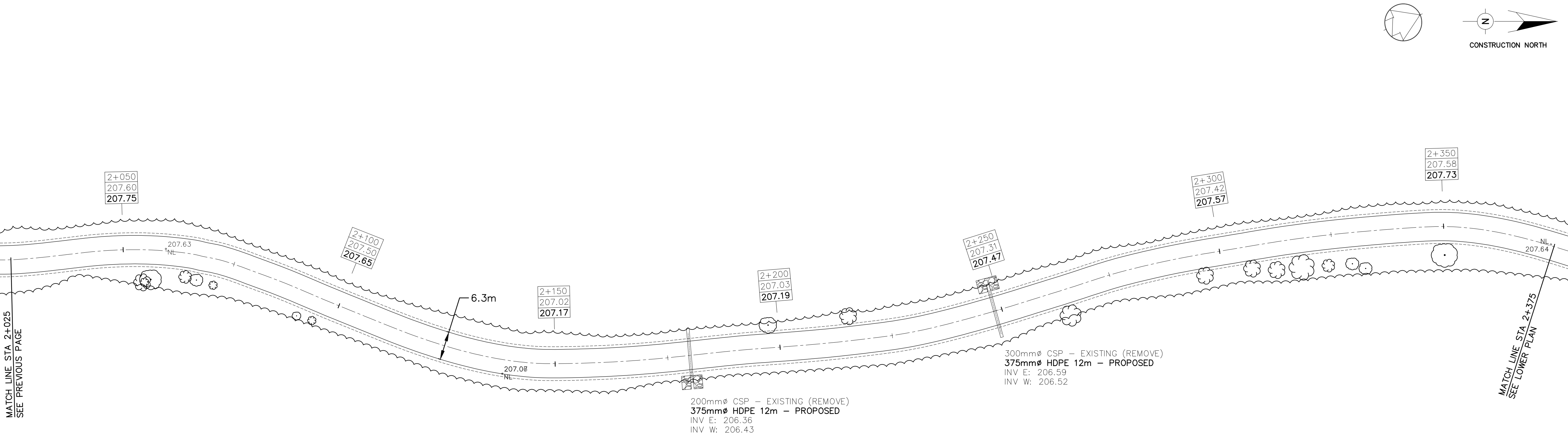

- NOTES:
1. NEW CULVERTS TO BE PLACED AT SAME INVERTS AS EXISTING CULVERTS, UNLESS NOTED ON DRAWING. INVERT ELEVATIONS SHOWN ARE EXISTING.
 2. PROPOSED CENTRELINE ELEVATIONS ARE TOP OF ASPHALT.
 3. MINIMUM 300mm COVER ON ALL CULVERTS.
 4. ROCK EXCAVATION WILL NOT BE REQUIRED FOR ROADWAY WIDENING OR ROADSIDE DITCHES. IT MAY BE REQUIRED FOR PLACING OR CULVERTS OR ECO-STRUCTURES.
 5. FOR ADDITIONAL NOTES DRAWING 16012-14.
 6. ALL TREES WITHIN CLEARING AND GRUBBING LIMITS MARKED SPECIFICALLY BY PARKS CANADA STAFF SHALL NOT BE REMOVED.

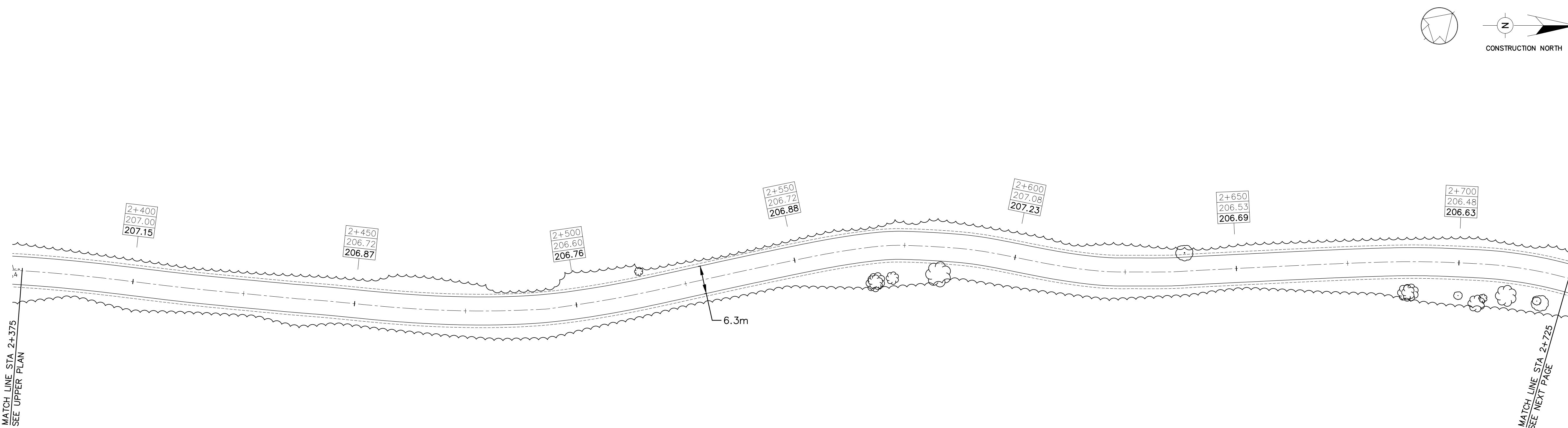

- NOTES:
1. NEW CULVERTS TO BE PLACED AT SAME INVERTS AS EXISTING CULVERTS, UNLESS NOTED ON DRAWING. INVERT ELEVATIONS SHOWN ARE EXISTING.
 2. PROPOSED CENTRELINE ELEVATIONS ARE TOP OF ASPHALT.
 3. MINIMUM 300mm COVER ON ALL CULVERTS.
 4. ROCK EXCAVATION WILL NOT BE REQUIRED FOR ROADWAY WIDENING OR ROADSIDE DITCHES. IT MAY BE REQUIRED FOR PLACING OR CULVERTS OR ECO-STRUCTURES.
 5. FOR ADDITIONAL NOTES SEE DRAWING 16012-14.
 6. ALL TREES WITHIN CLEARING AND GRUBBING LIMITS MARKED SPECIFICALLY BY PARKS CANADA STAFF SHALL NOT BE REMOVED.

STATION	ORIGINAL ELEVATION	PROPOSED ELEVATION
1+000	200.67	200.82
2+050	207.60	207.75
2+100	207.50	207.65
2+150	207.02	207.17
2+200	207.03	207.19
2+250	207.31	207.47
2+300	207.42	207.57
2+350	207.58	207.73
2+400	207.00	207.15
2+450	206.72	206.87
2+500	206.60	206.76
2+550	206.72	206.88
2+600	207.08	207.23
2+650	206.53	206.69
2+700	206.48	206.63

* EXISTING EDGE OF SURFACE TREATMENT NOT SHOWN
** EXISTING EDGE OF SHOULDER NOT SHOWN
BENCHMARK: 194.40 - SIB AT STA 0+160 ON EAST SIDE OF ROAD

3	07/18/16	TENDER ISSUE	T.D.L.	J.T.G.
2	07/08/16	2ND SUBMISSION	T.D.L.	J.D.
1	06/03/16	FOR REVIEW	T.D.L.	
NO.	DATE	DESCRIPTION	Drawn by Dessine par	Approved Approuvé
REVISIONS				

ENGINEERING
CONSULTANTS LTD

Unit 104D
1010 9th Ave West
Owen Sound, On
N4K 5R7

Parcs Canada

Parks Canada

Canada

PARKS CANADA
EASTERN ONTARIO FIELD UNIT

Type of Record /
Type d'enregistrement

Project title / Titre du projet

CYPRUS LAKE ROAD RECAPITALIZATION

Drawing title / Titre du dessin

PLAN VIEW STA 2+025 - 2+725 AND DETAILS

Plot Scale / Echelle 1:500 (Arch D 24x36 Plot Size)		
Drawn by/ Dessine par T.D.L.		Date 07/18/2016
Field Recording by / Releve-Temoin par N/A		Date N/A
Approved by / Approuve par J.T.G.		Date 07/18/2016
Checked by/ Verifie par J.D.		Date 07/18/2016
Project No./ No. du projet 16012	Asset No. ??	Sheet No./ Feuille No. 05
Drawing Re No./No. du Dessin 16012-05		

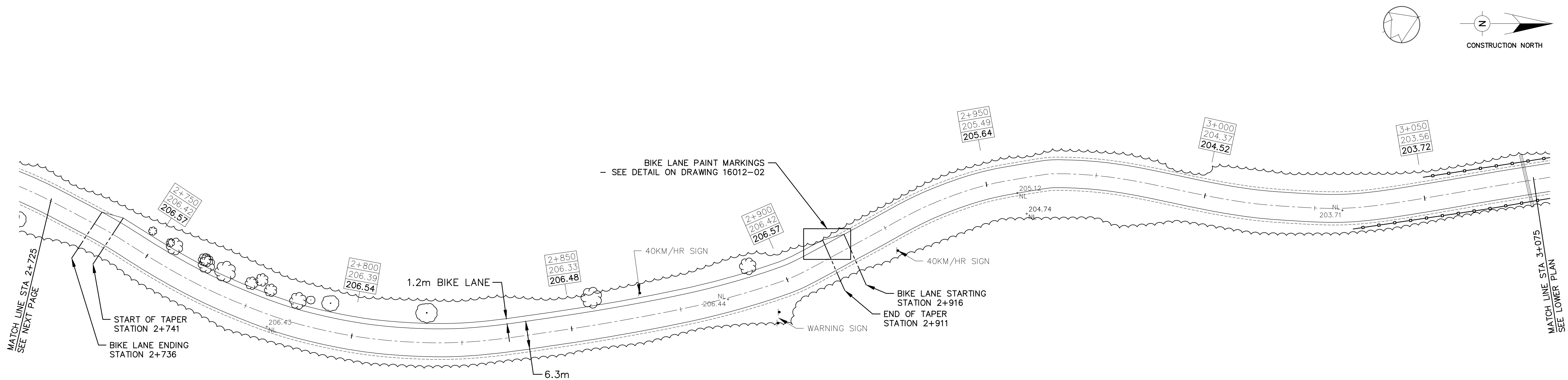

NOTES:

1. NEW CULVERTS TO BE PLACED AT SAME INVERTS AS EXISTING CULVERTS, UNLESS NOTED ON DRAWING. INVERT ELEVATIONS SHOWN ARE EXISTING.
2. PROPOSED CENTRELINE ELEVATIONS ARE TOP OF ASPHALT.
3. MINIMUM 300mm COVER ON ALL CULVERTS.
4. ROCK EXCAVATION WILL NOT BE REQUIRED FOR ROADWAY WIDENING OR ROADSIDE DITCHES. IT MAY BE REQUIRED FOR PLACING OR CULVERTS OR ECO-STRUCTURES.
5. FOR ADDITIONAL NOTES SEE DRAWING 16012-14.
6. ALL TREES WITHIN CLEARING AND GRUBBING LIMITS MARKED SPECIFICALLY BY PARKS CANADA STAFF SHALL NOT BE REMOVED.

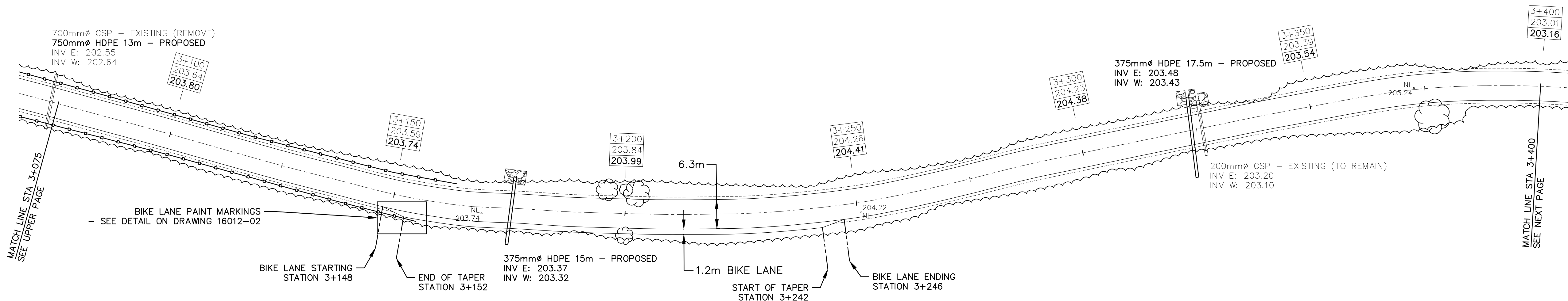
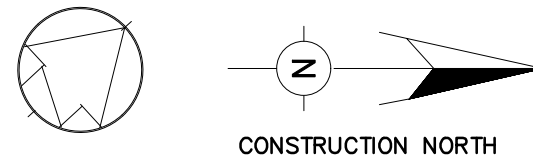
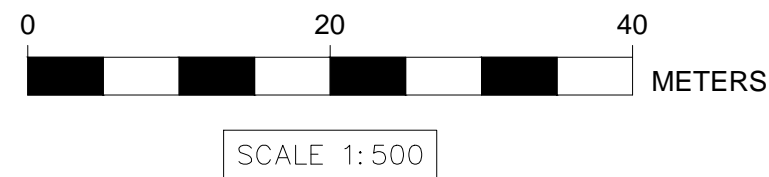

NOTES:

1. NEW CULVERTS TO BE PLACED AT SAME INVERTS AS EXISTING CULVERTS, UNLESS NOTED ON DRAWING. INVERT ELEVATIONS SHOWN ARE EXISTING.
2. PROPOSED CENTRELINE ELEVATIONS ARE TOP OF ASPHALT.
3. MINIMUM 300mm COVER ON ALL CULVERTS.
4. ROCK EXCAVATION WILL NOT BE REQUIRED FOR ROADWAY WIDENING OR ROADSIDE DITCHES. IT MAY BE REQUIRED FOR PLACING OR CULVERTS OR ECO-STRUCTURES.
5. FOR ADDITIONAL NOTES SEE DRAWING 16012-14.
6. ALL TREES WITHIN CLEARING AND GRUBBING LIMITS MARKED SPECIFICALLY BY PARKS CANADA STAFF SHALL NOT BE REMOVED.

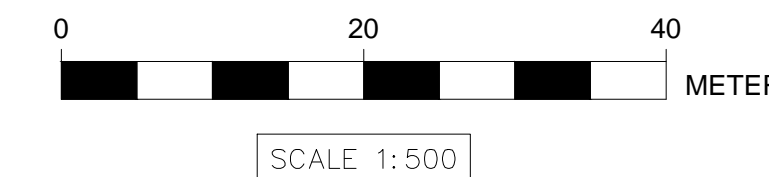

LEGEND

1+000	STATION
200.67	ORIGINAL C ELEVATION
200.82	PROPOSED C ELEVATION
---	EXISTING & PROPOSED C OF ROAD
---	PROPOSED EDGE OF ASPHALT*
---	PROPOSED EDGE OF SHOULDER**
---	EXISTING TREE LINE
---	EXISTING ROCK OUT CROP
---	EXISTING NAIL & ELEVATION
---	PROPOSED SILT FENCING
---	RIPRAP AT DOWNSTREAM END OF CULVERTS

* EXISTING EDGE OF SURFACE TREATMENT NOT SHOWN

** EXISTING EDGE OF SHOULDER NOT SHOWN

BENCHMARK: 194.40 - SIB AT STA 0+160 ON EAST SIDE OF ROAD



3	07/18/16	TENDER ISSUE	T.D.L.	J.T.G.
2	07/08/16	2ND SUBMISSION	T.D.L.	J.D.
1	06/03/16	FOR REVIEW	T.D.L.	
NO.	DATE	DESCRIPTION	Drawn by Dessine par	Approved Approuve

REVISIONS

ENGINEERING
CONSULTANTS LTD

Unit 104D
1010 9th Ave West
Owen Sound, On
N4K 5R7



Canada

PARKS CANADA
EASTERN ONTARIO FIELD UNIT

Type of Record /
Type d'enregistrement

Project title / Titre du projet

CYPRUS LAKE ROAD
RECAPITALIZATION

Drawing title / Titre du dessin

PLAN VIEW
STA 2+725 - 3+400
AND DETAILS

Plot Scale / Echelle

1:500 (Arch D 24x36 Plot Size)

Drawn by/ Dessine par
T.D.L.

Date
07/18/2016

Field Recording by /
Releve-Temoin par
N/A

Date
N/A

Approved by / Approuve par
J.T.G.

Date
07/18/2016

Checked by/ Verifie par
J.D.

Date
07/18/2016

Project No./ No. du projet
16012

Asset No.
??

Sheet No./
Feuille No.

Drawing Re No./No. du Dessin
16012-06

06

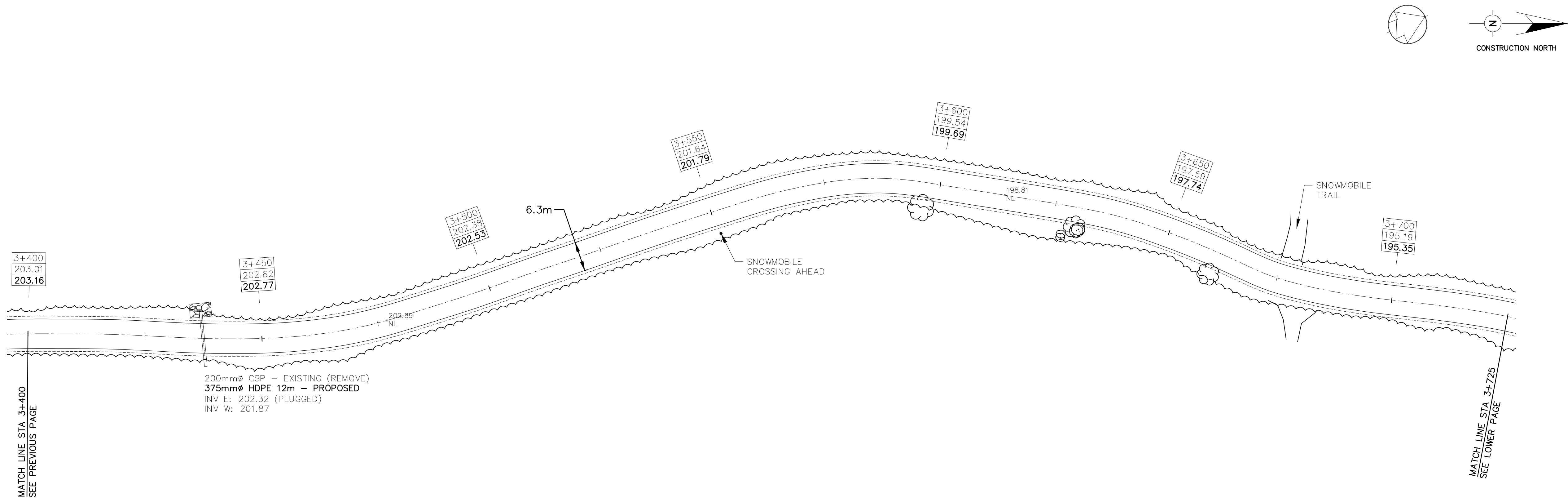

NOTES:

- NEW CULVERTS TO BE PLACED AT SAME INVERTS AS EXISTING CULVERTS, UNLESS NOTED ON DRAWING. INVERT ELEVATIONS SHOWN ARE EXISTING.
- PROPOSED CENTRELINE ELEVATIONS ARE TOP OF ASPHALT.
- MINIMUM 300mm COVER ON ALL CULVERTS.
- ROCK EXCAVATION WILL NOT BE REQUIRED FOR ROADWAY WIDENING OR ROADSIDE DITCHES. IT MAY BE REQUIRED FOR PLACING OR CULVERTS OR ECO-STRUCTURES.
- FOR ADDITIONAL NOTES SEE DRAWING 16012-14.
- ALL TREES WITHIN CLEARING AND GRUBBING LIMITS MARKED SPECIFICALLY BY PARKS CANADA STAFF SHALL NOT BE REMOVED.

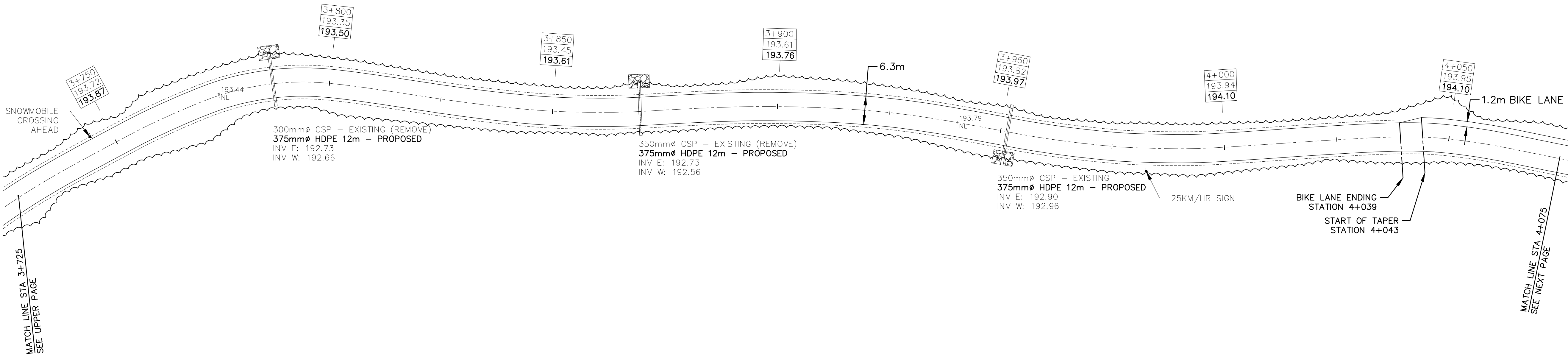
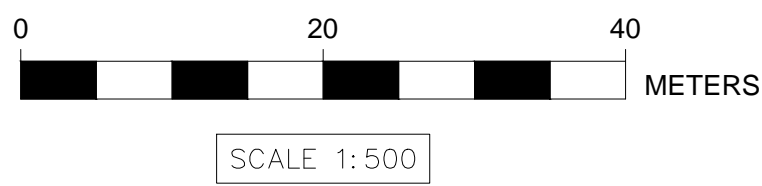

NOTES:

- NEW CULVERTS TO BE PLACED AT SAME INVERTS AS EXISTING CULVERTS, UNLESS NOTED ON DRAWING. INVERT ELEVATIONS SHOWN ARE EXISTING.
- PROPOSED CENTRELINE ELEVATIONS ARE TOP OF ASPHALT.
- MINIMUM 300mm COVER ON ALL CULVERTS.
- ROCK EXCAVATION WILL NOT BE REQUIRED FOR ROADWAY WIDENING OR ROADSIDE DITCHES. IT MAY BE REQUIRED FOR PLACING OR CULVERTS OR ECO-STRUCTURES.
- FOR ADDITIONAL NOTES SEE DRAWING 16012-14.
- ALL TREES WITHIN CLEARING AND GRUBBING LIMITS MARKED SPECIFICALLY BY PARKS CANADA STAFF SHALL NOT BE REMOVED.

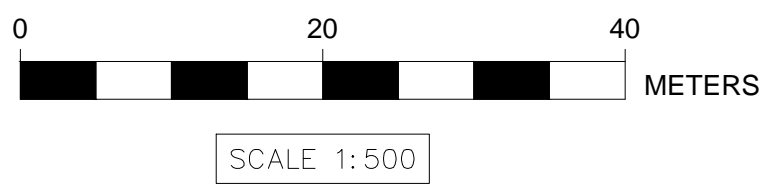

LEGEND

1+000	STATION
200.67	ORIGINAL C ELEVATION
200.82	PROPOSED C ELEVATION
---	EXISTING & PROPOSED C OF ROAD
---	PROPOSED EDGE OF ASPHALT*
---	PROPOSED EDGE OF SHOULDER**
---	EXISTING TREE LINE
---	EXISTING ROCK OUT CROP
202.89 NL	EXISTING NAIL & ELEVATION
---	PROPOSED SILT FENCING
---	RIPRAP AT DOWNSTREAM END OF CULVERTS

* EXISTING EDGE OF SURFACE TREATMENT NOT SHOWN

** EXISTING EDGE OF SHOULDER NOT SHOWN

BENCHMARK: 194.40 - SIB AT STA 0+160 ON EAST SIDE OF ROAD



3	07/18/16	TENDER ISSUE	T.D.L.	J.T.G.
2	07/08/16	2ND SUBMISSION	T.D.L.	J.D.
1	06/03/16	FOR REVIEW	T.D.L.	
NO.	DATE	DESCRIPTION	Drawn by Dessine par	Approved Approuve

REVISIONS

ENGINEERING
CONSULTANTS LTD

Unit 104D
1010 9th Ave West
Owen Sound, On
N4K 5R7

Parcs
Canada

Parcs
Canada

Canada

PARKS CANADA
EASTERN ONTARIO FIELD UNIT

Type of Record /
Type d'enregistrement

Project title / Titre du projet

CYPRUS LAKE ROAD
RECAPITALIZATION

Drawing title / Titre du dessin

PLAN VIEW
STA 3+400 - 4+075
AND DETAILS

Plot Scale / Echelle
1:500 (Arch D 24x36 Plot Size)

Drawn by/ Dessine par
T.D.L. 07/18/2016

Field Recording by /
Releve-Temoin par
N/A N/A

Approved by / Approuve par
J.T.G. 07/18/2016

Checked by/ Verifie par
J.D. 07/18/2016

Project No./ No. du projet
16012 ??

Drawing Re No./No. du Dessin
16012-07

07

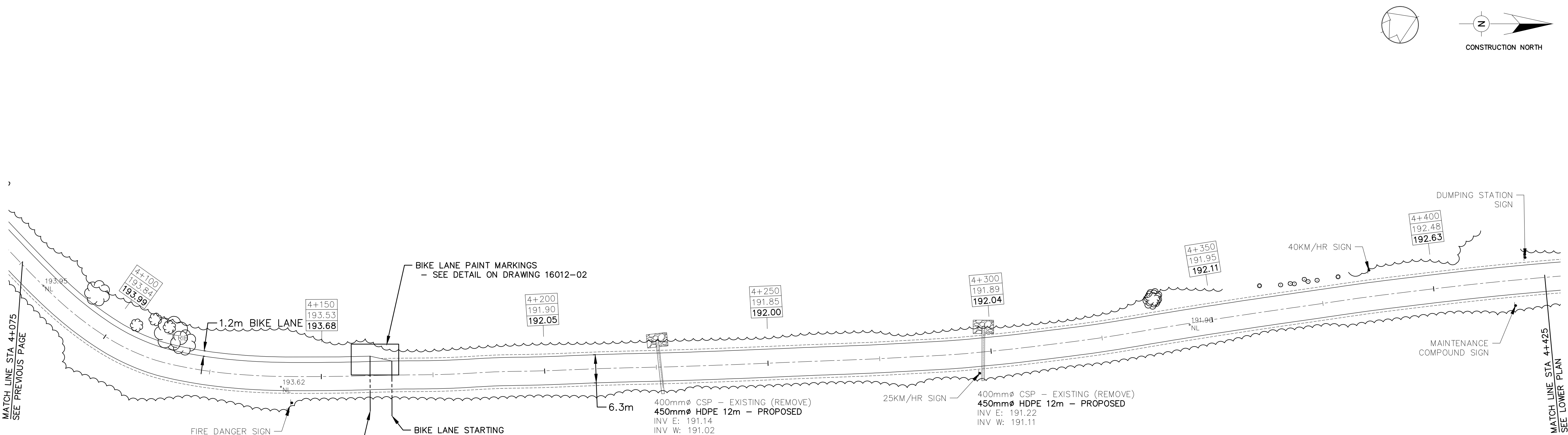

NOTES:

1. NEW CULVERTS TO BE PLACED AT SAME INVERTS AS EXISTING CULVERTS, UNLESS NOTED ON DRAWING. INVERT ELEVATIONS SHOWN ARE EXISTING.
2. PROPOSED CENTRELINE ELEVATIONS ARE TOP OF ASPHALT.
3. MINIMUM 300mm COVER ON ALL CULVERTS.
4. ROCK EXCAVATION WILL NOT BE REQUIRED FOR ROADWAY WIDENING OR ROADSIDE DITCHES. IT MAY BE REQUIRED FOR PLACING OR CULVERTS OR ECO-STRUCTURES.
5. FOR ADDITIONAL NOTES SEE DRAWING 16012-14.
6. ALL TREES WITHIN CLEARING AND GRUBBING LIMITS MARKED SPECIFICALLY BY PARKS CANADA STAFF **SHALL NOT** BE REMOVED.

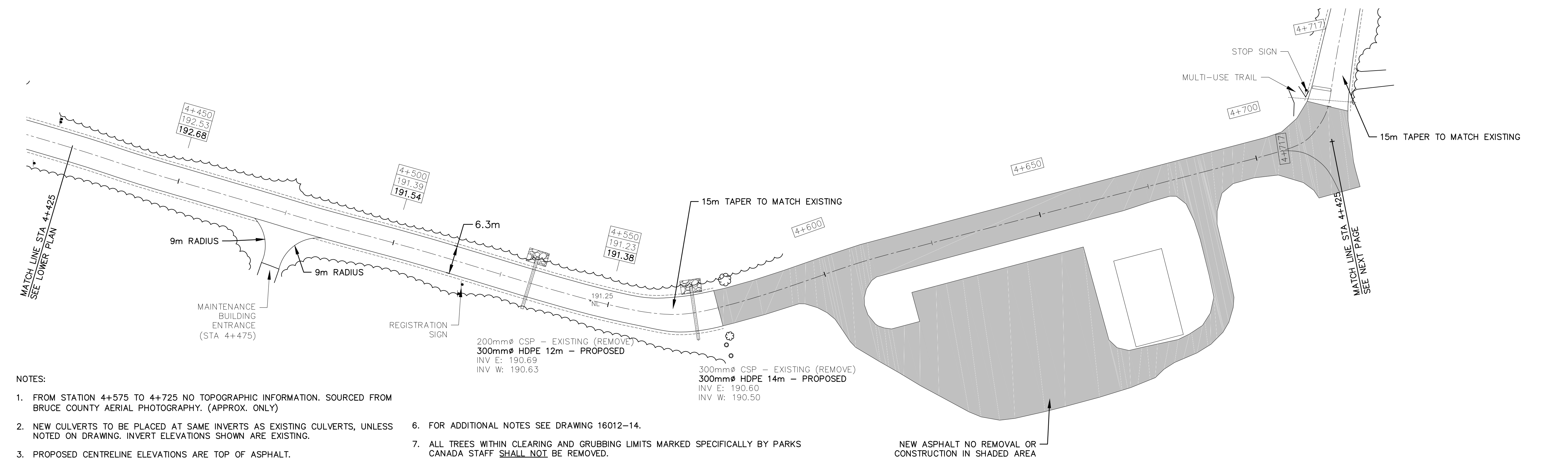
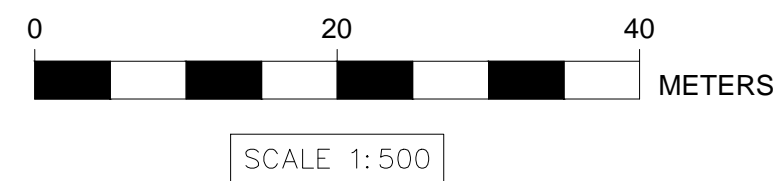

NOTES:

1. FROM STATION 4+575 TO 4+725 NO TOPOGRAPHIC INFORMATION. SOURCED FROM BRUCE COUNTY AERIAL PHOTOGRAPHY. (APPROX. ONLY)
2. NEW CULVERTS TO BE PLACED AT SAME INVERTS AS EXISTING CULVERTS, UNLESS NOTED ON DRAWING. INVERT ELEVATIONS SHOWN ARE EXISTING.
3. PROPOSED CENTRELINE ELEVATIONS ARE TOP OF ASPHALT.
4. MINIMUM 300mm COVER ON ALL CULVERTS.
5. ROCK EXCAVATION WILL NOT BE REQUIRED FOR ROADWAY WIDENING OR ROADSIDE DITCHES. IT MAY BE REQUIRED FOR PLACING OR CULVERTS OR ECO-STRUCTURES.
6. FOR ADDITIONAL NOTES SEE DRAWING 16012-14.
7. ALL TREES WITHIN CLEARING AND GRUBBING LIMITS MARKED SPECIFICALLY BY PARKS CANADA STAFF **SHALL NOT** BE REMOVED.

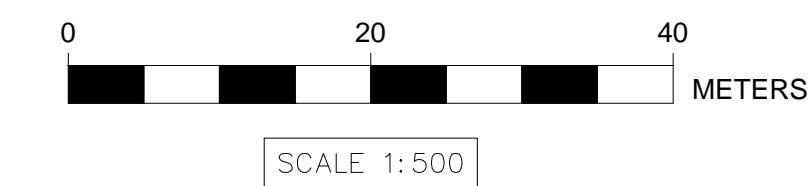

LEGEND

<div>1+000</div> <div>200.67</div> <div>200.82</div>	STATION
<div>---</div>	ORIGINAL ϕ ELEVATION
<div>---</div>	PROPOSED ϕ ELEVATION
<div>---</div>	EXISTING & PROPOSED ϕ OF ROAD
<div>---</div>	PROPOSED EDGE OF ASPHALT*
<div>---</div>	PROPOSED EDGE OF SHOULDER**
<div>---</div>	EXISTING TREE LINE
<div>---</div>	EXISTING ROCK OUT CROP
<div>202.89</div> <div>NL</div>	EXISTING NAIL & ELEVATION
<div>---</div>	PROPOSED SILT FENCING
<div>---</div>	RIPRAP AT DOWNSTREAM END OF CULVERTS

* EXISTING EDGE OF SURFACE TREATMENT NOT SHOWN

** EXISTING EDGE OF SHOULDER NOT SHOWN

BENCHMARK: 194.40 – SIB AT STA 0+160 ON EAST SIDE OF ROAD



3	07/18/16	TENDER ISSUE	T.D.L.	J.T.G.
2	07/08/16	2ND SUBMISSION	T.D.L.	J.D.
1	06/03/16	FOR REVIEW	T.D.L.	
NO.	DATE	DESCRIPTION	Drawn by Dessine par	Approved Approuvé
REVISIONS				

ENGINEERING
CONSULTANTS LTD

Unit 104D
1010 9th Ave West
Owen Sound, On
N4K 5R7

Parcs
Canada

Parks
Canada

Canada

PARKS CANADA
EASTERN ONTARIO FIELD UNIT

Type of Record /
Type d'enregistrement

Project title / Titre du projet

CYPRUS LAKE ROAD
RECAPITALIZATION

Drawing title / Titre du dessin

PLAN VIEW
STA 4+075 – 4+717
AND DETAILS

Plot Scale / Echelle

1:500 (Arch D 24x36 Plot Size)

Drawn by/ Dessine par
T.D.L.

Date
07/18/2016

Field Recording by /
Releve-Témoin par
N/A

Date
N/A

Approved by / Approuvé par
J.T.G.

Date
07/18/2016

Checked by/ Verifié par
J.D.

Date
07/18/2016

Project No./ No. du projet
16012

Asset No.
??

Sheet No./
Feuille No.

Drawing Re No./No. du Dessin
16012-08

08

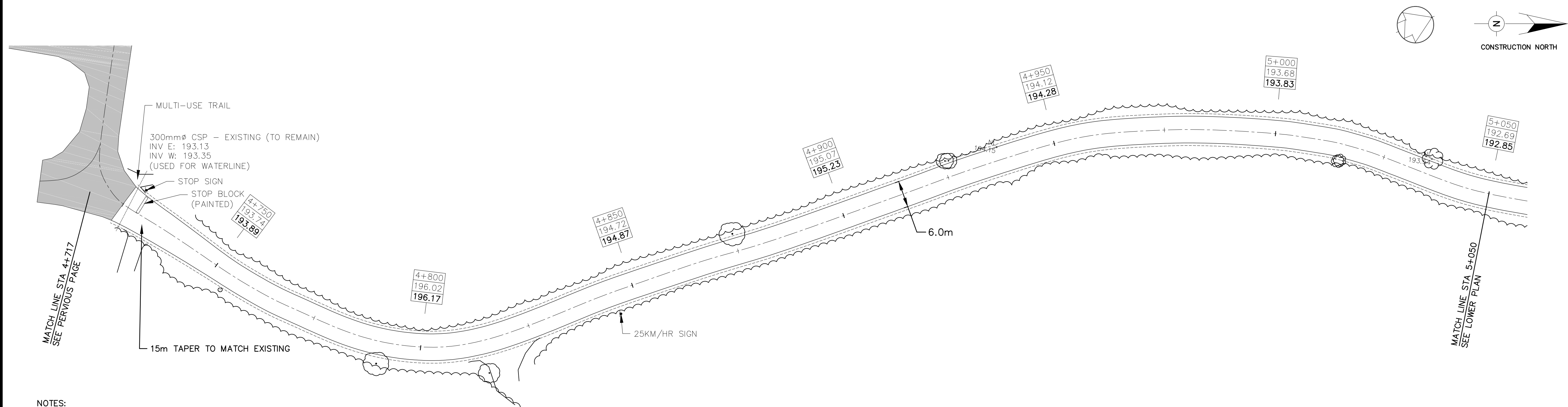

NOTES:

1. NEW CULVERTS TO BE PLACED AT SAME INVERTS AS EXISTING CULVERTS, UNLESS NOTED ON DRAWING. INVERT ELEVATIONS SHOWN ARE EXISTING.
2. MULTI-USE TRAIL ON WEST SIDE OF ROAD. CLEARING & GRUBBING TO BE 4m FROM CENTRELINE OF ROAD, FROM STA 4+750 – 5+350. (WEST SIDE ONLY).
3. PROPOSED CENTRELINE ELEVATIONS ARE TOP OF ASPHALT..
4. MINIMUM 300mm COVER ON ALL CULVERTS.
5. ROCK EXCAVATION WILL NOT BE REQUIRED FOR ROADWAY WIDENING OR ROADSIDE DITCHES. IT MAY BE REQUIRED FOR PLACING OR CULVERTS OR ECO-STRUCTURES.
6. FOR ADDITIONAL NOTES SEE DRAWING 16012-14.
7. ALL TREES WITHIN CLEARING AND GRUBBING LIMITS MARKED SPECIFICALLY BY PARKS CANADA STAFF SHALL NOT BE REMOVED.

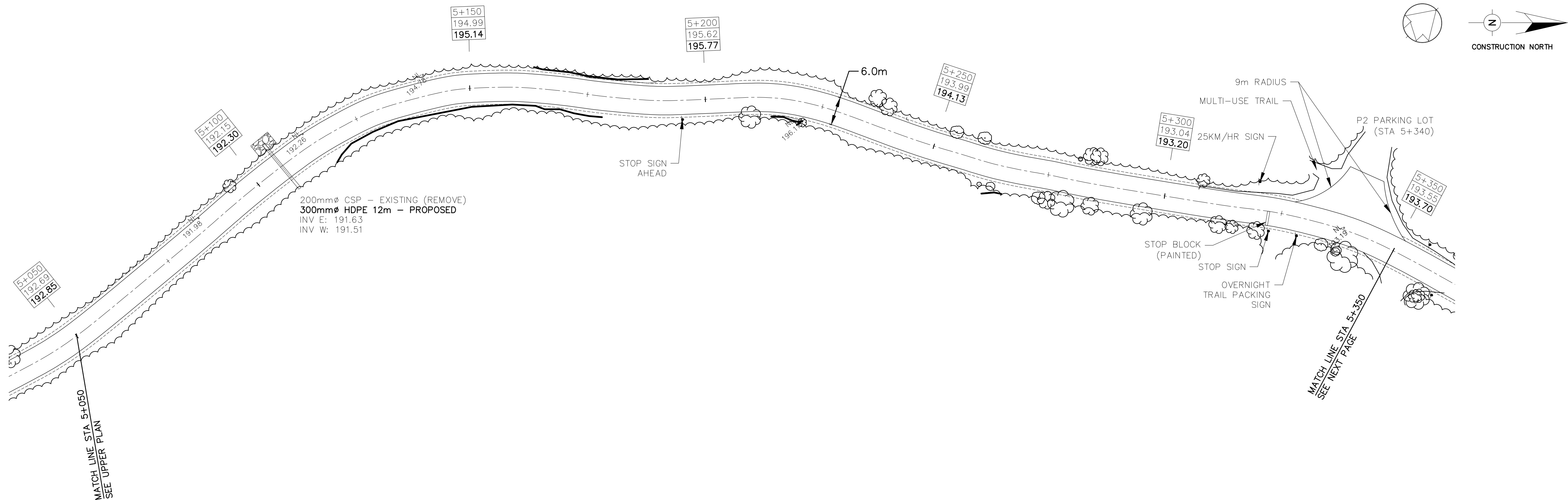
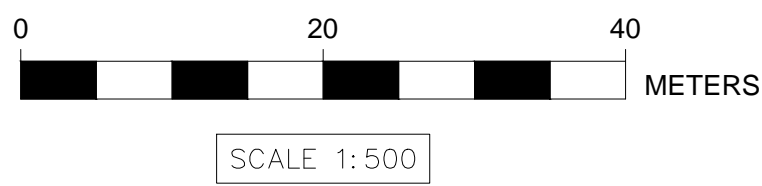

NOTES:

1. NEW CULVERTS TO BE PLACED AT SAME INVERTS AS EXISTING CULVERTS, UNLESS NOTED ON DRAWING. INVERT ELEVATIONS SHOWN ARE EXISTING.
2. MULTI-USE TRAIL ON WEST. CLEARING & GRUBBING TO BE 4m FROM CENTRELINE OF ROAD, FROM STA 4+750 – 5+350. (WEST SIDE ONLY).
3. PROPOSED CENTRELINE ELEVATIONS ARE TOP OF ASPHALT.
4. MINIMUM 300mm COVER ON ALL CULVERTS.
5. ROCK EXCAVATION WILL NOT BE REQUIRED FOR ROADWAY WIDENING OR ROADSIDE DITCHES. IT MAY BE REQUIRED FOR PLACING OR CULVERTS OR ECO-STRUCTURES.
6. FOR ADDITIONAL NOTES SEE DRAWING 16012-14.
7. ALL TREES WITHIN CLEARING AND GRUBBING LIMITS MARKED SPECIFICALLY BY PARKS CANADA STAFF SHALL NOT BE REMOVED.

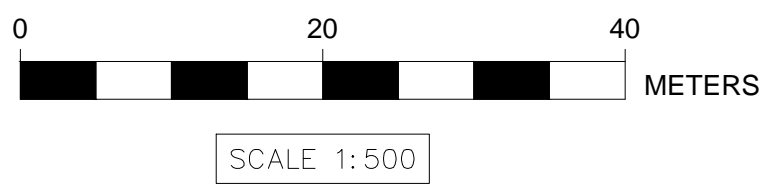

LEGEND

1+000 200.67 200.82	STATION ORIGINAL C ELEVATION PROPOSED C ELEVATION
---	EXISTING & PROPOSED C OF ROAD
---	PROPOSED EDGE OF ASPHALT*
---	PROPOSED EDGE OF SHOULDER**
---	EXISTING TREE LINE
---	EXISTING ROCK OUT CROP
---	EXISTING NAIL & ELEVATION
---	PROPOSED SILT FENCING
---	RIPRAP AT DOWNSTREAM END OF CULVERTS

* EXISTING EDGE OF SURFACE TREATMENT NOT SHOWN

** EXISTING EDGE OF SHOULDER NOT SHOWN

BENCHMARK: 194.40 – SIB AT STA 0+160 ON EAST
SIDE OF ROAD



3	07/18/16	TENDER ISSUE	T.D.L.	J.T.G.
2	07/08/16	2ND SUBMISSION	T.D.L.	J.D.
1	06/03/16	FOR REVIEW	T.D.L.	
NO.	DATE	DESCRIPTION	Drawn by Dessine par	Approved Approuvé

REVISIONS



ENGINEERING
CONSULTANTS LTD

Unit 104D
1010 9th Ave West
Owen Sound, On
N4K 5R7



Parcs
Canada

Parks
Canada



Canadä

PARKS CANADA
EASTERN ONTARIO FIELD UNIT

Type of Record /
Type d'enregistrement

Project title / Titre du projet

CYPRUS LAKE ROAD
RECAPITALIZATION

Drawing title / Titre du dessin

PLAN VIEW
STA 4+717 – 5+350
AND DETAILS

Plot Scale / Echelle

1:500 (Arch D 24x36 Plot Size)

Drawn by/ Dessine par
T.D.L. 07/18/2016

Field Recording by /
Releve-Temoin par
N/A N/A

Approved by / Approuve par
J.T.G. 07/18/2016

Checked by/ Verifie par
J.D. 07/18/2016

Project No./ No. du projet
16012 ??

Drawing Re No./No. du Dessin
16012-09

09

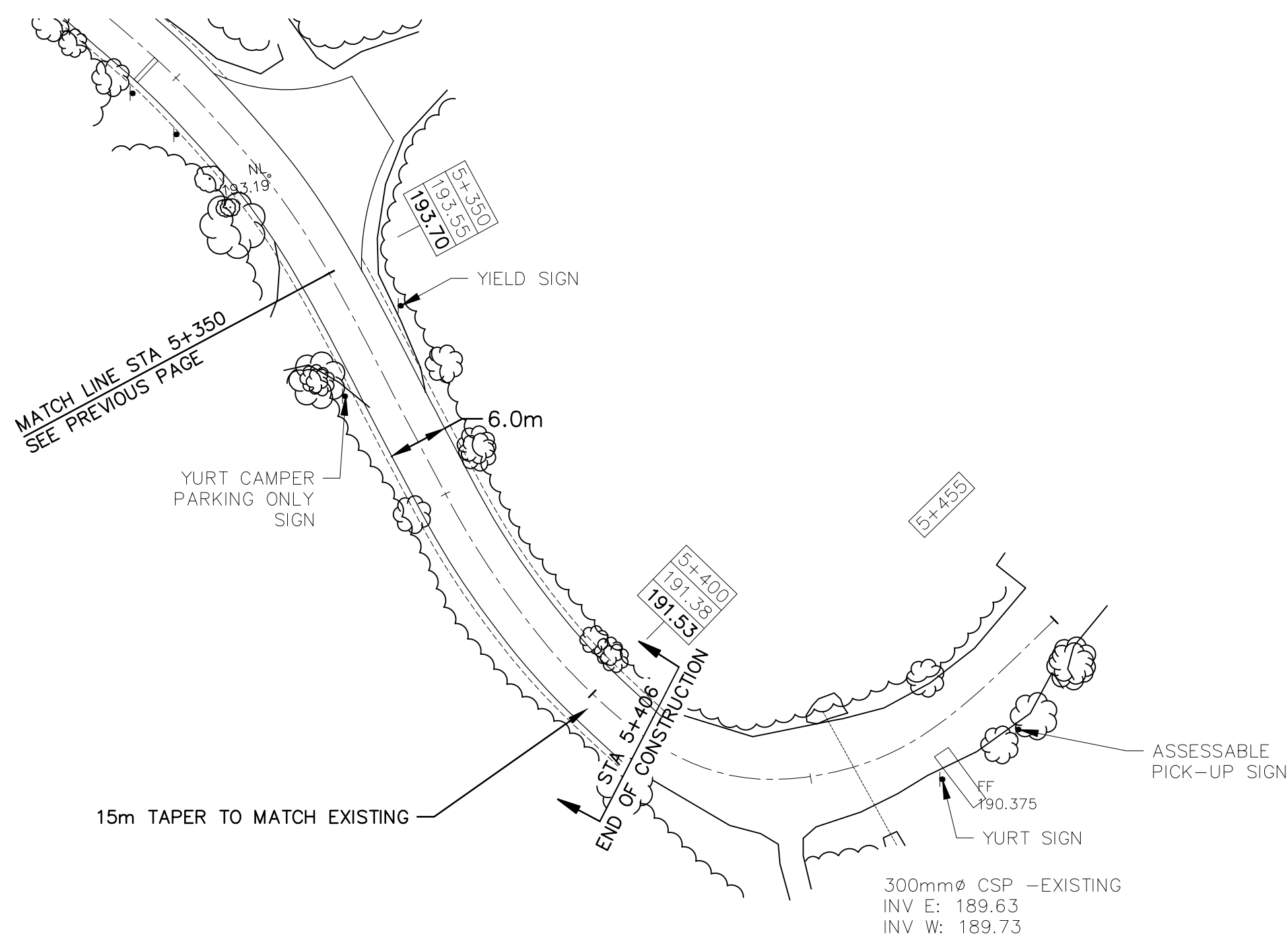

NOTES:

1. NEW CULVERTS TO BE PLACED AT SAME INVERTS AS EXISTING CULVERTS, UNLESS NOTED ON DRAWING. INVERT ELEVATIONS SHOWN ARE EXISTING.
2. END OF CONSTRUCTION TO END AT NEW ASPHALT, APPROX. STATION 5+406.
3. PROPOSED CENTRELINE ELEVATIONS ARE TOP OF ASPHALT.
4. MINIMUM 300mm COVER ON ALL CULVERTS.
5. ROAD EXCAVATION WILL NOT BE REQUIRED FOR ROADWAY WIDENING OR ROADSIDE DITCHES. IT MY BE REQUIRED FOR PLACING OR CULVERTS OR ECO-STRUCTURES.
6. FOR ADDITIONAL NOTES SEE DRAWING 16012-14.
7. ALL TREES WITHIN CLEARING AND GRUBBING LIMITS MARKED SPECIFICALLY BY PARKS CANADA STAFF SHALL NOT BE REMOVED.

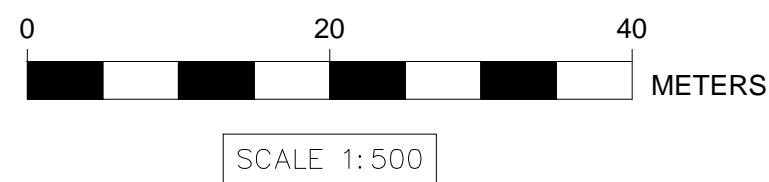

LEGEND				
1+000	STATION			
200.67	ORIGINAL C ELEVATION			
200.82	PROPOSED C ELEVATION			
---	EXISTING & PROPOSED C OF ROAD			
---	PROPOSED EDGE OF ASPHALT*			
---	PROPOSED EDGE OF SHOULDER**			
---	EXISTING TREE LINE			
---	EXISTING ROCK OUT CROP			
202.89 NL	EXISTING NAIL & ELEVATION			
---	PROPOSED SILT FENCING			
---	RIPRAP AT DOWNSTREAM END OF CULVERTS			
* EXISTING EDGE OF SURFACE TREATMENT NOT SHOWN				
** EXISTING EDGE OF SHOULDER NOT SHOWN				
BENCHMARK: 194.40 - SIB AT STA 0+160 ON EAST SIDE OF ROAD				



3	07/18/16	TENDER ISSUE	T.D.L.	J.T.G.
2	07/10/16	2ND SUBMISSION	T.D.L.	J.D.
1	06/03/16	FOR REVIEW	T.D.L.	
NO.	DATE	DESCRIPTION	Drawn by Dessine par	Approved Approuve

REVISIONS



ENGINEERING
CONSULTANTS LTD

Unit 104D
1010 9th Ave West
Owen Sound, On
N4K 5R7



Parcs
Canada

Parks
Canada



Canada

PARKS CANADA
EASTERN ONTARIO FIELD UNIT

Type of Record /
Type d'enregistrement

Project title / Titre du projet

CYPRUS LAKE ROAD
RECAPITALIZATION

Drawing title / Titre du dessin

PLAN VIEW
STA 5+350 - 5+455
AND DETAILS

Plot Scale / Echelle

1:500 (Arch D 24x36 Plot Size)

Drawn by/ Dessine par	Date
T.D.L.	07/18/2016

Field Recording by / Releve-Temoin par	Date
N/A	N/A

Approved by / Approuve par	Date
J.T.G	07/18//2016

Checked by/ Verifie par	Date
J.D.	07/18/2016

Project No./ No. du projet	Asset No.	Sheet No./ Feuille No.
16012	??	10

Drawing Re No./No. du Dessin
16012-10

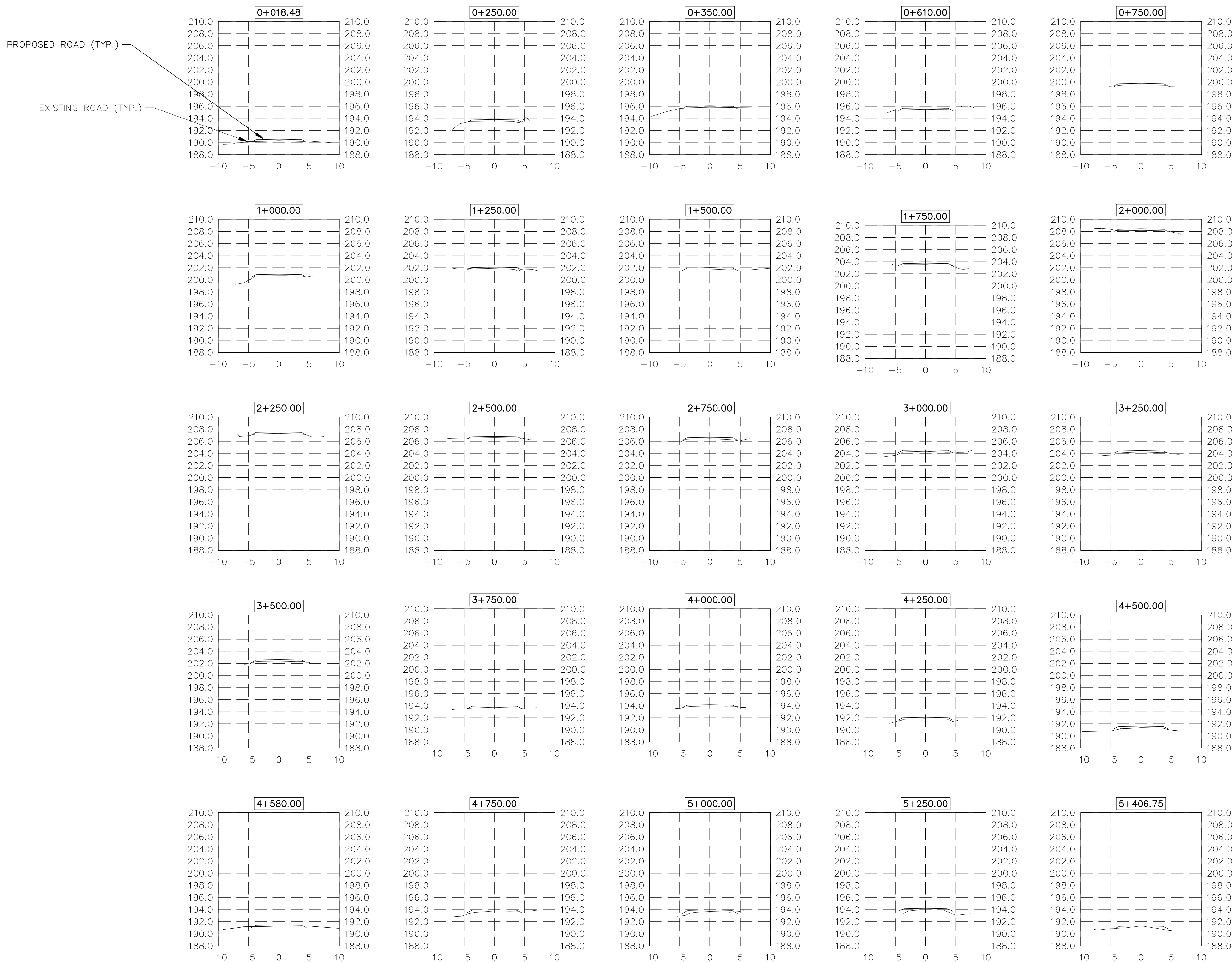

NOTES:

1. NEW CULVERTS TO BE PLACED AT SAME INVERTS AS EXISTING CULVERTS, UNLESS NOTED ON DRAWING. INVERT ELEVATIONS SHOWN ARE EXISTING.

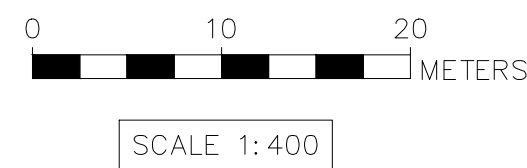

3	07/18/16	TENDER ISSUE	T.D.L.	J.T.G.
2	07/08/16	2ND SUBMISSION	T.D.L.	J.D.
1	06/03/16	FOR REVIEW	T.D.L.	
NO.	DATE	DESCRIPTION	Drawn by Dessine par	Approved Approuvé

REVISIONS

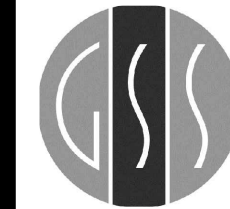

ENGINEERING
CONSULTANTS LTD.

Unit 104D
1010 9th Ave. West
Owen Sound, On
N4K 5R7



Parcs
Canada

Parks
Canada



Canada

PARKS CANADA
EASTERN ONTARIO FIELD UNIT

Type of Record /
Type d'enregistrement

Project title / Titre du projet

CYPRUS LAKE ROAD
RECAPITALIZATION

Drawing title / Titre du dessin

CROSS SECTION VIEW
STA 0+018 - 5+406
AND DETAILS

Plot Scale / Echelle

1:400 (Arch D 24x36 Plot Size)

Drawn by/ Dessine par
T.D.L. 07/18/2016

Field Recording by /
Releve-Temoin par
N/A N/A

Approved by / Approuve par
J.T.G. 07/18/2016

Checked by/ Verifie par
J.D. 07/18/2016

Project No./ No. du projet
16012

Asset No.
??

Sheet No./
Feuille No.

Drawing Re No./No. du Dessin
16012-11

11



TYPICAL 6.3m CROSS SECTION FROM
HWY #6 TO STATION 4+575
CYPRUS LAKE ROAD RECAPITALIZATION
PARKS CANADA
1:40 SCALE

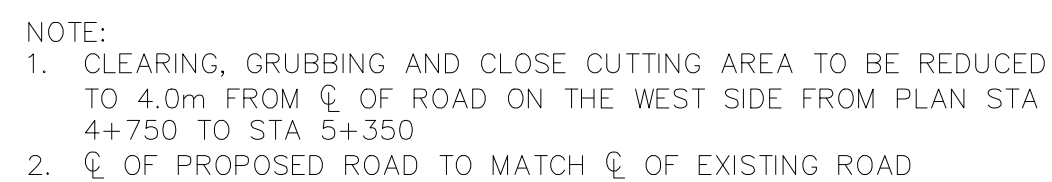

TYPICAL 6.0m CROSS SECTION FROM
STATION 4+750 TO STATION 5+406
CYPRUS LAKE ROAD RECAPITALIZATION
PARKS CANADA
1:40 SCALE



TYPICAL 6.3m CROSS SECTION SHOWING WIDENED AREAS
FOR BIKE LANE ONE SIDE
CYPRUS LAKE ROAD RECAPITALIZATION
PARKS CANADA
1:40 SCALE

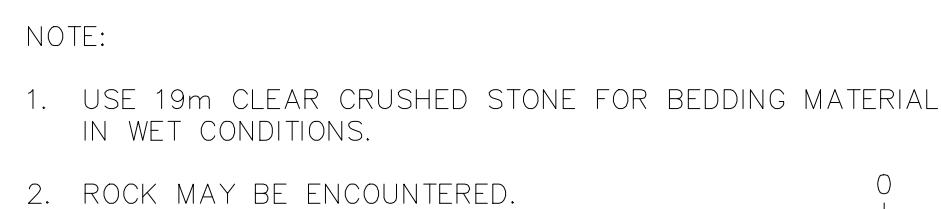

TYPICAL SECTION FOR PLACING ROAD
CROSSING CULVERTS
CYPRUS LAKE ROAD RECAPITALIZATION
PARKS CANADA
1:20 SCALE



TYPICAL CROSS SECTION SHOWING
ROAD CROSSING CULVERT
CYPRUS LAKE ROAD RECAPITALIZATION
PARKS CANADA
1:40 SCALE

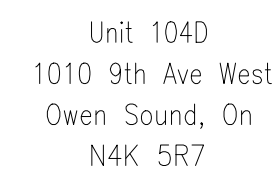
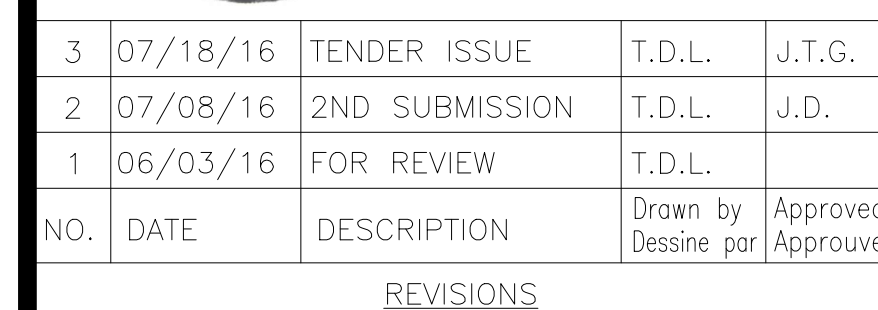

Canadä

PARKS CANADA
EASTERN ONTARIO FIELD UNIT

Type of Record /
Type d'enregistrement

Project title / Titre du projet

CYPRUS LAKE ROAD
RECAPITALIZATION

Drawing title / Titre du dessin

ROAD CROSS SECTIONS,
STANDARDS
AND DETAILS

Plot Scale / Echelle

AS SHOWN (Arch D 24x36 Plot Size)

Drawn by/ Dessine par	Date
T.D.L.	07/18/2016

Field Recording by / Releve-Termin par N/A	Date N/A
--	-------------

Approved by / Approuvé par J.T.G.	Date 07/18/2016
--------------------------------------	--------------------

Checked by/ Verifie par	Date
J.D.	07/18/2016

Project No./ No. du projet	Asset No.
16012	??

Drawing Re No./No. du Dessin	
16012-12	

12

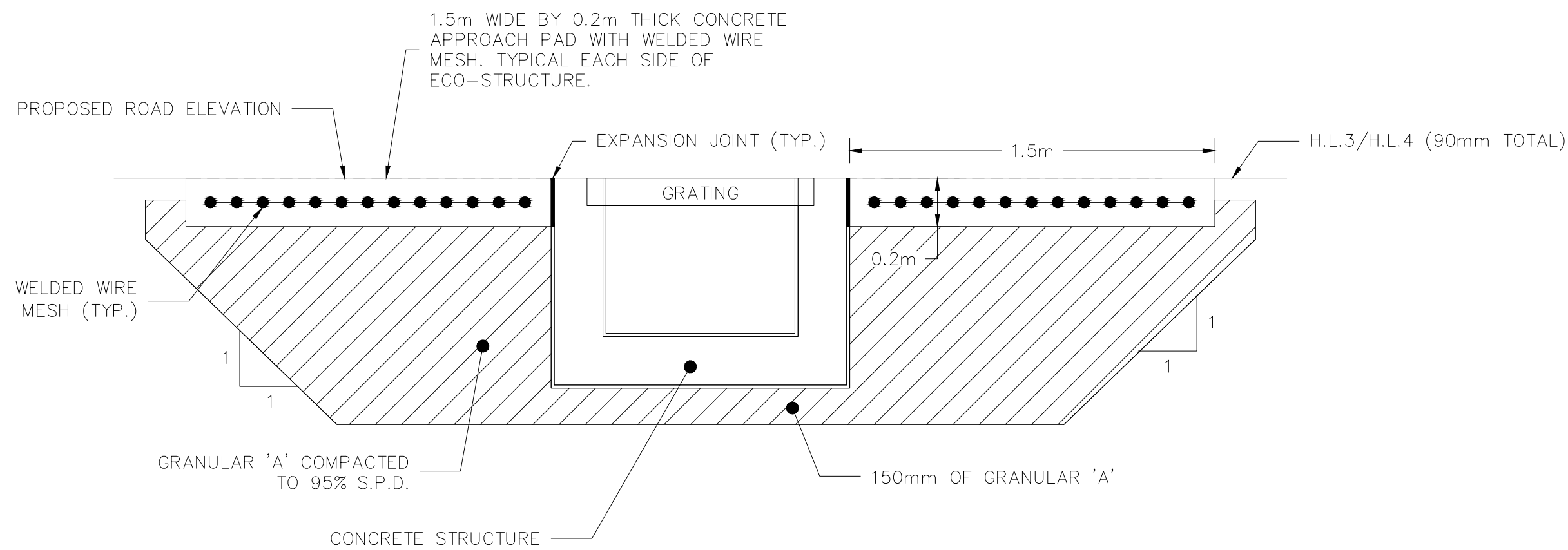
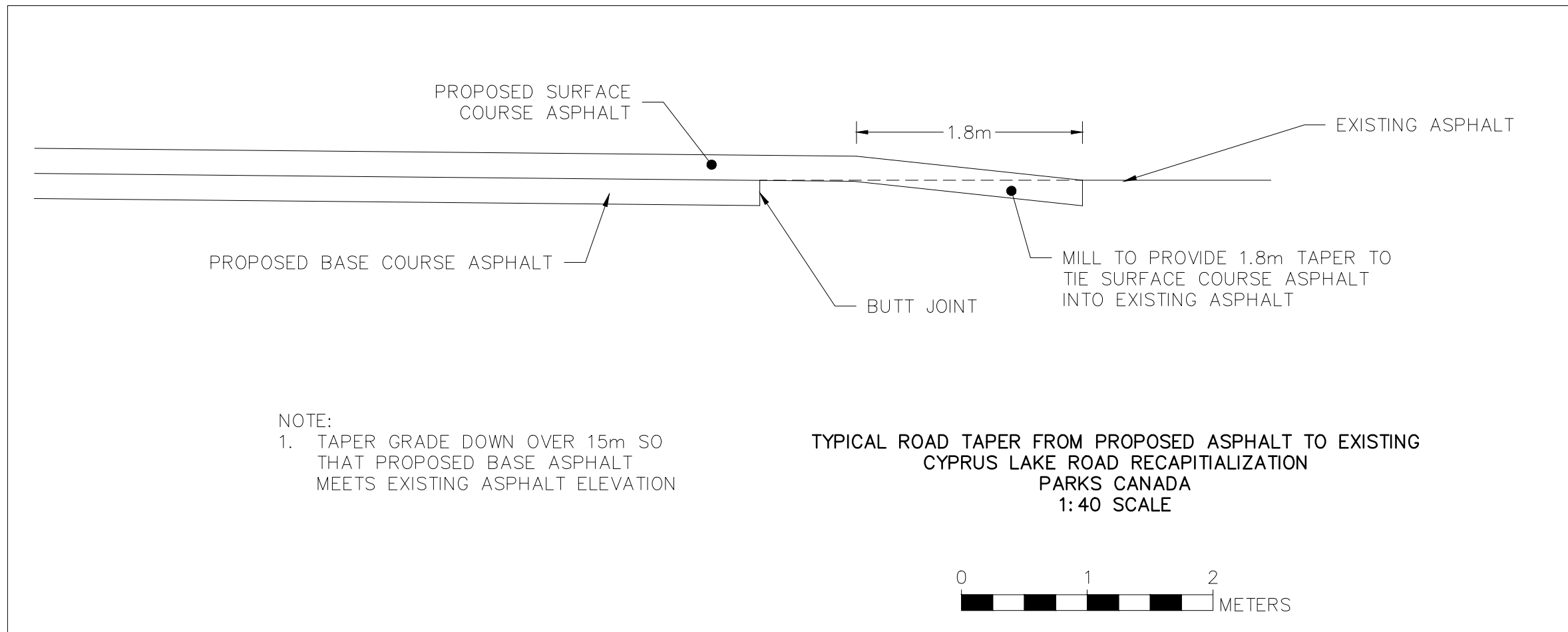
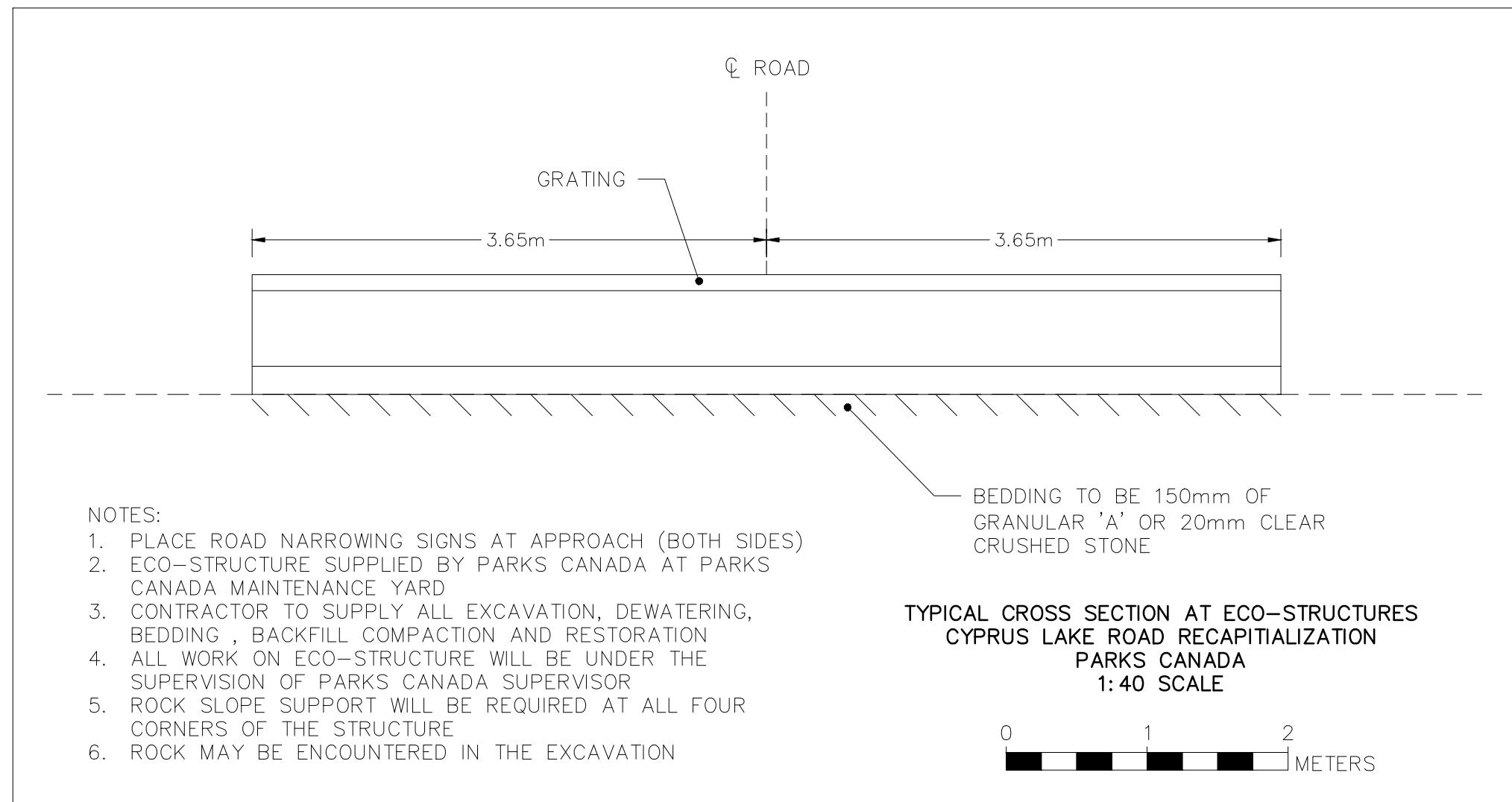
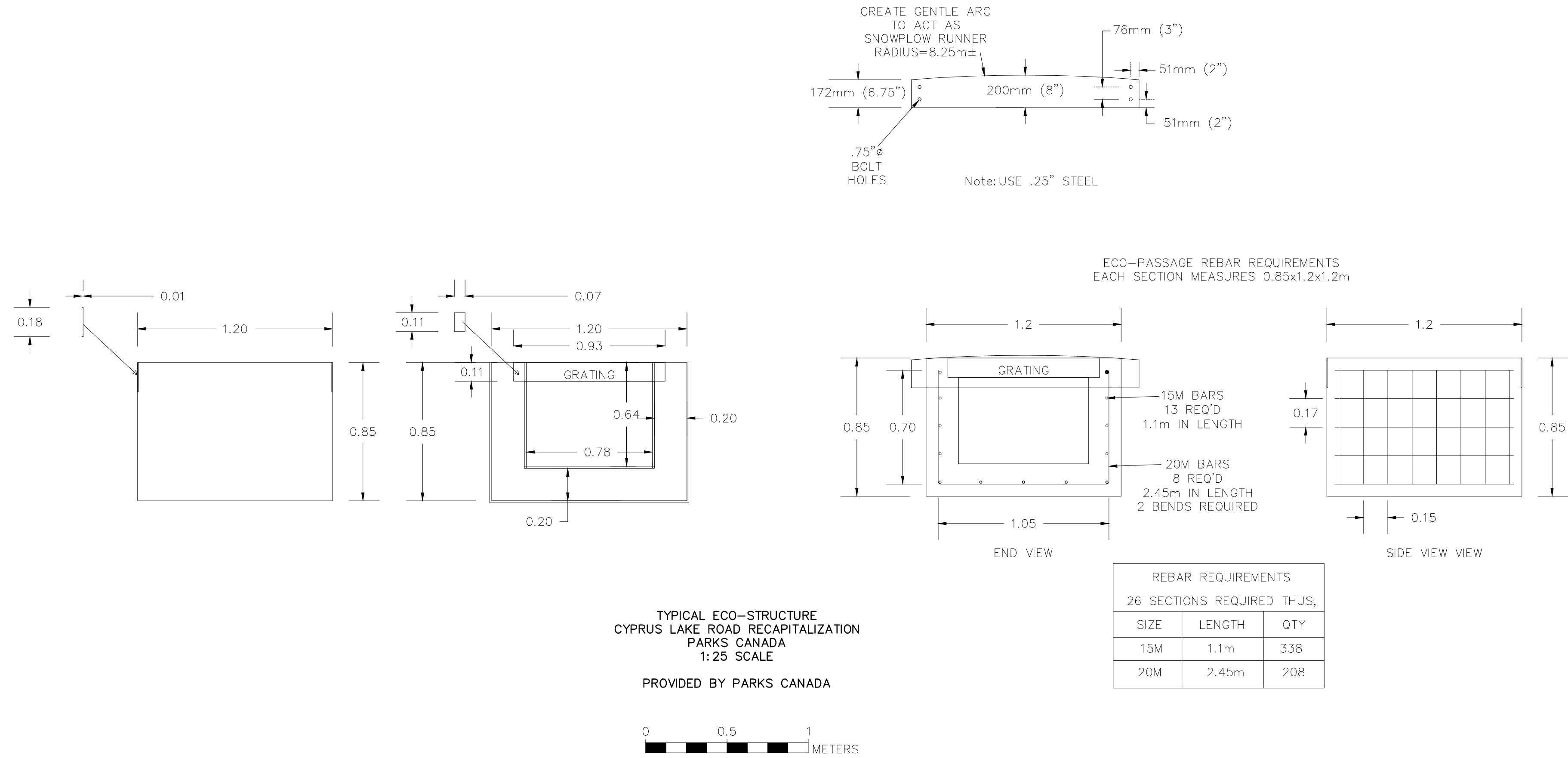

- NOTE:
1. ENSURE ADEQUATE BEARING CAPACITY AT BASE OF EXCAVATION
 2. IT IS ANTICIPATED THAT ROCK MAY BE ENCOUNTERED
 3. CONCRETE ECO-STRUCTURE AND GRATING SUPPLIED BY PARKS CANADA
 4. ECO STRUCTURES WILL BE INSTALLED UNDER THE SUPERVISION OF A PARKS CANADA OFFICIAL
 5. CONCRETE APPROACH PAD SHALL BE 35 MPa CONCRETE. SUBMIT DESIGN MIX FOR APPROVAL. 6% AIR ENTRAINMENT. PROVIDE EXPANSION JOINT TO OWNERS APPROVAL BETWEEN ECO-STRUCTURE AND APPROACH PAD FOR FULL WIDTH OF ROAD, INCLUDING SHOULDER WIDTHS.
 6. OVERALL LENGTH OF EACH CONCRETE APPROACH PAD IS 7.5m.
 7. CONCRETE APPROACH PADS TO MATCH EDGE OF ECO-STRUCTURE FOR FULL WIDTH BUT 2% CROSS FALL AT OTTER LIMITS TO MATCH ADJACENT ASPHALT.

CROSS SECTION SHOWING TYPICAL ECO STRUCTURE
INSTALLATION
CYPRUS LAKE ROAD RECAPITALIZATION
PARKS CANADA
1:20 SCALE

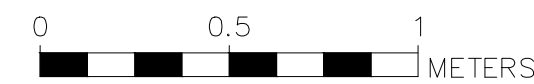

3	07/18/16	TENDER ISSUE	T.D.L.	J.T.G.
2	07/08/16	2ND SUBMISSION	T.D.L.	J.D.
1	06/03/16	FOR REVIEW	T.D.L.	
NO.	DATE	DESCRIPTION	Drawn by Dessine par	Approved Approuvé

REVISIONS



ENGINEERING
CONSULTANTS LTD

Unit 104D
1010 9th Ave West
Owen Sound, On
N4K 5R7



Parcs
Canada

Parks
Canada



Canada

PARKS CANADA
EASTERN ONTARIO FIELD UNIT

Type of Record /
Type d'enregistrement

Project title / Titre du projet

CYPRUS LAKE ROAD
RECAPITALIZATION

Drawing title / Titre du dessin

ECO-STRUCTURES
CROSS SECTIONS,
STANDARDS & DETAILS

Plot Scale / Echelle

AS SHOWN (Arch D 24x36 Plot Size)

Drawn by/ Dessine par
T.D.L.

Date
07/18/2016

Field Recording by /
Releve-Temoin par
N/A

Date
N/A

Approved by / Approuve par
J.T.G.

Date
07/18/2016

Checked by/ Verifie par
J.D.

Date
07/18/2016

Project No./ No. du projet
16012

Asset No.
??

Sheet No./
Feuille No.

Drawing Re No./No. du Dessin
16012-13

13

GENERAL

1.

ALL WORK UNDER THIS CONTRACT WILL BE GOVERNED BY
 - GOVERNMENT OF CANADA SPECIFICATIONS (NMS)
 - IF THERE IS NO NMS SPECIFICATION, ONTARIO PROVINCIAL STANDARD SPECIFICATIONS WILL BE USED IN PRESENT (WITH THE EXCEPTION OF PAYMENT OR MEASUREMENT FOR PAYMENT PROVISIONS)
2.

HOURS OF WORK WILL BE LIMITED TO DAYLIGHT HOURS, MONDAY TO SATURDAY EXCEPT FOR HOLIDAY WEEKENDS. NO WORK MAY BE CARRIED OUT BETWEEN 5pm FRIDAY AND 7am TUESDAY ON HOLIDAY WEEKENDS.
3.

TRAFFIC CONTROL
THE CONTRACTOR WILL BE RESPONSIBLE FOR TRAFFIC CONTROL. THIS WILL INCLUDE BUT NOT BE LIMITED TO SIGNAGE, BARRICADES, LIGHTING, FLAG PERSONS. SINGLE LANE TRAFFIC MUST BE MAINTAINED AT ALL TIMES WITH TWO (2) FLAG PERSONS DIRECTING TRAFFIC AT EACH AREA WHERE A LANE REDUCTION IS REQUIRED. TWO LANE TRAFFIC MUST BE MAINTAINED AT ALL NON WORKING HOURS.
4.

CLEARING, GRUBBING, CLOSE CUT CLEARING AND TRIMMING TO BE LIMITED TO THE AREA SHOWING THE TYPICAL CROSS SECTIONS PLUS ANY ADDITIONAL TREES OR BRANCHES THAT MAY BE DESIGNATED BY THE CONTRACT ADMINISTRATOR. REFER TO TYPICAL CROSS SECTIONS PLAN DRAWING 16012-12.
5.

ALL WOOD, BRANCHES, ROCKS AND DEBRIS FROM THE CLEARING AND GRUBBING OPERATION TO BE DISPOSED OF OFF SITE IN ACCORDING WITH LOCAL GUIDELINES AND REGULATIONS.
6.

THE INSTALLATION OF CULVERTS WILL INCLUDE DEWATERING, SILT CONTROL (SILT FENCE, TURBIDITY CURTAINS, COFFER DAMS AS REQUIRED) AND ALL EXCAVATION BEDDING, BACKFILL RIP-RAP AND RESTORATION.
7.

THE CONTRACTOR WILL BE RESPONSIBLE FOR LOCATING ALL UTILITIES AND THE PROTECTION OF ALL UTILITIES WITHIN HIS WORK AREA.
8.

THE CONTRACTOR IS RESPONSIBLE FOR ALL LAYOUT AND GRADES. PARKS CANADA WILL PROVIDE A BENCH MARK WITH GEODECTIC ELEVATION. THE EXISTING CENTRE LINE OF THE TRAVELING ROAD WILL BE THE HORIZONTAL CONTROL.
2.

THE EXISTING ROADBASE TO BE COMPACTED TO 98% OF ITS MAXIMUM PROCTOR DENSITY PRIOR TO PLACING ADDITIONAL GRANULAR A.
3.

ALL POLYETHYLENE CULVERTS TO BE PIPE STIFFNESS 320kPa.
4.

PLACE 150mm RIP RAP (APPROX. 1.0m X 1.5m) AT THE DOWNSTREAM END OF EACH ROAD CROSSING CULVERT. RIP RAP THICKNESS NOT TO EXCEED 300mm. RIP RAP TO BE PLACED ON GEOTEXTILE MEETING THE REQUIREMENTS OF OPSS 1860 CLASS 1.
5.

ECO-STRUCTURES (SUPPLIED BY PARKS CANADA) TO BE PLACED AT APPROXIMATE PLAN STATIONS 0+647 AND 1+623.
6.

DUST CONTROL WILL BE THE CONTRACTORS RESPONSIBILITY. WATER, CALCIUM OR OTHER DUST SUPPRESSANTS MAY BE REQUIRED.
7.

THE FINISHED SHOULDERS (0.6m WIDE) WILL REQUIRE COMPACTION WITH SMALL VIBRATORY COMPACTORS OR TEMPERS.
8.

A SINGLE WHITE SOLID LINE 0.10m WIDE WILL BE PAINTED ON ALL NEW ASPHALT WITH GAPS ONLY AT THE PARK CANADA ENTRANCE.
9.

STOP BLOCKS (WHITE) 0.3m WIDE WILL BE PAINTED ON THE NEW PAVEMENT AT EACH STOP SIGN.
10.

BIKE LANE PAINTING ALSO REQUIRED. SEE DRAWINGS FOR DETAILS.

EROSION CONTROL

1.

SILT FENCE TO BE IN ACCORDANCE WITH O.P.S.D. 219.110. SILT FENCE TO BE PLACED WHERE SHOWN ON THE PLAN, AROUND DISTURBED AREAS FOR CULVERT INSTALLATIONS AND WHERE REQUIRED BY THE CONTRACT ADMINISTRATOR. LOCATIONS REQUIRING SILT FENCE MAY CHANGE DUE TO SITE CONDITIONS AT TIME OF CONSTRUCTION.

ROADWORK

1.

PRIOR TO PLACING ANY GRANULAR MATERIAL THE SURFACE TREATMENT WILL BE PULVERIZED TO A DEGREE THAT WILL ALLOW TO BE INCORPORATED (GRADED) INTO THE EXISTING GRAVEL ROAD BASE. TOPSOIL WILL BE STRIPPED TO THE LIMIT OF THE PROPOSED ROAD SLOPES AND THE EXISTING ROAD WILL BE SHAPED AND WIDENED TO ACCOMMODATE THE PROPOSED CROSS SECTION. EXISTING SHOULDERS WILL BE GRADED TO CONFORM TO THE PROPOSED CROSS SECTION EXCEPT WHERE ROCK IS ENCOUNTERED. ROCK EXCAVATION WILL NOT BE REQUIRED EXCEPT FOR PLACING OF CULVERTS OR ECO-STRUCTURES.



3	07/18/16	TENDER ISSUE	T.D.L.	J.T.G.
2	07/08/16	2ND SUBMISSION	T.D.L.	J.D.
1	06/03/16	FOR REVIEW	T.D.L.	
NO.	DATE	DESCRIPTION	Drawn by Dessine par	Approved Approuvé

REVISIONS



ENGINEERING
CONSULTANTS LTD

Unit 104D
1010 9th Ave. West
Owen Sound, On
N4K 5R7



Parcs
Canada

Parks
Canada



Canada

PARKS CANADA
EASTERN ONTARIO FIELD UNIT

Type of Record /
Type d'enregistrement

Project title / Titre du projet

CYPRUS LAKE ROAD
RECAPITALIZATION

Drawing title / Titre du dessin

GENERAL NOTES

Plot Scale / Echelle N.T.S. (Arch D 24x36 Plot Size)		
Drawn by/ Dessine par T.D.L.		Date 07/18/2016
Field Recording by / Releve-Temoin par N/A		Date N/A
Approved by / Approuve par J.T.G.		Date 07/18/2016
Checked by/ Verifie par J.D.		Date 07/18/2016
Project No./ No. du projet 16012	Asset No. ??	Sheet No./ Feuille No. <div>14</div>
Drawing Re No./No. du Dessin 16012-14		