

1. Main Waiting Area

1.1 Function

- 1.1.1 Point of entry for all staff, clients and visitors
- 1.1.2 Representational space - portrays a positive image of Canada

1.2 Finishes

- 1.2.1 Enhanced Level
- 1.2.2 Hard surface flooring for high levels of traffic

1.3 Furnishings

- 1.3.1 Soft seating for visitors
- 1.3.2 Writing surface and brochure rack for visitor information
- 1.3.3 Wheelchair accessible counter with a signature book
- 1.3.4 Flags of Canada and the host country to the sides (left and right respectively) and portraits above (from left to right: Queen, Governor General, Prime Minister, Minister(s))

1.4 Equipment

- 1.4.1 Computer / tablet station for visitors
- 1.4.2 courtesy telephone

1.5 Communications

- 1.5.1 Standard building systems
- 1.5.2 DSL drop
- 1.5.3 Wired internet access
- 1.5.4 WIFI access to DFATD controlled intranet provider

1.6 Lighting

- 1.6.1 Combination of fully dimmable standard office LED light fixtures + fully dimmable accent lighting TBD by Architect.
- 1.6.2 Adjustable spot lights for artwork locations.
- 1.6.3 Light Level: As per design brief part 5.
- 1.6.4 Lighting Control: Line voltage dimming light switches.

1.7 Electrical / Fire Protection

- 1.7.1 General purpose normal power receptacles for house keeping. Dedicated circuit for television
- 1.7.2 Photoelectric smoke detector centrally located in the public area.
- One fire alarm signalling / visual appliances

1.8 Mechanical

- 1.8.1 When possible, the Representational Zone should be ventilated with a dedicated air handler unit. When independent units are not possible, these areas should be 100% exhaust (no air return). The amount of cooling and heating must be sufficient to maintain design criteria of the project brief part 5.
- 1.8.2 All Representational zones shall have a slightly lower air pressure compared to the operation zone to avoid migration of air from the Representational zone to the operation zone
- 1.8.3 Provide a ventilation and control suitable to maintain the comfort level whatever the occupancy is.

1.9 Acoustical

- 1.9.1 STC rating: 42

1.10 Special construction

1.11 Schematic Layout

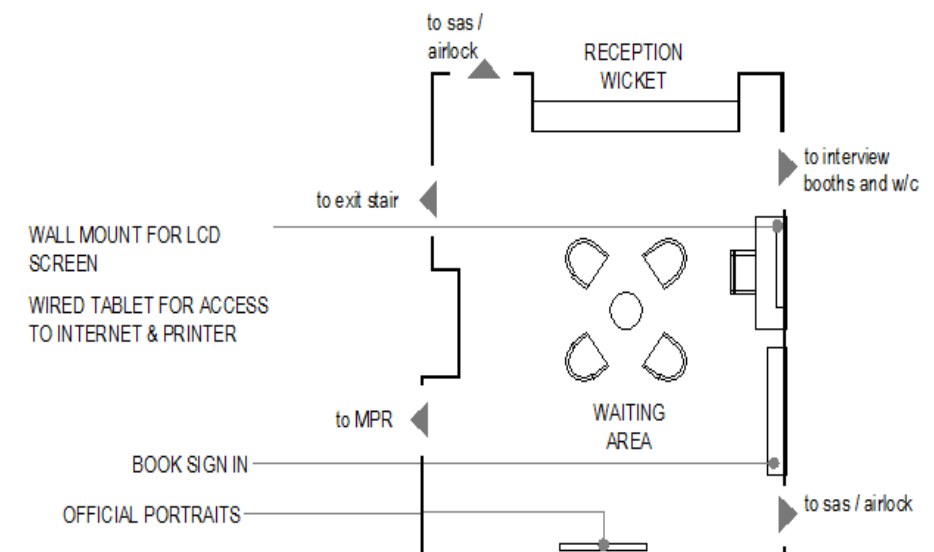

2. Reception Wicket

2.1 Function

- 2.1.1 Main point of contact for clients and visitors to the embassy
- 2.1.2 An unobstructed view of the entire waiting area and a window viewing into the Airlock

2.2 Finishes

- 2.2.1 Standard Office, in co-ordination with interior finishes

2.3 Furnishings

- 2.3.1 Built-in counter
- 2.3.2 Workstation, with storage, as required
- 2.3.3 Barrier free
- 2.3.4 Ergonomic chair
- 2.3.5 Keyboard tray

2.4 Equipment

- 2.4.1 Computer which is not visible to the client
- 2.4.2 Telephone
- 2.4.3 Switchboard
- 2.4.4 Parcel and document pass throughs
- 2.4.5 Annunciator panel

2.5 Communications

- 2.5.1 Standard building systems

2.6 Lighting

- 2.6.1 Combination of standard office LED fixtures + additional fully dimmable accent lighting TBD architect. Locate those lights to avoid unwanted shadow on the counter.
- 2.6.2 Take precaution with the location and intensity of the light to avoid creating a 2 sided mirror condition.
- 2.6.3 Light Level: As per design brief part 5.
- 2.6.4 Lighting Control: Line voltage and dimmer switches + central lighting control switch for open area to be located at this location.

2.7 Electrical / Fire Protection

- 2.7.1 Three Clean Power duplex receptacles beside the Voice Data (V/D) drop underneath work counter.
- 2.7.2 One general purpose normal power receptacle on one wall
- 2.7.3 Fire alarm panel to be located in this room
- 2.7.4 One photoelectric smoke detector

2.8 Mechanical

- 2.8.1 HVAC provided from the main system for this floor. The amount of cooling must be sufficient to maintain design criteria of the project brief part 4.
- 2.8.2 The receptionist wicket shall have a slightly higher air pressure than the waiting area.

2.9 Acoustical

- 2.9.1 STC rating: 42

2.10 Special construction

- 2.10.1 Walls between reception and public must be type 1 or 2

2.11 Schematic Layout

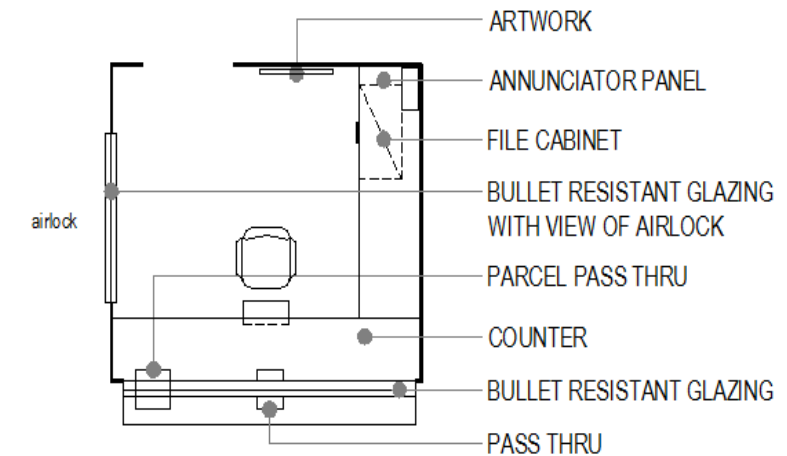

3. Interview Booths - Type A

3.1 Function

3.1.1 Type A interview booth - accommodates one interviewers and two clients

3.2 Finishes

3.2.1 Standard Office, in co-ordination with interior finishes
3.2.2 Hard surface flooring on client side

3.3 Furnishings

3.3.1 On operations (interviewer) side - built-in 610mm deep counter at desk height and ergonomic seating
3.3.2 On reception (client) side - built-in 450mm deep counter at desk height and visitor seating

3.4 Equipment

3.4.1 Computer which is not visible to the client
3.4.2 Telephone
3.4.3 Document pass-through
3.4.4 Stand alone printer
3.4.5 Credit / ATM machine

3.5 Communications

3.5.1 Standard building systems

3.6 Lighting

3.6.1 Combination of standard office LED fixtures + additional accent lighting TBD by Architect.
3.6.2 Locate light fixture to avoid unwanted shadow on the counter.
3.6.3 Take precaution with the location and intensity of the light to avoid creating a 2 sided mirror condition.
3.6.4 Light Level: As per design brief part 5.
3.6.5 Lighting Control: Line voltage switches.

3.7 Electrical / Fire Protection

3.7.1 One normal power receptacle on the client side above the counter.
3.7.2 Three Clean Power receptacles on DFATD Side on a 16 amp circuit beside the V/D drops.
3.7.3 Install one 19mm rigid conduit raceway between the client and DFATD side for biometrics equipment.
3.7.4 One photoelectric smoke detector on each side of the interview wicket

3.8 Mechanical

3.8.1 HVAC provided from the main system on the operational zone and from the same system as the waiting area for the reception zone. The amount of cooling must be sufficient to maintain design criteria of the project brief part 4.
3.8.2 The interviewer side shall have a slightly higher air pressure than the client side to avoid migration of air from the client side to the interviewer side.

3.9 Acoustical

3.9.1 STC rating: 42

3.10 Special construction

3.10.1 Walls separating the interview booths from public side must be type 1 or 2

3.11 Schematic Layout

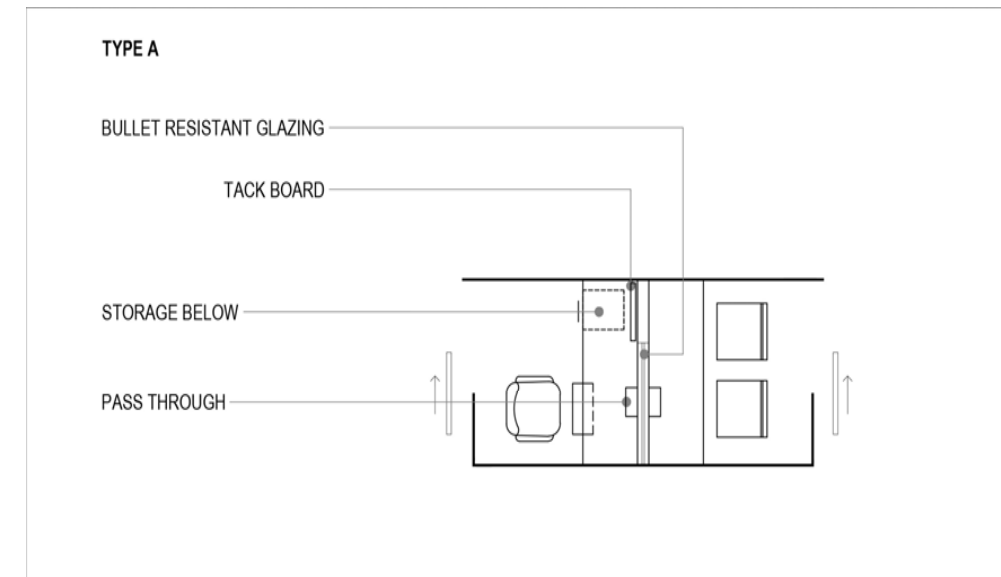

4. Multi-Purpose Room

4.1 Function

- 4.1.1 Flexible foundation representational space located in a prime location with a feature view
- 4.1.2 Multiple furniture set ups to suit both large and small scale business and social functions
- 4.1.3 Large scale gatherings include: trade delegations, media releases, conferences, public meetings and cultural events
- 4.1.4 Small scale functions include: meetings, training sessions, luncheons

4.2 Finishes

- 4.2.1 Enhanced Level finishes suitable to a high level representational space
- 4.2.2 Hard surface flooring, durable for high levels of traffic

4.3 Furnishings

- 4.3.1 Flexible, stackable furniture to accommodate multiple functions
- 4.3.2 Folding tables
- 4.3.3 Conference chairs as required
- 4.3.4 Cocktail tables
- 4.3.5 Credenza
- 4.3.6 Lectern
- 4.3.7 Fine art

4.4 Equipment

- 4.4.1 Drop down screen and projector
- 4.4.2 Built-in audio / visual and video-conference equipment with remote control panel
- 4.4.3 LCD wall-mounted screen
- 4.4.4 Sound system
- 4.4.5 Telephone

4.5 Communications

- 4.5.1 Audio and data drops flexible for multiple functions including floor, wall and ceiling, as required
- 4.5.2 Wi-Fi access to DFATD controlled internet provider

4.6 Lighting

- 4.6.1 Combination of fully dimmable standard office LED fixtures + fully dimmable accent lighting TBD by Architect.
- 4.6.2 Adjustable and dimmable LED spot lights for artwork
- 4.6.3 Light Level: 0 - 500 lux variable
- 4.6.4 Lighting Control: Line voltage dimmer switches.

4.7 Electrical / Fire Protection

- 4.7.1 Two Clean power duplex receptacles located adjacent to the Voice Data/cable floor outlets on a dedicated circuit
- 4.7.2 All wall receptacles connected on a 16 amp circuit from the normal power panel
- 4.7.3 Provision for a wall mounted receptacles at the TV/ screen location on a dedicated circuit.
- 4.7.4 Provision for point of connection for electric screen.
- 4.7.5 Provision for Audio Visual system.
- 4.7.6 Provision for Cable TV.
- 4.7.7 One signalling appliance both visual and sound.
- 4.7.8 One photoelectric smoke detector

4.8 Mechanical

- 4.8.1 When possible, the Representational Zone should be ventilated with a dedicated air handler unit. It can be the same as the waiting area. When independent units are not possible, these areas should be 100% exhaust (no air return). The amount of cooling must be sufficient to maintain design criteria of the project brief part 4.
- 4.8.2 Provide a ventilation and control suitable to maintain the comfort level whatever the use and the occupancy is.

4.9 Acoustical

- 4.9.1 STC rating: 45

4.10 Special construction

- 4.10.1 To feature Canadian art / sculpture
- 4.10.2 AV equipment to be hidden when not in use

4.11 Schematic Layout

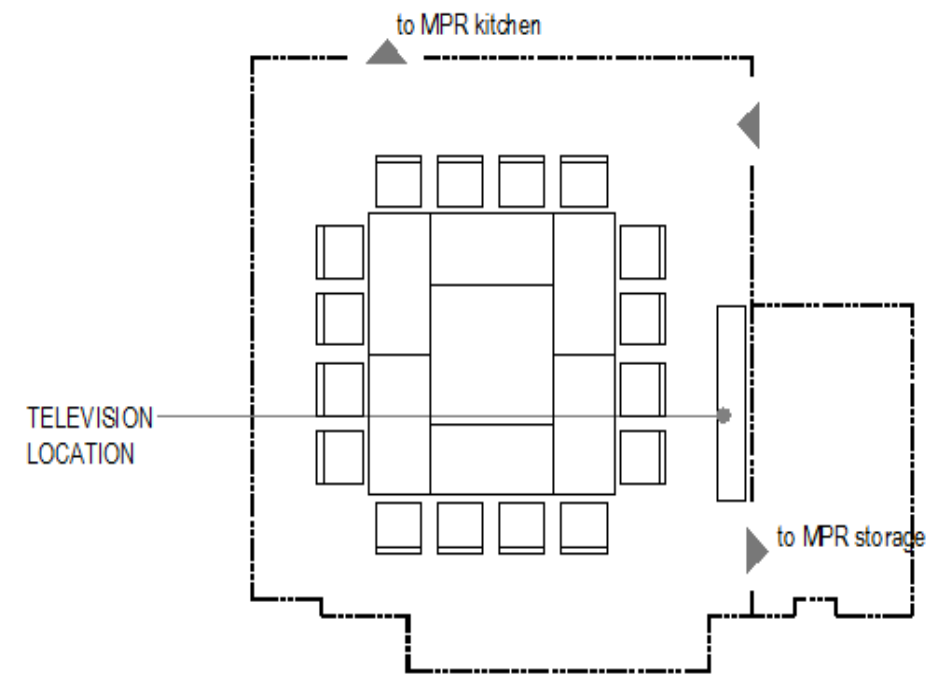

5. Multi-Purpose Kitchen

5.1 Function

5.1.1 Catering / warming facility

5.2 Finishes

5.2.1 Durable all finishes to be durable and to match current built in cupboards/counters
 5.2.2 Detailed layouts, elevations, samples/finishes to be approved by DFATD
 5.2.3 Locally sourced, large scale floor tile

5.3 Furnishings

5.3.1 Dishwasher, glass washer, large microwave, ice maker, warming oven, water dispenser, drinks fridge, fridge

5.4 Equipment

5.5 Communications

5.6 Lighting

5.6.1 Standard office LED lighting fixtures.
 5.6.2 Lighting Level: 500 lux over work area.
 5.6.3 Lighting Control: Line voltage switch.
 5.6.4 Fluorescent LED strip lighting under overhead cupboard controlled by wall mounted switch under the cupboard.

5.7 Electrical / Fire Protection

5.7.1 One wall mounted duplex outlet (normal Power) for each piece of kitchen equipment such as microwave, glass dishwasher (2), warming cabinet, ice maker, wine fridge, drink fridge and refrigerator. A minimum of 6 circuits are required for all kitchen appliances as per para 6.8 of the brief.
 5.7.2 Note: Any countertop Outlets located within 1500mm of the sink shall be the European "Schuko" 16A-230v CEE7 GFCI (RCBO/RCD) (EU1-16r) duplex outlet, (10ma. trip), IP20.
 5.7.3 Heat detector located on the ceiling of the kitchen

5.8 Mechanical

5.8.1 The kitchen for the MPR will require a kitchen extraction to limit the migration of odours into the adjacent space. The kitchen will be a catering re-heat kitchen. No cooking or food preparation will be done on site. It is a warming kitchen.
 5.8.2 Install kitchen hood if a commercial dishwasher is installed.

5.9 Acoustical

5.9.1 STC rating: 45

5.10 Special construction

5.11 Schematic Layout

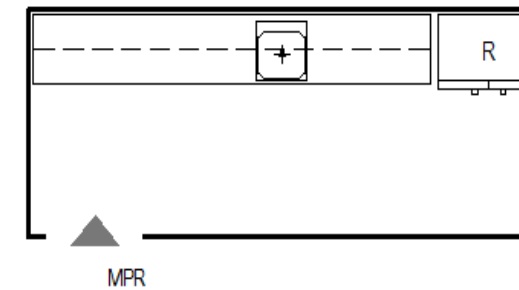

6. Meeting Rooms

6.1 Function

- 6.1.1 Space for staff to use for meeting within the operational and secure zones
- 6.1.2 Size and quantity based on total population per floor

6.2 Finishes

- 6.2.1 Enhanced Level finishes
- 6.2.2 Durable for high levels of traffic
- 6.2.3 Door with glass sidelight

6.3 Furnishings

- 6.3.1 Fixed furniture (conference table with cable management and chairs, credenza / storage unit)
- 6.3.2 Photographic prints, map, clocks as required

6.4 Equipment

- 6.4.1 Wall mount LCD TV w/ laptop connection
- 6.4.2 Teleconference (polycom)

6.5 Communications

- 6.5.1 To accommodate table mounted polycomm for teleconferences

6.6 Lighting

- 6.6.1 Combination of fully dimmable standard office LED fixture + fully dimmable adjustable spot lights for artwork. Locations TBD by architect
- 6.6.2 Lighting Level: 0 to 500 lux
- 6.6.3 Lighting Control: Line voltage dimmer switches.

6.7 Electrical / Fire Protection

- 6.7.1 One 16 amp duplex receptacle located adjacent to the V/D outlet.
- 6.7.2 One wall mounted duplex receptacle behind the TV on a dedicated circuit.
- 6.7.3 Two general purpose receptacles on each partition walls.
- 6.7.4 Photoelectric smoke detector.

6.8 Mechanical

- 6.8.1 HVAC provided by the main unit for this floor. The amount of cooling must be sufficient to maintain design criteria of project brief part 4.

6.9 Acoustical

- 6.9.1 STC rating: 42

6.10 Special construction

6.11 Schematic Layout

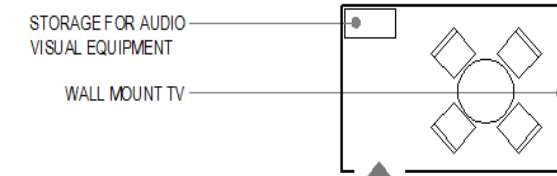

7. Video Conference Room

7.1 Function

- 7.1.1 To provide audio-visual requirements to seat 8-14
- 7.1.2 representational space

7.2 Finishes

- 7.2.1 Enhanced Level finishes
- 7.2.2 durable for high level of traffic

7.3 Furnishings

- 7.3.1 Flexible or fixed furniture (conference table with cable management and chairs, credenza / storage unit)
- 7.3.2 Photographic prints, map, clocks as required

7.4 Equipment

- 7.4.1 Wall mount LCD display, central control panel, polycomm
- 7.4.2 Telephone
- 7.4.3 VCnet equipment (by DFATD)

7.5 Communications

- 7.5.1 Reference section 8 brief

7.6 Lighting

- 7.6.1 Combination of fully dimmable standard LED light fixtures + fully dimmable adjustable spot lights for artwork. Locations TBD by architect.
- 7.6.2 Lighting Level: 0 to 500 lux
- 7.6.3 Lighting Control: Line voltage dimmer switches.

7.7 Electrical / Fire Protection

- 7.7.1 One 16 amp duplex receptacle located adjacent to the V/D outlet.
- 7.7.2 One wall mounted duplex receptacle behind the TV on a dedicated circuit.
- 7.7.3 Two general purpose receptacles on each partition wall.
- 7.7.4 Photoelectric smoke detector.

7.8 Mechanical

- 7.8.1 HVAC provided by the main unit for this floor. The amount of cooling must be sufficient to maintain design criteria of project brief part 4 whatever the occupancy.

7.9 Acoustical

- 7.9.1 STC Rating: 42

7.10 Special construction

7.11 Schematic Layout

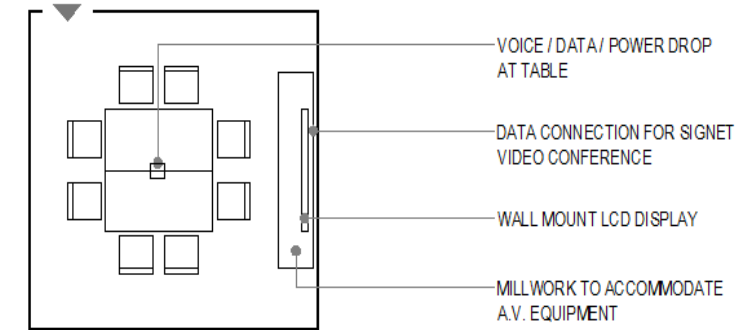

8. Quiet Room

8.1 Function

8.1.1 Small, enclosed space for the shared use of staff working in open office workstations
 8.1.2 For private phone calls or for temporary work requiring a high level of concentration

8.2 Finishes

8.2.1 Standard Office finishes in coordination with interior finishes

8.3 Furnishings

8.3.1 Soft seating, table for telephone

8.4 Equipment

8.4.1 Telephone
 8.4.2 SIGNET workstation

8.5 Communications

8.5.1 Standard building system

8.6 Lighting

8.6.1 Fully dimmable standard office LED light fixtures.
 8.6.2 Lighting Level: 0 to 500 lux
 8.6.3 Lighting Control: Line voltage dimmer switch.

8.7 Electrical / Fire Protection

8.7.1 One 16 amp duplex receptacle located adjacent to the V/D outlet
 8.7.2 Photoelectric smoke detector

8.8 Mechanical

8.8.1 HVAC provided by the main unit for this floor. The amount of cooling must be sufficient to maintain design criteria of project brief part 4.

8.9 Acoustical

8.9.1 STC Rating: 42

8.10 Special construction

8.11 Schematic Layout

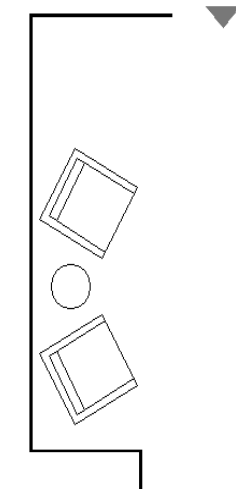

9. Business Centre

9.1 Function

- 9.1.1 A shared space to accommodate copier, fax, printers, stationary storage, mail and a computer with scanner
- 9.1.2 Centrally located for convenience of access

9.2 Finishes

- 9.2.1 Standard Office Finishes
- 9.2.2 Durable for high levels of traffic

9.3 Furnishings

- 9.3.1 1830mm to 3050mm of linear counter and storage
- 9.3.2 Storage for paper, toner, garbage and recycling

9.4 Equipment

- 9.4.1 4 in 1: printer, copier, scanner, fax
- 9.4.2 Shredder
- 9.4.3 Stand-alone computer
- 9.4.4 SIGNET workstation

9.5 Communications

- 9.5.1 Standard building system

9.6 Lighting

- 9.6.1 Standard office LED light fixture.
- 9.6.2 Light Level as per project brief part 5.
- 9.6.3 Lighting Control: Line voltage light switch.
- 9.6.4 Fluorescent LED strip lighting under overhead cupboard controlled by one switch mounted under the cupboard.

9.7 Electrical / Fire Protection

- 9.7.1 One 16A receptacle for photocopier on a dedicated circuit
- 9.7.2 One 16A receptacle for printer on a dedicated circuit
- 9.7.3 One 16A receptacle for shredder on a dedicated circuit.
- 9.7.4 Two 16A receptacles installed beside the V/D drop on a dedicated circuit.
- 9.7.5 Photoelectric smoke detector

9.8 Mechanical

- 9.8.1 HVAC provided from the main system for this floor. The amount of cooling must be sufficient to maintain design criteria of the project brief part 4.
- 9.8.2 Exhaust rate of 2.5 l/s per m².

9.9 Acoustical

9.10 Special construction

9.11 Schematic Layout

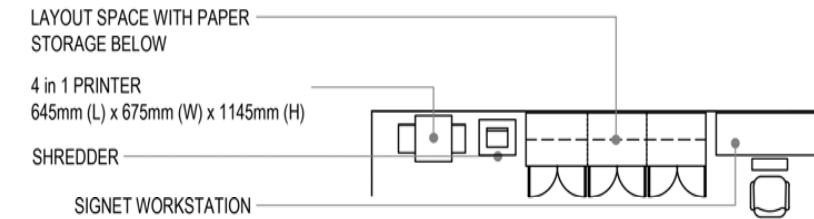

10. Staff Lunchroom + Kitchenettes

10.1 Function

10.1.1 Space for staff to prepare food, eat, lounge and / or meet

10.2 Finishes

- 10.2.1 Standard Office finishes
- 10.2.2 Hard surface or resilient flooring
- 10.2.3 Durable for high levels of traffic

10.3 Furnishings

- 10.3.1 Kitchen millwork w/ quartz counter top
- 10.3.2 Recycling centre and garbage bins
- 10.3.3 Dining / meeting tables, stackable chairs / stools

10.4 Equipment

10.
4.1
T_w

10.5 Communications

10.6 Lighting

- 10.6.1 Standard office LED fixtures + fully dimmable ambience lighting TBD by architect.
- 10.6.2 Light Level as per PB part 5.
- 10.6.3 Lighting Control: Line voltage light and dimmer switches.
- 10.6.4 Fluorescent LED strip lighting under overhead cupboard controlled by wall mounted switch under the cupboard.

10.7 Electrical / Fire Protection

- 10.7.1 Four 16A duplex receptacle located above the kitchen counter on normal power on 2 dedicated circuits.
- 10.7.2 One 16A receptacle for fridge on a dedicated circuit.
- 10.7.3 One 16A receptacle for microwave on a dedicated circuit.
- 10.7.4 One 16A receptacle for the dishwasher on a dedicated circuit.
- 10.7.5 Three 16A receptacle on each walls.
- 10.7.6 Provision for Cable TV and Wall mount electrical outlet for TV on a dedicated circuit
- 10.7.7 Photoelectric smoke detector

10.8 Mechanical

- 10.8.1 HVAC provided from the main system for this floor. The amount of cooling must be sufficient to maintain design criteria of the project brief part 4.
- 10.8.2 Appropriate air circulation to control the environment and to avoid migration of odour to the surrounding.
- 10.8.3 Exhaust rate of 1.5 l/s per m².
- 10.8.4 Provide hot (Install tank if not existing) and cold domestic water to the sink complete with isolating valves under the sink.
- 10.8.5 Provide water treatment to have potable water at the sink.
- 10.8.6 Make the connection to the dishwasher
- 10.8.7 Provide cast iron drainage connected to the main building drain pipe and venting for the piping.

10.9 Acousti

10.10 Special construction

10.11 Schematic Layout

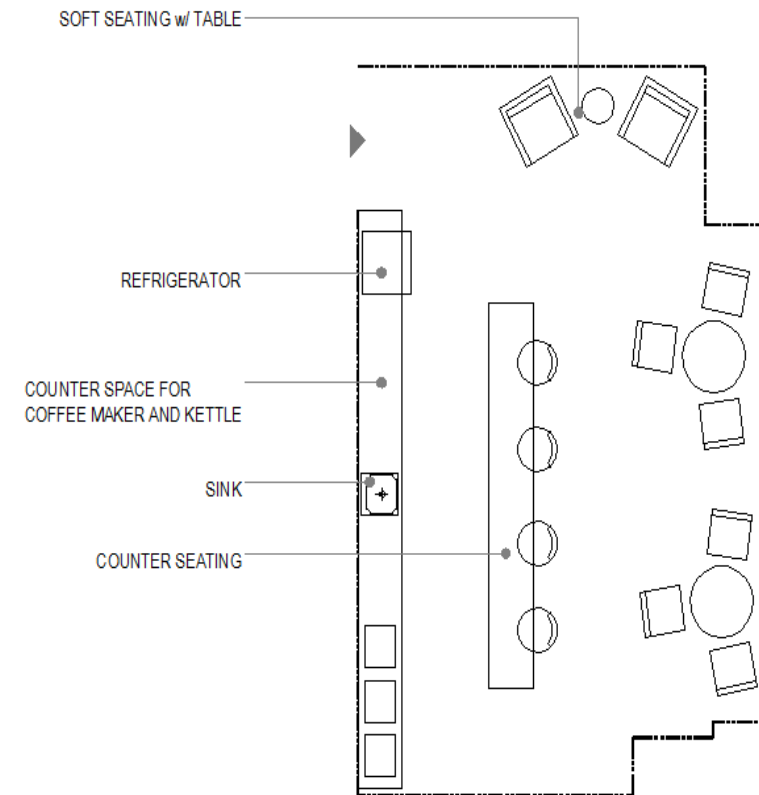

11. Open Workstation / Touchdown - 1.5 sq.m

11.1 Function

11.1.1 Touch down space for visitors or part time staff to work

11.2 Finishes

11.2.1 Standard Office finishes

11.3 Furnishings

11.3.1 Open office systems furniture

11.4 Equipment

11.4.1 Standard Signet workstation
11.4.2 Telephone

11.5 Communications

11.5.1 Voice / data receptacles

11.6 Lighting

11.6.1 Standard office LED light fixtures.
11.6.2 Light Level as per project brief part 5.
11.6.3 Lighting Control: Central light switch located near the main floor entrance of the Embassy.

11.7 Electrical / Fire Protection

11.7.1 Two 16A clean power duplex receptacle within a Legrand power pole or equivalent.
11.7.2 Maximum of four workstations per 16 amps circuit.
11.7.3 Photoelectric Smoke detector.

11.8 Mechanical

11.8.1 HVAC provided from the main system for this floor. The amount of cooling must be sufficient to maintain design criteria of the project brief part 4.

11.9 Acoustical

11.10 Special construction

11.11 Schematic Layout

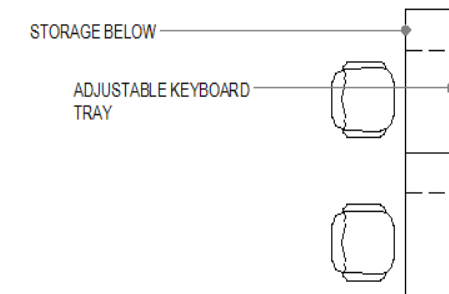

12. Open Workstation - 4.5 sq.m

12.1 Function

12.1.1 Space for program staff to work

12.2 Finishes

12.2.2 Standard Office finishes

12.3 Furnishings

12.3.1 Open office systems furniture
12.3.2 Workstation with file, binder and book storage

12.4 Equipment

12.4.1 Standard Signet workstation
12.4.2 Telephone

12.5 Communications

12.5.1 Voice / data receptacles

12.6 Lighting

12.6.1 Standard office LED light fixtures.
12.6.2 Light Level: As per design brief part 5.
12.6.3 Lighting Control: Central light switch located near the main floor entrance of the Embassy.

12.7 Electrical / Fire Protection

12.7.1 Two 16A clean power duplex receptacle with USB connector capability
12.7.2 Maximum of four workstations per 16 amps circuit
12.7.3 Photoelectric Smoke detector.

12.8 Mechanical

12.8.1 HVAC provided from the main system for this floor. The amount of cooling must be sufficient to maintain design criteria of the project brief part 4.

12.9 Acoustical

12.10 Special construction

12.11 Schematic Layout

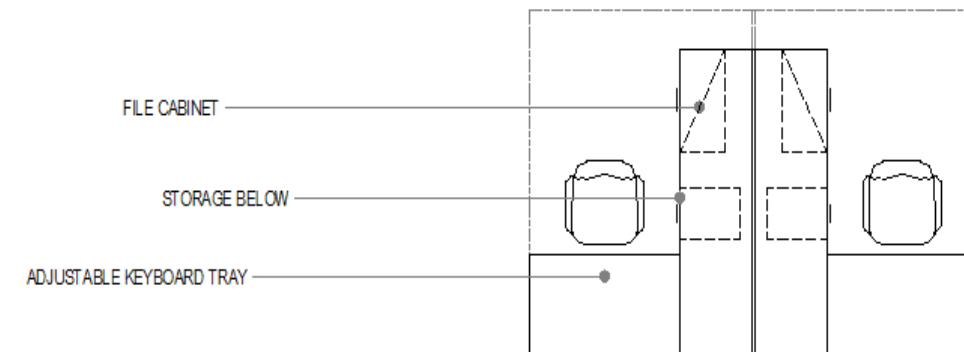

13. Enclosed Workstation 14sq.m

13.1 Function

13.1.1 Space for Head of Mission (HOM) to work

13.2 Finishes

13.2.1 Enhanced Level finishes

13.3 Furnishings

- 13.3.1 Casegoods, ergonomic set up
- 13.3.2 Workstation with file, binder and book storage
- 13.3.3 Include two guest chairs in front of desk
- 13.3.4 Include separate small soft seating or meeting area
- 13.3.5 Fine art

13.4 Equipment

- 13.4.1 Standard Signet workstation
- 13.4.2 Telephone

13.5 Communications

13.5.1 Voice / data receptacles to suit

13.6 Lighting

- 13.6.1 Combination of fully dimmable standard office LED light fixtures + fully dimmable accent lighting TBD by Architect.
- 13.6.2 Adjustable and dimmable spot lights for artwork locations
- 13.6.3 Light Level: As per design brief part 5
- 13.6.4 Lighting Control: Line voltage dimming light switches.

13.7 Electrical / Fire Protection

- 13.7.1 Two duplex receptacles wall mounted located beside the V/D drop / C5 terminal point on a dedicated circuit.
- 13.7.2 General purpose duplex receptacle on each wall of the room.
- 13.7.3 One 16 amp receptacle located behind TV on dedicated circuit.
- 13.7.4 One Photoelectric Smoke detector.

13.8 Mechanical

13.8.1 HVAC provided from the main system for this floor. The amount of cooling must be sufficient to maintain design criteria of the project brief part 4.

13.9 Acoustical

13.9.1 STC Rating: 54

13.10 Special construction

13.11 Schematic Layout

