

FISHERIES AND OCEANS

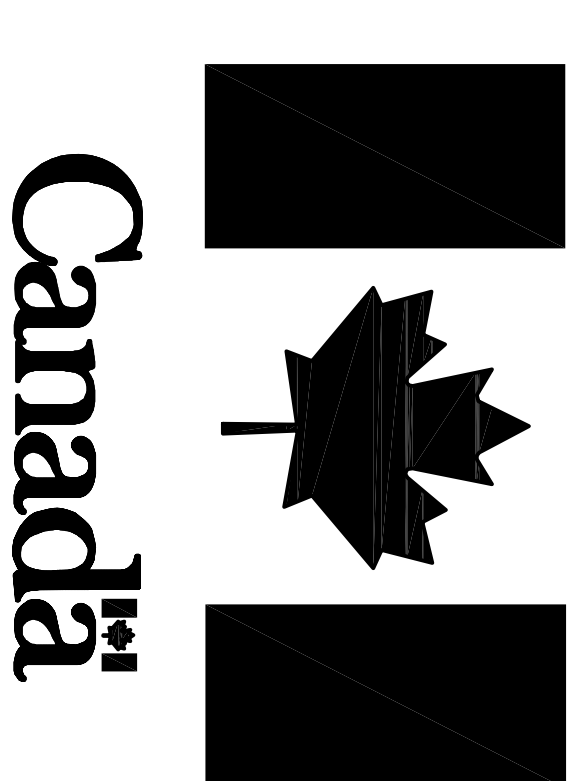

**RESTORATION OF THE CAPE BAULD
LIGHT TOWER**
CAPE BAULD, NL

PROJECT NO.: F6879-167006
ISSUED FOR TENDER

DATE: AUGUST 7, 2016

CLIENT/OWNER:
DEPARTMENT OF FISHERIES & OCEANS,
REAL PROPERTY, SAFETY & SECURITY

PRIME CONSULTANTS:
AFN ENGINEERING INC.

DRAWING LIST:
TITLE WORK PLAN
02M1101A02401C1
02M1101A02401C2 DETAILS AND NOTES

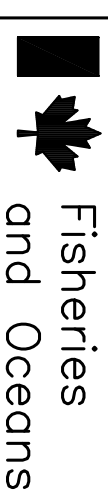

Fisheries and Oceans
Pêches et Océans
Real Property, Safety & Security
Biens immobiliers, protection et sécurité

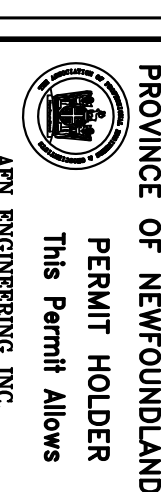

PROVINCE OF NEWFOUNDLAND
PERMIT HOLDER
This Permit Allows
APR ENGINEERING, INC.
APR ENGINEERING INC.
2016
To practice Professional Engineering in Newfoundland and Labrador, effective from August 1, 2016, which is valid for the year 2016.

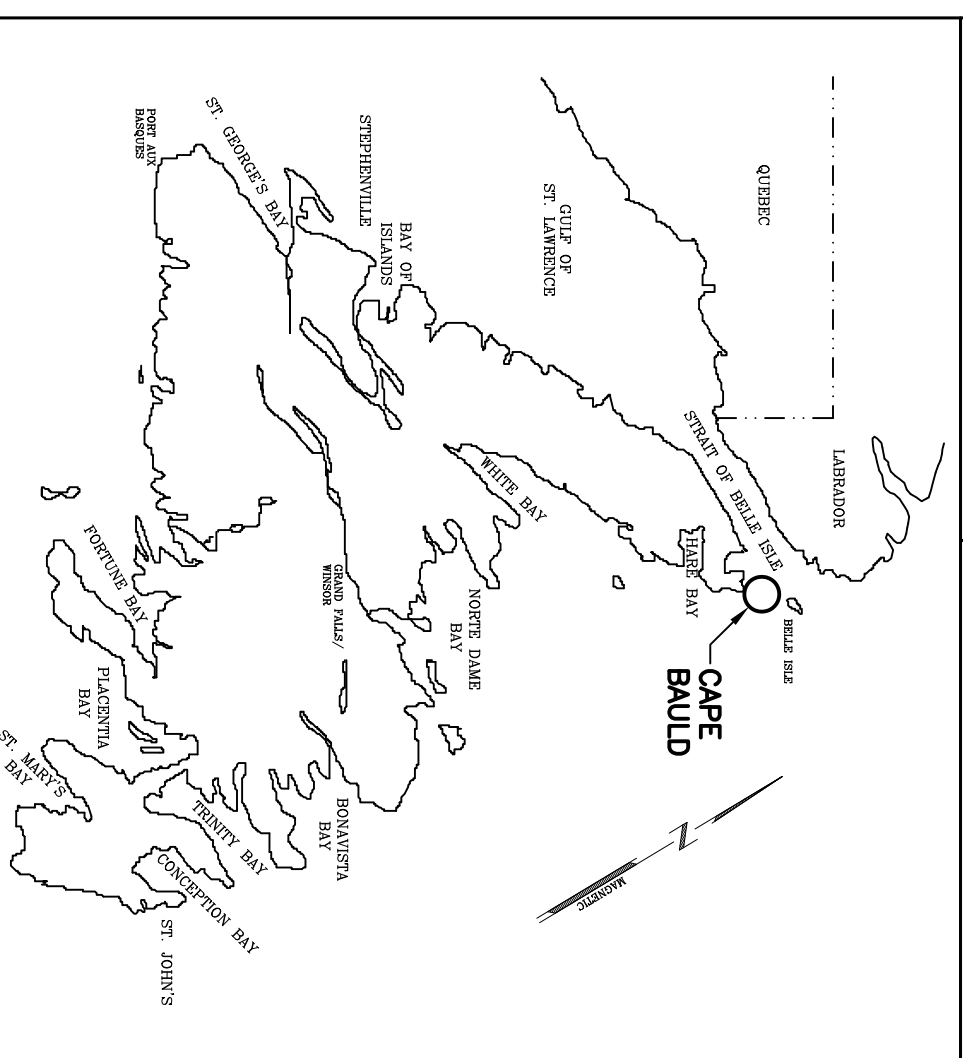

LEAD PAINT IS PRESENT ON THE TOWER. ALL LEAD PAINT REMOVAL ACTIVITIES ARE TO BE IN ACCORDANCE WITH THE REMOVAL OF LEAD FROM BUILDINGS ACT AND REGULATIONS. THE "GUIDELINES FOR LEAD IN CONSTRUCTION PRODUCTS FROM OCCUPATIONAL, HEALTH AND SAFETY BRANCH, ONTARIO MINISTRY OF LABOUR, APRIL, 2011", A COPY OF THIS DOCUMENT CAN BE PROVIDED BY THE DEPARTMENTAL REPRESENTATIVE UPON REQUEST.

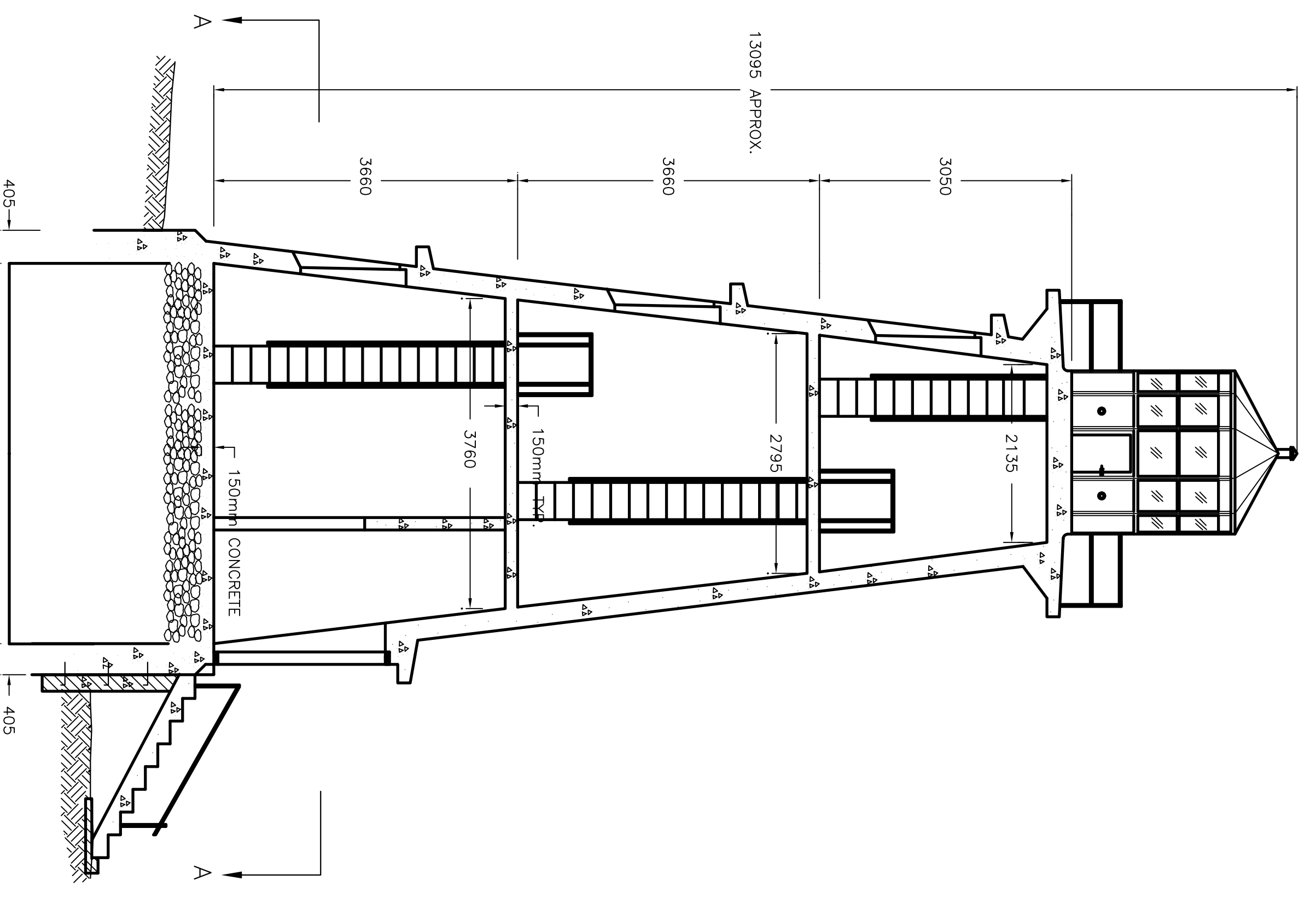

SECTION B-B
SCALE: 1:50
1 1 1

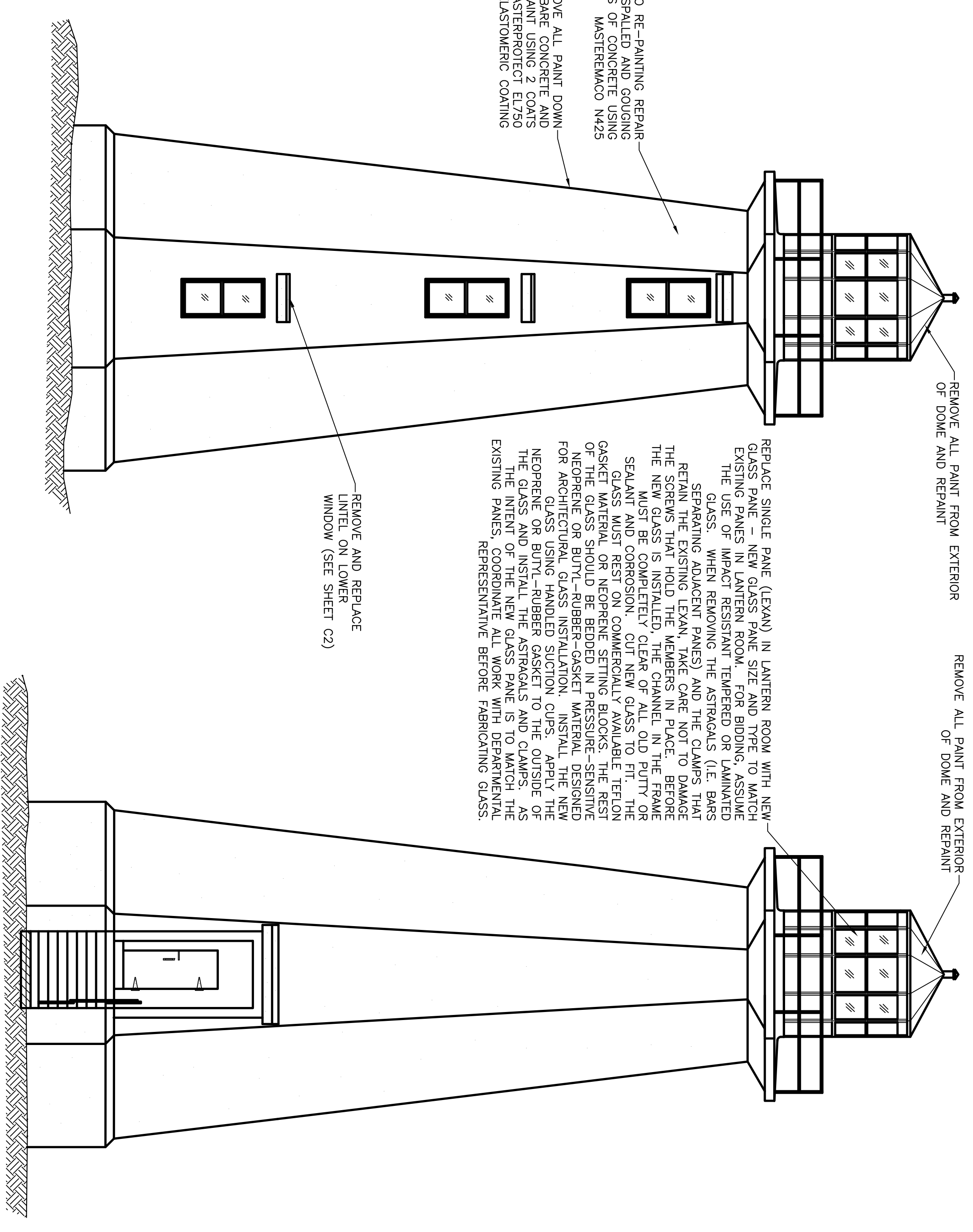

REAR ELEVATION
SCALE: 1:50
1 1 1

FRONT ELEVATION
SCALE: 1:50
1 1 1

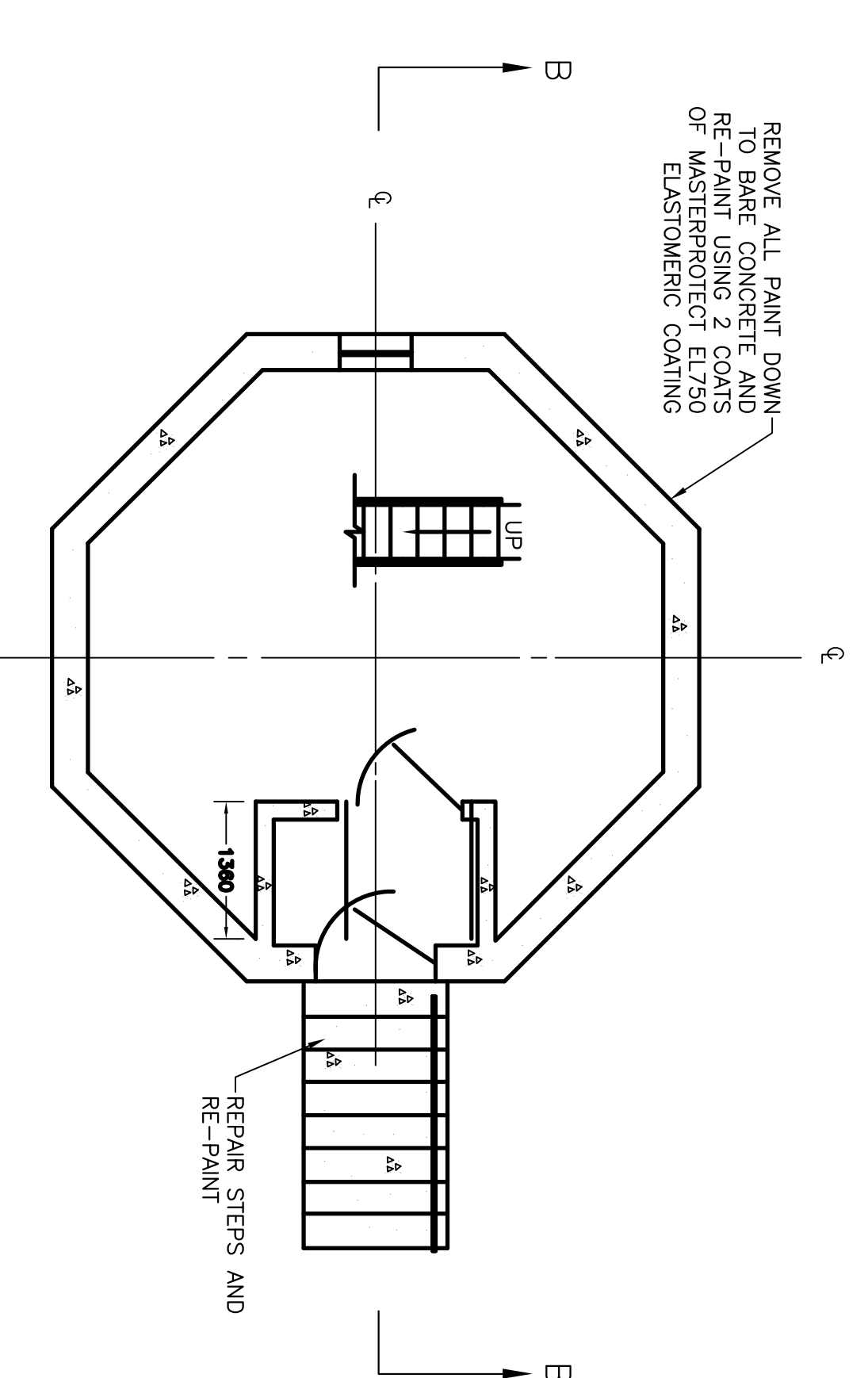

SECTION A-A
SCALE: 1:50
1 1 1

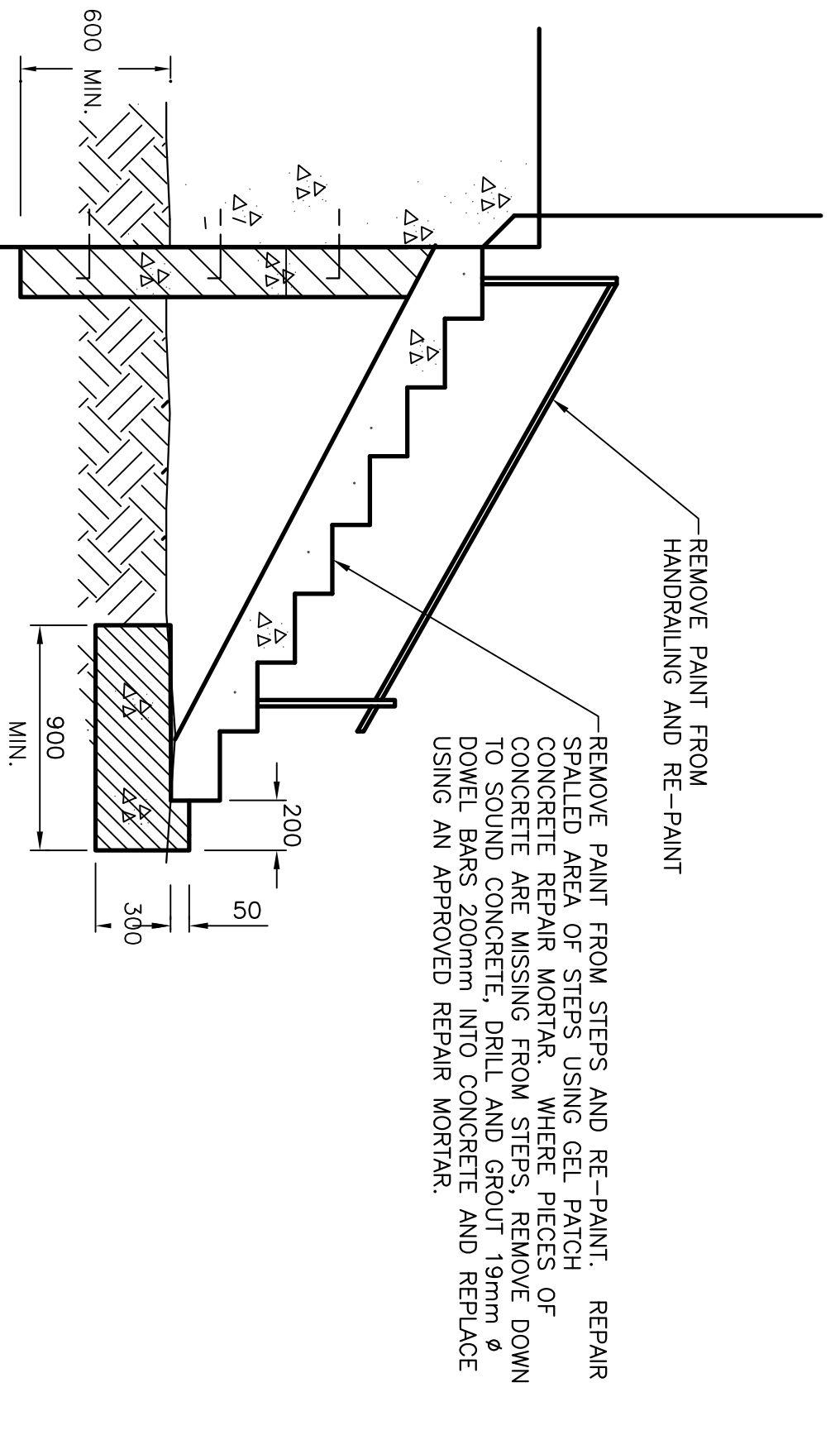

EXTERIOR STEPS
SCALE: 1:50
1 1 1

WORK PLAN

RESTORATION OF THE
CAPE BAULD LIGHT TOWER

no.	revision	date	by	approved
A	ISSUED FOR TENDER	08/07/16	P.H.	N.H.

Drawing - design

drawn - dessiné	checked - vérifié	designed - dessiné par
P.H.	N.H.	P.H.
date - date	checked - vérifié	designed - dessiné par
AUGUST 7, 2016	N.H.	P.H.
scale - échelle	approved for tender - approuvé pour l'offre	
AS SHOWN		
project no. - projet no.	drawing no. - no. du dessin	sheet - feuille
FS9379-167006	02M1101A02401C1	C1

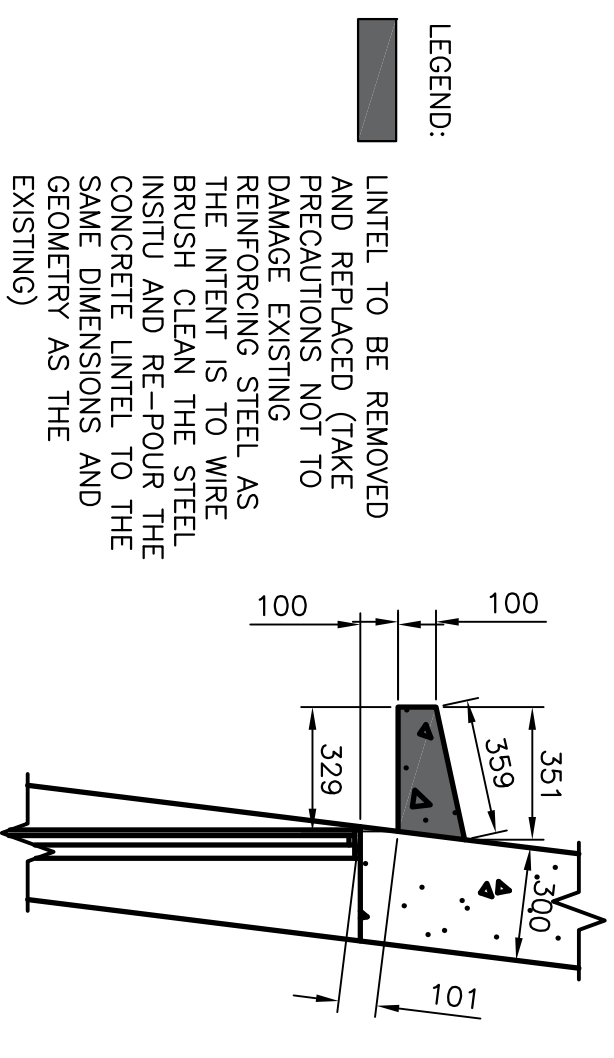

LINTEL REPLACEMENT
SCALE : 1:20
0mm 500mm 1000mm 1500mm 2000mm 2500mm

- CONCRETE TOWER:**
- HIGH PRESSURE WASH AND/OR SAND BLAST THE ENTIRE EXTERIOR OF THE TOWER TO REMOVE ALL PAINT DOWN TO BARE CONCRETE. NO EXISTING PAINT IS TO REMAIN ON THE EXTERIOR OF THE LIGHT TOWER AREAS ON THE EXTERIOR TO A MINIMUM OF 50MM WITH A MINIMUM DEPTH OF 25mm. ASSUME AN ADDITIONAL 50mm OF CONCRETE SPALLING, ONCE CRACKS AND SPALLED AREAS HAVE BEEN PREPARED, APPLY MASTER BAKO N425 (OR APPROVED EQUIVALENT) IN ACCORDANCE WITH MANUFACTURER'S INSTRUCTIONS. WHEN PRESSURE WASH THE ENTIRE EXTERIOR CONCRETE STRUCTURE TO REMOVE ALL CONTAMINANTS THAT MAY BE ON THE SURFACE.
 - ONCE REPAIRS HAVE CURED, PRESSURE WASH THE ENTIRE EXTERIOR CONCRETE EQUIVALENT TO THE ENTIRE EXTERIOR CONCRETE SURFACE, APPLY AS PER MANUFACTURER'S WRITTEN INSTRUCTIONS. ENSURE HOVRINGS IS IN PLACE PRIOR TO PRESSURE WASHING. GENERAL NOTES ON THIS PAGE, PAINT COLOUR TO BE WHITE TO MATCH EXISTING.

- ALUMINIUM ENCLOSURE:**
- PRESSURE WASH OR ABRASIVE BLAST TO REMOVE ALL EXISTING COATING THAT ARE ON SURFACE. GENERAL REQUIREMENT IS A LIGHT ABRASIVE BLAST TO ACHIEVE AN ANCHOR PROFILE OF 1.5MILS (ROUGH SAND PAPER FINISH).
 - DEPARTMENTAL REPRESENTATIVE WILL CONDUCT AN INSPECTION PRIOR TO RE-PAINING TO BE INITIATED WITHOUT THE APPROVAL OF THE DEPARTMENTAL REPRESENTATIVE. RE-PAINT INTERIOR AND EXTERIOR OF LANTERN ROOM ENCLOSURE.
- ACCEPTABLE PAINT PRODUCTS (OR APPROVED EQUIVALENTS) FOR ALUMINIUM SECTIONS, ARE AS FOLLOWS:**
- PRIME SURFACE BY APPLYING 2 COATS OF AMERLOCK 2 SURFACE TOLERANT EPOXY COATING (OR APPROVED EQUIVALENT) AT 5-7 MILS DRY FILM THICKNESS PER COAT. APPLY ONE COAT OF AMERSHIELD HIGH SOLIDS POLYURETHANE COATING (OR APPROVED EQUIVALENT) AT 3-5 MILS DRY FILM THICKNESS.
 - ALL RED PAINT TO BE "COAST GUARD RED".

- GAUVANIZED STEEL SECTIONS:**
- GAUVANIZED STEEL SECTIONS: PRESSURE WASH OR ABRASIVE BLAST TO REMOVE ALL EXISTING COATING THAT ARE ON THE SURFACE. GENERAL REQUIREMENT IS A LIGHT ABRASIVE BLAST TO ACHIEVE AN ANCHOR PROFILE OF 1.5MILS (ROUGH SAND PAPER FINISH).
 - DEPARTMENTAL REPRESENTATIVE WILL CONDUCT AN INSPECTION PRIOR TO RE-PAINING TO BE INITIATED WITHOUT THE APPROVAL OF THE DEPARTMENTAL REPRESENTATIVE. RE-PAINT INTERIOR AND EXTERIOR OF LANTERN ROOM ENCLOSURE.
- ACCEPTABLE PAINT PRODUCTS (OR APPROVED EQUIVALENTS) FOR GALVANIZED STEEL SECTIONS, ARE AS FOLLOWS:**
- PRIME SURFACE BY APPLYING 2 COATS OF AMERLOCK 2 SURFACE TOLERANT EPOXY COATING (OR APPROVED EQUIVALENT) AT 5-7 MILS DRY FILM THICKNESS PER COAT. APPLY ONE COAT OF AMERSHIELD HIGH SOLIDS POLYURETHANE COATING (OR APPROVED EQUIVALENT) AT 3-5 MILS DRY FILM THICKNESS.
 - ALL RED PAINT TO BE "COAST GUARD RED".

- GENERAL NOTES:**
- SCAFFOLDING MUST BE DESIGNED AND STAMPED BY A PROFESSIONAL ENGINEER, LICENSED BY PEG-NL TO PRACTICE ENGINEERING IN THE PROVINCE OF NEWFOUNDLAND AND LABRADOR. THE SCAFFOLDING MUST BE COMPLETELY ENCLOSED AND HOARDED TO ENSURE PROPER TEMPERATURES AND AMBIENT SURFACE CONDITIONS CAN BE MAINTAINED PRIOR TO, DURING, AND AFTER PAINTING OPERATIONS. NO EXTERIOR PAINTING WORK WILL BE PERMITTED UNTIL THE SCAFFOLDING AND HOARDED ENCLOSURE IS FULLY ENCLOSED. SCAFFOLDING AND HOARDED ENCLOSURE TO BE STAMPED BY P.E.N.G.
 - MANDATORY SITE VISIT: NO ADDITIONAL COST TO CANADA WILL BE INCURRED TO OBTAIN CRITICAL DIMENSIONS AND FULLY UNDERSTAND THE SCOPE OF WORK DURING THE PRE-TENDER MANDATORY SITE VISIT.

Fishes and Oceans **Pêches et Océans**
Safety & Security **Biens immobiliers, protection et sécurité**

PROVINCE OF NEWFOUNDLAND
PERMIT HOLDER
 The Permit Holders
 ARE ENGINEERING INC.
 100 Water Street
 St. John's, NL A1B 1X6
 In Newfoundland and Labrador, the Professional Engineer's Act, R.S.N.S. 1990, c. 100, which is valid for the term 2016.

REGISTERED PROFESSIONAL ENGINEER
 WILL C. BURN
 100 Water Street
 St. John's, NL A1B 1X6
 REGISTRATION NO. 10000
 REGISTRATION EXPIRES 31/03/2018

RESTORATION OF THE CAPE BAULD LIGHT TOWER

Drawn - dessiné P.H. designed - dessiné par N.H.
 date - date AUGUST 7, 2016 checked - vérifié N.H.
 scale - échelle AS SHOWN approved for tender - approuvé pour l'offre

Project no. - projet no. drawing no. - no. du dessin sheet - feuille
 F69379-167006 02M1101A02401C2 C2

A	ISSUED FOR TENDER	08/07/16	P.H.	N.H.
no.	revision	date	by	approved
no.	revision	date	by	approved

Project - projet

DETAILS AND NOTES