

Addendum / Addenda

Project Description / Description de projet M02M10 Re-Roof Project		
Solicitation No./N° de sollicitation 16-22069	Project No./N° de projet 5230	W.O. No./N° d'ordre de travail A1-006900-03-01
Departmental Representative / représentant ministériel Kirk Williams		Date September 6, 2016
Notice: This addendum shall form part of the tender documents and all conditions shall apply and be read in conjunction with the original plans and specifications.		Nota: Cet addenda fait partie intégrale des dossiers d'appel; toutes les conditions énoncées doivent être lues et appliquées en conjonction avec les plans et les devis originaux.

Alternates

1. Revise Section 061000; page 3, Item 2.4.3.1.1 to read AIR-SHIELD by W.R. Meadows shall be considered equal
2. The self ballasted anchor system by DBI Sala is considered an acceptable alternate to the product specified in Section 07 52 00, Item 2.20.

General

3. Add north wing of Building M2 to contract as indicated on roof plan drawing, attached. Construction detailing and specifications are provided in the original documents.
4. The Mandatory Site Visit Attendance Sheets are attached.



National Research
Council Canada

Conseil national de
recherches Canada

Canada 

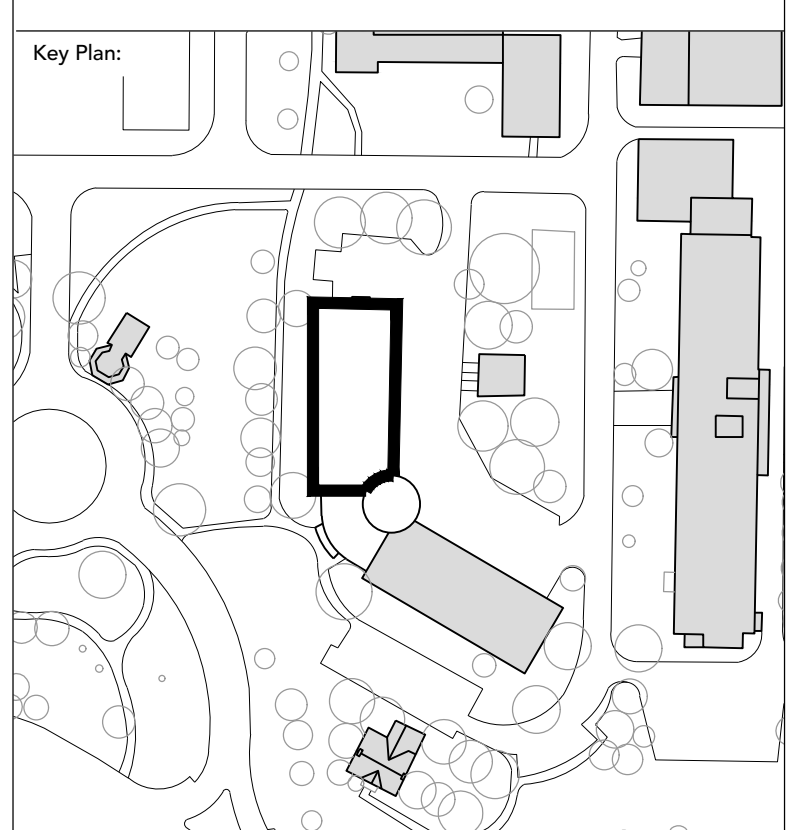
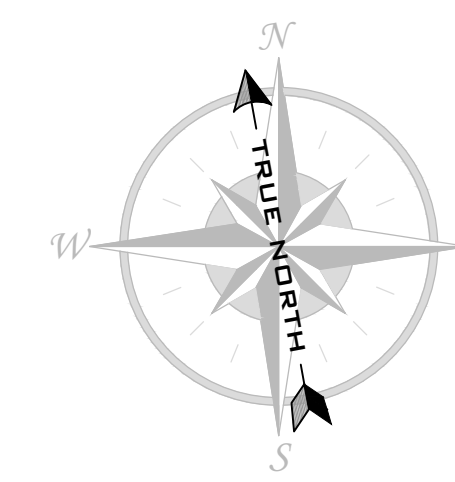

Notes:
 1. CONTRACTOR IS RESPONSIBLE TO VERIFY ALL DIMENSIONS AND CONFIRM EXISTING CONDITIONS.
 2. NOTIFY CONSULTANT IMMEDIATELY OF ANY DEVIATIONS FROM ASSUMED EXISTING CONDITIONS AS THEY ARE ENCOUNTERED ON SITE.
 3. DRAWINGS ARE NOT TO BE SCALED.

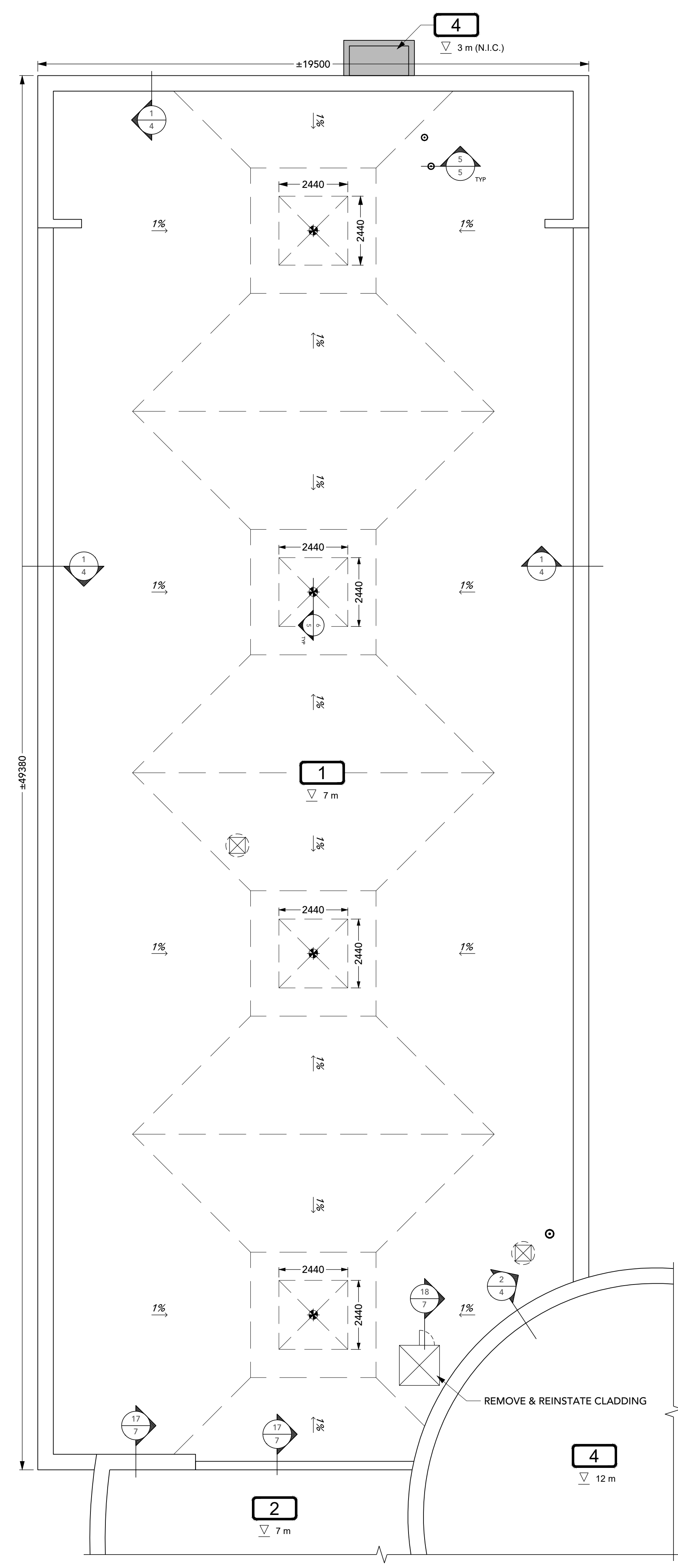

LEGEND	
SYMBOL	DESCRIPTION
	BELL EXHAUST
	EXTENT & DIRECTION OF SLOPED INSULATION
	DOOR
	PLUMBING VENT
	ROOF DRAIN & SUMP
	ROOF NUMBER, ELEVATION & AREA
	ROOF STRUCTURE

ROOF PLAN
1:100

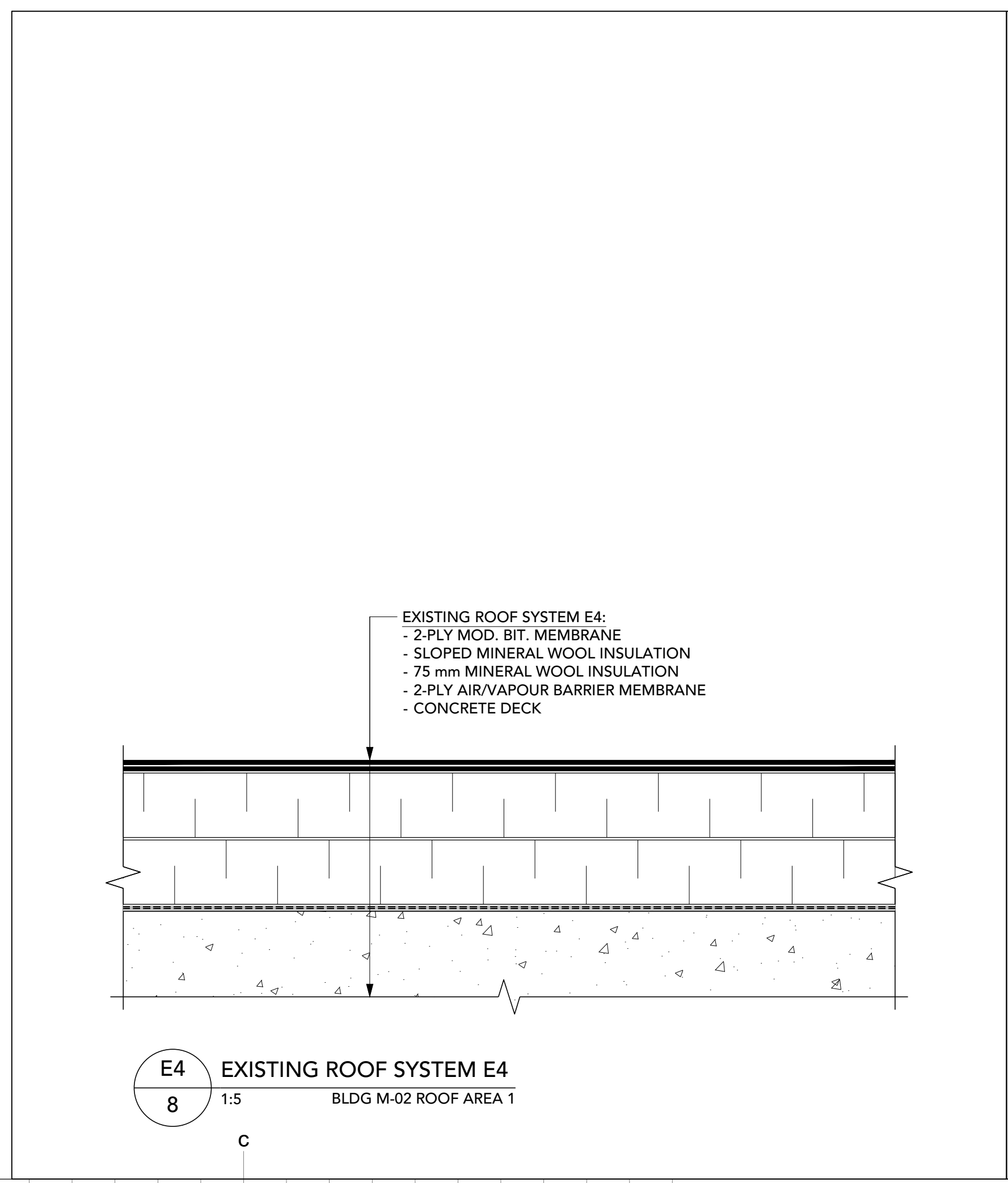

E4 EXISTING ROOF SYSTEM E4
 8 1:5 BLDG M-02 ROOF AREA 1

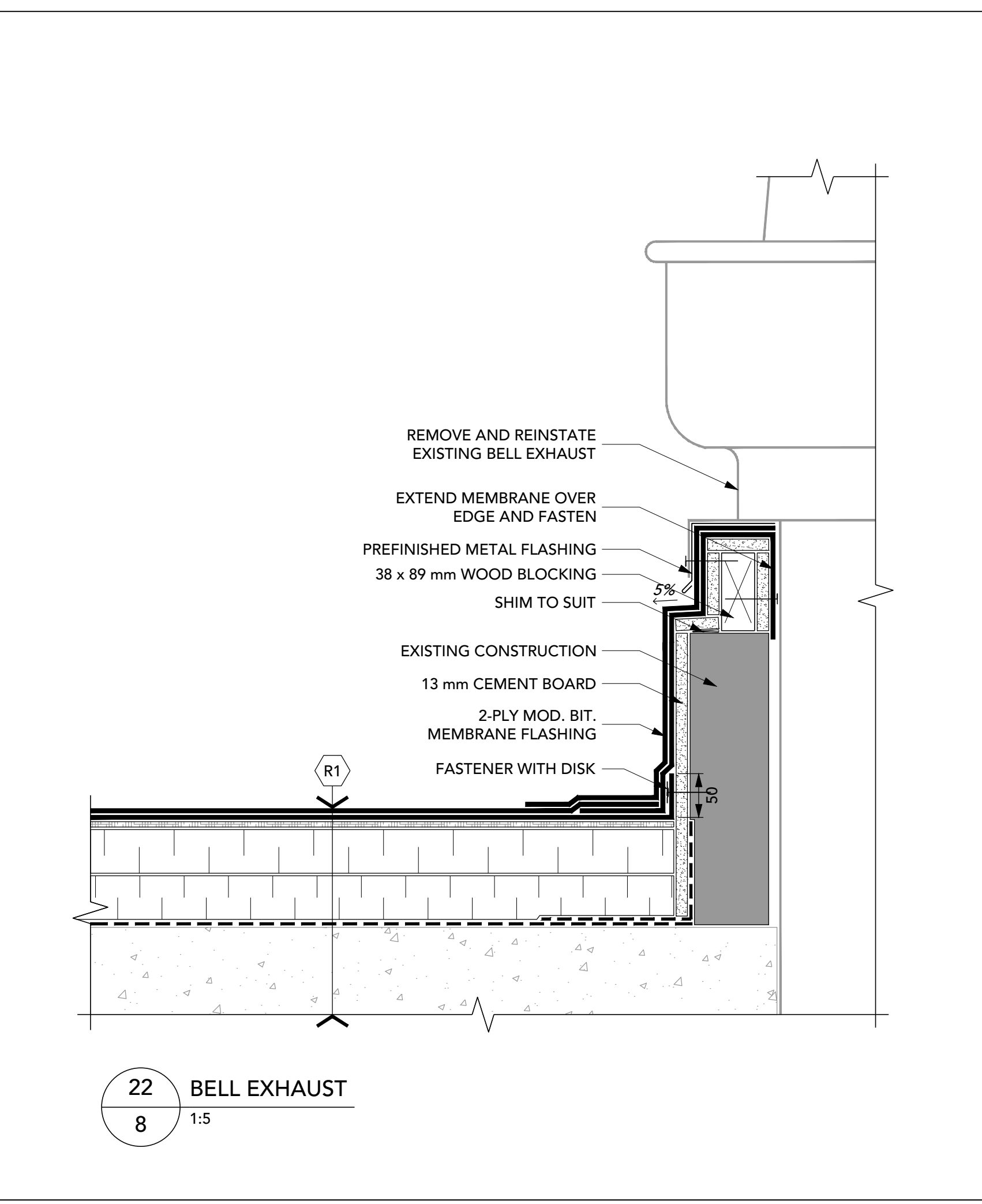

22 BELL EXHAUST
 8 1:5

o Verify all dimensions and site conditions and be responsible for same.
 o Vérifier toutes les dimensions et l'état des lieux et en assumer la responsabilité.

A	A Detail no.	A
B	No. du détail	B
C	Location drawing no. sur dessin no.	C
	C Drawing no. dessin no.	

project: **ROOF REPLACEMENT BUILDING M-02, ROOF AREAS 1, 2, 4 + 5 BUILDING M-10, ROOF AREAS 1, 2 + 5 1200 MONTREAL ROAD, OTTAWA NATIONAL RESEARCH COUNCIL**

drawing: **ROOF AREA 1, PLAN AND DETAILS BUILDING M-02**

FOR ADDENDUM 1

designed	conçu	date	2016-09-01
drawn	dessiné	scale	AS NOTED
checked	vérifié	sheet	8 of/ de 8
approved	approuvé	W.O.no.	A1-007001-03-01
dwg.no.		D.T.no.	
		dessin no.	

Mandatory Site Visit Attendance / Visite de chantier obligatoire

Project Description / Description de projet		M2 M10 Re-Roofing		Closing Date	September 15, 2016	Closing time	2:00 PM
Solicitation No./N° de sollicitation		16-22069		Project No./No de projet	M2 M10-5230	1st Showing	August 25, 2016
Departmental Representative / représentant		Kirk Williams		Signature		2nd Showing	August 29, 2016
				Alternate/Questions deadline	August 31, 2016	Addendum Deadline	September 7, 2016
						Showing Time	
						9:00AM	

COMPANY/COMPAGNIE	NAME/NOM	SIGNATURE	PHONE/TELEPHONE	FAX/TELECOPIEUR	EMAIL/COURRIEL
John Hammond Plumbing	Rossie Bergman	[Signature]	613-850-9450	613-799-9935	johnh@nrc.gov.com
Ray Cyr Roofing	Matt Ray	[Signature]	613-223-4096	613-744-2413	Sdcsrochers@CRB.ca
Coureur Rolland Boudreault	Simon Desrochers	[Signature]	819-962-6881	819-777-9144	Sdesrochers@Plym.ca
Plym Canada Lt.	Rhysander Patel	[Signature]	613-696-0086	613-749-3329	bpatel@Plym.ca
T.P. GRAUFORD LTD	STEVE COOPER	[Signature]	613-822-2312	613-822-1368	stvecooper@Ptrauford.ca
RB5	BEN RICARDO	[Signature]	613-264-1012	613-264-0882	ben.r@rb5-na.com
END OF SHOWING # /					



Mandatory Site Visit Attendance / Visite de chantier obligatoire

Project Description / Description de projet		M2 M10 Re-Roofing		Closing Date	September 15, 2016	Closing time	2:00 PM
Solicitation No./N° de sollicitation		16-22069		1st Showing	August 25, 2016	Showing Time	9:00AM
Project No./No de projet		M2 M10-5230		2nd Showing	August 29, 2016		
Departmental Representative / représentant	Signature		Alternate/Questions deadline	Addendum Deadline			
Kirk Williams	[Signature]		August 31, 2016	September 7, 2016			

COMPANY/COMPAGNIE	NAME/NOM	SIGNATURE	PHONE/TELEPHONE	FAX/TELECOPIEUR	EMAIL/COURRIEL
Norlin Insulation and Roofing	Guillemette Bilodeau	[Signature]	613-236-4059		estima@norlinroofing.com
Tricrest Roofing	Craig Hulwa	[Signature]	613 913 5998		Info@TricrestRoofing.ca
Coverite Eastern	Greg Molson	[Signature]	780-993-2039		molson@gcoverite.ca
Thym Consulting Lt.	Rhuyardes Petel	[Signature]	613-696-0086		lpetal@thym.ca
Loft Free Roofing	Darryl HANILL	[Signature]	613 505 9496		LeAK-Free@LoftFreeRoofing.com
THOMSON PERS	Martine Lecours	[Signature]	819 777 5828		esthmeturc@tmradford.ca