

CONTRACTOR TO ENSURE
THAT CONSTRUCTION EQUIPMENT
FITS THROUGH EXISTING DOOR.
NO MODIFICATIONS PERMITTED.

SALLY PORT

LIMIT OF WORK & ACCESS WITHIN
THE INSTITUTION PROPERTY. ALL
TRUCK ACCESS FOR HAULING IS
LIMITED TO HIGHWAY HALF LOAD
RESTRICTIONS

List of Drawings:

SITE PLAN

SP1 EXISTING SITE PLAN & AREA OF WORK ACCESS

ARCHITECTURAL

A100 EXISTING/DEMOLITION & NEW BASEMENTS PLANS
A101 EXISTING/DEMOLITION AND NEW GROUND FLOOR PLANS
A102 EXISTING/DEMOLITION & NEW SECOND FLOOR PLANS
A103 EXISTING/DEMOLITION & NEW THIRD FLOOR PLANS
A200 SECTIONS & DETAILS

STRUCTURAL

S000 GENERAL NOTES & DETAILS
S100 BASEMENT & GROUND FLOOR PLANS
S101 SECOND & THIRD FLOOR PLANS
S102 ROOF FRAMING PLAN
S200 SECTIONS & DETAILS
S201 SECTIONS & DETAILS
S202 SECTIONS & DETAILS

MECHANICAL

M000 MECHANICAL LEGEND AND DRAWING LIST
M100 FOUNDATION AND GROUND FLOOR PLANS - PLUMBING LAYOUT - DEMOLITION
M101 SECOND FLOOR PLAN - PLUMBING LAYOUT AND SCHEMATIC - DEMOLITION
M200 FOUNDATION AND GROUND FLOOR PLANS - FIRE PROTECTION LAYOUT - DEMOLITION AND NEW WORK
M201 FOUNDATION AND GROUND FLOOR PLANS - FIRE PROTECTION LAYOUT - DEMOLITION AND NEW WORK
M300 FOUNDATION AND GROUND FLOOR PLANS - HVAC LAYOUT - DEMOLITION
M302 SECOND AND ATTIC FLOOR PLANS - HVAC LAYOUT - DEMOLITION

ELECTRICAL

E000 ELECTRICAL SCHEDULES, LEGEND AND DRAWING LIST
E100 ELECTRICAL SINGLE LINE DIAGRAM DEMOLITION AND FIRE ALARM RISER DIAGRAM NEW WORK
E200 ELECTRICAL BASEMENT LIGHTING, POWER AND SYSTEMS DEMOLITION
E201 ELECTRICAL GROUND FLOOR LIGHTING, POWER AND SYSTEMS DEMOLITION
E202 ELECTRICAL SECOND FLOOR LIGHTING, POWER AND SYSTEMS DEMOLITION
E203 ELECTRICAL THIRD FLOOR LIGHTING, POWER AND SYSTEMS DEMOLITION
E300 ELECTRICAL LIGHTING, POWER AND SYSTEMS NEW WORK

LEGEND

--- LIMIT OF WORK

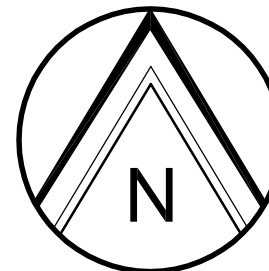

04	RE-ISSUED FOR TENDER	AUG 15/16
03	ISSUED FOR TENDER	JUL 07/16
02	ISSUED FOR 99% REVIEW	MAR 7/16
01	ISSUED FOR 50% REVIEW	FEB 1/16
revision		date

Do not scale drawings. Verify all dimensions and conditions on site and immediately notify the departmental representative of all discrepancies.

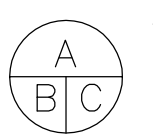

A Detail No.
No. du détail
B drawing no. - where detail required
dessin no. - où détail exigé
C drawing no. - where detailed
dessin no. - où détaillé

project title
titre du projet
KINGSTON ONTARIO
COLLINS BAY INSTITUTION
CORRECTIONAL SERVICE CANADA
1455 BATH ROAD
CBI BLD'G B1: INTERIOR DEMOLITION

drawing title
titre du dessin
EXISTING SITE PLAN
AND AREA OF WORK

drawn by
dessiné par **M.E.**

designed by
conc par **A.M./C.F.**

approved by
approuvé par **A.M.**

tender
soumission **JACK TO** project manager
administrateur de projets

project date
date du projet **2016/02/19**

project no.
no. du projet **R.051672.001**

drawing no.
dessiné no. **SP1**

1 SITE PLAN
SP1 SCALE: N.T.S.

2 PLAN: AREA OF WORK
SP1 SCALE: N.T.S.

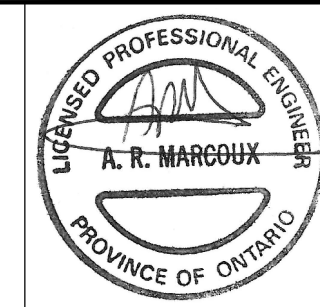

Public Works and
Government Services Canada
Architectural and Engineering Services
Ontario Region

Travaux publics et
Services gouvernementaux Canada
Services d'architecture et de génie
Région de l'Ontario

Architect/Structural Consultants:
CLELAND JARDINE
ENGINEERING LTD.
200-580 TERRY COX DR.
OTTAWA, ONT. K1H 1S3
CJE # 15-1234A

Mechanical & Electrical Consultants:
J2Jp2g Consultants Inc.
ENGINEERS • PLANNERS • PROJECT MANAGERS
12 INTERNATIONAL DRIVE, PEMBRIDGE, ON
Phone: (877) 525-0207, Fax: (877) 525-4533
1150 MORRISON DRIVE, SUITE 410, OTTAWA, ON
Phone: (877) 525-1800, Fax: (877) 525-2000

LEGEND

- EXISTING BACKFILLED AREA
- NEW BACKFILLED AREA
- SERVICE TUNNEL

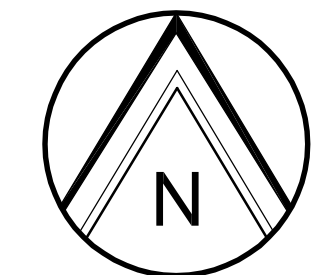

04	RE-ISSUED FOR TENDER	AUG 15/16
03	ISSUED FOR TENDER	JUL 07/16
02	ISSUED FOR 99% REVIEW	MAR 7/16
01	ISSUED FOR 50% REVIEW	FEB 1/16
revision		date

Do not scale drawings. Verify all dimensions and conditions on site and immediately notify the departmental representative of all discrepancies.

A	Detail No.
B	No. du detail
C	drawing no. - where detail required dessin no. - où détail exigé
	drawing no. - where detailed dessin no. - où détaillé

project title
titre du projet
KINGSTON ONTARIO
COLLINS BAY INSTITUTION
CORRECTIONAL SERVICE CANADA
1455 BATH ROAD
CBI BLD'G B1: INTERIOR DEMOLITION

drawing title
titre du dessin
EXISTING/DEMOLITION & NEW BASEMENT PLANS

drawn by
dessiné par
M.E.

designed by
conc par
A.M./C.F.

approved by
approuvé par
A.M.

tender
soumission
JACK TO

project date
date du projet
2016/02/19

project no.
no. du projet
R.051672.001

drawing no.
dessiné no.
A100

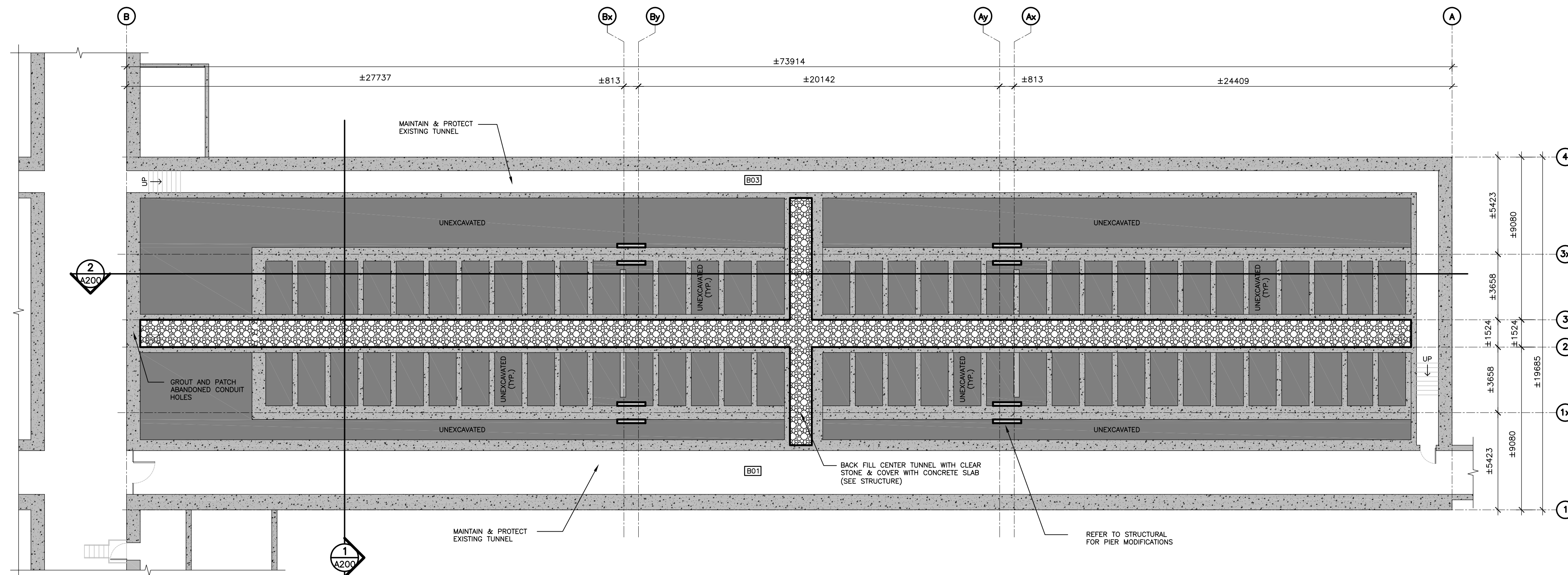

2 PLAN: BASEMENT (NEW)
SCALE: 1:150

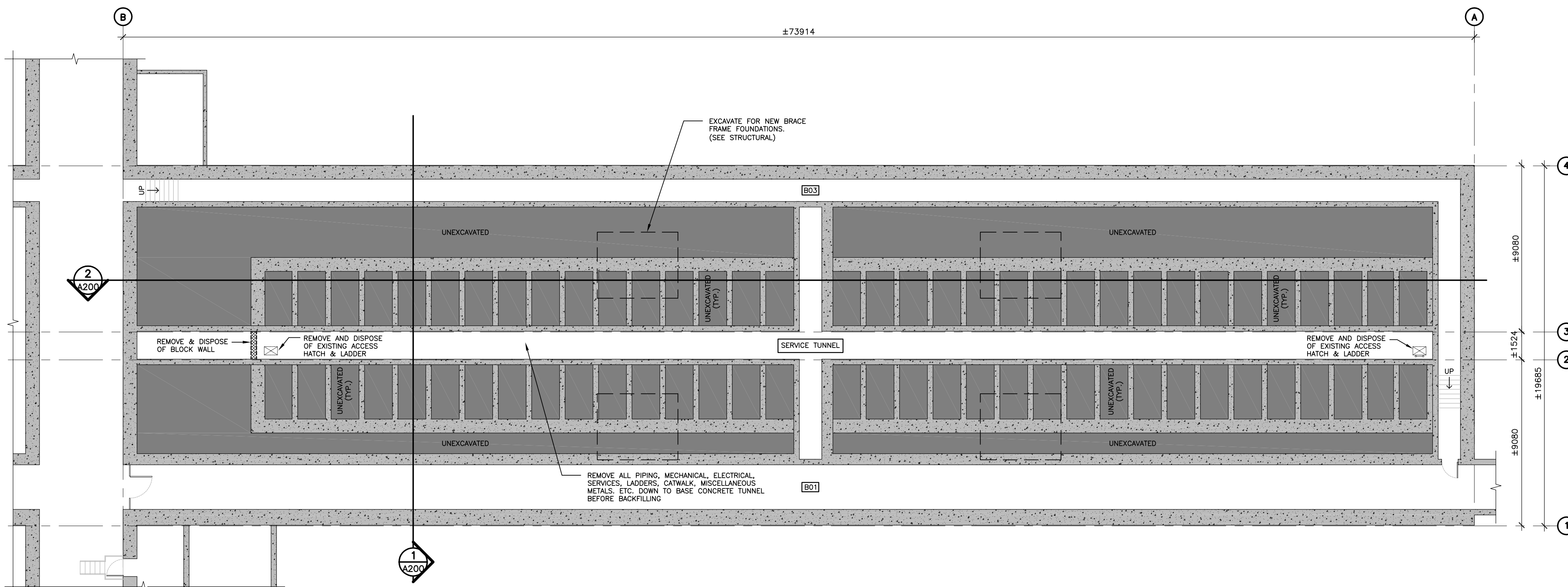

1 PLAN: BASEMENT (EXISTING)
SCALE: 1:150

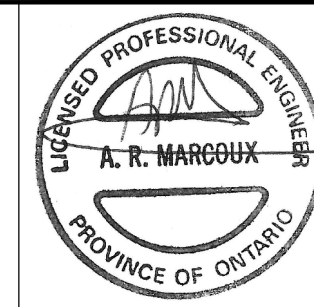

Public Works and
Government Services Canada
Architectural and Engineering Services
Ontario Region

Travaux publics et
Services gouvernementaux Canada
Services d'architecture et de génie
Région de l'Ontario

Architect/Structural Consultants:

**CLELAND
JARDINE**
ENGINEERING LTD.
200-540 TERRY COX DR.
K1M 1Y1
(416) 391-1333

CJE # 15-1234A

Mechanical & Electrical Consultants:

Jp2g Consultants Inc.
ENGINEERS • PLANNERS • PROJECT MANAGERS

12 INTERNATIONAL DRIVE, PEMBROKE, ON
Phone: (819) 255-2007 Fax: (819) 255-4633
1150 MORRISON DRIVE, SUITE 410, OTTAWA, ON
Phone: (819) 255-1500 Fax: (819) 255-2000

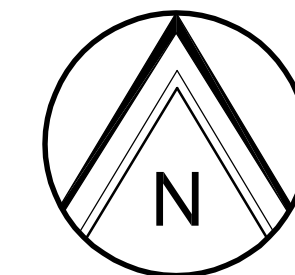
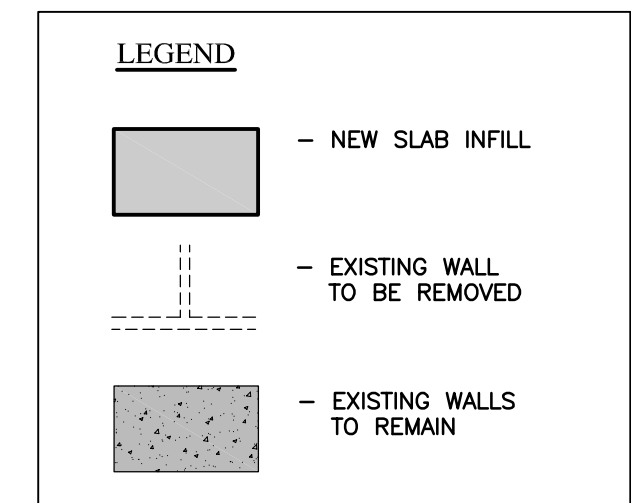

04	RE-ISSUED FOR TENDER	AUG 15/16
03	ISSUED FOR TENDER	JUL 07/16
02	ISSUED FOR 99% REVIEW	MAR 7/16
01	ISSUED FOR 50% REVIEW	FEB 1/16
revision		date

Do not scale drawings. Verify all dimensions and conditions on site and immediately notify the departmental representative of all discrepancies.

A	Detail No.
B	No. du détail
C	drawing no. - where detail required dessin no. - où détail exigé
C	drawing no. - where detailed dessin no. - où détaillé

project title
titre du projet

KINGSTON ONTARIO

**COLLINS BAY INSTITUTION
CORRECTIONAL SERVICE CANADA
1455 BATH ROAD**

CBI BLD'G B1: INTERIOR DEMOLITION

drawing title
titre du dessin

**EXISTING/DEMOLITION & NEW
GROUND FLOOR PLANS**

drawn by
dessiné par

M.E.

designed by
conc par

A.M./C.F.

approved by
approuvé par

A.M.

tender
soumission

JACK TO

project manager
administrateur de projets

project date
date du projet

2016/02/19

project no.
no. du projet

R.051672.001

drawing no.
dessiné no.

A101

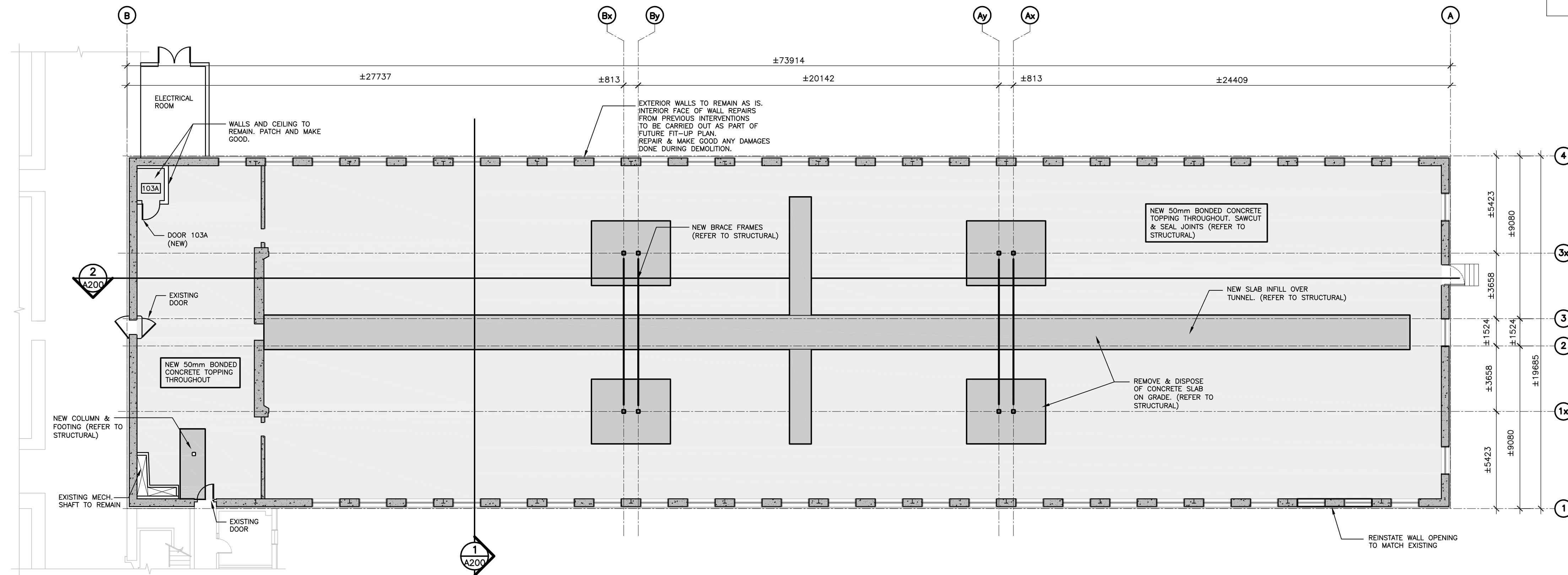

2 PLAN: GROUND FLOOR (NEW)
A101 SCALE: 1:150

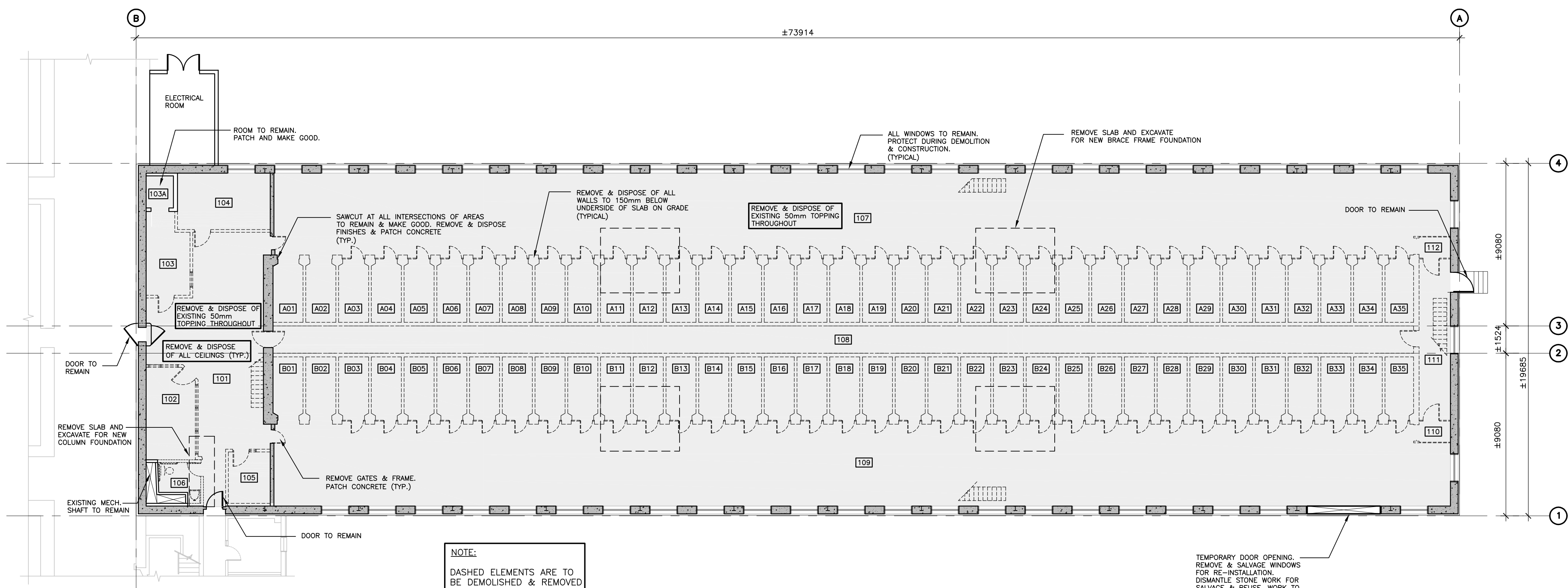

1 PLAN: GROUND FLOOR (EXISTING)
A101 SCALE: 1:150

NOTE:
DASHED ELEMENTS ARE TO
BE DEMOLISHED & REMOVED

TEMPORARY DOOR OPENING.
REMOVE & SALVAGE WINDOWS
FOR RE-INSTALLATION.
DISMANTLE STONE WORK FOR
SALVAGE & REUSE. WORK TO
BE CARRIED OUT BY HERITAGE
MASON. (REFER TO STRUCTURAL)



Public Works and
Government Services Canada
Architectural and Engineering Services
Ontario Region

Travaux publics et
Services gouvernementaux Canada
Services d'architecture et de génie
Région de l'Ontario

Architect/Structural Consultants:
CLELAND JARDINE
ENGINEERING LTD.
200-540 TERRY CO. DR.
OTTAWA, ONT. K1H 1S3
CJE # 15-1234A

Mechanical & Electrical Consultants:
Jp2g Consultants Inc.
ENGINEERS • PLANNERS • PROJECT MANAGERS
12 INTERNATIONAL DRIVE, PEMBRIDGE, ON
Phone: (877) 525-2007, Fax: (877) 525-4513
1150 MORRISON DRIVE, SUITE 410, OTTAWA, ON
Phone: (877) 525-1800, Fax: (877) 525-2000

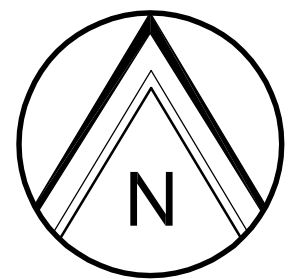
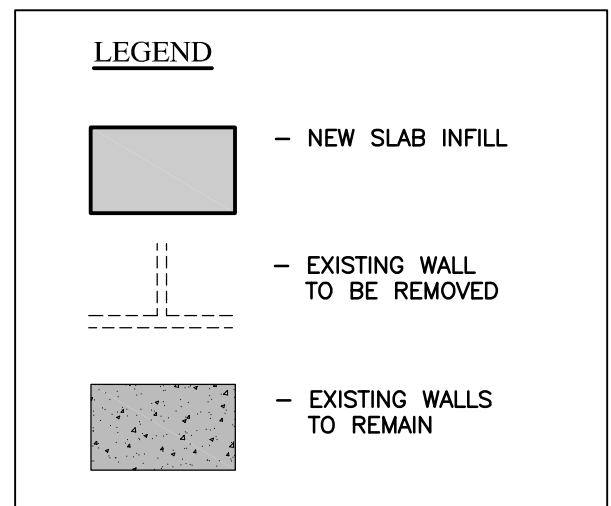

04	RE-ISSUED FOR TENDER	AUG 15/16
03	ISSUED FOR TENDER	JUL 07/16
02	ISSUED FOR 99% REVIEW	MAR 7/16
01	ISSUED FOR 50% REVIEW	FEB 1/16
revision		date

Do not scale drawings. Verify all dimensions and conditions on site and immediately notify the departmental representative of all discrepancies.

A	Detail No.
B	No. du détail
C	drawing no. - where detail required dessin no. - où détail exigé
	drawing no. - where detailed dessin no. - où détaillé

project title
titre du projet
KINGSTON ONTARIO
COLLINS BAY INSTITUTION
CORRECTIONAL SERVICE CANADA
1455 BATH ROAD
CBI BLD'G B1: INTERIOR DEMOLITION

drawing title
titre du dessin
EXISTING/DEMOLITION & NEW
SECOND FLOOR PLANS

drawn by dessiné par	M.E.
designed by conc par	A.M./C.F.
approved by approuvé par	A.M.
tender soutmission	JACK TO
project date date du projet	2016/02/19
project no. no. du projet	R.051672.001
drawing no. dessiné no.	A102

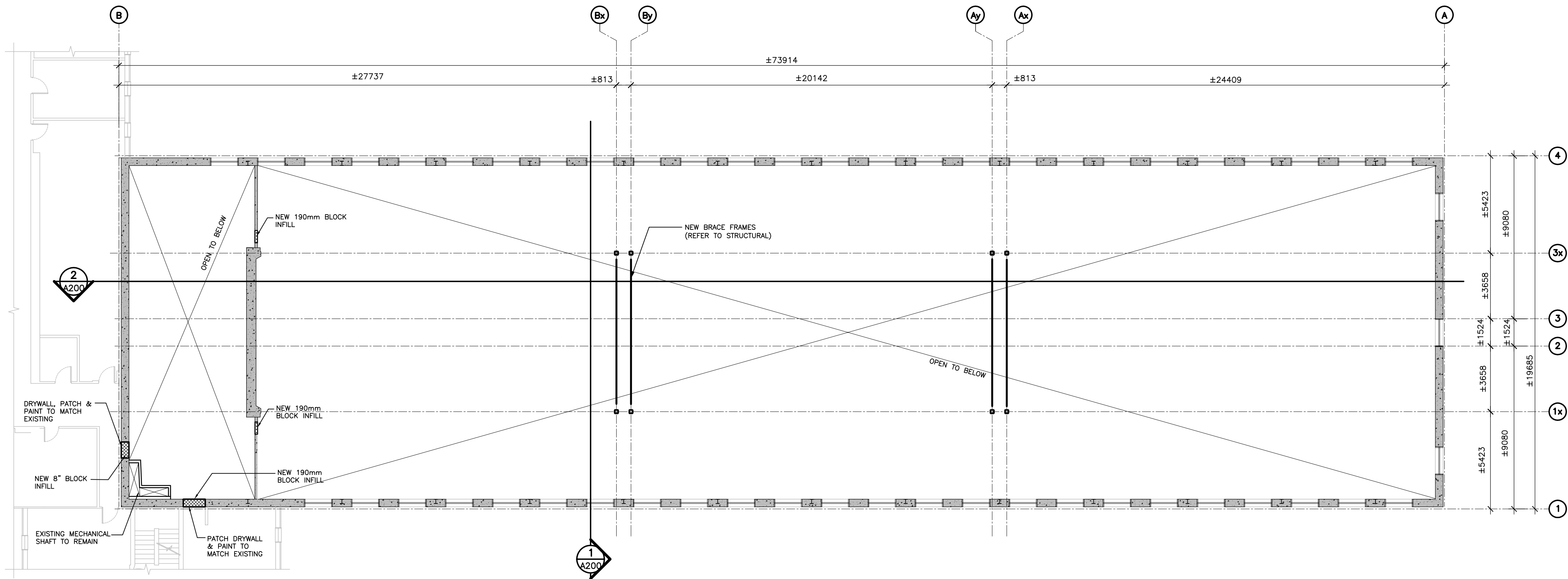

2 PLAN: SECOND FLOOR (NEW)
A102 SCALE: 1:150

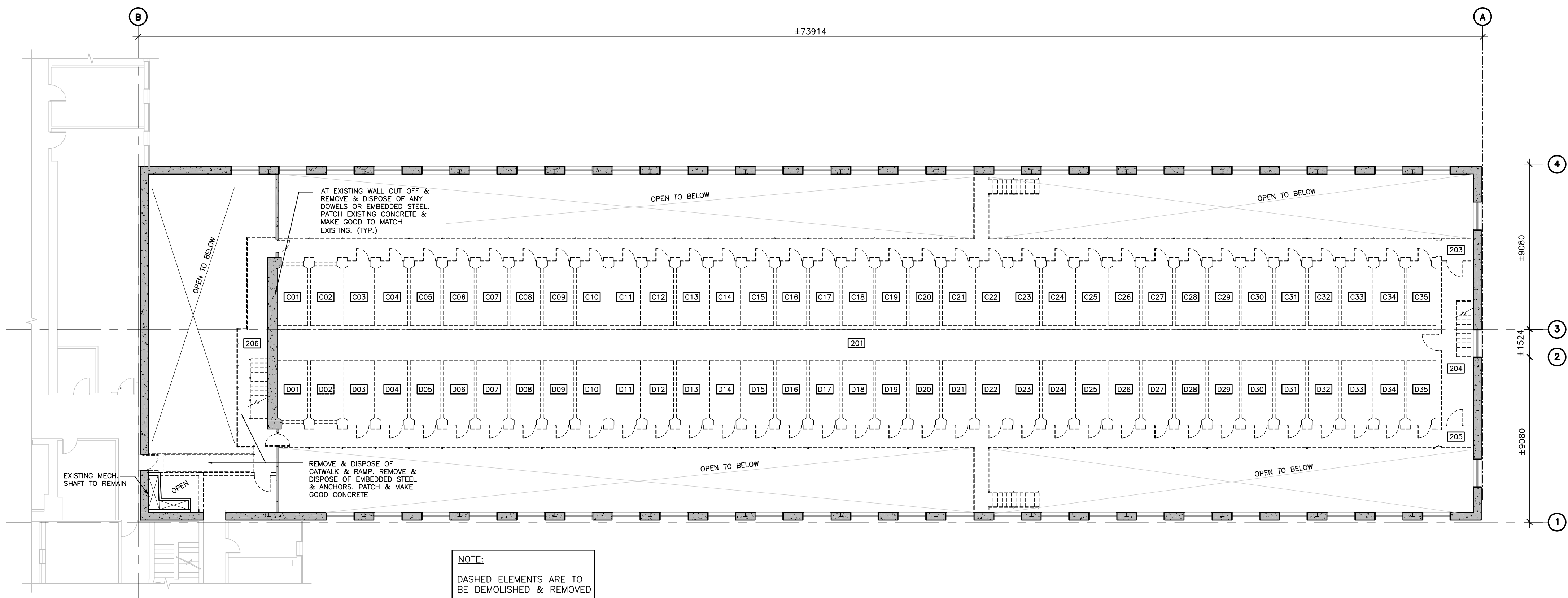

NOTE:
DASHED ELEMENTS ARE TO
BE DEMOLISHED & REMOVED

1 PLAN: SECOND FLOOR (EXISTING)
A102 SCALE: 1:150

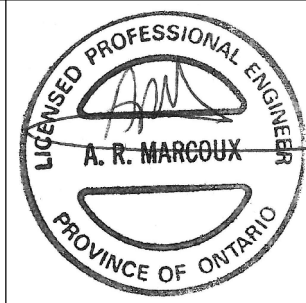

Public Works and
Government Services Canada
Architectural and Engineering Services
Ontario Region

Travaux publics et
Services gouvernementaux Canada
Services d'architecture et de génie
Région de l'Ontario

Architect/Structural Consultants:

CLELAND JARDINE
ENGINEERING LTD
200-SHERBROOKE COURT
OTTAWA, ONTARIO K1H 1S3
CJE # 15-1234A

Mechanical & Electrical Consultants:

Jp2g Consultants Inc.
ENGINEERS • PLANNERS • PROJECT MANAGERS
12 INTERNATIONAL DRIVE, PEMBROKE, ON
Phone: (819) 335-0707, Fax: (819) 335-4513
1150 MORRISON DRIVE, SUITE 410, OTTAWA, ON
Phone: (819) 825-1800, Fax: (819) 825-2000

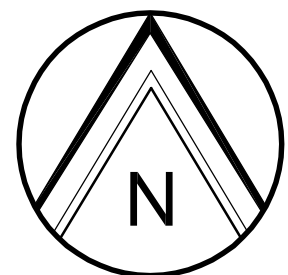
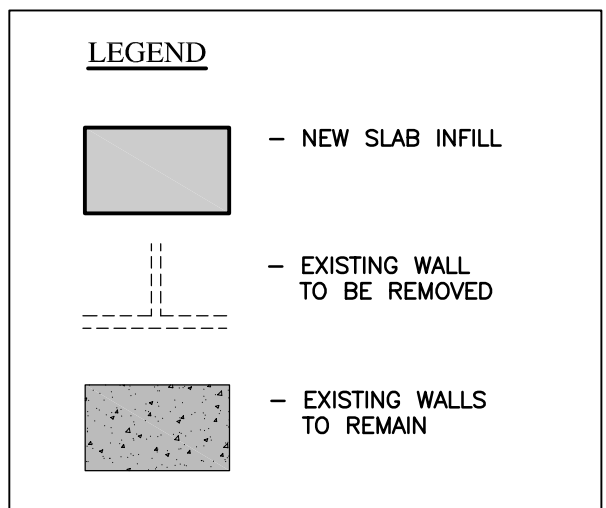

04	RE-ISSUED FOR TENDER	AUG 15/16
03	ISSUED FOR TENDER	JUL 07/16
02	ISSUED FOR 99% REVIEW	MAR 7/16
01	ISSUED FOR 50% REVIEW	FEB 1/16
revision		date

Do not scale drawings. Verify all dimensions and conditions on site and immediately notify the departmental representative of all discrepancies.

A	Detail No.
B	No. du detail
C	drawing no. - where detail required dessin no. - où détail exigé
C	drawing no. - where detailed dessin no. - où détaillé

project title
titre du projet
KINGSTON ONTARIO
COLLINS BAY INSTITUTION
CORRECTIONAL SERVICE CANADA
1455 BATH ROAD
CBI BLD'G B1: INTERIOR DEMOLITION

drawing title
titre du dessin
EXISTING/DEMOLITION & NEW
THIRD FLOOR PLANS

drawn by
dessiné par
M.E.

designed by
conc par
A.M./C.F.

approved by
approuvé par
A.M.

tender
soumission
JACK TO

project manager
administrateur de projets

project date
date du projet
2016/02/19

project no.
no. du projet
R.051672.001

drawing no.
dessiné no.
A103

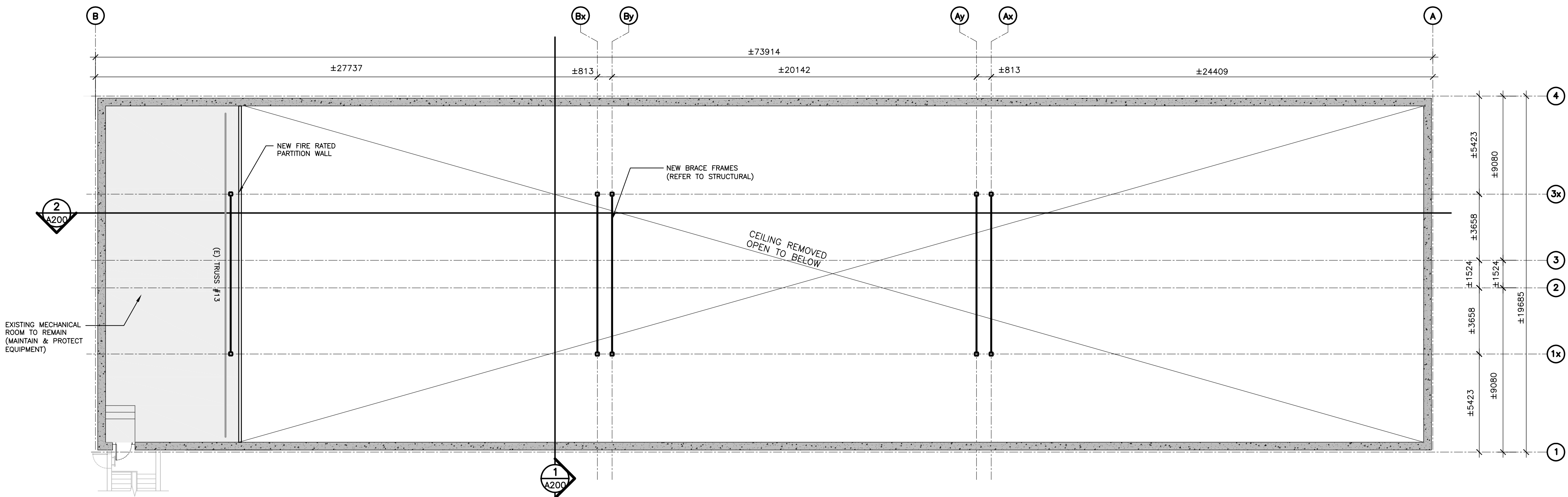

2 PLAN: THIRD FLOOR (NEW)
A103 SCALE: 1:150

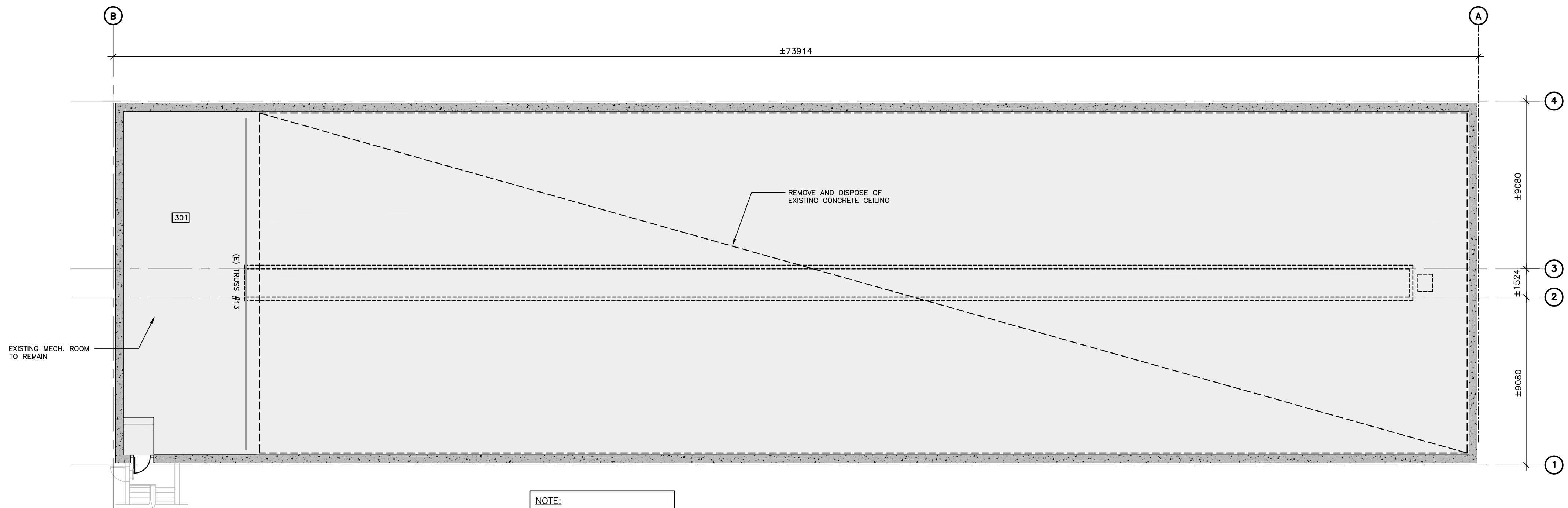

1 PLAN: THIRD FLOOR (EXISTING)
A103 SCALE: 1:150

NOTE:
DASHED ELEMENTS ARE TO
BE DEMOLISHED & REMOVED

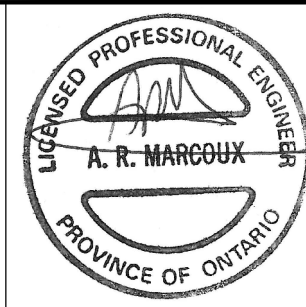

Public Works and
Government Services Canada
Architectural and Engineering Services
Ontario Region

Travaux publics et
Services gouvernementaux Canada
Services d'architecture et de génie
Région de l'Ontario

Architect/Structural Consultants:



200-580 TERRY COX DR.
K1M 1Y1
(416) 391-1133

CJE # 15-1234A

Mechanical & Electrical Consultants:



12 INTERNATIONAL DRIVE, PEMBROKE, ON
Phone: (819) 692-0007, Fax: (819) 692-4533
1150 MORRISON DRIVE, SUITE 410, OTTAWA, ON
Phone: (819) 693-1800, Fax: (819) 693-2000

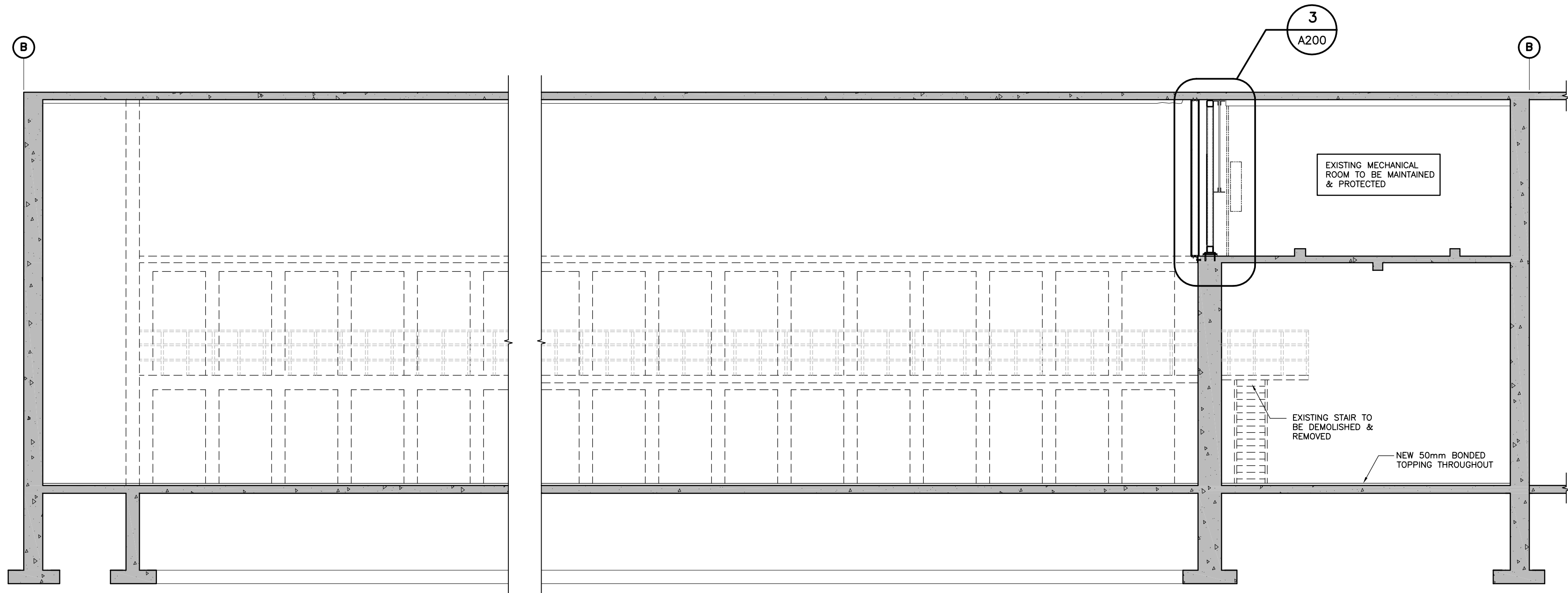

2 SECTION: CROSS SECTION
A200 SCALE: 1:75

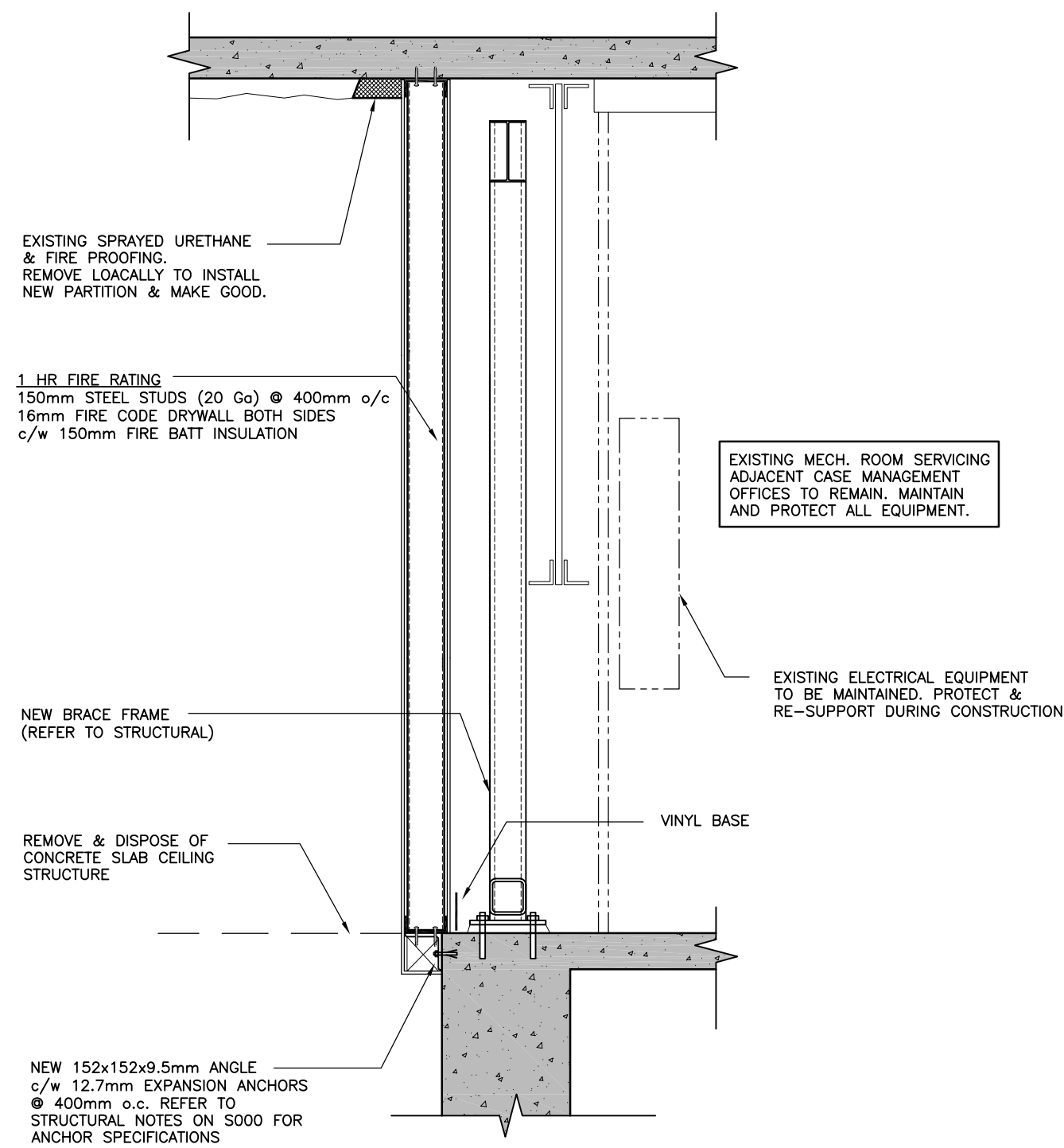

3 SECTION: CROSS SECTION
A200 SCALE: 1:25

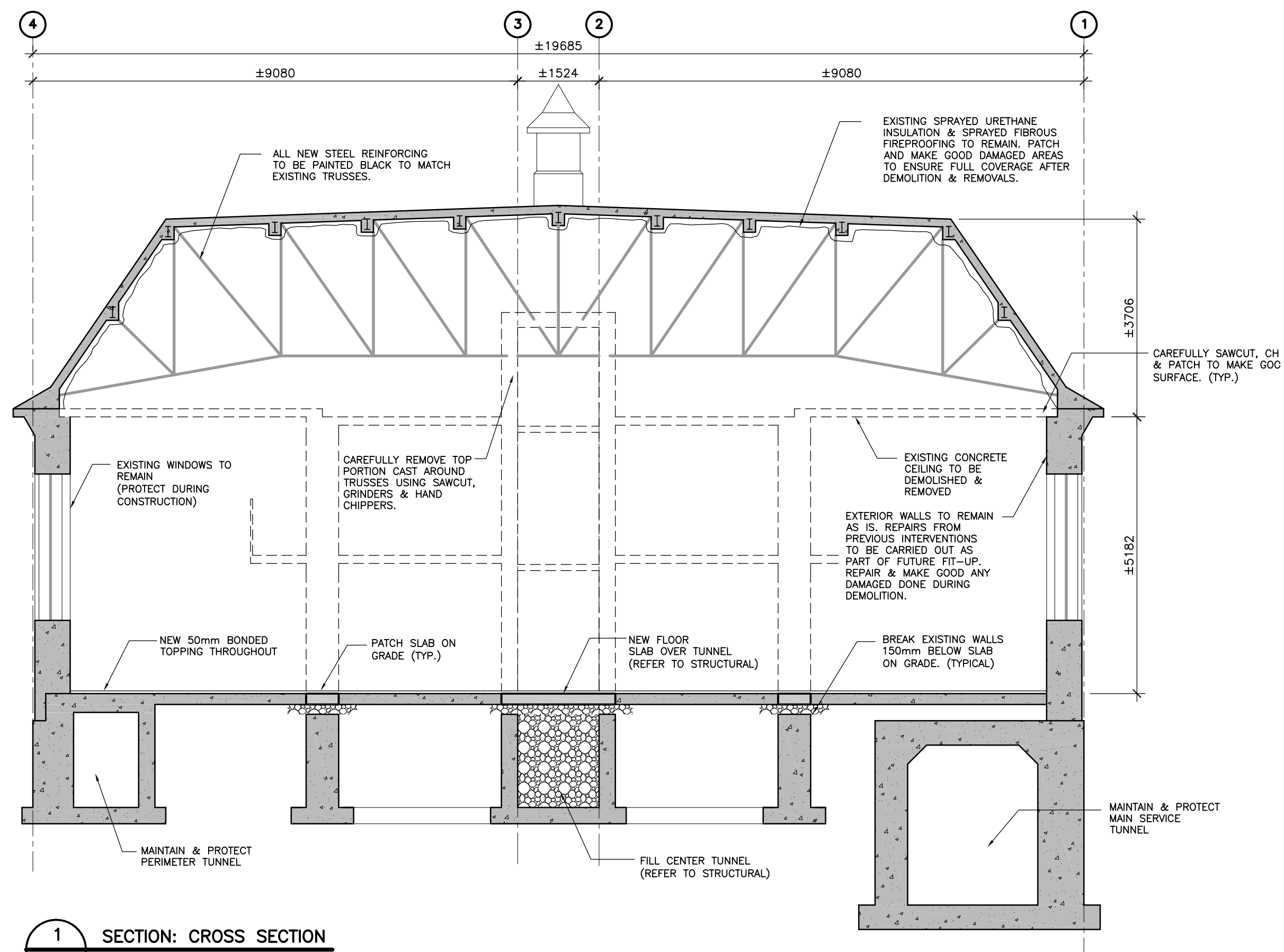

1 SECTION: CROSS SECTION
A200 SCALE: 1:75

04	RE-ISSUED FOR TENDER	AUG 15/16
03	ISSUED FOR TENDER	JUL 07/16
02	ISSUED FOR 99% REVIEW	MAR 7/16
01	ISSUED FOR 50% REVIEW	FEB 1/16
revision		date

Do not scale drawings. Verify all dimensions and conditions on site and immediately notify the departmental representative of all discrepancies.

A	Detail No.
B	No. du detail
C	drawing no. - where detail required dessin no. - où détail exigé
	drawing no. - where detailed dessin no. - où détaillé

project title
titre du projet
KINGSTON **ONTARIO**
COLLINS BAY INSTITUTION
CORRECTIONAL SERVICE CANADA
1455 BATH ROAD
CBI BLD'G B1: INTERIOR DEMOLITION

drawing title
titre du dessin

SECTIONS & DETAILS

drawn by dessiné par	M.E.	
designed by conc par	A.M./C.F.	
approved by approuvé par	A.M.	
tender soutmission	JACK TO	project manager administrateur de projets
project date date du projet	2016/02/19	
project no. no. du projet	R.051672.001	
drawing no. dessiné no.	A200	