

Parks  
Canada

Parcs  
Canada

# CAPE SPEAR VISITOR CENTRE RECAPITALIZATION ST. JOHN'S, NL - ACCESS ROAD BLACKHEAD ROAD / ROUTE 11 CAPE SPEAR, NL

PROJECT NO. 584

DRAWING LIST

CIVIL

C101	GENERAL SITE PLAN
C102	EXISTING ACCESS ROAD "A" AND "B" PLAN AND PROFILE
C103	PROPOSED ACCESS ROAD "A" AND "B" PLAN AND PROFILE
C104	ACCESS ROAD DETAILS

Canada

NOTES:

- CONTRACTOR IS ADVISED THAT PARTS OF THE ACCESS ROAD ARE ACCESSIBLE TO THE GENERAL PUBLIC (24 HOURS A DAY, 7 DAYS A WEEK ALL YEAR LONG) THROUGH EXISTING WALKING TRAILS. THESE WALKING TRAILS ARE TO REMAIN OPEN DURING THE COURSE OF THE CONSTRUCTION AND THEREFORE THE CONTRACTOR IS REQUIRED TO PROVIDE APPLICABLE SAFETY MEASURES TO PROTECT THE GENERAL PUBLIC.
- THE CONTRACTOR IS REQUIRED TO PROVIDE A PUBLIC SAFETY PROTECTION/ CONSTRUCTION STAGING PLAN FOR REVIEW BY THE DEPARTMENTAL REPRESENTATIVE. THE PLAN SHALL INCLUDE FENCING (BOTH FOR SAFETY AND SECURITY), SIGNAGE, SECURITY, WORK STAGING, REQUIRED ACCESSES ROUTING, MATERIAL STORAGE AND ALL OTHER COMPONENTS TO ENSURE PUBLIC SAFETY AND ACCESS TO AREAS SHOWN WHILE COMPLETING THE PROJECT. ALL REVEGETATED AREAS TO BE PROTECTED WITH 100% BIODEGRADABLE APPROVED EROSION CONTROL BLANKETS.
- CONTRACTOR TO PROVIDE EROSION AND SEDIMENT CONTROL PLAN FOR REVIEW BY DEPARTMENTAL REPRESENTATIVE AS WELL AS EROSION CONTROL MEASURES FOR AREAS TO BE NATURALIZED. MEASURES TO CONSIST OF BUT NOT LIMITED TO PERIMETER SILT FENCING FOR ALL DISTURBED AREAS, PROVISION OF FILTER FABRIC FOR ALL CATCH BASINS THAT ARE TO RECEIVE RUNOFF FROM THE CONSTRUCTION SITE. APPROVED EROSION CONTROL BLANKETS FOR PROTECTION OF REVEGETATED AREAS AND A 300mm THICK ROCK MATTRESS AT THE MAIN ENTRANCE AND EGRESS FOR CONSTRUCTION.
- ALL EQUIPMENT ARRIVING TO SITE MUST BE FREE FROM MUD, DEBRIS AND VEGETATION. EQUIPMENT MUST BE WASHED WITH HIGH PRESSURE WATER PRIOR TO ARRIVING TO SITE.
- THE CONTRACT ADMINISTRATOR MUST APPROVE ALL EQUIPMENT PRIOR TO ENTERING THE SITE.
- CONTRACTOR TO REINSTATE ALL DISTURBED AREAS TO ORIGINAL CONDITION OR BETTER UNLESS NOTED OTHERWISE.
- CONTRACTOR MUST MAINTAIN 3RD PARTY ACCESS TO THE AUTOMATED COAST GUARD LIGHT HOUSE AT ALL TIMES DURING THE PROJECT. CONTRACTOR MUST COMMUNICATE RESTRICTIONS TO THIS ACCESS TO THE DEPARTMENTAL REPRESENTATIVE IMMEDIATELY FOR APPROVAL. SUFFICIENT NOTICE MUST BE PROVIDED TO THE DEPARTMENTAL REPRESENTATIVE FOR APPROVAL AND NOTIFICATION TO 3RD PARTY USERS.
- CONTRACTOR TO COMPLETE UNDERGROUND LOCATES FOR EXISTING UNDERGROUND UTILITIES WITHIN THE PROJECT LIMITS BEFORE START OF ANY EXCAVATION. ALL INFORMATION SHALL BE SURVEYED AND PROVIDED TO DEPARTMENTAL REPRESENTATIVE.
- CONTRACTOR IS ADVISED THAT ANY SNOW CLEARING WITHIN THE CONSTRUCTION AND PROVIDED LAY DOWN AREAS WILL BE THE RESPONSIBILITY OF THE CONTRACTOR DURING CONSTRUCTION.
- ALL EXCAVATED BOULDERS TO REMAIN AND BE STOCKPILED ON SITE AT LOCATIONS DETERMINED BY DEPARTMENTAL REPRESENTATIVE.
- CONTRACTOR IS ADVISED THAT ALL VEGETATION AND TOPSOIL FROM DISTURBED AREAS ARE TO BE REUSED TO VEGETATE SLOPES AND SPECIFIED AREAS.



STANTEC Consulting Ltd.  
141 Kelsey Drive  
St. John's, NL  
Tel. 709.576.1458  
www.stantec.com

Copyright Reserved  
The contractor shall verify and be responsible for all dimensions. Do not scale drawings - all errors or omissions shall be reported to the Client. Reproduction or use for any purpose other than that authorized by Stantec is forbidden.

CONSULTANTS PROJECT NO. - 133347329

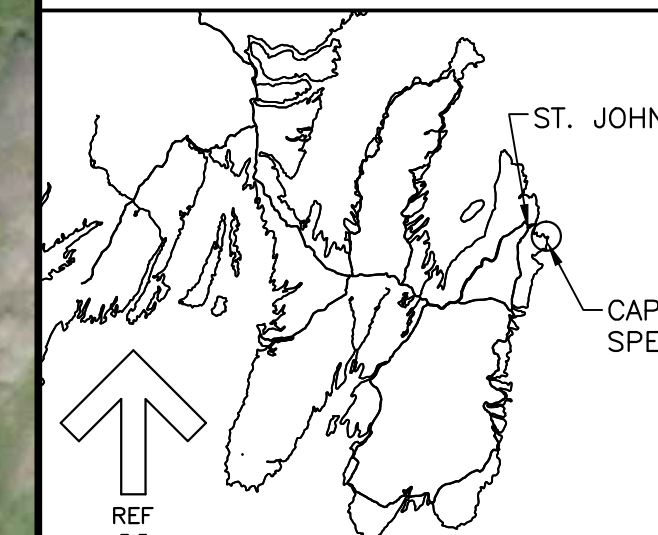

KEYPLAN: N.T.S.

- LEGEND:
- APPROXIMATE AREA OF WORK
  - PUBLIC ACCESS
  - 3RD PARTY ACCESS/PARKS CANADA ACCESS CLOSED TO PUBLIC
  - CONTRACTOR STOCKPILE/ HOARDING/ STOCKPILE/ LAYDOWN AND PARKING AREA



PROVINCE OF NEWFOUNDLAND AND LABRADOR  
ENGINEERING PERMIT J0291  
STANTEC CONSULTING LTD.  
Signature or Member Number (Member-in-Responsible Charge)

0	ISSUED FOR TENDER	09/16/2016
revisions		date

CAPE SPEAR NHS LIGHTHOUSE ACCESS ROAD RECAPITALIZATION

GENERAL SITE PLAN

designed	CB	conçu
date	2016.08.29	
drawn	SA	dessiné
date	2016.08.29	
approved		approuvé
date		
Tender		Soumission

PWSC Project Manager	Administrateur de projets TPSGC
project number	584
no. du projet	
drawing no.	C101
no. du dessin	

GENERAL SITE PLAN

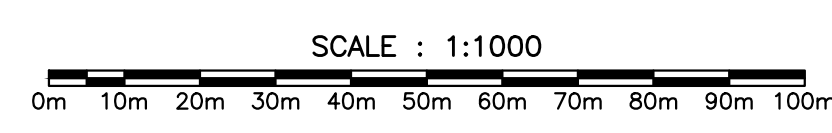

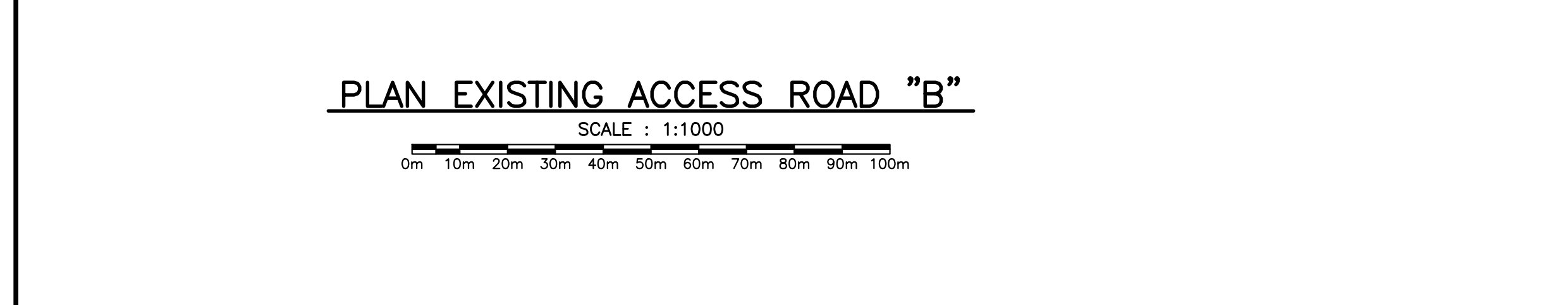
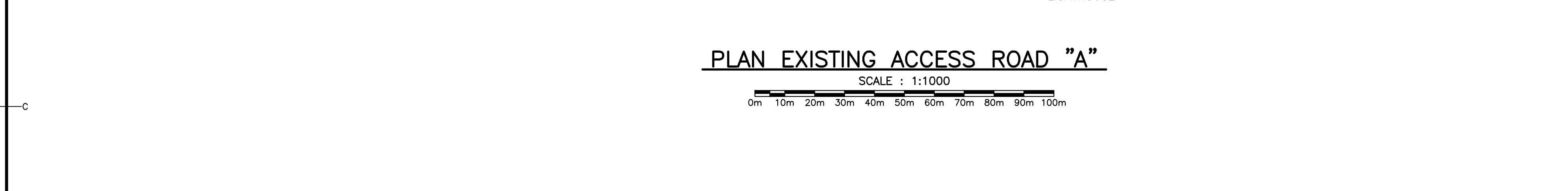
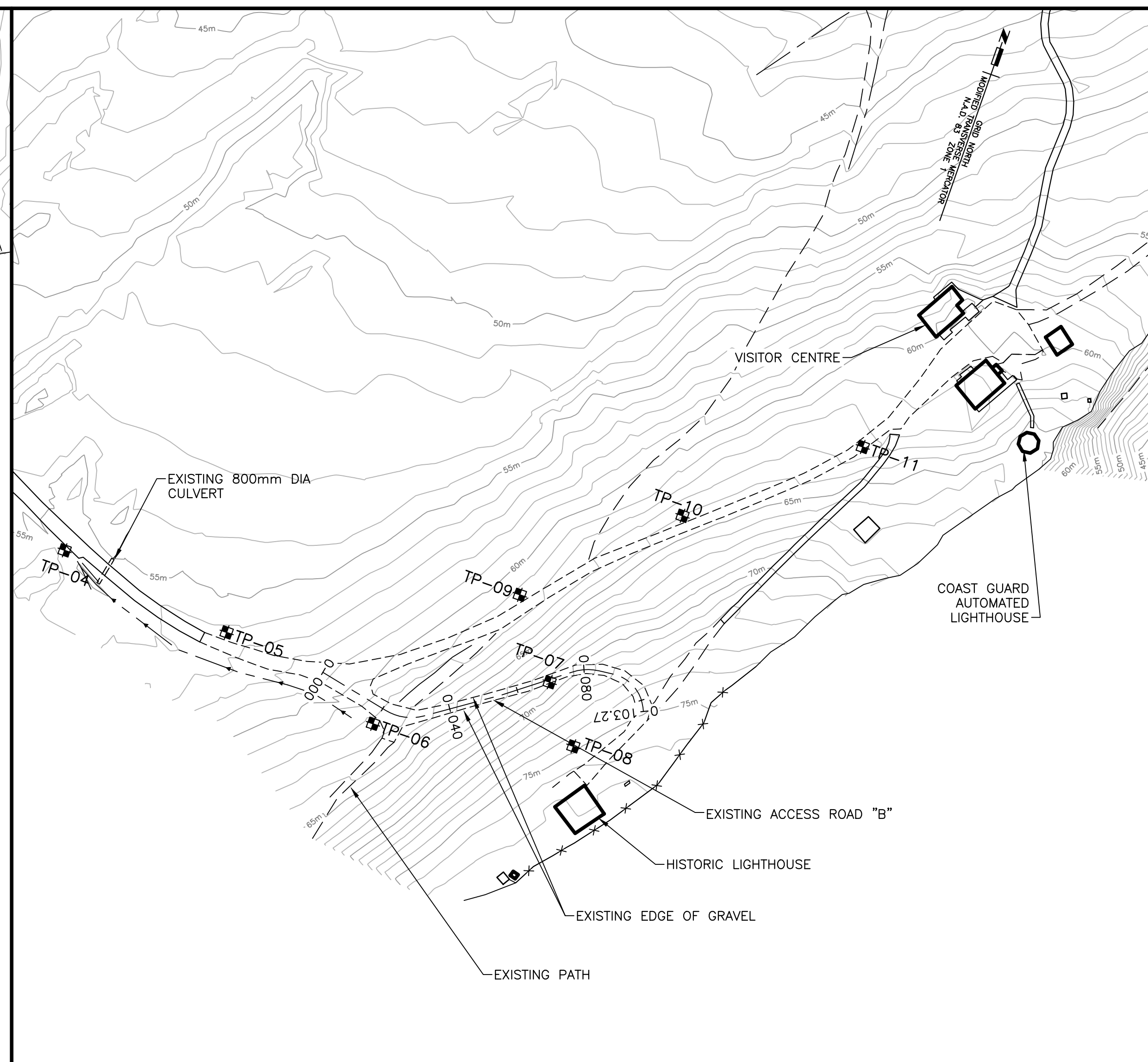
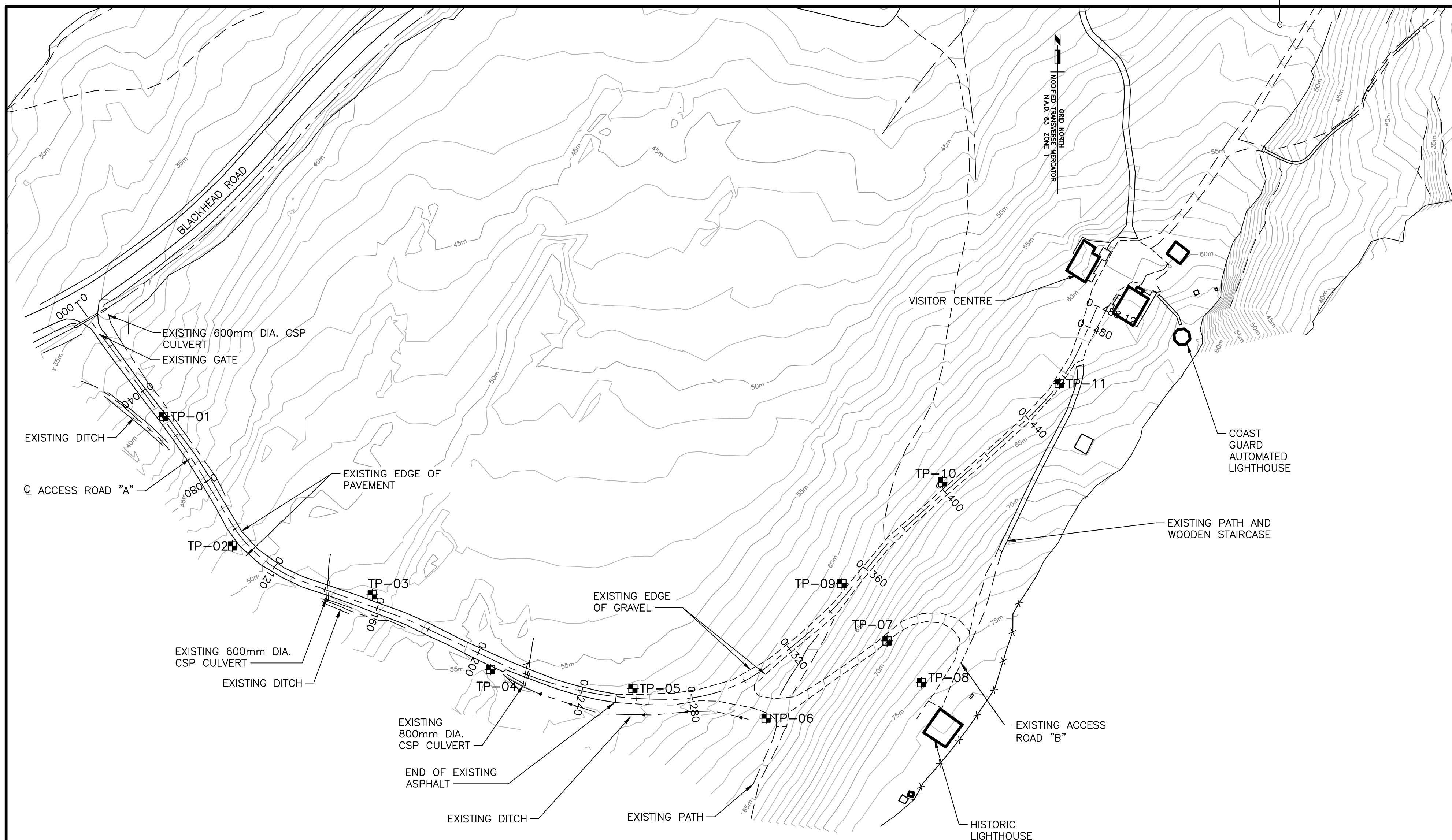

Parcs Canada  
Stantec  
STANTEC Consulting Ltd.  
141 Kelsey Drive  
St. John's, NL  
Tel. 709.576.1458  
www.stantec.com

Copyright Reserved  
The contractor shall verify and be responsible for all dimensions. On site conditions may vary - any errors or omissions shall be reported to the Client. The Contractor shall be responsible for all design and drawings are the property of Stantec. Reproduction or use for any purpose other than that authorized by Stantec is forbidden.

KEYPLAN: N.T.S.

LEGEND:

- EDGE OF GRAVEL ROAD
- EDGE OF PAVED ROAD
- PATHWAY
- ROAD
- EXISTING MAJOR CONTOURS
- EXISTING MINOR CONTOURS
- EXISTING DITCH
- TEST PIT LOCATIONS
- EXISTING CULVERT

PROFESSIONAL ENGINEER  
CHRISTOPHER W. BOONE  
16.06.16  
NEWFOUNDLAND & LABRADOR

PROVINCE OF NEWFOUNDLAND AND LABRADOR  
Engineering  
PERMIT J0291  
STANTEC CONSULTING LTD.  
Signature or Member Number  
(Member-in-Responsible Charge)

0	ISSUED FOR TENDER	09/16 2016
revisions		date
project		project
<b>CAPE SPEAR NHS LIGHTHOUSE ACCESS ROAD RECAPITALIZATION</b>		
drawing		design
<b>EXISTING ACCESS ROAD "A" &amp; "B" PLAN &amp; PROFILE</b>		
designed	CB	conçu
date	2016.05.03	
drawn	CS	dessiné
date	2016.07.25	
approved	CB	approuvé
date	2016.08.04	
Tender		Soumission
PLAN		
PWSC Project Manager	Administrateur de projets TPSC	
project number		no. du projet
		<b>584</b>
drawing no.		no. du dessin
		<b>C102</b>

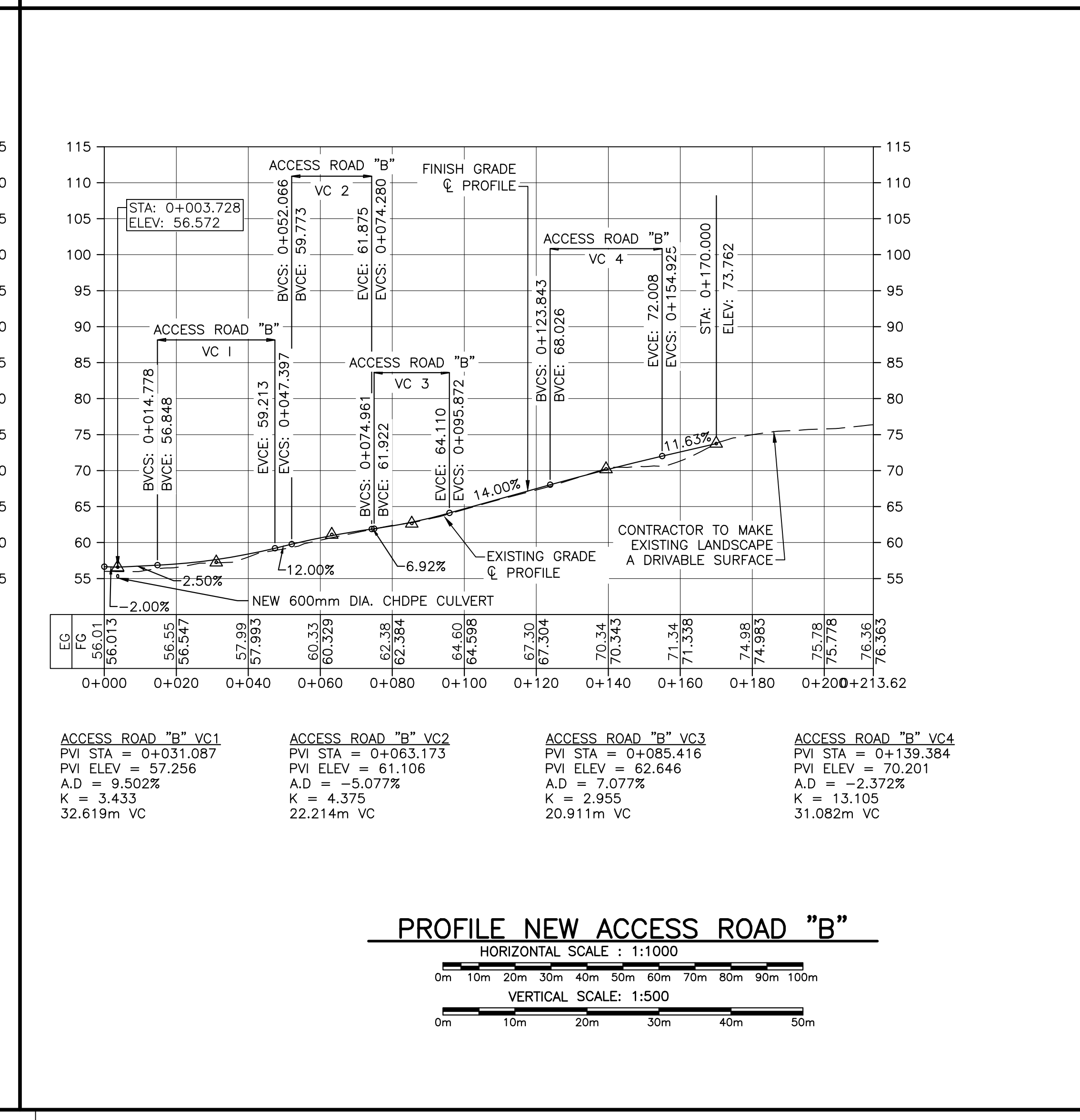
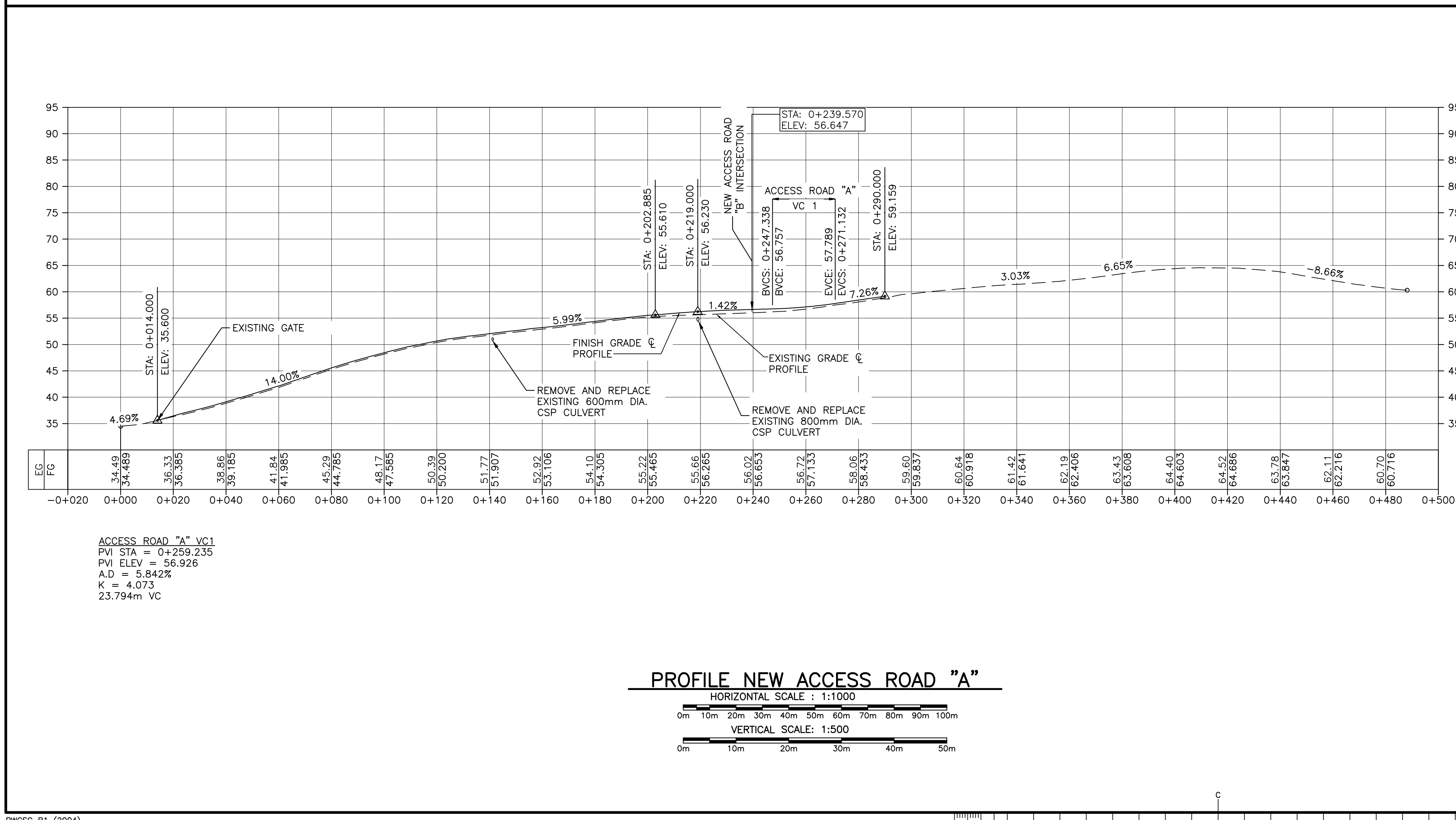
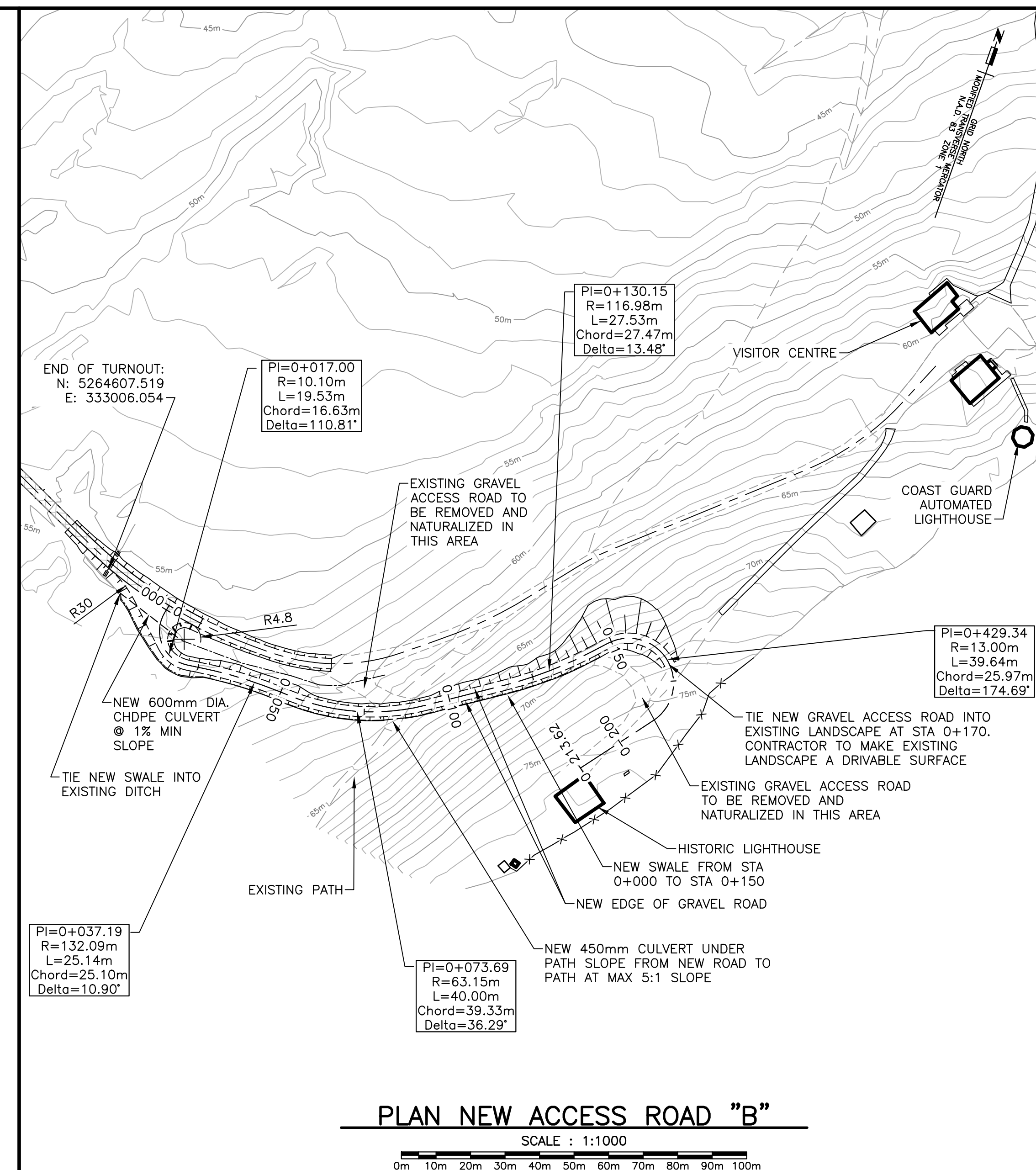
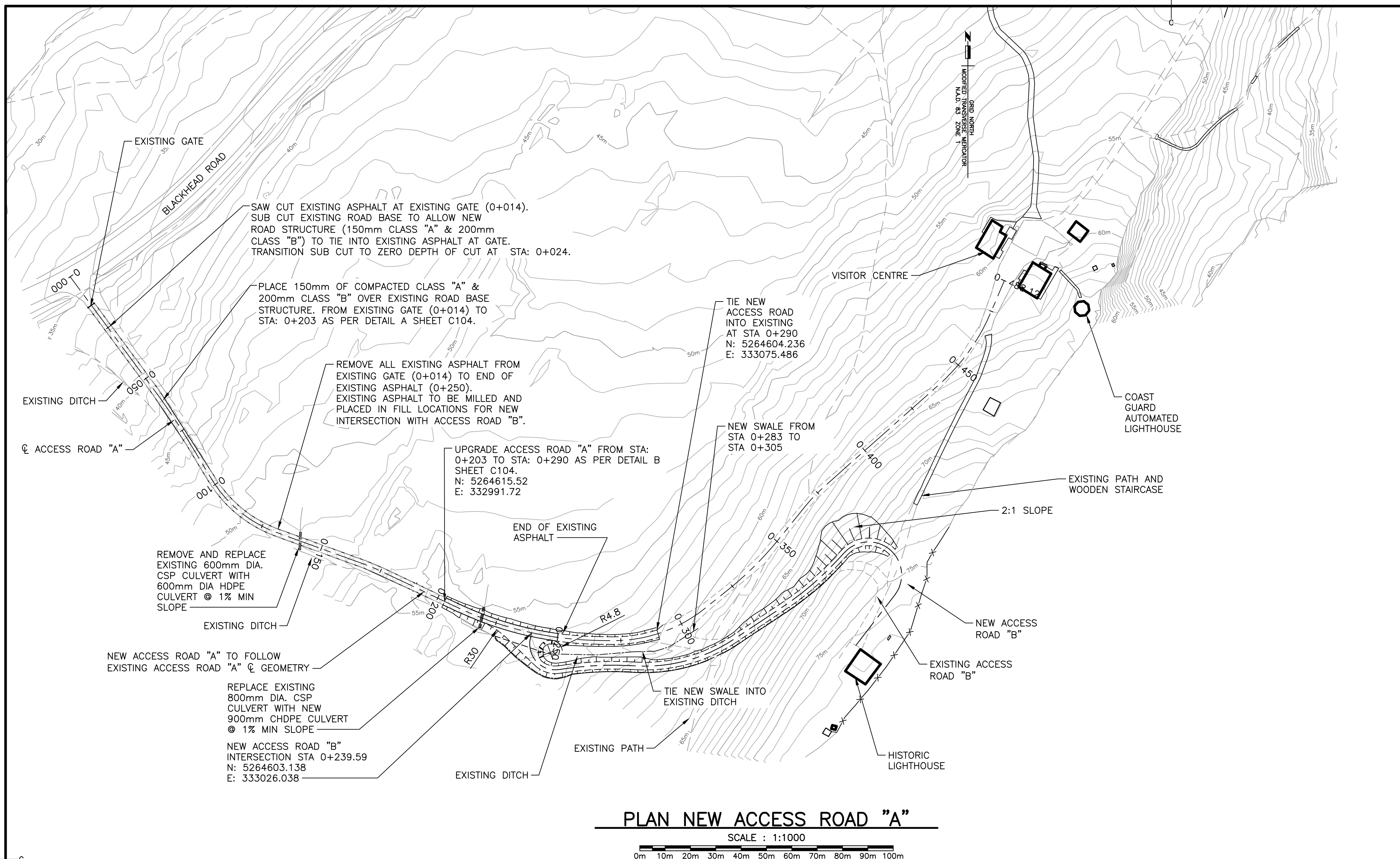

Parcs Canada  
Stantec  
STANTEC Consulting Ltd.  
141 Kelsey Drive  
St. John's, NL  
Tel: 709.576.1458  
www.stantec.com  
Copyright Reserved  
The contractor shall verify and be responsible for all dimensions, quantities and quality - any errors or omissions shall be reported to the Client. The Client shall be responsible for the accuracy of the information provided. The Contractor shall be responsible for the accuracy of the information provided. The Contractor shall be responsible for the accuracy of the information provided.

CONSULTANTS PROJECT NO. - 13347329

KEYPLAN: N.T.S.  
LEGEND:  
----- EDGE OF GRAVEL ROAD  
----- EDGE OF PAVED ROAD  
----- PATHWAY  
----- ROAD  
----- 50m EXISTING MAJOR CONTOURS  
----- EXISTING MINOR CONTOURS  
----- NEW SWALE  
----- EX. ASPHALT REMOVAL  
----- NEW CULVERT  
----- SLOPE

PROFESSIONAL ENGINEER  
NEWFOUNDLAND & LABRADOR  
16.06.16  
CHRISTOPHER W. BOONE  
PROVINCE OF NEWFOUNDLAND AND LABRADOR  
ENGINEERING PERMIT J0291  
STANTEC CONSULTING LTD.  
Signature or Member Number (Member-in-Responsible Charge)

0	ISSUED FOR TENDER	09/16 2016
revisions		date
project		project

**CAPE SPEAR NHS LIGHTHOUSE ACCESS ROAD RECAPITALIZATION**

designed	CB	conqu
date	2016.05.03	
drawn	CS	dessin
date	2016.07.25	
approved	CB	approuvé
date	2016.08.04	
Tender		Soumission
PLAN		
PWSC Project Manager	Administrateur de projets TPSC	
project number		no. du projet
		<b>584</b>
drawing no.		no. du dessin
		<b>C103</b>

KEYPLAN:  
LEGEND:

**SECTION A NOTES:**

1. REMOVE EXISTING ASPHALT FROM EXISTING GATE (0+014) TO END OF EXISTING ASPHALT (0+250). EXISTING ASPHALT TO BE MILLED AND PLACED IN FILL LOCATIONS AT NEW INTERSECTION WITH ACCESS ROAD 'B'.
2. SCARIFY EXISTING GRAVEL BASE UNDER EXISTING ASPHALT AS REQUIRED. PROOF ROLL EXISTING GRAVEL BASE. EXCAVATE AND REPLACE SOFT AREAS WITH 100mm MINUS ROCK FILL. THEN PLACE 150mm OF COMPACTION CLASS 'A' GRAVEL MATERIAL OVER 200mm OF COMPACTION CLASS 'B' GRAVEL MATERIAL.

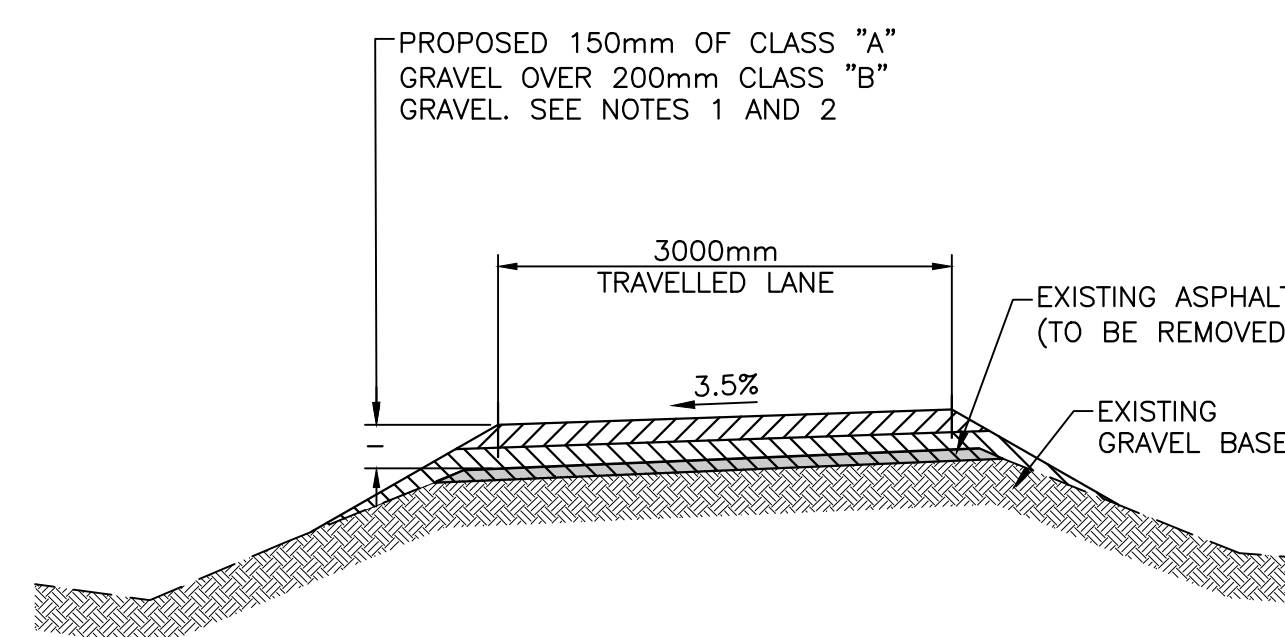

**TYPICAL ACCESS ROAD 'A' SECTION** (A) C102  
- STATION 0+014 TO STATION 0+203

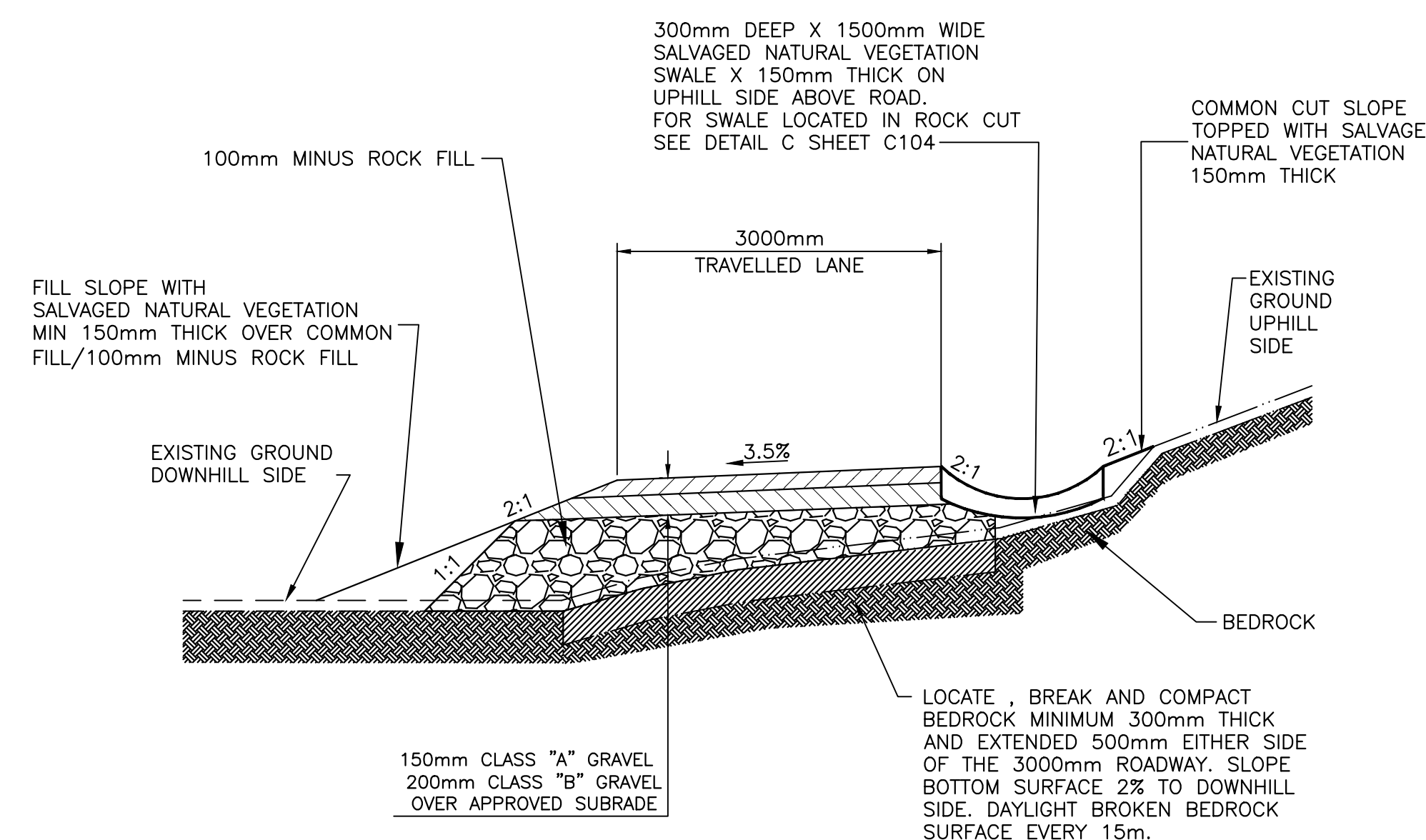
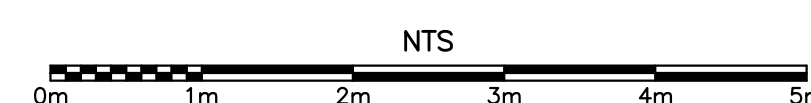

**TYPICAL ACCESS ROAD 'A' SECTION** (B) C102  
- STATION 0+203 TO STATION 0+290

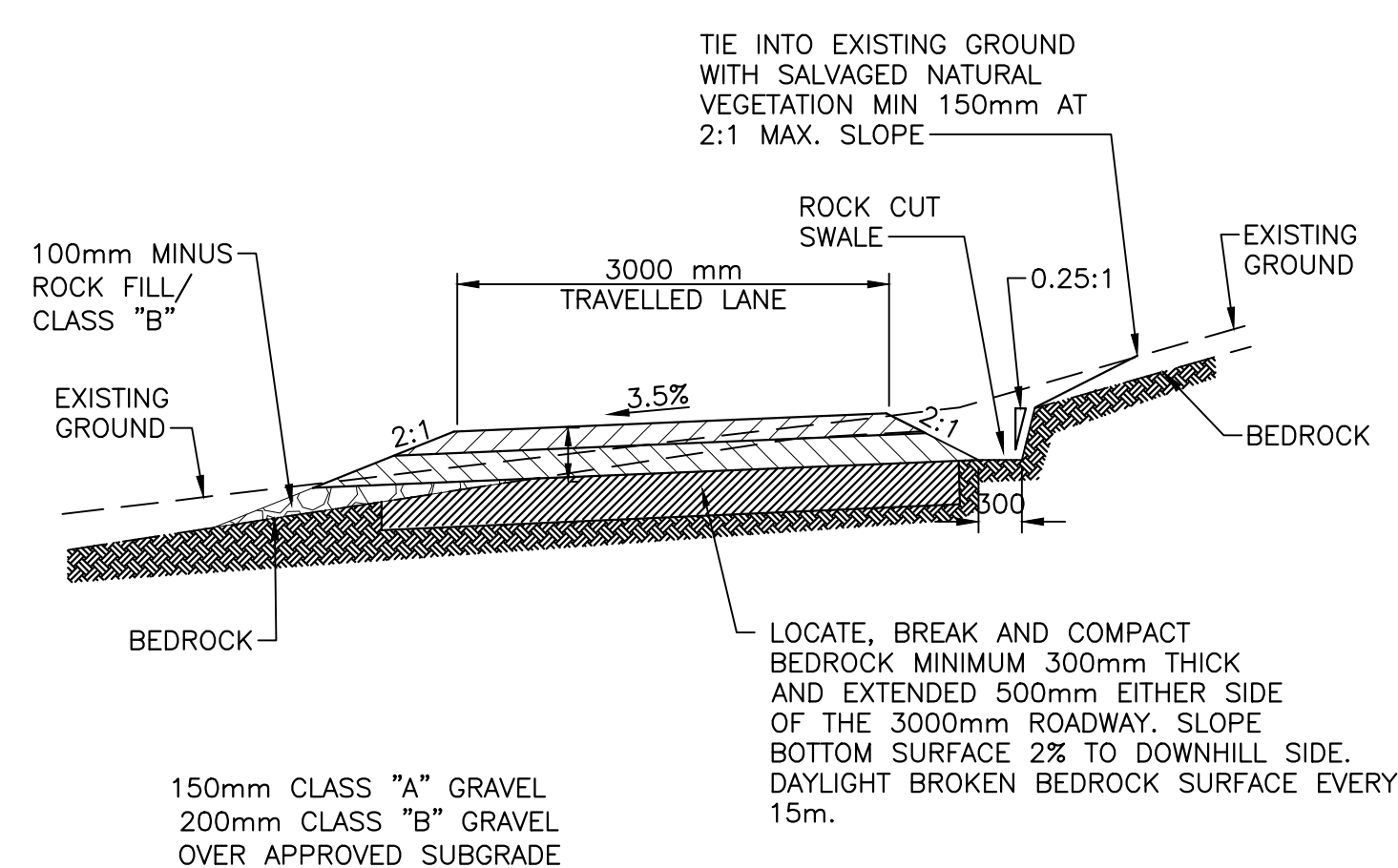
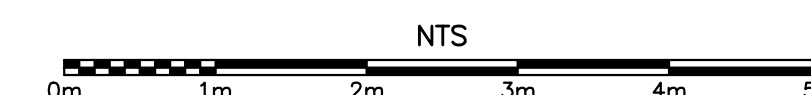

**TYPICAL ACCESS ROAD 'B' SECTION** (C) C102  
- STATION 0+000 TO STATION 0+150

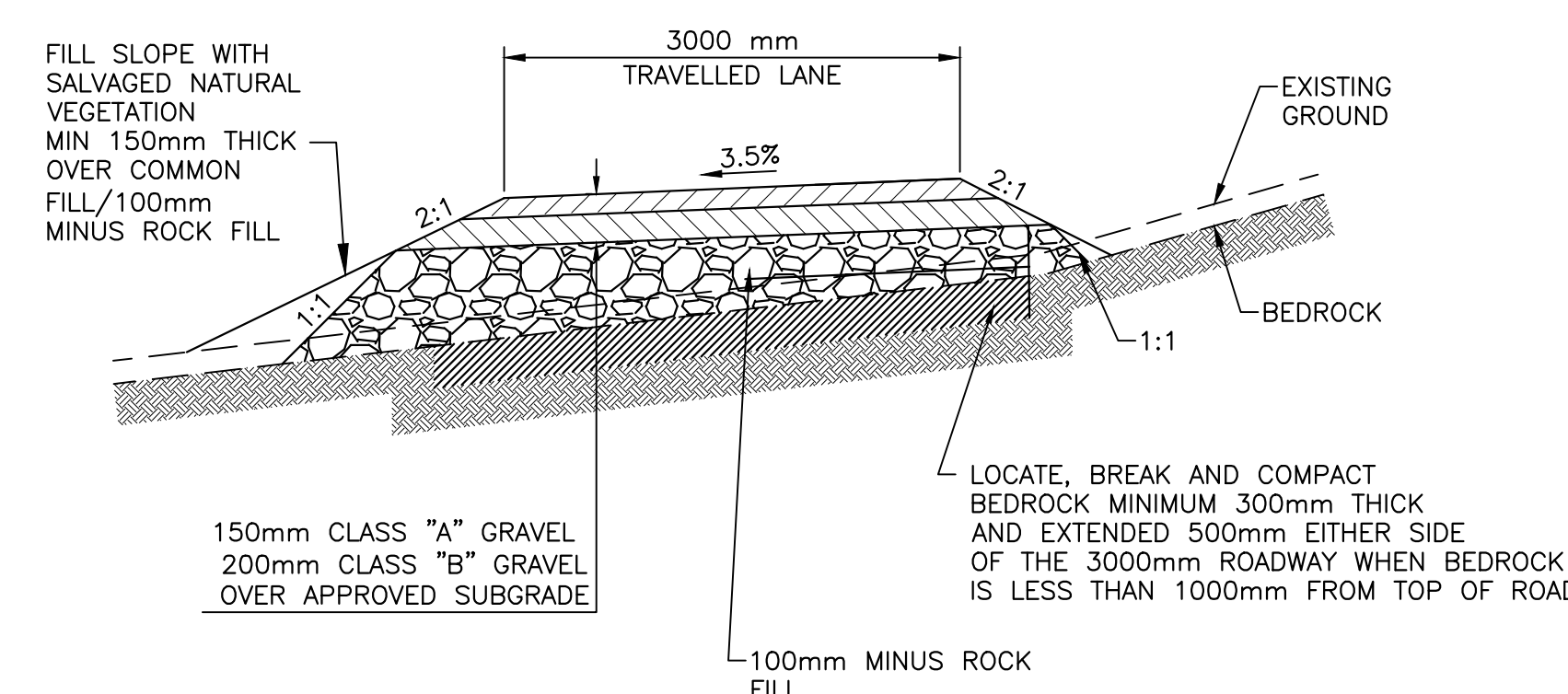
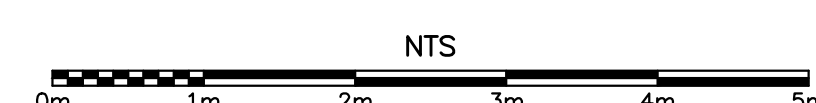

**TYPICAL ACCESS ROAD 'B' SECTION** (D) C102  
- STATION 0+150 TO STATION 0+170

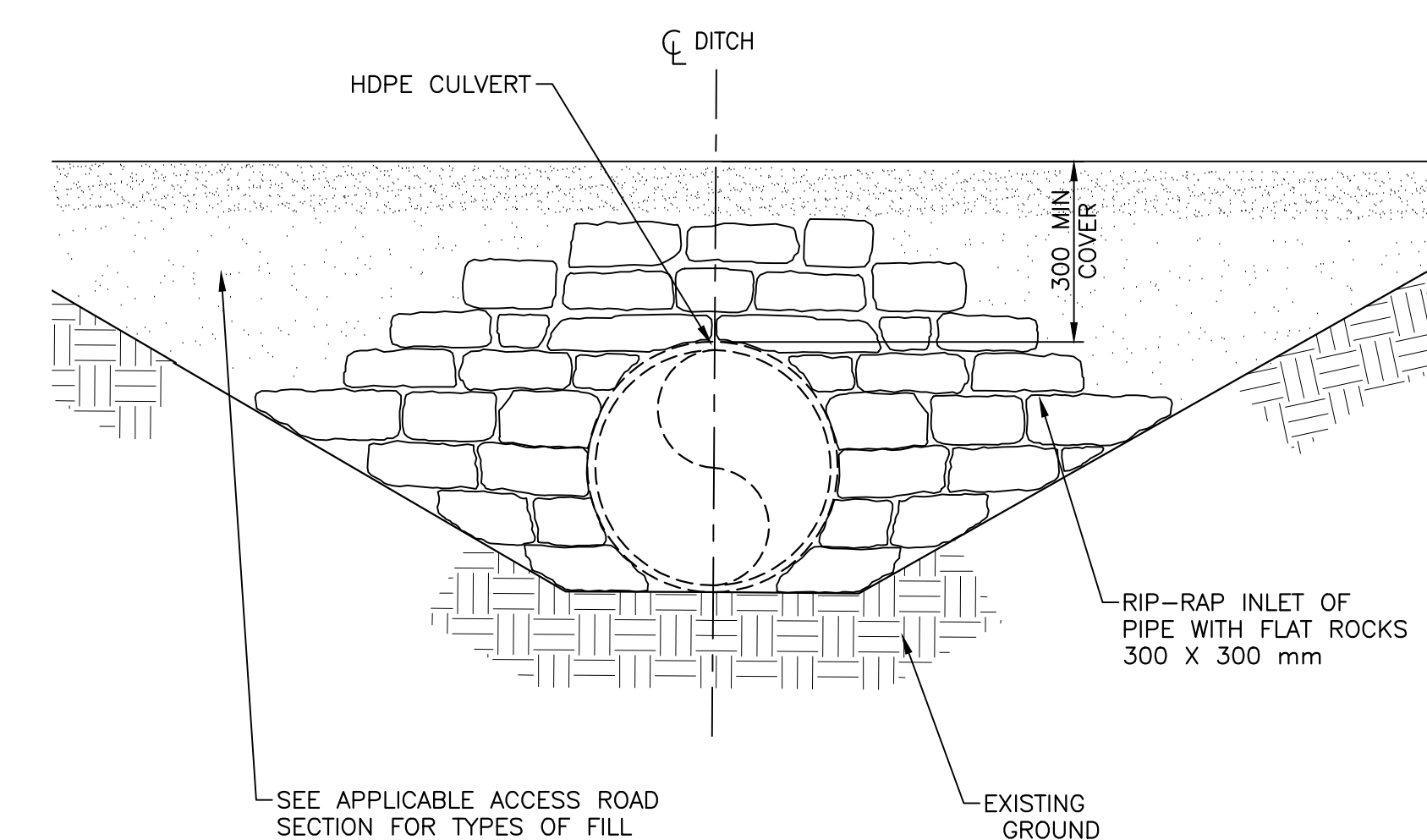
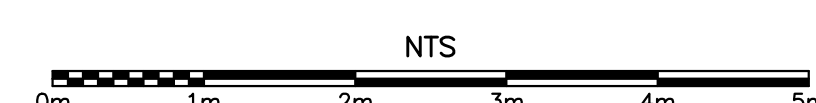

**TYPICAL RIP-RAP DETAIL** (E) C102

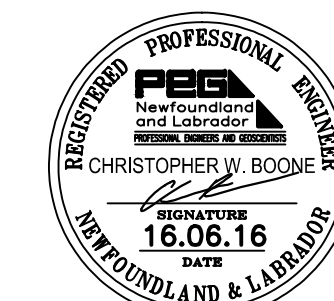
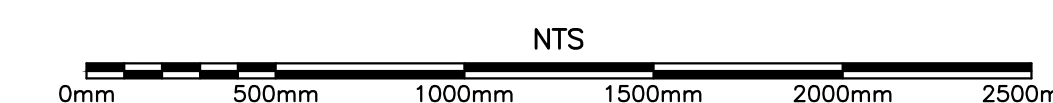

PROVINCE OF NEWFOUNDLAND AND LABRADOR  
ENGINEERING PERMIT J0291  
STANTEC CONSULTING LTD.  
Signature or Member Number (Member-in-Responsible Charge)

0	ISSUED TENDER	09/16 2016
revisions		date
project		project

**CAPE SPEAR NHS LIGHTHOUSE ACCESS ROAD RECAPITALIZATION**

drawing design

**ACCESS ROAD DETAILS**

designed	CB	conçu
date	2016.08.01	
drawn	AB	dessiné
date	2016.08.02	
approved	CB	approuvé
date	2016.08.04	
Tender		Submission

PWSC Project Manager Administrateur de projets TPSC  
project number no. du projet

**584**

drawing no. no. du dessin

**C104**