

ALTERATION ISSUE NO. ENCLOSED THIS O LATEST ISSUE CANCELS ALL PREVIOUS ISSUES							
ISSUE	DATE	D.A. NO.	INITIALS	ISSUE	DATE	D.A. NO.	INITIALS
2	29.7.70	01C	01C	5	22.1.71	01C	01C
3	12.10.70	01C	01C	6	1.3.71	01C	01C
4	27.11.70	01C	01C				

ARROWS & NOTATION IN CIRCLES  
REPRESENT THRUST FROM  
VOITH SCHNEIDER PROPELLERS.

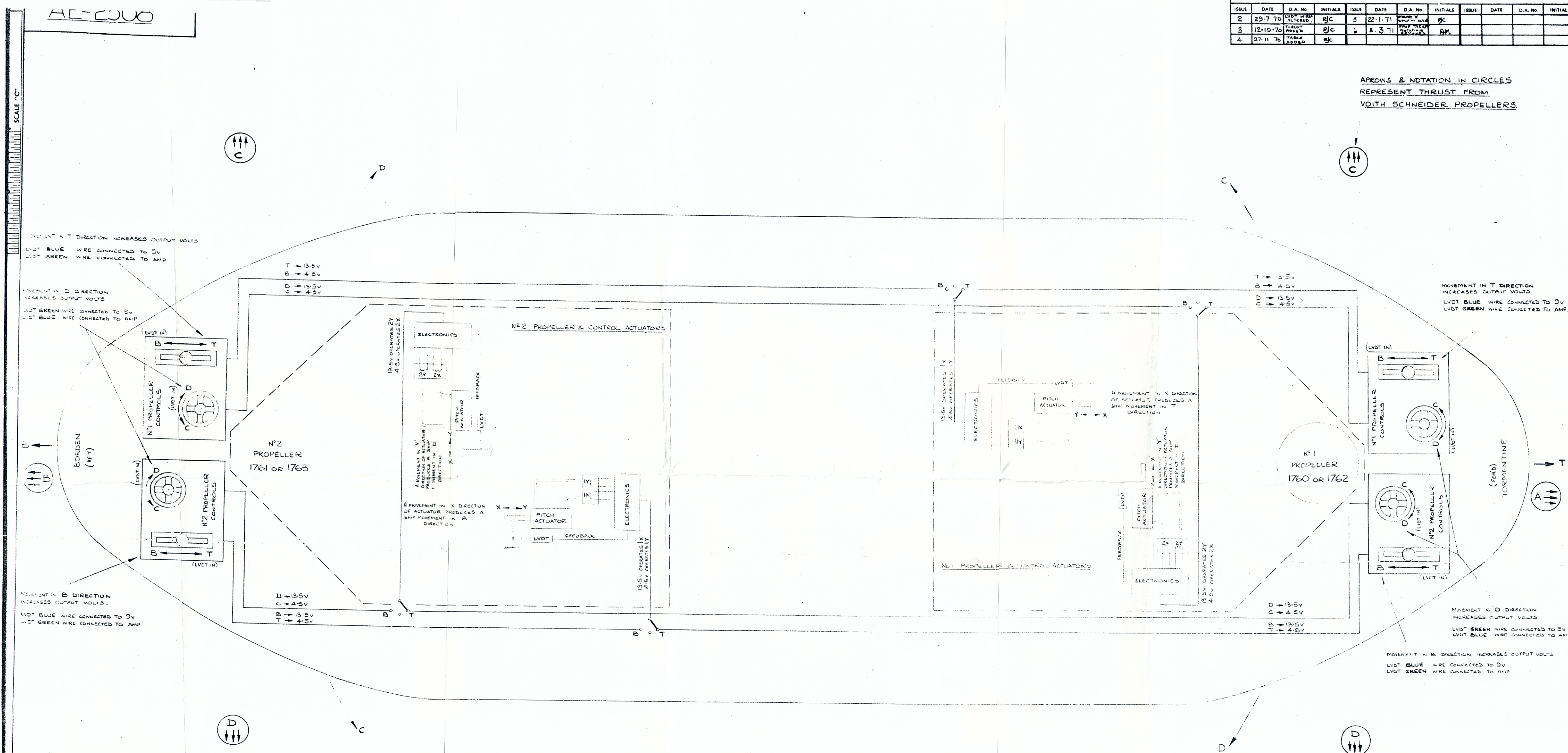

IF MOVEMENT OF ACTUATOR PRODUCES WRONG  
SHIPS DIRECTION CORRECT AT ACTUATOR  
SOLENOIDS & FEEDBACK LVDT

DIRECTIONAL ARROWS B, C, D, OR T REPRESENT SHIP MOVEMENT

IDENTIFICATION NUMBERS STAMPED ON SYSTEM COMPONENTS

	SHIP N°1		SHIP N°2	
	N°1 PROPELLER	N°2 PROPELLER	N°1 PROPELLER	N°2 PROPELLER
CONTROL CHASSIS	1A	1B	2A	2B
ARMENTINE BRIDGE CONTROL PLATE	1D	1E	2D	2E
BORDEN BRIDGE CONTROL PLATE	1G	1F	2G	2F
CONTROL VALVE PLATE	1N	1M	2N	2M
PITCH ACTUATOR	1J	1L	2J	2L
FUSE PLATE	1I	1K	2I	2K

MOTION	N°1 PROPELLER	N°2 PROPELLER
AREAS - ASTERN		
ACTUATOR	REVERSE T241 & T243	REVERSE T441 & T443
LVDT	REVERSE T242 & T244 AT LVDT	REVERSE T442 & T444 AT LVDT
ATHWARTSHIP		
ACTUATOR	REVERSE T245 & T247	REVERSE T445 & T447
LVDT	REVERSE T246 & T248 AT LVDT	REVERSE T446 & T448 AT LVDT

THIS DIAGRAM IS DASHED AT C & D IS FOR THE PURPOSE OF RELATING  
ACTUATOR OUTPUT MOVEMENT WITH MOVEMENT OF OPERATING CONTROL LEVER OR HANDWHEEL