



RETURN BIDS TO:
RETOURNER LES SOUMISSIONS À:
Bid Receiving Public Works and Government
Services Canada/Réception des soumissions Travaux
publics et Services gouvernementaux Canada
800 Burrard Street, Room 219
800, rue Burrard, pièce 219
Vancouver
British Columbia
V6Z 0B9
Bid Fax: (604) 775-9381

SOLICITATION AMENDMENT

MODIFICATION DE L'INVITATION

The referenced document is hereby revised; unless otherwise indicated, all other terms and conditions of the Solicitation remain the same.

Ce document est par la présente révisé; sauf indication contraire, les modalités de l'invitation demeurent les mêmes.

Comments - Commentaires

Vendor/Firm Name and Address
Raison sociale et adresse du
fournisseur/de l'entrepreneur

Issuing Office - Bureau de distribution
Public Works and Government Services Canada -
Pacific Region
800 Burrard Street, Room 219
800, rue Burrard, pièce 219
Vancouver
British C
V6Z 0B9

Title - Sujet SAR Station Building Construction	
Solicitation No. - N° de l'invitation F1700-165108/A	Amendment No. - N° modif. 002
Client Reference No. - N° de référence du client F1700-165108	Date 2016-11-30
GETS Reference No. - N° de référence de SEAG PW-\$PWY-028-7909	
File No. - N° de dossier PWY-6-39207 (028)	CCC No./N° CCC - FMS No./N° VME
Solicitation Closes - L'invitation prend fin at - à 02:00 PM on - le 2016-12-09	
Time Zone Fuseau horaire Pacific Standard Time PST	
F.O.B. - F.A.B. Plant-Usine: <input type="checkbox"/> Destination: <input checked="" type="checkbox"/> Other-Autre: <input type="checkbox"/>	
Address Enquiries to: - Adresser toutes questions à: Lam (PWY), Tian	Buyer Id - Id de l'acheteur pwy028
Telephone No. - N° de téléphone (604) 775-9382 ()	FAX No. - N° de FAX (604) 775-6633
Destination - of Goods, Services, and Construction: Destination - des biens, services et construction: DFO - Prince Rupert SAR Station Building Construction - Prince Rupert, BC	

Instructions: See Herein

Instructions: Voir aux présentes

Delivery Required - Livraison exigée	Delivery Offered - Livraison proposée
Vendor/Firm Name and Address Raison sociale et adresse du fournisseur/de l'entrepreneur	
Telephone No. - N° de téléphone Facsimile No. - N° de télécopieur	
Name and title of person authorized to sign on behalf of Vendor/Firm (type or print) Nom et titre de la personne autorisée à signer au nom du fournisseur/ de l'entrepreneur (taper ou écrire en caractères d'imprimerie)	
Signature	Date

Solicitation No. - N° de l'invitation
F1700-165108/A

Amd. No. - N° de la modif.
002

Buyer ID - Id de l'acheteur
pwy028

Client Ref. No. - N° de réf. du client

File No. - N° du dossier CCC No./N°
PWY-6-39207

CCC - FMS No./N° VME

Les documents français seront disponibles sur demande.

The Solicitation Amendment 002 is raised to issue Addendum #1

Vous trouverez l'addenda n° 2 ci-joint.

Les autres conditions ne changent pas.

***The following changes in the Tender Documents are effective IMMEDIATELY.
This addendum will form part of the Contract Documents***

Amend/revise the Standard Contract Documents as follows:

Clarifications & General Information

1. Aluminium Frame provided by Owner anticipated delivery for mid to late December.
2. Workbench in room 101 not in contract.
3. Network cabinet to be supplied by contractor. Switch to be supplied by client.

Contractor Questions

Question:

Can you give us the manufacturer of the eps panels please?

Response:

Design and standards for Prefabricated wall and roof panel design and specification are based on system provided by Mansonville Plastics, Korolite Engineering Panel Structures Ltd. Surry B.C.

Question:

Can we alternate with structural insulated panel that have zinc oxide powder built into OSB sheathing.

Response:

Insulated panels are to meet specification. Panel types containing OSB will not be accepted as alternates.

Question:

Can you find out what the capacity of the existing concrete wharf is? We want to set a crane up on in to fly in new structural steel

Response:

See attached plan of adjacent wharf for general information.

ARCHITECTURAL

Refer to architectural Drawings:

1/A6.02 & 4/A6.03 – see revised attached

See additional items to be provided by owner as part of the Aluminium frame package.

A7.01

See attached revised detail 1- Note partition wall & folding door height.

A7.01

See attached revised details 4, 5 & 6 showing additional dimensions.

7/ A7.02

See attached revised gear storage elevation.

STRUCTURAL

1. Refer to Structural frame drawings (4-30-16-SF) A/5 of 11 & 1/10 of 11: Gusset plate for cable bracing has been deleted from steel frame package. No cable bracing is required.
2. **S2.01** All metal structural support beams and metal porch fabrications to be hot dipped galvanized.

MECHANICAL

1. See attached Mechanical addendum A-M01. (1 page)

ELECTRICAL

1. See attached statement of work for coast guards general electrical standards. (8 pages)
2. Additional Electrical addendum to follow regarding site servicing.

SPECIFICATION

SECTION 07 41 16 Pre Fabricated Wall and Roof Panels

2.1 .1 Roof and Floor Panel Description

Delete

.1 ~~.1 Minimum R Value: R20~~

Add

.1 .1 Minimum R Value: R34

SECTION 09 65 10 Resilient Flooring

2.1 .1 Rubber flooring

Delete

4. ~~Thickness; Not less than 4mm~~

Add

4. Thickness; Not less than 3mm

SECTION 06 41 11 Architectural Woodwork and Finish Carpentry

2.11 .5

“plant on” backsplash is acceptable for solid surface counters

SECTION 09 90 00 Painting

2.4 Painting Systems

3 Hot dip galvanized metal: Metal structural support beams and metal porch units.

Delete

~~.1 — EXT 5.3 Epoxy over epoxy primer: G5 gloss finish.~~

Add

.1 EXT 5.2C: Inorganic zinc rich coating

.1 Touch-up all hot dipped galvanized surfaces with zinc rich primer where burned by field welding.

.1 Primer: maximum VOC limit to GS-11.

SECTION 05 12 23- Structural Steel For Buildings

2.1 MATERIALS

Add

2.1.6 .1 All metal structural support beams and metal porch fabrications to be hot dipped galvanized.

End Of Addendum 1



PRINCE

RUPERT

WATERLOT IN FRONT OF WATERFRONT BLOCK B
PLAN 1161

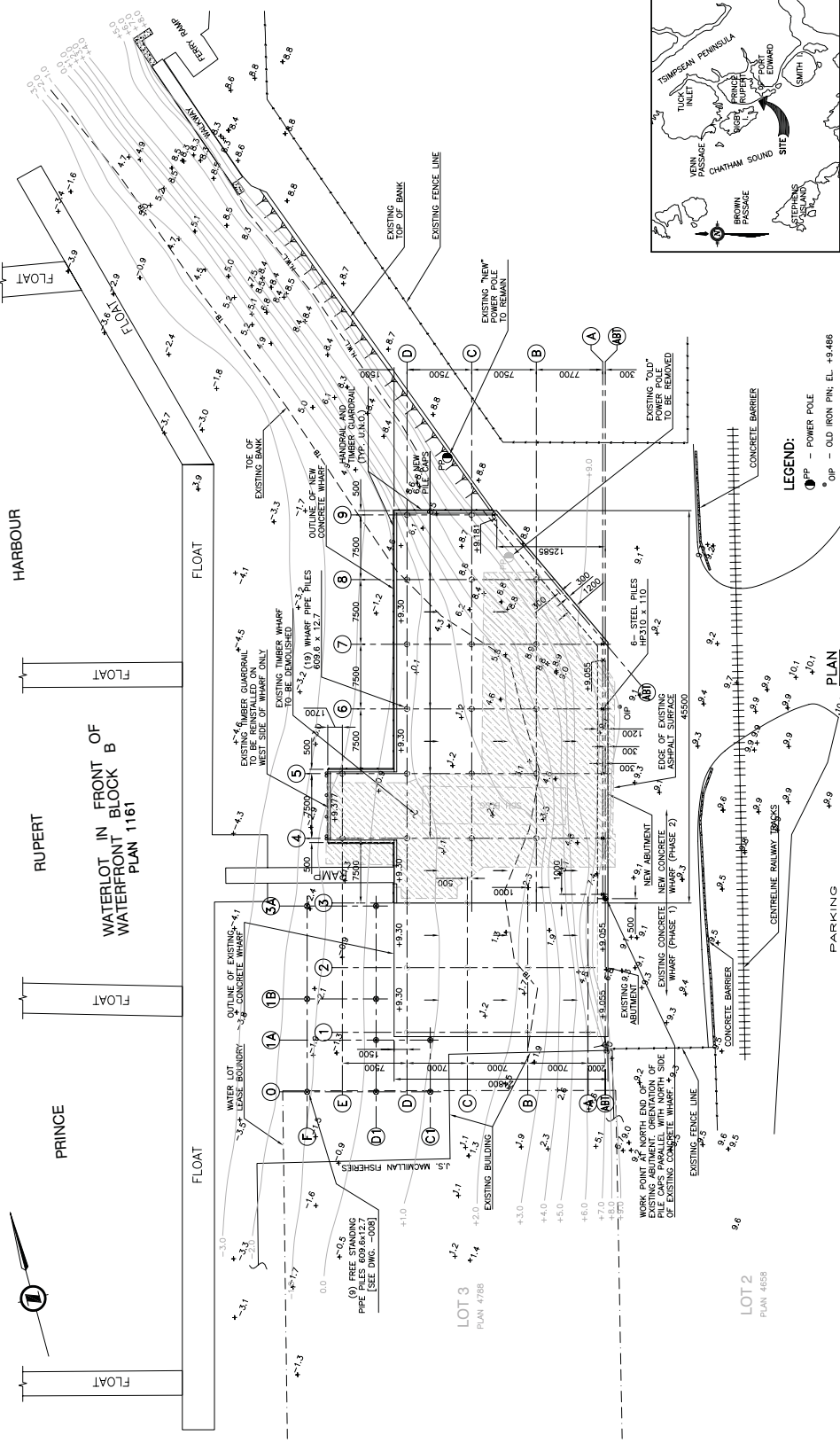

DESIGN CRITERIA:

- LIVE LOADS**
- UNIFORMLY DISTRIBUTED LIVE LOAD = 10.0MPa
 - LIVE LOAD FROM VEHICLE TRAFFIC ON WHARF EXPANSION:
2 AXLE STRAIGHT TRUCK WITH A GVW = 9,070kg
TRAILER WITH A GVW = 16,300kg
- ENVIRONMENTAL**
- WATER LEVEL:
HIGHER HIGH WATER LEVEL (H.H.W.L.) = +7.5m
MEAN HIGH WATER LEVEL (M.H.W.L.) = +6.0m
LOWER LOW WATER LEVEL (L.L.W.L.) = +4.0m
 - SNOW:
SPECIFIED GROUND SNOW LOAD $S_g = 1.96Pa$
SPECIFIED ASSOCIATED RAIN LOAD $R = 0.46Pa$
 - WIND:
WIND PRESSURE (1 IN 10 YEARS) $q = 0.54Pa$
 - SEISMIC:
SEISMIC ZONE ACCELERATION RATIO $A = 0.15$
SEISMIC ZONE VELOCITY RATIO $Z = 0.3$
SEISMIC ZONE VELOCITY-RELATED SEISMIC ZONE $Z = 5$

GENERAL NOTES:

- GENERAL**
- ALL DIMENSIONS ARE IN MILLIMETERS UNLESS NOTED OTHERWISE.
 - ELEVATIONS ARE IN METRES RELATIVE TO LOCAL TIDE & CHART DATUM.
[EL. 0.0 GEODETIC DATUM = EL. +3.8 TIDE & CHART]
 - PLAN BASED ON SMALL CRAFT HARBOURS FACILITY PLAN FOR FAIRVIEW
 - EXISTING TOPOGRAPHY AND BATHYMETRY BASED ON SURVEY PLAN 43846-01 BY MELHANNEN CONSULTING SERVICES LTD., DATED AUG. 16/04
 - GEOTECHNICAL INFORMATION BASED ON DATA PRESENTED IN THE GEOTECHNICAL REPORT BY GOLDER ASSOCIATES LTD. DATED FEBRUARY 24, 2005
- STRUCTURAL AND MISCELLANEOUS STEEL**
- ALL BOLTS TO CONFORM TO ASTM A325 UNLESS NOTED OTHERWISE.
 - ALL BOLTS TO CONFORM TO CAN CSA STD. G40.21/G40.21 UNLESS NOTED OTHERWISE.
 - ALL WELDING TO CONFORM TO CAN CSA STD. W47, W48 & W59. THE MINIMUM WELD SIZE TO BE 6mm.
 - PIPE PILE SECTIONS SHALL CONFORM WITH A.S.T.M. SPECIFICATIONS A522, GRADE 3 OR APPROVED EQUIVALENT.
 - ALL DIMENSIONS OF STRUCTURAL AND MISCELLANEOUS STEEL TO BE IN ACCORDANCE WITH TECHNICAL SPECIFICATIONS.
 - ANCHOR BOLTS TO BE DRIVING THREADED BARS COMPLETE WITH STANDARD HOT DIP GALVANIZED SINGLE CORROSION PROTECTION. STEEL GRADE 517/890.

REINFORCED CONCRETE

- CONCRETE CONSTRUCTION AND MATERIALS TO CONFORM TO CAN CSA STD. A23.1.
ALL CONCRETE TO BE NORMAL DENSITY WITH CLASS C-1 EXPOSURE
ALL CONCRETE TO BE TYPE 10
ALL CONCRETE TO BE 28 DAY COMPRESSIVE STRENGTH AFTER 28 DAY TO BE 35 MPa UNLESS NOTED OTHERWISE.
 - ALL REINFORCING STEEL TO BE DEFORMED BARS GRADE 400 CONFORMING TO CAN CSA STD. G30.18.
 - MINIMUM COVER TO ALL REINFORCEMENT TO BE 50mm UNLESS NOTED OTHERWISE.
 - ALL REINFORCEMENT HOOKS, LAPS AND DEVELOPMENT LENGTHS TO BE IN ACCORDANCE WITH CAN CSA STD. A23.3.
 - ALL EXPOSED CONCRETE EDGES TO BE CHAMFERED 20mm.
- DIMENSIONED LUMBER & SAWN LUMBER**
- ALL DIMENSIONED LUMBER AND SAWN LUMBER:
PACIFIC COAST D-FIR, No.2 STRUCTURAL GRADE OR BETTER.
 - ALL DIMENSIONED LUMBER AND SAWN LUMBER TO BE COA TREATED
CONFORMING TO CAN/CSA STD. 080 AND B.M.F. SEE TECHNICAL SPECIFICATIONS.
- PILE DRIVING**
- STEEL PIPE PILES TO BE SOCKETED A MINIMUM OF 2m INTO BEDROCK.
 - STEEL H-PILES TO BE DRIVEN TO REFUSAL.

LEGEND:

- OP - POWER POLE
- OP - OLD IRON PILE EL. +9.486

PLAN 1:250

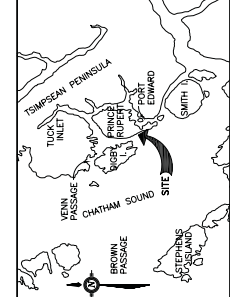

KEY PLAN

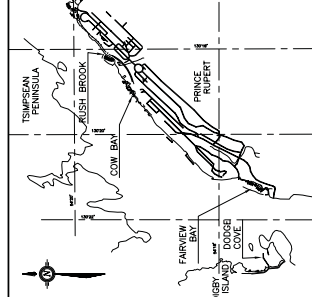

LOCATION PLAN
SCALE 1:10,000

VJA ENGINEERING & ASSOC. LTD. VANCOUVER, B.C.	
VIA Job No. 27121	
Public Works and Transportation Services City of Prince Rupert Pacific Region	
Project: CONCRETE WHARF PHASE 2 GENERAL ARRANGEMENT	
Drawing no. 863226	
Drawing no. 27121-001	
Scale: 1:10,000	
Date: MAY 14/07	
Author: U.S. L.A.	
Checked: U.S. L.A.	
Approved: U.S. L.A.	
Project Manager: U.S. L.A.	
Submitted: U.S. L.A.	
Reviewed: U.S. L.A.	
No. of sheets: 1	
No. of sheets: 1	

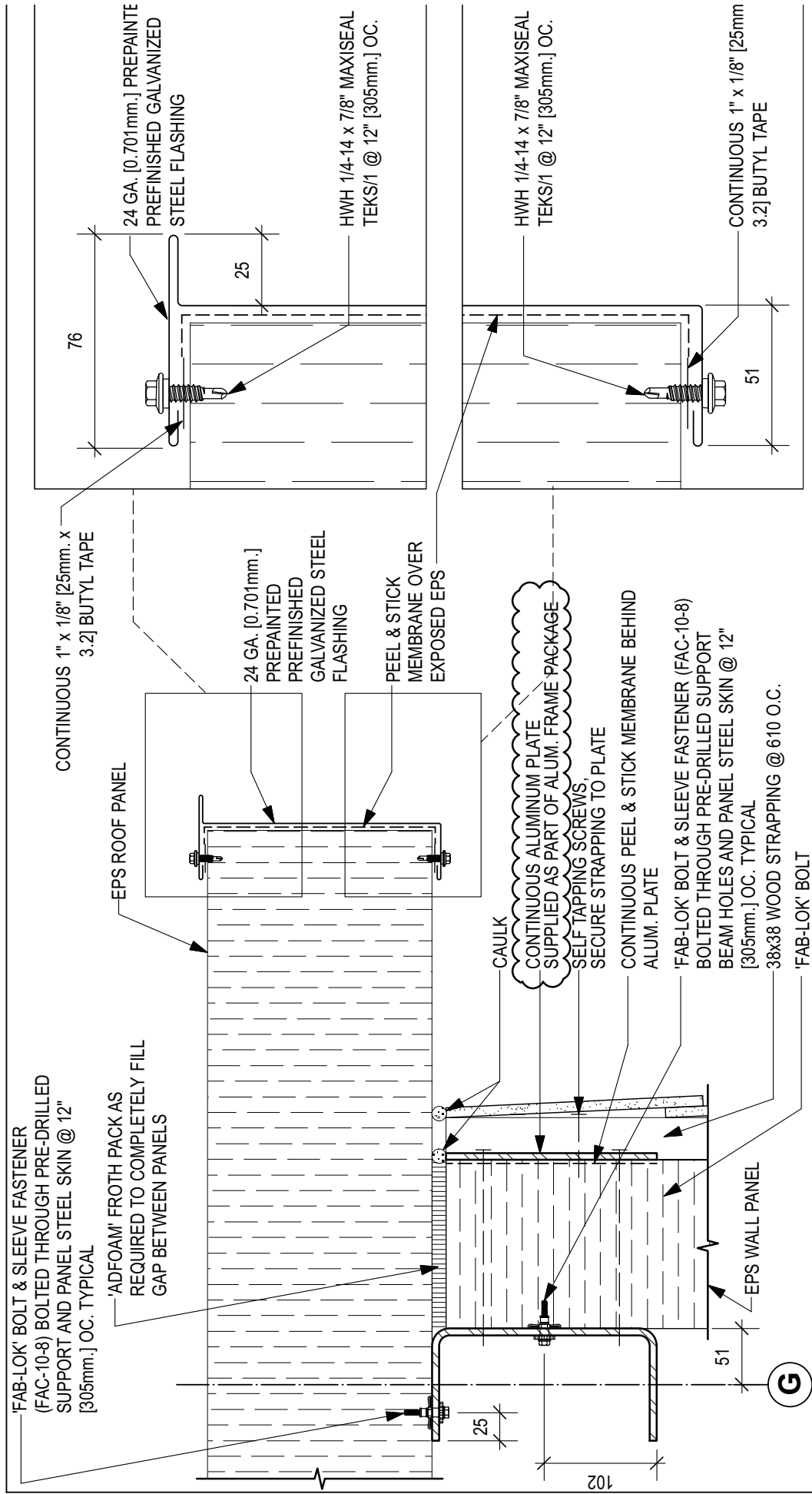

1 TYPICAL ROOF GABLE DETAIL

SCALE: 1:5

A6.02

